

CLEAR CHOICE HURRICANE IMPACT GLASS BLOCK WINDOW

GENERAL NOTES

- 1 - THIS WINDOW HAS BEEN DESIGNED AND TESTED IN ACCORDANCE WITH THE REQUIREMENTS OF THE CURRENT EDITION OF THE 2018 INTERNATIONAL BUILDING CODE (IBC) AND 2018 INTERNATIONAL RESIDENTIAL CODE (IRC).
- 2 - THIS WINDOW AS SHOWN HEREIN IS LARGE AND SMALL MISSILE IMPACT RATED. SHUTTERS ARE NOT REQUIRED.
- 3 - WOOD OR MASONRY OPENINGS, 1x OR 2x WOOD BUCKS, AND BUCK FASTENERS ARE BY OTHERS, AND SHALL BE PROPERLY DESIGNED & INSTALLED TO TRANSFER WIND LOADS IMPOSED BY THE GLAZING SYSTEM TO THE BUILDING STRUCTURE.
- 4 - ANCHOR TYPE, SIZE, SPACING AND EMBEDMENT SHALL BE AS SPECIFIED IN THESE DRAWINGS. ANCHOR EMBEDMENT TO SUBSTRATE SHALL BE BEYOND WALL DRESSING OR STUCCO.
- 5 - ALL FASTENERS PENETRATING INTO PRESSURE TREATED WOOD SHALL BE CAPABLE OF PREVENTING CORROSION DUE TO REACTION WITH PRESSURE TREATMENT CHEMICAL.
- 6 - DISSIMILAR MATERIALS THAT COME INTO CONTACT SHALL BE PROTECTED TO PREVENT GALVANIC REACTIONS.
- 7 - A WIND LOAD DURATION FACTOR Cd = 1.6 WAS USED FOR THE ANALYSIS OF WOOD SCREWS ONLY.
- 8 - SUBSTRATES SHALL MEET THE MINIMUM STRENGTH REQUIREMENTS AS SHOWN IN INSTALLATION ANCHOR REQUIREMENTS TABLE ON SHEET 2. CONCRETE OR MASONRY SUBSTRATES SHALL NOT BE CRACKED. FOR INSTALLATION TO METAL SUBSTRATES, ANCHORS SHALL BE LONG ENOUGH TO BE FULLY THREADED THROUGH THE METAL THICKNESS WITH AN ADDITIONAL 3/16" MIN. OF THREADS BEYOND.
- 9 - CORNER CONSTRUCTION - THE PVC CHANNELS ARE MITERED AND THERMALLY WELDED AT ALL CORNERS.

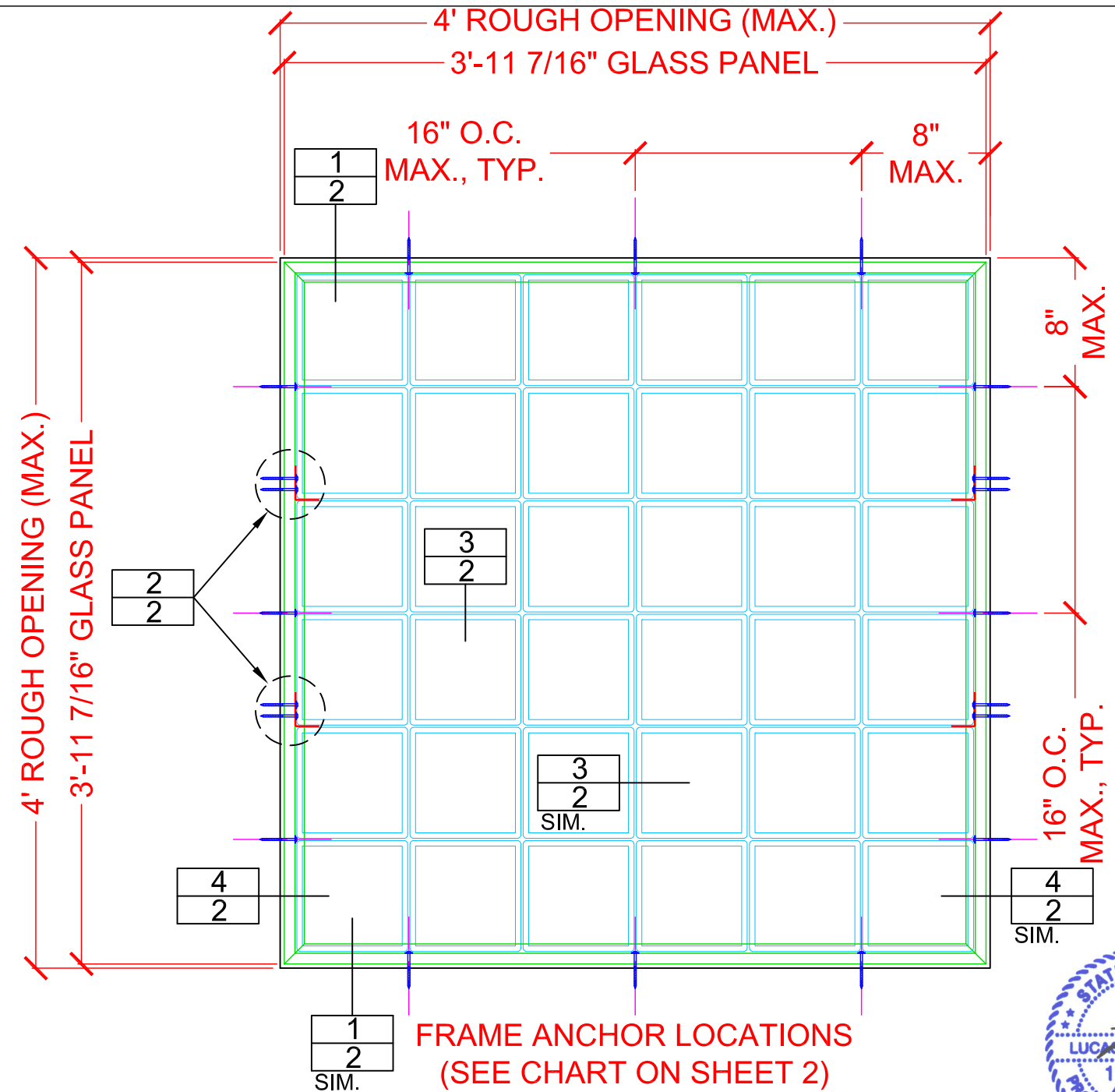

DESIGN PRESSURE
+/- 80.2 PSF

ELEVATION VIEW



11/1/2021
Lucas A. Turner, P.E.
TX PE #115094
Turner Engineering & Consulting, Inc.
TBPE Reg. #F-18075
2428 Old Natchez Trc Trl
Camden, TN 38320
Ph. 941-380-1574

MEDINA GLASS BLOCK, INC. dba THE GLASS BLOCK SUPPLY COMPANY 1213 MEDINA ROAD MEDINA, OHIO 44256		
JOB CLEAR CHOICE HURRICANE WINDOW SYSTEM		
ARCHITECT .		
SCALE N.T.S.	CONTRACTOR .	
DATE 9-27-21	SHEET 1	REV D
DRAWN BY R.BECAJ	CHECKED BY S.BOESCH	DRAWING NO MGBCCCH-TDI

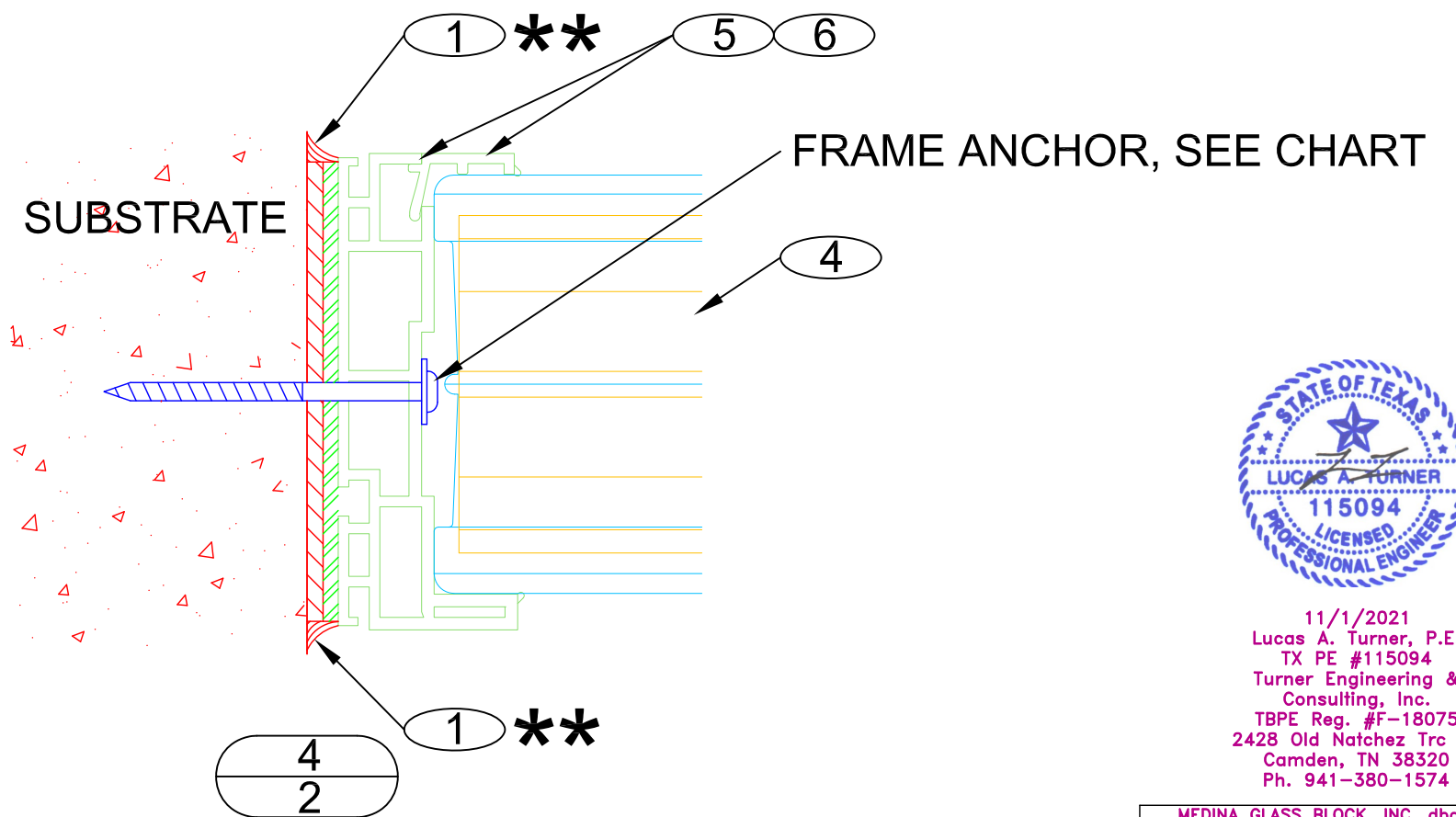
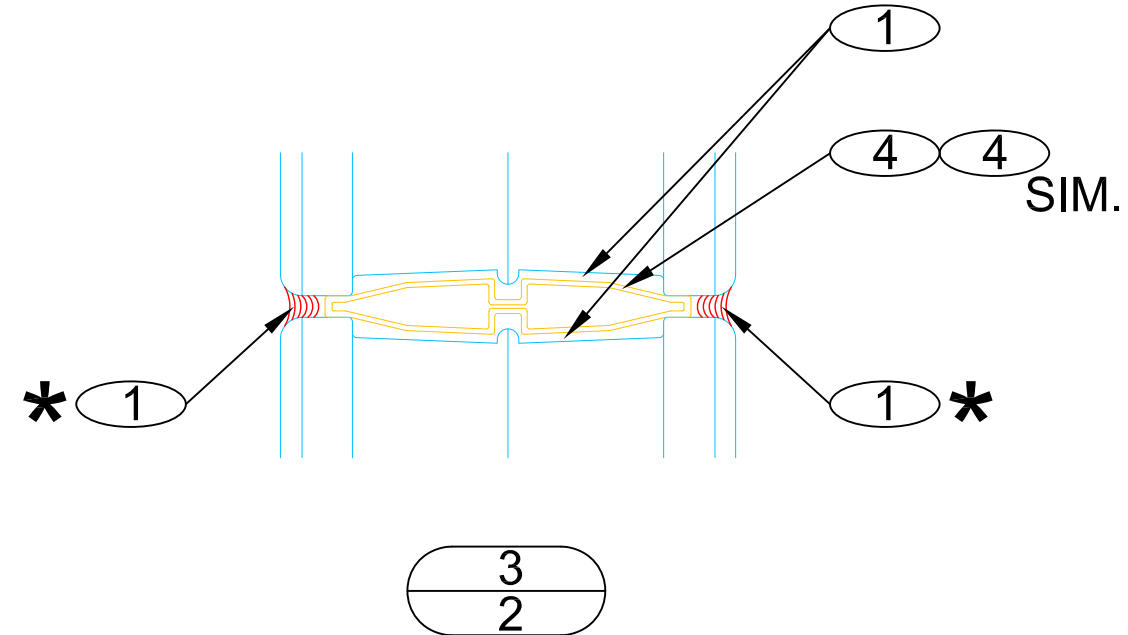
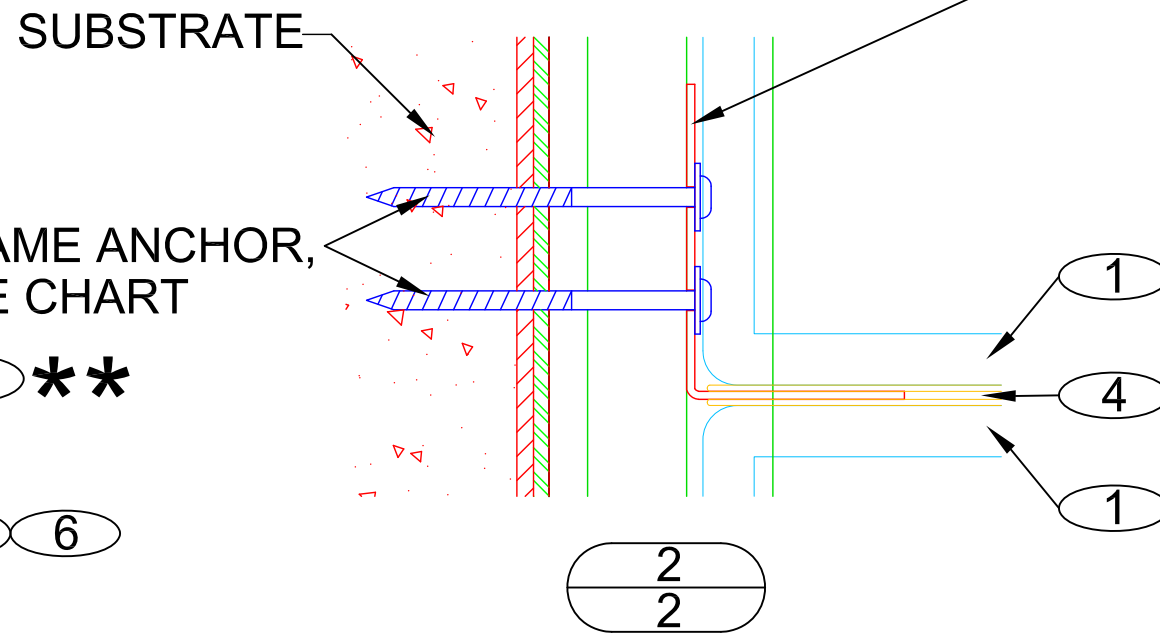
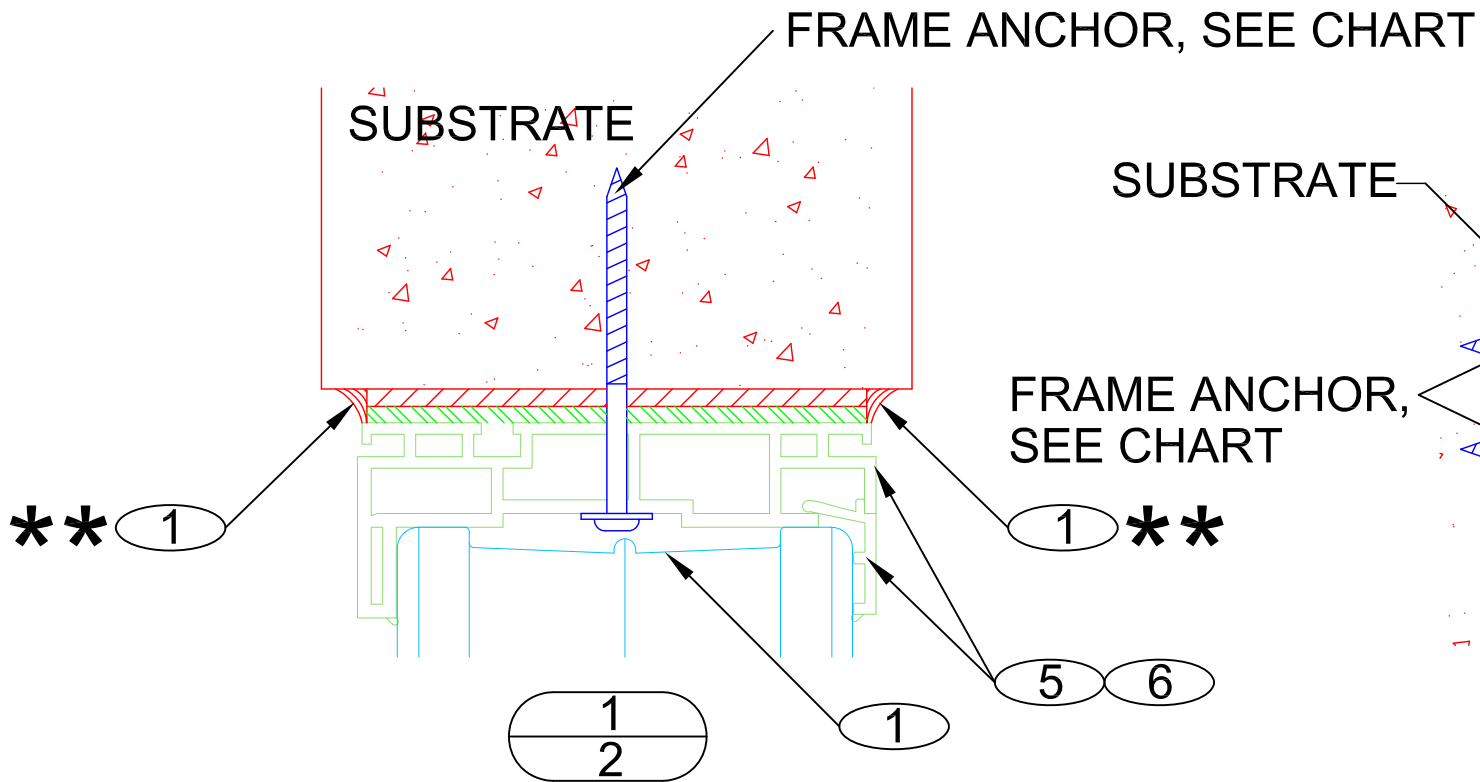

FRAME ANCHOR CHART

ID	SUBSTRATE	ANCHOR	MINIMUM EMBEDMENT	MIN. EDGE DISTANCE
A	CONCRETE (3,050 PSI MIN)	ELCO ULTRACON+	1 3/4"	2 1/2"
	GROUT FILLED CMU (ASTM-90)	ELCO ULTRACON+	1 1/4"	2 1/2"
B	2X4 MIN. SOUTHERN PINE (G=0.55 MIN.)	#10 WOOD SCREW (GR. 5 MIN.)	1 3/8"	1"
C	16 GAUGE (.060) MIN. STEEL STUD 33 KSI YIELD MIN.	#10 TEKS-TYPE THREAD CUTTING SCREW (GR.5 MIN.)	SEE NOTE	1/2"
	1/8" ALUM. 6063-T5 MIN. or 1/8" STEEL 33 KSI MIN.	#10 TEKS-TYPE THREAD CUTTING SCREW (GR.5 MIN.)	SEE NOTE	1/2"

FASTENER NOTES:
 1 - FOR INSTALLATION TO METAL SUBSTRATES, ANCHORS SHALL BE LONG ENOUGH TO BE FULLY THREADED THROUGH THE METAL THICKNESS WITH AN ADDITIONAL 3/16" MIN. OF THREADS BEYOND.
 2 - METAL AND CONCRETE ANCHORS MAY BE INSTALLED THRU 1x WOOD BUCKS, PROVIDED THEY ARE ANCHORED SUFFICIENTLY BY OTHERS TO TRANSFER LOADS TO THE BUILDING STRUCTURE.

- * 1 5/16" SILICONE JOINT
- ** 1 5/16" SILICONE JOINT, 1/4" MAX. SHIM & EXPANSION, HEAD, SILL & JAMBS



11/1/2021
 Lucas A. Turner, P.E.
 TX PE #115094
 Turner Engineering & Consulting, Inc.
 TBPE Reg. #F-18075
 2428 Old Natchez Trc Trl
 Camden, TN 38320
 Ph. 941-380-1574

MEDINA GLASS BLOCK, INC. dba THE GLASS BLOCK SUPPLY COMPANY 1213 MEDINA ROAD MEDINA, OHIO 44256			
JOB CLEAR CHOICE HURRICANE WINDOW SYSTEM			
ARCHITECT			
SCALE N.T.S.	CONTRACTOR		
DATE 9-27-21	SHEET 2	REV D	
DRAWN BY R.BECAJ	CHECKED BY S.BOESCH	DRAWING NO.	MGBCCCH-TDI

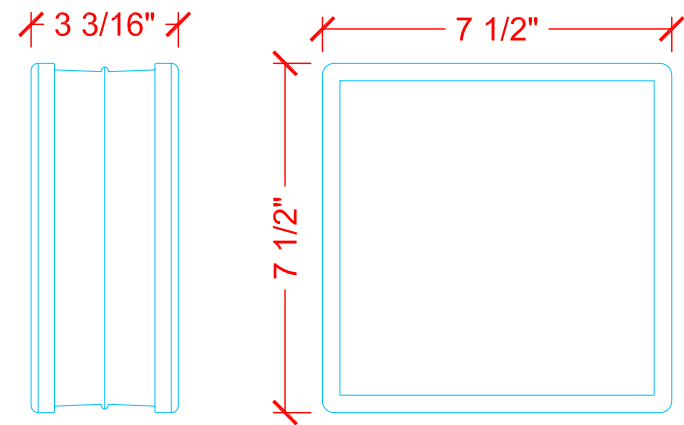

① SEVES 1919/8 BSH 20 GLASS BLOCK

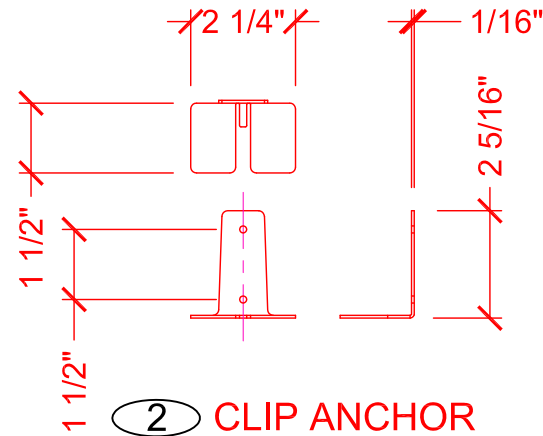

② CLIP ANCHOR

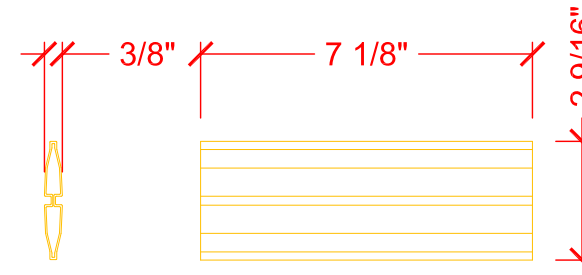

③ VERTICAL SUPPORT

BILL OF MATERIALS			
P/N	DESCRIPTION	MATERIAL	MANUFACTURER
1	GLASS BLOCK UNIT	GLASS	SEVES
2	ANCHOR SCREW	STEEL	KWANTEX RESEARCH
3	VERTICAL SUPPORT	PVC	QUALITY GLASS BLOCK
4	HORIZONTAL SUPPORT	PVC	QUALITY GLASS BLOCK
5	GLAZING STRIP	PVC	GLOBAL VINYL
6	VINYL CHANNEL	PVC	GLOBAL VINYL
7	STRUCTURAL SILICONE	SILICONE	DOW CORNING

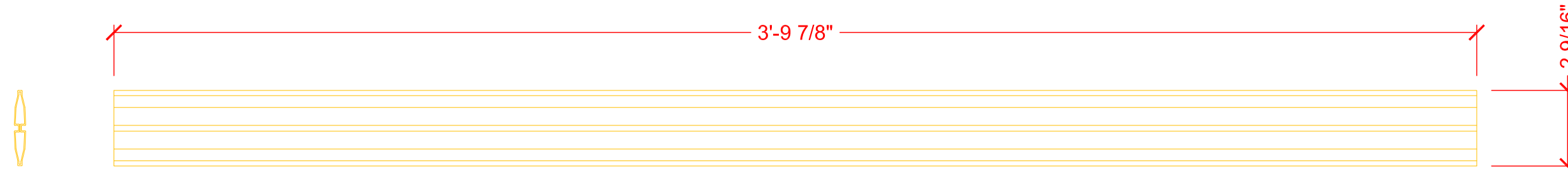

④ HORIZONTAL SUPPORT

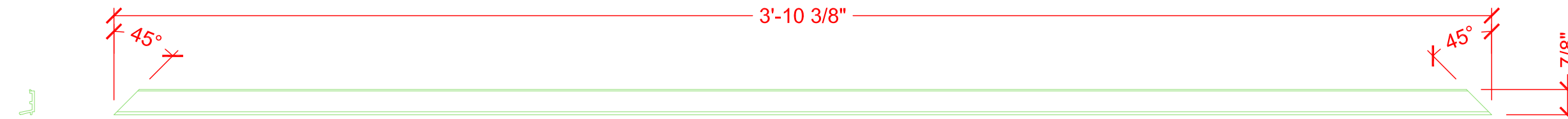

⑤ GLAZING STRIP

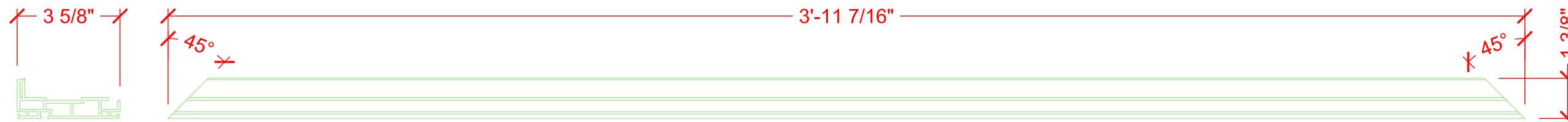

⑥ VINYL CHANNEL
4 PCS., ASSEMBLED WITH WELDED SEAMS



11/1/2021
 Lucas A. Turner, P.E.
 TX PE #115094
 Turner Engineering &
 Consulting, Inc.
 TBPE Reg. #F-18075
 2428 Old Natchez Trc Trl
 Camden, TN 38320
 Ph. 941-380-1574

MEDINA GLASS BLOCK, INC. dba THE GLASS BLOCK SUPPLY COMPANY 1213 MEDINA ROAD MEDINA, OHIO 44256			
JOB CLEAR CHOICE HURRICANE WINDOW SYSTEM			
ARCHITECT .			
SCALE N.T.S.	CONTRACTOR .		
DATE 9-27-21	SHEET 3	REV D	
DRAWN BY R.BECAJ	CHECKED BY S.BOESCH	DRAWING NO MGBCCCH-TDI	