

TYPICAL ELEVATION WITH FASTENER SPACING

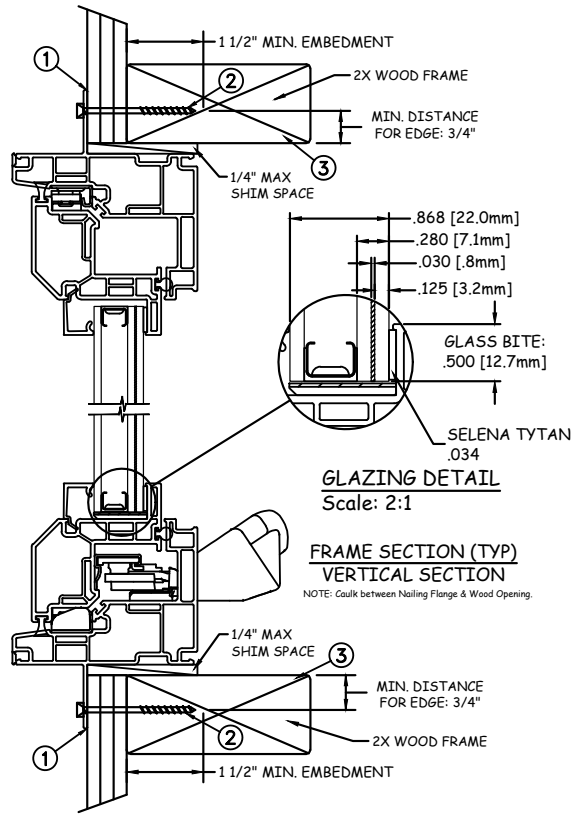

GLAZING DETAIL
Scale: 2:1

FRAME SECTION (TYP)
VERTICAL SECTION

NOTE: Caulk between Nailing Flange & Wood Opening.

NAIL FIN INSTALLATION

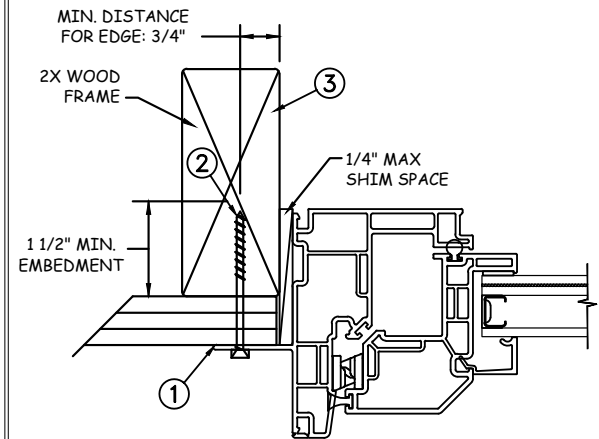

JAMB SECTION (TYP)
HORIZONTAL SECTION

NOTE: Caulk between Nailing Flange & Wood Opening.

Max Frame	DP RATING	IMPACT
108 x 72	+50/-55	YES

WINDZONE 2

Installation Notes:

1. Seal flange/frame to substrate. Sill shall be on a continuous serpentine bead of structural grade silicone caulk when no fastener is used to anchor the sill (typical).
2. Use #8 PH or greater fastener through the nail fin with sufficient length to penetrate a minimum of 1 1/2" into the wood framing. For 2X wood frame substrate (min. S.G. = 0.42).
3. Host structure (wood buck, masonry, steel) to be designed and anchored to properly transfer all loads to the structure. The host structure is the responsibility of the architect or engineer of record for the project of installation.

General Notes:

1. The product shown herein is designed, tested and manufactured to comply with the wind load criteria of the adopted 2018 International Building Code (IBC), the 2018 International Residential Code (IRC), the Texas Revisions and the industry requirement for the stated conditions.
2. At minimum, glazing shall be 3.2mm annealed - 11.8mm airspace - 3.2mm annealed - 0.8mm PVB Interlayer by Kurraray - 3.2mm annealed insulated glass.
3. Use structural or composite shims where required.

This schedule addresses only the fasteners required to anchor the window to achieve the rated design pressure up to the size limitations noted. It is not intended as a guide to the installation process and does not address the sealing consideration that may arise in different wall conditions. For the complete installation procedure, see the instructions packaged with the window or go to www.jeld-wen.com.

DISCLAIMER:

This drawing and its contents are confidential and are not to be reproduced or copied in whole or in part or used or disclosed to others except as authorized by JELD-WEN Inc.



Joseph A. Reed

2020.11.30 07:36:04 -05'00'
JOSEPH A. REED, P.E.
 Texas No. 100777
 5 Leigh Drive
 York, PA. 17406
 (717) 846-1200

PROJECT ENGINEER: --	DATE: 11/05/20
DRAWN BY: A. MCMILLAN	SCALE: NTS
CHECKED BY: J. GOOSSEN	TITLE: Premium Vinyl Impact Casement Window-WZ2
APPROVED BY: J. GOOSSEN	
RECORD No.: D013059.2	
REPORT No.: ESP025820P-218	PLANT NAME AND LOCATION: 5.15

JELD-WEN 3737 Lakeport Blvd
 Klamath Falls, OR. 97601
 Phone: (800) 535-3936

CAD DWG. No.: PremVinylCsmnt Cert	REV: B	SHEET 1 OF 4
--------------------------------------	-----------	-----------------

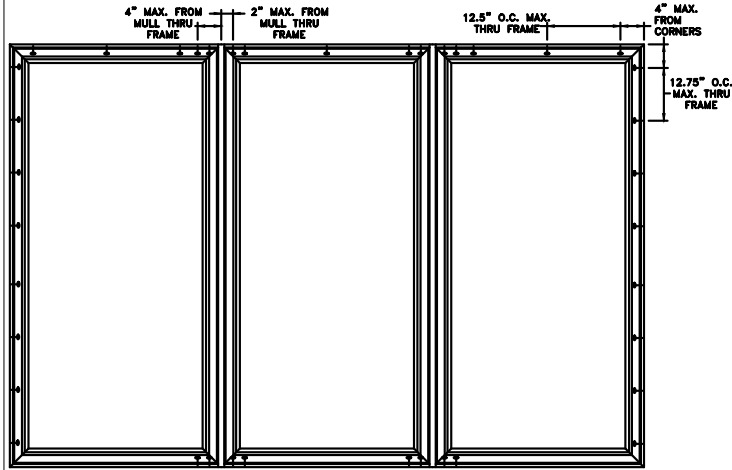

TYPICAL ELEVATION WITH FASTENER SPACING

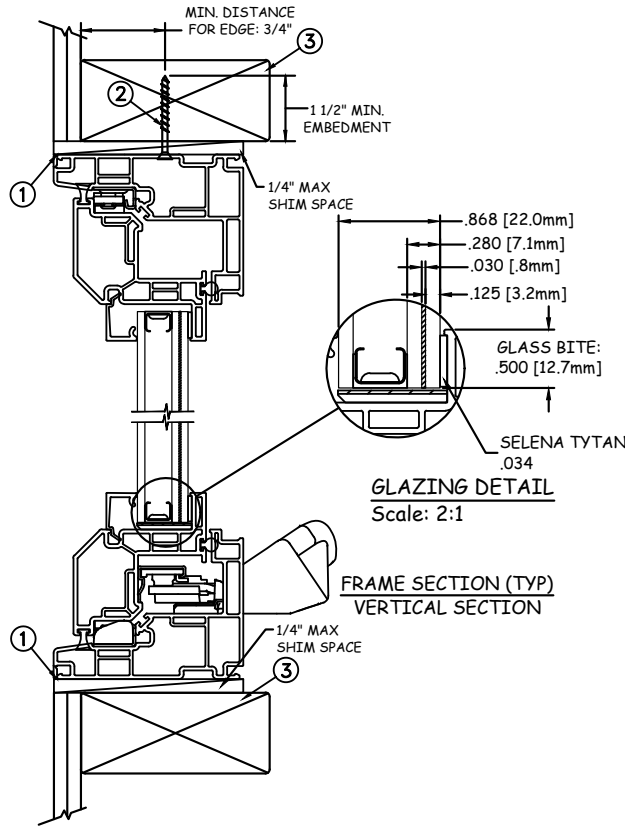

GLAZING DETAIL
Scale: 2:1

FRAME SECTION (TYP)
VERTICAL SECTION

THROUGH FRAME
INSTALLATION

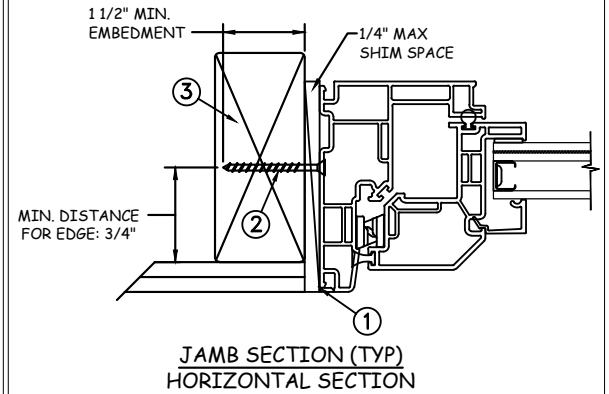

JAMB SECTION (TYP)
HORIZONTAL SECTION

Max Frame	DP RATING	IMPACT
108 x 72	+50/-55	YES

WINDZONE 2

Installation Notes:

1. Seal flange/frame to substrate.
2. Use #8 PH or greater fastener through the frame with sufficient length to penetrate a minimum of 1 1/2" into the wood framing. For 2X wood frame substrate (min. S.G. = 0.42).
3. Host structure (wood buck, masonry, steel) to be designed and anchored to properly transfer all loads to the structure. The host structure is the responsibility of the architect or engineer of record for the project of installation.

General Notes:

1. The product shown herein is designed, tested and manufactured to comply with the wind load criteria of the adopted 2018 International Building Code (IBC), the 2018 International Residential Code (IRC), the Texas Revisions and the industry requirement for the stated conditions.
2. At minimum, glazing shall be 3.2mm annealed - 11.8mm airspace - 3.2mm annealed - 0.8mm PVB Interlayer by Kurraray - 3.2mm annealed insulated glass.
3. Use structural or composite shims where required.

This schedule addresses only the fasteners required to anchor the window to achieve the rated design pressure up to the size limitations noted. It is not intended as a guide to the installation process and does not address the sealing consideration that may arise in different wall conditions. For the complete installation procedure, see the instructions packaged with the window or go to www.jeld-wen.com.

DISCLAIMER:

This drawing and its contents are confidential and are not to be reproduced or copied in whole or in part or used or disclosed to others except as authorized by JELD-WEN Inc.



Joseph A. Reed

2020.11.30 07:36:04 -05'00'
JOSEPH A. REED, P.E.
 Texas No. 100777
 5 Leigh Drive
 York, PA. 17406
 (717) 846-1200

PROJECT ENGINEER: --	DATE: 11/05/20
DRAWN BY: A. MCMILLAN	SCALE: NTS
CHECKED BY: J. GOOSSEN	TITLE: Premium Vinyl Impact Casement Window-WZ2
APPROVED BY: J. GOOSSEN	
RECORD No.: D013059.2	
REPORT No.: ESP025820P-2185.15	PLANT NAME AND LOCATION:

JELD-WEN 3737 Lakeport Blvd
 Klamath Falls, OR. 97601
 Phone: (800) 535-3936

CAD DWG. No.: PremVinylCsmnt Cert	REV: B	SHEET 2 OF 4
--------------------------------------	-----------	-----------------

MASONRY INSTALLATION

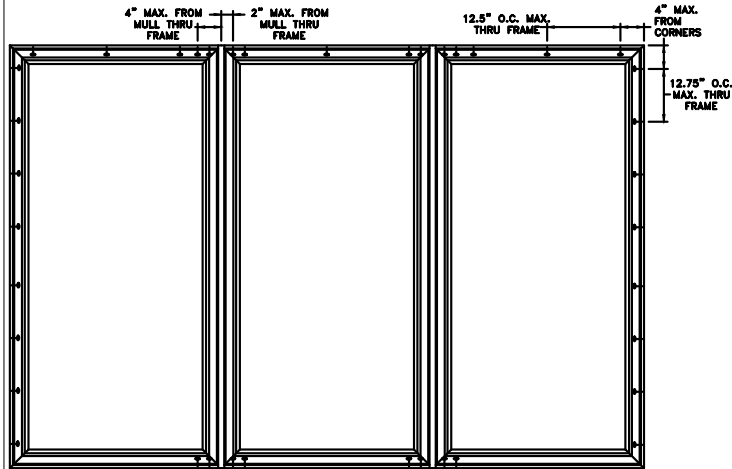

TYPICAL ELEVATION WITH FASTENER SPACING

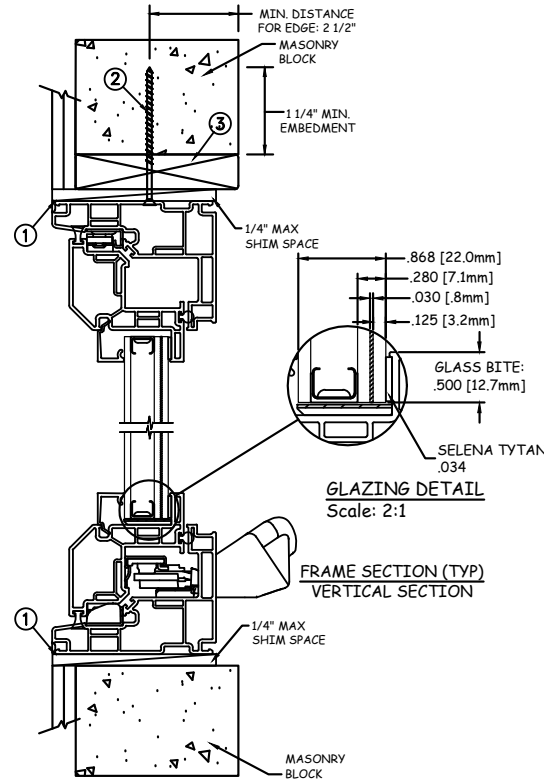

GLAZING DETAIL
Scale: 2:1

FRAME SECTION (TYP)
VERTICAL SECTION

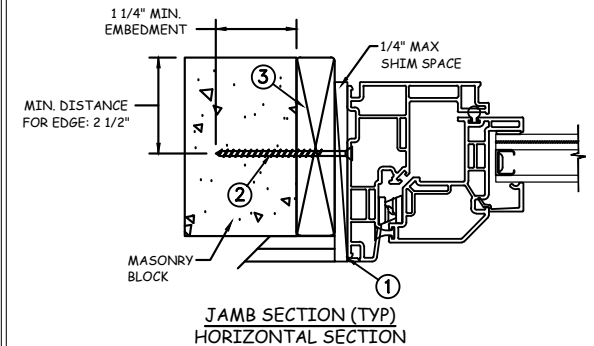

JAMB SECTION (TYP)
HORIZONTAL SECTION

Max Frame	DP RATING	IMPACT
108 x 72	+50/-55	YES

WINDZONE 2

Installation Notes:

1. Seal flange/frame to substrate.
2. Use 3/16" Tapcon or equivalent fasteners through frame with sufficient length to penetrate a minimum of 1 1/4" into concrete or masonry at each location with a 2 1/2" min from edge distance. For concrete (min. = 3000psi) or masonry (min. = 2000psi) (CMU shall conform to ASTM C90).
3. Host structure (wood buck, masonry, steel) to be designed and anchored to properly transfer all loads to the structure. The host structure is the responsibility of the architect or engineer of record for the project of installation.

General Notes:

1. The product shown herein is designed, tested and manufactured to comply with the wind load criteria of the adopted 2018 International Building Code (IBC), the 2018 International Residential Code (IRC), the Texas Revisions and the industry requirement for the stated conditions.
2. At minimum, glazing shall be 3.2mm annealed - 11.8mm airspace - 3.2mm annealed - 0.8mm PVB Interlayer by Kurraray - 3.2mm annealed insulated glass.
3. Use structural or composite shims where required.

This schedule addresses only the fasteners required to anchor the window to achieve the rated design pressure up to the size limitations noted. It is not intended as a guide to the installation process and does not address the sealing consideration that may arise in different wall conditions. For the complete installation procedure, see the instructions packaged with the window or go to www.jeld-wen.com.

DISCLAIMER:

This drawing and its contents are confidential and are not to be reproduced or copied in whole or in part or used or disclosed to others except as authorized by JELD-WEN Inc.



Joseph A. Reed

2020.11.30 07:36:04 -05'00'
JOSEPH A. REED, P.E.
 Texas No. 100777
 5 Leigh Drive
 York, PA. 17406
 (717) 846-1200

PROJECT ENGINEER: --	DATE: 11/05/20	JELD-WEN	3737 Lakeport Blvd Klamath Falls, OR. 97601 Phone: (800) 535-3936	
DRAWN BY: A. MCMILLAN	SCALE: NTS			
CHECKED BY: J. GOOSSEN	TITLE: Premium Vinyl Impact Casement Window-WZ2			
APPROVED BY: J. GOOSSEN	RECORD No.: D013059.2			
REPORT No.: ESP025820P-218	PLANT NAME AND LOCATION: 5.15	CAD DWG. No.: PremVinyl/Csmt Cert	REV: B	SHEET 3 OF 4

STEEL INSTALLATION

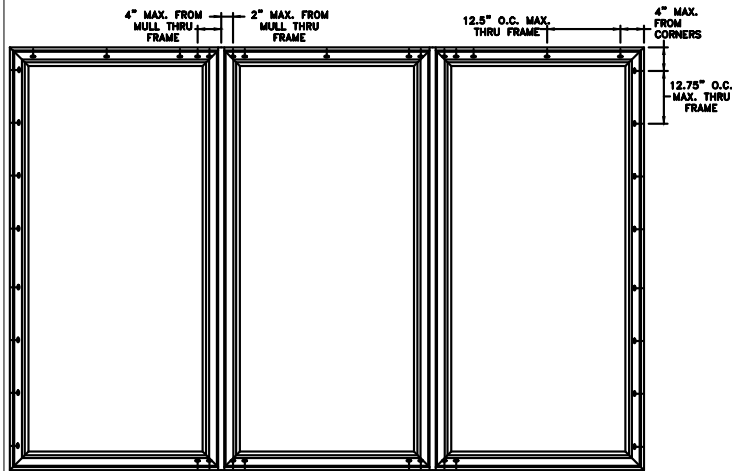

TYPICAL ELEVATION WITH FASTENER SPACING

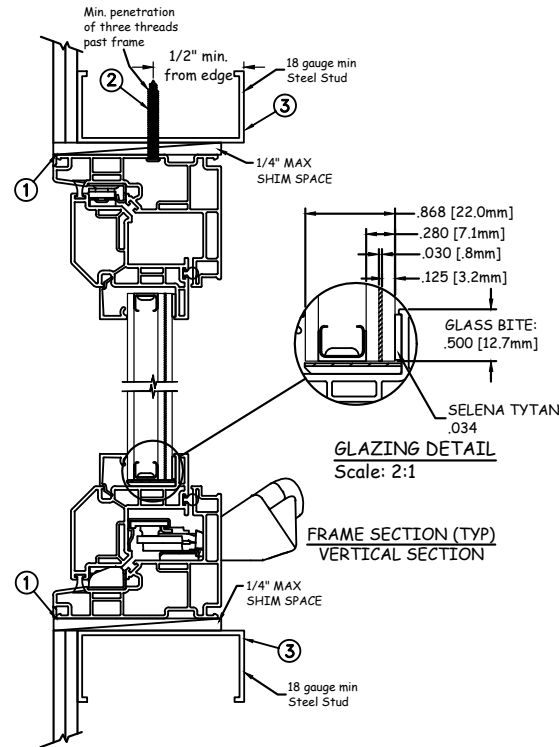

GLAZING DETAIL
Scale: 2:1

FRAME SECTION (TYP)
VERTICAL SECTION

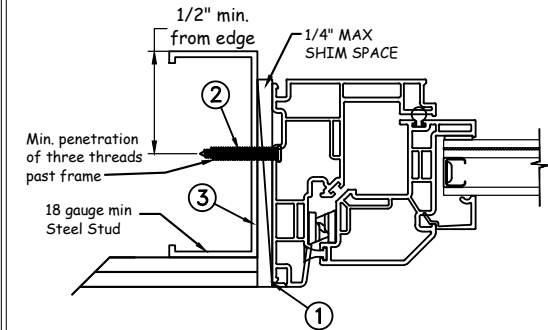

JAMB SECTION (TYP)
HORIZONTAL SECTION

Max Frame	DP RATING	IMPACT
108 x 72	+50/-55	YES

WINDZONE 2

Installation Notes:

1. Seal flange/frame to substrate.
2. For anchoring into metal framing, use #8 TEK Self Tapping screws with sufficient length to achieve a minimum penetration of three threads past the frame thickness. Locate anchors as shown in elevations and installation details. Steel substrate min. 18ga., fy = 33 ksi.
3. Host structure (wood buck, masonry, steel) to be designed and anchored to properly transfer all loads to the structure. The host structure is the responsibility of the architect or engineer of record for the project of installation.

General Notes:

1. The product shown herein is designed, tested and manufactured to comply with the wind load criteria of the adopted 2018 International Building Code (IBC), the 2018 International Residential Code (IRC), the Texas Revisions and the industry requirement for the stated conditions.
2. At minimum, glazing shall be 3.2mm annealed - 11.8mm airspace - 3.2mm annealed - 0.8mm PVB Interlayer by Kurraray - 3.2mm annealed insulated glass.
3. Use structural or composite shims where required.

This schedule addresses only the fasteners required to anchor the window to achieve the rated design pressure up to the size limitations noted. It is not intended as a guide to the installation process and does not address the sealing consideration that may arise in different wall conditions. For the complete installation procedure, see the instructions packaged with the window or go to www.jeld-wen.com.

DISCLAIMER:

This drawing and its contents are confidential and are not to be reproduced or copied in whole or in part or used or disclosed to others except as authorized by JELD-WEN Inc.



Joseph A. Reed

2020.11.30 07:36:04 -05'00'
JOSEPH A. REED, P.E.
 Texas No. 100777
 5 Leigh Drive
 York, PA. 17406
 (717) 846-1200

PROJECT ENGINEER: --	DATE: 11/05/20
DRAWN BY: A. MCMILLAN	SCALE: NTS
CHECKED BY: J. GOOSSEN	TITLE: Premium Vinyl Impact Casement Window-WZ2
APPROVED BY: J. GOOSSEN	
RECORD No.: D013059.2	
REPORT No.: ESP025820P-218	PLANT NAME AND LOCATION: 5.15

JELD-WEN 3737 Lakeport Blvd
 Klamath Falls, OR. 97601
 Phone: (800) 535-3936

CAD DWG. No.: PremVinyl/Csmt Cert	REV: B	SHEET 4 OF 4
--------------------------------------	-----------	-----------------