

REVISIONS			
REV	DESCRIPTION	DATE	APPROVED
A	REVISED PER NEW REQUIREMENTS	09/29/2020	R.L.

NOTES:

1. THE PRODUCT SHOWN HEREIN IS DESIGNED AND MANUFACTURED TO COMPLY WITH REQUIREMENTS OF THE 2018 IBC AND 2018 IRC.
2. WOOD FRAMING AND MASONRY OPENING TO BE DESIGNED AND ANCHORED TO PROPERLY TRANSFER ALL LOADS TO STRUCTURE. FRAMING AND MASONRY OPENING IS THE RESPONSIBILITY OF THE ARCHITECT OR ENGINEER OF RECORD.
3. 1X BUCK OVER MASONRY/CONCRETE IS OPTIONAL.
4. WHERE SHIM OR BUCK THICKNESS IS LESS THAN 1-1/2" WINDOW UNITS MUST BE ANCHORED THROUGH THE FRAME IN ACCORDANCE WITH MANUFACTURER'S PUBLISHED INSTALLATION INSTRUCTIONS. ANCHORS SHALL BE SECURELY FASTENED DIRECTLY INTO MASONRY, CONCRETE OR OTHER STRUCTURAL SUBSTRATE MATERIAL.
5. WHERE WOOD BUCK THICKNESS IS 1-1/2" OR GREATER, BUCK SHALL BE SECURELY FASTENED TO MASONRY, CONCRETE OR OTHER STRUCTURAL SUBSTRATE. WINDOW UNITS MAY BE ANCHORED THROUGH FRAME TO SECURED WOOD BUCK IN ACCORDANCE WITH MANUFACTURER'S PUBLISHED INSTALLATION INSTRUCTIONS.
6. WHERE 1X BUCK IS NOT USED DISSIMILAR MATERIALS MUST BE SEPARATED WITH APPROVED COATING OR MEMBRANE. SELECTION OF COATING OR MEMBRANE IS THE RESPONSIBILITY OF THE ARCHITECT OR ENGINEER OF RECORD.
7. BUCKS SHALL EXTEND BEYOND WINDOW INTERIOR FACE SO THAT FULL FRAME SUPPORT IS PROVIDED.
8. FOR FIN INSTALLATION SHIM AS NEEDED. FOR FRAME INSTALLATION SHIM AS REQUIRED AT EACH ANCHOR LOCATION WITH LOAD BEARING SHIM. SHIM WHERE SPACE OF 1/16" OR GREATER OCCURS. MAXIMUM ALLOWABLE SHIM STACK TO BE 1/4".
9. SHIMS SHALL BE LOCATED, APPLIED AND MADE FROM MATERIALS AND THICKNESS CAPABLE OF SUSTAINING APPLICABLE LOADS.
10. WIND LOAD DURATION FACTOR $C_d=1.6$ WAS USED FOR WOOD ANCHOR CALCULATIONS.
11. FRAME MATERIAL: EXTRUDED RIGID PVC.
12. UNITS MUST BE GLAZED PER ASTM E1300.
13. APPROVED IMPACT PROTECTIVE SYSTEM IS REQUIRED FOR THIS PRODUCT IN WIND BORNE DEBRIS REGIONS.

14. FOR ANCHORING INTO WOOD FRAMING OR 2X BUCK USE #10 WOOD SCREWS WITH SUFFICIENT LENGTH TO ACHIEVE A 1 1/4" MINIMUM EMBEDMENT INTO SUBSTRATE. LOCATE ANCHORS AS SHOWN IN ELEVATIONS AND INSTALLATION DETAILS.
15. FOR ANCHORING INTO MASONRY/CONCRETE USE 1/4" TAPCONS WITH SUFFICIENT LENGTH TO ACHIEVE A 1 1/4" MINIMUM EMBEDMENT INTO SUBSTRATE WITH 2" MINIMUM EDGE DISTANCE. LOCATE ANCHORS AS SHOWN IN ELEVATIONS AND INSTALLATION DETAILS.
16. FOR ANCHORING INTO METAL STRUCTURE USE #10 SMS OR SELF DRILLING SCREWS WITH SUFFICIENT LENGTH TO ACHIEVE 3 THREADS MINIMUM BEYOND STRUCTURE INTERIOR WALL. LOCATE ANCHORS AS SHOWN IN ELEVATIONS AND INSTALLATION DETAILS.
17. ALL FASTENERS TO BE CORROSION RESISTANT.
18. INSTALLATION ANCHORS SHALL BE INSTALLED IN ACCORDANCE WITH ANCHOR MANUFACTURER'S INSTALLATION INSTRUCTIONS AND ANCHORS SHALL NOT BE USED IN SUBSTRATES WITH STRENGTHS LESS THAN THE MINIMUM STRENGTH SPECIFIED BELOW:
 - A. WOOD: MINIMUM SPECIFIC GRAVITY OF $G=0.42$
 - B. CONCRETE: MINIMUM COMPRESSIVE STRENGTH OF 2,000 PSI.
 - C. MASONRY: HOLLOW/FILLED BLOCK PER ASTM C90 WITH $F_m=2,000$ PSI MINIMUM.
 - D. METAL STRUCTURE: STEEL 18GA (.048") $F_y=33$ KSI/ $F_u=52$ KSI OR ALUMINUM 6063-T5 $F_u=30$ KSI .125" THICK MINIMUM

TABLE OF CONTENTS	
SHEET NO.	DESCRIPTION
1	NOTES
2	ELEVATIONS
3 - 4	INSTALLATION DETAILS
5	COMPONENTS

WINDOW MART 5760 ALBERT PIKE PO BOX 570 ROYAL, AR 71968		
SERIES 1147 VINYL DOUBLE HUNG WINDOW NON-IMPACT NOTES		
DRAWN: R.S	DWG NO. 08-03055	REV A
SCALE NTS	DATE 03/29/2017	SHEET 1 OF 5
L. ROBERTO LOMAS P.E. 1432 WOODFORD RD LEWISVILLE, NC 27023 434-688-0609 rllomas@rlomaspe.com		

SIGNED: 09/29/2020



Luis R. Lomas P.E.
TX No.: 101889

REVISIONS			
REV	DESCRIPTION	DATE	APPROVED
A	REVISED PER NEW REQUIREMENTS	09/29/2020	R.L.

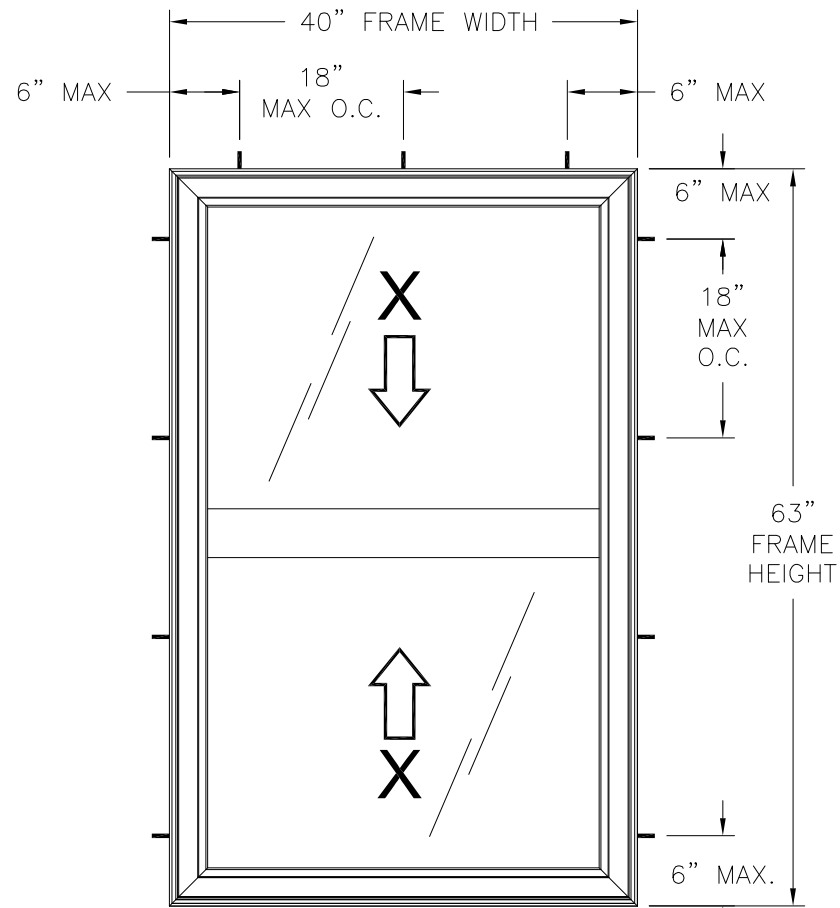

1147 DOUBLE HUNG WINDOW
EXTERIOR VIEW
FRAME INSTALLATION

DESIGN PRESSURE RATING	IMPACT RATING
+40.0/-45.0PSF	NONE

40" X 63" UNIT SHOWN. OTHER SIZES APPROVED AS LONG AS FRAME AREA DOES NOT EXCEED 17.5 FT²

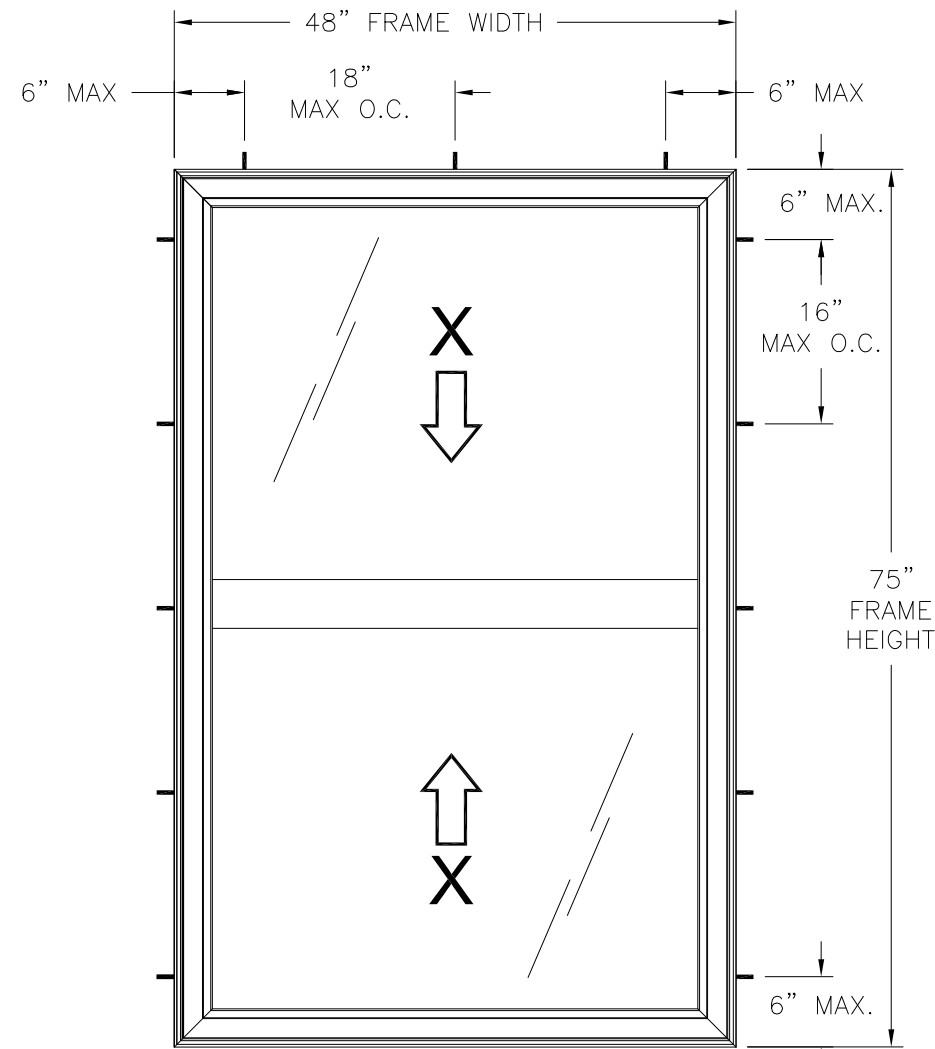

1147 DOUBLE HUNG WINDOW
EXTERIOR VIEW
FRAME INSTALLATION

DESIGN PRESSURE RATING	IMPACT RATING
+25.0/-30.0PSF	NONE

48" X 75" UNIT SHOWN. OTHER SIZES APPROVED AS LONG AS FRAME AREA DOES NOT EXCEED 25.0 FT²

NOTES:

1. 48" x 75" UNIT, SASH SIZE: 44 7/16" x 37 3/16"
2. 48" x 75" UNIT, D.L.O.: 40 15/16" x 33 11/16"
3. 40" x 63" UNIT, SASH SIZE: 35 7/16" x 31 3/16"
4. 40" x 63" UNIT, D.L.O.: 32 15/16" x 27 11/16"

HARDWARE SCHEDULE

A.	(2) METAL CAM LOCK WITH KEEPER, 10 1/2" EACH END OF LOCK RAIL.
B.	(4) PLASTIC TILT LATCH AT EACH END OF TOP AND LOCK RAILS.
C.	(4) CONSTANT FORCE BALANCE WITH TILT LOCKING SHOE, TWO PER JAMB
D.	(4) METAL PIVOT BAR AT EACH END OF BOTTOM AND EXTERIOR MEETING RAILS
E.	(2) PLASTIC NIGHT LATCHES, ONE PER EACH TOP SASH STILE

WINDOW MART

5760 ALBERT PIKE PO BOX 570
ROYAL, AR 71968

SERIES 1147 VINYL DOUBLE HUNG WINDOW
NON-IMPACT
ELEVATIONS

DRAWN: R.S	DWG NO. 08-03055	REV A
SCALE NTS	DATE 03/29/2017	SHEET 2 OF 5
L. ROBERTO LOMAS P.E. 1432 WOODFORD RD LEWISVILLE, NC 27023 434-688-0609 rllomas@lrlomaspe.com		

SIGNED: 09/29/2020



Luis R. Lomas P.E.
TX No.: 101889

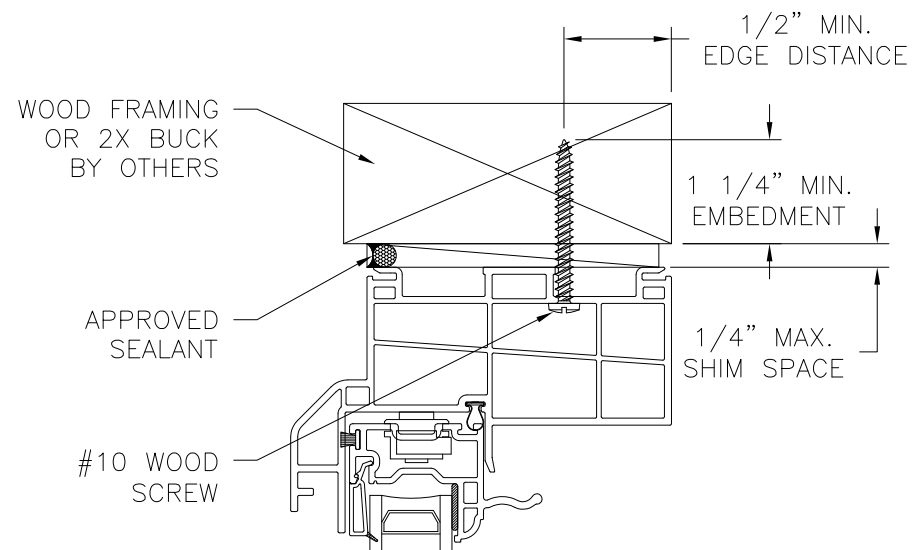

EXTERIOR

INTERIOR

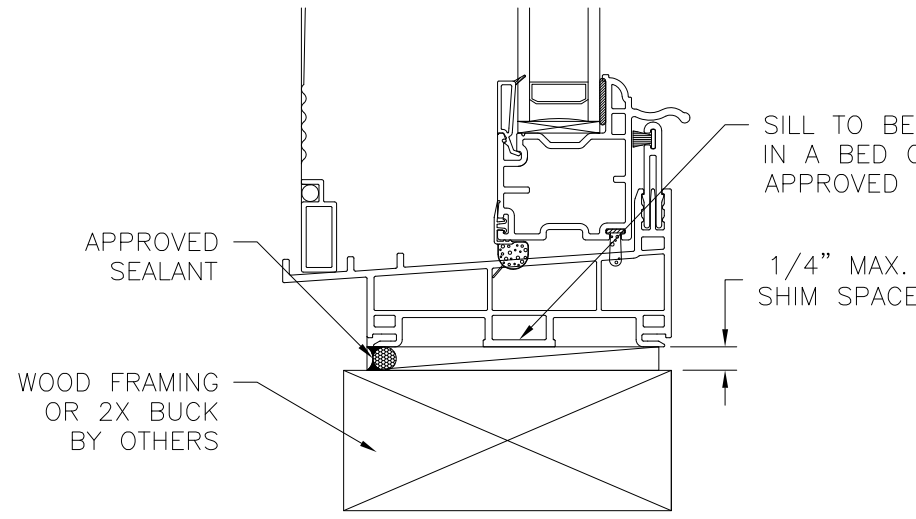

VERTICAL CROSS SECTION
WOOD FRAMING OR 2X BUCK INSTALLATION

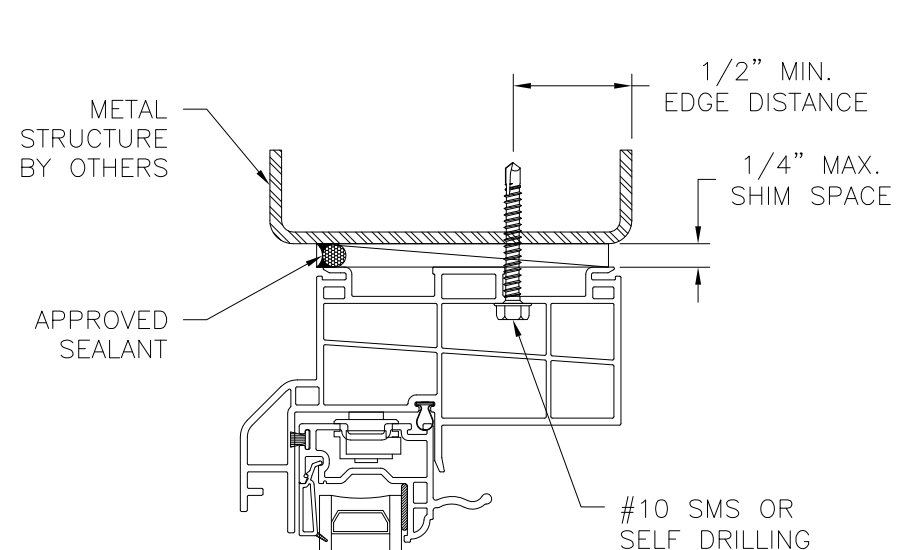

EXTERIOR

INTERIOR

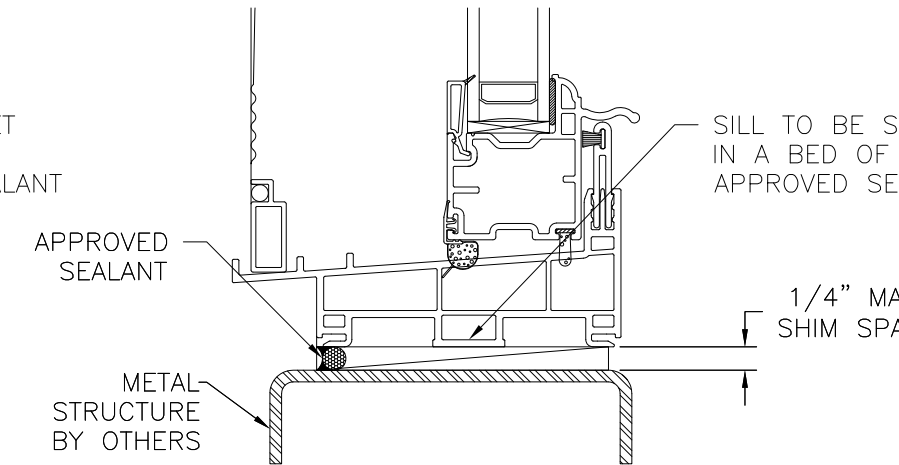

VERTICAL CROSS SECTION
METAL STRUCTURE INSTALLATION

REVISIONS			
REV	DESCRIPTION	DATE	APPROVED
A	REVISED PER NEW REQUIREMENTS	09/29/2020	R.L.

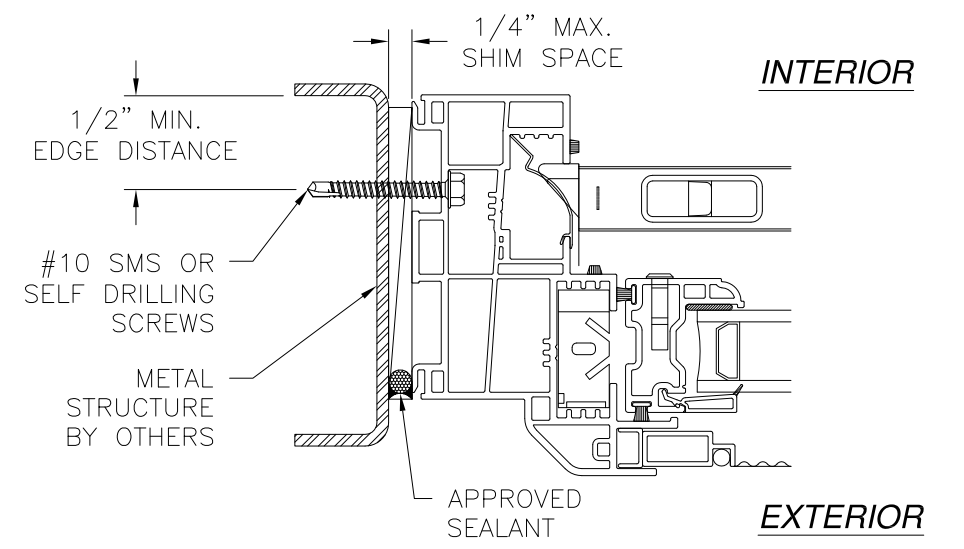

JAMB INSTALLATION DETAIL
METAL STRUCTURE INSTALLATION

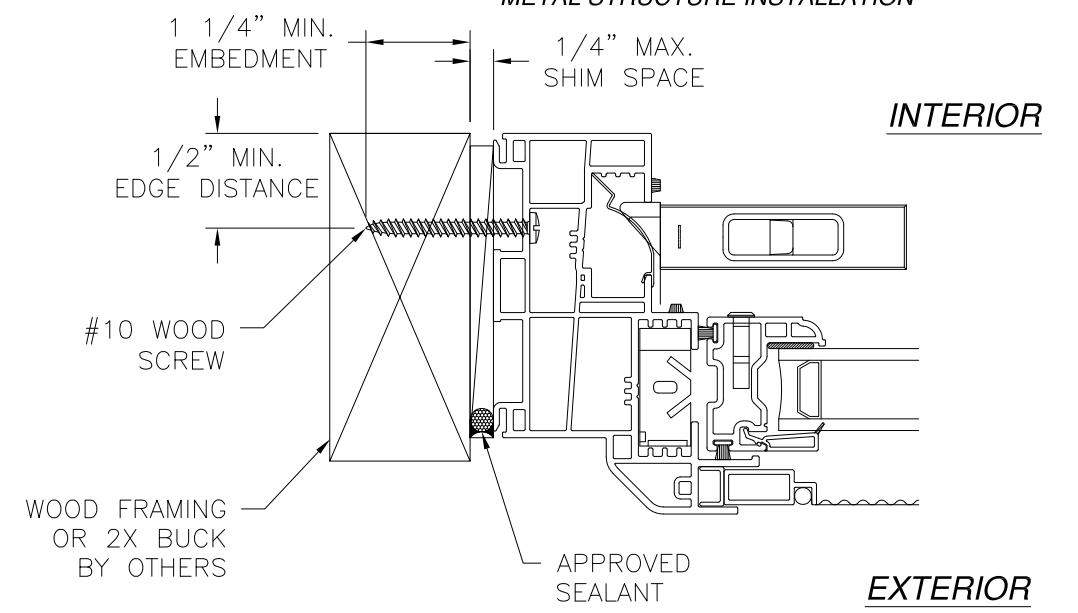

JAMB INSTALLATION DETAIL
WOOD FRAMING OR 2X BUCK INSTALLATION

SIGNED: 09/29/2020

NOTES:
1. INTERIOR AND EXTERIOR FINISHES, BY OTHERS, NOT SHOWN FOR CLARITY.
2. PERIMETER AND JOINT SEALANT BY OTHERS TO BE DESIGNED IN ACCORDANCE WITH ASTM E2112

WINDOW MART
5760 ALBERT PIKE PO BOX 570
ROYAL, AR 71968

SERIES 1147 VINYL DOUBLE HUNG WINDOW
NON-IMPACT
INSTALLATION DETAILS

DRAWN: R.S	DWG NO. 08-03055	REV A
SCALE NTS	DATE 03/29/2017	SHEET 3 OF 5

L. ROBERTO LOMAS P.E.
1432 WOODFORD RD LEWISVILLE, NC 27023
434-688-0609 rllomas@rlomaspe.com



Luis R. Lomas P.E.
TX No.: 101889

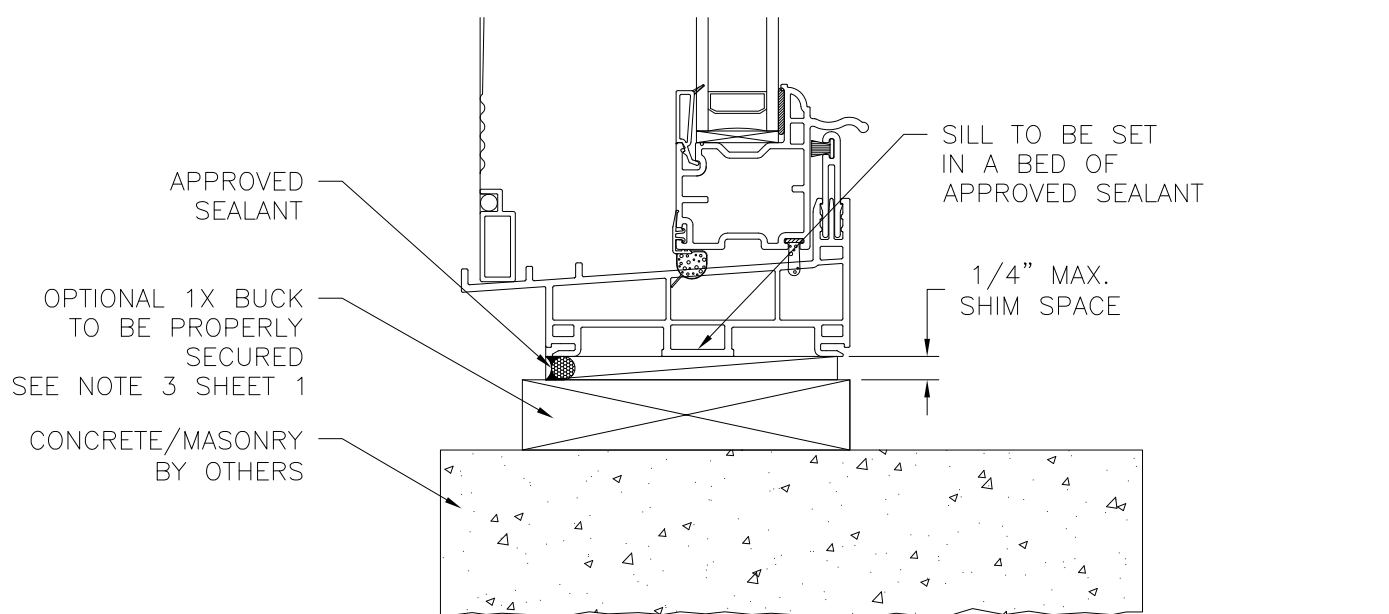
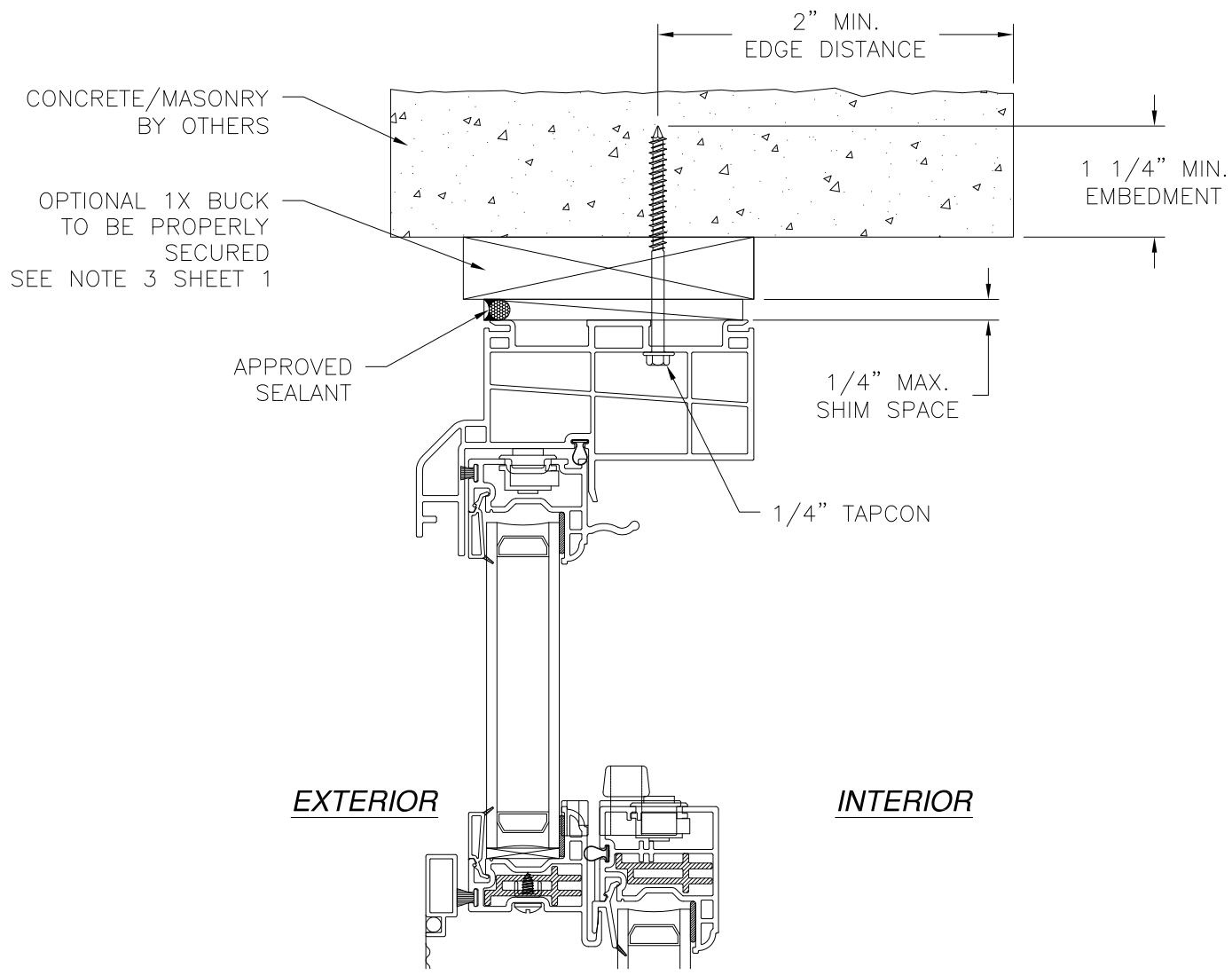

**VERTICAL CROSS SECTION
CONCRETE/MASONRY INSTALLATION**

REVISIONS			
REV	DESCRIPTION	DATE	APPROVED
A	REVISED PER NEW REQUIREMENTS	09/29/2020	R.L.

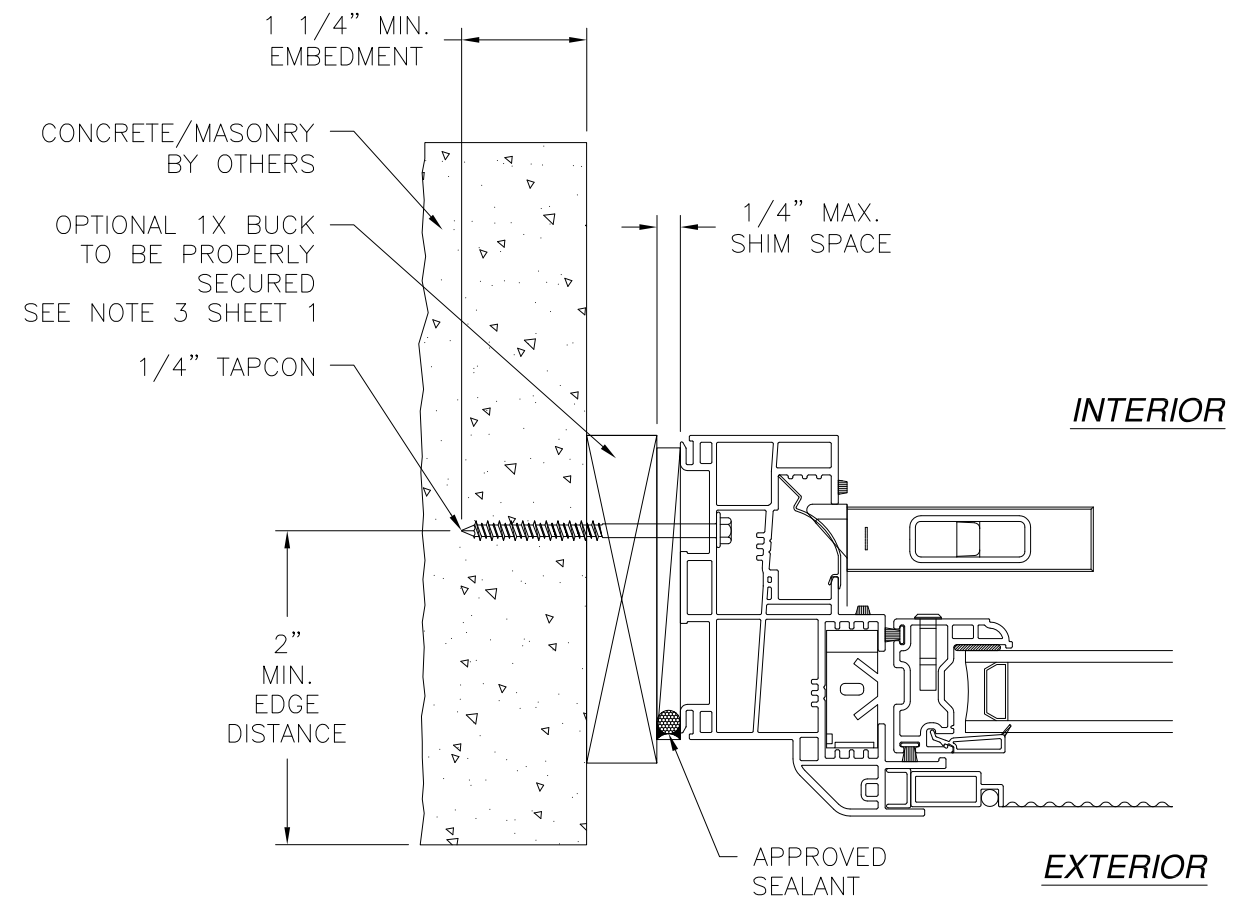

**JAMB INSTALLATION DETAIL
CONCRETE/MASONRY INSTALLATION**

- NOTES:**
1. INTERIOR AND EXTERIOR FINISHES, BY OTHERS, NOT SHOWN FOR CLARITY.
 2. PERIMETER AND JOINT SEALANT BY OTHERS TO BE DESIGNED IN ACCORDANCE WITH ASTM E2112

SIGNED: 09/29/2020

WINDOW MART
5760 ALBERT PIKE PO BOX 570
ROYAL, AR 71968

SERIES 1147 VINYL DOUBLE HUNG WINDOW
NON-IMPACT
INSTALLATION DETAILS

DRAWN: R.S	DWG NO. 08-03055	REV A
SCALE NTS	DATE 03/29/2017	SHEET 4 OF 5

L. ROBERTO LOMAS P.E.
1432 WOODFORD RD LEWISVILLE, NC 27023
434-688-0609 rllomas@rlomaspe.com



Luis R. Lomas P.E.
TX No.: 101889

REVISIONS			
REV	DESCRIPTION	DATE	APPROVED
A	REVISED PER NEW REQUIREMENTS	09/29/2020	R.L.

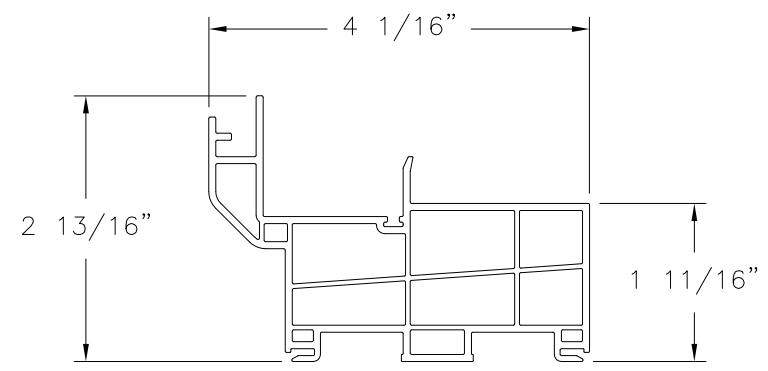

HEAD FRAME (10005085)
EXTRUDED PVC

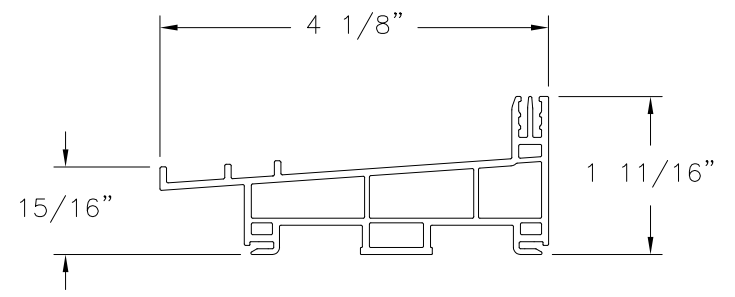

SILL FRAME (10005086)
EXTRUDED PVC

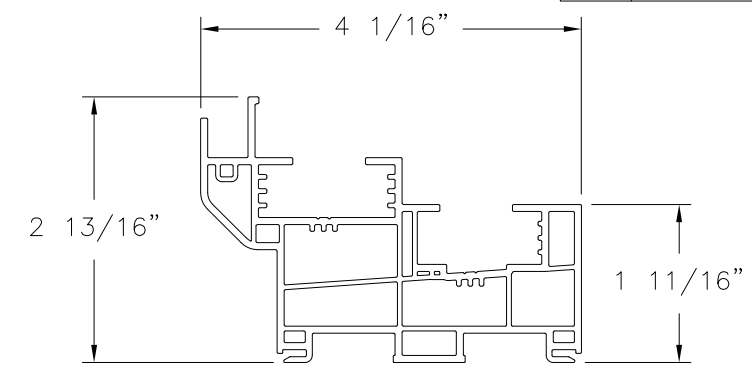

JAMB FRAME (10005083)
EXTRUDED PVC

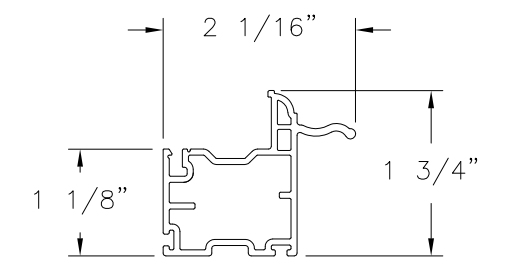

BOTTOM RAIL (10005526)
EXTRUDED PVC

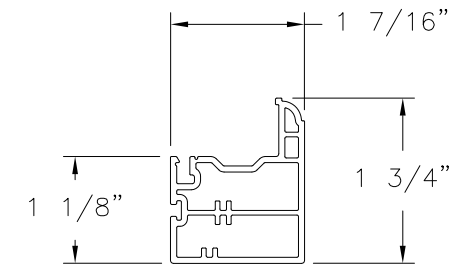

LOCK RAIL (10005521)
EXTRUDED PVC

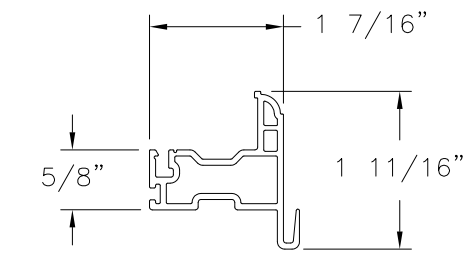

KEEPER RAIL (10005522)
EXTRUDED PVC

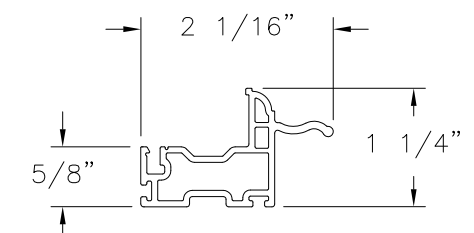

TOP RAIL (10005525)
EXTRUDED PVC

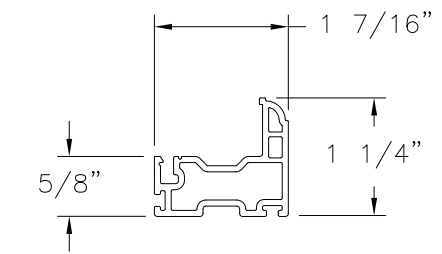

TOP STILE (10005524)
EXTRUDED PVC

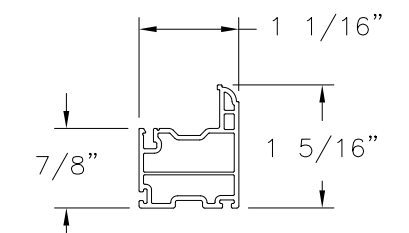

BOTTOM STILE (10005520)
EXTRUDED PVC

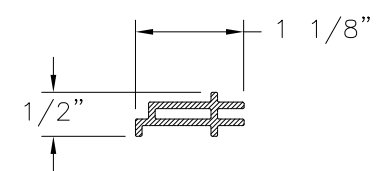

MEETING RAILS REINFORCEMENT
10000660
FIBERGLASS

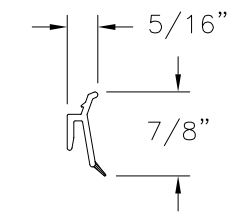

INTERLOCK GLAZING BEAD (10005551)
EXTRUDED PVC

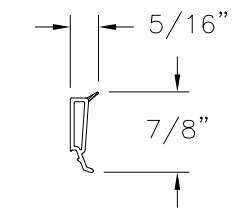

GLAZING BEAD (10005470)
EXTRUDED PVC

WINDOW MART
5760 ALBERT PIKE PO BOX 570
ROYAL, AR 71968

SERIES 1147 VINYL DOUBLE HUNG WINDOW
NON-IMPACT
COMPONENTS

DRAWN: R.S	DWG NO. 08-03055	REV A
SCALE NTS	DATE 03/29/2017	SHEET 5 OF 5

L. ROBERTO LOMAS P.E.
1432 WOODFORD RD LEWISVILLE, NC 27023
434-688-0609 rllomas@lrlomaspe.com

SIGNED: 09/29/2020



Luis R. Lomas P.E.
TX No.: 101889