

WINCORE™

WINDOWS & DOORS

250 Staunton Turnpike, Parkersburg, WV 26104

500 Series Vinyl Single Hung Window "NON-IMPACT"

EVALUATED FOR USE IN THE STATE OF TEXAS

TDI WIN-2158

The Wincore Single Hung Window described herein complies with the 2018 International Residential Code (IRC), Sections R301 & R609 and the 2018 International Building Code (IBC), Sections 1404.13, 1609, 1709.5, 2403 and 2404 subject to the following conditions:

1. Anchors shall be as listed and spaced as shown in the details. Anchor embedment to base material shall be beyond wall dressing or stucco.
2. When used in areas requiring wind-borne debris protection this product is required to be protected with an impact resistant covering that complies with Section R301.2.1.2 of the IRC and Section 1609.1.2 of the IBC.
3. Allowable design pressure requirements must be equal to or less than the design pressure rating shown in the design pressure chart, sheet 1 of this drawing.
4. Conditions not covered by this drawing are subject to further engineering analysis.

TABLE OF CONTENTS

SHEET#	DESCRIPTION
1	Typical elevations, design pressures & general notes
2	Vertical & horizontal cross sections & frame anchoring
3	Bill of materials, components & glazing details

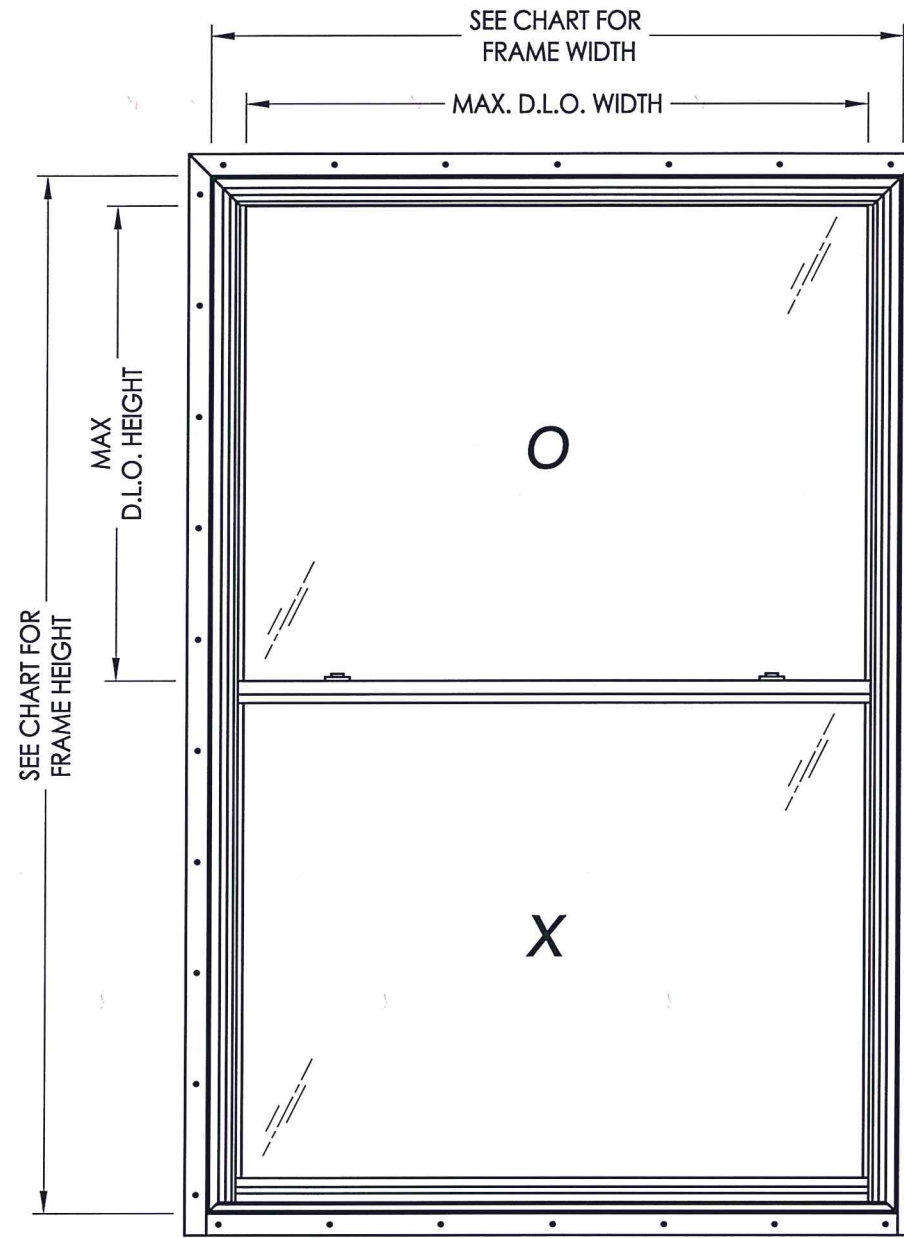

MAX. FRAME DIMENSION	MAX. FIXED D.L.O. DIMENSION	GLASS TYPE	DESIGN PRESSURE (PSF)		BOTTOM RAIL REINFORCEMENT REQUIRED
			POSITIVE	NEGATIVE	
36.0" X 80.0"	31.5" X 36.75"	G1	+50.0	-50.0	YES
48.0" X 72.0"	43.5" X 32.75"	G2	+50.0	-50.0	YES
48.0" X 96.0"	43.5" X 55"	G2	+40.0	-40.0	NO
40.0" X 84.0"	35.5" X 38.5"	G2	+35.0	-35.0	YES
52.0" X 77.0"	47.5" X 35.25"	G2	+35.0	-35.0	YES
36.0" X 96.0"	31.5" X 44.75"	G2	+30.0	-30.0	NO
48.0" X 96.0"	43.5" X 44.75"	G3	+30.0	-30.0	NO

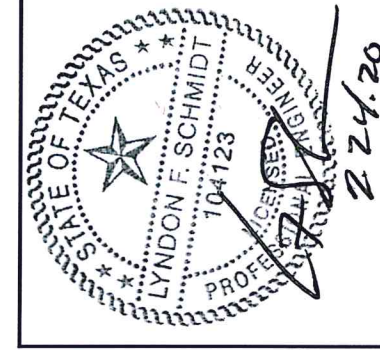

Documents Prepared By: Lyndon F. Schmidt, P.E.
TEXAS P.E. #104123

RW BUILDING CONSULTANTS, INC.
P.O. Box 230 Valrico FL 33595
Phone No.: 813.659.9197
TEXAS BOARD OF PROFESSIONAL ENGINEERS
CERTIFICATE OF REGISTRATION # F-11852

PRODUCT: 500 Series Vinyl Single Hung Window
PART OR ASSEMBLY: TYPICAL ELEVATION, DESIGN PRESSURES & GENERAL NOTES

NO.	DATE	REVISIONS
1	1/21/20	UPDATE TO 2018 IBC/IRC
		LFS BY

DATE: 1/06/16

SCALE: N.T.S.

DWG. BY: JK

CHK. BY: LFS

DRAWING NO.:

TX-4592

SHEET 1 OF 3

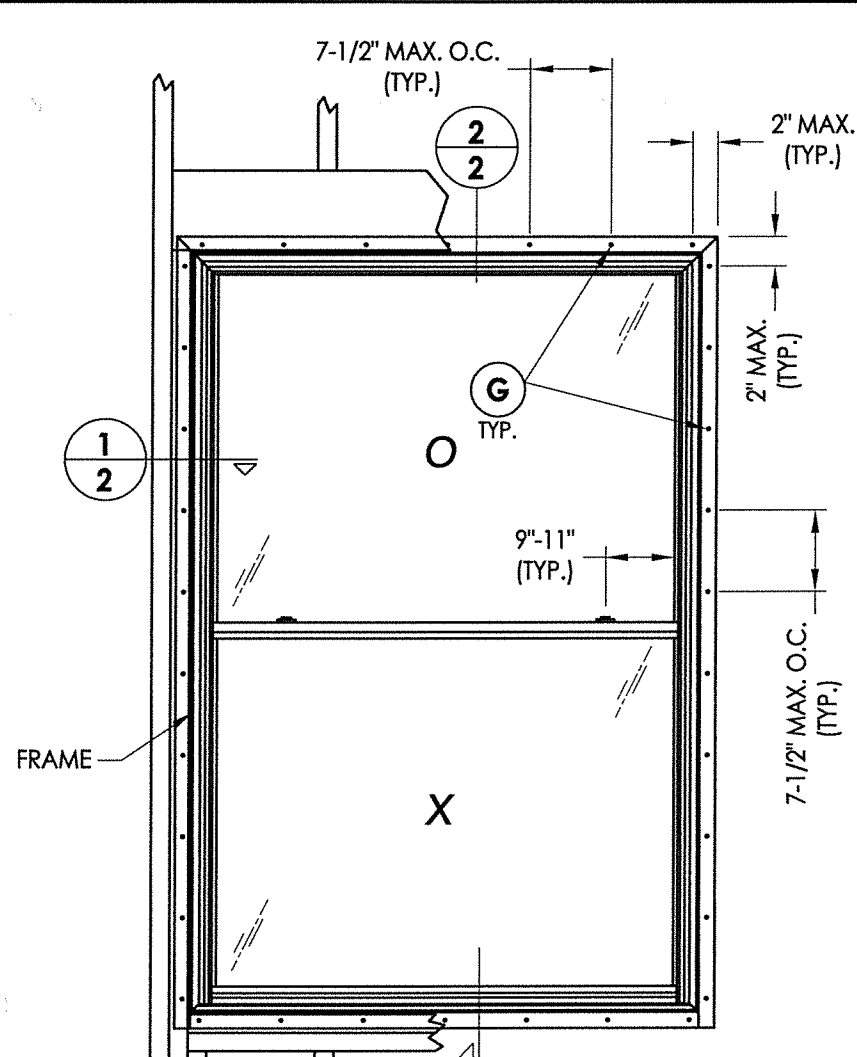

2x framing to be designed by the engineer or architect of record.

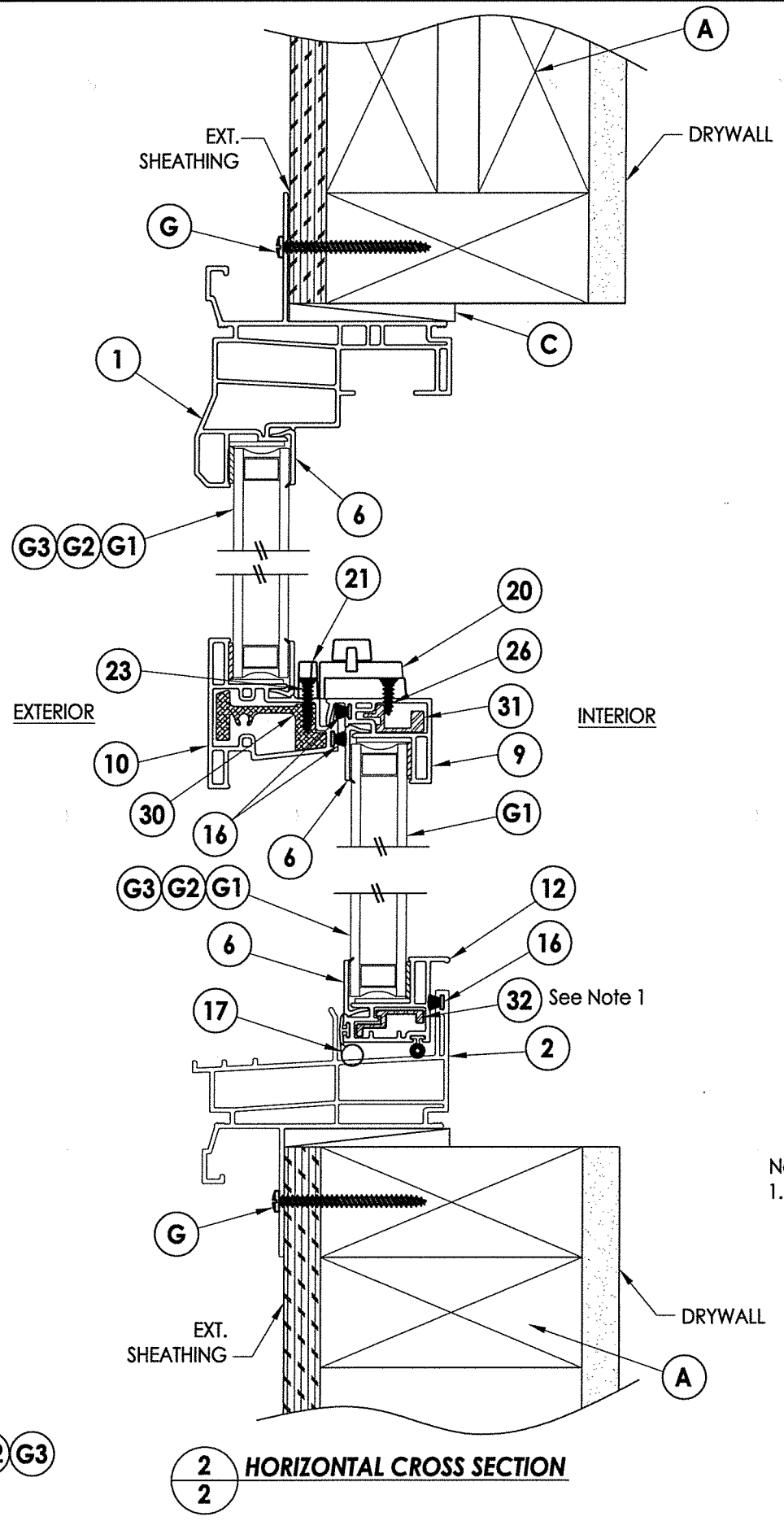
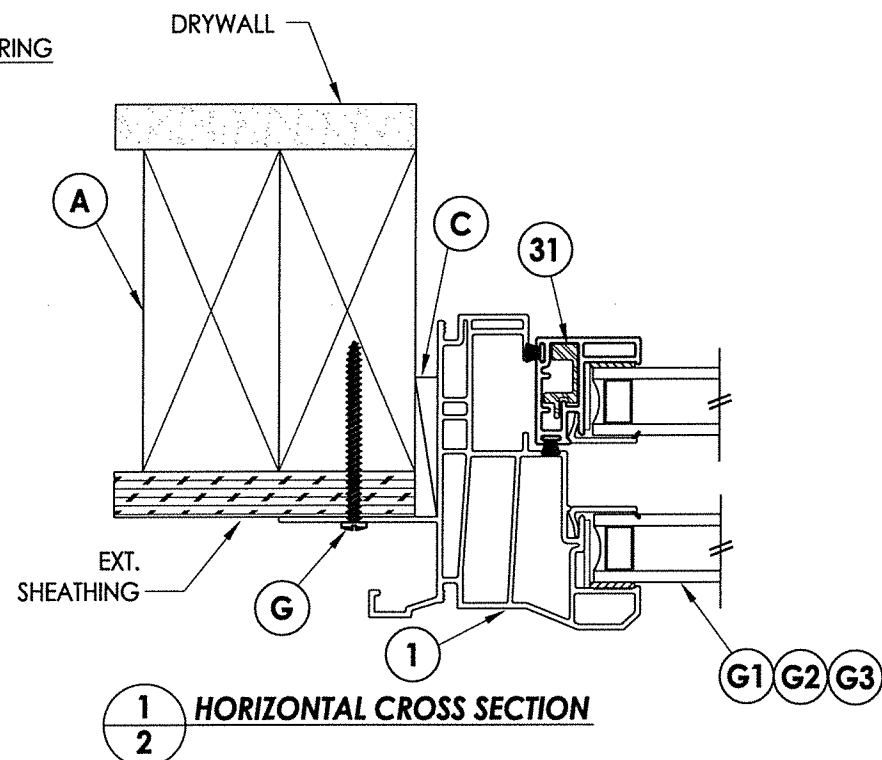

Note:
1. See Sheet 1 for bottom rail reinforcement requirements.

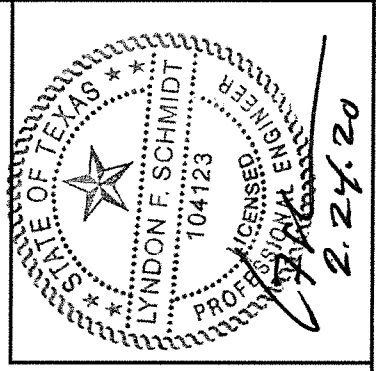

Documents Prepared By: Lyndon F. Schmidt, P.E.
TEXAS P.E. #104123

RW BUILDING CONSULTANTS, INC.
P.O. Box 230 Valrico FL 33595
Phone No.: 813.659.9197

TEXAS BOARD OF PROFESSIONAL ENGINEERS
CERTIFICATE OF REGISTRATION # F-11852

PRODUCT: 500 Series Vinyl Single Hung Window

PART OR ASSEMBLY: VERTICAL & HORIZONTAL CROSS SECTIONS & FRAME ANCHORING

REVISIONS	
NO.	DATE
1	1/21/20
	UPDATE TO 2018 IBC/IRC
	LFS BY

DATE: 1/06/16
SCALE: N.T.S.
DWG. BY: JK
CHK. BY: LFS
DRAWING NO.: TX-4592
SHEET 2 OF 3

R:\Clients\Wincore PERMANENT\B - (2018) Texas Dept of Ins\WIN 2158 - Sgl Hung 400\C - Drawings\2018 IBC UPDATE\TX-4592.dwg, 3.1

BILL OF MATERIALS		
ITEM #	DESCRIPTION	MATERIAL
A	2X FRAMING SG >= 0.42	WOOD
C	1/4" MAX. SHIM SPACE	-
G	#8 X 2-1/2" PFH WOOD SCREW (1-3/4" MIN. EMBEDMENT)	STEEL
1	FRAME HEAD AND JAMB*	PVC
2	FRAME SILL*	PVC
5	SASH STILE*	PVC
6	GLAZING BEAD*	PVC
9	LOCK RAIL LOWER SASH*	PVC
10	STAYBAR*	PVC
12	BOTTOM RAIL LOWER SASH*	PVC
16	WEATHERSTRIP ULTRA FAB .270 PILE - 270 -1875B	-
17	WEATHERSTRIP SILLBULB (AMESBURY 32690)	-
20	LOCK 8513 / 8845 LAWRENCE	PVC
21	KEEPER 2700 - 214 LAWRENCE	PVC
23	#6 X 3/4" PFH (VINYL LOCK SCREWS)	STEEL
24	SASH TILT LATCH - ASHLAND	PVC
26	#6 X 1/2" PFH (VINYL LOCK SCREWS)	STEEL
30	REINFORCEMENT (FIXED MEETING RAIL) ALUM. 6063-T6	ALUM
31	REINFORCEMENT (MEETING RAIL/SASH STILES) ALUM. 6063-T6	ALUM
32	REINFORCEMENT (BTM. RAIL) ALUM. 6063-T6	ALUM

* THE APPROVED WHITE RIGID PVC EXTERIOR EXTRUSIONS FOR WINDOWS ARE TO BE PRODUCED BY EXTRUDERS LICENSEES IN "AAMA CERTIFICATION PROGRAMS FOR RIGID PVC EXTRUSIONS".

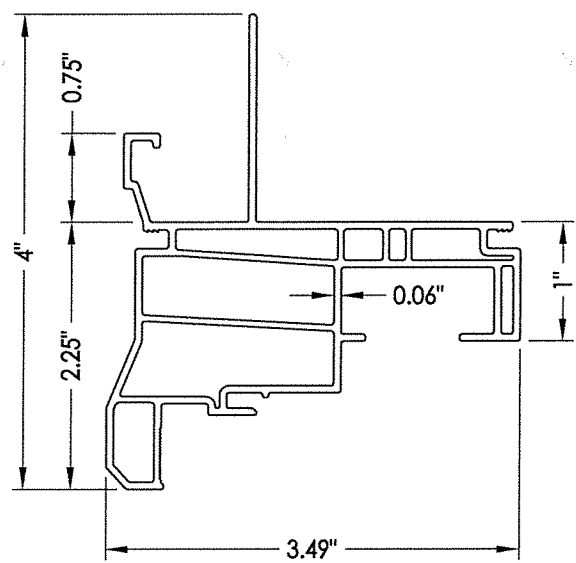

1 FRAME HEAD & JAMB

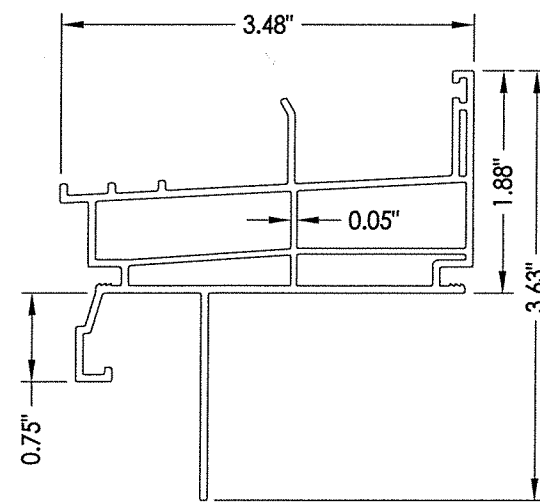

2 FRAME SILL

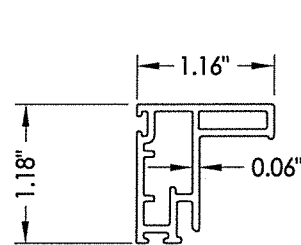

5 SASH STILE

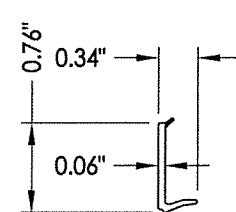

6 GLAZING BEAD

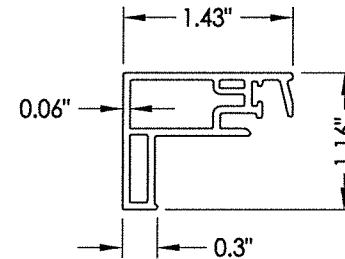

9 LOCK RAIL Lower Sash

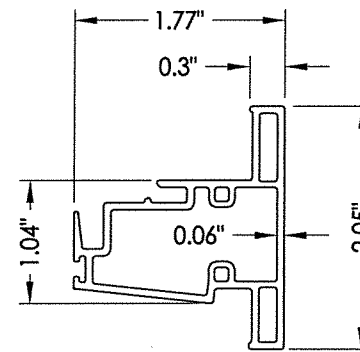

10 STAYBAR

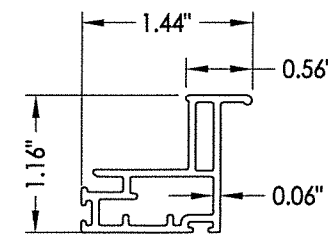

12 BOTTOM RAIL Lower Sash

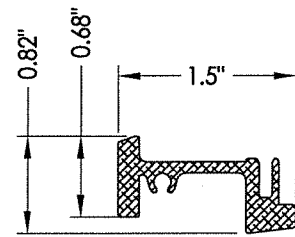

30 REINFORCEMENT FIXED MEETING RAIL

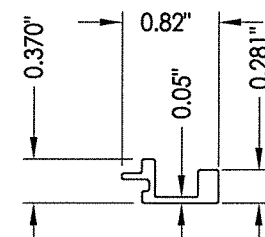

31 REINFORCEMENT MEETING RAIL/SASH STILE

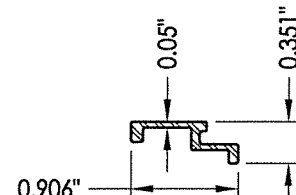

32 REINFORCEMENT BTM. RAIL

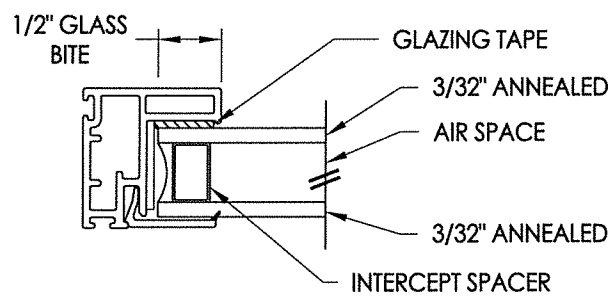

G1 GLAZING DETAIL

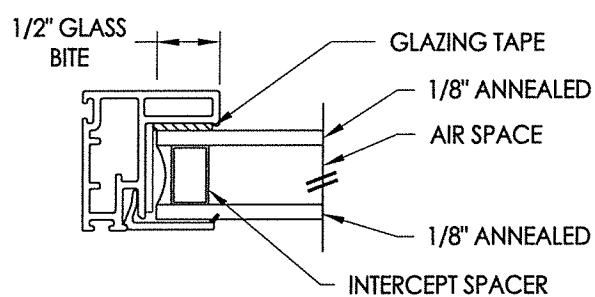

G2 GLAZING DETAIL

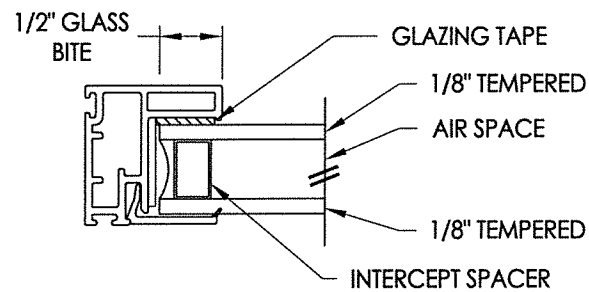

G3 GLAZING DETAIL

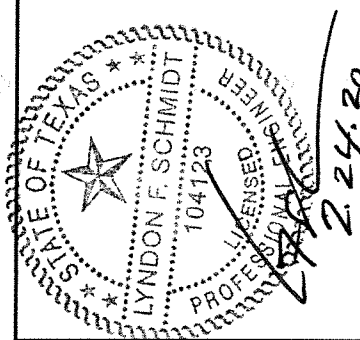

Documents Prepared By: Lyndon F. Schmidt, P.E.
TEXAS P.E. #104123

RW BUILDING CONSULTANTS, INC.
P.O. Box 230 Valrico FL 33595
Phone No.: 813.659.9197

TEXAS BOARD OF PROFESSIONAL ENGINEERS
CERTIFICATE OF REGISTRATION # F-11852

PRODUCT:	500 Series Vinyl Single Hung Window
PART OR ASSEMBLY:	BILL OF MATERIALS & GLAZING DETAILS

NO.	DATE	REVISIONS
1	1/21/20	UPDATE TO 2018 IBC/IRC
		LFS
		BY

DATE:	1/06/16
SCALE:	N.T.S.
DWG. BY:	JK
CHK. BY:	LFS
DRAWING NO.:	TX-4592
SHEET	3 OF 3

© 2016 R.W. BUILDING CONSULTANTS INC.