



MODEL 1860 FIXED PICTURE WINDOW,
NON-IMPACT RESISTANT,
EQUAL-LEG, INTEGRAL FIN AND FIN/FLANGE FRAMES

DP RATING SEE TABLES A-E	NOT RATED FOR IMPACT RESISTANCE
-----------------------------	---------------------------------------



A. LYNN MILLER, P.E., P.E.# 106954

1) THIS PRODUCT HAS BEEN DESIGNED & TESTED TO COMPLY WITH THE REQUIREMENTS OF THE 2018 INTERNATIONAL RESIDENTIAL CODE (IRC), AND THE 2018 INTERNATIONAL BUILDING CODE (IBC).

2) SHUTTERS ARE REQUIRED WHEN USED IN WIND-BORNE DEBRIS REGIONS.

3) MASONRY ANCHORS MAY BE USED INTO WOOD. ALL WOOD BUCKS LESS THAN 1-1/2" THICK ARE TO BE CONSIDERED 1X INSTALLATIONS. 1X WOOD BUCKS ARE OPTIONAL IF UNIT IS INSTALLED DIRECTLY TO SUBSTRATE. WOOD BUCKS DEPICTED AS 2X ARE 1-1/2" THICK OR GREATER.

4) ANCHOR EMBEDMENT TO BASE MATERIAL SHALL BE BEYOND WALL DRESSING OR STUCCO. USE ANCHORS OF SUFFICIENT LENGTH.

5) MAX. 1/4" SHIMS ARE REQUIRED AT EACH ANCHOR LOCATION WHERE THE PRODUCT IS NOT FLUSH TO THE SUBSTRATE. USE SHIMS CAPABLE OF TRANSFERRING APPLIED LOADS.

6) THE ANCHORAGE METHODS SHOWN HAVE BEEN DESIGNED TO RESIST THE WIND LOADS CORRESPONDING TO THE REQUIRED DESIGN PRESSURE. THE 33-1/3% STRESS INCREASE HAS NOT BEEN USED IN THE DESIGN OF THIS PRODUCT. THE 1.6 LOAD DURATION FACTOR WAS USED FOR THE EVALUATION OF ANCHORS INTO WOOD. ANCHORS THAT COME INTO CONTACT WITH OTHER DISSIMILAR MATERIALS SHALL MEET THE REQUIREMENTS OF THE INTERNATIONAL BUILD CODE FOR CORROSION RESISTANCE.

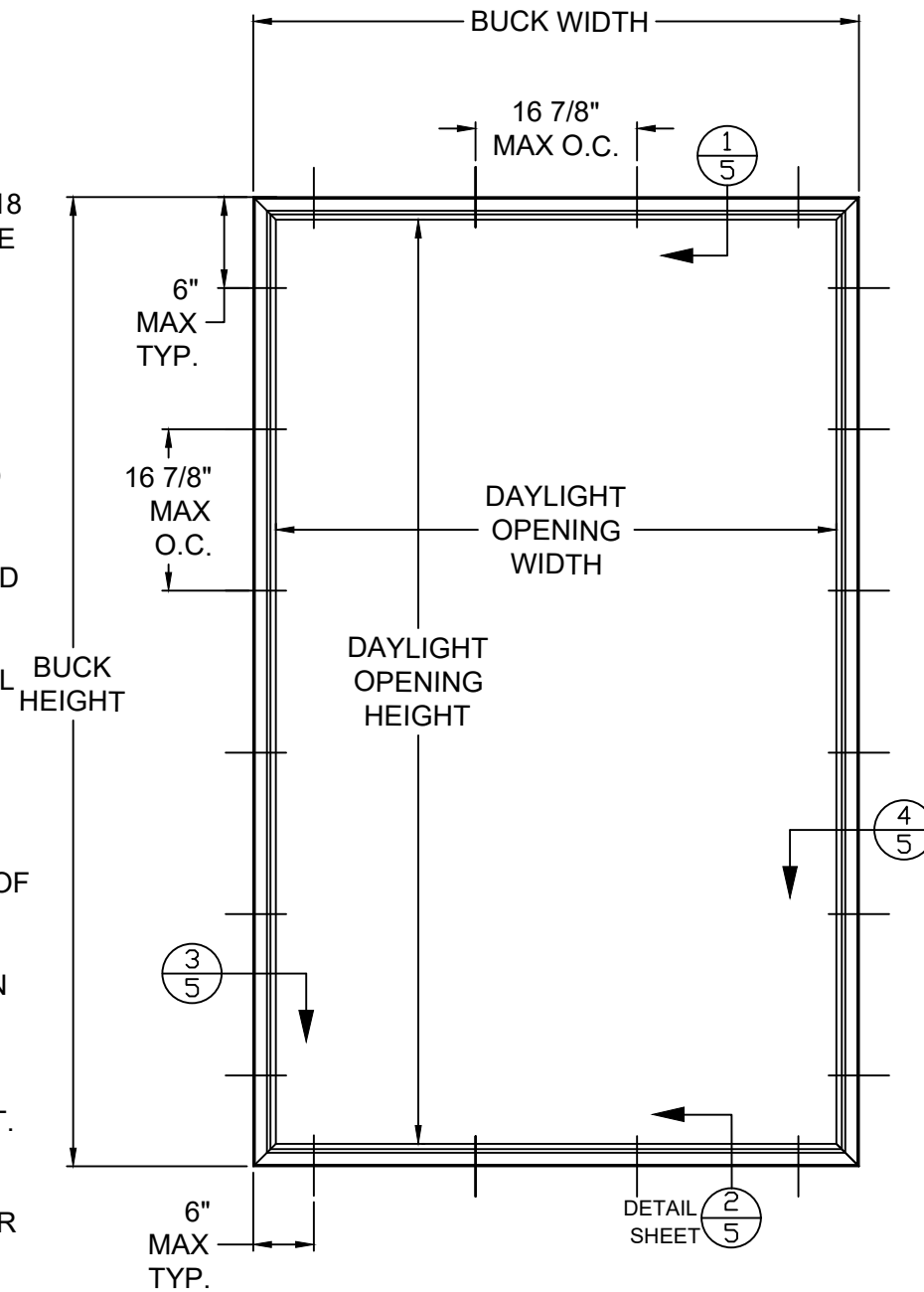

TYP. ANCHOR LOCATIONS
(EQUAL-LEG FRAME)
SEE TABLES A-E FOR SIZES

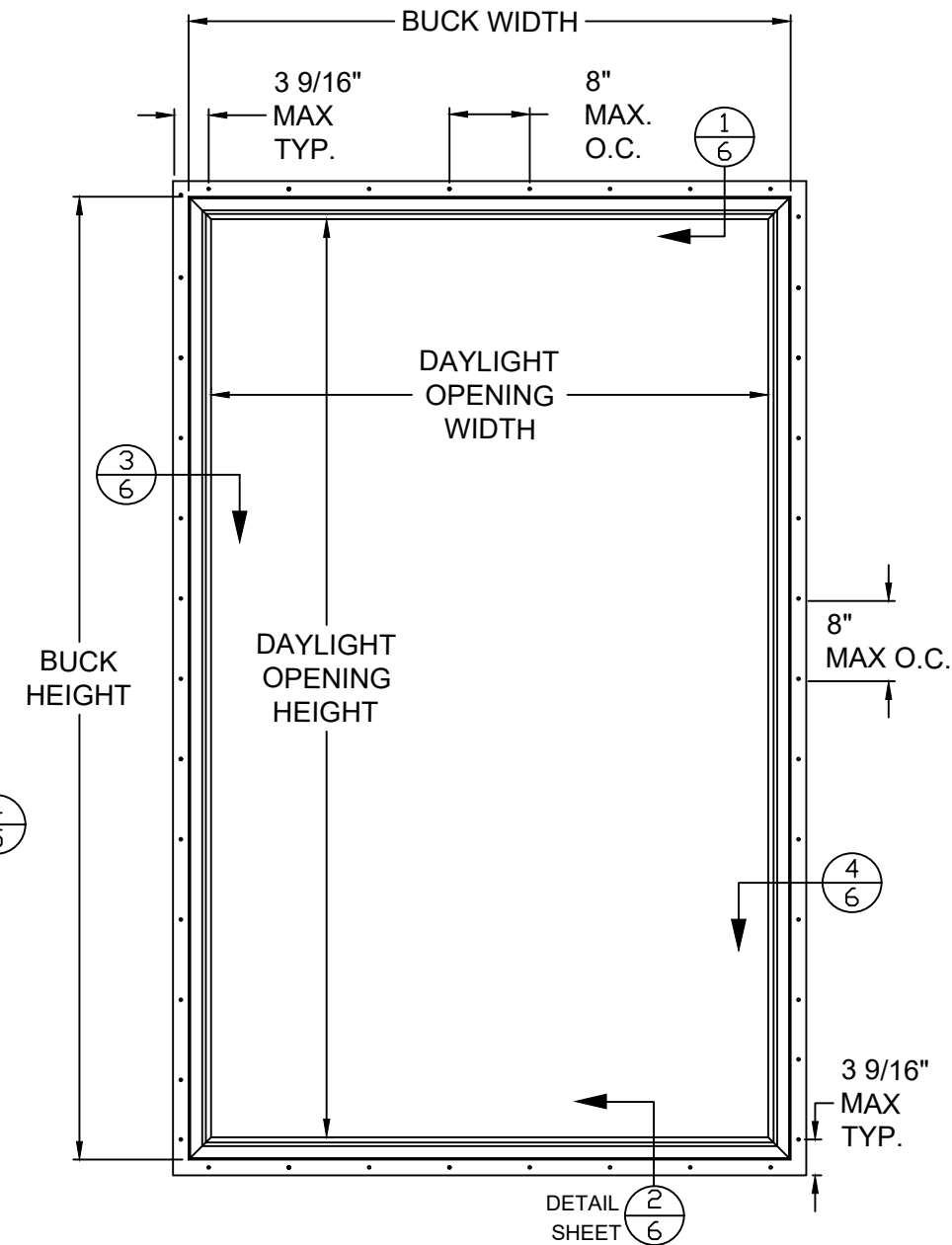

TYP. ANCHOR LOCATIONS
(INTEGRAL FIN AND FIN/FLANGE FRAME)
SEE TABLES A-E FOR SIZES

TABLE 1: DESIGN PRESSURES

Buck Width	Buck Height	Design Pressure		Certification Number
		(+) psf	(-) psf	
60"	96"	50.0	50.0	NI015673

FOR SIZES NOT SHOWN, ROUND UP TO THE NEXT AVAILABLE WIDTH OR HEIGHT DIMENSION.

DAYLIGHT OPENING WIDTH = BUCK WIDTH - 4 7/16"
DAYLIGHT OPENING HEIGHT = BUCK HEIGHT - 4 7/16"

PREPARED BY: A. LYNN MILLER, P.E. REGISTRATION #F-23136
1070 TECHNOLOGY DR
N. VENICE, FL 34275
(941)-480-1600

COPYRIGHT © 2022
NEWSOUTH WINDOW SOLUTIONS
LIMITED LICENSE TO MAKE
COPIES FOR PERMITTING

1860 SERIES PICTURE WINDOW	BY:	
GENERAL NOTES & ANCHOR ELEVATION	REVISION:	
NEWSOUTH WINDOW SOLUTIONS 10741 CROSSROADS COMMERCE BLVD. TAMPA, FL 33610	DATE:	
	#:	
	DATE:	9/01/22
	SCALE:	NTS
	BY:	S. Berkowitz
	DRAWING #:	TDI-PW1860
	SHEET:	1 OF 7

TABLE A:

		Window Design Pressure (psf)																	
		Glass Type 1: 7/8" IG (1/8" A - AIRSPACE - 1/8" A)																	
		Long Side (in.)																	
		51.5	54	56	58	60	62	64	66	68	70	72	74	76	78	80	82	84	86
Short Side (in.)	18	+/-50	+/-50	+/-50	+/-50	+/-50	+/-50	+/-50	+/-50	+/-50	+/-50	+/-50	+/-50	+/-50	+/-50	+/-50	+/-50	+/-50	+/-50
	20	+/-50	+/-50	+/-50	+/-50	+/-50	+/-50	+/-50	+/-50	+/-50	+/-50	+/-50	+/-50	+/-50	+/-50	+/-50	+/-50	+/-50	+/-50
	22	+/-50	+/-50	+/-50	+/-50	+/-50	+/-50	+/-50	+/-50	+/-50	+/-50	+/-50	+/-50	+/-50	+/-50	+/-50	+/-50	+/-50	+/-50
	24	+/-50	+/-50	+/-50	+/-50	+/-50	+/-50	+/-50	+/-50	+/-50	+/-50	+/-50	+/-50	+/-50	+/-50	+/-50	+/-50	+/-50	+/-50
	26	+/-50	+/-50	+/-50	+/-50	+/-50	+/-50	+/-50	+/-50	+/-50	+/-50								
	28	+/-50	+/-50	+/-50	+/-50	+/-50	+/-50	+/-50	+/-50	+/-50	+/-50								
	30	+/-50	+/-50	+/-50	+/-50	+/-50	+/-50	+/-50	+/-50	+/-50	+/-50								
	32	+/-50	+/-50	+/-50	+/-50	+/-50	+/-50	+/-50	+/-50	+/-50	+/-50								
	34	+/-50	+/-50	+/-50	+/-50	+/-50	+/-50	+/-50	+/-50	+/-50	+/-50								
	36	+/-50	+/-50	+/-50	+/-50	+/-50	+/-50	+/-50	+/-50	+/-50	+/-50								
	38	+/-50	+/-50	+/-50	+/-50	+/-50	+/-50	+/-50	+/-50	+/-50	+/-50								
	40	+/-50	+/-50	+/-50	+/-50	+/-50	+/-50	+/-50	+/-50	+/-50									
	42	+/-50	+/-50	+/-50	+/-50	+/-50	+/-50	+/-50											
	44	+/-50	+/-50	+/-50	+/-50	+/-50													
	46	+/-50	+/-50	+/-50															
	48	+/-50	+/-50																
51.5	+/-50																		

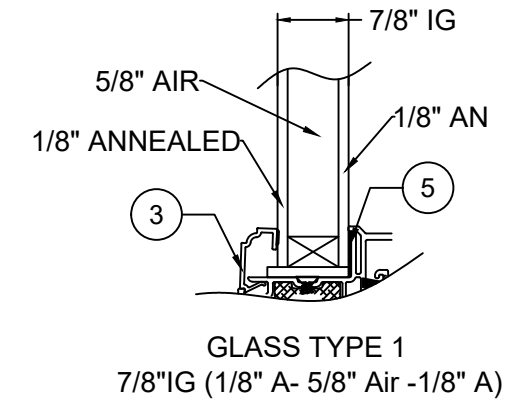
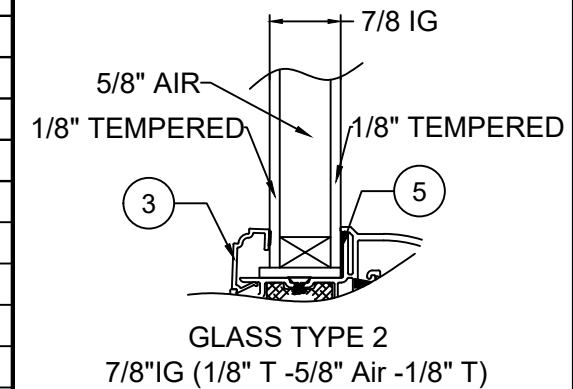

TABLE B:

		Window Design Pressure (psf)																	
		Glass Type 2: 7/8" IG (1/8" T - AIRSPACE - 1/8" T)																	
		Long Side (in.)																	
		60	64	66	68	70	72	74	76	78	80	82	84	86	88	90	92	94	96
Short Side (in.)	24	+/-50	+/-50	+/-50	+/-50	+/-50	+/-50	+/-50	+/-50	+/-50	+/-50	+/-50	+/-50	+/-50	+/-50	+/-50	+/-50	+/-50	+/-50
	26	+/-50	+/-50	+/-50	+/-50	+/-50	+/-50	+/-50	+/-50	+/-50	+/-50	+/-50	+/-50	+/-50	+/-50	+/-50	+/-50	+/-50	+/-50
	28	+/-50	+/-50	+/-50	+/-50	+/-50	+/-50	+/-50	+/-50	+/-50	+/-50	+/-50	+/-50	+/-50	+/-50	+/-50	+/-50	+/-50	+/-50
	30	+/-50	+/-50	+/-50	+/-50	+/-50	+/-50	+/-50	+/-50	+/-50	+/-50	+/-50	+/-50	+/-50	+/-50	+/-50	+/-50	+/-50	+/-50
	32	+/-50	+/-50	+/-50	+/-50	+/-50	+/-50	+/-50	+/-50	+/-50	+/-50	+/-50	+/-50	+/-50	+/-50	+/-50	+/-50	+/-50	+/-50
	34	+/-50	+/-50	+/-50	+/-50	+/-50	+/-50	+/-50	+/-50	+/-50	+/-50	+/-50	+/-50	+/-50	+/-50	+/-50	+/-50	+/-50	+/-50
	36	+/-50	+/-50	+/-50	+/-50	+/-50	+/-50	+/-50	+/-50	+/-50	+/-50	+/-50	+/-50	+/-50	+/-50	+/-50	+/-50	+/-50	+/-50
	38	+/-50	+/-50	+/-50	+/-50	+/-50	+/-50	+/-50	+/-50	+/-50	+/-50	+/-50	+/-50	+/-50	+/-50	+/-50	+/-50	+/-50	+/-50
	40	+/-50	+/-50	+/-50	+/-50	+/-50	+/-50	+/-50	+/-50	+/-50	+/-50	+/-50	+/-50	+/-50	+/-50	+/-50	+/-50	+/-50	+/-50
	42	+/-50	+/-50	+/-50	+/-50	+/-50	+/-50	+/-50	+/-50	+/-50	+/-50	+/-50	+/-50	+/-50	+/-50	+/-50	+/-50		
	44	+/-50	+/-50	+/-50	+/-50	+/-50	+/-50	+/-50	+/-50	+/-50	+/-50	+/-50	+/-50	+/-50	+/-50				
	46	+/-50	+/-50	+/-50	+/-50	+/-50	+/-50	+/-50	+/-50	+/-50	+/-50	+/-50							
	48	+/-50	+/-50	+/-50	+/-50	+/-50	+/-50	+/-50	+/-50	+/-50									
	50	+/-50	+/-50	+/-50	+/-50	+/-50	+/-50												
	52	+/-50	+/-50	+/-50	+/-50	+/-50													
	54	+/-50	+/-50	+/-50	+/-50														
56	+/-50	+/-50	+/-50																
58	+/-50	+/-50																	
60	+/-50																		



PREPARED BY: A. LYNN MILLER, P.E. REGISTRATION #F-23136
1070 TECHNOLOGY DR
N. VENICE, FL 34275
(941)-480-1600

1860 SERIES PICTURE WINDOW	DP AND GLASS TYPES	NEWSOUTH WINDOW SOLUTIONS 10741 CROSSROADS COMMERCE BLVD. TAMPA, FL 33610
BY:		
REVISION:		
DATE:		
#:		
DATE:	9/01/22	
SCALE:	NTS	
BY:	S. Berkowitz	
DRAWING #:	TDI-PW1860	
SHEET:	2 OF 7	

NOTE: 1) FOR SIZES NOT SHOWN, ROUND UP TO THE NEXT AVAILABLE WIDTH OR HEIGHT DIMENSION.

TABLE C:

Window Design Pressure (psf)												
Glass Type 3: 7/8" IG (3/16" A - AIRSPACE - 3/16" A)												
		Long Side (in.)										
		70	72	74	76	78	80	82	84	86	88	90
Short Side (in.)	42	+/-50	+/-50	+/-50	+/-50	+/-50	+/-50	+/-50	+/-50	+/-50	+/-50	+/-50
	44	+/-50	+/-50	+/-50	+/-50	+/-50	+/-50	+/-50	+/-50	+/-50	+/-50	+/-50
	46	+/-50	+/-50	+/-50	+/-50	+/-50	+/-50	+/-50	+/-50	+/-50	+/-50	+/-50
	48	+/-50	+/-50	+/-50	+/-50	+/-50	+/-50	+/-50	+/-50	+/-50	+/-50	+/-50
	50	+/-50	+/-50	+/-50	+/-50	+/-50	+/-50	+/-50	+/-50	+/-50	+/-50	+/-50
	52	+/-50	+/-50	+/-50	+/-50	+/-50	+/-50	+/-50	+/-50	+/-50	+/-50	+/-50
	54	+/-50	+/-50	+/-50	+/-50	+/-50	+/-50	+/-50	+/-50	+/-50	+/-50	
	56	+/-50	+/-50	+/-50	+/-50	+/-50	+/-50	+/-50	+/-50	+/-50	+/-50	
	58	+/-50	+/-50	+/-50	+/-50	+/-50	+/-50	+/-50	+/-50			
60	+/-50	+/-50	+/-50	+/-50	+/-50	+/-50	+/-50					

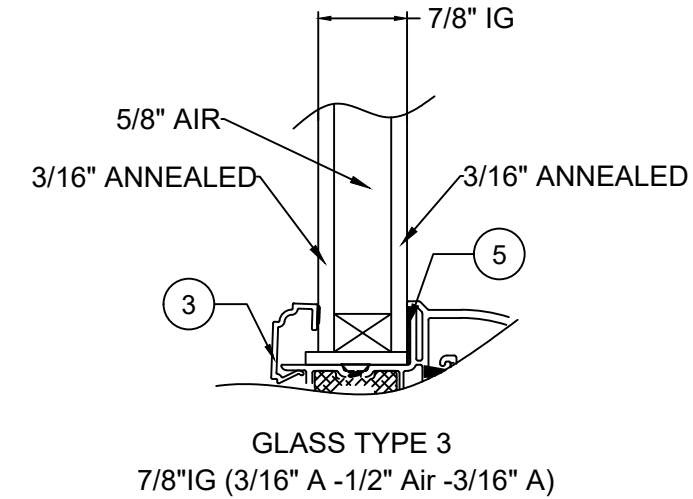
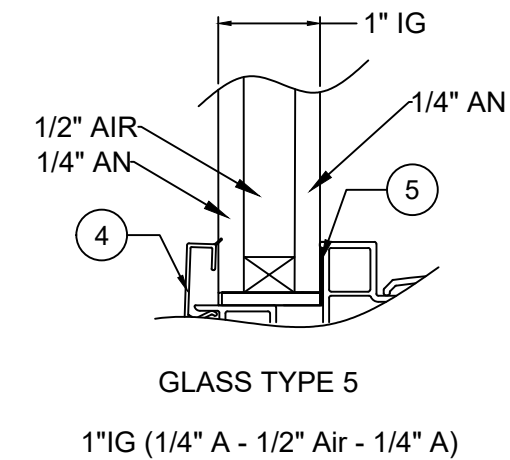

TABLE D:

Window Design Pressure (psf)												
Glass Type 5: 1" IG (1/4" A - AIRSPACE - 1/4" A)												
		Long Side (in.)										
		76	78	80	82	84	86	88	90	92	94	96
Short Side (in.)	44	+/-50	+/-50	+/-50	+/-50	+/-50	+/-50	+/-50	+/-50	+/-50	+/-50	+/-50
	46	+/-50	+/-50	+/-50	+/-50	+/-50	+/-50	+/-50	+/-50	+/-50	+/-50	+/-50
	48	+/-50	+/-50	+/-50	+/-50	+/-50	+/-50	+/-50	+/-50	+/-50	+/-50	+/-50
	50	+/-50	+/-50	+/-50	+/-50	+/-50	+/-50	+/-50	+/-50	+/-50	+/-50	+/-50
	52	+/-50	+/-50	+/-50	+/-50	+/-50	+/-50	+/-50	+/-50	+/-50	+/-50	+/-50
	54	+/-50	+/-50	+/-50	+/-50	+/-50	+/-50	+/-50	+/-50	+/-50	+/-50	+/-50
	56	+/-50	+/-50	+/-50	+/-50	+/-50	+/-50	+/-50	+/-50	+/-50	+/-50	+/-50
	58	+/-50	+/-50	+/-50	+/-50	+/-50	+/-50	+/-50	+/-50	+/-50	+/-50	+/-50
	60	+/-50	+/-50	+/-50	+/-50	+/-50	+/-50	+/-50	+/-50	+/-50	+/-50	+/-50



A. LYNN MILLER, P.E., P.E.# 106954

REGISTRATION #F-23136
PREPARED BY: A. LYNN MILLER, P.E.
1070 TECHNOLOGY DR
N. VENICE, FL 34275
(941)-480-1600

COPYRIGHT © 2022
NEWSOUTH WINDOW SOLUTIONS
LIMITED LICENSE TO MAKE
COPIES FOR PERMITTING

1860 SERIES PICTURE WINDOW	BY:				
DP TABLES & GLASS TYPES	REVISION:				
NEWSOUTH WINDOW SOLUTIONS 10741 CROSSROADS COMMERCE BLVD. TAMPA, FL 33610	DATE:				
	#:				
	DATE:	9/01/22			
	SCALE:	NTS			
	BY:	S. Berkowitz			
	DRAWING #:	TDI-PW1860			
	SHEET:	3 OF 7			

NOTE: 1) FOR SIZES NOT SHOWN, ROUND UP TO THE NEXT AVAILABLE WIDTH OR HEIGHT DIMENSION.

TABLE E:

		Window Design Pressure (psf)										
		Glass Type 4: 7/8" IG (3/16" T - AIRSPACE - 3/16" T)										
		Glass Type 6: 1" IG (1/4" T - AIRSPACE - 1/4" T)										
		Long Side (in.)										
		76	78	80	82	84	86	88	90	92	94	96
Short Side (in.)	44	+/-50	+/-50	+/-50	+/-50	+/-50	+/-50	+/-50	+/-50	+/-50	+/-50	+/-50
	46	+/-50	+/-50	+/-50	+/-50	+/-50	+/-50	+/-50	+/-50	+/-50	+/-50	+/-50
	48	+/-50	+/-50	+/-50	+/-50	+/-50	+/-50	+/-50	+/-50	+/-50	+/-50	+/-50
	50	+/-50	+/-50	+/-50	+/-50	+/-50	+/-50	+/-50	+/-50	+/-50	+/-50	+/-50
	52	+/-50	+/-50	+/-50	+/-50	+/-50	+/-50	+/-50	+/-50	+/-50	+/-50	+/-50
	54	+/-50	+/-50	+/-50	+/-50	+/-50	+/-50	+/-50	+/-50	+/-50	+/-50	+/-50
	56	+/-50	+/-50	+/-50	+/-50	+/-50	+/-50	+/-50	+/-50	+/-50	+/-50	+/-50
	58	+/-50	+/-50	+/-50	+/-50	+/-50	+/-50	+/-50	+/-50	+/-50	+/-50	+/-50
	60	+/-50	+/-50	+/-50	+/-50	+/-50	+/-50	+/-50	+/-50	+/-50	+/-50	+/-50

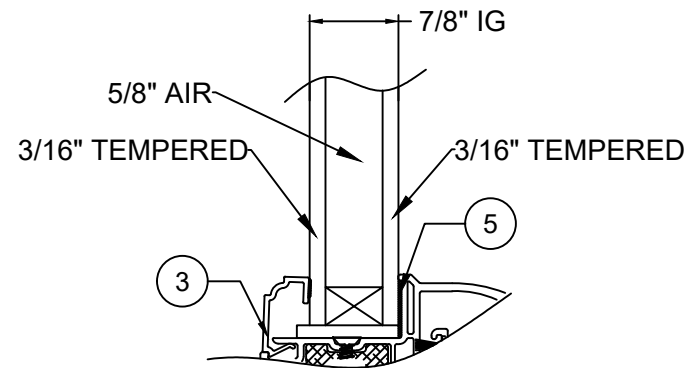

GLASS TYPE 4
7/8"IG (3/16" T - 1/2" Air - 3/16" T)

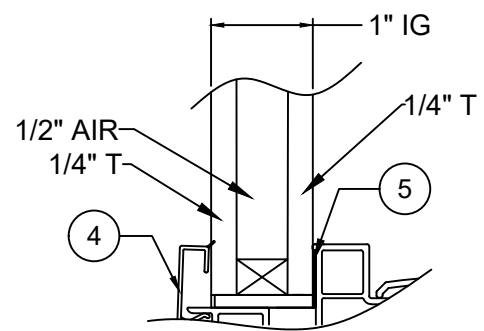

GLASS TYPE 6
1"IG (1/4" T - 1/2" Air - 1/4" T)

NOTE 1) FOR SIZES NOT SHOWN, ROUND UP TO THE NEXT AVAILABLE WIDTH OR HEIGHT DIMENSION.



A. LYNN MILLER, P.E., P.E.# 106954

PREPARED BY: A. LYNN MILLER, P.E. REGISTRATION #F-23136
1070 TECHNOLOGY DR
N. VENICE, FL 34275
(941)-480-1600

COPYRIGHT © 2022
NEWSOUTH WINDOW SOLUTIONS
LIMITED LICENSE TO MAKE
COPIES FOR PERMITTING

1860 SERIES PICTURE WINDOW	BY:				
DP TABLES & GLASS TYPES	REVISION:				
NEWSOUTH WINDOW SOLUTIONS 10741 CROSSROADS COMMERCE BLVD. TAMPA, FL 33610	DATE:				
	#:				
	DATE:	9/01/22			
	SCALE:	NTS			
	BY:	S. Berkowitz			
	DRAWING #:	TDI-PW1860			
	SHEET:	4 OF 7			



A. LYNN MILLER, P.E., P.E.# 106954

REGISTRATION #F-23136
 PREPARED BY: A. LYNN MILLER, P.E.
 1070 TECHNOLOGY DR
 N. VENICE, FL 34275
 (941)-480-1600

COPYRIGHT © 2022
 NEWSOUTH WINDOW SOLUTIONS
 LIMITED LICENSE TO MAKE
 COPIES FOR PERMITTING

1860 SERIES PICTURE WINDOW
 EQUAL LEG INSTALLATION
 SECTION VIEWS
 NEWSOUTH WINDOW SOLUTIONS
 10741 CROSSROADS COMMERCE BLVD.
 TAMPA, FL 33610

BY:	
REVISION:	
DATE:	
#:	
DATE:	9/01/22
SCALE:	NTS
BY:	S. Berkowitz
DRAWING #:	TDI-PW1860
SHEET:	5 OF 7

1 HEAD EQUAL-LEG FRAME X-SECTION INTO 2X WOOD OR MASONRY

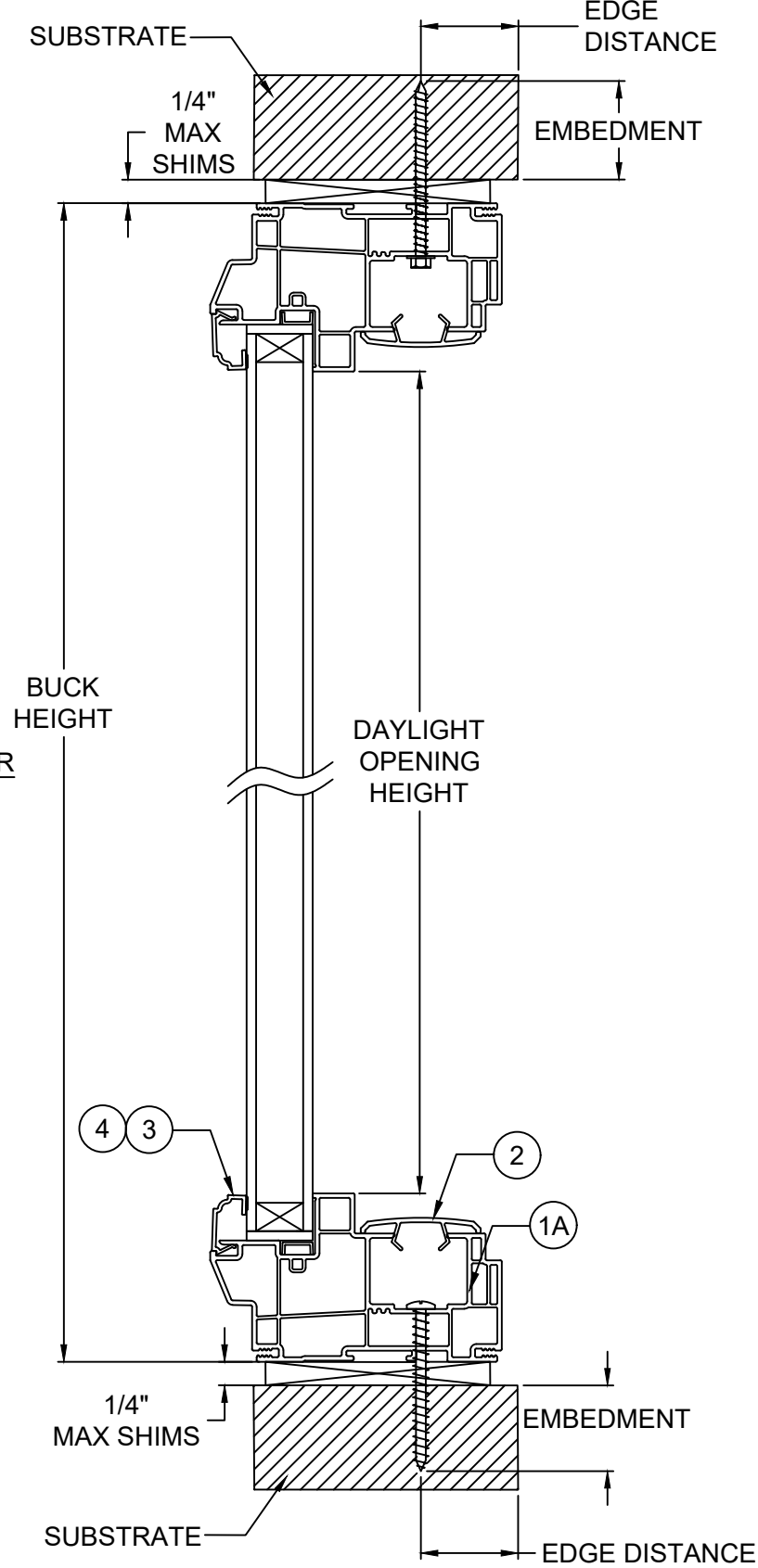

2 SILL EQUAL-LEG FRAME X-SECTION INTO 2X WOOD OR MASONRY

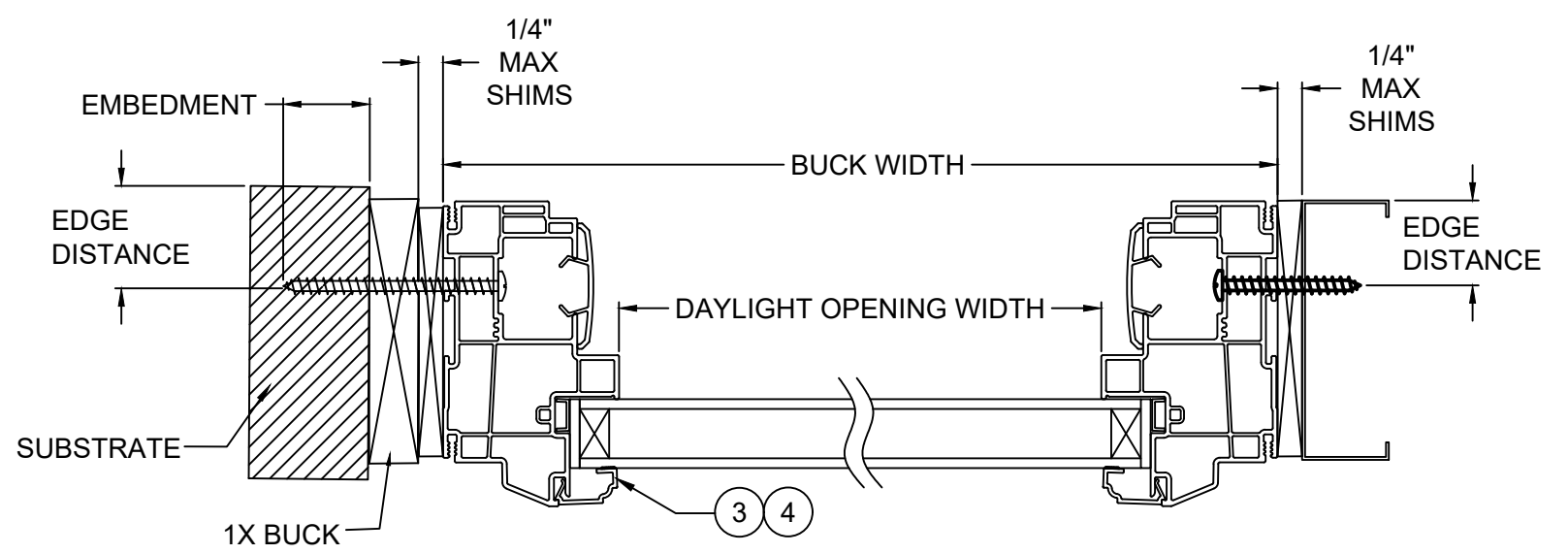

3 JAMB EQUAL-LEG FRAME X-SECTION THRU 1X INTO 2X WOOD OR MASONRY

4 JAMB EQUAL-LEG FRAME X-SECTION USING SCREWS INTO METAL

TABLE 2: INSTALLATION ANCHORS

Anchor	Substrate	Min. Edge Distance	Min. O.C. Distance	Min. Embedment
#10 Steel SMS #10 410 SS SMS	S. Pine	1/2"	0.756	1-3/8"
	6063-T5	5/16"	0.473	0.045 (18 ga)
	A36 Steel	5/16"	0.567	0.035 (20 ga)
	A653 Stud, Gr. 33	5/16"	0.567	0.035 (20 ga)
3/16" Steel Ultracon+	Concrete (2.9 ksi)	1"	3.375	1-3/4"
	UngROUTED CMU, (ASTM C-90)	1"	3	1-1/4"
	Southern Pine (SG = .55)	1/2"	0.75	1-3/8"
1/4" Steel Ultracon+	Concrete (2.9 ksi)	1"	4	1-3/8"
	UngROUTED CMU, (ASTM C-90)	1"	3	1-1/4"
	Southern Pine (SG = .55)	1"	1	1-3/8"

- 1) ANCHOR MUST EXTEND A MINIMUM OF 3 THREADS BEYOND ANY METAL SUBSTRATE.
- 2) "UNGROUTED CMU" VALUES MAY BE USED FOR GROUTED CMU APPLICATIONS.
- 3) ALL ANCHOR HEAD TYPES ARE APPLICABLE.

INSTALLATION NOTES:

- 1) SEE SHEET 1 FOR ANCHOR SPACING REQUIREMENTS.
- 2) ANY INSTALLATION OPTION SHOWN (2X BUCK OR WOOD FRAMING, 1X BUCK, DIRECT TO MASONRY, STEEL STUD) MAY BE USED ON ANY SIDE OF THE WINDOW.
- 3) USE ONLY SUBSTRATE APPROPRIATE ANCHORS LISTED IN ANCHOR TABLE 2. FOLLOW EMBEDMENT AND EDGE DISTANCE LIMITS. MAX. SHIM THICKNESS TO BE 1/4". ANY INSTALLATION OPTION SHOWN MAY BE USED ON ANY OR ALL SIDES OF THE WINDOW.



A. LYNN MILLER, P.E., P.E.# 106954

REGISTRATION #F-23136
 PREPARED BY: A. LYNN MILLER, P.E.
 1070 TECHNOLOGY DR
 N. VENICE, FL 34275
 (941)-480-1600

COPYRIGHT © 2022
 NEWSOUTH WINDOW SOLUTIONS
 LIMITED LICENSE TO MAKE
 COPIES FOR PERMITTING

1860 SERIES PICTURE WINDOW	BY:	
FIN OR FIN/FLANGE INSTALLATION SECTION VIEWS	REVISION:	
NEWSOUTH WINDOW SOLUTIONS 10741 CROSSROADS COMMERCE BLVD. TAMPA, FL 33610	DATE:	
	#:	
	DATE:	9/01/22
	SCALE:	NTS
	BY:	S. Berkowitz
	DRAWING #:	TDI-PW1860
	SHEET:	6 OF 7

1 HEAD INTEGRAL FIN OR FIN/FLANGE FRAME X-SECTION USING NAILS INTO 2X WOOD

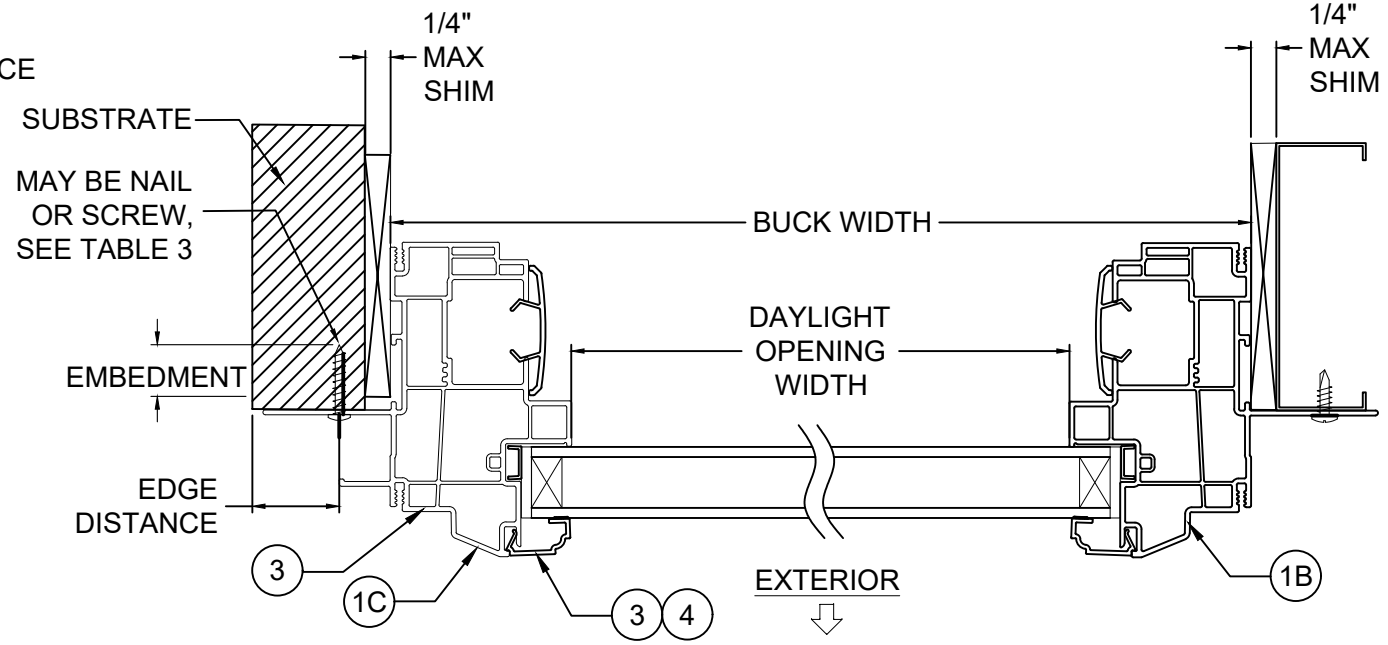
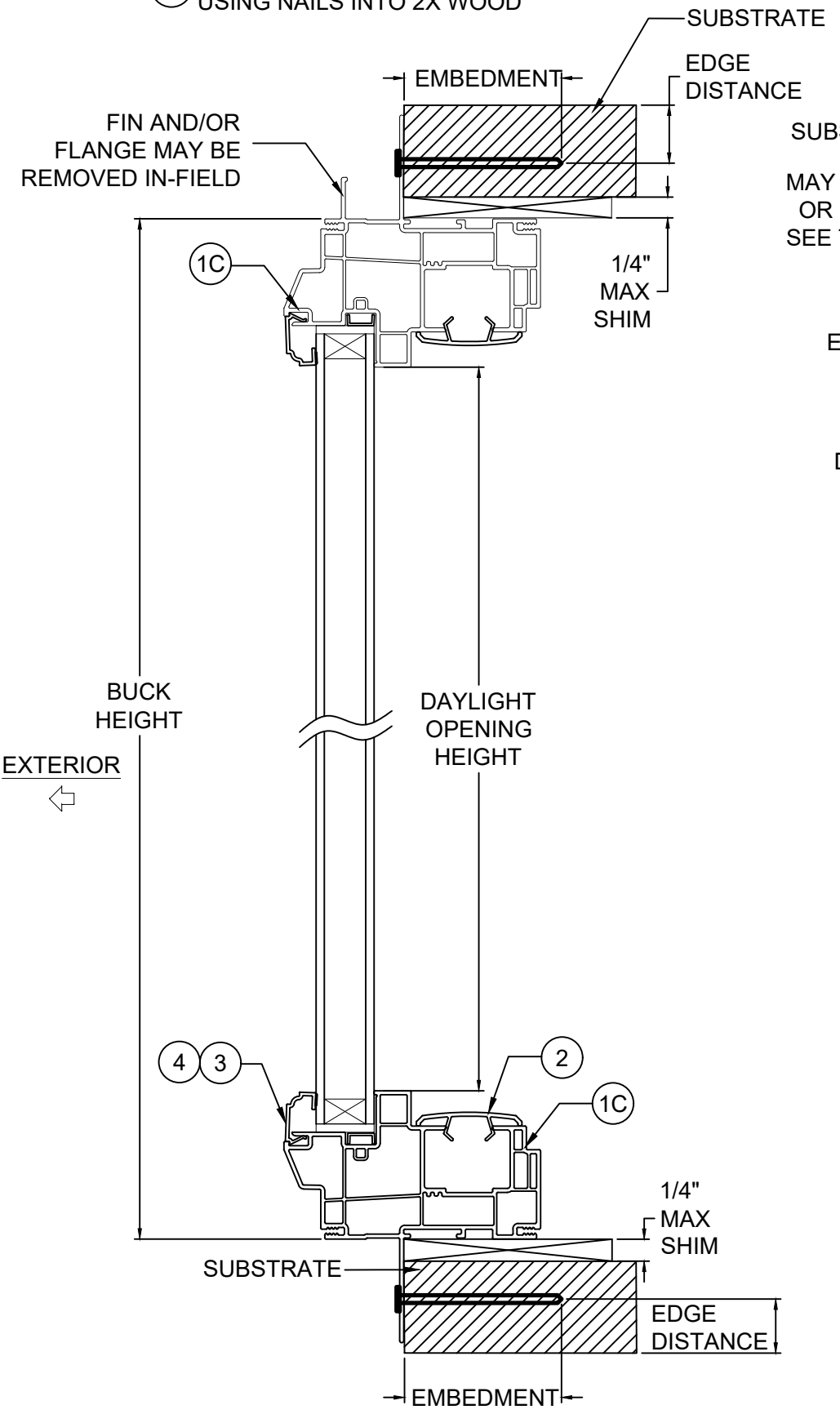

3 JAMB INTEGRAL FIN OR FIN/FLANGE X-SECTION THRU 1X INTO 2X WOOD OR MASONRY

4 JAMB INTEGRAL FIN OR FIN/FLANGE X-SECTION USING SCREW INTO METAL

TABLE 3: INSTALLATION ANCHORS

Anchor	Substrate	Min. Edge Distance	Min. O.C. Distance	Min. Embedment
2-1/2" x .113" Box Nail	P.T. Southern Pine (SG = .55)	5/16"	0.452	2-7/16"
2-1/2" x .131" Common Nail	P.T. Southern Pine (SG = .55)	5/16"	0.524	2-7/16"
2-1/2" x .145" Roofing Nail	P.T. Southern Pine (SG = .55)	3/8"	0.58	2-7/16"
#10 Steel SMS	P.T. Southern Pine (SG = .55)	1/2"	0.756	1-7/16"
	6063-T5	3/8"	0.473	0.057 (16 ga)
	A36 Steel	5/16"	0.567	0.035 (20 ga)
	Steel Stud Gr. 33	5/16"	0.567	0.035 (20 ga)

- 1) ANCHOR MUST EXTEND A MINIMUM OF 3 THREADS BEYOND ANY METAL SUBSTRATE.
- 2) ALL ANCHOR HEAD TYPES ARE APPLICABLE.

INSTALLATION NOTES:

- 1) SEE SHEET 1 FOR SPACING REQUIREMENTS.
- 2) FLANGE AND/OR FIN MAY BE REMOVED TO CREATE OTHER APPROVED FRAME TYPES.
- 3) USE ONLY SUBSTRATE APPROPRIATE ANCHORS LISTED IN ANCHOR TABLE 3. FOLLOW EMBEDMENT AND EDGE DISTANCE LIMITS. ANY INSTALLATION OPTION SHOWN MAY BE USED ON ANY OR ALL SIDES OF THE WINDOW.
- 4) MAX. SHIM THICKNESS TO BE 1/4". MAX. SHIM SPACING TO BE MAXIMUM 18".

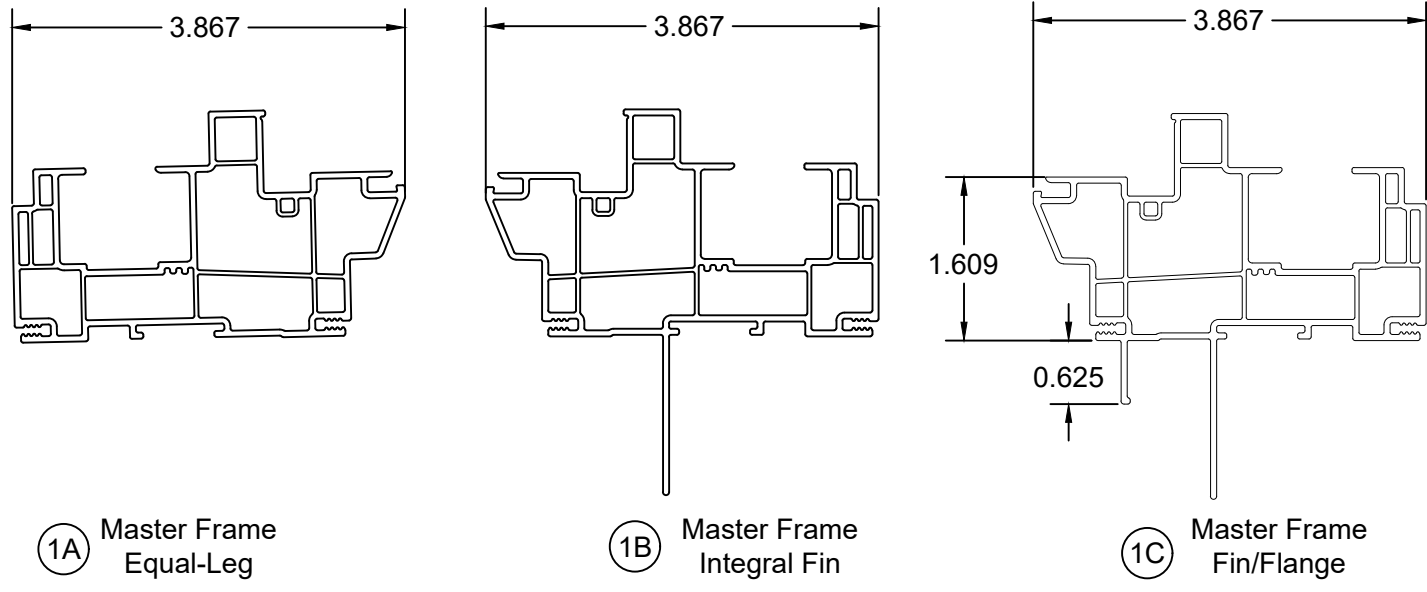

1A Master Frame Equal-Leg
 1B Master Frame Integral Fin
 1C Master Frame Fin/Flange

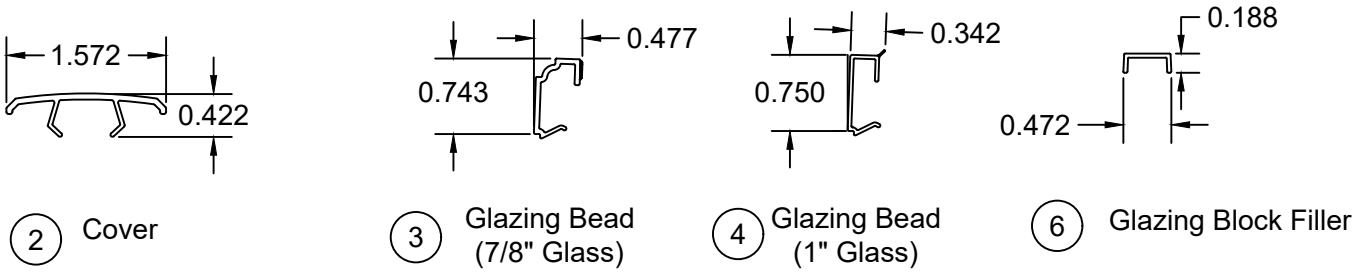

2 Cover
 3 Glazing Bead (7/8" Glass)
 4 Glazing Bead (1" Glass)
 6 Glazing Block Filler

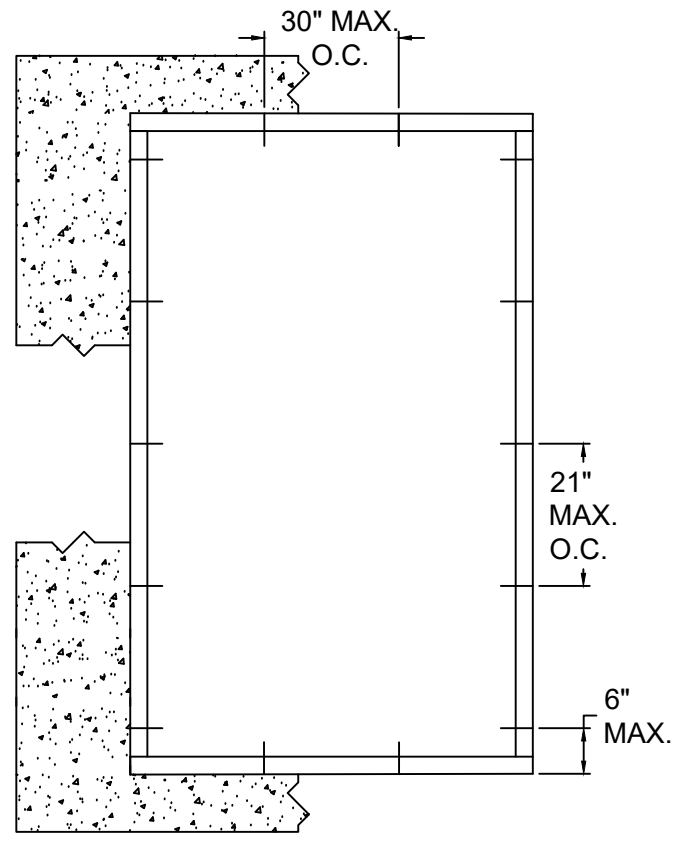

BUCK ANCHORAGE DETAIL

TABLE 5

Anchor	Substrate	Minimum Edge Distance	Minimum Embedment
1/4" Steel Ultracon+	Concrete (min. 3.0 ksi)	1"	1-3/8"
	UngROUTED CMU, (ASTM C-90)	1"	1-1/4"

- 1) "UNGROUTED CMU" VALUES MAY BE USED FOR GROUDED CMU APPLICATIONS.
- 2) ALL ANCHOR HEAD TYPES ARE APPLICABLE.

TABLE 4: BILL OF MATERIALS

Item	Description	Part #	Material
1A	Master Frame Equal Leg	1833A	Rigid PVC
1B	Master Frame Fin	1853J	Rigid PVC
1C	Master Frame Fin-Flange	1853A	Rigid PVC
2	Cover	1863	Rigid PVC
3	Glazing Bead 7/8" Glass	1876	Rigid PVC
4	Glazing Bead 1" Glass	836	Rigid PVC
5	Glazing compound: RGS 7700, Dow 791, 983	-	
6	Glazing Block Filler	440	Rigid PVC

THE APPROVED, RIGID PVC EXTERIOR EXTRUSIONS ARE TO BE PRODUCED BY EXTRUDERS' LICENSEES UNDER "AAMA CERTIFICATION PROGRAMS FOR RIGID PVC EXTRUSIONS".



REGISTRATION #F-23136
 PREPARED BY: A. LYNN MILLER, P.E.
 1070 TECHNOLOGY DR
 N. VENICE, FL 34275
 (941)-480-1600
 COPYRIGHT © 2022
 NEWSOUTH WINDOW SOLUTIONS
 LIMITED LICENSE TO MAKE
 COPIES FOR PERMITTING

1860 SERIES PICTURE WINDOW	BY:	
BILL OF MATERIALS, EXTRUSIONS, & BUCK INSTALLATION DETAILS	REVISION:	
NEWSOUTH WINDOW SOLUTIONS 10741 CROSSROADS COMMERCE BLVD. TAMPA, FL 33610	DATE:	
	#:	
	DATE:	9/01/22
	SCALE:	NTS
	BY:	S. Berkowitz
	DRAWING #:	TDI-PW1860
	SHEET:	7 OF 7

A. LYNN MILLER, P.E., P.E.# 106954