

MAXIM INDUSTRIES, INC.

SERIES "BCM" CURB MOUNT SKYLIGHT (HVHZ)

INSTALLATION ANCHORAGE DETAILS

NOTES:

1. THIS SKYLIGHT WAS TESTED AND IS DESIGNED TO COMPLY WITH ALL REQUIREMENTS OF THE 2018 INTERNATIONAL BUILDING CODE AND 2018 INTERNATIONAL RESIDENTIAL CODE.
2. THIS SKYLIGHT MEETS SMALL & LARGE MISSILE IMPACT RESISTANCE (TAS-201/ASTM E1886/ASTM E1996) AND NO ADDITIONAL PROTECTION IS REQUIRED.
3. THIS SKYLIGHT COMPLIES WITH TAS 201, 202, 203.
4. THIS SKYLIGHTS COMPLIES WITH AAMA/WDMA/CSA 101/I.S.2/A440 AND ASTM E1886/ASTM E1996.
5. ALL SIZES EQUAL TO OR LESS THAN THE TEST SIZE TOTAL SQUARE FOOTAGE ARE APPROVED
6. ALL FRAMING, ROOF DECK, FLASHING, AND FASTENERS ARE BY OTHERS AND MUST COMPLY WITH THE 2018 INTERNATIONAL OR RESIDENTIAL BUILDING CODE.
7. FOR ATTACHMENT OF ALUMINUM ANGLE (ITEM NO. 2) TO ALUMINUM FRAME (ITEM NO. 1), USE ITEM NO. 7 WITH SPACING SHALL BE 4" FROM EACH CORNER AND 6" ON CENTER MAXIMUM.
8. FOR ATTACHMENT OF ALUMINUM FRAME (ITEM NO. 1) TO CURB (BY OTHERS), USE ITEM NO. 8 WITH SPACING SHALL BE 4" FROM EACH CORNER AND 6" ON CENTER MAXIMUM.

BILL OF MATERIALS:

1. 0.6" THICKNESS (TYPICAL BUT VARIES) 6063-T5 EXTRUDED ALUMINUM FRAME MITERED AND WELDED AT FOUR CORNERS.
2. 0.105" THICKNESS (TYPICAL BUT VARIES) 6063-T5 EXTRUDED ALUMINUM ANGLE, 2" X 2", MITERED AND WELDED AT FOUR CORNERS.
3. PLASKOLITE TUFFAK SL UV OR PALRAM UV ENHANCED .118" POLYCARBOANTE DOME PER LATEST MIAMI-DADE NOTICE OF ACCEPTANCE.
4. GALLINA POLICARB 5 LAYER 16MM RDC MULTIWALL POLYCARBONATE PER LATEST MIAMI-DADE NOTICE OF ACCEPTANCE.
5. DOW CORNING 795 SILICONE BUILDING SEALANT LOCATED BETWEEN ALUMINUM ANGLE AND OUTER DOME.
6. ITW SM 5127 SEALANT TAPE LOCATED BETWEEN 16MM RDC MULTIWALL AND EXTRUDED ALUMINUM FRAME.
7. NO. 10 X .375" STAINLESS STEEL FASTENERS; 4" FROM EACH CORNER, MAXIMUM 6" ON CENTER.
8. SKYLIGHT CURB FASTENERS; 4" FROM EACH CORNER, MAXIMUM 6" ON CENTER.
 - 8.1. FOR WOOD CURB #12 SS WOOD SCREW, PAN HEAD OR HEX HEAD
 - 8.1.1. MIN. WOOD DENSITY= 0.42 MIN. EMBEDMENT 1- 3/8" AND MIN. EDGE DISTANCE 2-1/2"
 - 8.2. FOR CONCRETE CURB 3/16" ITW TAPCON
 - 8.2.1. MIN. F'C= 2000 PSI MIN. EMBEDMENT 1" MIN. EDGE DISTANCE 1-1/8"
 - 8.3. FOR HOLLOW BLOCK OR GROUT FILLED CMU CURB 3/16" TAPCON
 - 8.3.1. ASTM C90 CMU DENSITY > 117 PCF, MIN. EMBEDMENT 1" MIN. EDGE DISTANCE 2"

TABLE OF CONTENTS	
SHEET	DESCRIPTION
1	NOTES AND BILL OF MATERIALS
2	ELEVATION AND ANCHORAGE
3	SECTION VIEWS

DESIGN PRESSURE RATING (PSF)	IMPACT RATING
±60.0	WIND ZONE 4 MISSILE LEVEL D

PROJECT #422-0706

MAXIM INDUSTRIES, INC
201 LONGHORN ROAD
FORT WORTH, TEXAS 76179

TITLE: SERIES "BCM" CURB MOUNT SKYLIGHT (HVHZ)
NOTES, ELEVATION & ANCHOR LAYOUT

DRAWN BY: RJA	DATE: 8/2/22	DRAWING NO: MAX1004	SHEET: 1 OF 3	
SCALE: N/A	REV:			



Robert J. Amoruso, P.E.
TX P.E. No. 80817

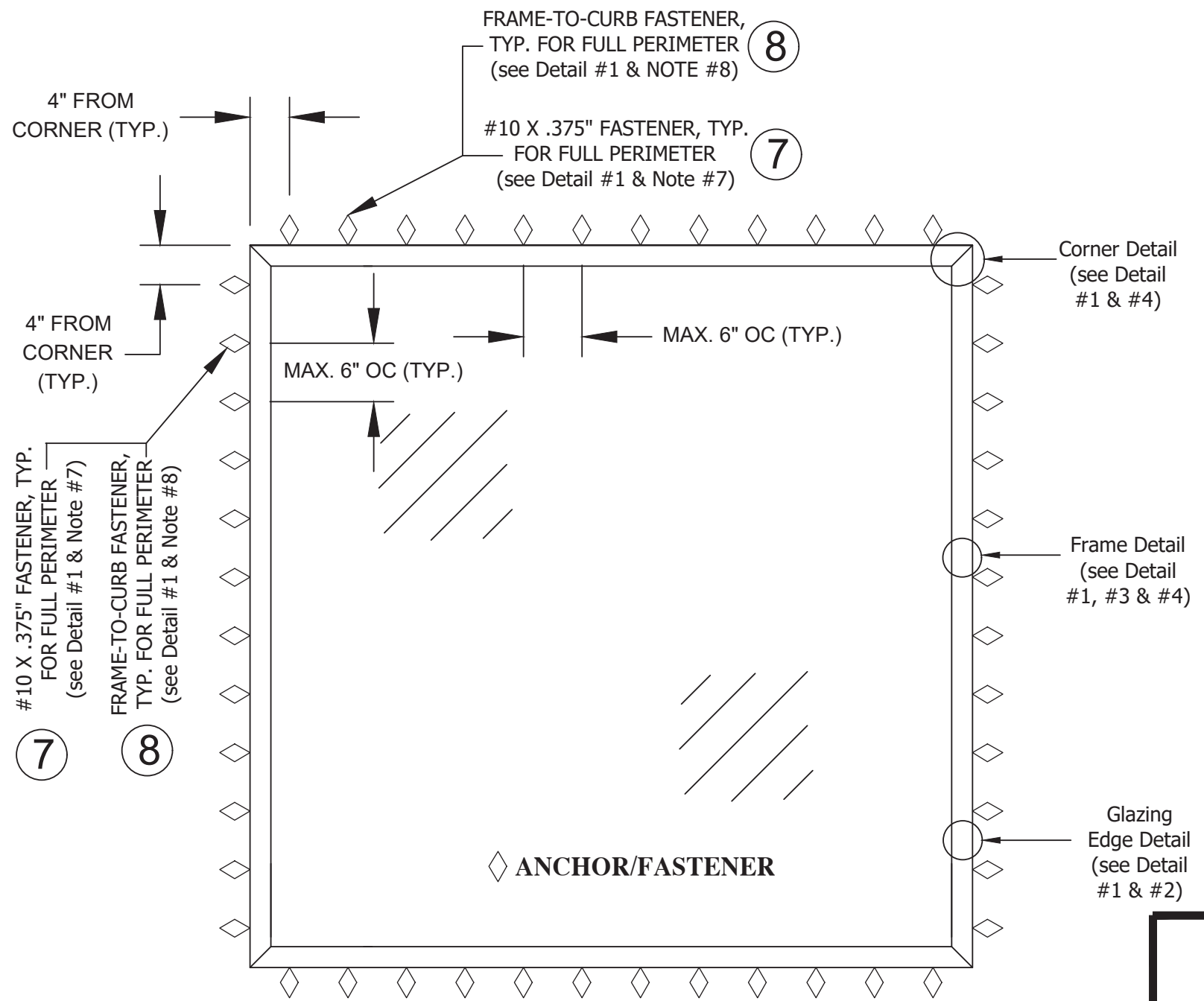
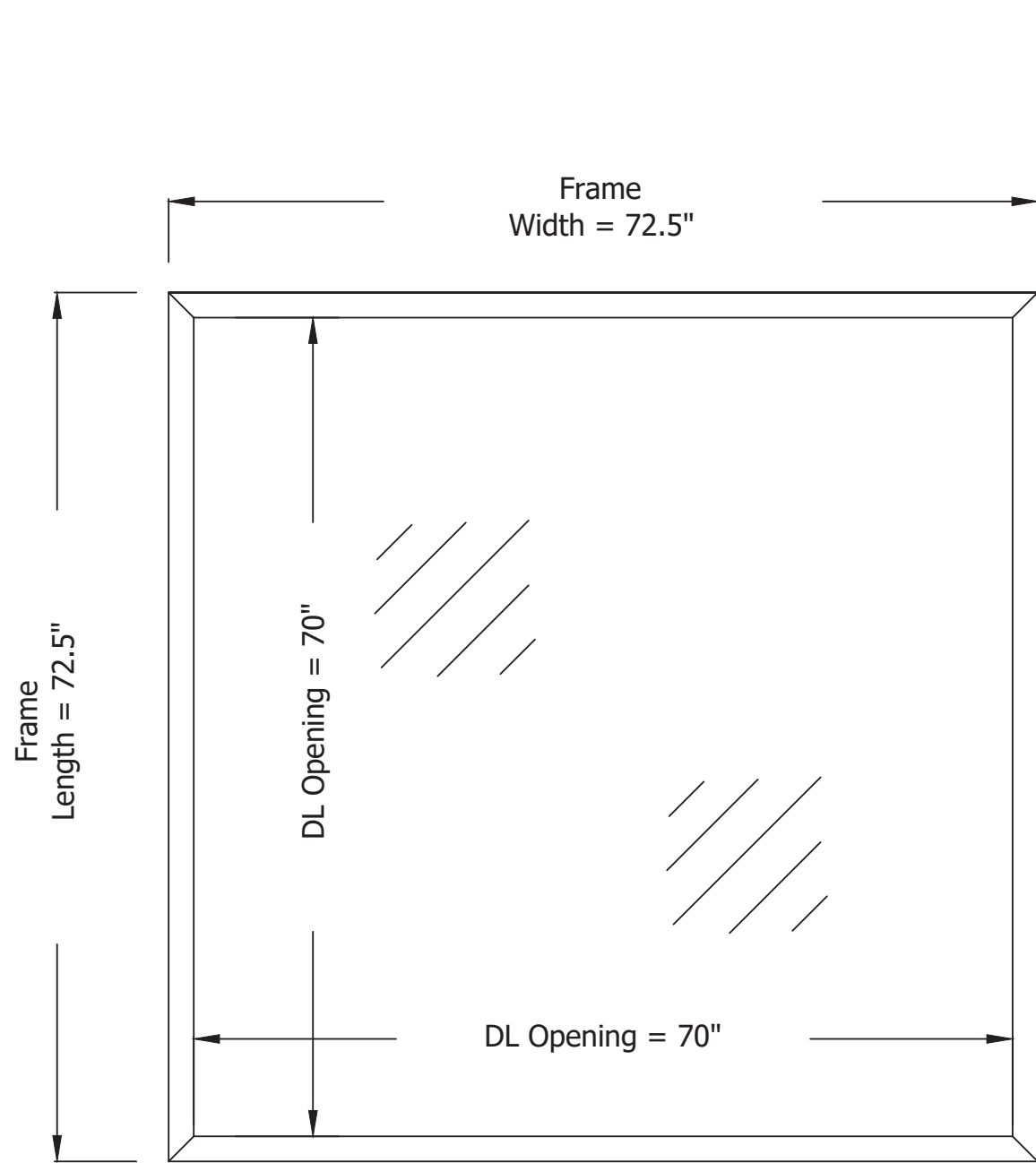

ELEVATION & ANCHOR LAYOUT

EXTERIOR VIEW

ANCHORAGE NOTES:

1. A MINIMUM OF 12 ANCHORS IS REQUIRED ON EACH SIDE OF THE SKYLIGHT. SEE ELEVATION ABOVE.
 - 1.1. FRAME-TO-CURB INSTALLATION FASTENER ITEM NO. 8 SHALL BE INSTALLED AT 4" FROM EACH CORNER AND 6" ON CENTER ALONG FULL PERIMETER (EACH SIDE).
 - 1.2. ANGLE-TO-FRAME INSTALLATION FASTENER ITEM NO. 7 SHALL BE INSTALLED AT 4" FROM EACH CORNER AND 6" ON CENTER ALONG FULL PERIMETER (EACH SIDE).
2. FOR SKYLIGHTS SMALLER IN WIDTH AND/OR HEIGHT, THE ANCHOR QUANTITY CAN BE REDUCED WHILE MAINTAINING THE 4" CORNER SPACING AND 6" O.C. SPACING ALONG THE FULL PERIMETER.

Robert J. Amoruso, P.E.
TX P.E. No. 80817

PROJECT #422-0706		DATE: 8/2/22	REV: ---
MAXIM INDUSTRIES, INC 201 LONGHORN ROAD FORT WORTH, TEXAS 76179		DRAWING NO: MAX1004	DESCRIPTION
TITLE: SERIES "BCM" CURB MOUNT SKYLIGHT (HVHZ) SECTION VIEWS		SCALE: N/A	DATE
PREPARED BY: RJA		REV: ---	BY
PTC PRODUCT DESIGN GROUP, LLC PO BOX 520775 LONGWOOD, FLORIDA 32752 REGISTRATION NO. P-13740		SHEET: 2 OF 3	DATE

Detail #1:
Frame, Angle & Glazing Section Detail

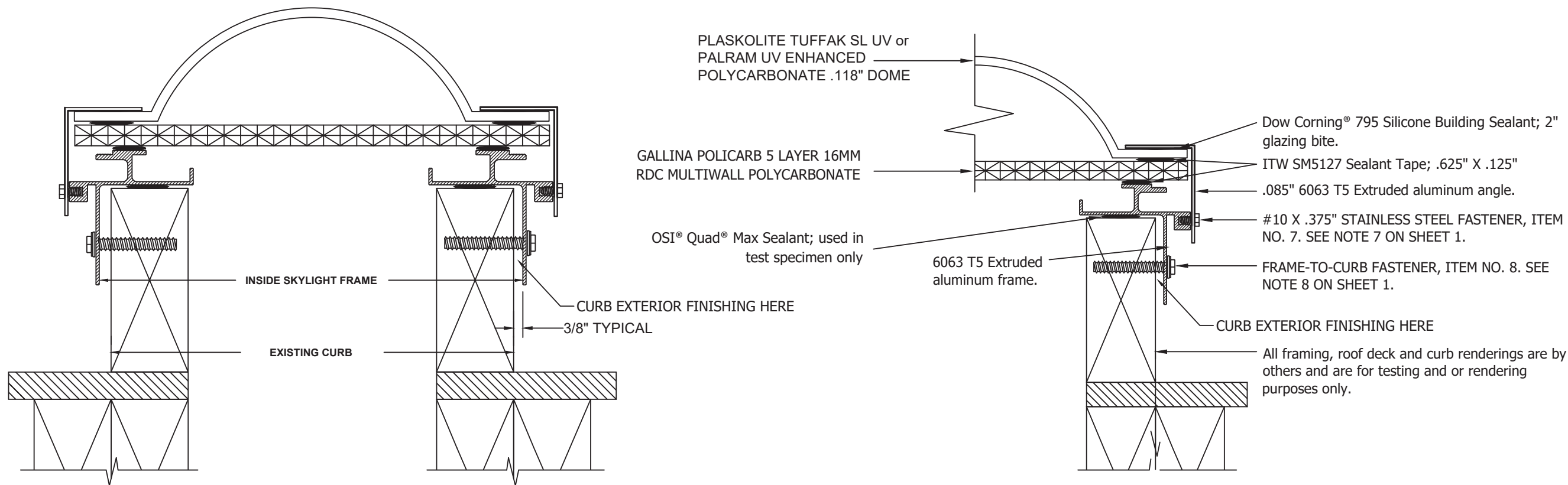

Detail #2: Glazing Detail

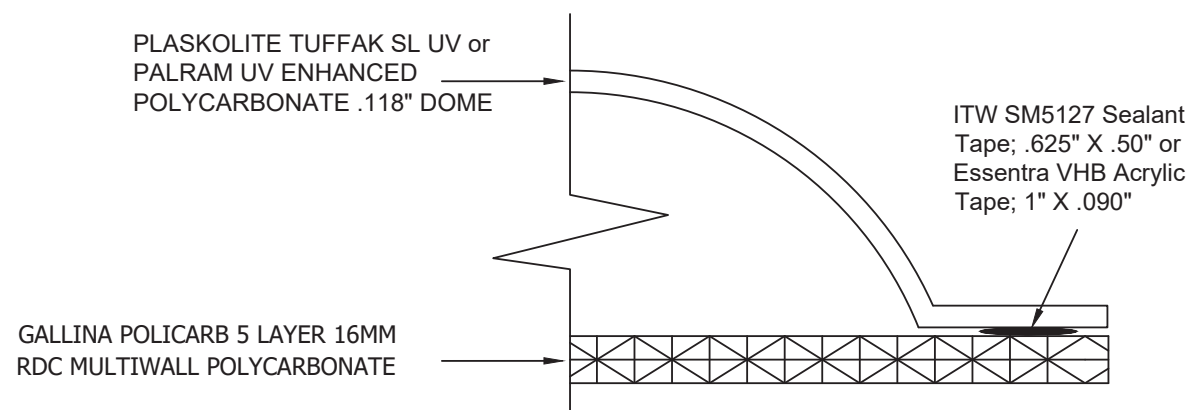

Detail #3
Aluminum Shape Weld Detail
AFCO Part #AF-4950

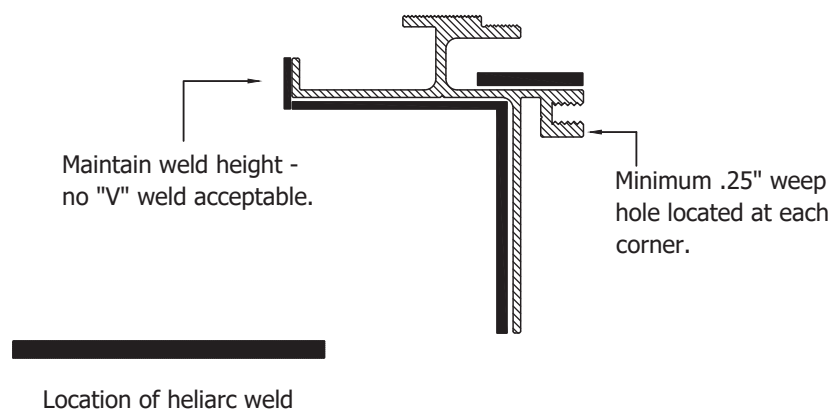

Detail #4
2" X 2" Aluminum Angle
Weld Detail
AFCO Part #AF-4230

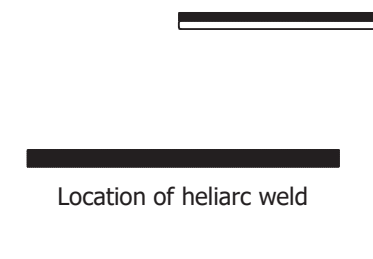

PROJECT #422-0706

MAXIM INDUSTRIES, INC 201 LONGHORN ROAD FORT WORTH, TEXAS 76179	DATE:	8/2/22
	DRAWING NO.:	MAX1004
TITLE: SERIES "BCM" CURB MOUNT SKYLIGHT (HVHZ) SECTION VIEWS	DRAWN BY:	RJA
	SCALE:	N/A
PREPARED BY:	REV:	---
PTC PRODUCT DESIGN GROUP, LLC PO BOX 520775 LONGWOOD, FLORIDA 32752 REGISTRATION NO. F-13740	SHEET:	3 OF 3

Robert J. Amoruso, P.E.
TX P.E. No. 80817