

PARTS LIST				
NO.	PART NUMBER	DESCRIPTION	MANUFACTURER	MATERIAL
1		1" x 3 3/8" STRUCTURAL TUBE MULL		ALUMINUM 6063-T6
2		GOALPOST STYLE BRACKET		ALUMINUM 6063-T6
3	AM72	COVER		RIGID PVC
4		GOALPOST BRACKET OFFSET		ALUMINUM 6063-T6

REVISIONS			
REV	DESCRIPTION	DATE	APPROVED

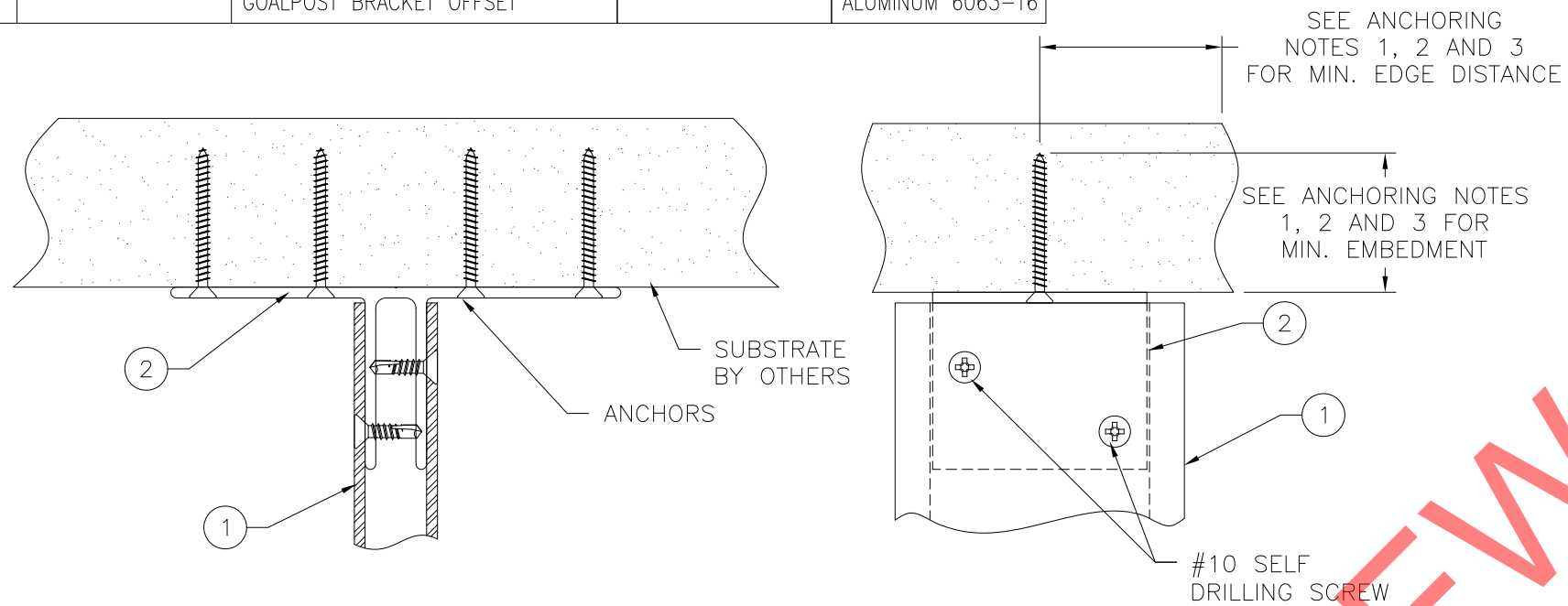

CLIP INSTALLATION DETAIL
MULLION TOP AND BOTTOM

ANCHORING NOTES:

- FOR ANCHORING INTO WOOD FRAMING OR 2X BUCK USE #10 WOOD SCREWS WITH SUFFICIENT LENGTH TO ACHIEVE A 1 3/8" MINIMUM EMBEDMENT INTO SUBSTRATE AND 1/2" MINIMUM EDGE DISTANCE. LOCATE ANCHORS AS SHOWN IN ELEVATIONS AND INSTALLATION DETAILS.
- FOR ANCHORING INTO CONCRETE USE 3/16" TAPCONS WITH SUFFICIENT LENGTH TO ACHIEVE A 1 1/4" MINIMUM EMBEDMENT INTO SUBSTRATE WITH 1 1/2" MINIMUM EDGE DISTANCE. LOCATE ANCHORS AS SHOWN IN ELEVATIONS AND INSTALLATION DETAILS.
- FOR ANCHORING INTO METAL STRUCTURE USE #10 SMS OR SELF DRILLING SCREWS WITH SUFFICIENT LENGTH TO ACHIEVE 3 THREADS MINIMUM BEYOND STRUCTURE INTERIOR WALL AND 3/4" MINIMUM EDGE DISTANCE. LOCATE ANCHORS AS SHOWN IN ELEVATIONS AND INSTALLATION DETAILS.
- FOR ATTACHING WINDOW UNITS TO MULLION USE #10 SELF TAPPING SCREWS WITH SUFFICIENT LENGTH TO ACHIEVE A MINIMUM EMBEDMENT OF 3 THREADS PAST THE MULLION WALL. LOCATE SCREWS 6" FROM EACH MULLION END AND 8" MAX O.C. THEREAFTER STAGGER SCREWS AT EACH WINDOW.
- FOR WINDOW UNITS ANCHORING SCHEDULE REFER TO WINDOW APPROVED INSTALLATION INSTRUCTIONS
- ALL FASTENERS TO BE CORROSION RESISTANT.
- INSTALLATION ANCHORS SHALL BE INSTALLED IN ACCORDANCE WITH ANCHOR MANUFACTURER'S INSTALLATION INSTRUCTIONS AND ANCHORS SHALL NOT BE USED IN SUBSTRATES WITH STRENGTHS LESS THAN THE MINIMUM STRENGTH SPECIFIED BELOW:
 - WOOD - MINIMUM SPECIFIC GRAVITY OF G=0.42
 - CONCRETE - MINIMUM COMPRESSIVE STRENGTH OF 3,192 PSI.
 - METAL STRUCTURE: STEEL 18GA, 33KSI OR ALUMINUM 6063-T5 .060" THICK MINIMUM

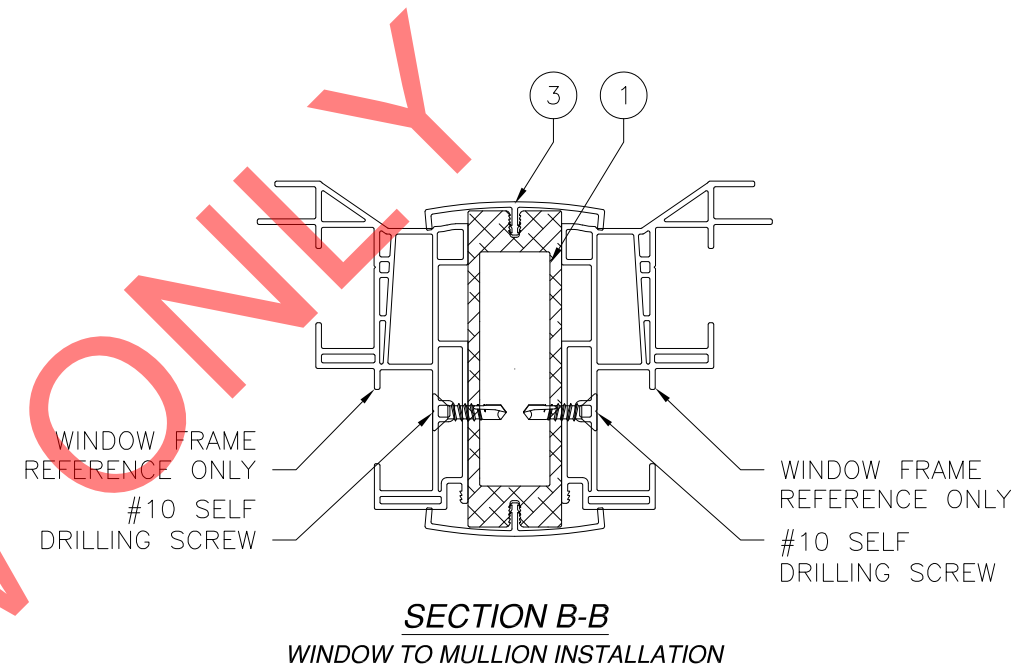

SECTION B-B
WINDOW TO MULLION INSTALLATION

FOR REVIEW ONLY

SIGNED: 06/05/2018

BURRIS WINDOWS 2005 McDANIEL DR. SUITE 100 CARROLLTON, TX 75006		
1" X 3 3/8" STRUCTURAL TUBING MULLION VERTICAL - LMI & SMI INSTALLATION DETAILS AND BILL OF MATERIALS		
DRAWN: A.R.	DWG NO. 08-03234	REV -
SCALE NTS	DATE 05/01/18	SHEET 2 OF 3
L. ROBERTO LOMAS P.E. 1432 WOODFORD RD LEWISVILLE, NC 27023 434-688-0609 rllomas@rlomaspe.com		



Luis R. Lomas P.E.
TX No.: 101889

REVISIONS			
REV	DESCRIPTION	DATE	APPROVED

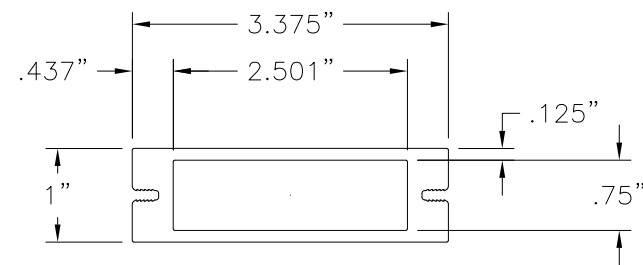

① **1" x 3 3/8" STRUCTURAL TUBING MULLION**
6063-T6 ALUMINUM .125" THICK

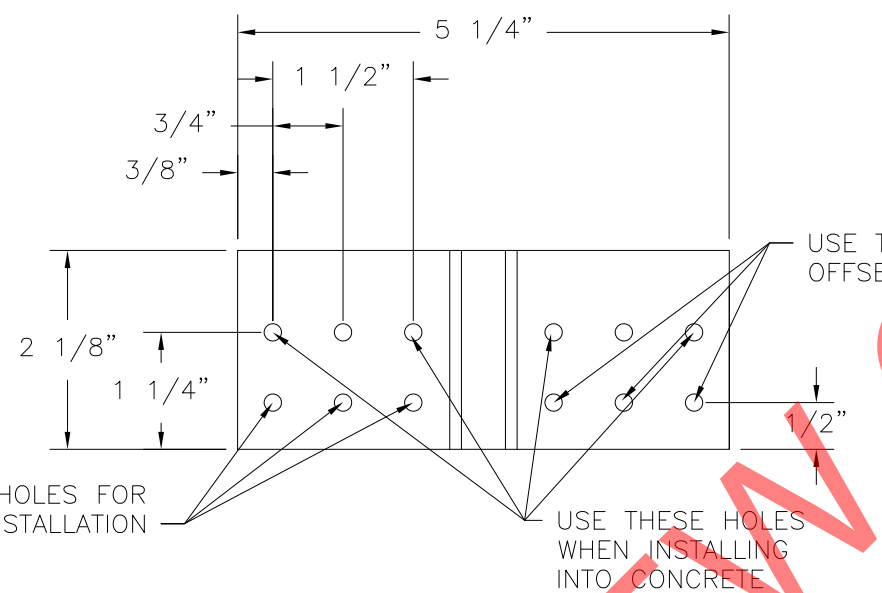

USE THESE HOLES FOR OFFSET INSTALLATION

USE THESE HOLES FOR OFFSET INSTALLATION

USE THESE HOLES WHEN INSTALLING INTO CONCRETE

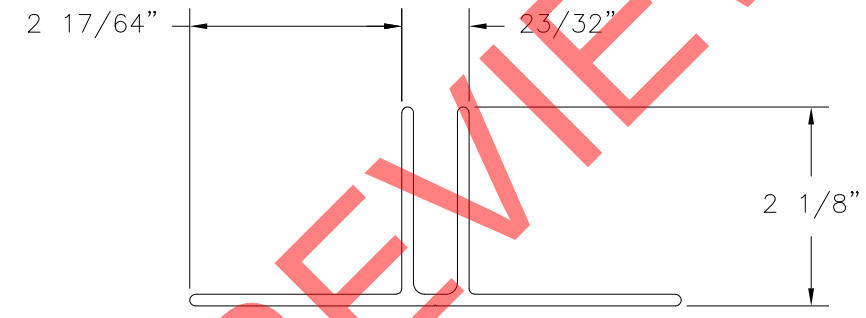

② **GOALPOST STYLE BRACKET (5 1/4" x 2 1/8")**
6063-T6 ALUMINUM .125" THICK

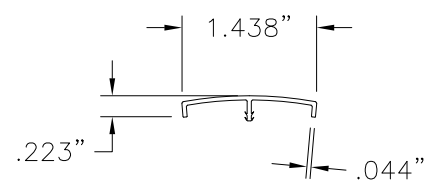

③ **COVER**
RIGID PVC .044" THICK

FOR REVIEW ONLY

SIGNED: 06/05/2018

BURRIS WINDOWS 2005 McDANIEL DR. SUITE 100 CARROLLTON, TX 75006		
1" X 3 3/8" STRUCTURAL TUBING MULLION VERTICAL - LMI & SMI COMPONENTS		
DRAWN: A.R.	DWG NO. 08-03234	REV -
SCALE NTS	DATE 05/01/18	SHEET 3 OF 3
L. ROBERTO LOMAS P.E. 1432 WOODFORD RD LEWISVILLE, NC 27023 434-688-0609 rllomas@lrlomaspe.com		



Luis R. Lomas P.E.
TX No.: 101889