

Doors tested per ANSI/DASMA 108 for static air pressure and ANSI/DASMA 115 for large missile impact and cyclic wind pressure

| Maximum Door Width | Stiles per Sect. | Hinges per Sect. | Design Loads | |
|--------------------|------------------|------------------|--------------|-------|
| 8'-2" | 2 | 2 | 43.0 | -48.0 |
| 9'-2" | 2 | 2 | | |
| 10'-2" | 2 | 2 | | |
| 12'-2" | 3 | 3 | | |
| 14'-2" | 3 | 3 | | |

John E. Scates
 2560 King Arthur Blvd, Ste 124-54
 Lewisville, TX 75056
 FL PE #51737
 TX PE #56308-12203

End Stile Detail
 .075 Thick Aluminum Wall Extrusions

| |
|-------------------------|
| Scale: None |
| Drawn by: R. Frey |
| Checked by: G. Wedekind |
| Date: 02/28/19 |
| ECO: 7679.01 |



1101 East River Road
 Dixon, IL. 61021

| | | |
|--|--------------|-------|
| Title: Spec, Wind Load AlumaView - AV200, StyleView - CPF, WPF | | |
| No. P-2909 | Sheet 1 of 3 | Rev B |

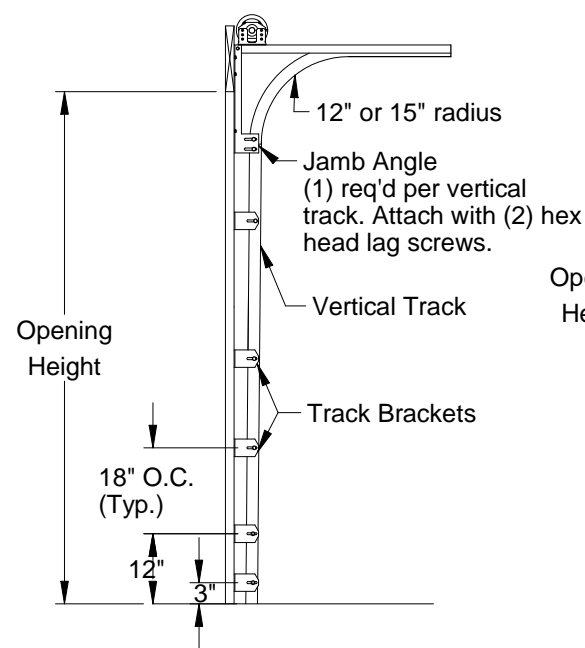

**Typical Track Installation
Bracket Mount
Wood Jamb**

Normal headroom track shown, low headroom, lift clearance and vertical lift track available

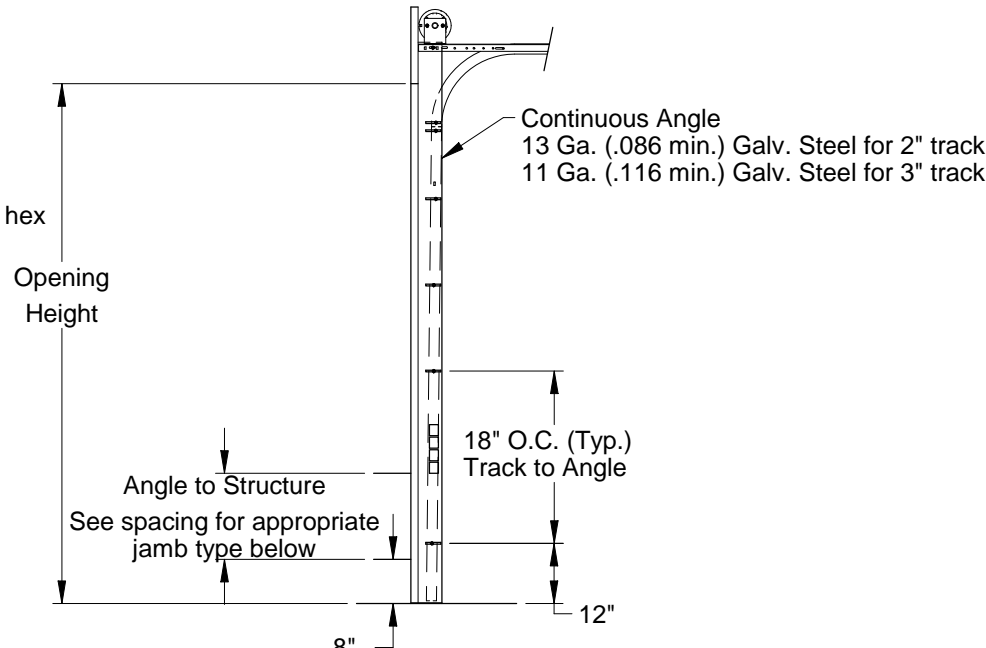

**Typical Track Installation
Angle Mount
Wood, Steel or Concrete Jamb**

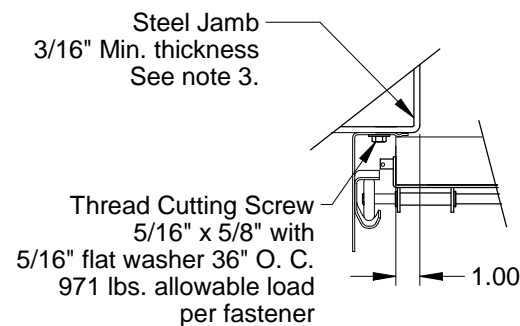
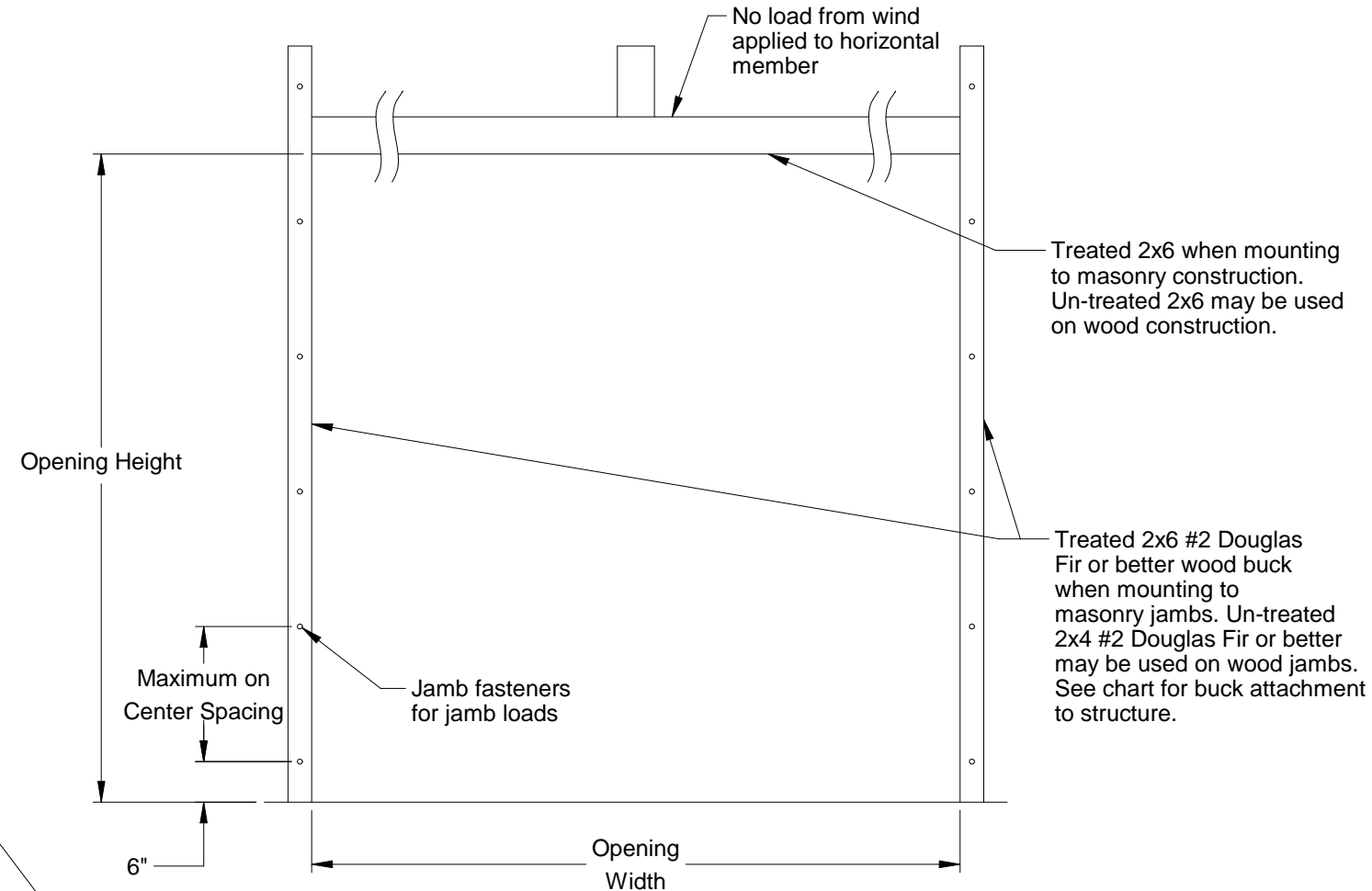

**Track Assembly Attachment
to Steel Jamb**

2" Track Angle Mount Turned-in (shown)
3" Track Angle Mount Available

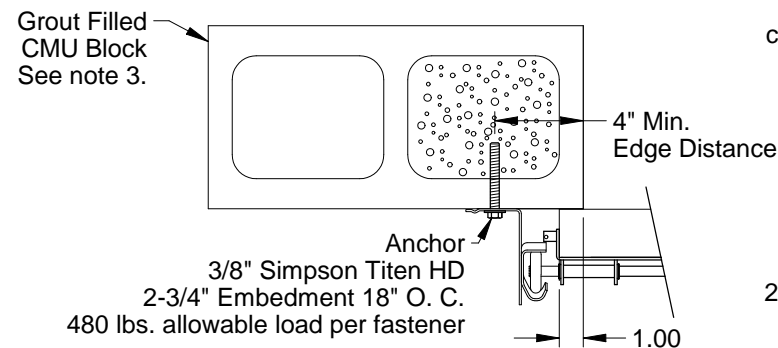

**Track Assembly Attachment
to Grout Filled CMU Block**

2" Track Angle Mount Turned-out (shown)
3" Track Angle Mount Available

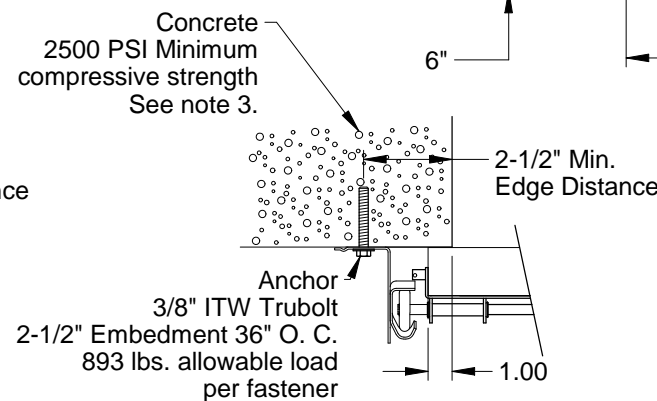

**Track Assembly Attachment
to 2500 PSI Min. Concrete**

2" Track Angle Mount Turned-out (shown)
3" Track Angle Mount Available

Jamb Attachment Notes:

1. Maximum Positive Load per Jamb = (14'-2" x 43.0 PSF) / 2 = 305 lbs. per foot.
2. Maximum Negative Load per Jamb = (14'-2" x -48.0 PSF) / 2 = 340 lbs. per foot.
3. Design of the supporting structure shall be the sole responsibility of the building designer and shall be designed for the jamb loads listed in notes 1 and 2.
4. Alternate jamb attachments may be used if approved by a registered Professional Engineer.
5. DASMA Technical Data Sheet TDS-161 may be used for alternate jamb attachments.
6. 3/8" diameter lag screws required 1/16" pilot hole and 1-1/2" minimum required distance.

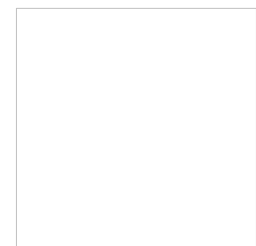

John E. Scates
2560 King Arthur Blvd, Ste 124-54
Lewisville, TX 75056
FL PE #51737
TX PE #56308-12203

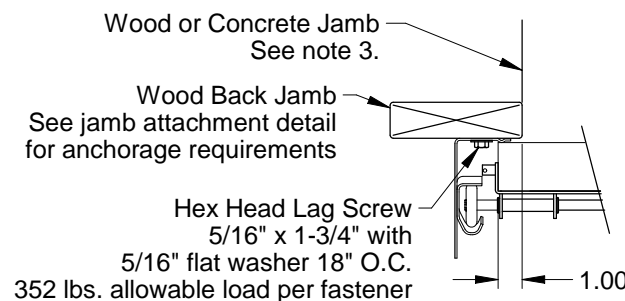

**Track Assembly Attachment
to Wood Back Jamb**

2" Track Angle Mount Turned-in (shown)
3" Track Angle Mount Available

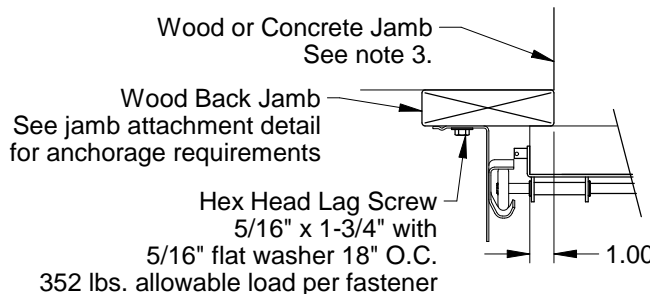

**Track Assembly Attachment
to Wood Back Jamb**

2" Track Angle Mount Turned-out (shown)
3" Track Angle Mount Available

| 2x6 Attachment to Structure | | | | | | |
|-----------------------------|---|-------------------|-----------------------|---------------------------|---------------------------|------------------------|
| Structure Type | Fastener Type | Minimum Embedment | Minimum Edge Distance | Minimum on Center Spacing | Maximum on Center Spacing | Allowable Tension Load |
| 2500 PSI Min. Concrete | 1/4" Tapcon+ (Plus) with 1-1/8" OD Washer | 2" | 2.5 | 6" | 20" | 526 |
| Southern Pine | 3/8" x 3" Lag with 1-1/8" OD Washer | 1.50" | 1.50" | 1.50" | 24" | 655 |
| Spruce Pine Fir | 3/8" x 3" LAG with 1-1/8" OD Washer | 1.50" | 1.50" | 1.50" | 18" | 482 |

| |
|-------------------------|
| Scale: None |
| Drawn by: R. Frey |
| Checked by: G. Wedekind |
| Date: 02/28/19 |
| ECO: 7679.01 |



1101 East River Road
Dixon, IL 61021

| | | |
|--|---------|-------|
| Title: Spec, Wind Load AlumaView - AV200, StyleView - CPF, WPF | | |
| No. P-2909 | Sheet 2 | Rev B |

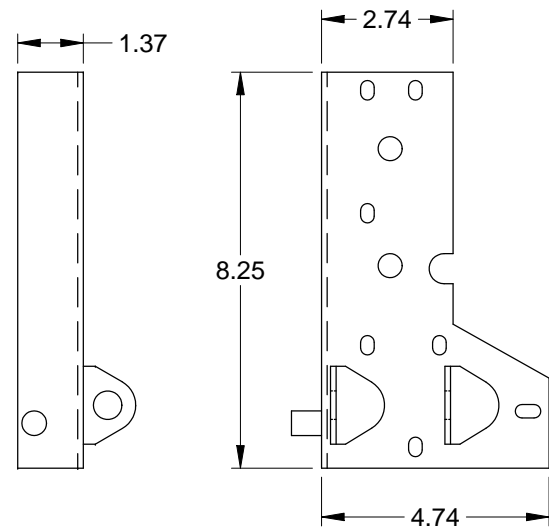

Corner Bracket
(For doors over 600 lbs.)
.116 Galv. Steel

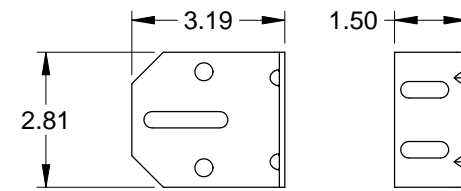

3" Track Bracket
.116 Galv. Steel

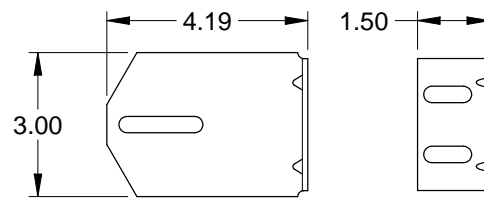

4" Track Bracket
.116 Galv. Steel

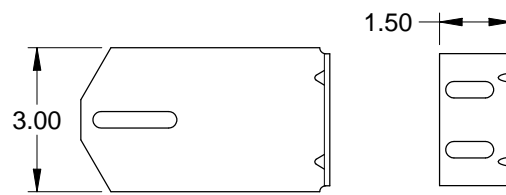

5" Track Bracket
.116 Galv. Steel

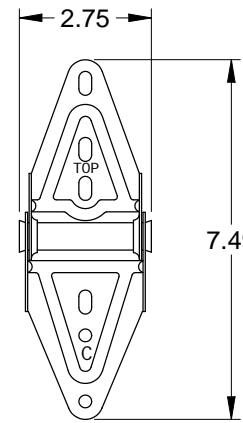

Center Hinge
.045 Galv. Steel

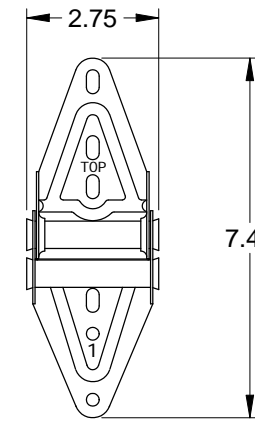

Edge Hinge
.086 Galv. Steel

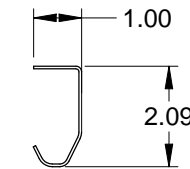

2" Track
.086 Galv. Steel

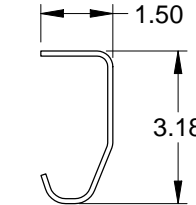

3" Track (Optional)
.105 Galv. Steel

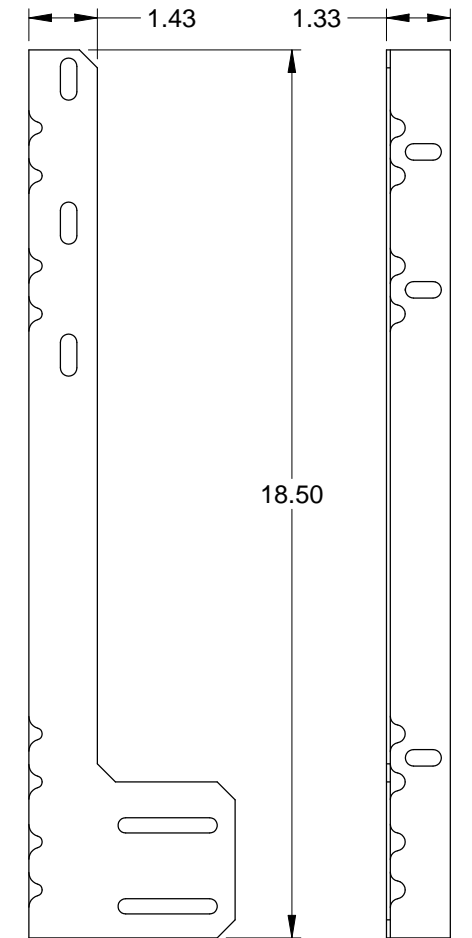

Jamb Angle
.078 Galv. Steel

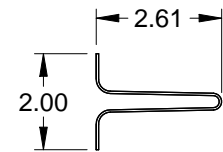

Steel U-bar
18 Ga. (.049 min.) Galvanized
High Tensile Steel
80 KSI Minimum Yield

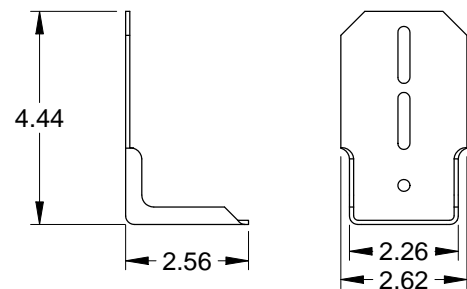

Top Fixture
.086 Galv. Steel

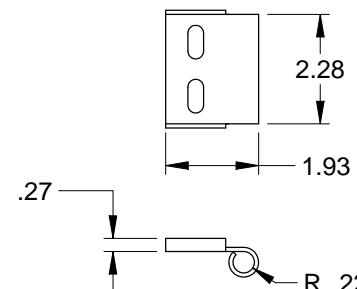

Roller Carrier
.116 Galv. Steel
Attached to Top Fixture
w/(2) Track Bolts and Whiz Nuts

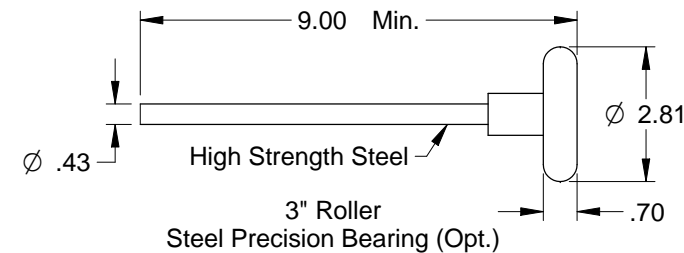

3" Roller
Steel Precision Bearing (Opt.)

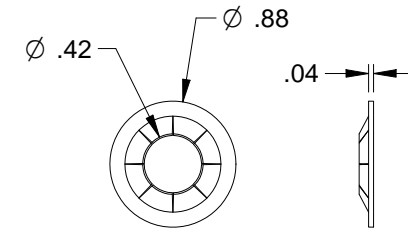
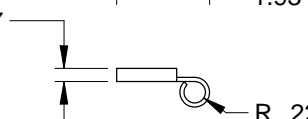

Retaining Nut

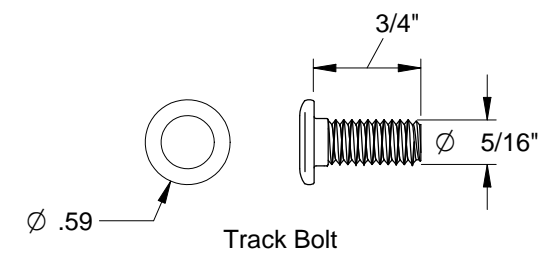

Track Bolt

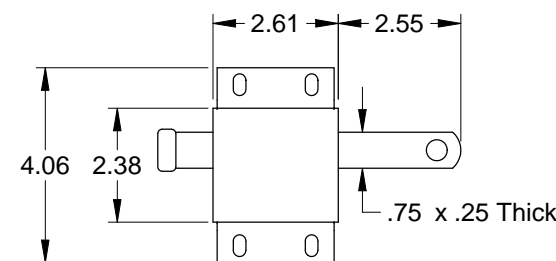

Slide Lock
Case .086 Galv. Steel

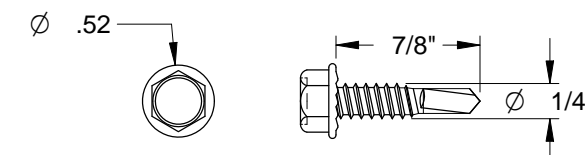

Self-Drilling Screw

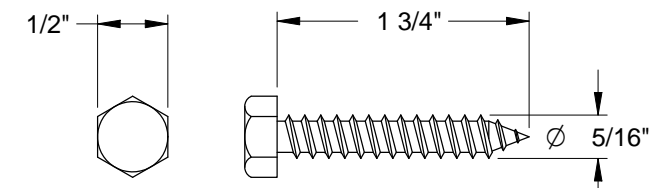

Hex Head Lag Screw

| |
|-------------------------|
| Scale: None |
| Drawn by: R. Frey |
| Checked by: G. Wedekind |
| Date: 02/28/19 |
| ECO: 7679.01 |



1101 East River Road
Dixon, IL 61021

Title: Spec, Wind Load
AlumaView - AV200,
StyleView - CPF, WPF

No. P-2909

Sheet
3

Rev
B

John E. Scates
2560 King Arthur Blvd, Ste 124-54
Lewisville, TX 75056
FL PE #51737
TX PE #56308-12203