

TH160
 Exterior Skin = .013
 Interior Skin = .013

TM175
 Exterior Skin = .017
 Interior Skin = .013

TM200
 Exterior Skin = .013
 Interior Skin = .013

Doors tested per ANSI/DASMA 108 for static air pressure

Maximum Door Width	Ctr Hngs per Sect	Design Loads
8'-2"	1	48.9 -54.8
9'-2"	1	43.6 -48.8
10'-2"	2	39.3 -44.0
12'-2"	2	27.8 -30.8
14'-2"	3	23.9 -26.5
16'-2"	3	20.9 -23.2

John E. Scates
 2560 King Arthur Blvd, Ste 124-54
 Lewisville, TX 75056
 FL PE #51737
 TX PE #56308-12203

Rev.	Description	ECO	Date
B	Removed vent option, annealed & tempered glass on sht 1.	7679.03	12/09/19
A	New release for production.	7679.01	01/29/19

Scale: None
Drawn by: R. Frey
Checked by: G. Wedekind
Date: 01/29/19
ECO: 7679.01



Title: Spec, Wind Load TH160, TM175, TM200	
No. P-2813	Sheet 1 of 3
Rev B	

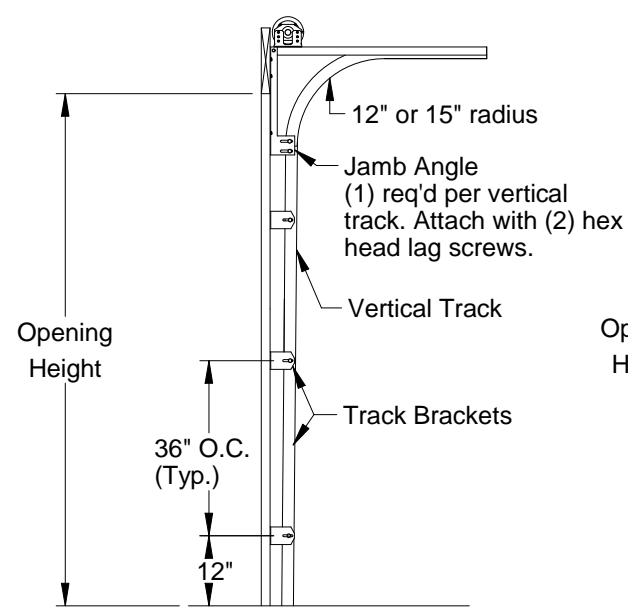

**Typical Track Installation
Bracket Mount
Wood Jamb**

Normal headroom track shown, low headroom, lift clearance and vertical lift track available

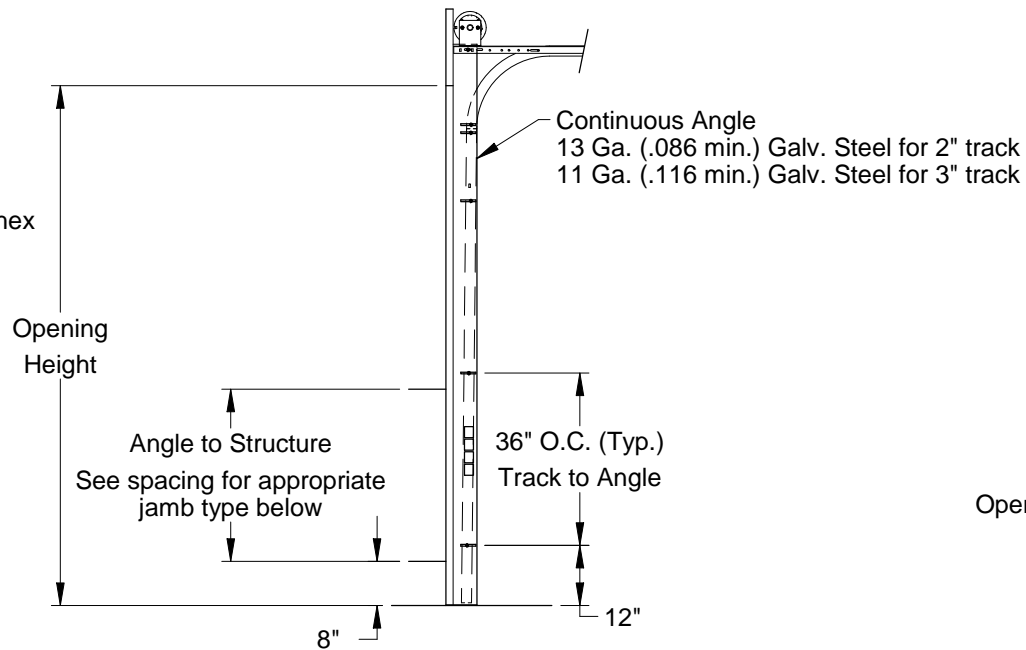

**Typical Track Installation
Angle Mount
Wood, Steel or Concrete Jamb**

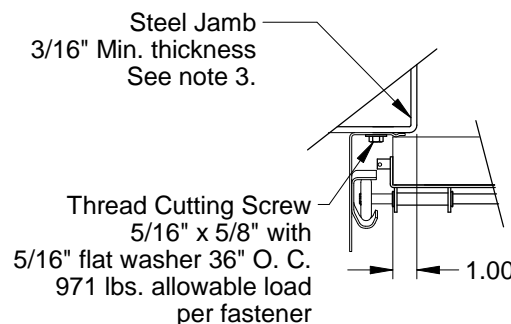
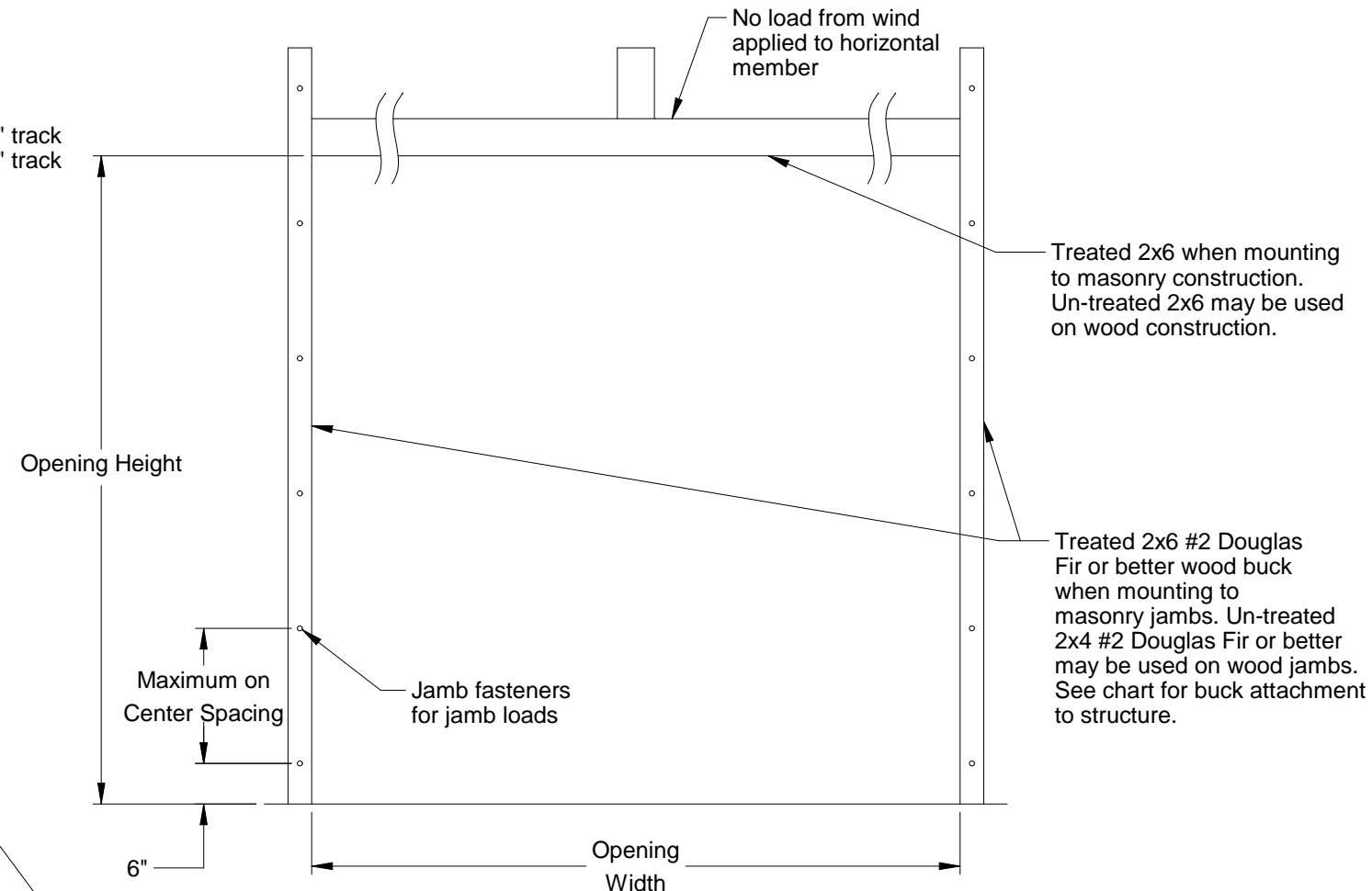

**Track Assembly Attachment
to Steel Jamb**

2" Track Angle Mount Turned-in (shown)
3" Track Angle Mount Available

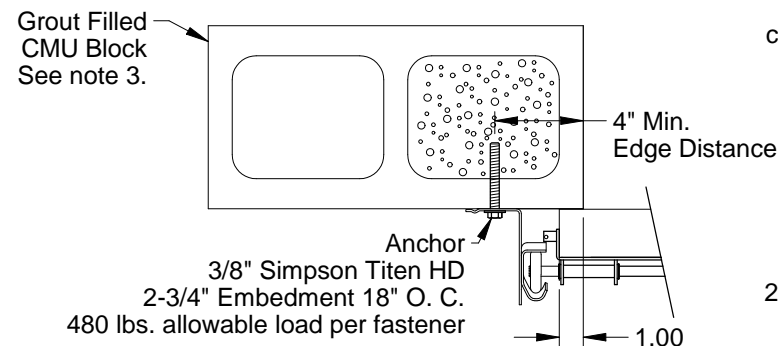

**Track Assembly Attachment
to Grout Filled CMU Block**

2" Track Angle Mount Turned-out (shown)
3" Track Angle Mount Available

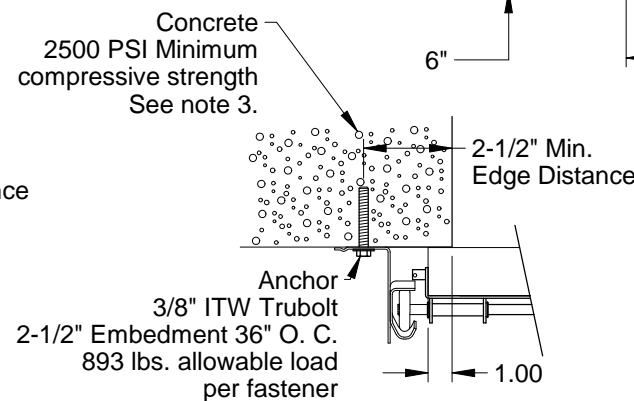

**Track Assembly Attachment
to 2500 PSI Min. Concrete**

2" Track Angle Mount Turned-out (shown)
3" Track Angle Mount Available

Jamb Attachment Notes:

1. Maximum Positive Load per Jamb = (10'-2" x 39.3 PSF) / 2 = 200 lbs. per foot.
2. Maximum Negative Load per Jamb = (10'-2" x -44.0 PSF) / 2 = 224 lbs. per foot.
3. Design of the supporting structure shall be the sole responsibility of the building designer and shall be designed for the jamb loads listed in notes 1 and 2.
4. Alternate jamb attachments may be used if approved by a registered Professional Engineer.
5. DASMA Technical Data Sheet TDS-161 may be used for alternate jamb attachments.
6. 3/8" diameter lag screws required 1/16" pilot hole and 1-1/2" minimum required distance.

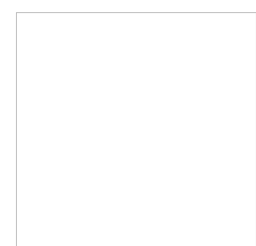

John E. Scates
2560 King Arthur Blvd, Ste 124-54
Lewisville, TX 75056
FL PE #51737
TX PE #56308-f2203

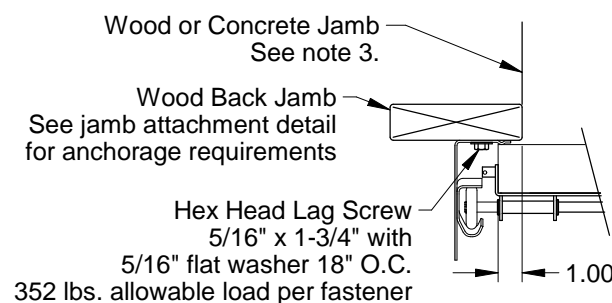

**Track Assembly Attachment
to Wood Back Jamb**

2" Track Angle Mount Turned-in (shown)
3" Track Angle Mount Available

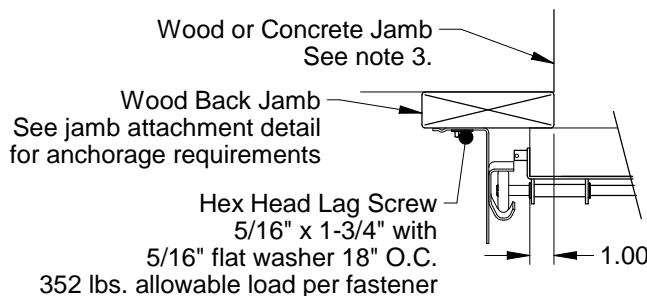

**Track Assembly Attachment
to Wood Back Jamb**

2" Track Angle Mount Turned-out (shown)
3" Track Angle Mount Available

2x6 Attachment to Structure						
Structure Type	Fastener Type	Minimum Embedment	Minimum Edge Distance	Minimum on Center Spacing	Maximum on Center Spacing	Allowable Tension Load
2500 PSI Min. Concrete	1/4" Tapcon+ (Plus) with 1-1/8" OD Washer	2"	2.5	6"	24"	526
Southern Pine	3/8" x 3" Lag with 1-1/8" OD Washer	1.50"	1.50"	1.50"	24"	655
Spruce Pine Fir	3/8" x 3" LAG with 1-1/8" OD Washer	1.50"	1.50"	1.50"	24"	482

Scale: None
Drawn by: R. Frey
Checked by: G. Wedekind
Date: 01/29/19
ECO: 7679.01



1101 East River Road
Dixon, IL 61021

Title: Spec, Wind Load TH160, TM175, TM200		
No. P-2813	Sheet 2	Rev B

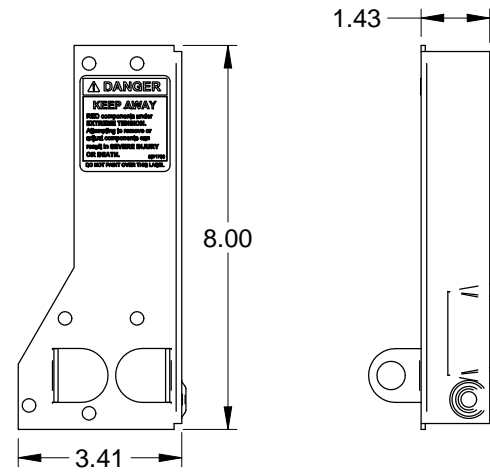

Corner Bracket
.086 Galv. Steel

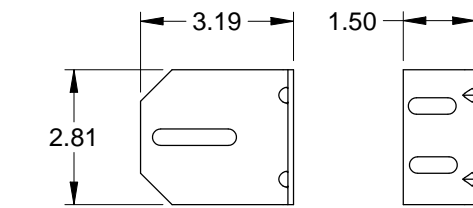

3" Track Bracket
.116 Galv. Steel

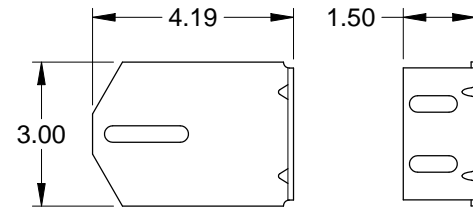

4" Track Bracket
.116 Galv. Steel

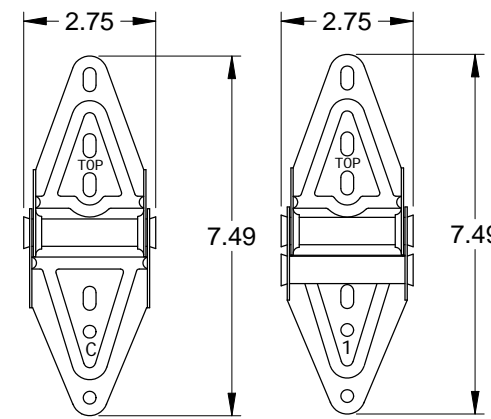

Center Hinge
.045 Galv. Steel

Edge Hinge
.086 Galv. Steel

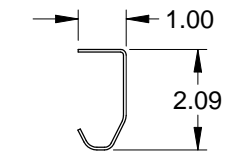

2" Track
.055 Galv. Steel

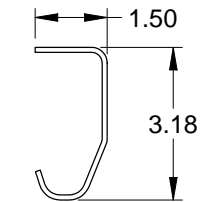

3" Track (Optional)
.105 Galv. Steel

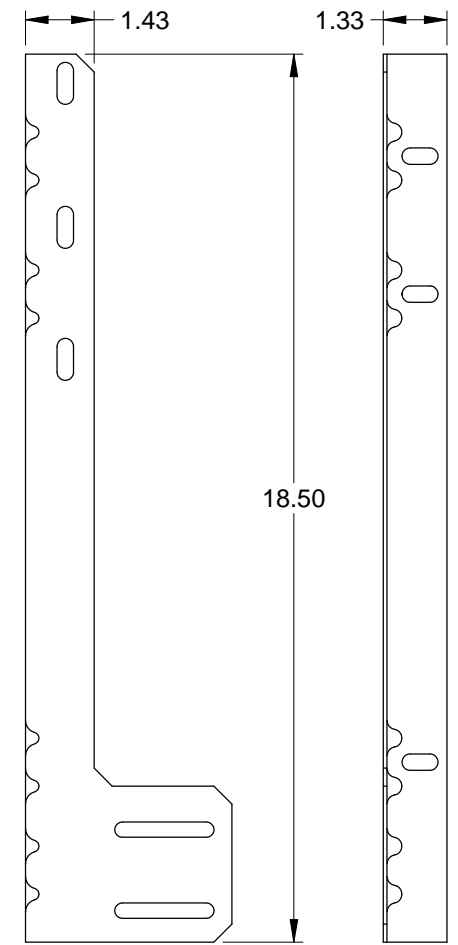

Jamb Angle
.078 Galv. Steel

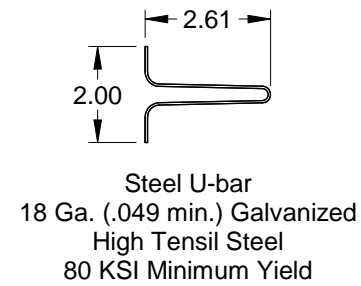

Steel U-bar
18 Ga. (.049 min.) Galvanized
High Tensil Steel
80 KSI Minimum Yield

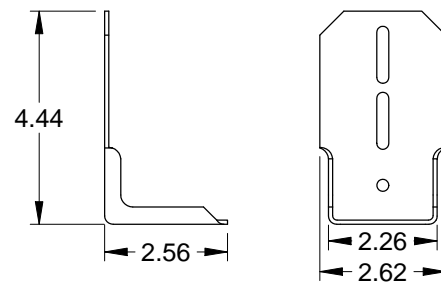

Top Fixture
.086 Galv. Steel

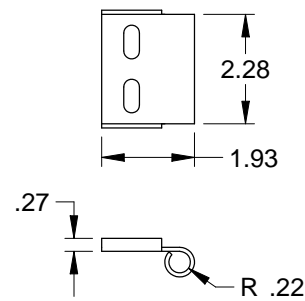

Roller Carrier
.086 Galv. Steel
Attached to Top Fixture
w/(2) Track Bolts and Whiz Nuts

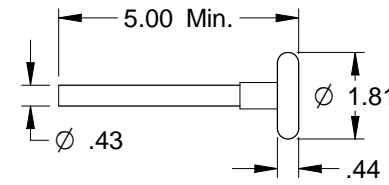

2" Roller
Nylon 11-ball (Std.)
Steel 10-ball (Opt.)

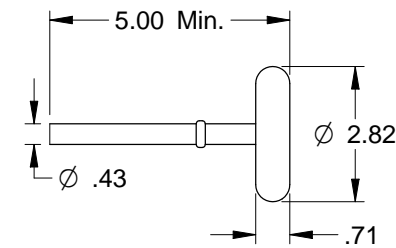

3" Roller
Steel 10-ball (Opt.)

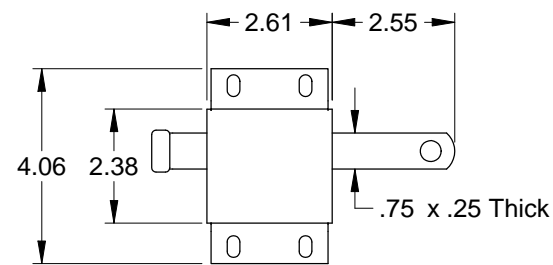

Slide Lock
Case .086 Galv. Steel

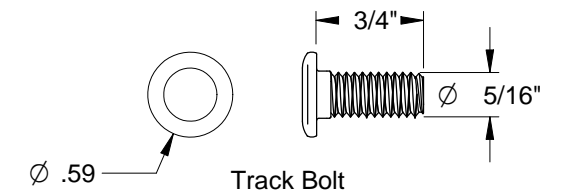

Track Bolt

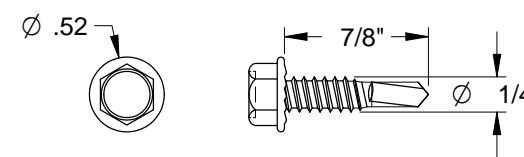

Self-Drilling Screw

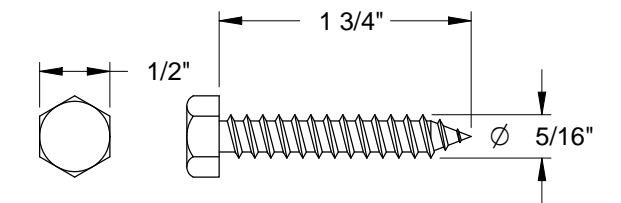

Hex Head Lag Screw

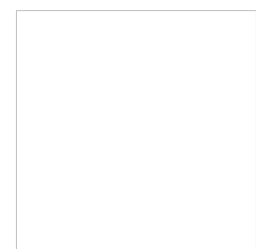

John E. Scates
2560 King Arthur Blvd, Ste 124-54
Lewisville, TX 75056
FL PE #51737
TX PE #56308-f2203

Scale: None	<p>1101 East River Road Dixon, IL 61021</p>	Title: Spec, Wind Load TH160, TM175, TM200	
Drawn by: R. Frey		No. P-2813	Sheet 3
Checked by: G. Wedekind			Rev B
Date: 01/29/19		ECO: 7679.01	