

Door Height  
7'-0" High shown  
Other door heights available up to 16'-0" using 18" or 21" high sections

Windows (Optional)  
See options on sht. 2  
One row maximum

Steel Reinforcement  
(1) Box strut per section,  
(2) U-bar on top section fastened to all center and end stiles using (2) sheet metal screws at each stile.

Locks required on doors not electrically operated.

Door Width  
See chart for other door widths (16'-0" shown)  
Interior Elevation

Doors tested per ANSI/DASMA 108 for static air pressure

Maximum Door Width	Colonial				Ranch				Carriage House			
	Stiles per Sect.	Hinges per Sect.	Design Loads		Stiles per Sect.	Hinges per Sect.	Design Loads		Stiles per Sect.	Hinges per Sect.	Design Loads	
8'-0"	1	1	31.1	-37.3	1	1	31.1	-37.3	1	1	31.1	-37.3
9'-0"	1	1			1	1			1	1		
10'-0"	2	2	26.6	-32.0	1	1	26.6	-32.0	1	1	26.6	-32.0
12'-0"	3	3			2	2			2	2		
14'-0"	4	4	23.3	-28.0	2	2	23.3	-28.0	2	2	23.3	-28.0
16'-0"	3	3			3	3			3	3		

John E. Scates  
2560 King Arthur Blvd, Ste 124-54  
Lewisville, TX 75056  
FL PE #51737  
TX PE #56308-f2203

Rev.	Description	ECO	Date
B	Removed vent option on sheet 1.	7679.02	12/09/19
A	New release for production.	7679.01	01/07/19

Scale: None
Drawn by: R. Frey
Checked by: G. Wedekind
Date: 01/07/19
ECO: 7679.01



Title: Spec, Wind Load BuildMark / TradeMark	
No. P-2806	Sheet 1 of 3
Rev B	

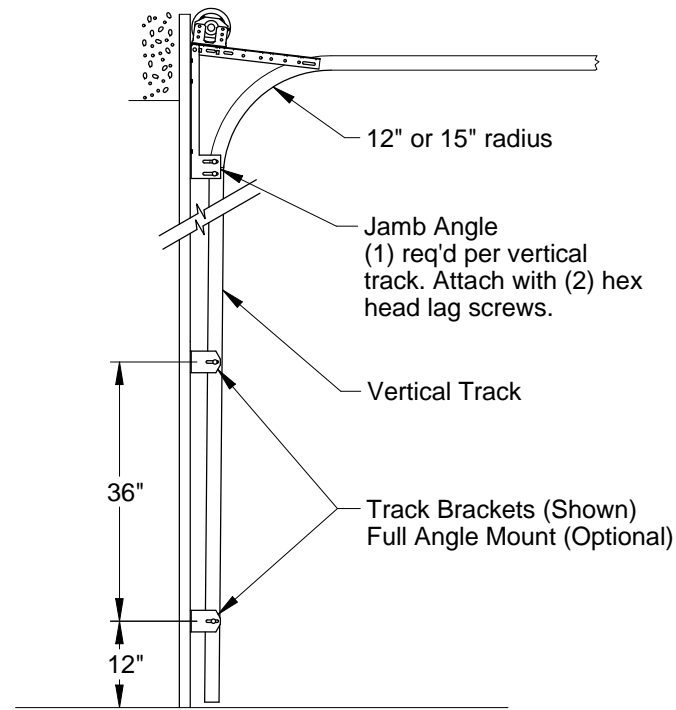

**Typical Track Installation**  
Normal headroom track shown, low headroom, lift clearance and vertical lift track available

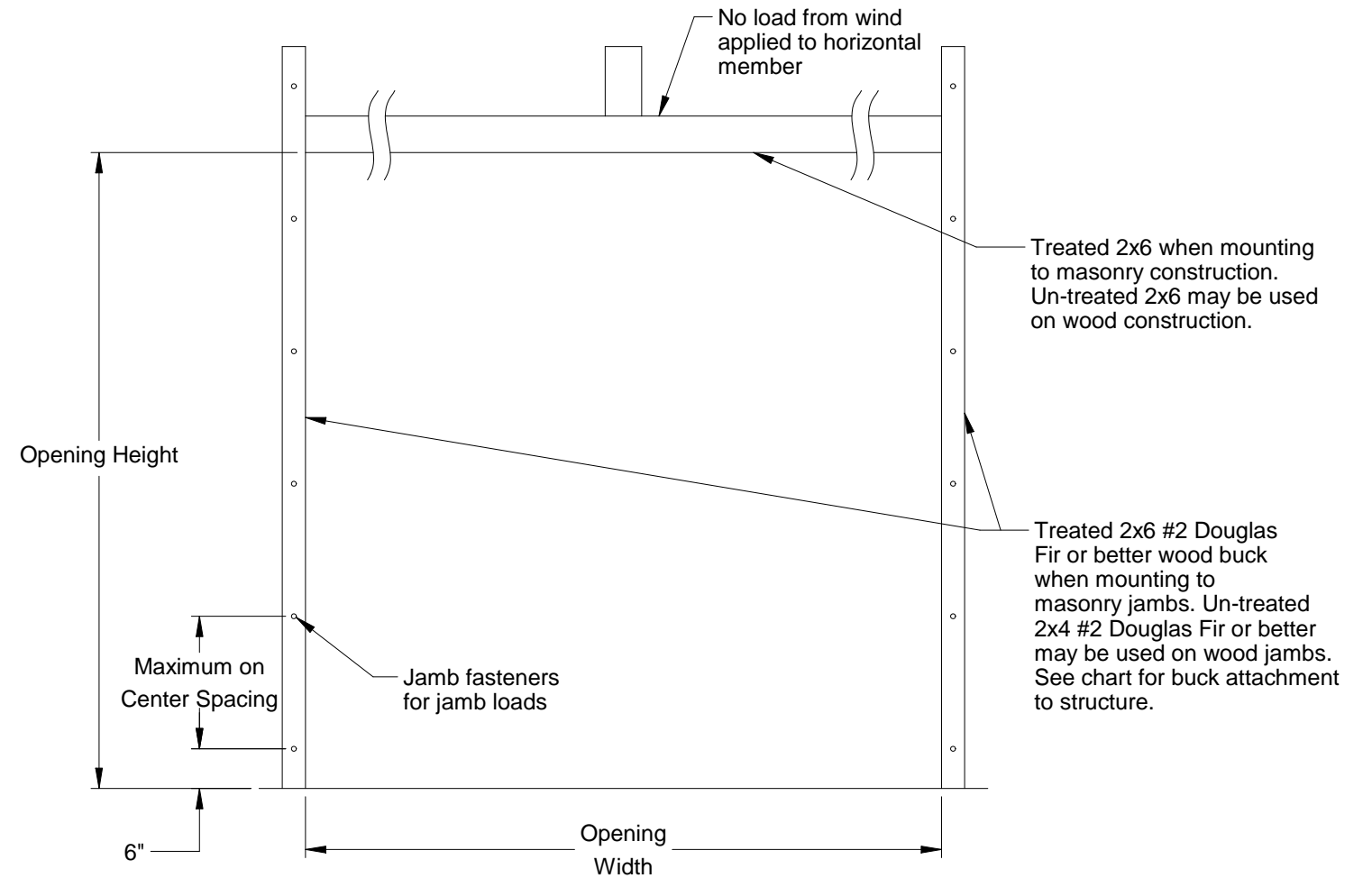

**Jamb Attachment Notes:**

1. Maximum Positive Load per Jamb = (16'-0" x 23.3 PSF) / 2 = 187 lbs. per foot.
2. Maximum Negative Load per Jamb = (16'-0" x -28.0 PSF) / 2 = 224 lbs. per foot.
3. Design of the supporting structure shall be the sole responsibility of the building designer and shall be designed for the jamb loads listed in notes 1 and 2.
4. Alternate jamb attachments may be used if approved by a registered Professional Engineer.
5. DASMA Technical Data Sheet TDS-161 may be used for alternate jamb attachments.
6. 3/8" diameter lag screws required 1/16" pilot hole and 1-1/2" minimum required distance.

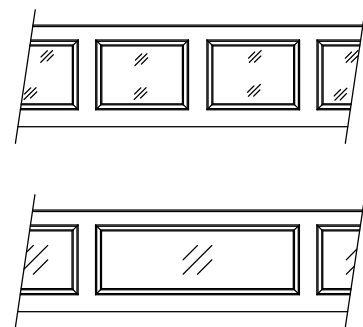

Colonial windows  
1/8" DSB - Clear, Obscure, Satin  
1/8" Tempered - Clear, Obscure, Satin

Ranch windows  
1/8" DSB - Clear, Obscure, Satin  
1/8" Tempered - Clear, Obscure, Satin

**Window Options**

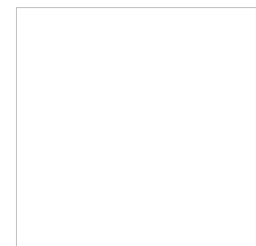

John E. Scates  
2560 King Arthur Blvd, Ste 124-54  
Lewisville, TX 75056  
FL PE #51737  
TX PE #56308-f2203

Professional Engineer's seal provided only for verification of wind load construction details

2x6 Attachment to Structure						
Structure Type	Fastener Type	Minimum Embedment	Minimum Edge Distance	Minimum on Center Spacing	Maximum on Center Spacing	Allowable Tension Load
2500 PSI Min. Concrete	1/4" Tapcon+ (Plus) with 1-1/8" OD Washer	2"	2.5	6"	24"	526
Southern Pine	3/8" x 3" Lag with 1-1/8" OD Washer	1.50"	1.50"	1.50"	24"	655
Spruce Pine Fir	3/8" x 3" LAG with 1-1/8" OD Washer	1.50"	1.50"	1.50"	24"	482

Scale: None
Drawn by: R. Frey
Checked by: G. Wedekind
Date: 01/07/19
ECO: 7679.01



1101 East River Road  
Dixon, IL 61021

Title: Spec, Wind Load  
BuildMark / TradeMark

No. P-2806

Sheet 2

Rev B

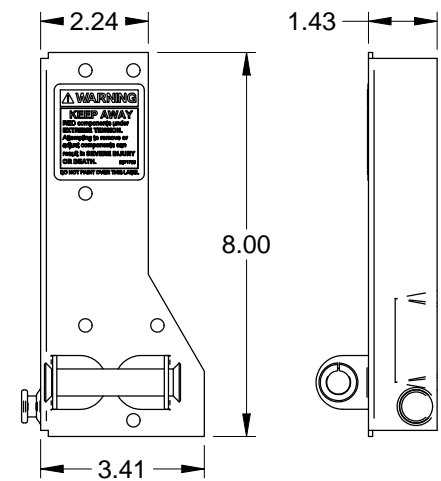

Corner Bracket  
.086 Galv. Steel

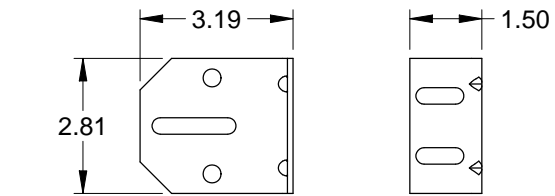

3" Track Bracket  
.116 Galv. Steel

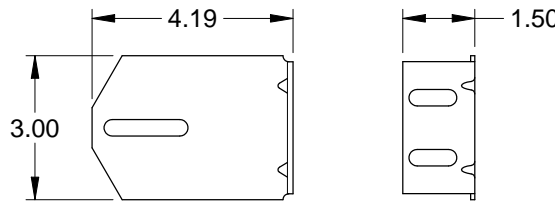

4" Track Bracket  
.116 Galv. Steel

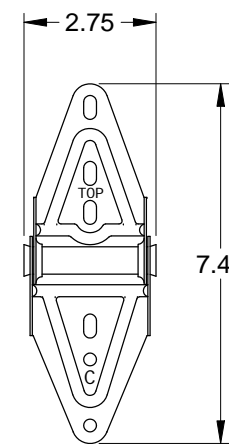

Center Hinge  
.070 Galv. Steel

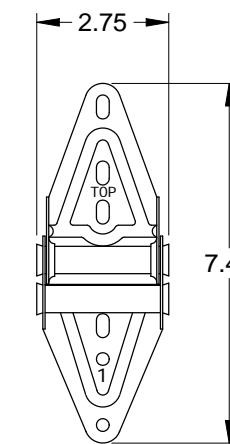

Edge Hinge  
.086 Galv. Steel

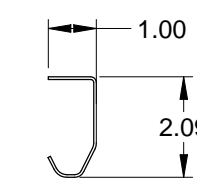

2" Track  
.055 Galv. Steel

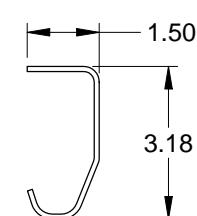

3" Track (Optional)  
.105 Galv. Steel

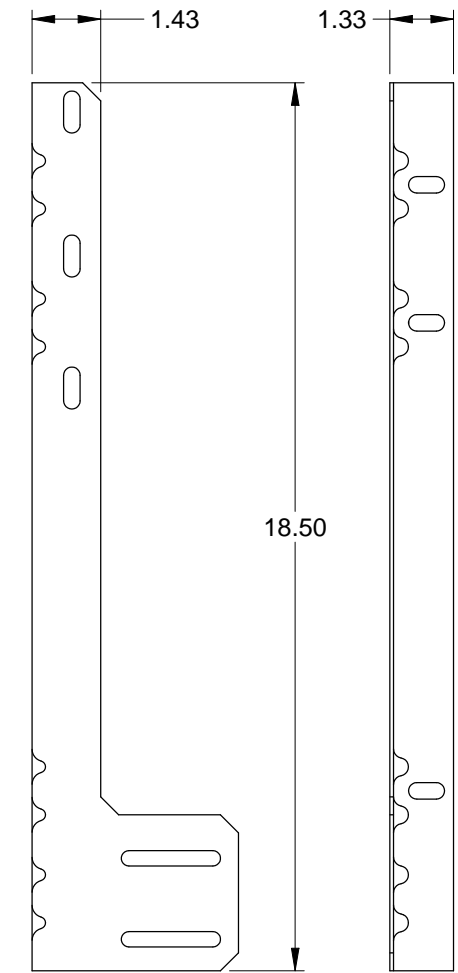

Jamb Angle  
.078 Galv. Steel

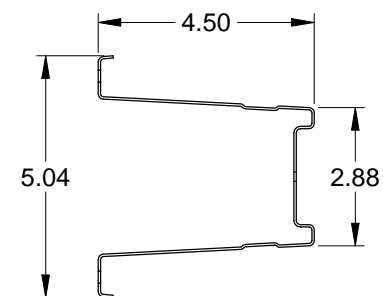

Steel Box Strut  
20 Ga. (.035" Min.) Galvanized  
High Tensile Steel  
80 KSI Minimum Yield

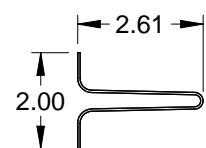

Steel U-bar  
18 Ga. (.049" Min.) Galvanized  
High Tensile Steel  
80 KSI Minimum Yield

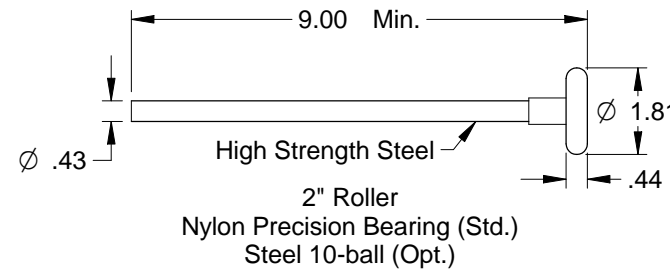

2" Roller  
Nylon Precision Bearing (Std.)  
Steel 10-ball (Opt.)

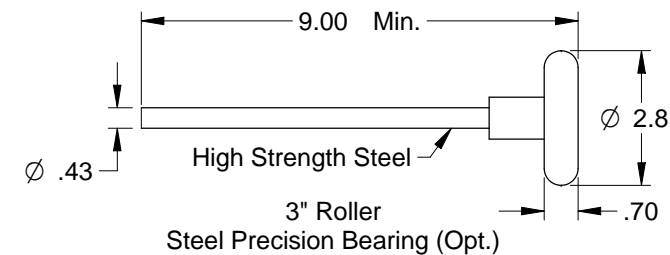

3" Roller  
Steel Precision Bearing (Opt.)

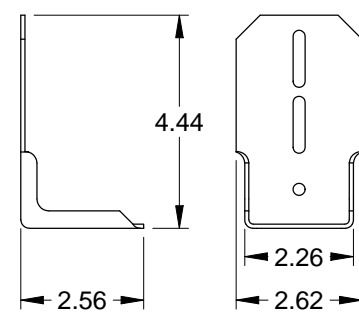

Top Fixture  
.086 Galv. Steel

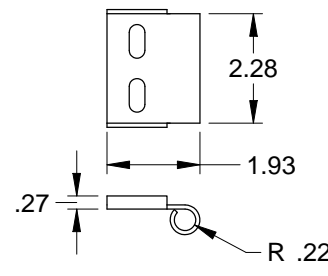

Roller Carrier  
.086 Galv. Steel  
Attached to Top Fixture  
w/(2) Track Bolts and Whiz Nuts

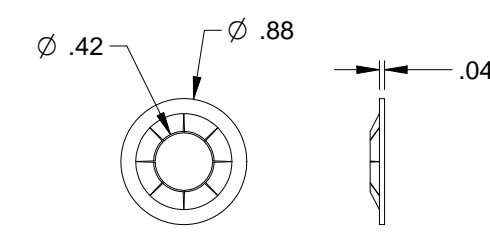

Retaining Nut

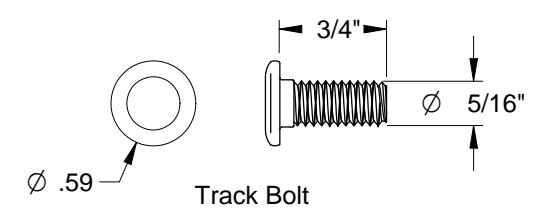

Track Bolt

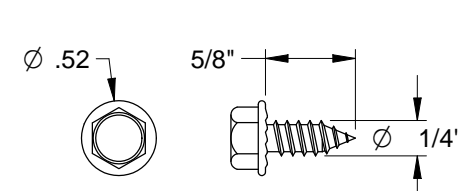

Sheet Metal Screw

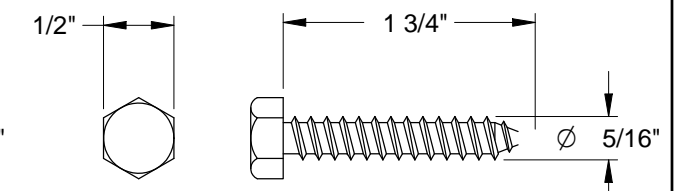

Hex Head Lag Screw

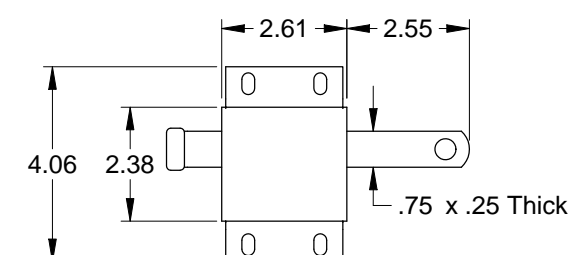

Slide Lock  
Case .086 Galv. Steel



John E. Scates  
2560 King Arthur Blvd, Ste 124-54  
Lewisville, TX 75056  
FL PE #51737  
TX PE #56308-f2203

Scale: None
Drawn by: R. Frey
Checked by: G. Wedekind
Date: 01/07/19
ECO: 7679.01



1101 East River Road  
Dixon, IL 61021

Title: Spec, Wind Load BuildMark / TradeMark		
No. P-2806	Sheet 3	Rev B