

CLOPAY MODEL 3200 (24 GA MIN EXT SKIN)
 CLOPAY MODEL 3220 (20 GA MIN EXT SKIN)
 HOLMES MODEL 240/240G (24 GA MIN EXT SKIN)
 MAX 16'-2" WIDE X 18'-0" HIGH

DOOR HEIGHT 'A'	NUMBER OF SECTIONS
UP TO 8'-0"	4
8'-3" THRU 10'-0"	5
10'-3" THRU 12'-0"	6
12'-3" THRU 14'-0"	7
14'-3" THRU 16'-0"	8
16'-3" THRU 18'-0"	9

MAX. SECTION HEIGHT: 24"

THE OPTIONAL GLAZING SHOWN ON THIS DRAWING MEETS THE WIND LOAD REQUIREMENTS OF THE FLORIDA BUILDING CODE OR INTERNATIONAL BUILDING CODE BUT DOES NOT MEET THE IMPACT RESISTANT REQUIREMENT FOR WINDBORNE DEBRIS REGIONS (REF. CHAPTER 16 FBC/IBC)

NOTE: THE DESIGN OF THE SUPPORTING STRUCTURAL ELEMENTS ARE THE RESPONSIBILITY OF THE PROFESSIONAL OF RECORD FOR THE BUILDING OR STRUCTURE AND IN ACCORDANCE WITH CURRENT BUILDING CODES FOR THE LOADS LISTED ON THIS DRAWING.

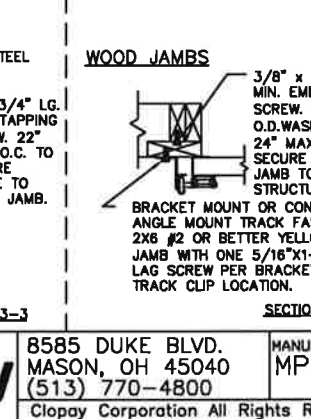
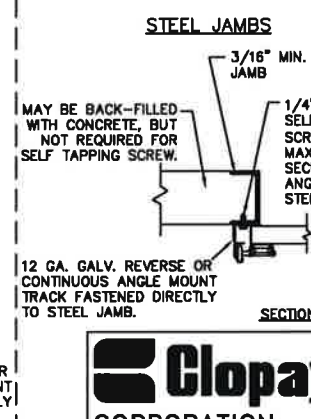
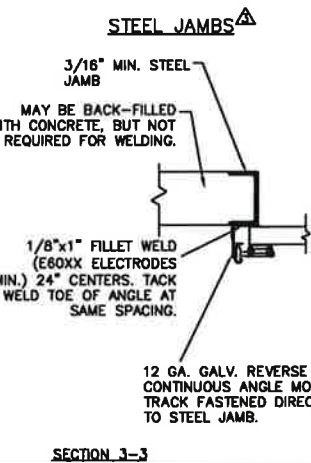
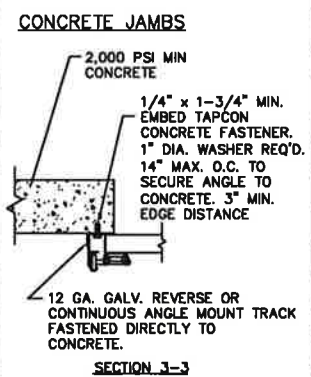
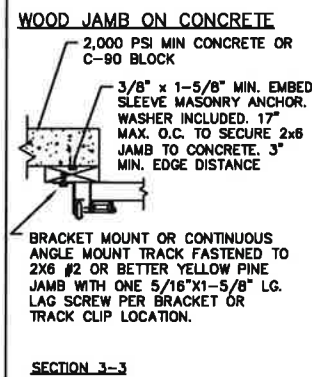
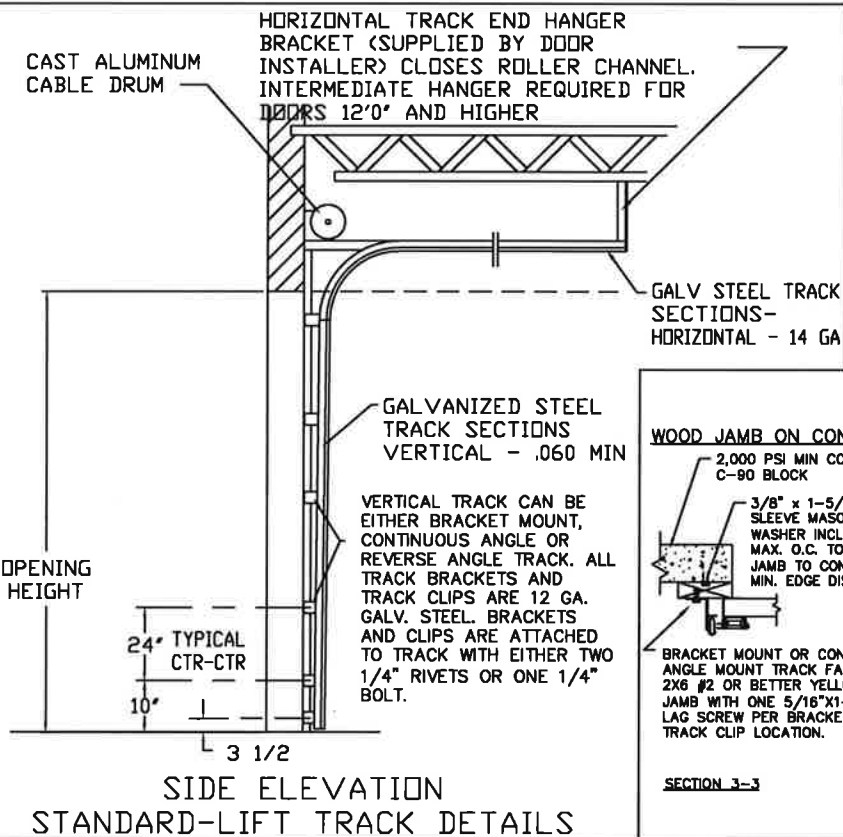

8585 DUKE BLVD.
 MASON, OH 45040
 (513) 770-4800
 Clipay Corporation All Rights Reserved.

MANUFACTURING PRODUCT CODE:
 MPC: C-DSIE-1F447
 DATE: 3-27-92
 DRAWN BY: LEG

WINDLOAD RATING: W5
 DESCRIPTION: WIND LOAD 3200, 3220
 DRAWING NUMBER: 200040

DESIGN LOADS: +30.0 PSF, -32.0 PSF
 TEST LOADS: +45.0 PSF, -48.0 PSF

DESIGN ENGINEER: MARK W. WESTERFIELD, P.E.
 FLORIDA P.E. #48495, NC P.E. #23832, TEXAS P.E. #91513

Mark W. Westerfield
 5/31/22

REGISTERED PROFESSIONAL ENGINEER
 STATE OF TEXAS
 91513

REV	DATE	DESCRIPTION
4	9/97	MOVED 12'-2" W DOORS TO DWG #101687
05	3/2000	ADDED FULL VISION NOTE; REVISE JAMB NOTE
06	3/2000	ADD TRACK OPTIONS NOTE
07	8/24/00	ADD PUSHNUTS; OLD DESIGN LOADS +/-30 PSF
8	10/2003	UPDATED TRACK AND JAMB ATTACHMENT INFO
9	05/2005	UPDATED CODE REF., SPECIFIED OPT. ACRYLIC
10	09/2005	ADDED M/N 240 (WAS ON D/N 102079)
11	10/2005	ADDED ROLLER OPTION
12	11/2008	UPDATED JAMB ATTACH.; ADDED MPC, 240G
13	02/2012	UPDATED WINDCODE CHART
14	08/2012	REVISED FOR TD1
15	06/2013	REMOVED ACRYLIC/WIRE GLAZING; SPEC. FV DIM
16	08/2016	REMOVED WIND SPEED TABLE.
17	02/2022	REVISED FOR TD1

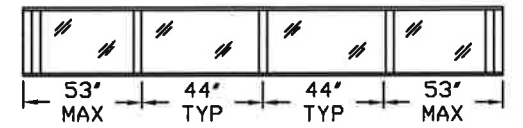
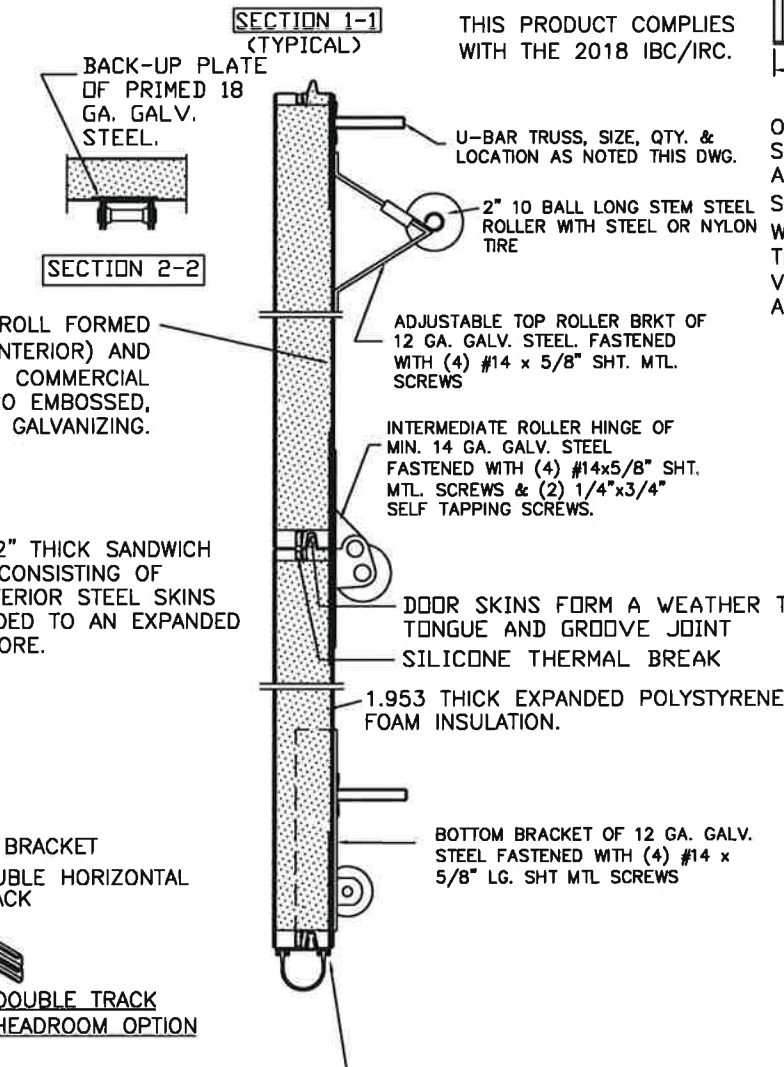

OPTIONAL ALUMINUM FULL VISION WINDOW LITE SECTIONS AVAILABLE, SINGLE PANE OR INSULATED. ALL PANES ANNEALED GLASS OR STRONGER. SINGLE PANES 1/2" OR THICKER. INSULATED WINDOWS 1/2" THICK, CONSISTING OF (2) PANES 1/2" THICK. MAXIMUM DLO: 50" X 21-3/4". FULL VISION SECTIONS TO HAVE SAME REINFORCEMENT AS OTHER SECTIONS.

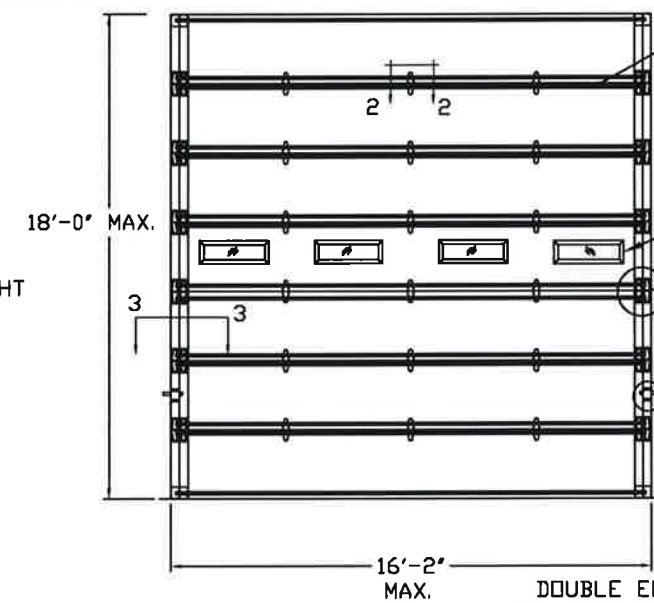

3" X 20 GA. STEEL U-BAR TRUSS. (2) PER SECTION, (1) AT TOP, (1) AT BOTTOM. INSTALLED WITH #14 x 3/4" LG. SELF TAPPING SHT. MTL. SCREWS.

OPTIONAL SINGLE PANE OR INSULATED WINDOW LITES. ALL PANES ANNEALED GLASS OR STRONGER. SINGLE PANES 1/2" OR THICKER. INSULATED WINDOWS 1/2" THICK, CONSISTING OF (2) PANES 1/2" THICK. FRAMES SECURED WITH (10) PUSHITTE PAN #8-16 X 2" PHILLIPS HEAD SCREWS. (3) ON EACH HORIZONTAL EDGE, (2) ON EACH VERTICAL EDGE. MAXIMUM DLO: 21-3/8" X 5-1/2".

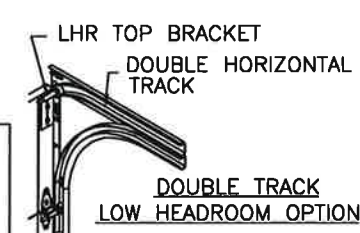

NOTE: DOUBLE TRACK LOW HEADROOM, HI-LIFT TRACK, FOLLOW-THE-ROOF TRACK, AND VERTICAL LIFT TRACK ARE AVAILABLE OPTIONS. 3" TRACK ALSO AVAILABLE.

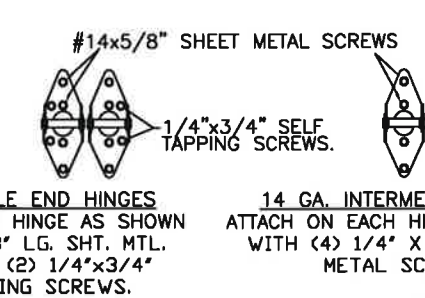

ORIGINAL DRAWINGS ARE SIGNED IN BLUE INK WITH A RAISED SEAL (EMBOSS).

DESIGN ENGINEER: MARK W. WESTERFIELD, P.E.
 FLORIDA P.E. #48495, NC P.E. #23832, TEXAS P.E. #91513