

Professional Engineer Seal for Lyndon F. Schmidt, P.E., License No. 104123, State of Texas. Signature: *LFS*, Date: *7.18*.

Documents Prepared By: Lyndon F. Schmidt, P.E. TEXAS P.E. #104123

R.W. BUILDING CONSULTANTS, INC.
P.O. Box 230 Valrico FL, 33595
Phone No.: 813.659.9197

CERTIFICATE OF REGISTRATION # F-11852

1
2 **HORIZONTAL CROSS SECTION**

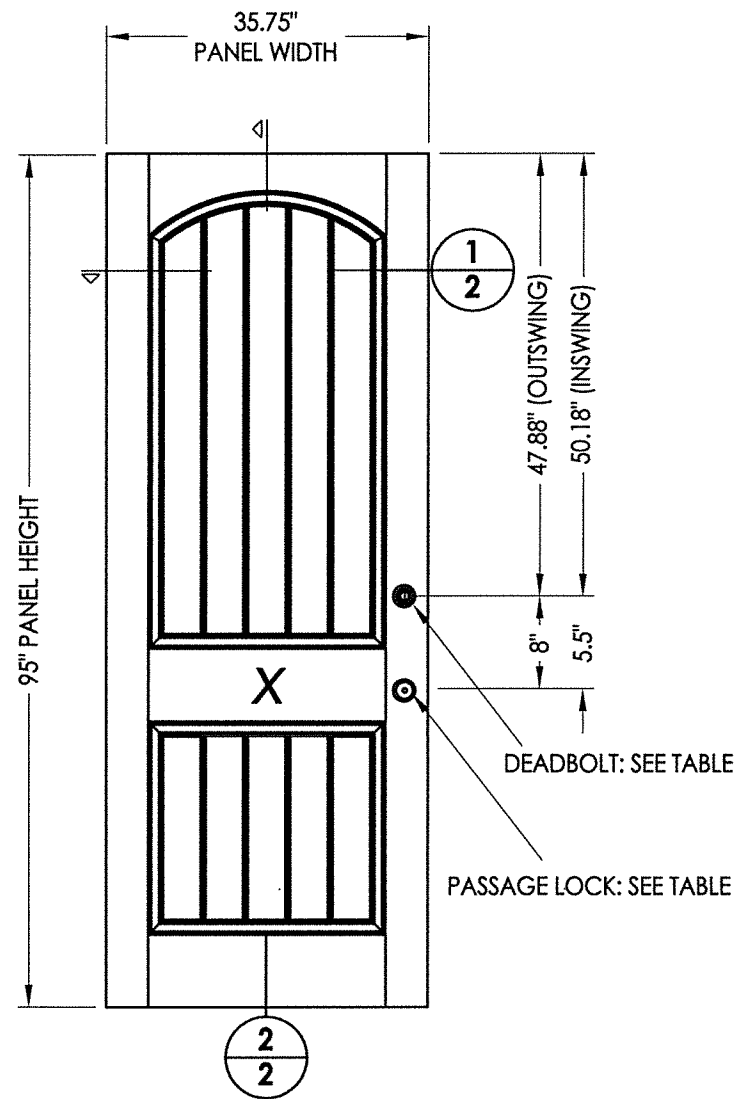

40 **DOOR PANEL**
Taylor Door
w/ Mastergrain Fiberglass skins

HARDWARE TABLE			
MANUFACTURER	MODEL		MAX. DESIGN PRESSURE
KWIKSET	KNOB:	KWIKSET SIGNATURE SERIES	70 PSF
	DEADBOLT:	KWIKSET SIGNATURE SERIES (980)	
SCHLAGE	KNOB/LEVER:	"F" SERIES	65 PSF
	DEADBOLT:	B60/62	

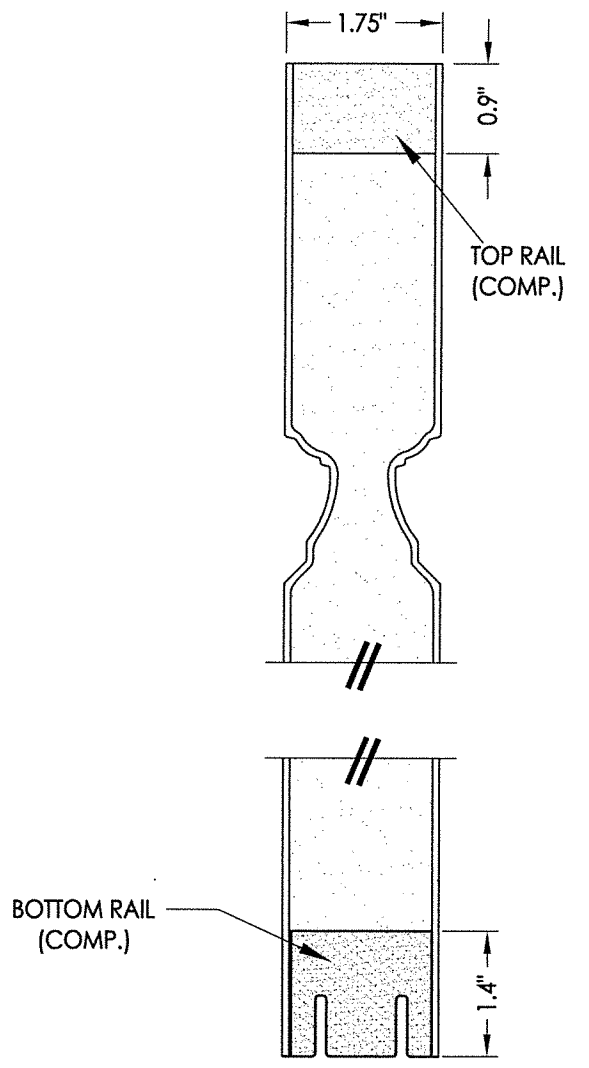

2
2 **VERTICAL CROSS SECTION**

FIBERGLASS DOOR SKIN: MIN. 0.090" THK.)
CORE MATERIAL: POLYURETHANE FOAM (1.9 PCF MIN.)

PRODUCT:	SUNRISE FIBERGLASS DOOR
PART OR ASSEMBLY:	DOOR PANEL DETAILS
DATE:	3/28/18
SCALE:	N.T.S.
DWG. BY:	JK
CHK. BY:	LFS
DRAWING NO.:	TX-4802
SHEET	2 OF 8

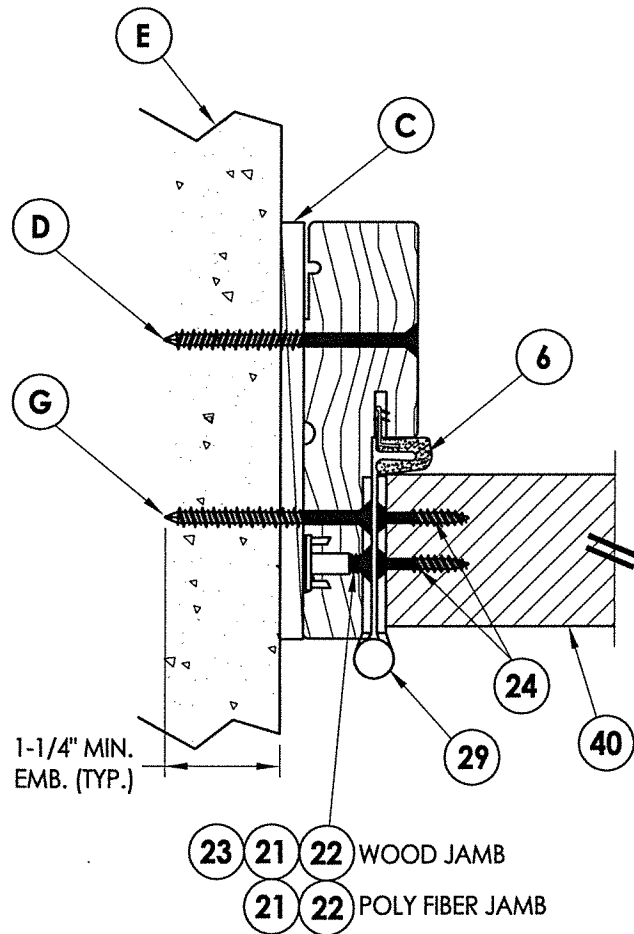

1 **HORIZONTAL CROSS SECTION**
5 Shown Direct to Masonry
 Outswing shown (Inswing similar)

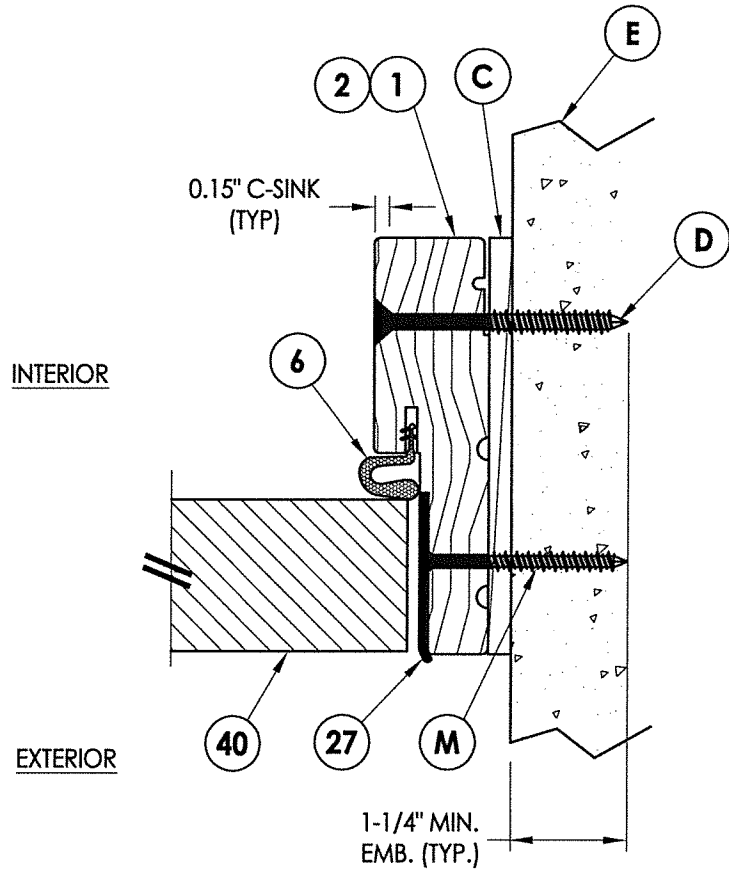

2 **HORIZONTAL CROSS SECTION**
5 Shown Direct to Masonry
 Outswing shown (Inswing similar)

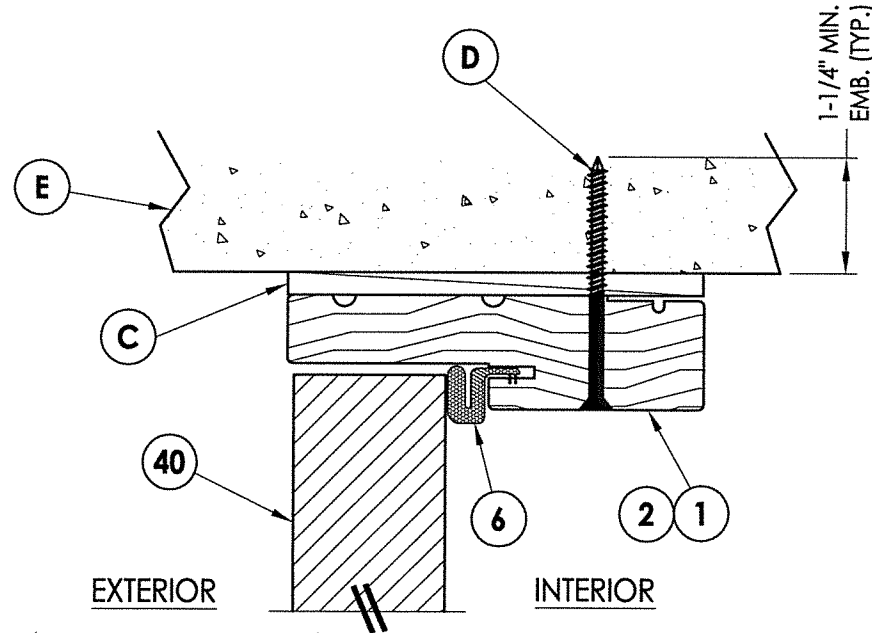

3 **VERTICAL CROSS SECTION**
5 Shown Direct to Masonry
 Outswing shown (Inswing similar)

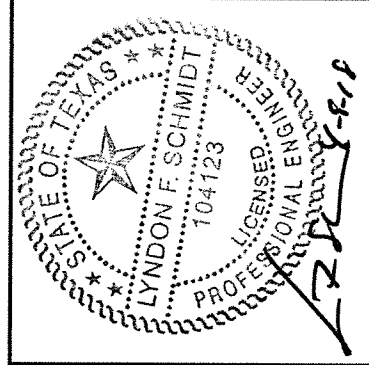

Documents Prepared By: Lyndon F. Schmidt, P.E.
 TEXAS P.E. #104123

RW BUILDING CONSULTANTS, INC.
 P.O. Box 230 Valrico FL. 33595
 Phone No.: 813.659.9197

CERTIFICATE OF REGISTRATION # F-11852

PRODUCT: SUNRISE
 FIBERGLASS DOOR
 PART OR ASSEMBLY:
 HORIZONTAL & VERTICAL CROSS
 SECTIONS (DIRECT TO MASONRY)

NO.	DATE	BY	REVISIONS

DATE: 3/28/18

SCALE: N.T.S.

DWG. BY: JK

CHK. BY: LFS

DRAWING NO.:

TX-4802

SHEET 5 OF 8

R:\Clients\Sunrise Windows\B - Texas Dept of Ins\YDI - XXX Fiberglass Door - Opaque, Impact (Tru-Grain Composite)\Drawings\TX-4802.dwg, 6

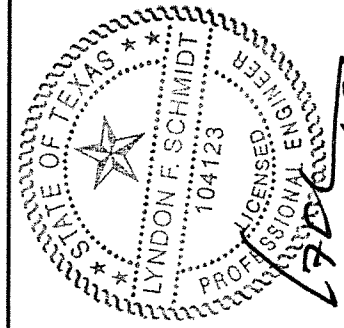

Documents Prepared By: Lyndon F. Schmidt, P.E.
TEXAS P.E. #104123

RW BUILDING CONSULTANTS, INC.
P.O. Box 230 Vairico FL 33595
Phone No.: 813.659.9197

CERTIFICATE OF REGISTRATION # F-11852

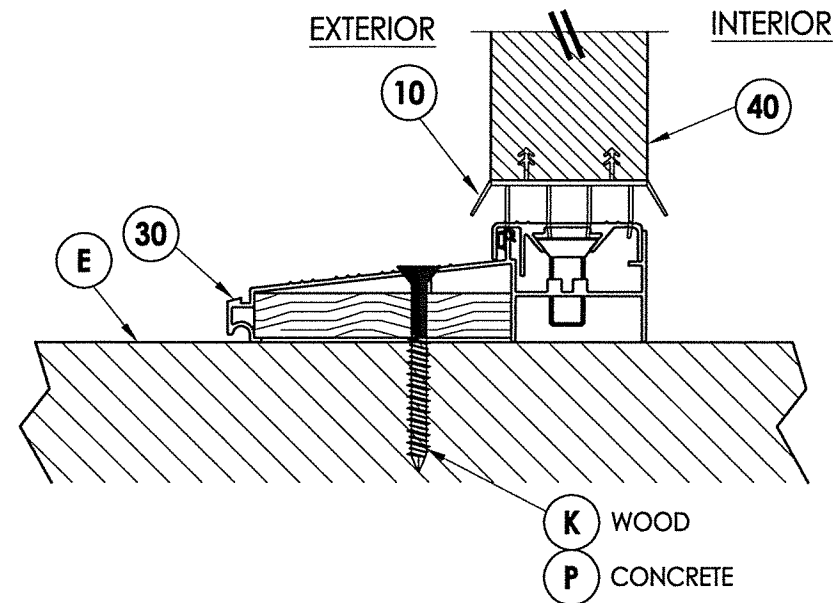

1 VERTICAL CROSS SECTION
6 Inswing configuration

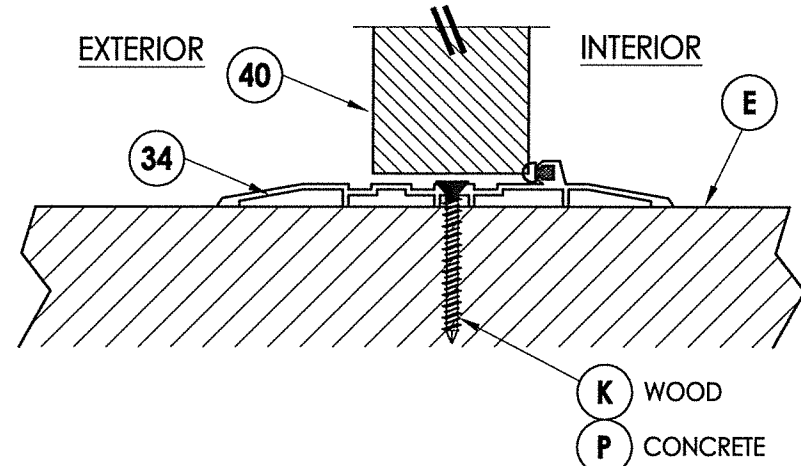

2 VERTICAL CROSS SECTION
6 Outswing configuration

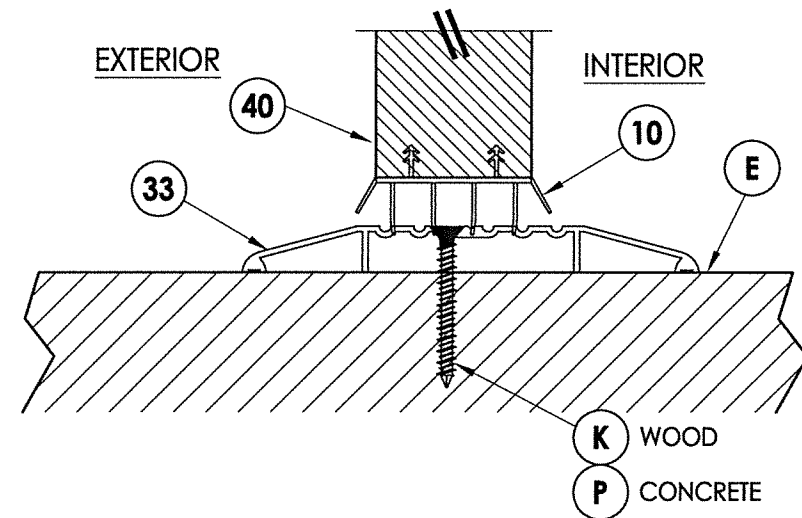

5 VERTICAL CROSS SECTION
6 Inswing configuration

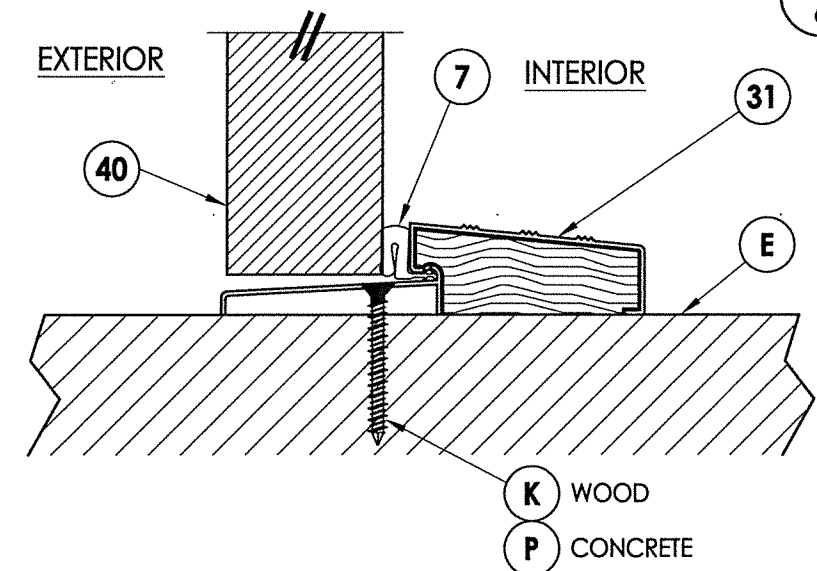

3 VERTICAL CROSS SECTION
6 Outswing configuration

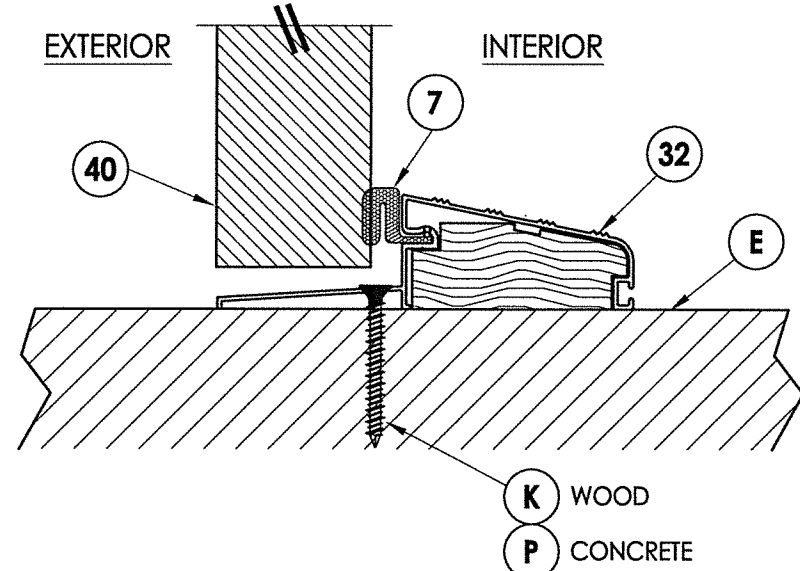

4 VERTICAL CROSS SECTION
6 Outswing configuration

PRODUCT: SUNRISE FIBERGLASS DOOR
PART OR ASSEMBLY: VERTICAL CROSS SECTIONS (THRESHOLDS)

NO.	DATE	BY	REVISIONS

DATE: 3/28/18
SCALE: N.T.S.
DWG. BY: JK
CHK. BY: LFS
DRAWING NO.: TX-4802
SHEET 6 OF 8

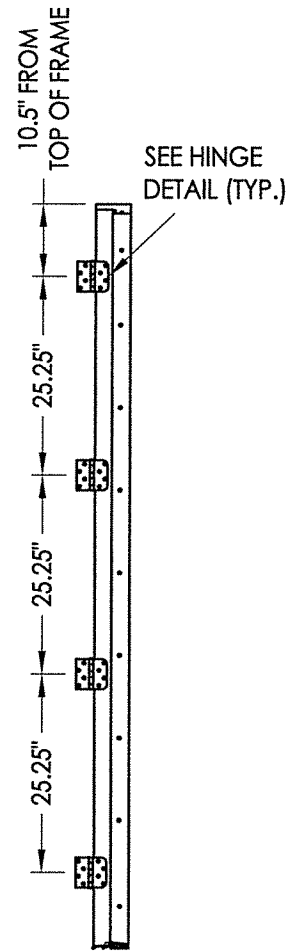

HINGE JAMB

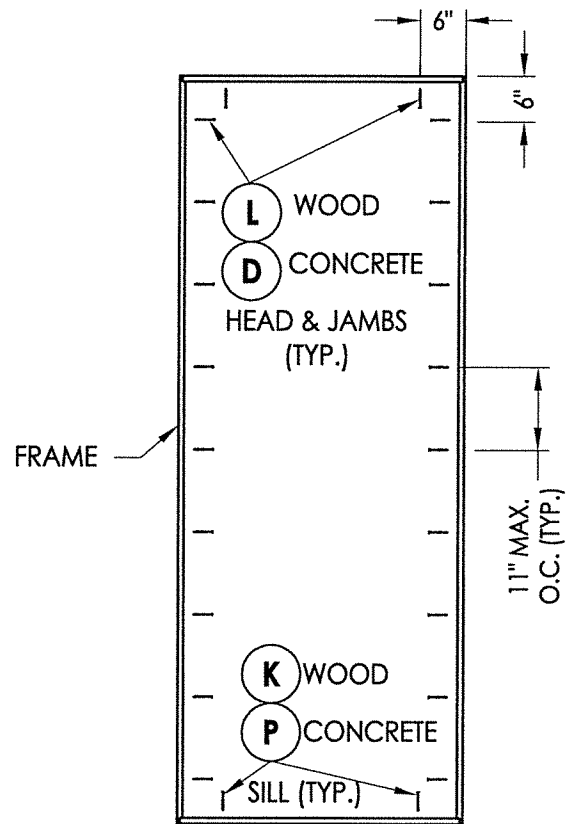

FRAME ANCHORING

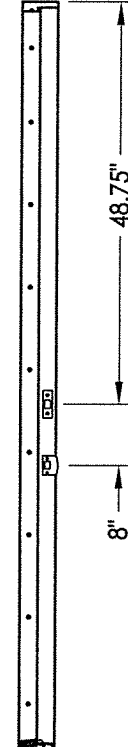

STRIKE JAMB
Outswing

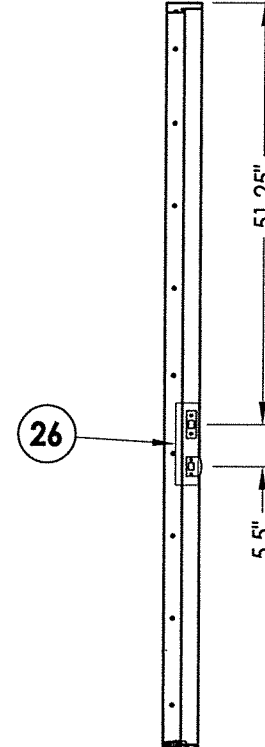

STRIKE JAMB
Inswing

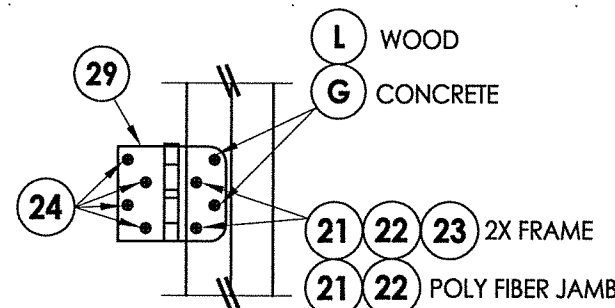

HINGE DETAIL

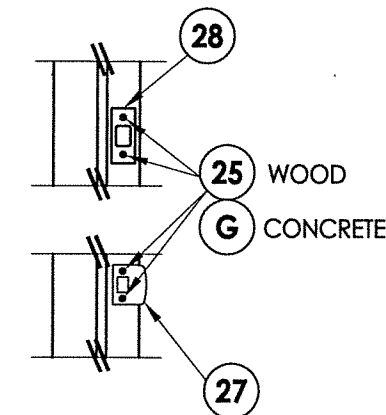

LATCH AND DEADBOLT DETAIL

CONCRETE ANCHOR NOTES:

- Concrete anchor locations at the corners may be adjusted to maintain the min. edge distance to mortar joints.
- Concrete anchor locations noted as "MAX. ON CENTER" must be adjusted to maintain the min. edge distance to mortar joints, additional concrete anchors may be required to ensure the "MAX. ON CENTER" dimension are not exceeded.
- Concrete anchor table:

ANCHOR TYPE	ANCHOR SIZE	MIN. EMBEDMENT	MIN. CLEARANCE TO MASONRY EDGE	MIN. CLEARANCE TO ADJACENT ANCHOR
ITW TAPCON®	1/4"	1-1/4"	2"	4"
ELCO ULTRACON®	1/4"	1-1/4"	1"	4"
ITW TAPCON®	3/16"	1-1/4"	3"	1-1/2"

WOOD SCREW INSTALLATION NOTES:

- Maintain a minimum 5/8" edge distance, 1" end distance, & 1" o.c. spacing of wood screws to prevent the splitting of wood.

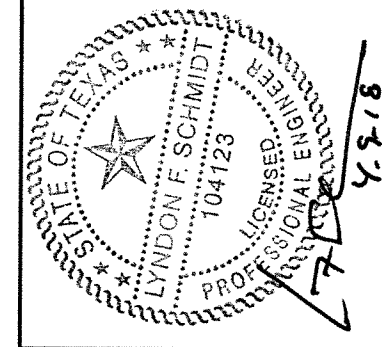

Documents Prepared By: Lyndon F. Schmidt, P.E.
TEXAS P.E. #104123

RW BUILDING CONSULTANTS, INC.
P.O. Box 230 Valrico FL 33595
Phone No.: 813.659.9197

CERTIFICATE OF REGISTRATION # F-11852

PRODUCT: SUNRISE FIBERGLASS DOOR
PART OR ASSEMBLY: FRAME ANCHORING (X)

NO.	DATE	BY	REVISIONS

DATE: 3/28/18
SCALE: N.T.S.
DWG. BY: JK
CHK. BY: LFS
DRAWING NO.: TX-4802
SHEET 7 OF 8

BILL OF MATERIALS

ITEM #	DESCRIPTION	MATERIAL
A	1X BUCK (SG >= 0.42)	WOOD
B	2X STUD (SG >= 0.42)	WOOD
C	1/4" MAX. SHIM SPACE	-
D	1/4" PFH ELCO OR ITW CONCRETE SCREW (1.375" MIN. EMBEDMENT)	STEEL
E	MASONRY - 3,000 PSI MIN. CONCRETE CONFORMING TO ACI 301 OR HOLLOW BLOCK CONFORMING TO ASTM C90	CONCRETE
G	3/16" ITW CONCRETE SCREW (1-1/4" MIN. EMBEDMENT)	STEEL
K	#10 PFH WOOD SCREW (1.5" MIN. EMBEDMENT)	STEEL
L	#10 X 2-1/2" PFH WOOD SCREW (1.15" MIN. EMBEDMENT)	STEEL
P	1/4" PFH ELCO OR ITW CONCRETE SCREW (1-3/4" MIN. EMBEDMENT)	STEEL
X	2X REINFORCEMENT (SG>= 0.55)	WOOD
1	JAMB (FINGER JOINT PINE w/ VINYL WRAP)	WOOD
2	JAMB (POLY FIBER)	COMP.
6	WEATHERSTRIP (MEDIUM REACH)	FOAM
7	WEATHERSTRIP (LONG REACH)	FOAM
10	SWEEP	VINYL
21	#10-24 X 5/8" M.S. w/ 1/2" STAFAST INSERT P/N D102413	STEEL
22	#10-24 X 5/8" M.S. w/ 3/8" STAFAST PRONG TEE NUT	STEEL
23	#10 x 3/4" PFH WOOD SCREW	STEEL
24	#10 x 1" PFH WOOD SCREW	STEEL

BILL OF MATERIALS

ITEM #	DESCRIPTION	MATERIAL
25	#8 x 2-1/2" PFH WOOD SCREW	STEEL
26	REINFORCEMENT PLATE	STEEL
27	LATCH STRIKE PLATE	STEEL
28	DEADBOLT STRIKE PLATE	STEEL
29	4" X 4" HINGE	STEEL
30	INSWING THRESHOLD	ALUM/COMP
31	OUTSWING THRESHOLD	ALUM/COMP
32	OUTSWING THRESHOLD	ALUM/COMP
33	ADA THRESHOLD	ALUM
34	ADA BUMP THRESHOLD	ALUM
40	DOOR PANEL	-

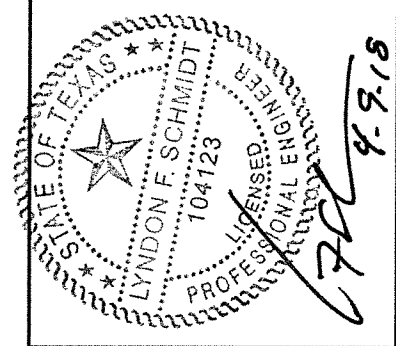

Documents Prepared By: Lyndon F. Schmidt, P.E.
TEXAS P.E. #104123

RW BUILDING CONSULTANTS, INC.
P.O. Box 230 Valrico FL 33595
Phone No.: 813.659.9197

CERTIFICATE OF REGISTRATION # F-11852

PRODUCT: SUNRISE FIBERGLASS DOOR

PART OR ASSEMBLY: BILL OF MATERIALS AND COMPONENTS

NO. DATE BY REVISIONS

DATE: 3/28/18
SCALE: N.T.S.
DWG. BY: JK
CHK. BY: LFS
DRAWING NO.: TX-4802
SHEET 8 OF 8

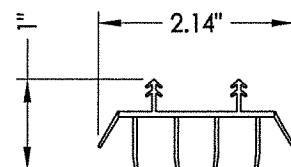

10 SWEEP

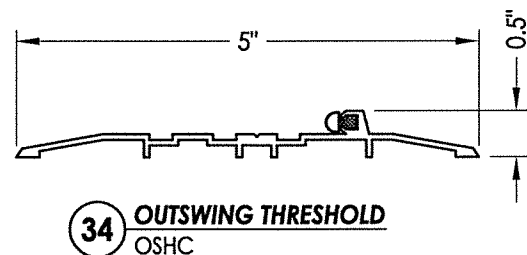

34 OUTSWING THRESHOLD OSHC

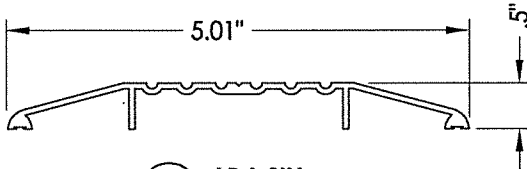

33 ADA SILL ISHC

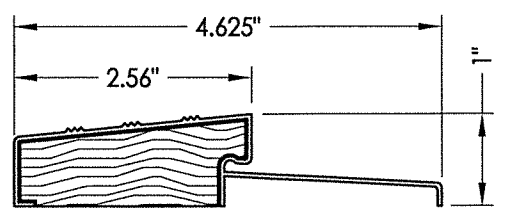

31 OUTSWING THRESHOLD QOS

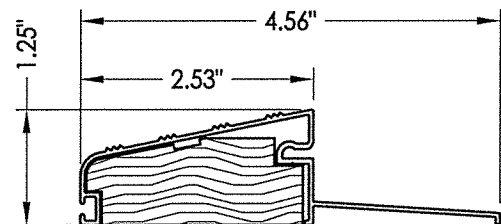

32 OUTSWING THRESHOLD QOSH

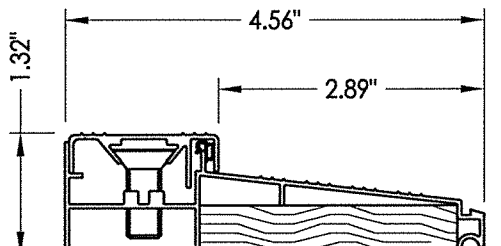

30 INSWING THRESHOLD ISCS

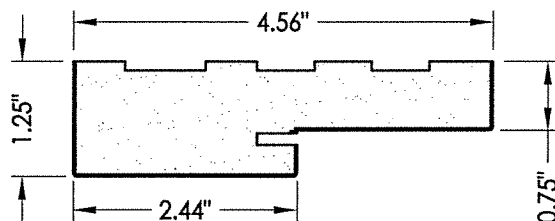

1 WOOD JAMB W/ Vinyl Wrap

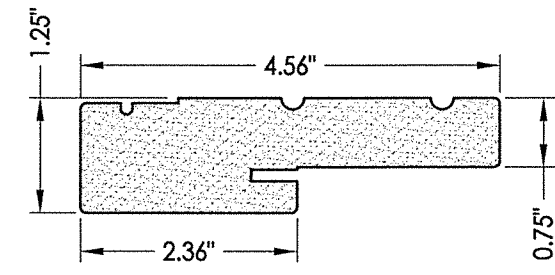

2 POLY FIBER JAMB

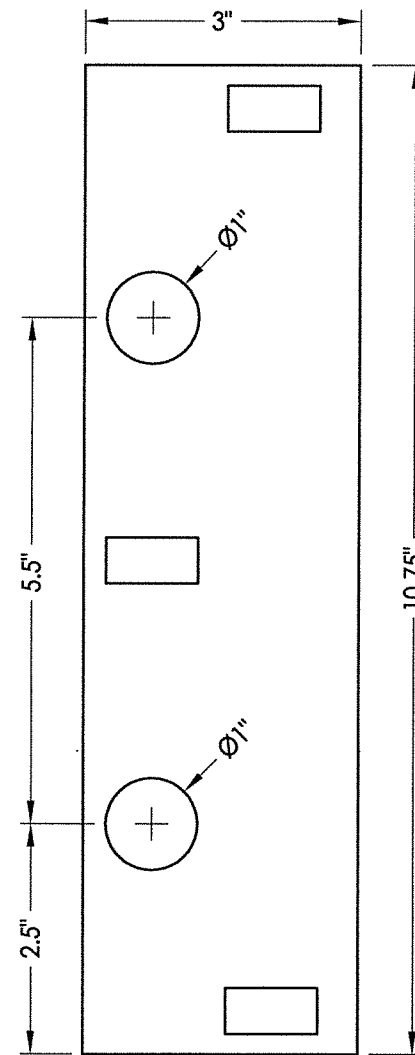

26 REINFORCEMENT PLATE 16 GA. (Inswing only)