

THERMA TRU® DOORS

Fiber-Classic® & Smooth-Star®

COMPOSITE EDGE OPAQUE FIBERGLASS SINGLE DOOR IN SWING / OUT SWING "NON-IMPACT"

EVALUATED FOR USE IN THE STATE OF TEXAS

TDI DR-947

The Fiberglass Door system described herein complies with the 2018 International Residential Code (IRC), Sections R301 & R609 and the 2018 International Building Code (IBC), Sections 1404.13, 1609, 1709.5, 2403 and 2404 subject to the following conditions:

1. Anchors shall be as listed and spaced as shown in the details. Anchor embedment to base material shall be beyond wall dressing or stucco.
2. When used in areas requiring wind-borne debris protection this product is required to be protected with an impact resistant covering that complies with Section R301.2.1.2 of the IRC and Section 1609.1.2 of the IBC.
3. Allowable design pressure requirements must be equal to or less than the design pressure rating shown in the design pressure chart, sheet 1 of this drawing.
4. Conditions not covered by this drawing are subject to further engineering analysis.
5. Fiber-Classic and Smooth-Star Door and Sidelite panels require the use of "J" part numbers. These door and sidelite panels must be stained or painted within six months of installation.

TABLE OF CONTENTS	
SHEET #	DESCRIPTION
1	Typical Elevations, Design Pressures & General Notes
2	Door Panel Details
3	Elevations
4	Horizontal & Vertical Cross Sections
5	Vertical Cross Sections (Thresholds)
6	Frame Anchoring & Hardware Details
7	Components
8	Bill of Materials

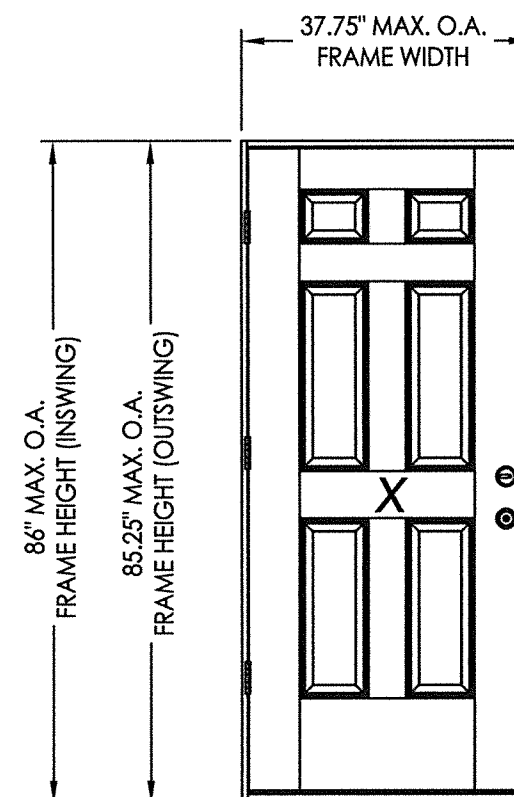

CONFIGURATION	DESIGN PRESSURE (PSF) IN SWING		DESIGN PRESSURE (PSF) OUT SWING	
	POSITIVE	NEGATIVE	POSITIVE	NEGATIVE
X	+70.0	-75.0	+70.0	-70.0

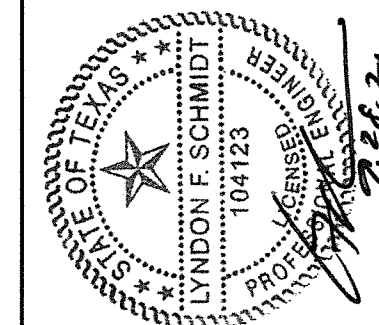

Documents Prepared By: Lyndon F. Schmidt, P.E.
TEXAS P.E. #104123

RW BUILDING CONSULTANTS, INC.
P.O. Box 230 Valrico FL 33595
Phone No.: 813.659.9197

CERTIFICATE OF REGISTRATION # F-11852

PRODUCT: THERMA-TRU FIBERGLASS DOOR
PART OR ASSEMBLY: TYPICAL ELEVATION, DESIGN PRESSURES & GENERAL NOTES

NO.	DATE	REVISIONS
1	9/28/21	UPDATE TO 2018 IBC/IRC CODE

DATE: 11/14/17
SCALE: N.T.S.
DWG. BY: JK
CHK. BY: LFS
DRAWING NO.: TX-4719
SHEET 1 OF 8

Z:\Clients\Therma Tru PERMANENT\B - Texas Dept of Ins\TDI - DR 947 - 6'8 & 8'0 Opaque Comp Edge Non-Impact (TX 4716 - 4727)\C - Drawings\TX-4719-20.dwg

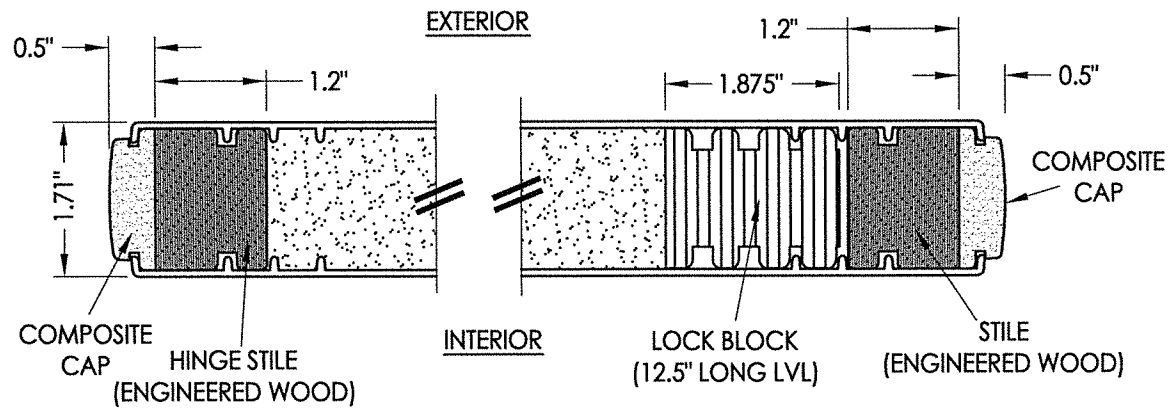

1 HORIZONTAL CROSS SECTION
2

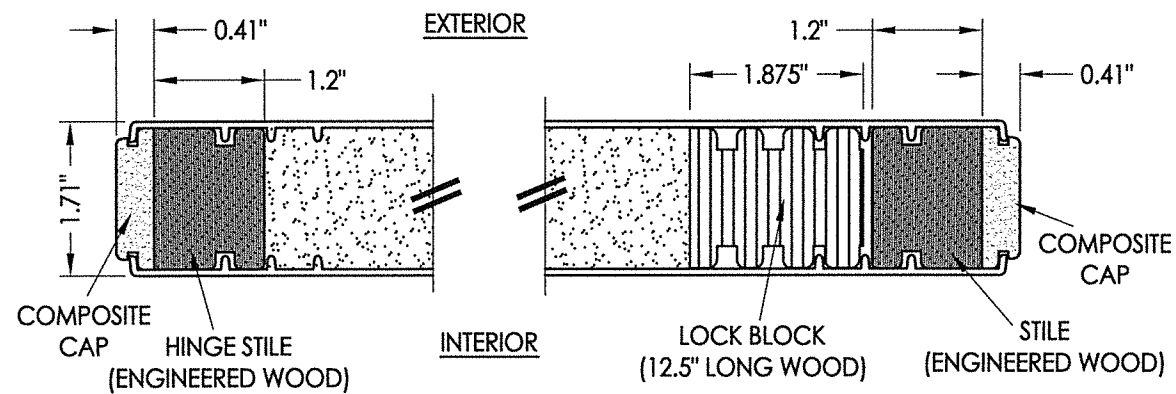

2 HORIZONTAL CROSS SECTION
2

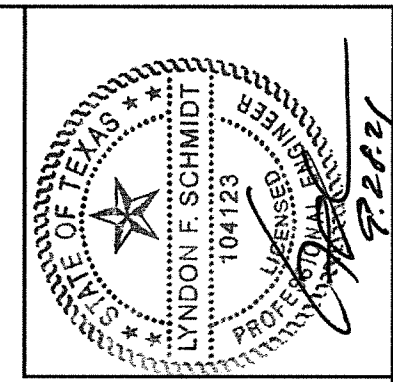

Documents Prepared By: Lyndon F. Schmidt, P.E.
TEXAS P.E. #104123

RW BUILDING CONSULTANTS, INC.
P.O. Box 230 Valrico FL 33595
Phone No.: 813.659.9197

CERTIFICATE OF REGISTRATION # F-11852

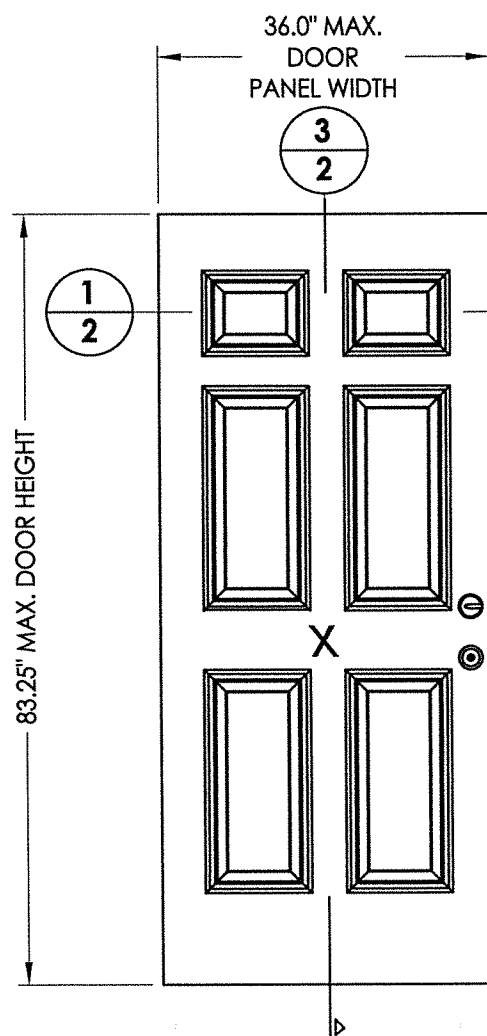

40 DOOR PANEL
BOOK

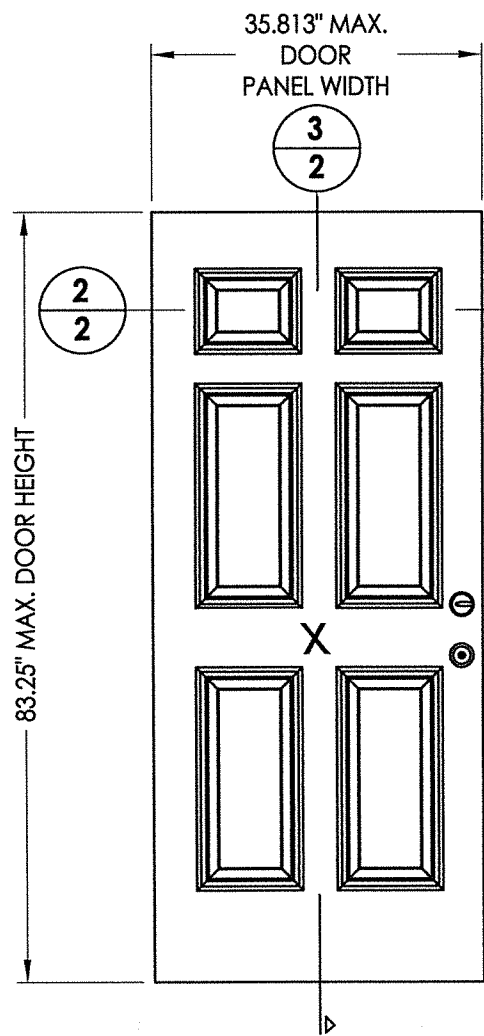

41 DOOR PANEL
Hybrid Door

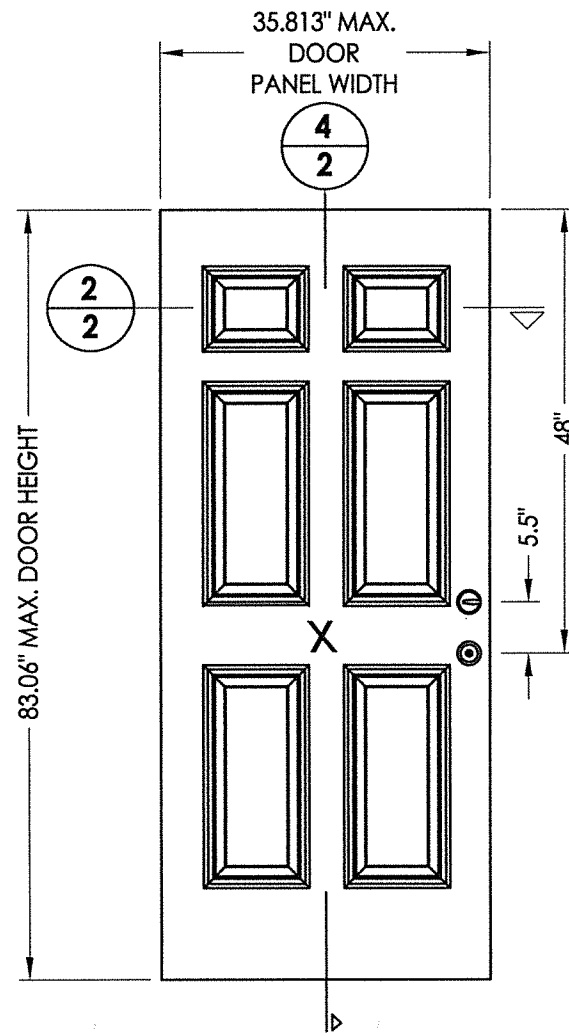

42 DOOR PANEL
UI Door

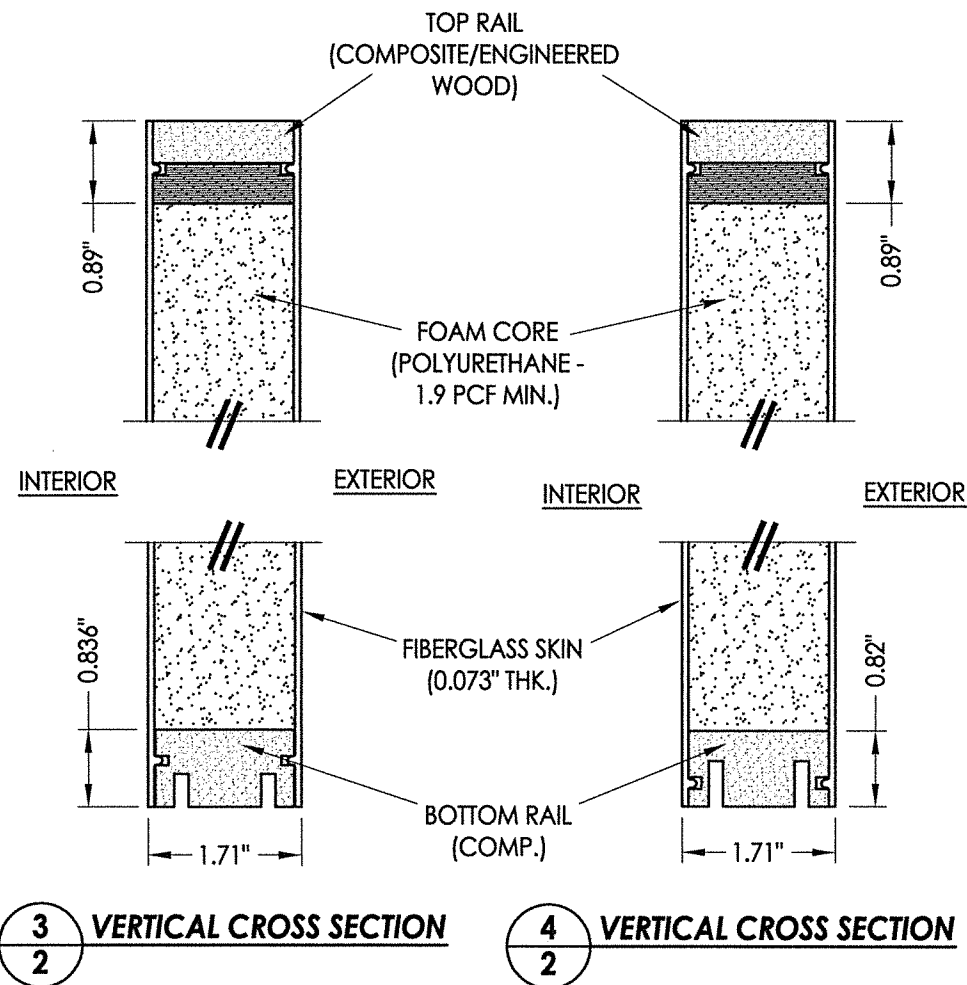

3 VERTICAL CROSS SECTION
2

4 VERTICAL CROSS SECTION
2

PRODUCT:	Therma-TRU FIBERGLASS DOOR
PART OR ASSEMBLY:	DOOR PANEL DETAILS

NO.	DATE	REVISIONS	BY
1	9/28/21	UPDATE TO 2018 IBC/IRC CODE	LFS

DATE:	11/14/17
SCALE:	N.T.S.
DWG. BY:	JK
CHK. BY:	LFS
DRAWING NO.:	TX-4719
SHEET	2 OF 8

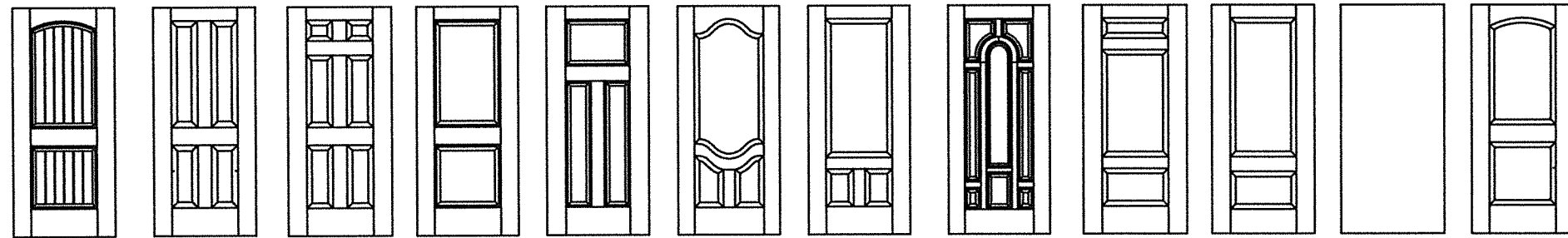

Fiber Classic/Smooth-Star Door Panel Options

Panel options shown are for illustration and are representative only
(similar opaque panel configurations are allowed)

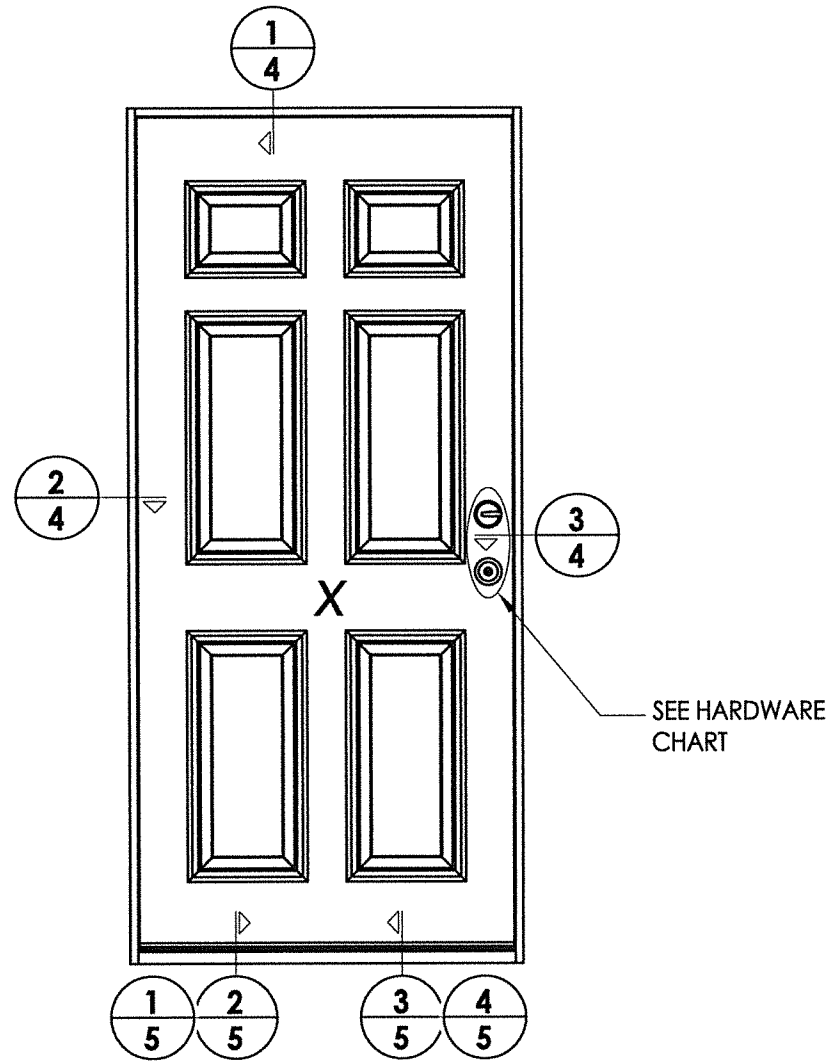

HARDWARE TABLE	
MANUFACTURER	MODEL
SCHLAGE	KNOB: F51
	DEADBOLT: B60
KWIKSET	KNOB: SIGNATURE SERIES
	DEADBOLT: SIGNATURE SERIES (980)

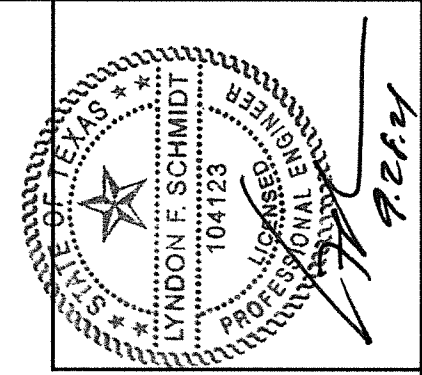

Documents Prepared By: Lyndon F. Schmidt, P.E.
TEXAS P.E. #104123

RW BUILDING CONSULTANTS, INC.
P.O. Box 230 Valrico FL, 33595
Phone No.: 813.689.9197

CERTIFICATE OF REGISTRATION # F-11852

PRODUCT: THERMA-TRU FIBERGLASS DOOR

PART OR ASSEMBLY: ELEVATIONS

NO.	DATE	REVISIONS	
		DATE	BY
1	9/28/21	UPDATE TO 2018 IBC/IRC CODE	LFS

DATE: 11/14/17
SCALE: N.T.S.
DWG. BY: JK
CHK. BY: LFS
DRAWING NO.: TX-4719
SHEET 3 OF 8

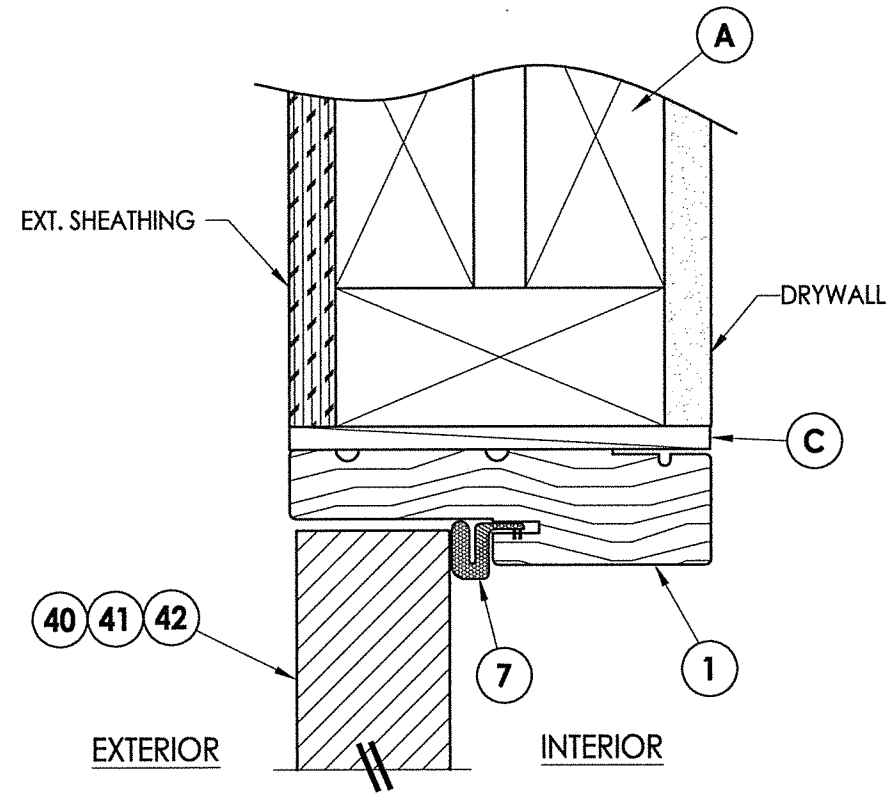

1 VERTICAL CROSS SECTION
4 Outswing shown (Inswing similar)

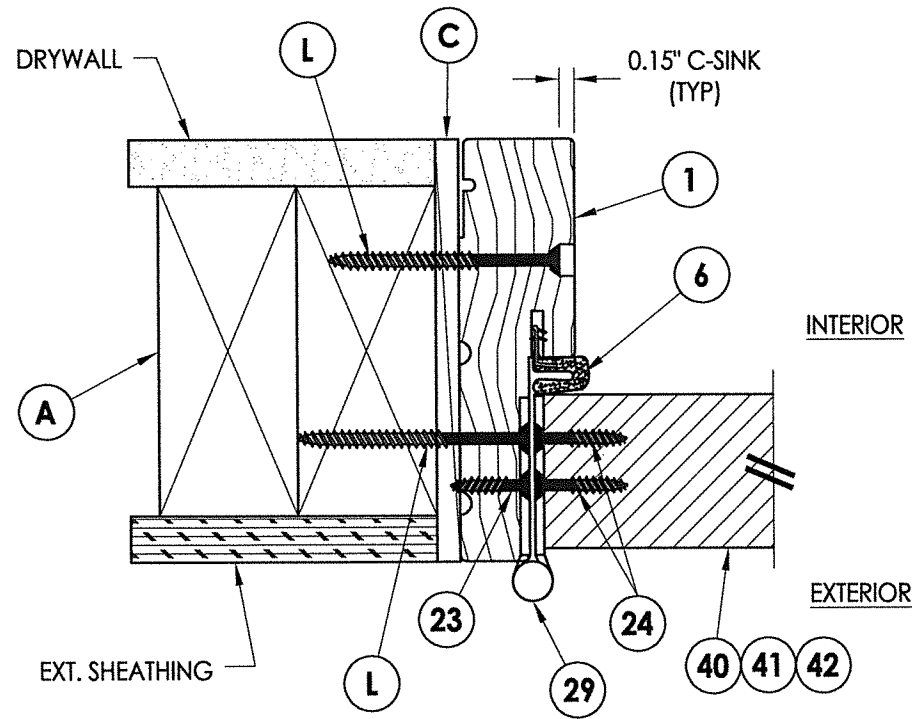

2 HORIZONTAL CROSS SECTION
4 Outswing shown (Inswing similar)

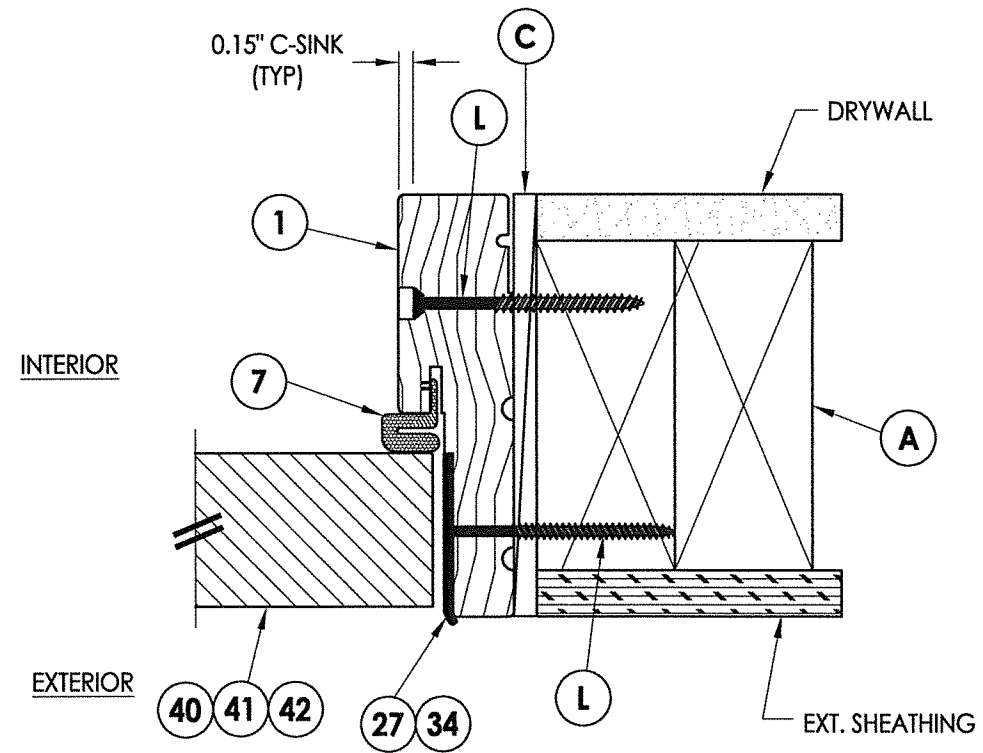

3 HORIZONTAL CROSS SECTION
4 Outswing shown (Inswing similar)

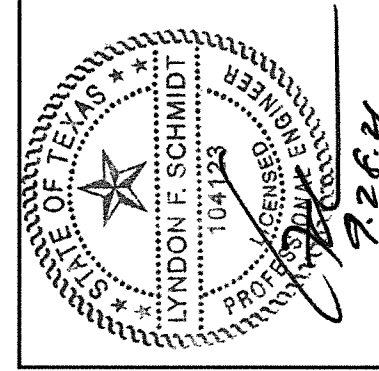

Documents Prepared By: Lyndon F. Schmidt, P.E.
 TEXAS P.E. #104123

RW BUILDING CONSULTANTS, INC.
 P.O. Box 230 Valrico FL 33595
 Phone No.: 813.659.9197

CERTIFICATE OF REGISTRATION # F-11852

PRODUCT: THERMA-TRU FIBERGLASS DOOR
 PART OR ASSEMBLY: HORIZONTAL & VERTICAL CROSS SECTIONS

NO.	DATE	REVISIONS	LFS	BY
1	9/28/21	UPDATE TO 2018 IBC/IRC CODE	LFS	

DATE: 11/14/17
 SCALE: N.T.S.
 DWG. BY: JK
 CHK. BY: LFS
 DRAWING NO.: TX-4719
 SHEET 4 OF 8

Z:\Clients\Therma Tru PERMANENT\B - Texas Dept of Ins\TDI - DR 947 - 68 & 8'0 Opaque Comp Edge Non-Impact (TX 4716 - 4727)\C - Drawings\TX-4719-20.dwg

Notes:

- 1. Sill Item #'s 16, 32, 33, 34, 35, 36, 37, 38 & 39 are attached to jambs w/ (3) #8 X 2-1/2" pph screws at each end.
- Sill Item #'s 17 & 18 are attached to jambs w/ (2) #8 X 2-1/2" pph screws at each end.
- Sill Item #15 is attached to jambs utilizing (2) #10 X 1-1/2" pph screws at each end.

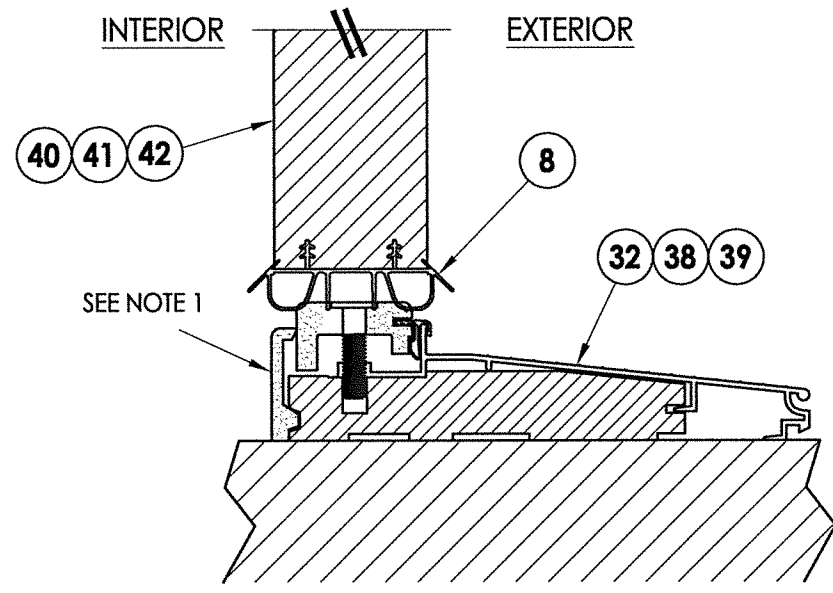
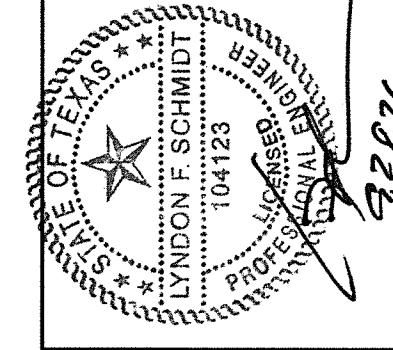

1 VERTICAL CROSS SECTION
5 Inswing Sill

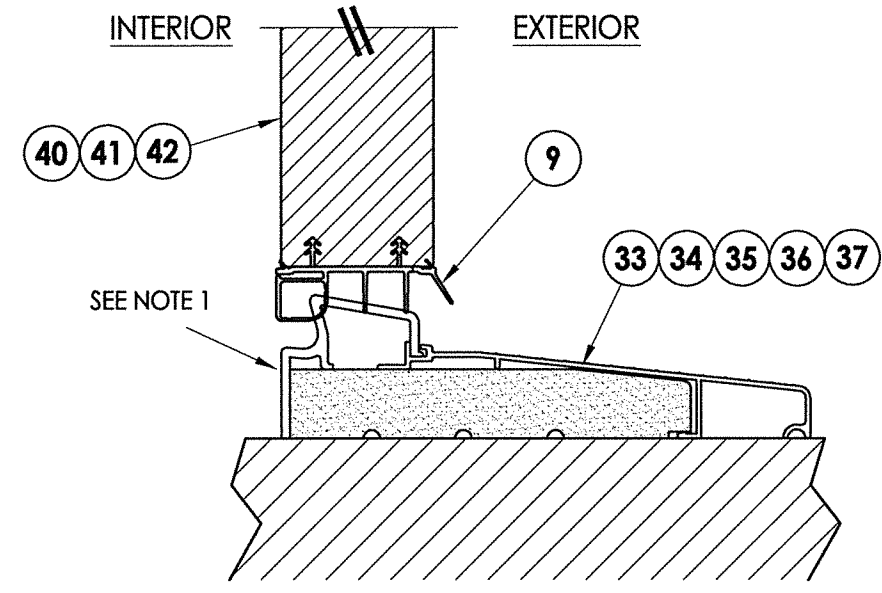

2 VERTICAL CROSS SECTION
5 Inswing Sill

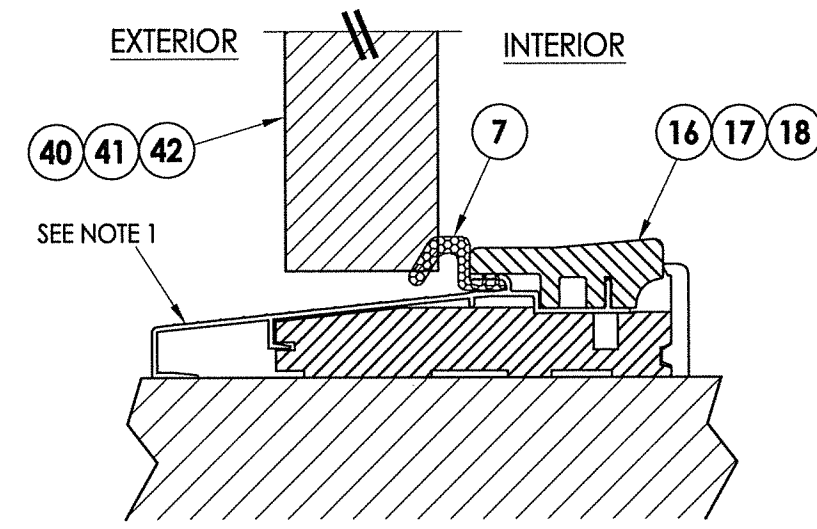

3 VERTICAL CROSS SECTION
5 Outswing Sill (Coastal Sill Shown)

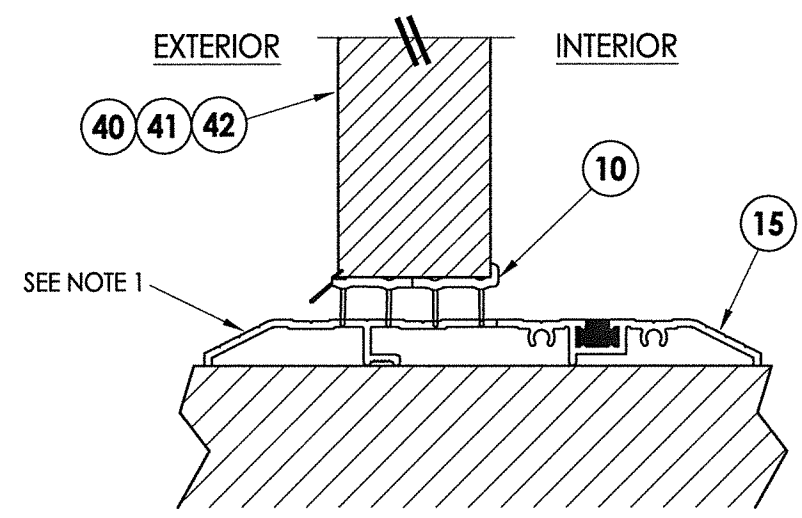

4 VERTICAL CROSS SECTION
5 Public Access Sill

Documents Prepared By: Lyndon F. Schmidt, P.E. TEXAS P.E. #104123		BUILDING CONSULTANTS, INC. P.O. Box 230 Valrico FL 33595 Phone No.: 813.659.9197	
PRODUCT: THERMA-TRU FIBERGLASS DOOR		PART OR ASSEMBLY: VERTICAL CROSS SECTIONS (THRESHOLDS)	
DATE: 11/14/17		SCALE: N.T.S.	
DWG. BY: JK		CHK. BY: LFS	
DRAWING NO.: TX-4719		REVISIONS	
NO.	DATE	DESCRIPTION	BY
1	9/28/21	UPDATE TO 2018 IBC/IRC CODE	LFS
SHEET 5 OF 8			

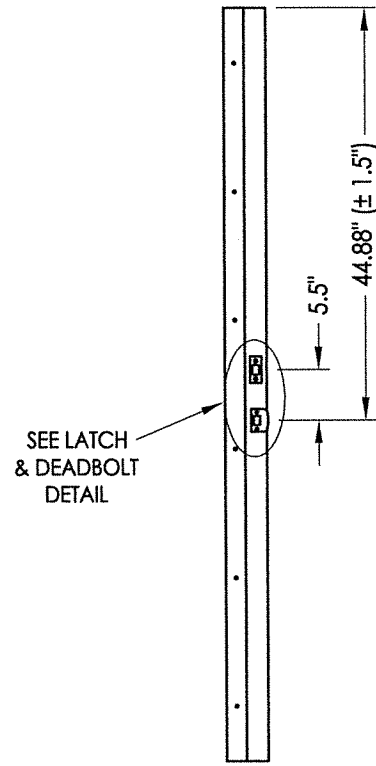

STRIKE JAMB
Latch and Deadbolt

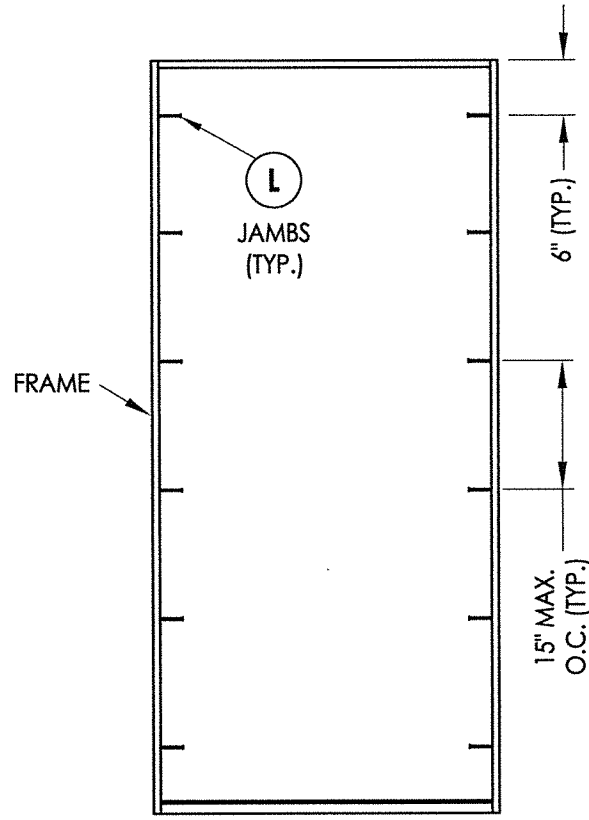

X

FRAME ANCHORING

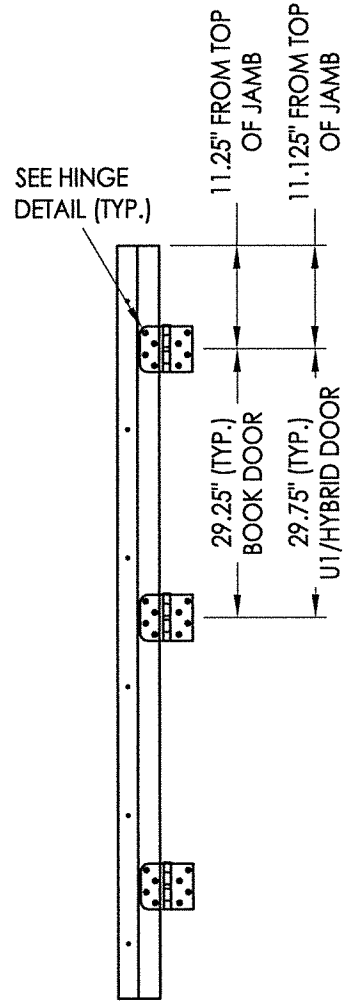

HINGE JAMB

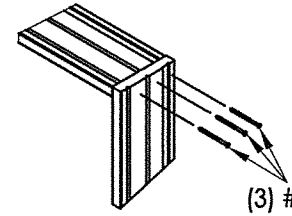

JAMB TO HEAD DETAIL
(TYP.)

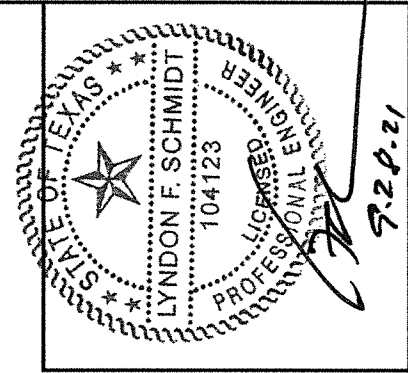

Documents Prepared By: Lyndon F. Schmidt, P.E.
TEXAS P.E. #104123

RW BUILDING CONSULTANTS, INC.
P.O. Box 230 Valrico FL 33595
Phone No.: 813.659.9197

CERTIFICATE OF REGISTRATION # F-11852

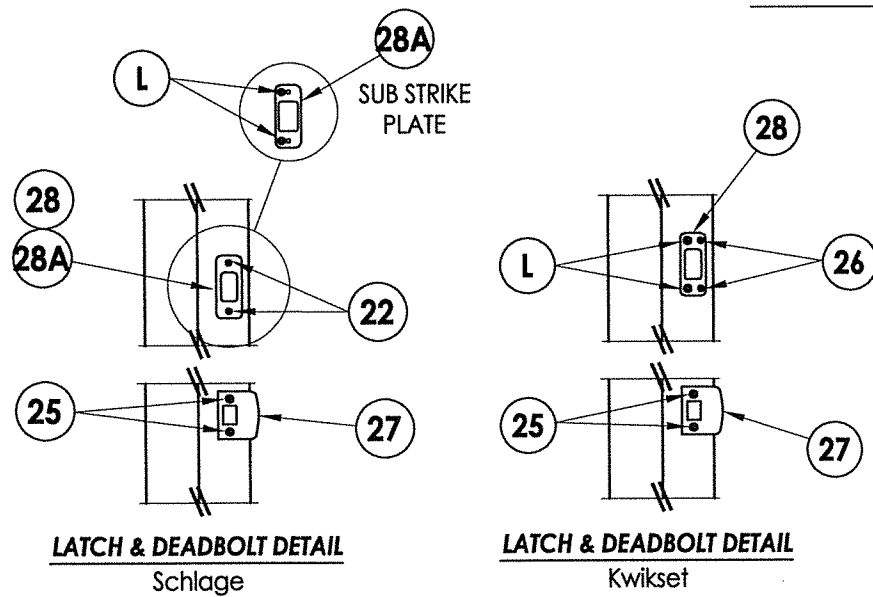

LATCH & DEADBOLT DETAIL
Schlage

LATCH & DEADBOLT DETAIL
Kwikset

LATCH & DEADBOLT STRIKE DETAILS
(Standard Deadbolt Strike Plate)

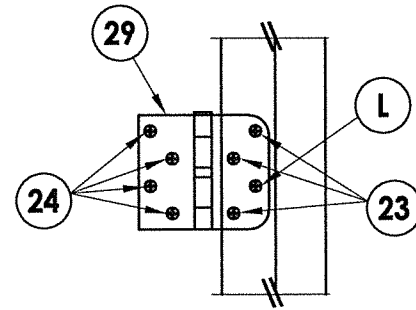

HINGE DETAIL

PRODUCT:	THERMA-TRU FIBERGLASS DOOR	
PART OR ASSEMBLY:	FRAME ANCHORING & HARDWARE DETAILS	
NO.	DATE	BY
1	9/28/21 UPDATE TO 2018 IBC/IRC CODE	LFS
REVISIONS		
DATE: 11/14/17		
SCALE: N.T.S.		
DWG. BY: JK		
CHK. BY: LFS		
DRAWING NO.: TX-4719		
SHEET 6 OF 8		

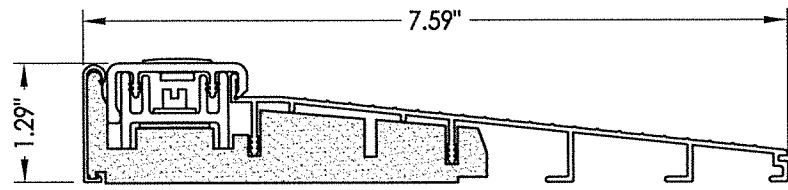

32 INSWING THRESHOLD
Inswing Basic Composite Adjustable Sill 7-1/2"

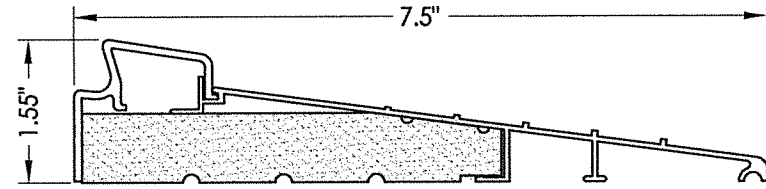

37 INSWING THRESHOLD
Inswing Basic Fixed 7-1/2" Sill

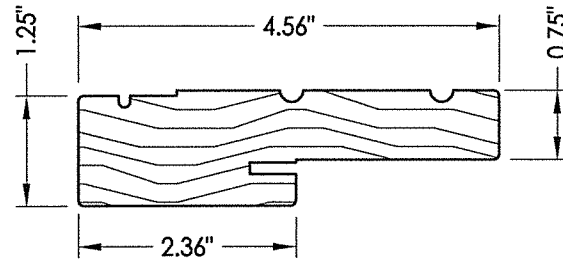

1 WOOD JAMB

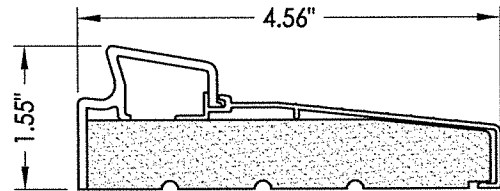

33 INSWING THRESHOLD
Inswing Basic Fixed Sill

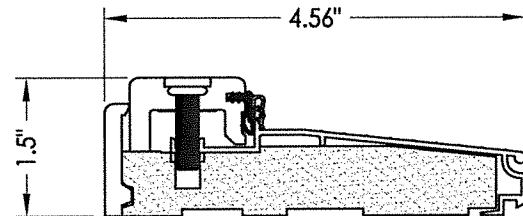

38 INSWING THRESHOLD
Inswing Composite Adjustable Sill

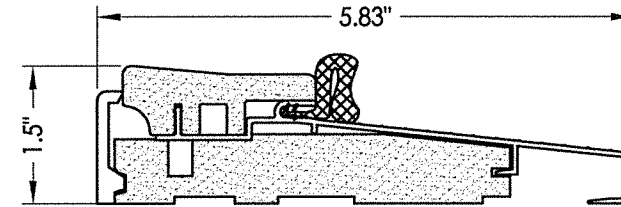

16 OUTSWING THRESHOLD
Composite Sill

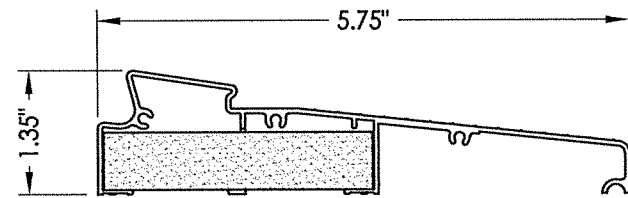

34 INSWING THRESHOLD
Inswing Moderate Climate Sill 1-3/8"

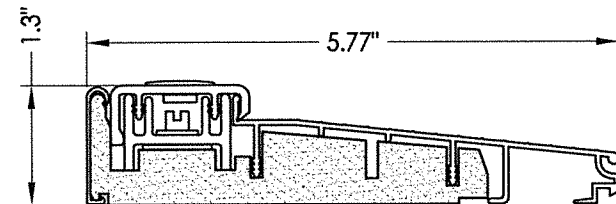

39 INSWING THRESHOLD
Inswing Basic Composite Adjustable Sill

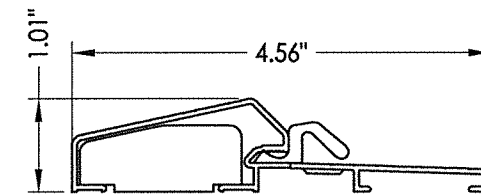

17 OUTSWING THRESHOLD
Composite / Aluminum Sill

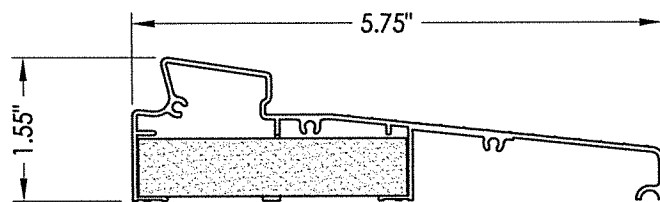

35 INSWING THRESHOLD
Inswing Moderate Climate Sill

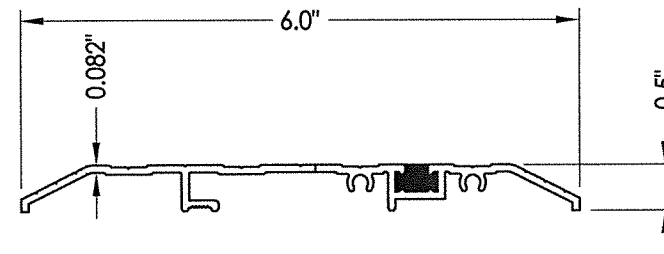

15 PUBLIC ACCESS THRESHOLD

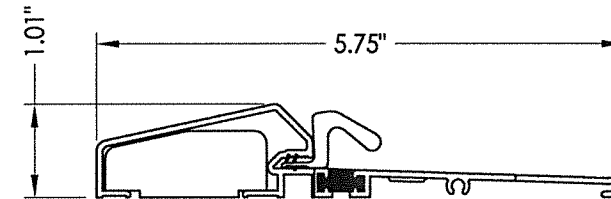

18 OUTSWING THRESHOLD
Composite / Aluminum Sill
(Thermal Break)

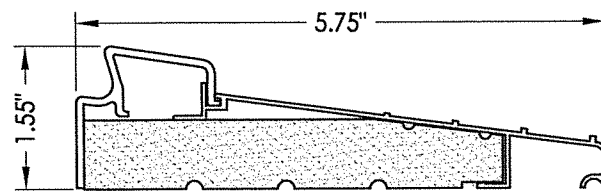

36 INSWING THRESHOLD
Inswing Basic Fixed 5-3/4" Sill

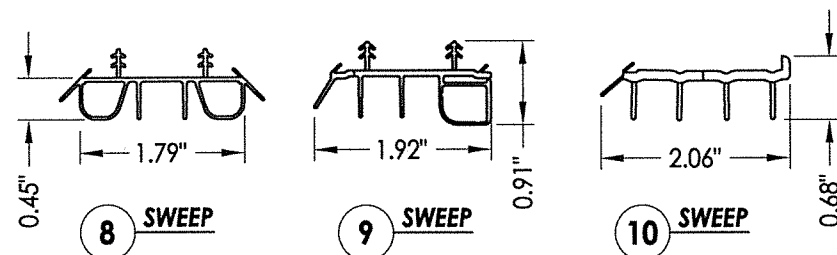

8 SWEEP

9 SWEEP

10 SWEEP

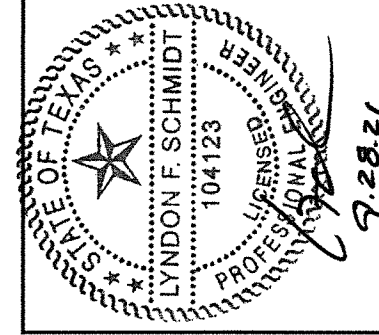

Documents Prepared By: Lyndon F. Schmidt, P.E.
TEXAS P.E. #104123

RW BUILDING CONSULTANTS, INC.
P.O. Box 230 Valrico FL 33595
Phone No.: 813.659.9197

CERTIFICATE OF REGISTRATION # F-11852

PRODUCT:		THERMA-TRU FIBERGLASS DOOR	
PART OR ASSEMBLY:		COMPONENTS	
NO.	DATE	REVISIONS	BY
1	9/28/21	UPDATE TO 2018 IBC/IRC CODE	LFS
DATE:	11/14/17		
SCALE:	N.T.S.		
DWG. BY:	JK		
CHK. BY:	LFS		
DRAWING NO.:	TX-4719		
SHEET	7 OF 8		

BILL OF MATERIALS

ITEM #	DESCRIPTION	MATERIAL
A	2X FRAMING (SG >= 0.42)	WOOD
C	1/4" MAX. SHIM SPACE	-
L	#10 X 2-1/2" PFH WOOD SCREW (1.15" MIN. EMBEDMENT)	STEEL
1	JAMB (FINGER JOINT PINE)	WOOD
6	WEATHERSTRIP (MEDIUM REACH)	FOAM
7	WEATHERSTRIP (LONG REACH)	FOAM
8	SWEEP	VINYL
9	SWEEP (USE w/ MODERATE CLIMATE THRESHOLD)	VINYL
10	SWEEP (USE w/ PUBLIC ACCESS THRESHOLD)	VINYL
15	PUBLIC ACCESS THRESHOLD	ALUM
16	OUTSWING THRESHOLD	ALUM/COMP
17	OUTSWING THRESHOLD	ALUM/COMP
18	OUTSWING THRESHOLD	ALUM/COMP
22	#8 x 3/4" PFH WOOD SCREW	STEEL
23	#10 x 3/4" PFH WOOD SCREW	STEEL
24	#10 x 1" PFH WOOD SCREW	STEEL
25	#8 x 2-1/2" PFH WOOD SCREW	STEEL
26	#8 x 5/8" PFH WOOD SCREW	STEEL
27	LATCH STRIKE PLATE	STEEL
28	DEADBOLT SUB STRIKE PLATE	STEEL
28A	DEADBOLT SUB STRIKE PLATE	STEEL
29	4" X 4" HINGE	STEEL
32	INSWING THRESHOLD	ALUM/COMP
33	INSWING THRESHOLD	ALUM/COMP
34	INSWING THRESHOLD	ALUM/COMP
35	INSWING THRESHOLD	ALUM/COMP
36	INSWING THRESHOLD	ALUM/COMP
37	INSWING THRESHOLD	ALUM/COMP
38	INSWING THRESHOLD	ALUM/COMP
39	INSWING THRESHOLD	ALUM/COMP
40	DOOR PANEL (BOOK)	-
41	DOOR PANEL (HYBRID)	-
42	DOOR PANEL (U1)	-

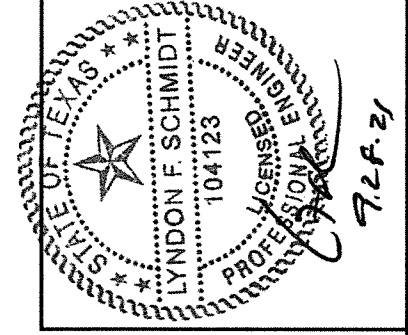

Documents Prepared By: Lyndon F. Schmidt, P.E.
TEXAS P.E. #104123

R.W. BUILDING CONSULTANTS, INC.
P.O. Box 230 Valrico FL 33595
Phone No.: 813.659.9197

CERTIFICATE OF REGISTRATION # F-11852

PRODUCT:		THERMA-TRU FIBERGLASS DOOR	
PART OR ASSEMBLY:		BILL OF MATERIALS	
NO.	DATE	DESCRIPTION	BY
1	9/28/21	UPDATE TO 2018 IBC/IRC CODE	LFS
REVISIONS			
DATE: 11/14/17			
SCALE: N.T.S.			
DWG. BY: JK			
CHK. BY: LFS			
DRAWING NO.: TX-4719			
SHEET 8 OF 8			