

Documents Prepared By: Lyndon F. Schmidt, P.E.
TEXAS P.E. #104123

RW BUILDING CONSULTANTS, INC.
P.O. Box 230 Valrico FL 33595
Phone No.: 813.659.9197

TEXAS BOARD OF PROFESSIONAL ENGINEERS
CERTIFICATE OF REGISTRATION # F-11852

Opaque Fiberglass Door

"NON-IMPACT"
INSWING / OUTSWING

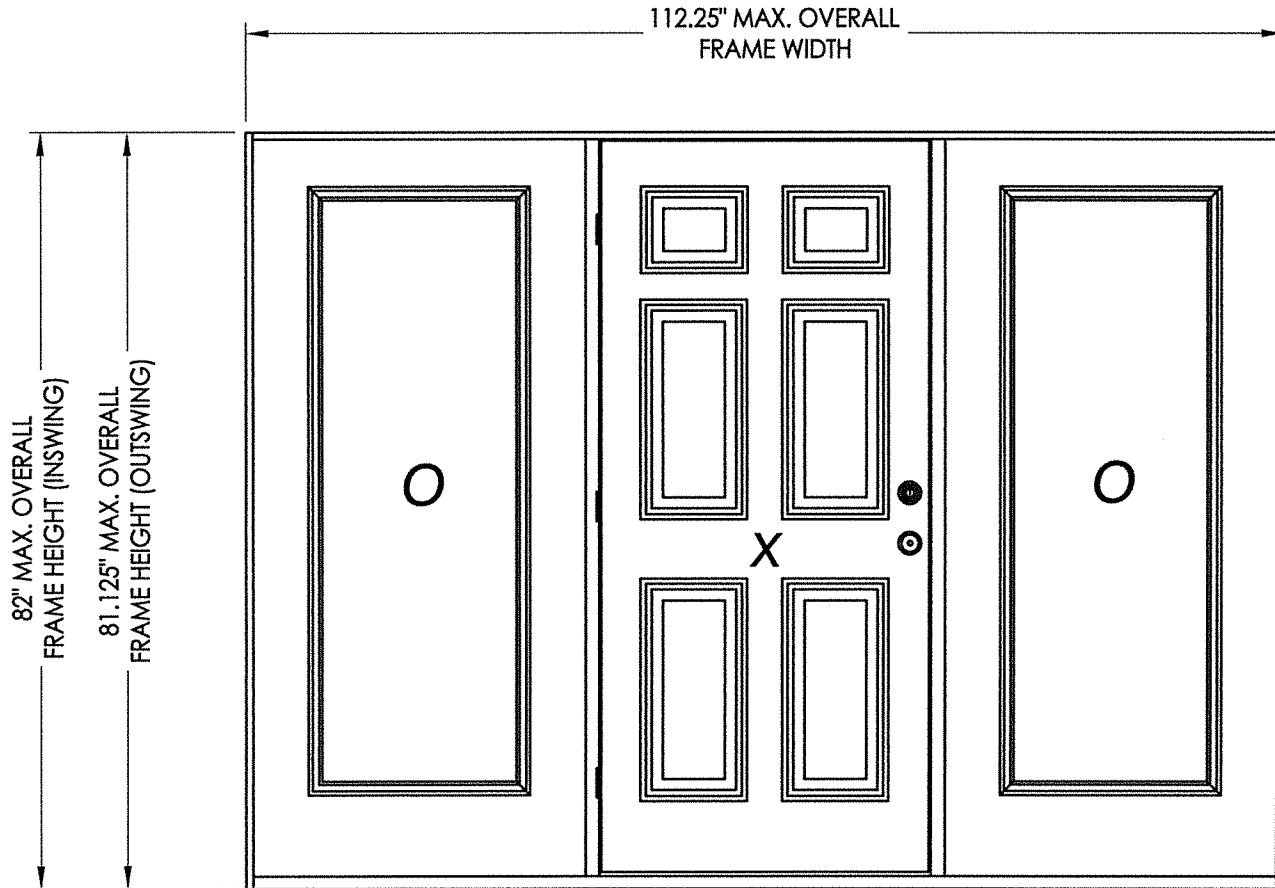

EVALUATED FOR USE IN THE STATE OF TEXAS

TDI DR-851

The Fiberglass Door system described herein complies with the 2018 International Residential Code (IRC), Sections R301 & R609 and the 2018 International Building Code (IBC), Sections 1404.13, 1609, 1709.5, 2403 and 2404 subject to the following conditions:

1. Anchors shall be as listed and spaced as shown in the details. Anchor embedment to base material shall be beyond wall dressing or stucco.
2. When used in areas requiring wind-borne debris protection this product is required to be protected with an impact resistant covering that complies with Section R301.2.1.2 of the IRC and Section 1609.1.2 of the IBC.
3. Allowable design pressure requirements must be equal to or less than the design pressure rating shown in the design pressure chart, sheet 1 of this drawing.
4. Conditions not covered by this drawing are subject to further engineering analysis.

TABLE OF CONTENTS

| SHEET # | DESCRIPTION |
|---------|--|
| 1 | Typical elevations, design pressures & general notes |
| 2 | Door panel details |
| 3 | Slidelite panel details (lip lite insert glazing) |
| 4 | Horizontal cross sections |
| 5 | Vertical cross sections |
| 6 | Vertical cross sections |
| 7 | Frame anchoring |

| CONFIG. | MODEL | DESIGN PRESSURE (PSF) | |
|---------|----------|-----------------------|----------|
| | | POSITIVE | NEGATIVE |
| OXO | INSWING | +45.0 | -45.0 |
| OXO | OUTSWING | +60.0 | -60.0 |

| | |
|-------------------|---|
| PRODUCT: | ENDURA |
| PART OR ASSEMBLY: | TYPICAL ELEVATION, DESIGN PRESSURES & GENERAL NOTES |
| DATE | 11/02/16 |
| SCALE | N.T.S. |
| DWG. BY: | JK |
| CHK. BY: | LFS |
| DRAWING NO.: | TX-4646 |
| SHEET | 1 OF 7 |

Z:\Clients\Endura PERMANENT\B - Texas Dept of Ins\TDI - DR-851 Plastpro FG Opaque (LK,DB)\C - Drawings\TX-4646.dwg

Z:\Clients\Endura PERMANENT\B - Texas Dept of Ins\TDI - DR-851 Plastpro FG Opaque (LK,DB)\C - Drawings\TX-4646.dwg

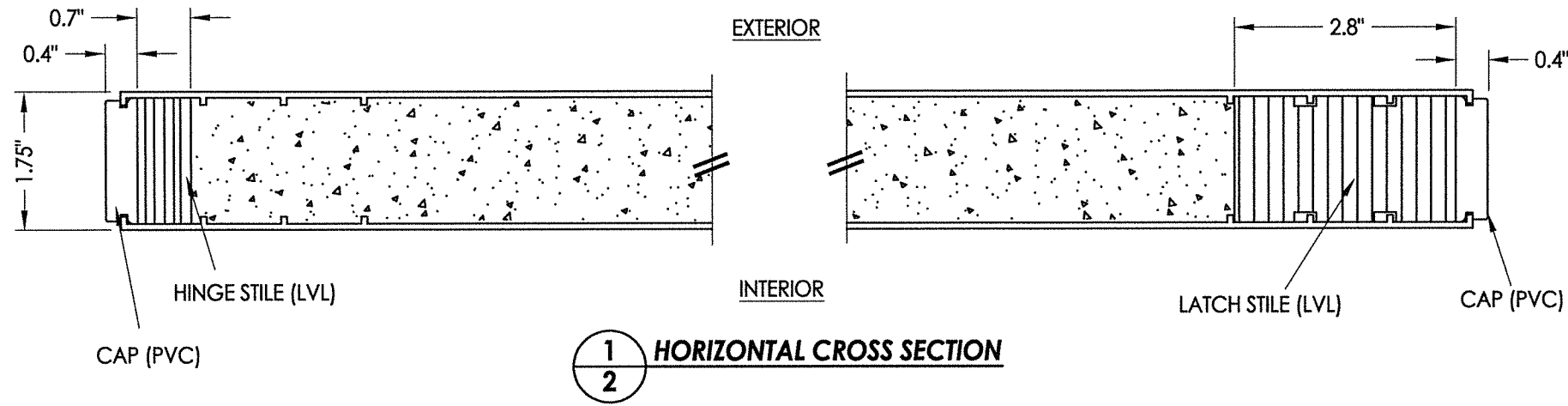

1
2 **HORIZONTAL CROSS SECTION**

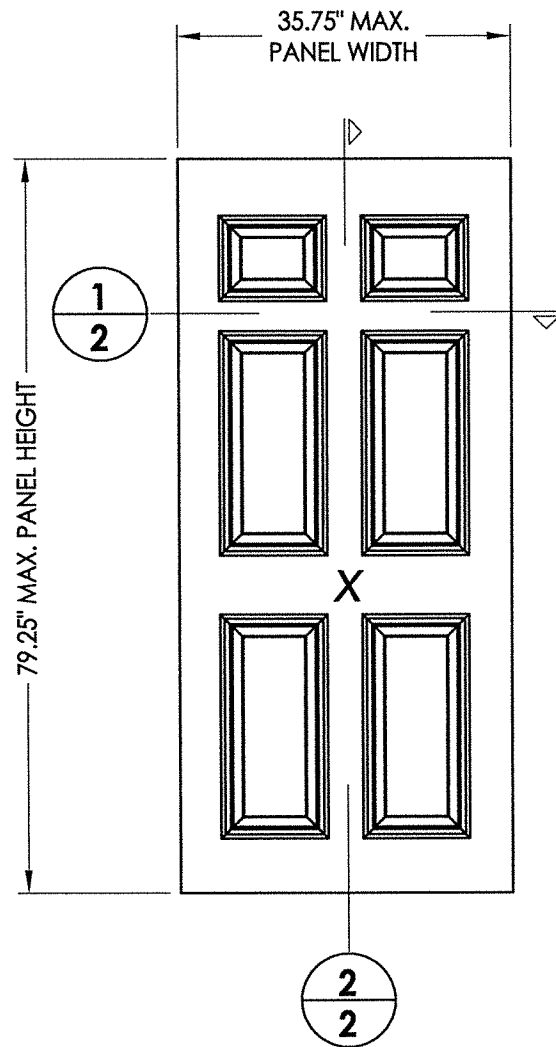

2
2 **DOOR PANEL**
Plastpro
Fiberglass

DOOR SKIN: FIBERGLASS (0.075" MIN. THICKNESS)
CORE MATERIAL: POLYURETHANE FOAM (1.9 PCF MIN.)

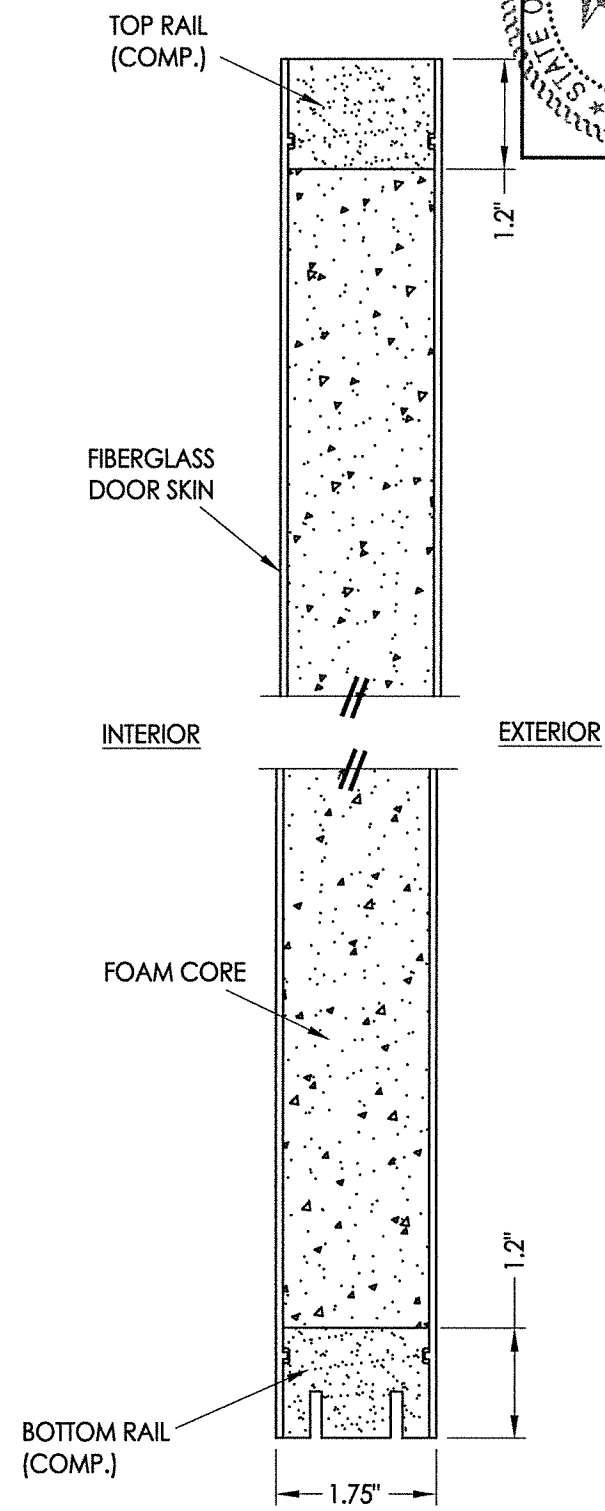

2
2 **VERTICAL CROSS SECTION**

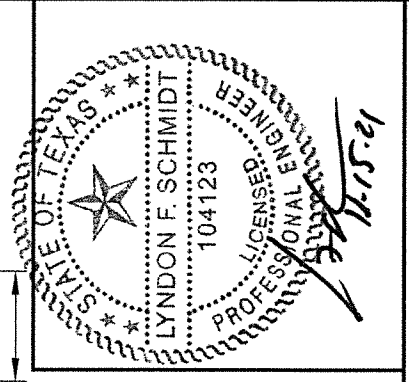

Documents Prepared By: Lyndon F. Schmidt, P.E.
TEXAS P.E. #104123

RW BUILDING CONSULTANTS, INC.
P.O. Box 230 Valrico FL, 33595
Phone No.: 813.659.9197
TEXAS BOARD OF PROFESSIONAL ENGINEERS
CERTIFICATE OF REGISTRATION # F-11852

PRODUCT: ENDURA
PART OR ASSEMBLY: DOOR PANEL DETAILS & GLAZING DETAIL

| NO. | DATE | REVISIONS |
|-----|----------|-----------------------------|
| 1 | 11/11/21 | UPDATE TO 2018 IBC/IRC CODE |
| | | LFS |
| | | BY |

DATE: 11/02/16
SCALE: N.T.S.
DWG. BY: JK
CHK. BY: LFS
DRAWING NO.: TX-4646
SHEET 2 OF 7

Z:\Clients\Endura PERMANENTVB - Texas Dept of Ins\TDI - DR-851 Plastpro FG Opaque (LK,DB)\C - Drawings\TX-4646.dwg

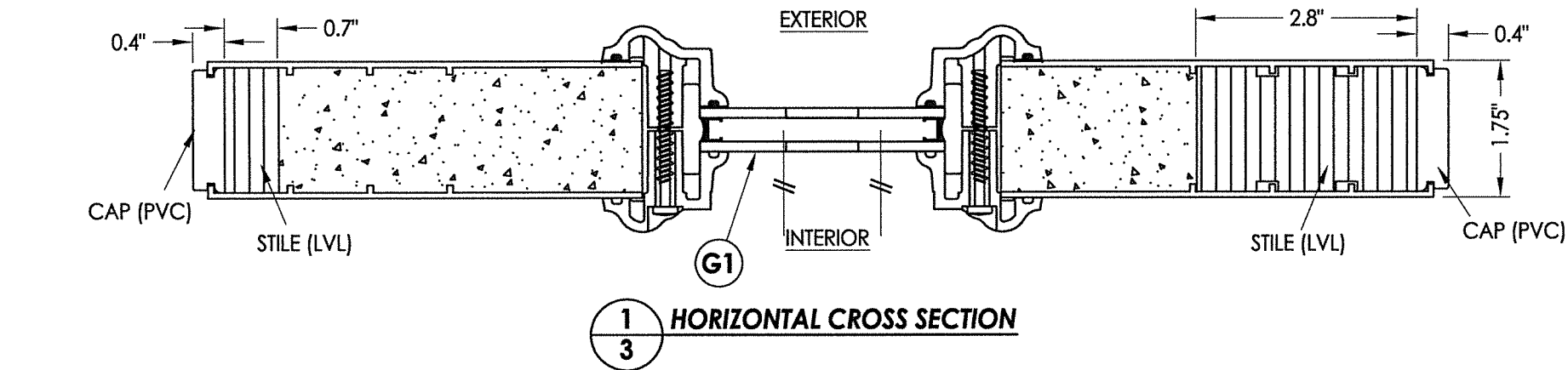

1
3 HORIZONTAL CROSS SECTION

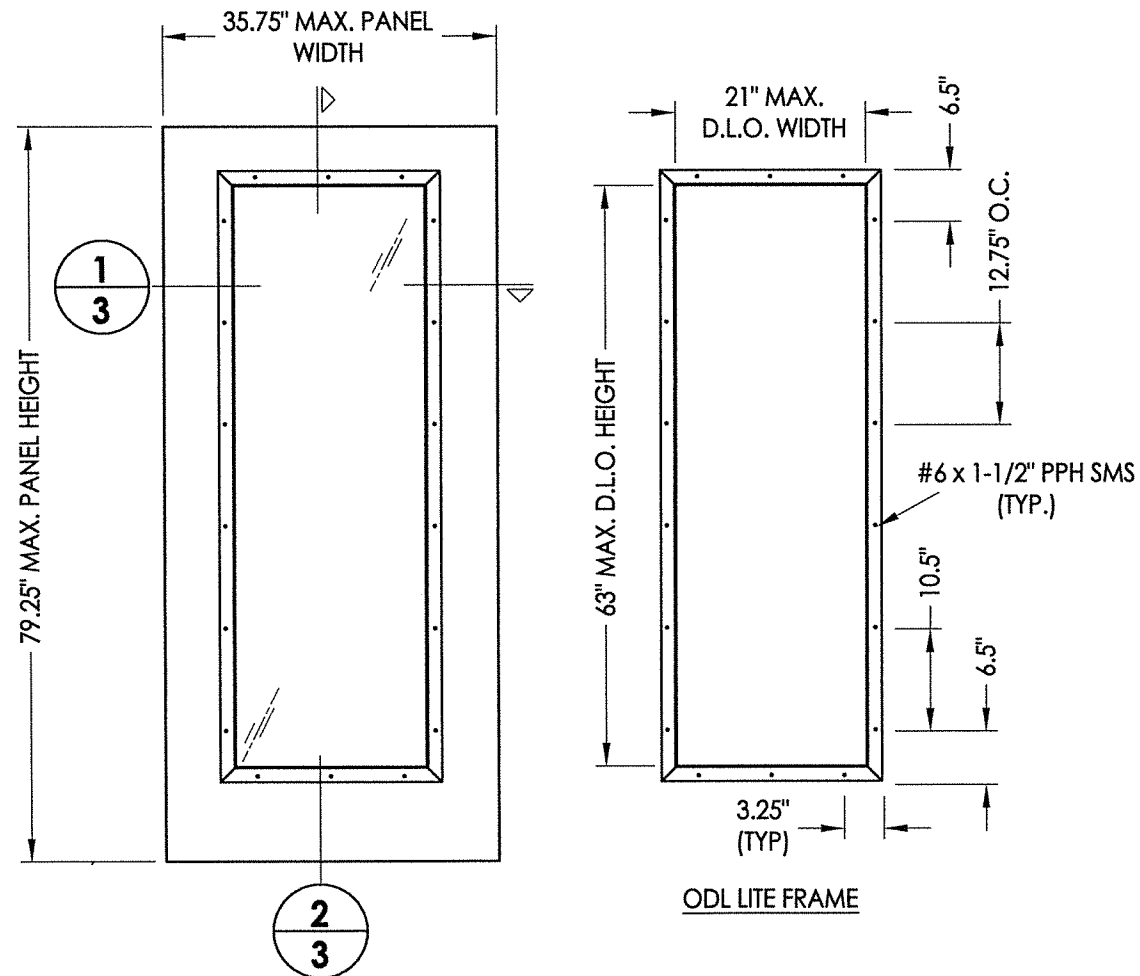

50 SIDELITE PANEL
Plastpro
Fiberglass

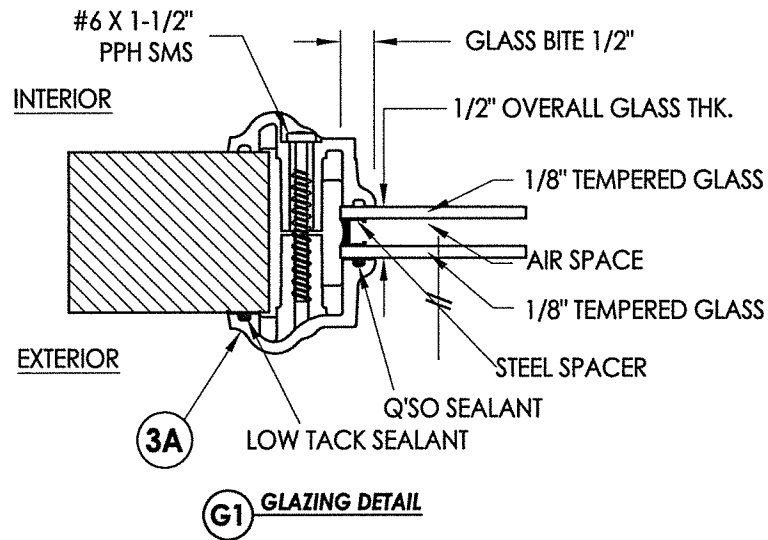

G1 GLAZING DETAIL

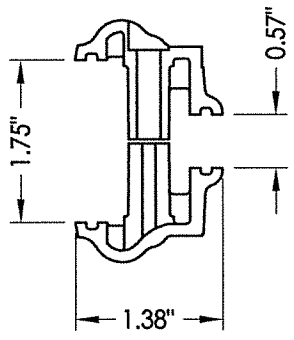

3A ODL LITE FRAME
HP Polypropylene

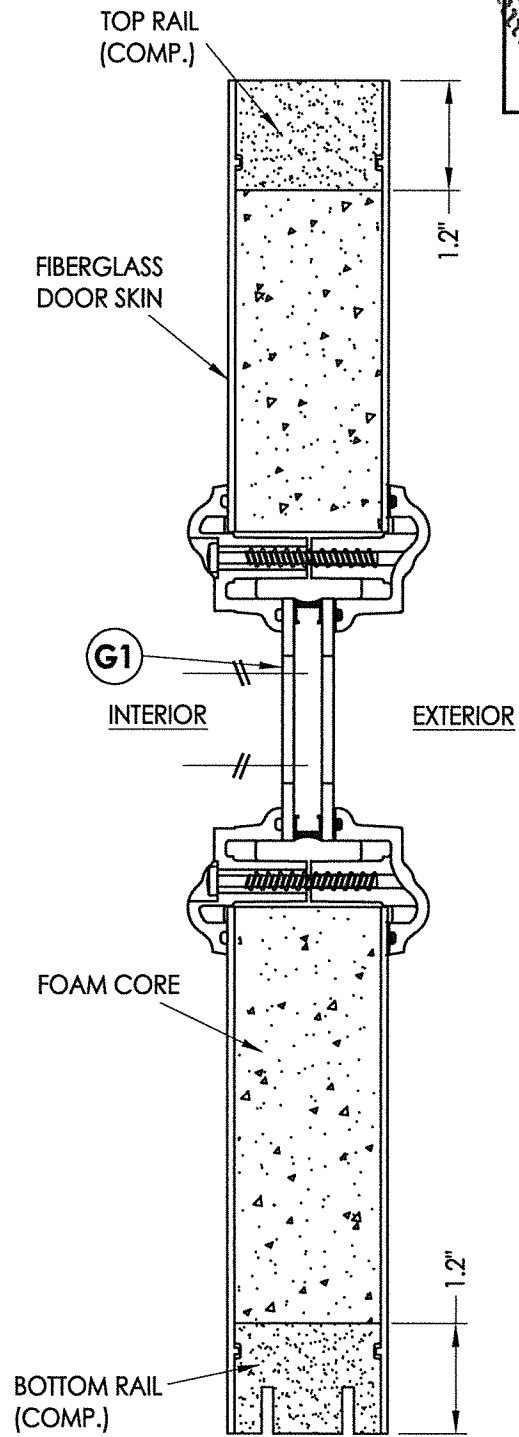

2
3 VERTICAL CROSS SECTION

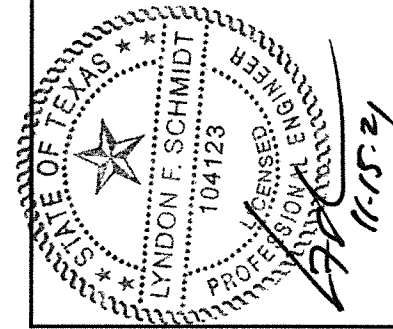

Documents Prepared By: Lyndon F. Schmidt, P.E.
TEXAS P.E. #104123

RW BUILDING CONSULTANTS, INC.
P.O. Box 230 Valrico FL, 33595
Phone No.: 813.659.9197
TEXAS BOARD OF PROFESSIONAL ENGINEERS
CERTIFICATE OF REGISTRATION # F-11852

PRODUCT: ENDURA
PART OR ASSEMBLY: SIDELITE PANEL DETAILS (LIP LITE INSERT GLAZING)

| NO. | DATE | DESCRIPTION | BY |
|-----|----------|-----------------------------|-----|
| 1 | 11/11/21 | UPDATE TO 2018 IBC/IRC CODE | LFS |

DATE: 11/02/16
SCALE: N.T.S.
DWG. BY: JK
CHK. BY: LFS
DRAWING NO.: TX-4646
SHEET 3 OF 7

© 2016 R.W. BUILDING CONSULTANTS INC.

Z:\Clients\Endura PERMANENT\B - Texas Dept of Ins\TDI - DR-851 Plastpro EG Opaque (LK,DB)\C - Drawings\TX-4646.49.dwg

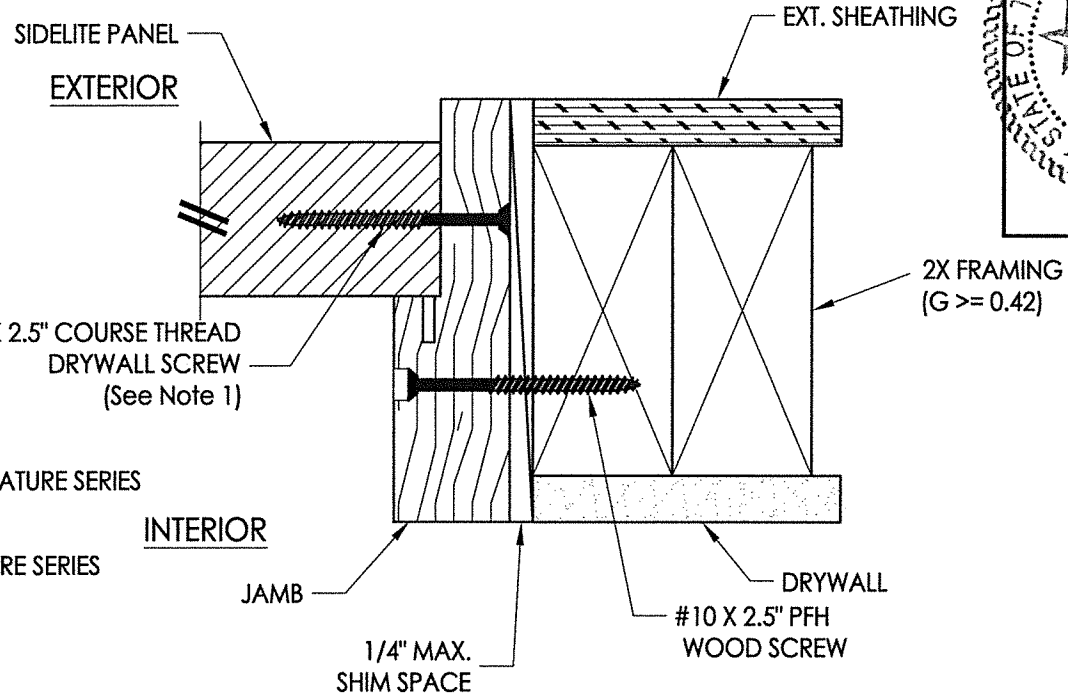
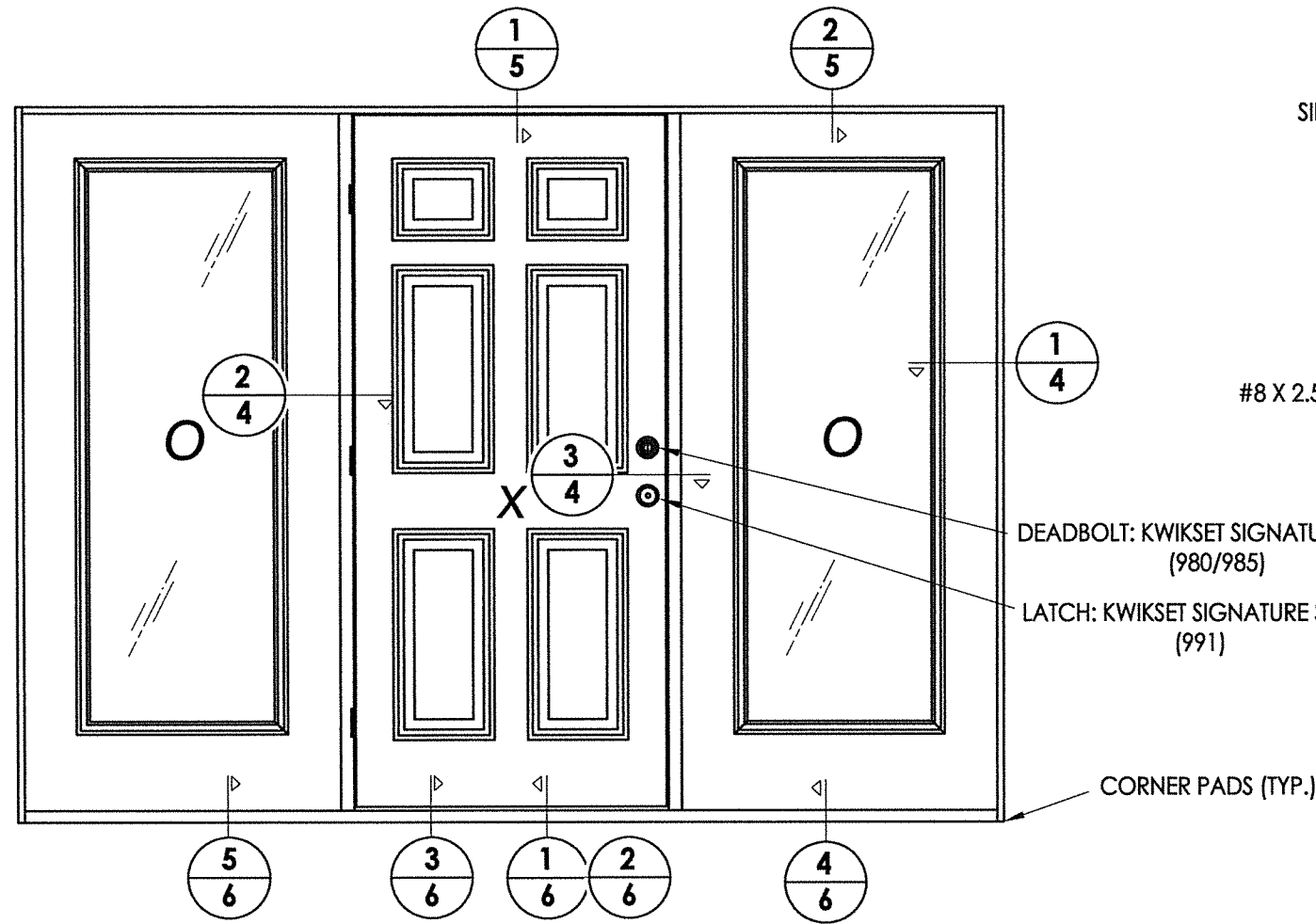

1 HORIZONTAL CROSS SECTION
4 Outswing shown - Inswing also approved

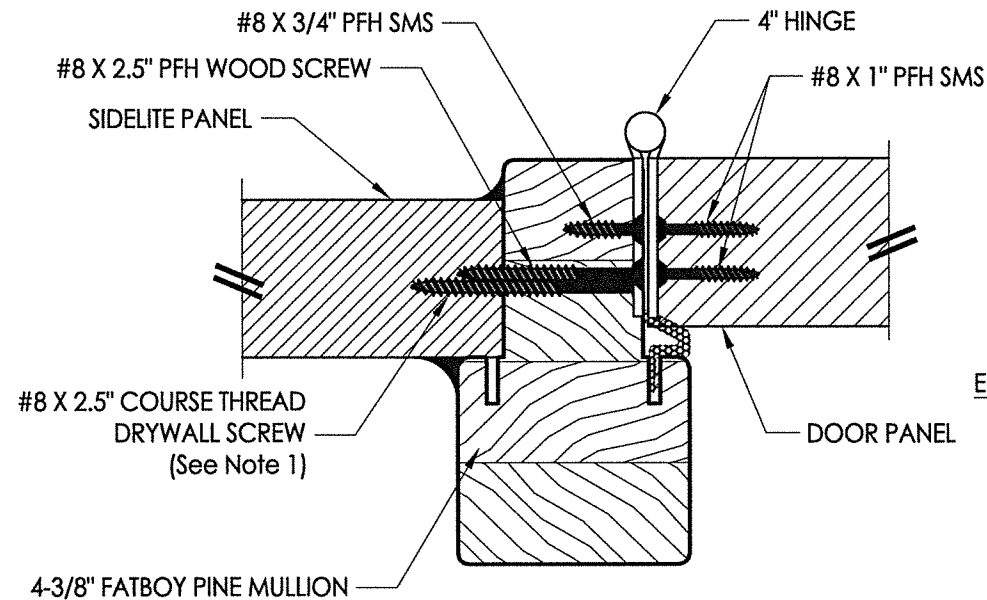
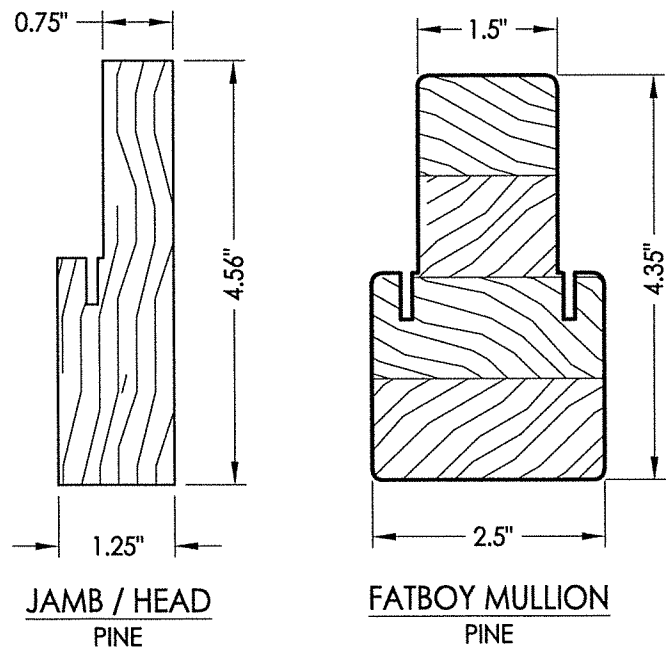

2 HORIZONTAL CROSS SECTION
4 Outswing shown - Inswing also approved

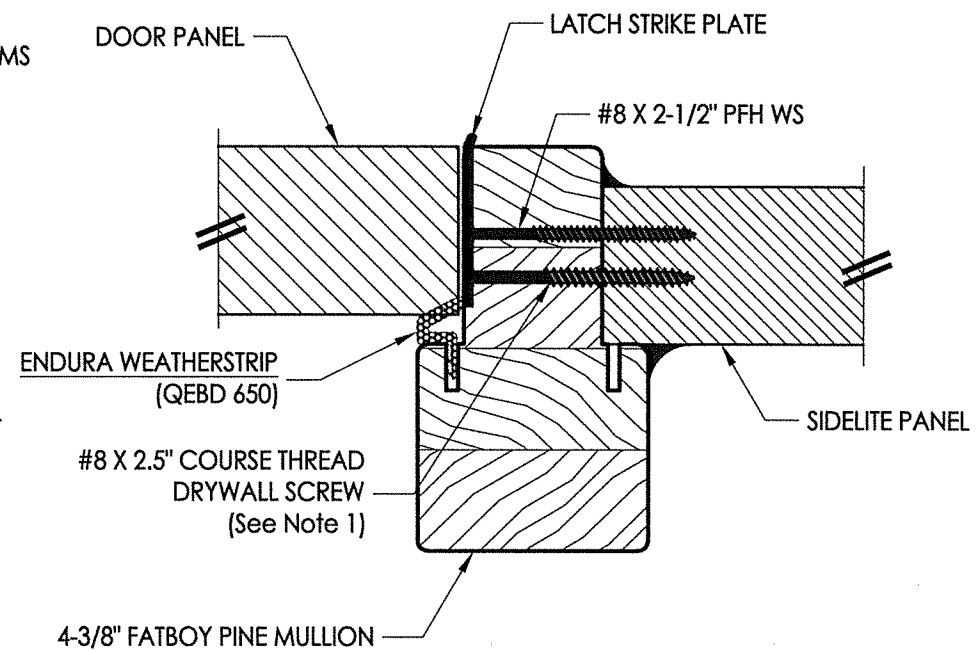

3 HORIZONTAL CROSS SECTION
4 Outswing shown - Inswing also approved

NOTE:
1. Spacing for sidelite screws: 6.5", 38.5" and 69" from head to sill (3 total).

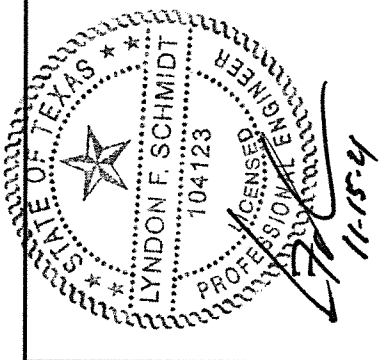

Documents Prepared By: Lyndon F. Schmidt, P.E.
TEXAS P.E. #104123

RW BUILDING CONSULTANTS, INC.
P.O. Box 230 Valrico FL, 33595
Phone No.: 813.659.9197

TEXAS BOARD OF PROFESSIONAL ENGINEERS
CERTIFICATE OF REGISTRATION # F-11852

| | |
|-------------------|---------------------------|
| PRODUCT: | ENDURA |
| PART OR ASSEMBLY: | FIBERGLASS DOOR |
| | HORIZONTAL CROSS SECTIONS |

| NO. | DATE | BY |
|-----------------------------|----------|-----|
| 1 | 11/11/21 | LFS |
| UPDATE TO 2018 IBC/IRC CODE | | |

| | |
|--------------|----------|
| DATE: | 11/02/16 |
| SCALE: | N.T.S. |
| DWG. BY: | JK |
| CHK. BY: | LFS |
| DRAWING NO.: | TX-4646 |
| SHEET | 4 OF 7 |

© 2016 R.W. BUILDING CONSULTANTS INC.

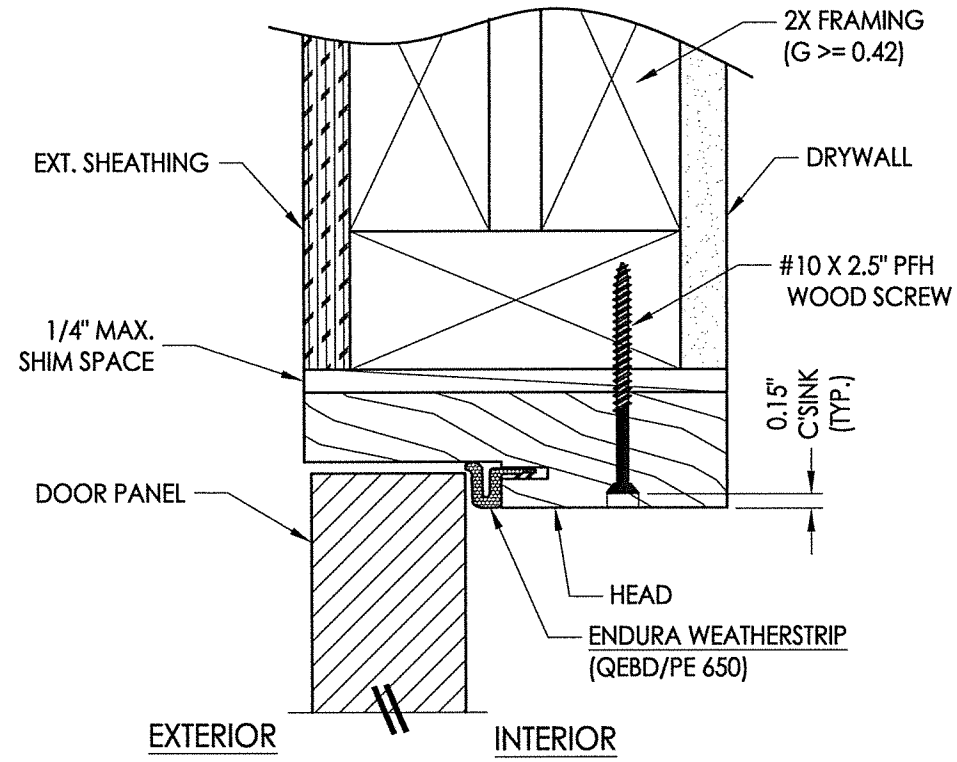

1 VERTICAL CROSS SECTION
5 Outswing shown - inswing also approved

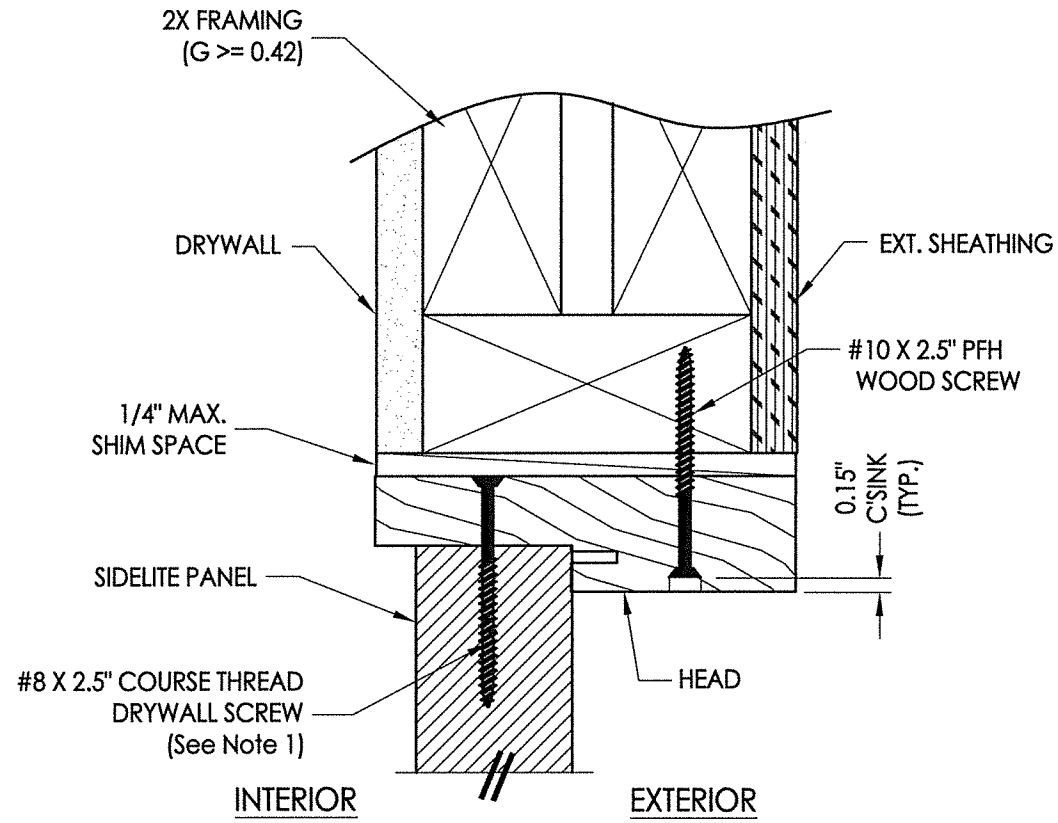

2 VERTICAL CROSS SECTION
5 Inswing shown - Outswing also approved

NOTE:
 1. Spacing for sidelite screws:
 6" from each end (2 total).

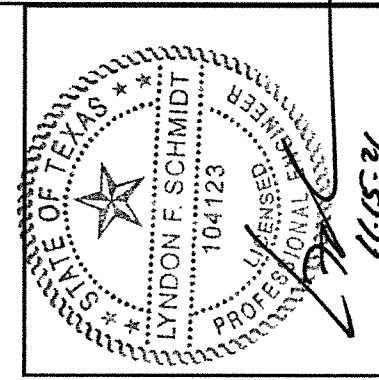

Documents Prepared By: Lyndon F. Schmidt, P.E.
 TEXAS P.E. #104123

RW BUILDING CONSULTANTS, INC.
 P.O. Box 230 Valrico FL 33595
 Phone No.: 813.659.9197

TEXAS BOARD OF PROFESSIONAL ENGINEERS
 CERTIFICATE OF REGISTRATION # F-11852

| | | | |
|----------------------|----------|---|-----|
| PRODUCT: ENDURA | | PART OR ASSEMBLY: VERTICAL CROSS SECTIONS | |
| NO. | DATE | DESCRIPTION | BY |
| 1 | 11/11/21 | UPDATE TO 2018 IBC/IRC CODE | LFS |
| REVISIONS | | | |
| DATE: 11/02/16 | | | |
| SCALE: N.T.S. | | | |
| DWG. BY: JK | | | |
| CHK. BY: LFS | | | |
| DRAWING NO.: TX-4646 | | | |
| SHEET 5 OF 7 | | | |

Z:\Clients\Endura PERMANENT\B - Texas Dept of Ins\TDI - DR-851 Plastpro FG Opaque (LK,DB)\C - Drawings\TX-4646.49.dwg

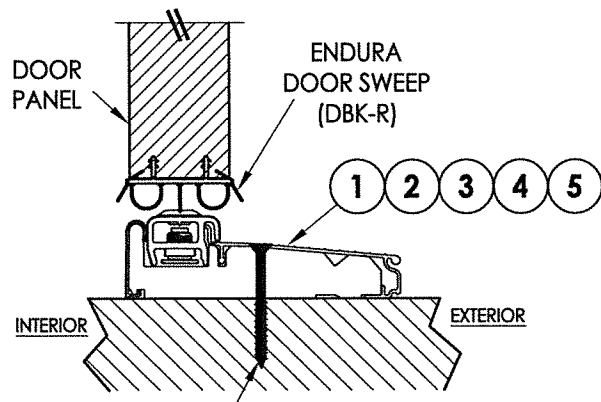

#10 X 2.5" PFH WOOD SCREW OR
1/4" X 2-3/4" DeWALT OR ITW CONCRETE SCREW

1 VERTICAL CROSS SECTION
6 Inswing Adjustable Threshold

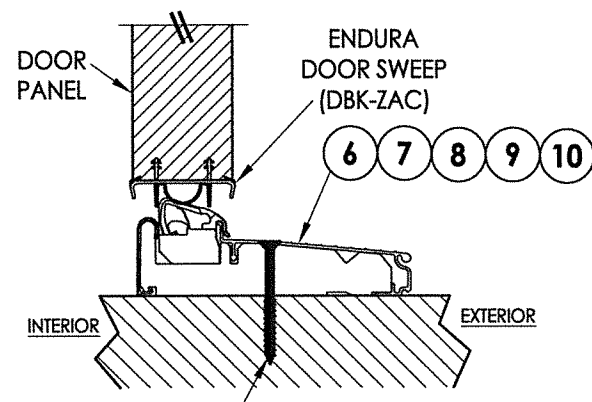

#10 X 2.5" PFH WOOD SCREW OR
1/4" X 2-3/4" DeWALT OR ITW CONCRETE SCREW

2 VERTICAL CROSS SECTION
6 Inswing Articulating Threshold

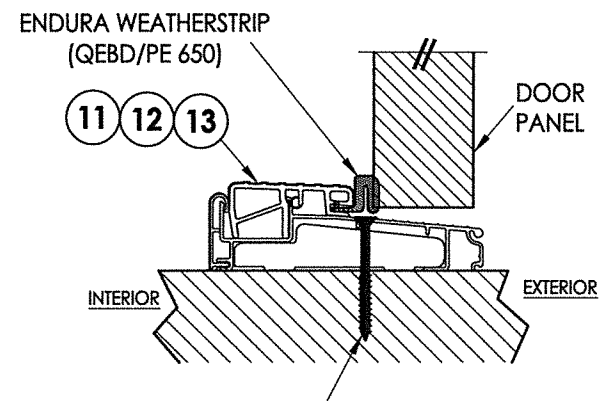

#10 X 2.5" PFH WOOD SCREW OR
1/4" X 2-3/4" DeWALT OR ITW CONCRETE SCREW

3 VERTICAL CROSS SECTION
6 Outswing Bump Threshold

NOTE:
1. Spacing for sidelite screws:
6" from each end (2 total).

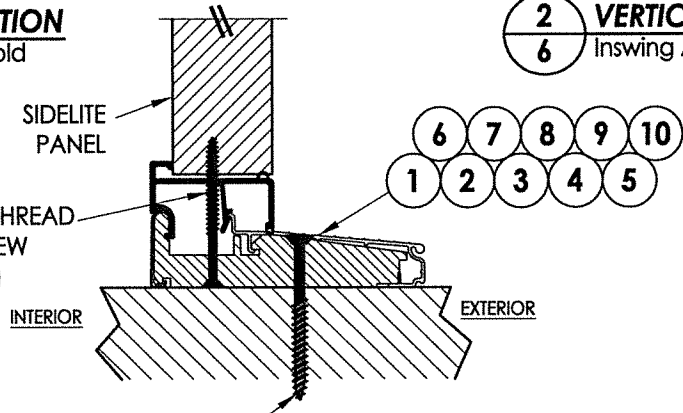
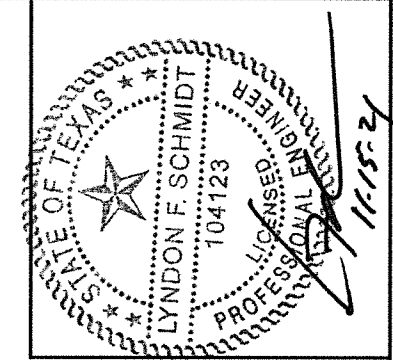

#8 X 2.5" COURSE THREAD
DRYWALL SCREW
(SEE NOTE 1)

#10 X 2.5" PFH WOOD SCREW OR
1/4" X 2-3/4" DeWALT OR ITW CONCRETE SCREW

4 VERTICAL CROSS SECTION
6 Inswing configuration

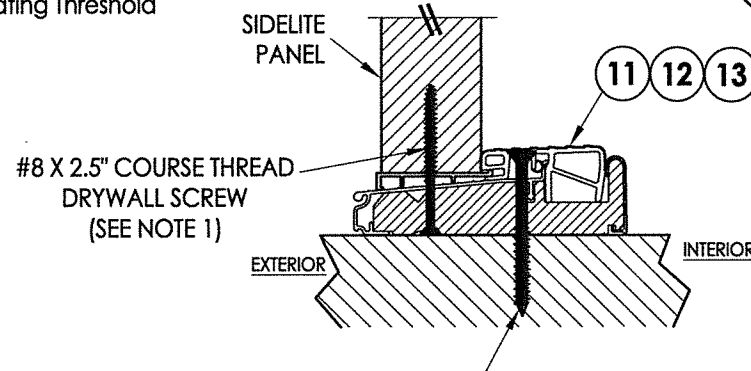

#8 X 2.5" COURSE THREAD
DRYWALL SCREW
(SEE NOTE 1)

#10 X 2.5" PFH WOOD SCREW OR
1/4" X 2-3/4" DeWALT OR ITW CONCRETE SCREW

5 VERTICAL CROSS SECTION
6 Outswing configuration

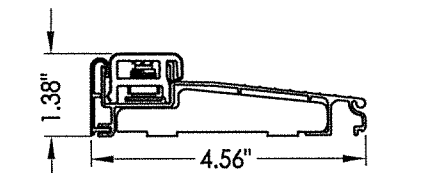

1 INSWING ADJUSTABLE THRESHOLD
ZAIL4565

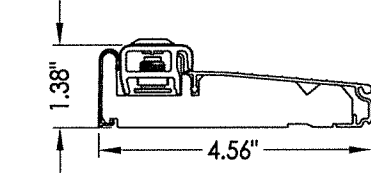

2 INSWING ADJUSTABLE THRESHOLD
ZAI4565FN

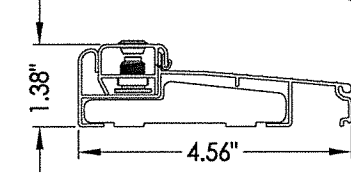

3 INSWING ADJUSTABLE THRESHOLD
ZAILA4565

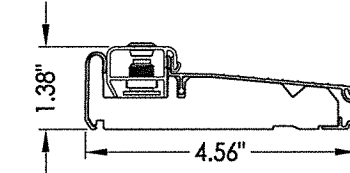

4 INSWING ADJUSTABLE THRESHOLD
ZAI4565FN

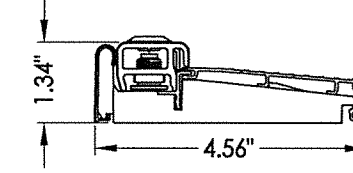

5 INSWING ADJUSTABLE THRESHOLD
ZAI4565RDS

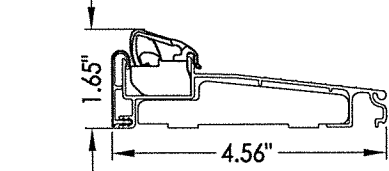

6 INSWING ARTICULATING THRESHOLD
ZACL4565

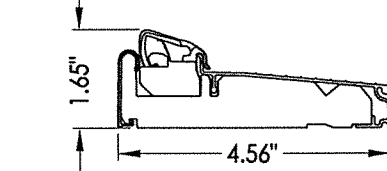

7 INSWING ARTICULATING THRESHOLD
ZAC4565FN

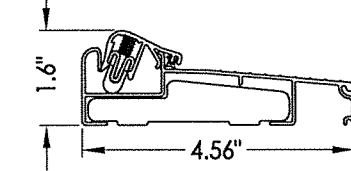

8 INSWING ARTICULATING THRESHOLD
ZACLA4565

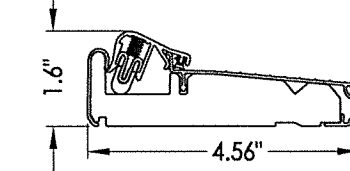

9 INSWING ARTICULATING THRESHOLD
ZACAA4565FN

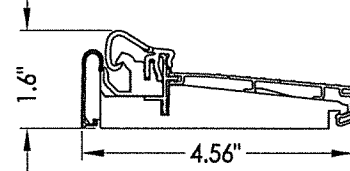

10 INSWING ARTICULATING THRESHOLD
ZAC4565RDS

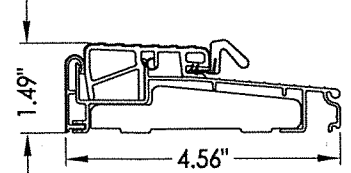

11 OUTSWING THRESHOLD
ZOBL4565

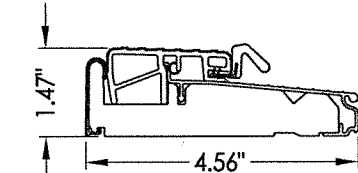

12 OUTSWING THRESHOLD
ZOB4565FN

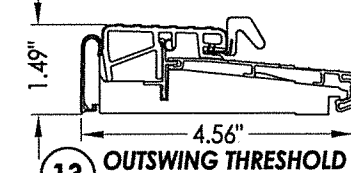

13 OUTSWING THRESHOLD
ZOB4565RDS

MAX. DESIGN PRESSURE = ±55 PSF

Documents Prepared By: Lyndon F. Schmidt, P.E.
TEXAS P.E. #104123

RW BUILDING CONSULTANTS, INC.
P.O. Box 230 Valrico FL 33595
Phone No.: 813.659.9197

TEXAS BOARD OF PROFESSIONAL ENGINEERS
CERTIFICATE OF REGISTRATION # F-11652

PRODUCT: ENDURA
FIBERGLASS DOOR

PART OR ASSEMBLY:
VERTICAL CROSS SECTIONS

| NO. | DATE | REVISIONS |
|-----|----------|-----------------------------|
| 1 | 11/11/21 | UPDATE TO 2018 IBC/IRC CODE |
| | | LFS |
| | | BY |

DATE: 11/02/16
SCALE: N.T.S.
DWG. BY: JK
CHK. BY: LFS
DRAWING NO.: TX-4646
SHEET 6 OF 7

Z:\Clients\Endura Permanent\B - Texas Dept of Ins\TDI - DR-851 Plastpro FG Opaque (L,K,DB)\C - Drawings\TX-4646.dwg

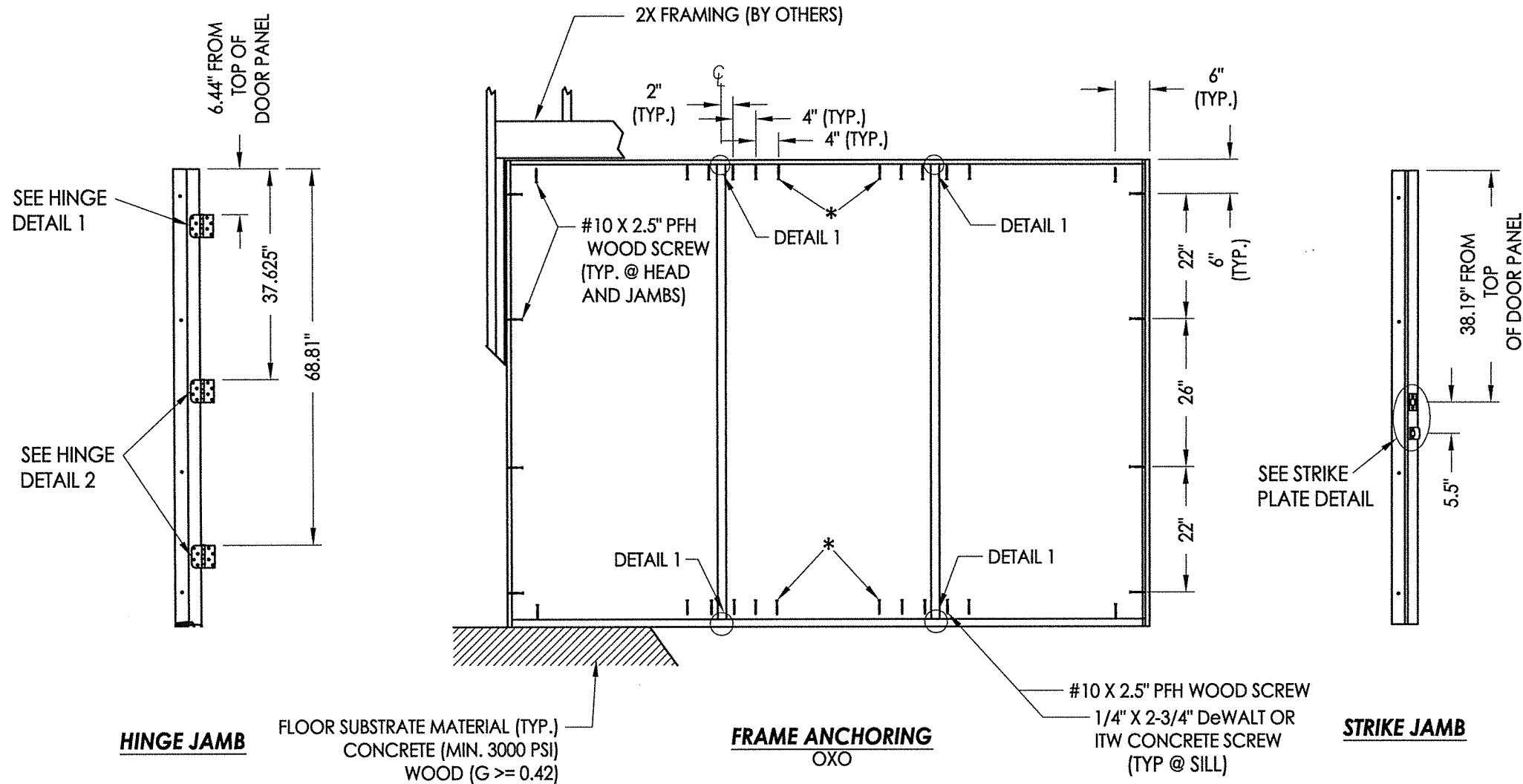

* NOTE: These additional anchors required for D.P. > 45 PSF.

CONCRETE ANCHOR NOTES:

- Concrete anchor locations at the corners may be adjusted to maintain the min. edge distance to mortar joints.
- Concrete anchor locations noted as "MAX. ON CENTER" must be adjusted to maintain the min. edge distance to mortar joints, additional concrete anchors may be required to ensure the "MAX. ON CENTER" dimension are not exceeded.
- Concrete anchor table:

| ANCHOR TYPE | ANCHOR SIZE | MIN. EMBEDMENT | MIN. CLEARANCE TO MASONRY EDGE | MIN. CLEARANCE TO ADJACENT ANCHOR |
|-------------------|-------------|----------------|--------------------------------|-----------------------------------|
| ITW TAPCON® | 1/4" | 1-3/4" | 1-1/2" | 4" |
| DeWALT ULTRACON+® | 1/4" | 1-3/4" | 1" | 4" |

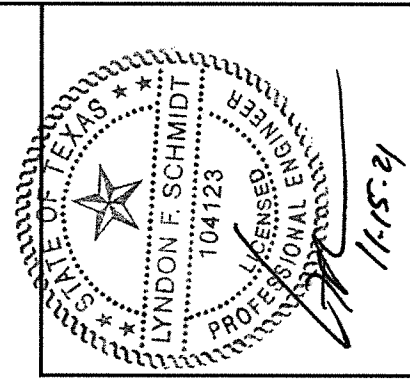
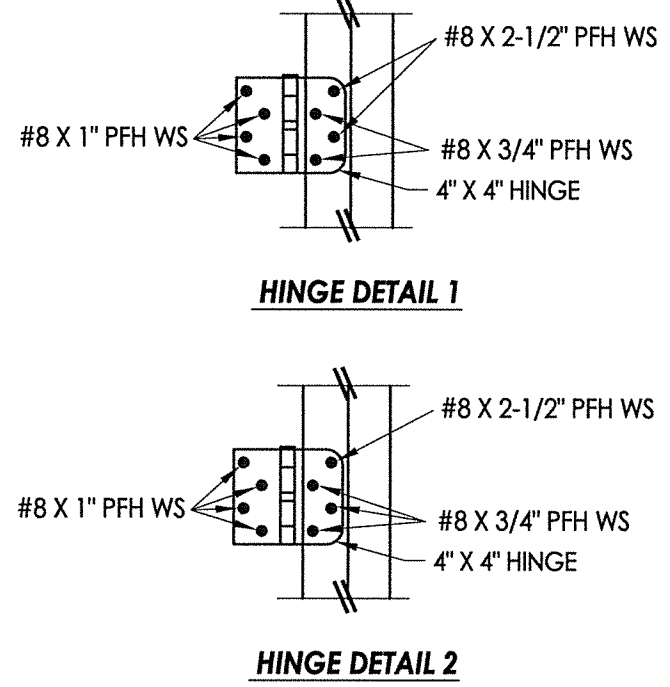
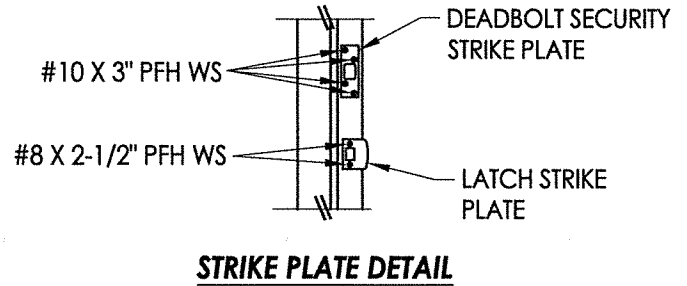
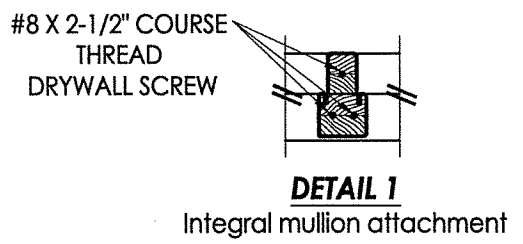

Documents Prepared By: Lyndon F. Schmidt, P.E.
TEXAS P.E. #104123

RW BUILDING CONSULTANTS, INC.
P.O. Box 230 Valrico FL 33595
Phone No.: 813.659.9197

TEXAS BOARD OF PROFESSIONAL ENGINEERS
CERTIFICATE OF REGISTRATION # F-11852

| | | |
|-----------------------------|-----------------|-----|
| PRODUCT: | ENDURA | |
| PART OR ASSEMBLY: | FRAME ANCHORING | |
| DATE: | 11/02/16 | |
| SCALE: | N.T.S. | |
| DWG. BY: | JK | |
| CHK. BY: | LFS | |
| DRAWING NO.: | TX-4646 | |
| SHEET | 7 OF 7 | |
| REVISIONS | | |
| NO. | DATE | BY |
| 1 | 11/11/21 | LFS |
| UPDATE TO 2018 IBC/IRC CODE | | |

© 2016 R.W. BUILDING CONSULTANTS INC.