

# SIMPSON DOOR COMPANY

## ***GLAZED & OPAQUE I.S. EXTERIOR WOOD DOORS***

### **INSTALLATION ANCHORAGE DETAILS**

**GENERAL NOTES:**

1. THE PRODUCT SHOWN HEREIN IS DESIGNED TO COMPLY WITH THE 2018 INTERNATIONAL BUILDING CODE AND 2018 INTERNATIONAL RESIDENTIAL CODE AT THE DESIGN PRESSURES STATED HEREIN.
2. THE PRODUCT DETAILS CONTAINED HEREIN ARE BASED UPON SIGNED AND SEALED TEST REPORT(S) NO. CCLI-10-115 AND ASSOCIATED LABORATORY DRAWINGS.
3. ADEQUACY OF THE EXISTING STRUCTURAL CONCRETE / MASONRY AND 2X FRAMING AS A MAIN WIND FORCE RESISTING SYSTEM CAPABLE OF WITHSTANDING AND TRANSFERRING APPLIED PRODUCT LOADS TO THE STRUCTURE IS THE RESPONSIBILITY OF THE ARCHITECT OR ENGINEER OF RECORD.
4. 1X AND 2X BUCKS (WHEN USED) SHALL BE DESIGNED AND ANCHORED TO PROPERLY TRANSFER ALL LOADS TO THE STRUCTURE. BUCK DESIGN AND INSTALLATION IS THE RESPONSIBILITY OF THE ARCHITECT OR ENGINEER OF RECORD.
5. THE INSTALLATION DETAILS DESCRIBED HEREIN ARE GENERIC AND MAY NOT REFLECT ACTUAL CONDITIONS FOR A SPECIFIC SITE. IF SITE CONDITIONS CAUSE INSTALLATION TO DEVIATE FROM THE REQUIREMENTS DETAILED HEREIN, SITE SPECIFIC DOCUMENTS SHALL BE PREPARED FOR USE WITH THIS DOCUMENT.
6. THESE DOOR ASSEMBLIES DO NOT SATISFY THE TEXAS DEPARTMENT OF INSURANCE'S CRITERIA FOR PROTECTION FROM WINDBORNE DEBRIS. THESE DOOR ASSEMBLIES WILL NEED TO BE PROTECTED WITH AN IMPACT PROTECTIVE SYSTEM WHEN INSTALLED IN AREAS WHERE WINDBORNE DEBRIS PROTECTION IS REQUIRED.
7. MATERIALS AND COMPONENTS:
  - 7.1. DOOR FRAME: PINE
  - 7.2. PANEL CORE MATERIAL: WESTERN HEMLOCK OR DOUGLAS FIR
  - 7.3. PANEL FACE VENEER: VARIABLE
  - 7.4. HINGES: 4 X 4 BUTT
  - 7.5. LATCH & DEADBOLT: KWIKSET SERIES 740 LOCKSET W/KWIKSET SERIES 980 DEADBOLT.
  - 7.6. LATCH & DEADBOLT: SCHLAGE F SERIES HANDLE SET W/SCHLAGE B60 DEADBOLT.
  - 7.7. MULT-POINT LOCKING HARDWARE: W & F MULTI-POINT TRILENNIUM 3000 SERIES.
  - 7.8. SURFACE BOLTS: IVES #253B BRASS.
  - 7.9. ASTRAGAL: ENDURA ULTIMATE ALUMINUM ASTRAGAL.
  - 7.10. THRESHOLD: ENDURA PRODUCTS ALUMINUM INSWING ADJUSTABLE #ZAI5625.
  - 7.11. THRESHOLD: YOUNG MFG. ALUMINUM/OAK INSWING.
  - 7.12. THRESHOLD: ALUMINUM INSWING ADA SILL
8. APPROVED CORNER CONSTRUCTION
  - 8.1. WOOD DOWEL SERIES
  - 8.2. MORTISE AND TENON SERIES
9. GLASS MEETS THE REQUIREMENTS OF ASTM E1300-12AE1 GLASS CHARTS. SEE SHEET 7 FOR GLAZING DETAIL. QUALIFIED GLAZING INCLUDES:
  - 9.1. 1/8" TEMPERED GLASS
  - 9.2. 3/4" O.V. INSULATING GLASS CONSISTING OF 1/8" TEMPERED GLASS x 1/2" AIR SPACE x 1/8" TEMPERED GLASS
10. DESIGNATIONS "X" AND "O" STAND FOR THE FOLLOWING (AS APPLICABLE):
  - 10.1. X: OPERABLE PANEL
  - 10.2. O: FIXED PANEL

**INSTALLATION NOTES:**

1. ONE (1) INSTALLATION ANCHOR IS REQUIRED AT EACH ANCHOR LOCATION SHOWN.
2. THE NUMBER OF INSTALLATION ANCHORS DEPICTED IS THE MINIMUM NUMBER OF ANCHORS TO BE USED FOR PRODUCT INSTALLATION. IN ADDITION TO THE INSTALLATION ANCHORS SHOWN, TWO (2) INSTALLATION ANCHORS ARE REQUIRED IN EACH HINGE. LOCATE HINGE ANCHORS IN THE TOP HOLE OF EACH HINGE LEAF INTO THE HINGE JAMB. ANCHORS ARE TO MATCH TYPE AND EMBEDMENT OF THOSE SHOWN HEREIN FOR RESPECTIVE SUBSTRATE.
3. SHIM AS REQUIRED AT EACH INSTALLATION ANCHOR WITH LOAD BEARING SHIM(S). MAXIMUM ALLOWABLE SHIM SIZE IS 1/4 INCH. SHIM WHERE SPACE OF 1/16 INCH OR GREATER OCCURS. SHIM(S) SHALL BE CONSTRUCTED OF HIGH DENSITY PLASTIC OR BETTER.
4. FOR INSTALLATION INTO WOOD FRAMING, USE #10 WOOD SCREWS OF SUFFICIENT LENGTH TO ACHIEVE 1 1/2 INCH MINIMUM EMBEDMENT.
5. FOR INSTALLATION THROUGH 1X BUCK TO CONCRETE / MASONRY, OR DIRECTLY INTO CONCRETE / MASONRY, USE 3/16 INCH ITW ADVANCED THREADFORM TECHNOLOGY TAPCONS OR EQUAL OF SUFFICIENT LENGTH TO ACHIEVE 1 INCH MINIMUM EMBEDMENT FOR CMU BLOCK AND 1 1/2 INCH MINIMUM EMBEDMENT FOR CONCRETE.
6. MINIMUM EMBEDMENT AND EDGE DISTANCE EXCLUDE WALL FINISHES (INCLUDING BUT NOT LIMITED TO STUCCO, FOAM, BRICK VENEER AND SIDING).
7. FOR CONCRETE BLOCK, DO NOT INSTALL INSTALLATION ANCHORS INTO MORTAR JOINTS. EDGE DISTANCE IS MEASURED FROM FREE EDGE OF BLOCK OR EDGE OF MORTAR JOINT INTO FACE SHELL OF BLOCK.
8. INSTALLATION ANCHOR CAPACITIES FOR PRODUCTS HEREIN ARE BASED ON SUBSTRATE MATERIALS WITH THE FOLLOWING PROPERTIES:
  - A. WOOD - MINIMUM SPECIFIC GRAVITY OF 0.42.
  - B. CONCRETE - MINIMUM COMPRESSIVE STRENGTH OF 2000 PSI.
  - C. MASONRY - STRENGTH CONFORMANCE TO ASTM C-90.

TABLE OF CONTENTS	
SHEET	SHEET DESCRIPTION
1	GENERAL NOTES, INSTALLATION NOTES & D.P. CHART
2	ELEVATION AND ANCHOR LAYOUT
3	ANCHOR LAYOUT
4	ANCHOR LAYOUT
5	VERTICAL SECTIONS & GLAZING DETAIL
6	HORIZONTAL SECTIONS
7	BILL OF MATERIALS AND GLAZING
8	TYPICAL APPROVED PANEL CONFIGURATIONS

DESIGN PRESSURE RATING (PSF)		
MAXIMUM SIZE OF DOORS	WHERE WATER INFILTRATION REQUIREMENT IS NOT NEEDED	
	W/SURFACE BOLTS W/STANDARD LOCKS	W/O SURFACE BOLTS W/STANDARD LOCKS
6'-2" x 8'-2" DOOR (XX)	±50.0 PSF	±35.0 PSF
3'-1 1/2" x 8'-2" DOOR (X)		

DESIGN PRESSURE RATING (PSF)		
MAXIMUM SIZE OF DOORS	WHERE WATER INFILTRATION REQUIREMENT IS NOT NEEDED	
	MULTI-POINT LOCK	
6'-2" x 8'-2" DOOR (XX)	±40.0 PSF	
3'-1 1/2" x 8'-2" DOOR (X)		

PROJECT: #419-1112

**SIMPSON DOOR COMPANY**  
 400 W. SIMPSON AVENUE  
 McCLEARY, WASHINGTON 98557  
**GLAZED & OPAQUE WOOD DOORS**  
**GENERAL AND INSTALLATION NOTES**

DRAWN BY: T.J.H.  
 SCALE: N.T.S.  
 DATE: 05/31/12  
 DRAWING NO: SIMP2060  
 SHEET: 1 OF 8  
 REV: A

**PTC**  
 PTC PRODUCT DESIGN GROUP, LLC  
 PO BOX 520775  
 LONGWOOD, FLORIDA 32752  
 TX CERTIFICATE OF REGISTRATION NO. F-13740  
 Phone: 321.690.1788  
 Fax: 321.690.1789  
 Email: info@ptc-corp.com

Robert J. Amoruso  
TX P.E. No. 80817

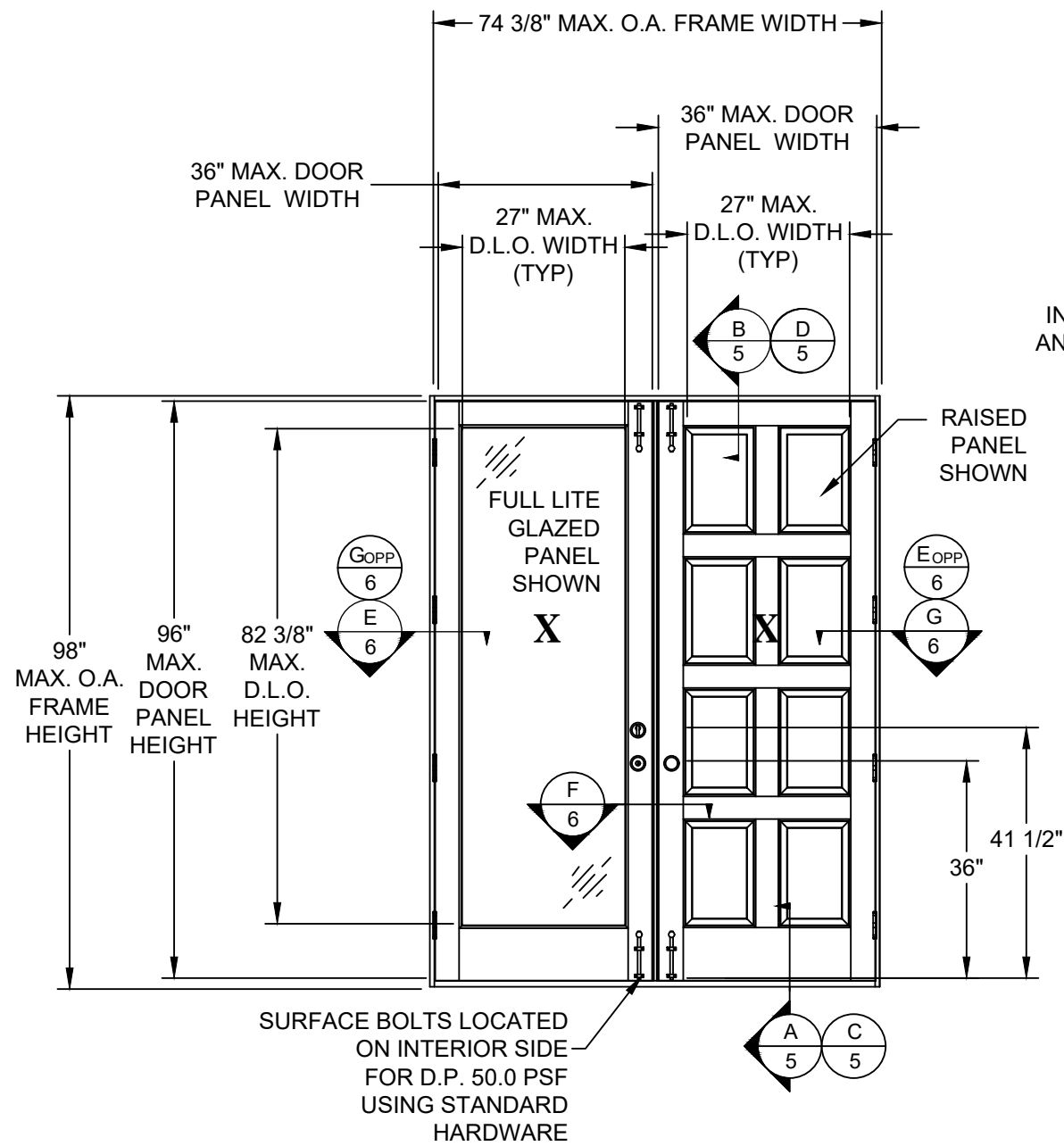

**ELEVATION**

INTERIOR VIEW  
(SHOWN W/ OPTIONAL SURFACE BOLTS)

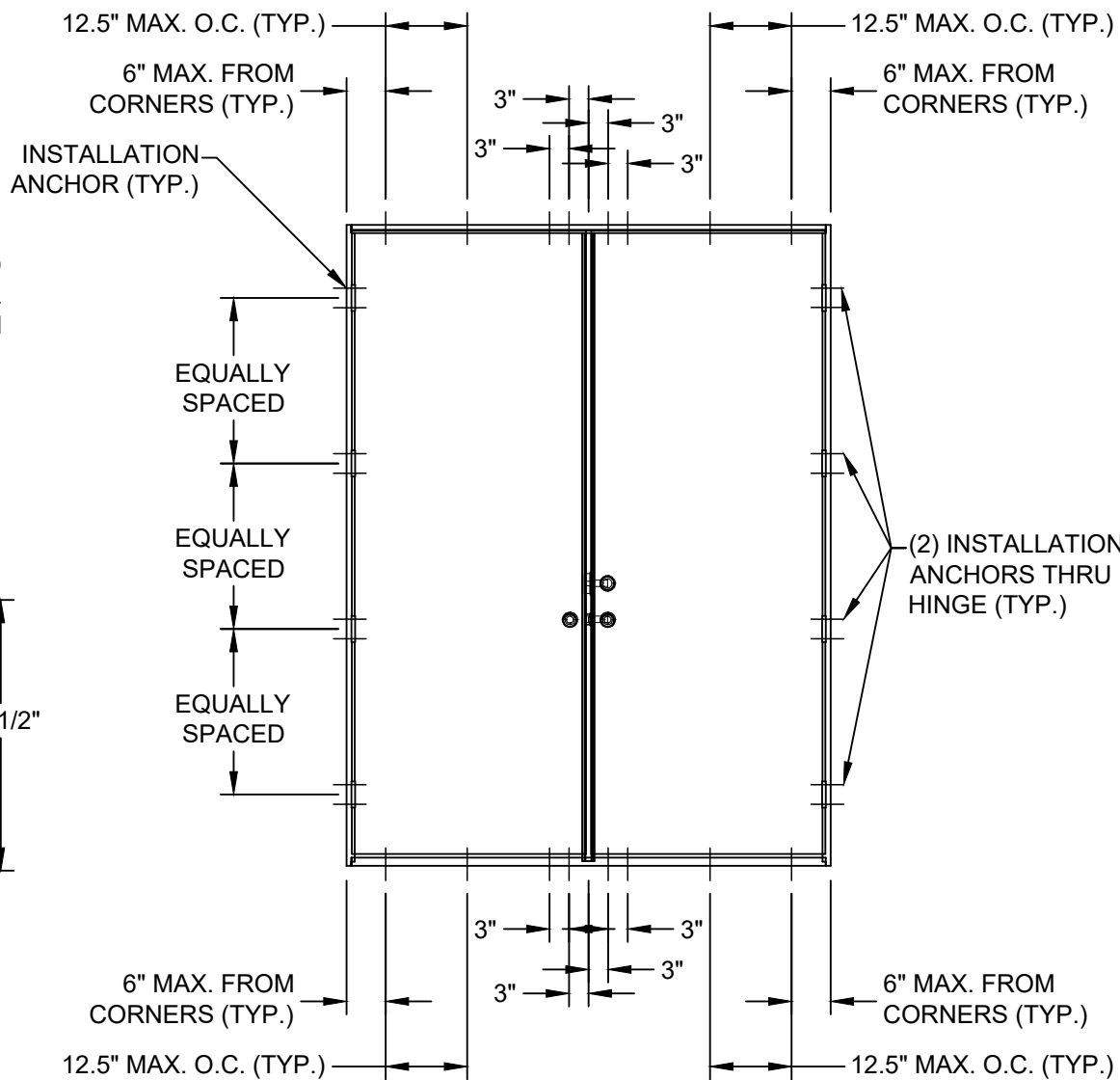

**ANCHOR LAYOUT**

**35.0 D.P. W/O SURFACE BOLTS**

INTERIOR VIEW  
(SEE INSTALLATION NOTE 2)

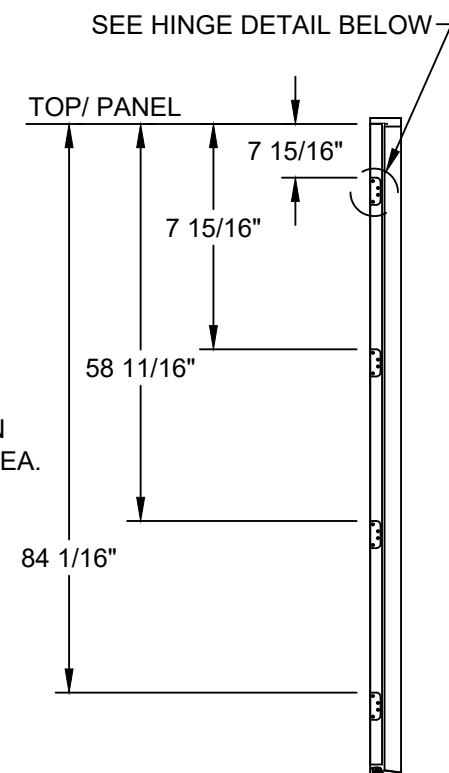

**HINGE JAMB ELEVATION**

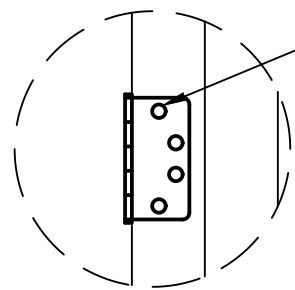

INSTALLATION ANCHOR  
(SEE INSTALLATION NOTE 2, SHEET 1)

**HINGE DETAIL**

PROJECT: #419-1112

SIMPSON DOOR COMPANY  
400 W. SIMPSON AVENUE  
MCCLEARY, WASHINGTON 98557  
GLAZED & OPAQUE WOOD DOORS  
ELEVATION & ANCHOR LAYOUT

DATE:	05/31/12	DRAWING NO.:	SIMP2060	REV:	2 OF 8
DRAWN BY:	TJH	SCALE:	N.T.S.	REV:	A
PREPARED BY:					
TX CERTIFICATE OF REGISTRATION:					
PHONE:	321.690.1788	FAX:	321.690.1789		
EMAIL:	info@ptc-corp.com				
DESCRIPTION:	UPDATE FOR RE-EVALUATION	DATE:	10/26/21	BY:	RIA

Robert J. Amoruso  
TX P.E. No. 80817



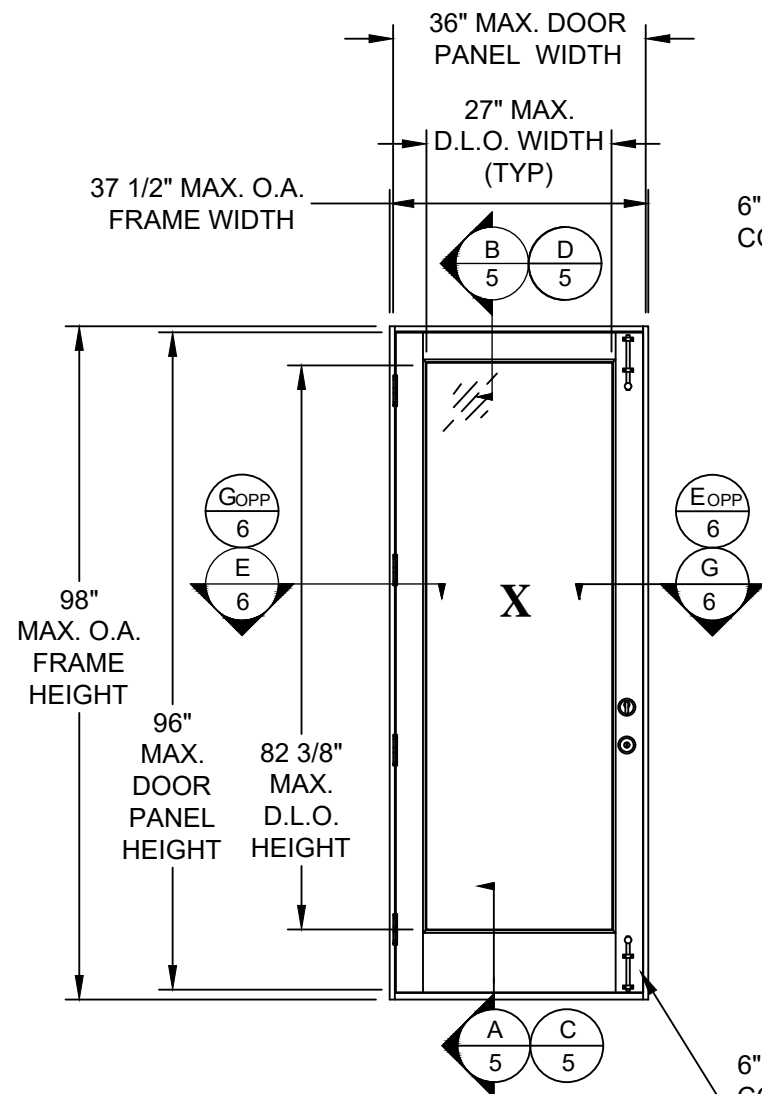

SURFACE BOLTS LOCATED ON INTERIOR SIDE FOR D.P. 50.0 PSF USING STANDARD HARDWARE

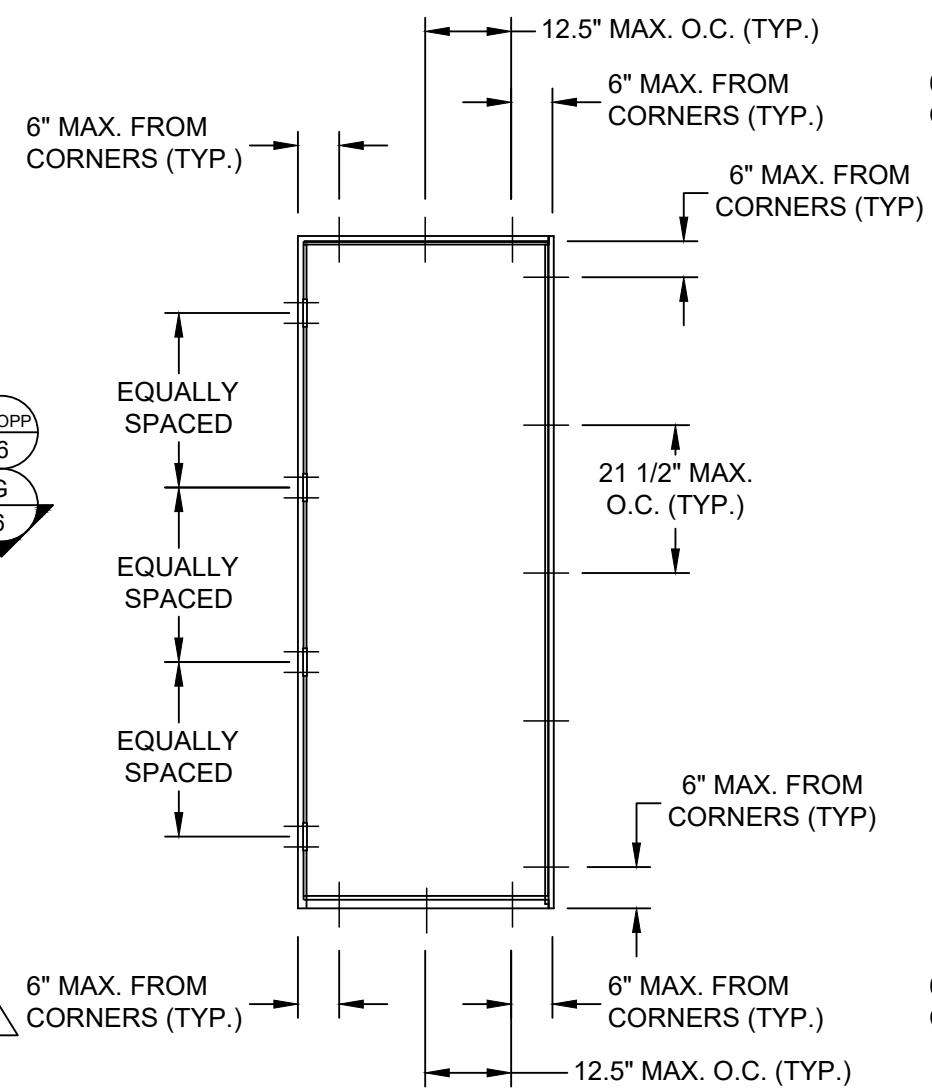

**ANCHOR LAYOUT**  
**35.0 & 40.0 D.P. W/O SURFACE BOLTS**  
**OR WITH MULTIPOINT**  
 INTERIOR VIEW  
 (SEE INSTALLATION NOTE 2)

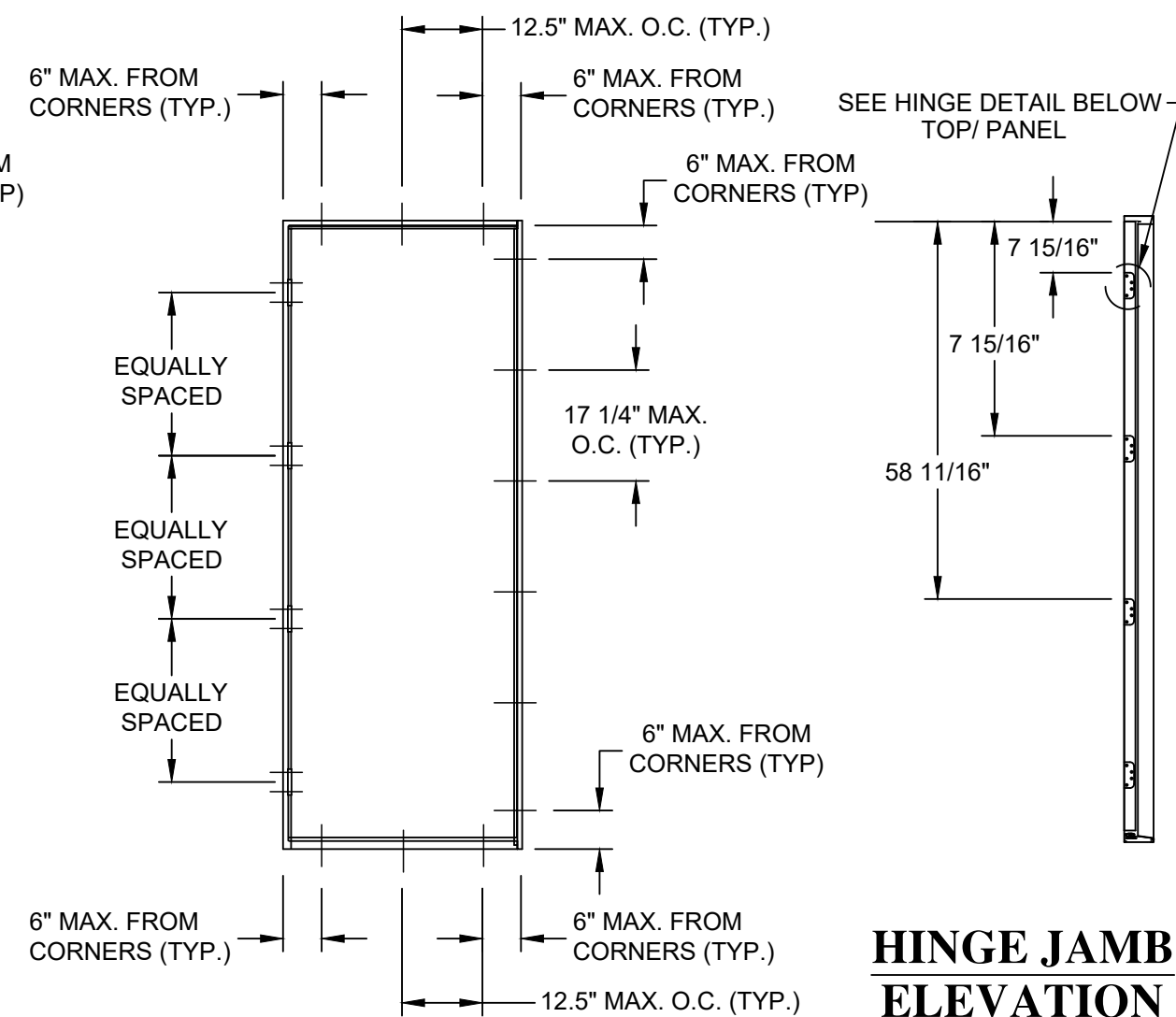

**ANCHOR LAYOUT**  
**50.0 PSF W/ SURFACE BOLTS**  
 INTERIOR VIEW  
 (SEE INSTALLATION NOTE 2)

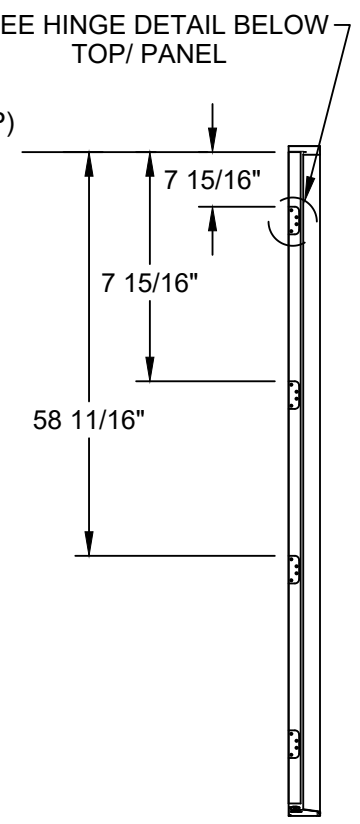

**HINGE JAMB**  
**ELEVATION**

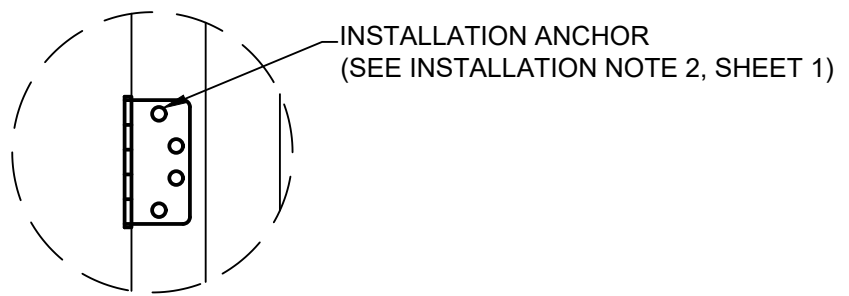

**HINGE DETAIL**

PROJECT: #419-1112

<b>SIMPSON DOOR COMPANY</b> 400 W. SIMPSON AVENUE McCLEARY, WASHINGTON 98557		DATE: 05/31/12 DRAWING NO: SIMP2060 SHEET: 4 OF 8
TITLE: <b>GLAZED &amp; OPAQUE WOOD DOORS</b> <b>ELEVATION &amp; ANCHOR LAYOUT</b>		DRAWN BY: TJH SCALE: N.T.S. REV: A
PREPARED BY: <b>PTC</b>		PTC PRODUCT DESIGN GROUP, LLC PO BOX 520775 LONGWOOD, FLORIDA 32752 TX CERTIFICATE OF REGISTRATION: F-13749 Phone: 321.690.1788 Fax: 321.690.1789 Email: info@ptc-corp.com

Robert J. Amoruso  
 TX P.E. No. 80817

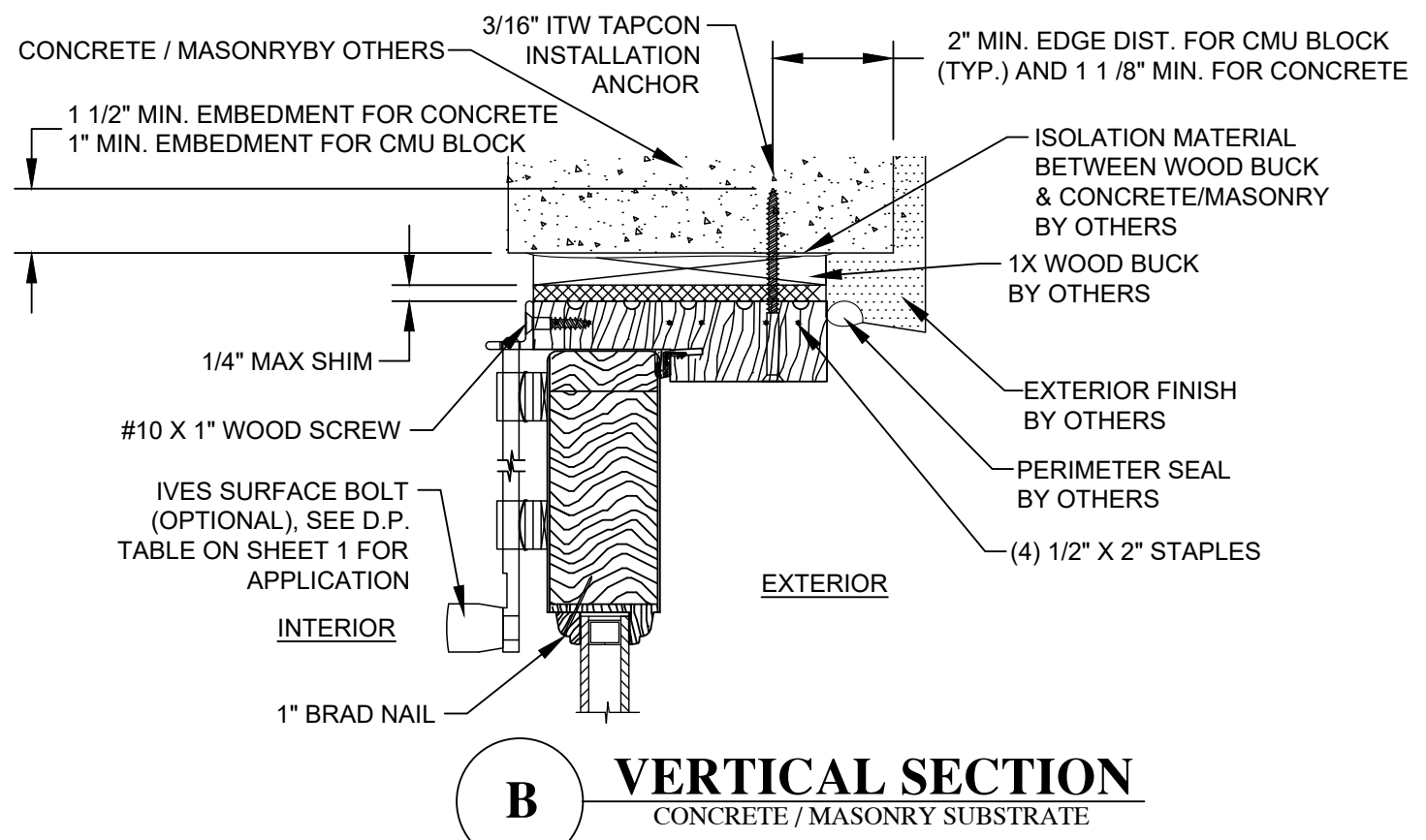
**B** VERTICAL SECTION  
CONCRETE / MASONRY SUBSTRATE

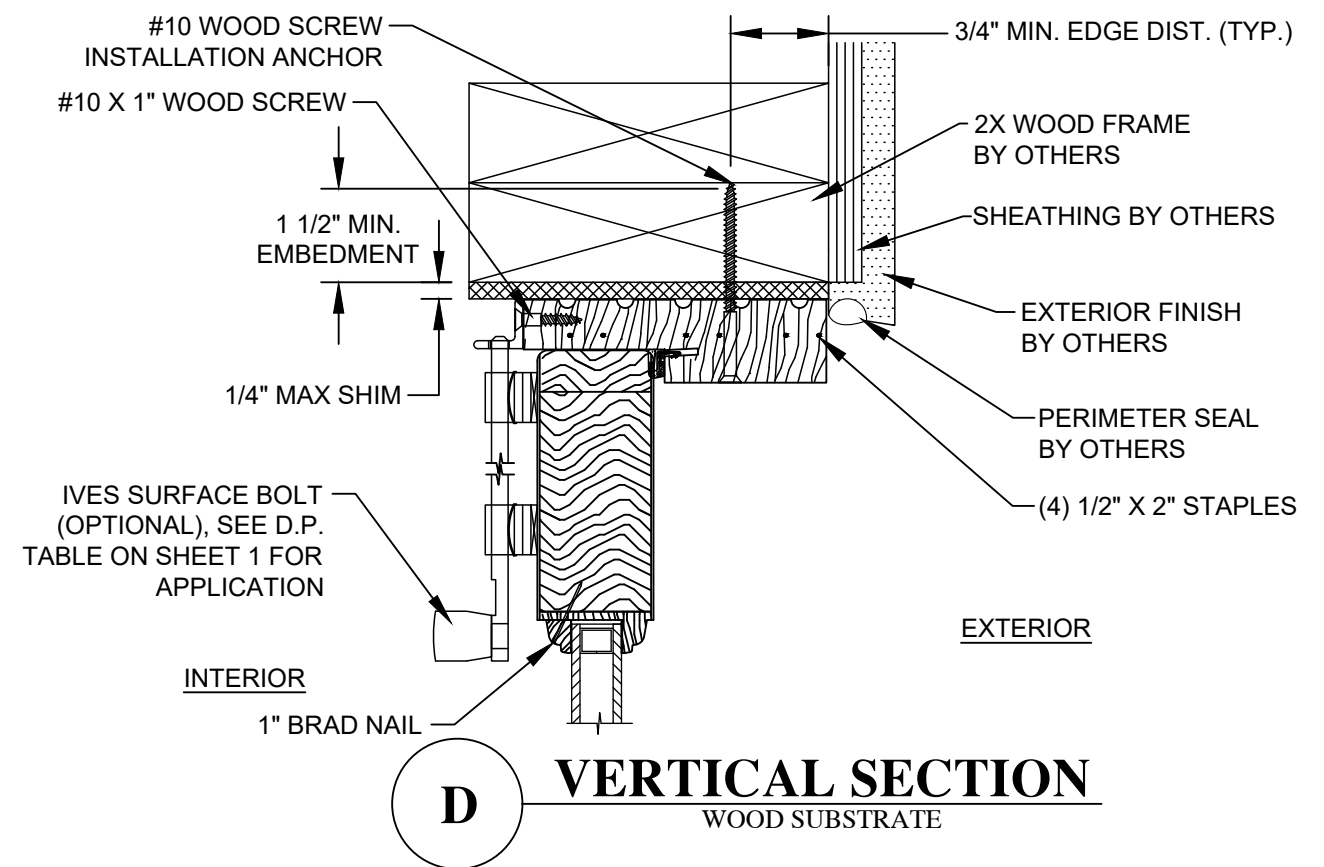

**D** VERTICAL SECTION  
WOOD SUBSTRATE

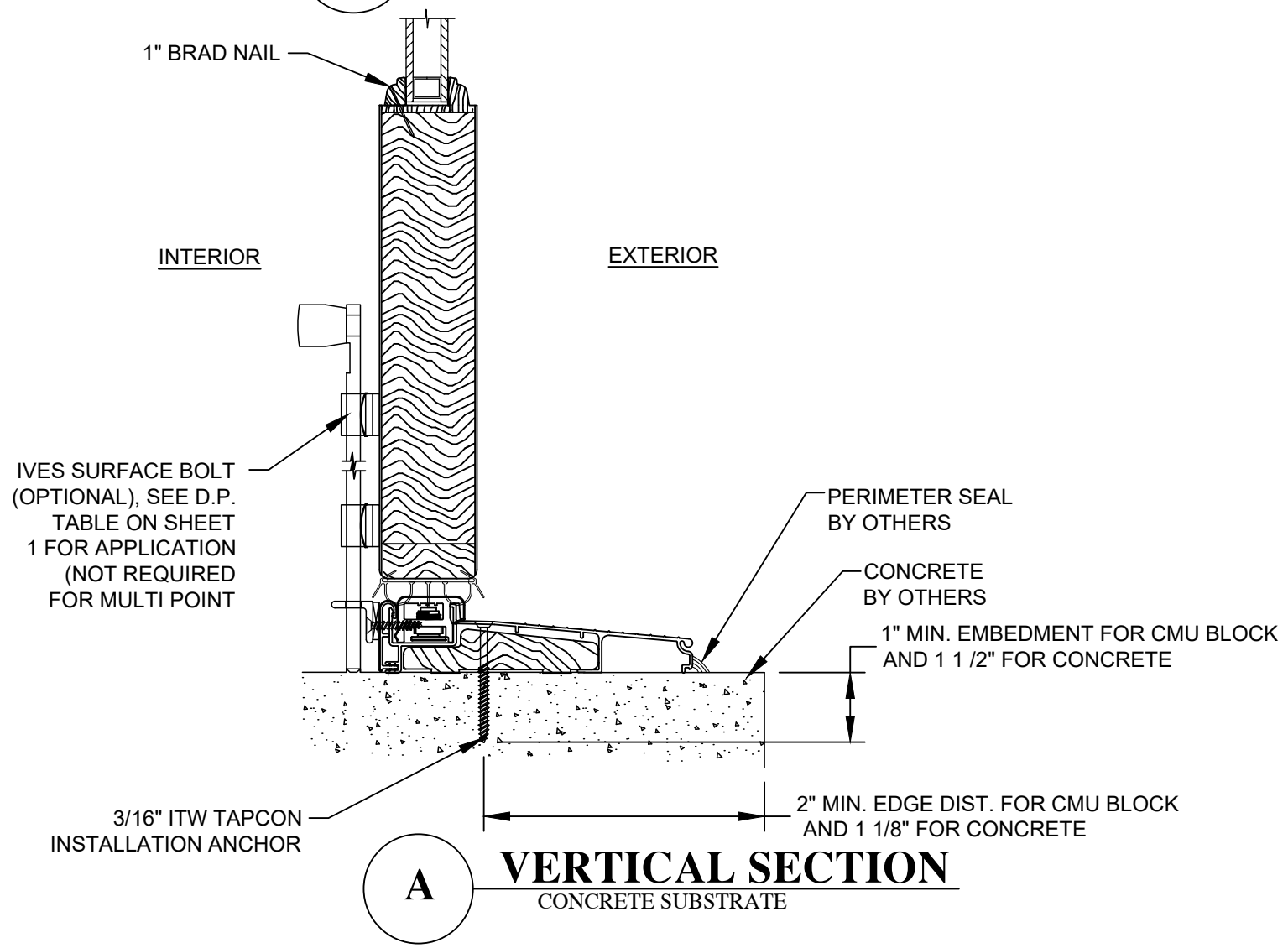

**A** VERTICAL SECTION  
CONCRETE SUBSTRATE

PROJECT: #419-1112

DATE	DESCRIPTION	REV
10/26/21	UPDATE FOR RE-EVALUATION	A
DATE	DESCRIPTION	REV

**SIMPSON DOOR COMPANY**  
400 W. SIMPSON AVENUE  
MCCLEARY, WASHINGTON 98557

TITLE: GLAZED & OPAQUE WOOD DOORS  
VERTICAL SECTIONS & GLAZING DETAIL

PREPARED BY: T.J.H.  
SCALE: N.T.S.  
REV: A

DATE: 05/31/12  
DRAWING NO: SIMP2060  
SHEET: 5 OF 8

PTC PRODUCT DESIGN GROUP, LLC  
PO BOX 520775  
LONGWOOD, FLORIDA 32752  
TX CERTIFICATE OF REGISTRATION: F-13740  
Phone: 321.690.1788  
Fax: 321.690.1789  
Email: info@ptc-corp.com

Robert J. Amoruso  
TX P.E. No. 80817

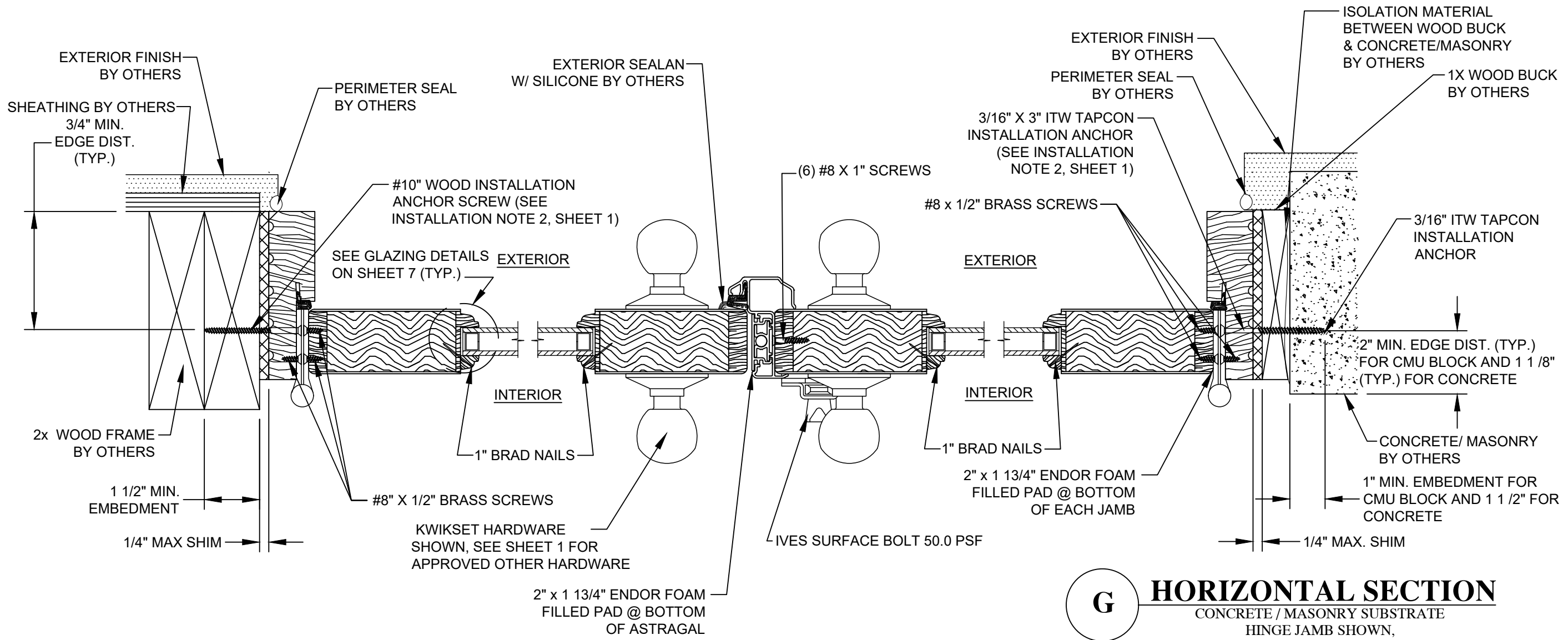

**E HORIZONTAL SECTION**  
WOOD SUBSTRATE  
HINGE JAMB SHOWN,  
STRIKE JAMB SIMILAR

**F HORIZONTAL SECTION**  
ENDORA "ULTIMATE HURRICANE ASTRAGAL"  
W/ & W/O OPTIONAL WOOD VENEER

**G HORIZONTAL SECTION**  
CONCRETE / MASONRY SUBSTRATE  
HINGE JAMB SHOWN,  
STRIKE JAMB SIMILAR

PROJECT: #419-1112

SIMPSON DOOR COMPANY 400 W. SIMPSON AVENUE McCLEARY, WASHINGTON 98557		DATE: 05/31/12	REVISION: A	DATE: 10/26/21	BY: RJA
TITLE: GLAZED & OPAQUE WOOD DOORS HORIZONTAL SECTIONS		DRAWING NO: SIMP2060	REVISION: A	DESCRIPTION: UPDATE FOR RE-EVALUATION	DATE: 10/26/21
PREPARED BY: T.J.H.	SCALE: N.T.S.	REV: A	SHEET: 6 OF 8	DESCRIPTION: UPDATE FOR RE-EVALUATION	DATE: 10/26/21
PTC PRODUCT DESIGN GROUP, LLC PO BOX 520775 LONGWOOD, FLORIDA 32752 TX CERTIFICATE OF REGISTRATION: F-131740		Phone: 321.690.1788 Fax: 321.690.1789 Email: info@ptc-corp.com			

Robert J. Amoruso  
TX P.E. No. 80817

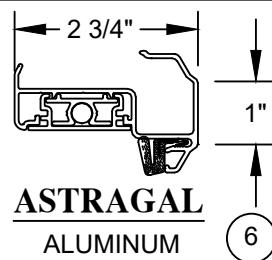

**ASTRAGAL**  
ALUMINUM

6

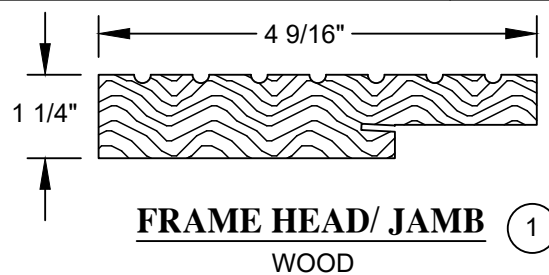

**FRAME HEAD/ JAMB**  
WOOD

1

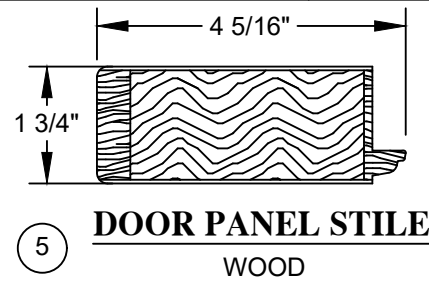

**DOOR PANEL STILE**  
WOOD

5

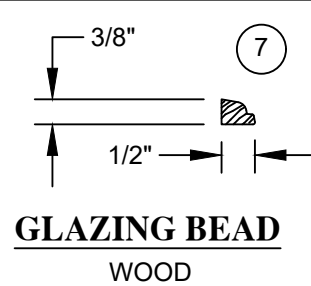

**GLAZING BEAD**  
WOOD

7

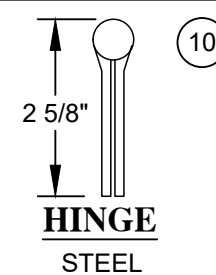

**HINGE**  
STEEL

10

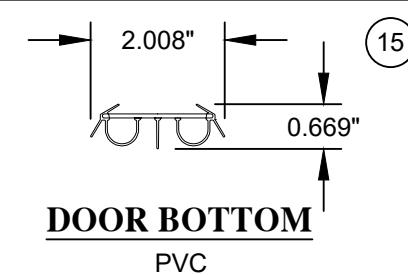

**DOOR BOTTOM**  
PVC

15

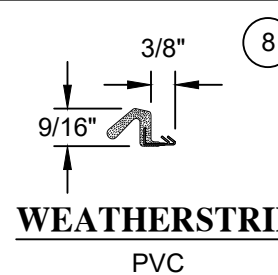

**WEATHERSTRIP**  
PVC

8

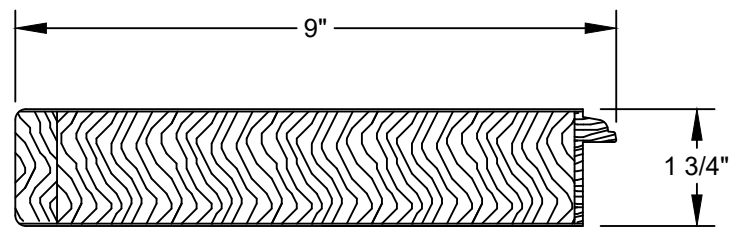

**DOOR PANEL SILL**  
WOOD

4

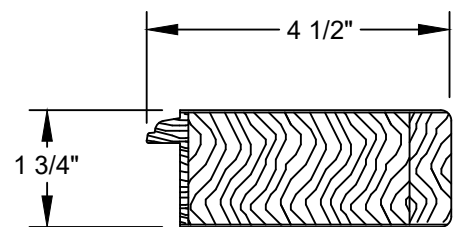

**DOOR PANEL HEAD**  
WOOD

3

ITEM	DESCRIPTION	PART #	MATERIAL	MANUFACTURER
1	FRAME HEAD & JAMB		PINE	SIMPSON DOOR
2	FRAME SILL	ZA15625	6063-T6 ALUMINUM	ENDURA / YOUNG MFG.
3	DOOR PANEL HEAD		WESTERN HEMLOCK *	SIMPSON DOOR
4	DOOR PANEL SILL		WESTERN HEMLOCK *	SIMPSON DOOR
5	DOOR PANEL STILE		WESTERN HEMLOCK *	SIMPSON DOOR
6	ASTRAGAL		ALUMINUM	ENDURA ULTIMATE
7	GLAZING BEAD		WESTERN HEMLOCK *	SIMPSON DOOR
8	WEATHERSTRIPPING	QEBD 650	PVC	SCHLEGAL
9				
10	4" BUTT HINGES		STEEL	
11	STANDARD LOCKSET		STEEL	KWIKSET/SCHLAGE
12	MULTIPOINT LOCKSET		STEEL	W& F
13	SURFACE BOLTS	253B 8"	BRASS	IVES
14	SURFACE BOLT STRIKE PLATE		STEEL	IVES
15	BOTTOM RAIL SWEEP		PVC	ENDURA
16	#9 x 2 1/4" WOOD SCREW		STEEL	
17	3/4" O.A. INSULATED GLASS CONSISTING OF: 1/8" TEMPERED GLASS, 1/2" AIR SPACE, 1/8" TEMPERED GLASS			
19	FRAME SILL I.S. ADA		WOOD	ENDURA

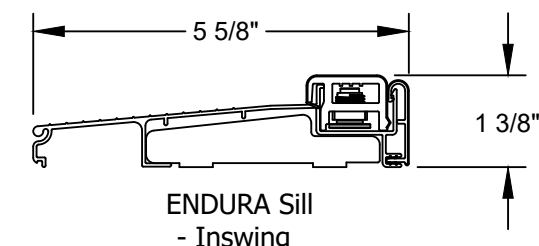

**IN-SWING SILL**  
ALUMINUM 0.053" TYP. WALL THICKNESS

2

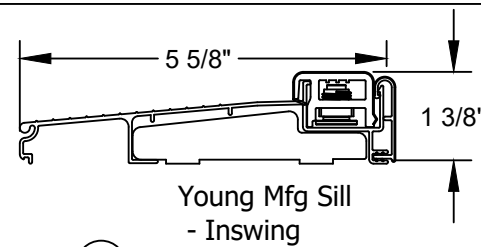

**IN-SWING SILL**  
ALUMINUM/OAK  
0.053" TYP. WALL THICKNESS

2

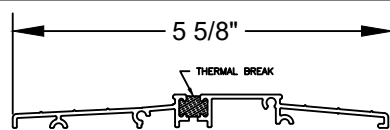

**IN-SWING SILL - ADA**

19

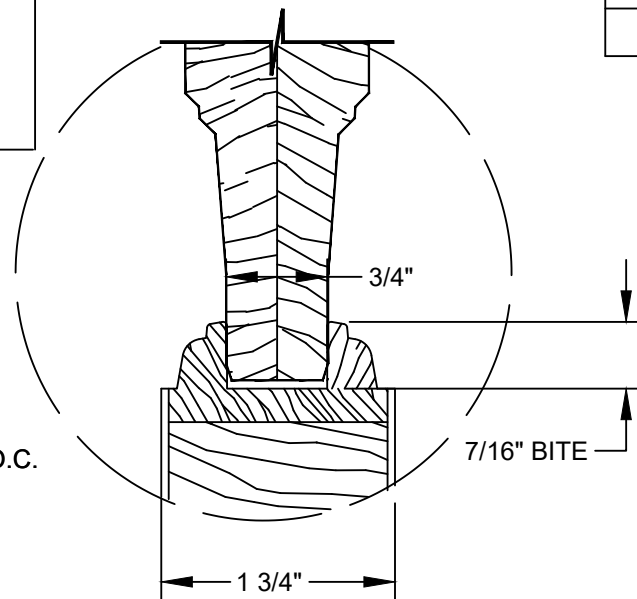

**WOOD PANEL DETAIL**

RAISED WOOD PANEL  
(DOOR LEAF ONLY)

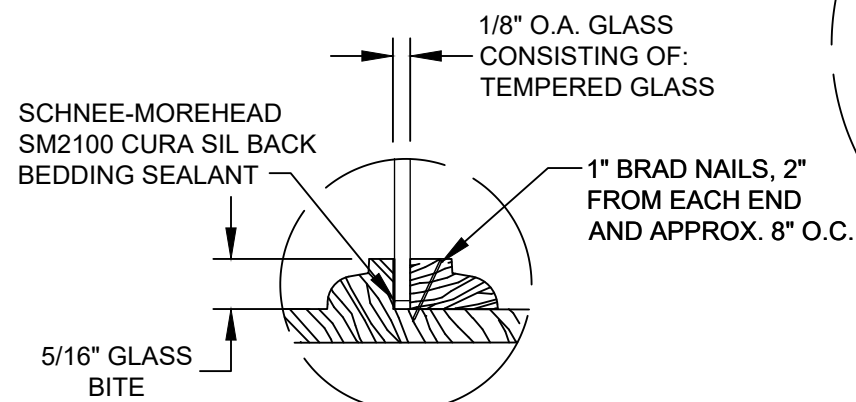

**GLAZING DETAIL 1**

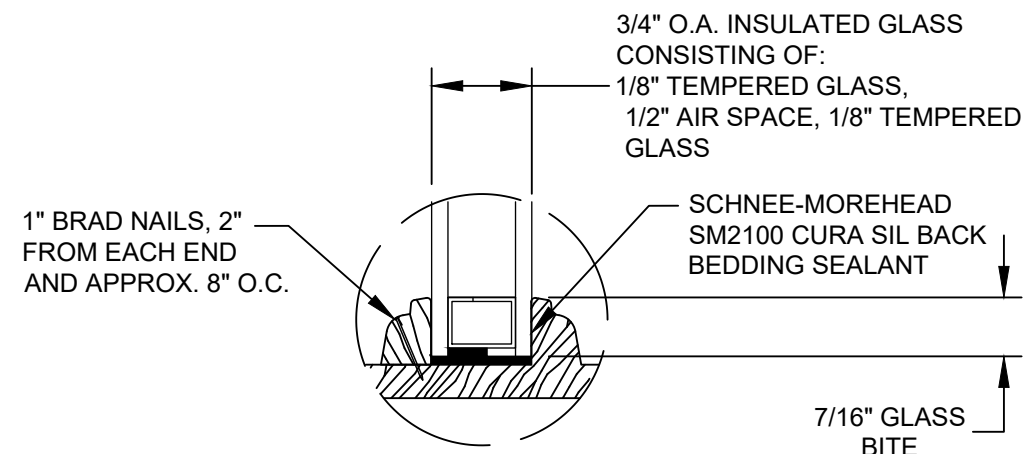

**GLAZING DETAIL 2**

\* DOUGLAS FIR MAY BE USED IN LIEU OF WESTERN HEMLOCK.

3/4" O.A. INSULATED GLASS  
CONSISTING OF:  
1/8" TEMPERED GLASS,  
1/2" AIR SPACE, 1/8" TEMPERED  
GLASS

PROJECT: #419-1112

SIMPSON DOOR COMPANY  
400 W. SIMPSON AVENUE  
MCCLEARY, WASHINGTON 98557

GLAZED & OPAQUE WOOD DOORS  
BILL OF MATERIALS AND GLAZING DETAILS

DRAWN BY:	TJH	DATE:	05/31/12
SCALE:	N.T.S.	DRAWING NO.:	SIMP2060
REV:	A	SHEET:	7 OF 8

Robert J. Amoruso  
TX P.E. No. 80817

PTC PRODUCT DESIGN GROUP, LLC  
PO BOX 520775  
LONGWOOD, FLORIDA 32752  
TX CERTIFICATE OF  
REGISTRATION: F-181749  
Phone: 321.690.1788  
Fax: 321.690.1789  
Email: info@ptc-corp.com

REV	DESCRIPTION	DATE	BY
A	UPDATE FOR RE-EVALUATION	10/26/21	RJA

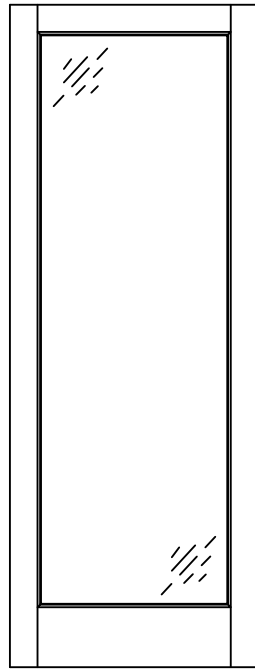

7001  
1501  
7711

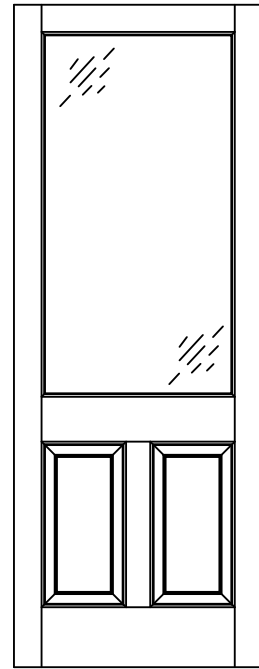

144  
7044

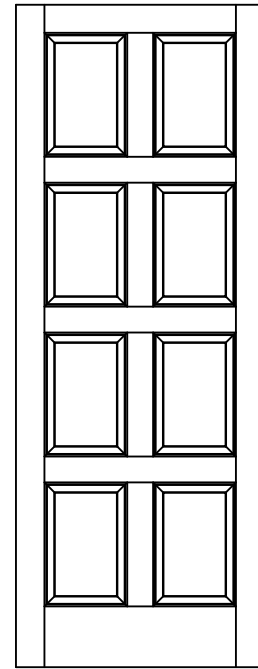

2010

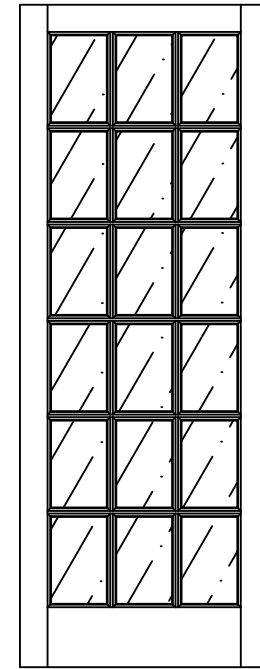

7018  
1518

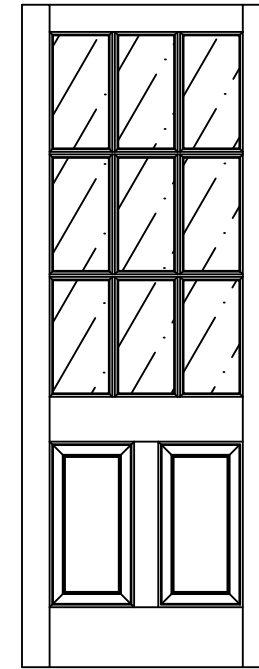

944  
7944

**TYPICAL APPROVED PANEL CONFIGURATIONS**

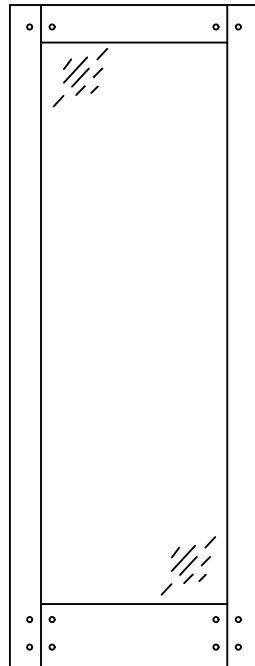

77001

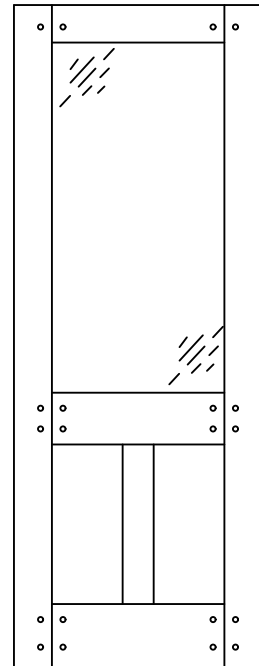

77044

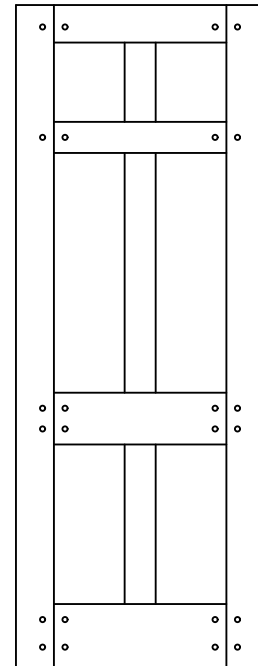

77130

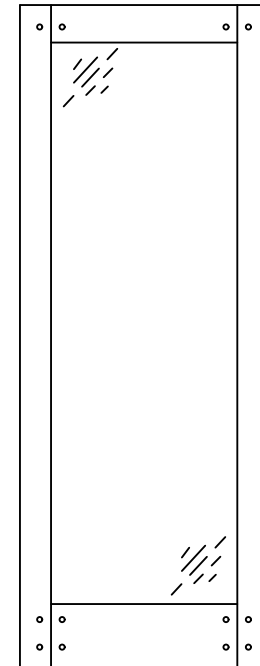

77018  
SDL only

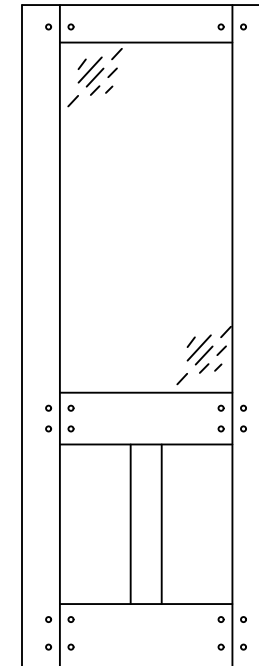

77944  
SDL only

PROJECT: #419-1112

SIMPSON DOOR COMPANY  
400 W. SIMPSON AVENUE  
MCCLARY, WASHINGTON 98557

GLAZED, & OPAQUE WOOD DOORS  
TYPICAL PANEL CONFIGURATIONS

PREPARED BY:	DATE:	DRAWING NO.:	REV:
TJH	05/31/12	SIMP2060	A
SCALE:			
N.T.S.			
DRAWN BY:			
TJH			
SHEET:			
8 OF 8			

PTC PRODUCT DESIGN GROUP, LLC  
PO BOX 520775  
LONGWOOD, FLORIDA 32752  
TX CERTIFICATE OF  
REGISTRATION: F-13740  
Phone: 321.690.1788  
Fax: 321.690.1789  
Email: info@ptc-corp.com

Robert J. Amoruso  
TX P.E. No. 80817

DESCRIPTION	DATE	BY
UPDATE FOR RE-EVALUATION	10/26/21	RIA
REV		