

LATCH & DEADBOLT DETAIL

ALUMINUM ASTRAGAL ASSEMBLY

ULTIMATE HURRICANE ASTRAGAL

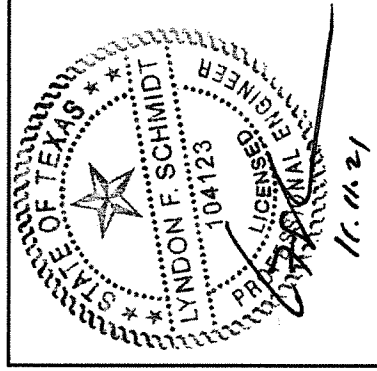

Documents Prepared By: Lyndon F. Schmidt, P.E.
TEXAS P.E. #104123

RW BUILDING CONSULTANTS, INC.
P.O. Box 230 Valrico FL 33595
Phone No.: 813.659.9197

TEXAS BOARD OF PROFESSIONAL ENGINEERS
CERTIFICATE OF REGISTRATION # F-11852

PRODUCT: ENDURA

PART OR ASSEMBLY: ASTRAGAL DETAILS

NO.	DATE	DESCRIPTION	BY
1	11/10/21	UPDATE TO 2018 IBC/IRC CODE	LFS

DATE: 11/06/18

SCALE: N.T.S.

DWG. BY: JK

CHK. BY: LFS

DRAWING NO.: TX-4902

SHEET 2 OF 6

Z:\Clients\Endura PERMANENT\B - Texas Dept of Ins\TDI - DR-1020 Flush GLZ JELD-WEN FG door XX (LK, DB) (4902-4903)C - Drawings\TX-4902-03.dwg

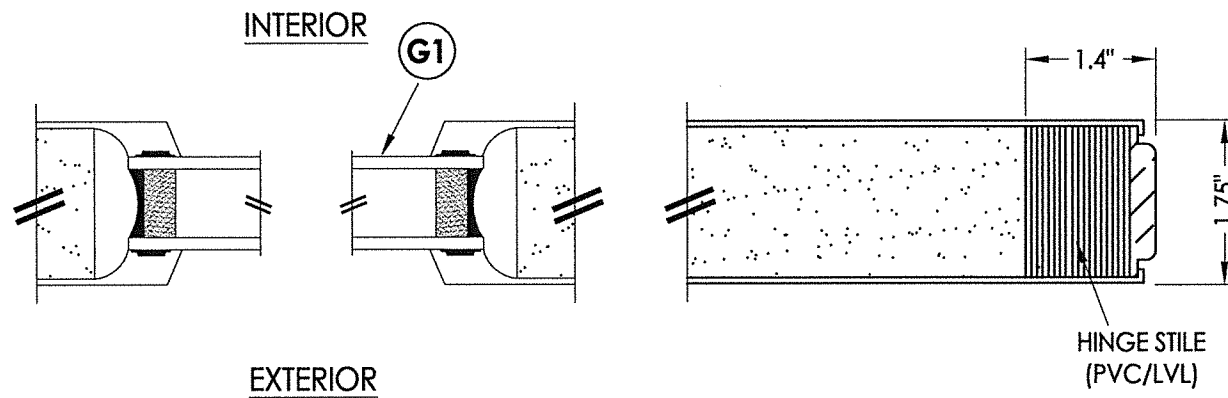
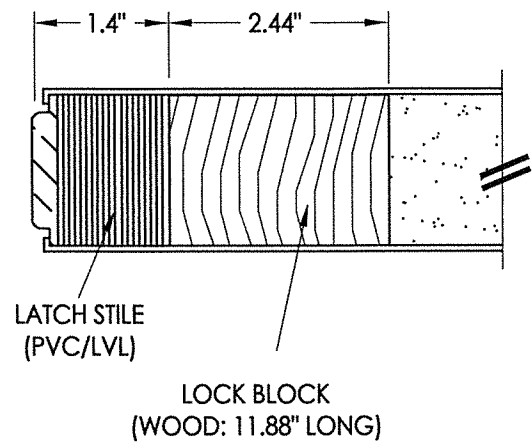

1
3 **HORIZONTAL CROSS SECTION**

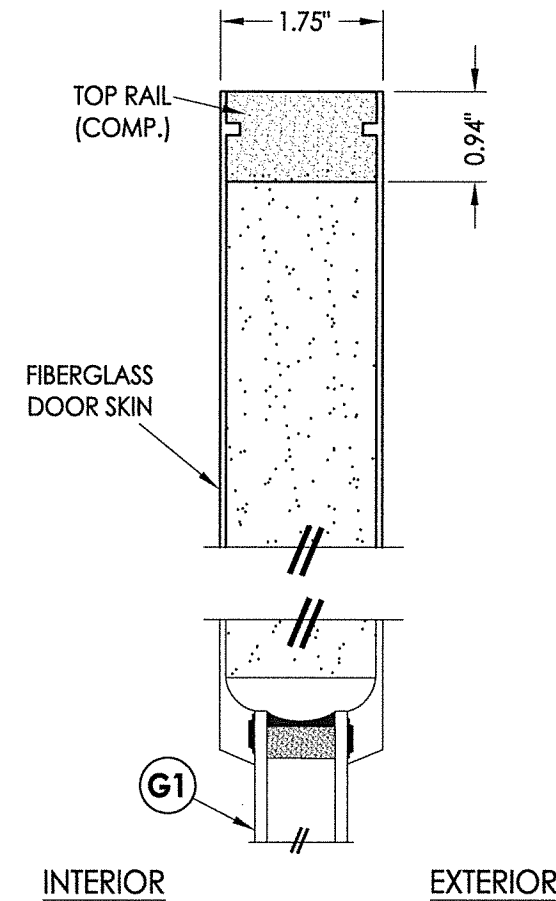

2
3 **VERTICAL CROSS SECTION**

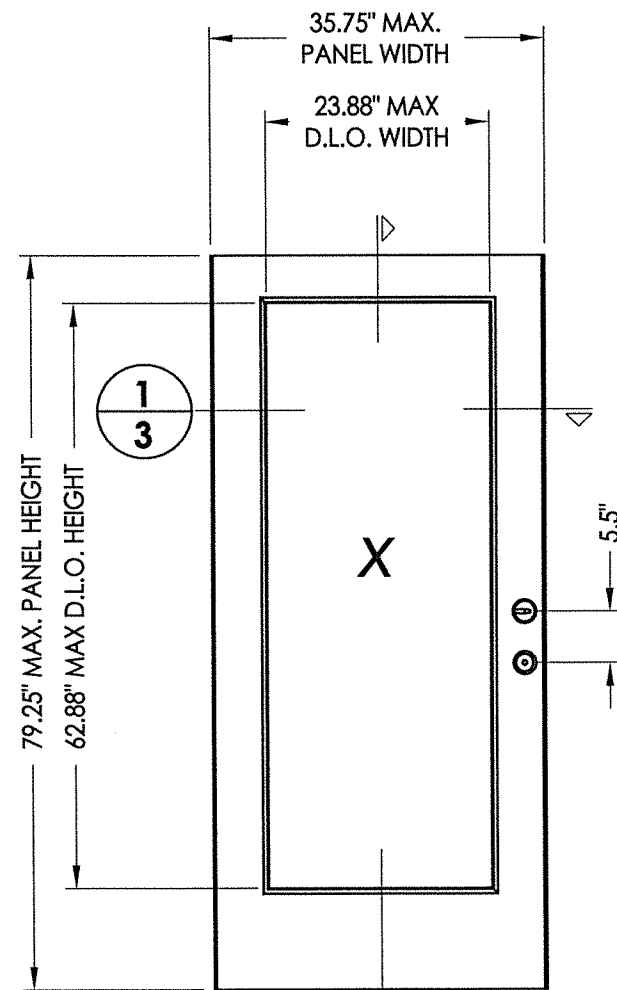

2
3
40 **DOOR PANEL**
JELD-WEN
Fiberglass

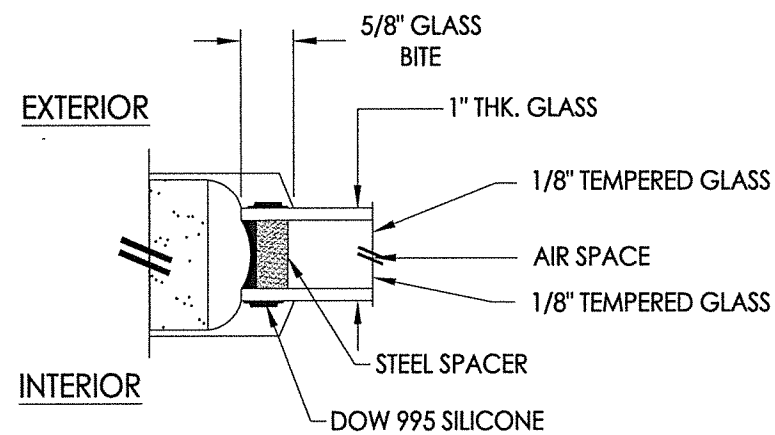

G1 **GLAZING DETAIL**
Flush Glazing

DOOR SKIN: FIBERGLASS (0.065" MIN. THICKNESS)
CORE MATERIAL: POLYURETHANE FOAM

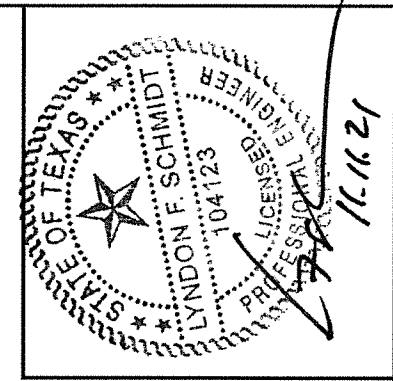

Documents Prepared By: Lyndon F. Schmidt, P.E.
TEXAS P.E. #104123

RW BUILDING CONSULTANTS, INC.
P.O. Box 230 Valrico FL, 33595
Phone No.: 813.659.9197

TEXAS BOARD OF PROFESSIONAL ENGINEERS
CERTIFICATE OF REGISTRATION # F-11852

PRODUCT:	ENDURA
PART OR ASSEMBLY:	DOOR PANEL DETAILS

NO.	DATE	DESCRIPTION	BY
1	11/10/21	UPDATE TO 2018 IBC/IRC CODE	LFS

DATE:	11/06/18
SCALE:	N.T.S.
DWG. BY:	JK
CHK. BY:	LFS
DRAWING NO.:	TX-4902
SHEET	3 OF 6

© 2018 R.W. BUILDING CONSULTANTS INC.

Z:\Clients\Endura PERMANENT\B - Texas Dept of Ins\TDI - DR-1020 Flush GLZ JELD-WEN FG door XX (LK, DB) (4902-4903)\C - Drawings\TX-4902-03.dwg

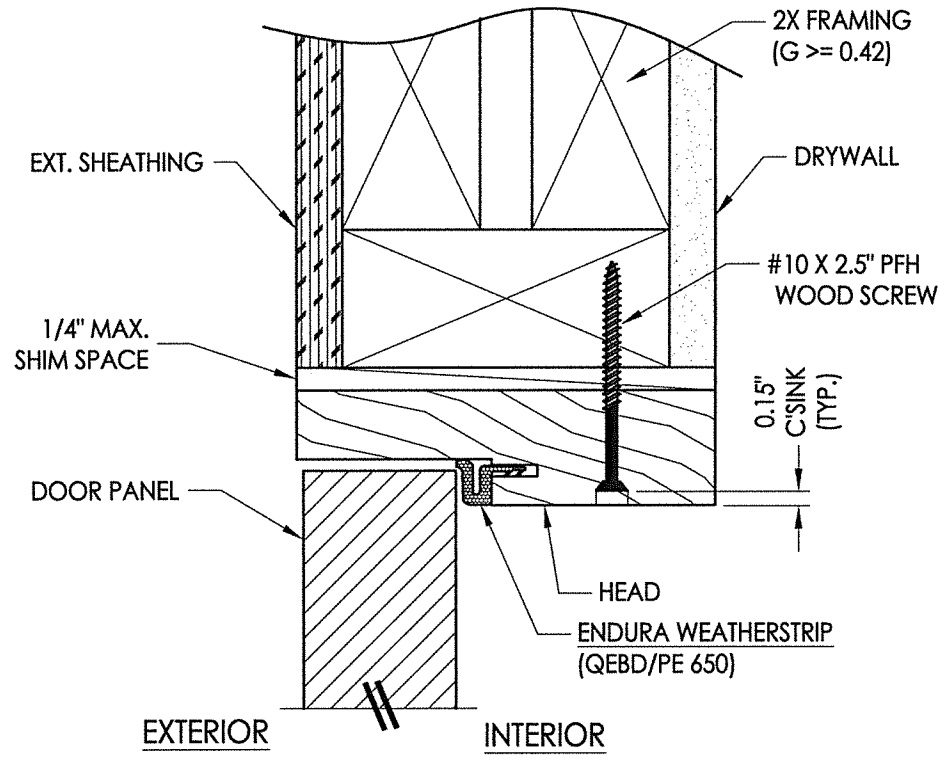
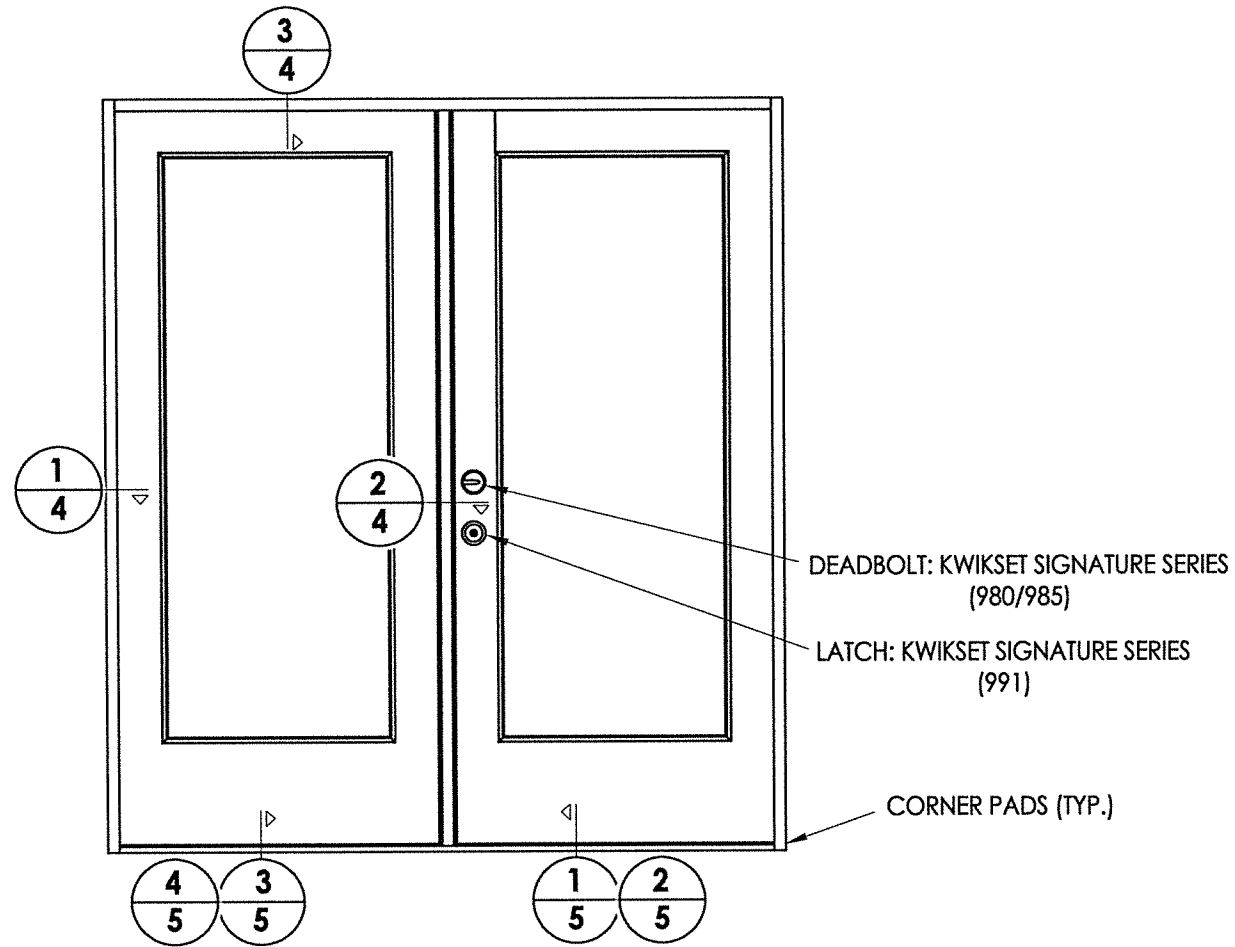

3 **VERTICAL CROSS SECTION**
4 Outswing shown - inswing also approved

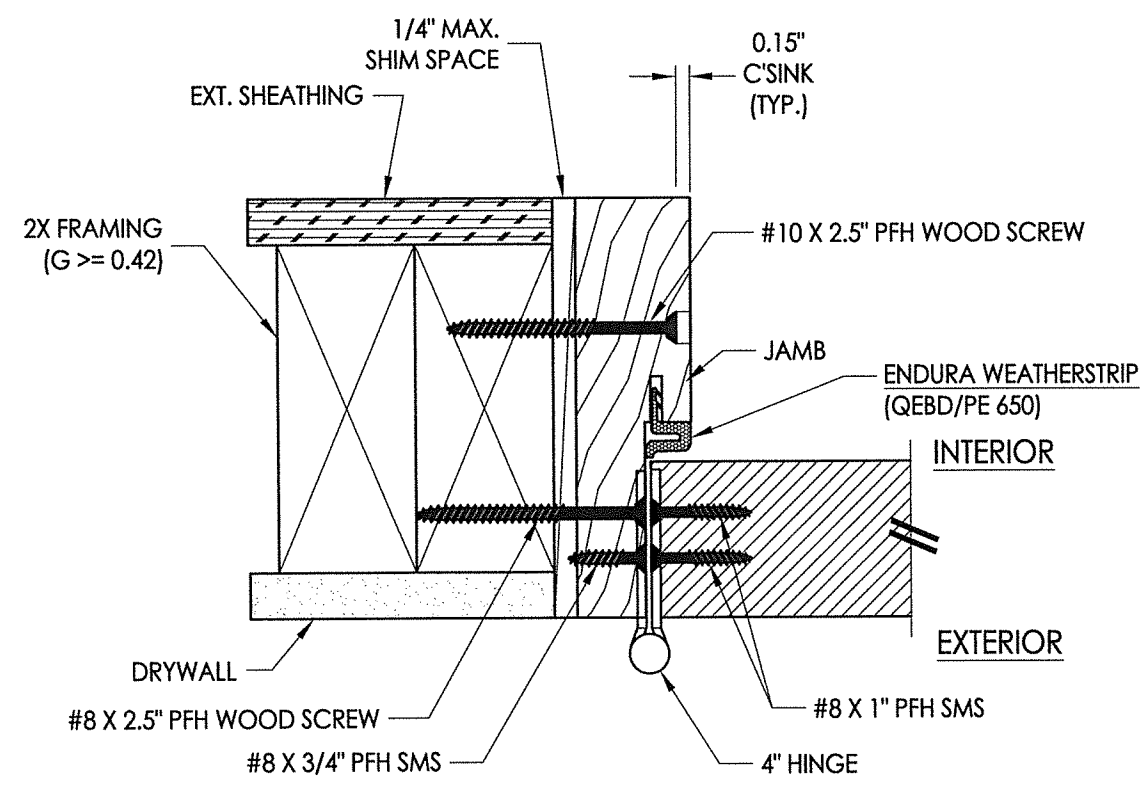

1 **HORIZONTAL CROSS SECTION**
4 Inswing shown - Outswing also approved

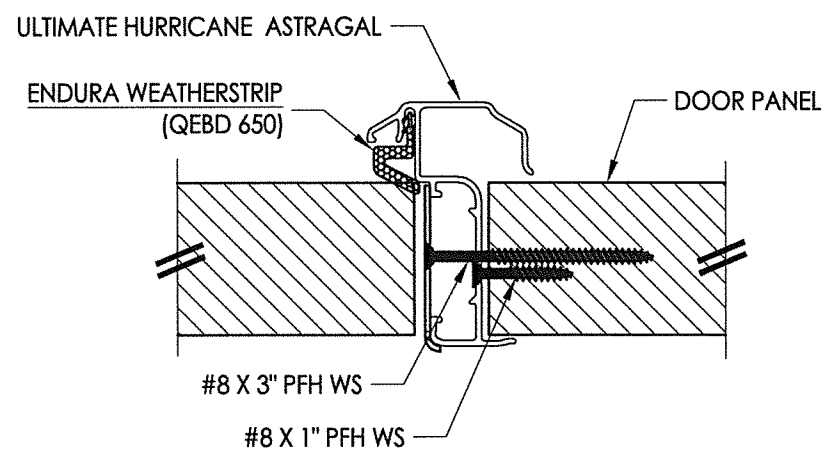

2 **HORIZONTAL CROSS SECTION**
4

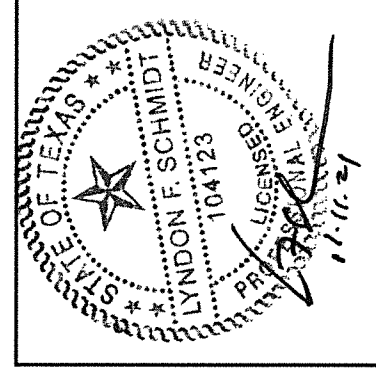

Documents Prepared By: Lyndon F. Schmidt, P.E.
 TEXAS P.E. #104123

RW BUILDING CONSULTANTS, INC.
 P.O. Box 230 Vairico FL 33595
 Phone No.: 813.659.9197
 TEXAS BOARD OF PROFESSIONAL ENGINEERS
 CERTIFICATE OF REGISTRATION # F-11852

PRODUCT:	ENDURA
PART OR ASSEMBLY:	HORIZONTAL & VERTICAL CROSS SECTIONS

NO.	DATE	BY
1	11/10/21	LFS
UPDATE TO 2018 IBC/IRC CODE		

DATE:	11/06/18
SCALE:	N.T.S.
DWG. BY:	JK
CHK. BY:	LFS
DRAWING NO.:	TX-4902
SHEET	4 OF 6

© 2018 R.W. BUILDING CONSULTANTS INC.

Z:\Clients\Endura PERMANENT\B - Texas Dept of Ins\TDI - DR-1020 Flush GLZ JELD-WEN FG door XX (LK, DB) (4902-4903)C - Drawings\TX-4902-03.dwg

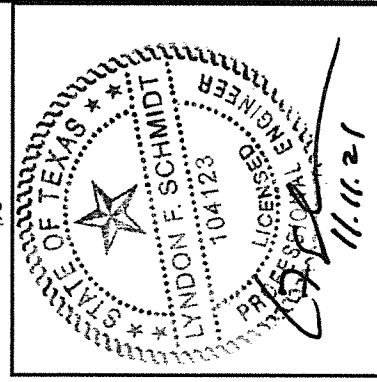
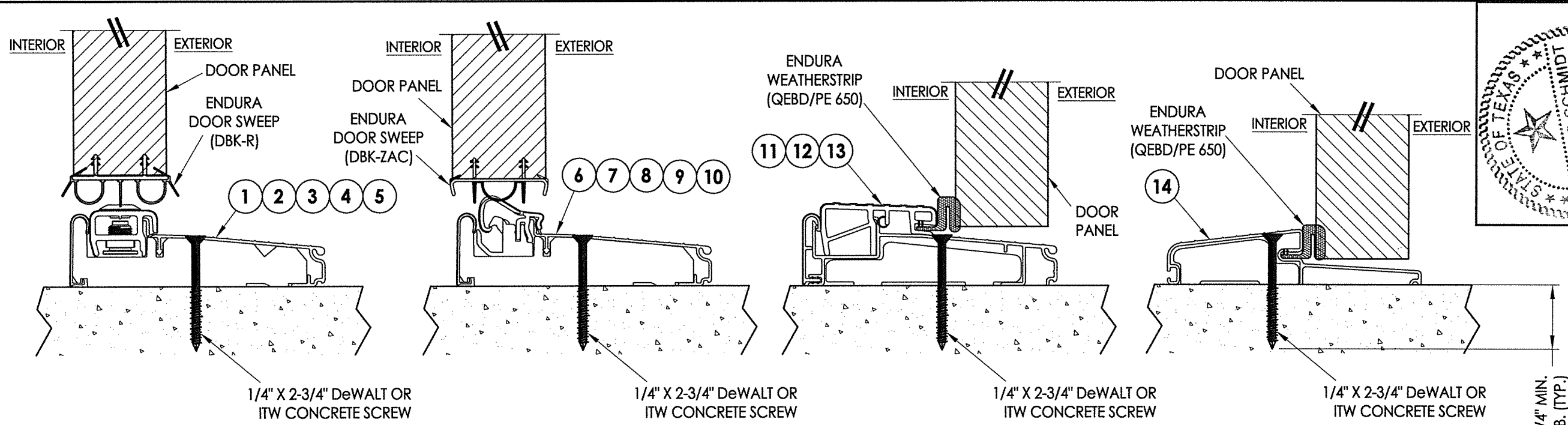

Documents Prepared By: Lyndon F. Schmidt, P.E.
TEXAS P.E. #104123

RW BUILDING CONSULTANTS, INC.
P.O. Box 230 Vairico FL 33595
Phone No.: 813.659.9197

TEXAS BOARD OF PROFESSIONAL ENGINEERS
CERTIFICATE OF REGISTRATION # F-11852

1 VERTICAL CROSS SECTION
5 Inswing Adjustable Threshold

2 VERTICAL CROSS SECTION
5 Inswing Articulating Threshold w/ Pin Capture

3 VERTICAL CROSS SECTION
5 Outswing Bump Threshold

4 VERTICAL CROSS SECTION
5 Outswing Bump Threshold

1-1/4" MIN.
EMB. (TYP.)

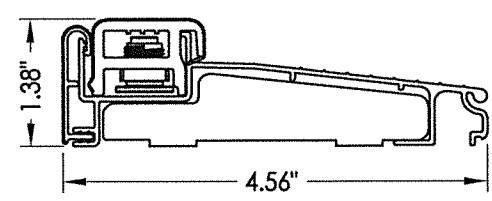

1 INSWING ADJUSTABLE THRESHOLD
ZAIL4565

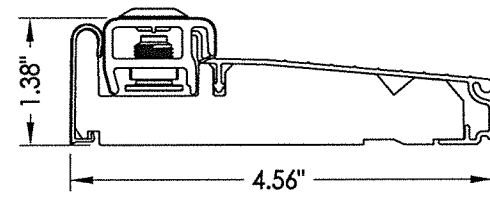

2 INSWING ADJUSTABLE THRESHOLD
ZAI4565FN

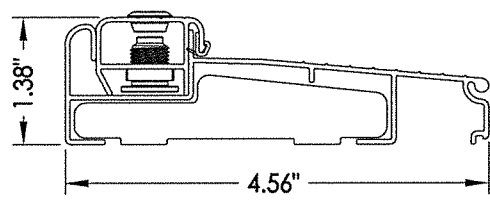

3 INSWING ADJUSTABLE THRESHOLD
ZAILAA4565

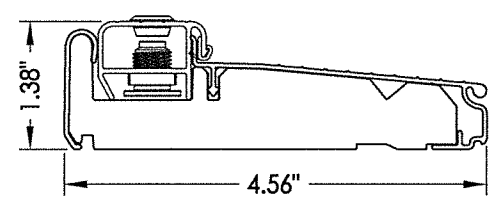

4 INSWING ADJUSTABLE THRESHOLD
ZIAAA4565FN

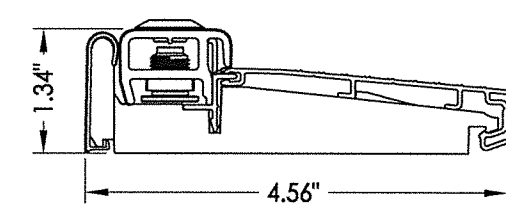

5 INSWING ADJUSTABLE THRESHOLD
ZAI4565RDS

MAX. DESIGN PRESSURE = ±50 PSF

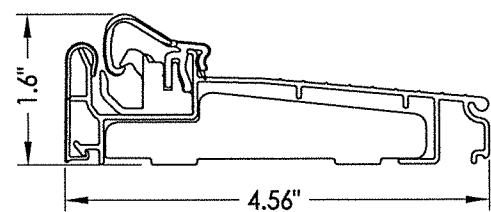

6 INSWING ARTICULATING THRESHOLD
ZACL4565

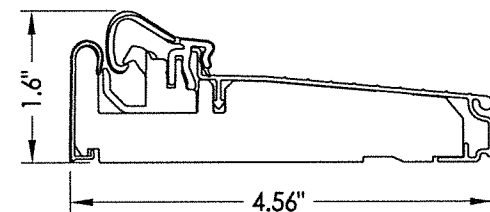

7 INSWING ARTICULATING THRESHOLD
ZAC4565FN

MAX. DESIGN PRESSURE = +45/-50 PSF

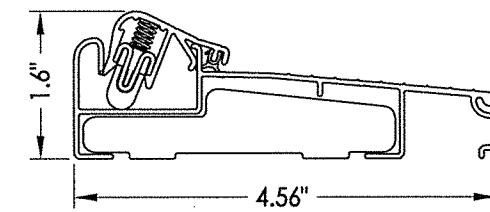

8 INSWING ARTICULATING THRESHOLD
ZACLA4565

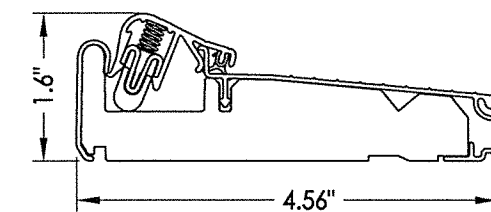

9 INSWING ARTICULATING THRESHOLD
ZACAA4565FN

MAX. DESIGN PRESSURE = +45/-50 PSF

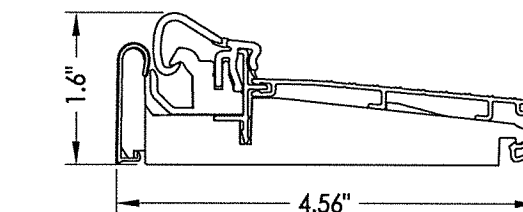

10 INSWING ARTICULATING THRESHOLD
ZAC4565RDS

MAX. DESIGN PRESSURE = ±45 PSF

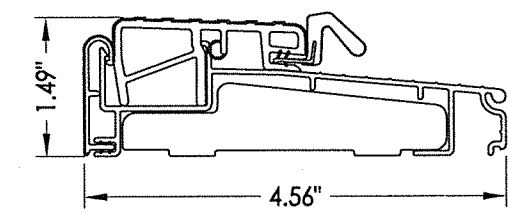

11 OUTSWING THRESHOLD
ZOBL4565

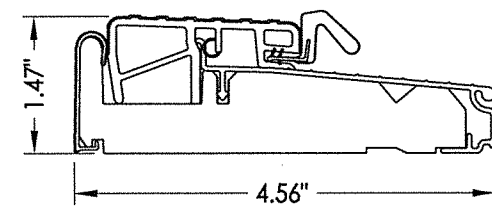

12 OUTSWING THRESHOLD
ZOB4565FN

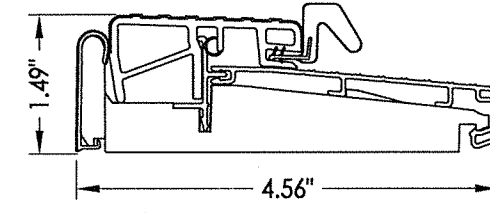

13 OUTSWING THRESHOLD
ZOB4565RDS

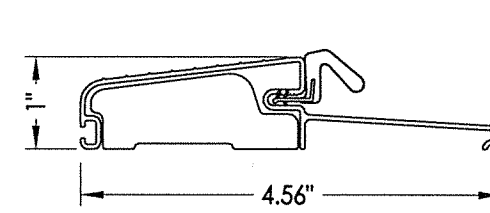

14 OUTSWING THRESHOLD
FOB4566

PRODUCT:	ENDURA	
PART OR ASSEMBLY:	VERTICAL CROSS SECTIONS	
NO.	DATE	BY
1	11/10/21	LFS
UPDATE TO 2018 IBC/IRC CODE		
REVISIONS		
DATE:	11/06/18	
SCALE:	N.T.S.	
DWG. BY:	JK	
CHK. BY:	LFS	
DRAWING NO.:	TX-4902	
SHEET	5 OF 6	

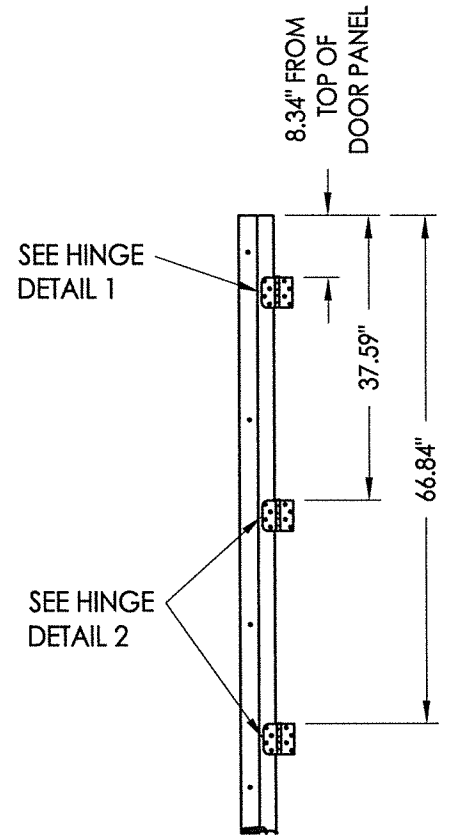

HINGE JAMB

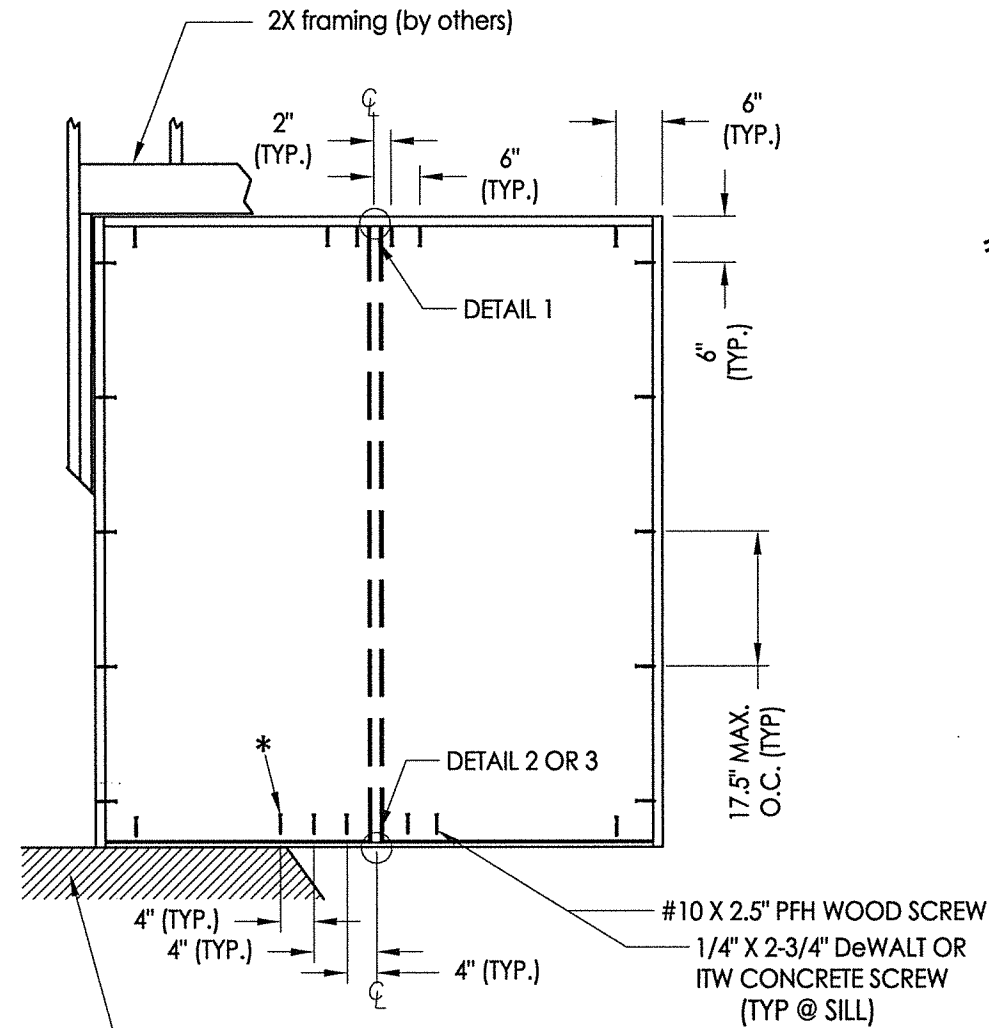

FRAME ANCHORING
XX

FLOOR SUBSTRATE MATERIAL (TYP.)
CONCRETE (MIN. 3000 PSI)
WOOD (G >= 0.42)

*NOTE: This anchor required for D.P. > 45 PSF.

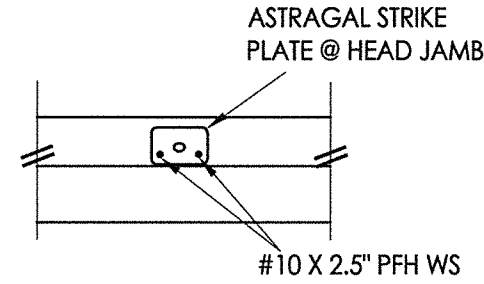

DETAIL 1

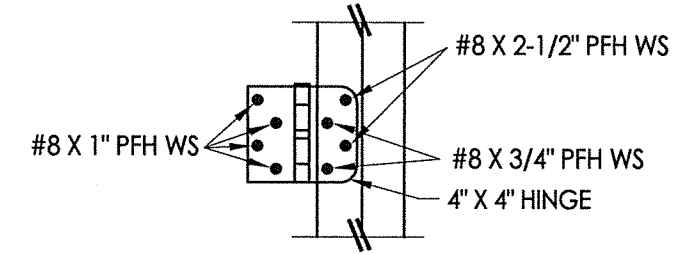

HINGE DETAIL 1

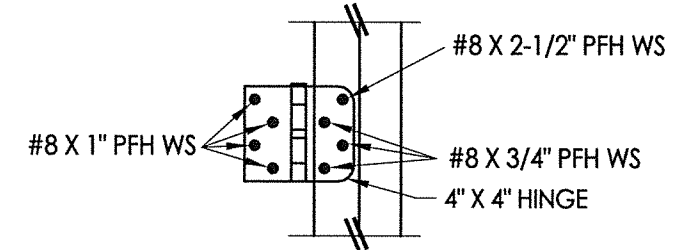

HINGE DETAIL 2

CONCRETE ANCHOR NOTES:

1. Concrete anchor locations at the corners may be adjusted to maintain the min. edge distance to mortar joints.
2. Concrete anchor locations noted as "MAX. ON CENTER" must be adjusted to maintain the min. edge distance to mortar joints, additional concrete anchors may be required to ensure the "MAX. ON CENTER" dimension are not exceeded.
3. Concrete anchor table:

ANCHOR TYPE	ANCHOR SIZE	MIN. EMBEDMENT	MIN. CLEARANCE TO MASONRY EDGE	MIN. CLEARANCE TO ADJACENT ANCHOR
ITW TAPCON®	3/16"	1-3/4"	3"	1-1/2"
	1/4"	1-3/4"	1-1/2"	4"
DeWALT ULTRACON®	1/4"	1-3/4"	1"	4"

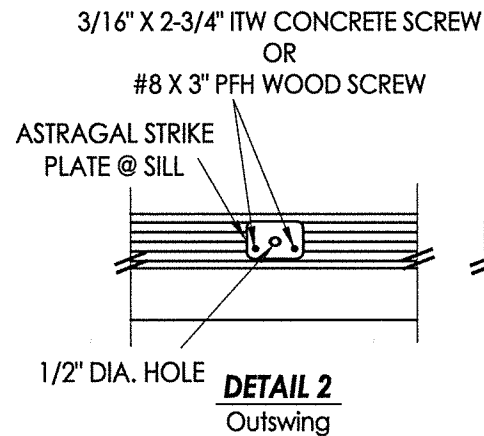

DETAIL 2
Outswing

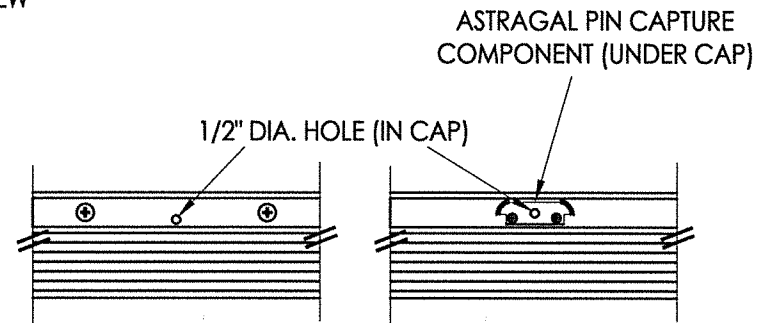

DETAIL 3
Inswing

DETAIL 3
Inswing

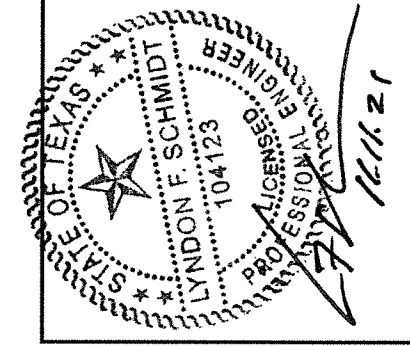

Documents Prepared By: Lyndon F. Schmidt, P.E.
TEXAS P.E. #104123

RW BUILDING CONSULTANTS, INC.
P.O. Box 230 Valrico FL 33595
Phone No.: 813.659.9197
TEXAS BOARD OF PROFESSIONAL ENGINEERS
CERTIFICATE OF REGISTRATION # F-11852

PRODUCT:	ENDURA	
PART OR ASSEMBLY:	FRAME ANCHORING	
NO.	DATE	BY
1	11/10/21	LFS
UPDATE TO 2018 IBC/IRC CODE		
REVISIONS		
DATE:	11/06/18	
SCALE:	N.T.S.	
DWG. BY:	JK	
CHK. BY:	LFS	
DRAWING NO.:	TX-4902	
SHEET	6 OF 6	