

YKK AP AMERICA, INC.

YHS 50 FI ALUMINUM STOREFRONT SYSTEM - OUTSIDE GLAZED (IMPACT)



YKK AP AMERICA, INC.
1229 HWY 441 BYPASS
DUBLIN, GEORGIA 31021
PH: (478)277-1955 FAX: (678)838-6001

INSTALLATION NOTES:

- SEE SHEET 16 & 17 FOR ANCHOR TYPE REQUIREMENTS, MINIMUM EMBEDMENTS, AND MINIMUM EDGE DISTANCES. ALL ANCHOR REQUIREMENTS MUST BE ADHERED TO. ANY DEVIATIONS FROM ANCHOR REQUIREMENTS REQUIRES SEPARATE EVALUATION AND APPROVAL.
- ONE (1) INSTALLATION ANCHOR IS REQUIRED AT EACH ANCHOR LOCATION SHOWN.
- THE NUMBER OF INSTALLATION ANCHORS DEPICTED IS THE MINIMUM NUMBER OF ANCHORS TO BE USED FOR PRODUCT INSTALLATION.
- INSTALL INDIVIDUAL INSTALLATION ANCHORS WITHIN A TOLERANCE OF ±1/2 INCH OF THE DEPICTED LOCATION IN THE ANCHOR LAYOUT DETAIL (I.E., WITHOUT CONSIDERATION OF TOLERANCES). TOLERANCES ARE NOT CUMULATIVE FROM ONE INSTALLATION ANCHOR TO THE NEXT.
- SHIM AS REQUIRED AT EACH INSTALLATION ANCHOR WITH LOAD BEARING SHIM(S). MAXIMUM ALLOWABLE SHIM STACK TO BE 3/8 INCH. SHIM WHERE SPACE OF 1/16 INCH OR GREATER OCCURS. SHIM(S) SHALL BE CONSTRUCTED OF HIGH DENSITY PLASTIC OR BETTER.
- MINIMUM EMBEDMENT AND EDGE DISTANCE EXCLUDE WALL FINISHES, INCLUDING BUT NOT LIMITED TO STUCCO, FOAM, BRICK VENEER, AND SIDING.
- INSTALLATION ANCHORS AND ASSOCIATED HARDWARE MUST BE MADE OF CORROSION RESISTANT MATERIAL OR HAVE A CORROSION RESISTANT COATING.
- FOR HOLLOW BLOCK AND GROUT FILLED BLOCK, DO NOT INSTALL INSTALLATION ANCHORS INTO MORTAR JOINTS. EDGE DISTANCE IS MEASURED FROM FREE EDGE OF BLOCK OR EDGE OF MORTAR JOINT INTO FACE SHELL OF BLOCK.
- INSTALLATION ANCHORS SHALL BE INSTALLED IN ACCORDANCE WITH ANCHOR MANUFACTURER'S INSTALLATION INSTRUCTIONS, AND ANCHORS SHALL NOT BE USED IN SUBSTRATES WITH STRENGTHS LESS THAN THE MINIMUM STRENGTH SPECIFIED BY THE ANCHOR MANUFACTURER.
- INSTALLATION ANCHOR CAPACITIES FOR PRODUCTS HEREIN ARE BASED ON SUBSTRATE MATERIALS WITH THE FOLLOWING PROPERTIES:
 - WOOD - MINIMUM SPECIFIC GRAVITY OF 0.42.
 - CONCRETE - MINIMUM COMPRESSIVE STRENGTH OF 3000 PSI.
 - MASONRY - CMU UNIT STRENGTH CONFORMS TO ASTM C-90, WITH MIN. COMPRESSIVE STRENGTH OF 2000 PSI AND GROUT CONFORMS TO ASTM C 476, MIN. GROUT COMPRESSIVE STRENGTH OF 2000 PSI.
 - STEEL - MINIMUM YIELD STRENGTH OF 36 KSI. MINIMUM 12 GA. WALL THICKNESS.
 - STEEL - MINIMUM YIELD STRENGTH OF 36 KSI. MINIMUM 18 GA. WALL THICKNESS WITH 2X WOOD BACKING.
 - ALUMINUM - MINIMUM 1/8 INCH THICK 6063-T5 ALUMINUM.

GENERAL NOTES:

- THE PRODUCT SHOWN HEREIN IS DESIGNED AND MANUFACTURED TO COMPLY WITH 2018 INTERNATIONAL BUILDING CODE (IBC) AND 2018 INTERNATIONAL RESIDENTIAL CODE (IRC), AND HAS BEEN EVALUATED ACCORDING TO THE FOLLOWING:
 - ASTM E283-04(12)
 - ASTM E330-14
 - ASTM E331-00(09)
 - ASTM E1886-13a
 - ASTM E1996-14a
 - TAS 201-94
 - TAS 202-94
 - TAS 203-94
- ADEQUACY OF THE EXISTING STRUCTURAL CONCRETE/MASONRY, 2X FRAMING AND METAL STUD FRAMING AS A MAIN WIND FORCE RESISTING SYSTEM CAPABLE OF WITHSTANDING AND TRANSFERRING APPLIED PRODUCT LOADS TO THE FOUNDATION IS THE RESPONSIBILITY OF THE ENGINEER OR ARCHITECT OF RECORD FOR THE PROJECT OF INSTALLATION.
- 1X AND 2X BUCKS (WHEN USED) SHALL BE DESIGNED AND ANCHORED TO PROPERLY TRANSFER ALL LOADS TO THE STRUCTURE. BUCK DESIGN AND INSTALLATION IS THE RESPONSIBILITY OF THE ENGINEER OR ARCHITECT OF RECORD FOR THE PROJECT OF INSTALLATION.
- THE INSTALLATION DETAILS DESCRIBED HEREIN ARE GENERIC AND MAY NOT REFLECT ACTUAL CONDITIONS FOR A SPECIFIC SITE. IF SITE CONDITIONS CAUSE INSTALLATION TO DEVIATE FROM THE REQUIREMENTS DETAILED HEREIN, A LICENSED ENGINEER OR ARCHITECT SHALL PREPARE SITE SPECIFIC DOCUMENTS FOR USE WITH THIS DOCUMENT.
- APPROVED IMPACT PROTECTIVE SYSTEM **IS NOT REQUIRED** ON THIS PRODUCT IN AREAS REQUIRING IMPACT RESISTANCE IN WIND ZONES 3 OR LESS. SEE SHEETS 3, 4 & 5 FOR LMI AND SMI GLASS TYPES.
- STOREFRONT FRAME MATERIAL: ALUMINUM 6063-T5
- ALL STRUCTURAL MATERIALS & DISSIMILAR METALS SHALL BE PROTECTED, TREATED, PAINTED, COATED, AND/OR ISOLATED AS REQUIRED IN THE APPLICABLE SECTIONS OF THE 2018 INTERNATIONAL BUILDING CODE AND REFERENCED DESIGN SPECIFICATIONS.
- GLASS MEETS THE REQUIREMENTS OF ASTM E 1300 GLASS CHARTS. SEE SHEETS 3, 4 & 5 FOR GLAZING DETAILS.

TABLE OF CONTENTS	
SHEET	SHEET DESCRIPTION
1	INSTALLATION & GENERAL NOTES
2	ELEVATION & ANCHOR LAYOUT
3	SMI GLAZING DETAILS
4	LMI GLAZING DETAILS
5	LMI GLAZING DETAILS
5A	GLAZING DETAILS (MISSILE LEVEL E)
6	LIGHT MULLION TABLES
7	MEDIUM MULLION TABLES
8	HEAVY MULLION TABLES
9	EXPANSION MULLION TABLES
10	SMI HEAVY MULLION TABLES
11	CORNER MULLION TABLES
12	TYPE A & B ANCHOR TABLES
13	TYPE C, D & E ANCHOR TABLES
14	DOOR MULLION TABLE (1)
15	DOOR MULLION TABLE (2)
16	VERTICAL SECTIONS & ANCHOR DESCRIPTIONS
17	VERTICAL SECTIONS
18	LIGHT & MEDIUM MULLION HORIZONTAL SECTIONS
19	HEAVY MULLION HORIZONTAL SECTIONS
20	CORNER MULLION HORIZONTAL SECTIONS
21	COMPONENTS & BILL OF MATERIALS
22	COMPONENTS

INSTRUCTIONS FOR USE:

- DETERMINE DESIGN WIND LOAD REQUIREMENTS BASED ON WIND VELOCITY, BLDG, HEIGHT, WIND ZONE USING APPLICABLE ASCE 7 STANDARD.
- SEE CHARTS ON SHEETS 3, 4, 5 & 5A FOR DESIGN LOAD CAPACITY OF DESIRED GLASS SIZE.
- CHECK MULLION CAPACITY FOR A GIVEN SPACING AND HEIGHT USING CHARTS ON SHEETS 6, 7, 8, 9, 10 & 11 FOR STORE FRONT MULLION AND SHEETS 14 & 15 FOR DOOR MULLION, THE CAPACITY SHOULD EXCEED THE DESIGN LOAD.
- USING CHART ON SHEET 12 & 13 SELECT ANCHOR OPTION WITH DESIGN RATING MORE THAN DESIGN LOAD SPECIFIED IN STEP 1 ABOVE.
- THE LOWEST VALUE RESULTING FROM STEP 2, 3 AND 4 SHALL APPLY TO ENTIRE SYSTEM.

TITLE: YHS 50 FI ALUMINUM STOREFRONT SYSTEM - OUTSIDE GLAZED (IMPACT)

INSTALLATION & GENERAL NOTES

PREPARED BY: BUILDING DROPS, INC.
398 E. DANIA BEACH BLVD., STE. 338
DANIA BEACH, FL 33004
PH: (954)399-8478
FAX: (954)744-4738
WEB: www.buildingdrops.com

REMARKS	BY	DATE

THE INSTALLATION DETAILS DESCRIBED HEREIN ARE GENERIC AND MAY NOT REFLECT ACTUAL CONDITIONS FOR A SPECIFIC SITE. IF SITE CONDITIONS CAUSE INSTALLATION TO DEVIATE FROM THE REQUIREMENTS DETAILED HEREIN, A LICENSED ENGINEER OR ARCHITECT SHALL PREPARE SITE SPECIFIC DOCUMENTS FOR USE WITH THIS DOCUMENT.

HERMES F. NORERO, P.E.
TEXAS P.E. No. 118471
BUILDING DROPS, INC.
398 E. DANIA BEACH BLVD. # 338
DANIA BEACH, FL 33004
TBPE FIRM No. 13734

DATE: 09.20.21

DWG. BY: MS CHK. BY: HFN

SCALE: NTS

DWG. #: YKK283

SHEET: 1

[PAGE 1 OF 23]

s:\projects\ykk_ap_america, inc.\tdi-21-0919 - tdi_submittal - revision cwsf 51, cwsf 52, cwsf 53\dwgs\ykk283_yhs 50 fi og_wz3.dwg 10/27/2021 5:45 PM

TITLE: YHS 50 FI ALUMINUM STOREFRONT SYSTEM - OUTSIDE GLAZED (IMPACT)

ELEVATION & ANCHOR LAYOUT

PREPARED BY: **BUILDING DROPS, INC.**
 398 E. DANIA BEACH BLVD., STE. 338
 DANIA BEACH, FL 33004
 PH: (954)399-8478
 FAX: (954)744-4738
 WEB: www.buildingdrops.com



REMARKS	BY	DATE

THE INSTALLATION DETAILS DESCRIBED HEREIN ARE GENERIC AND MAY NOT REFLECT ACTUAL CONDITIONS FOR A SPECIFIC SITE. IF SITE CONDITIONS CAUSE INSTALLATION TO DEVIATE FROM THE REQUIREMENTS DETAILED HEREIN, A LICENSED ENGINEER OR ARCHITECT SHALL PREPARE SITE SPECIFIC DOCUMENTS FOR USE WITH THIS DOCUMENT.

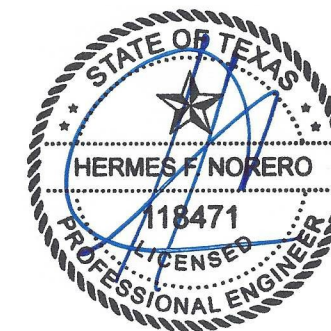

HERMES F. NORERO, P.E.
 TEXAS P.E. No 118471
 BUILDING DROPS, INC
 398 E. DANIA BEACH BLVD. # 338
 DANIA BEACH, FL 33004
 TBPE FIRM No. 13734

DATE: **09.20.21**

DWG. BY: **MS**

CHK. BY: **HFN**

SCALE: **NTS**

DWG. #: **YKK283**

SHEET:

2

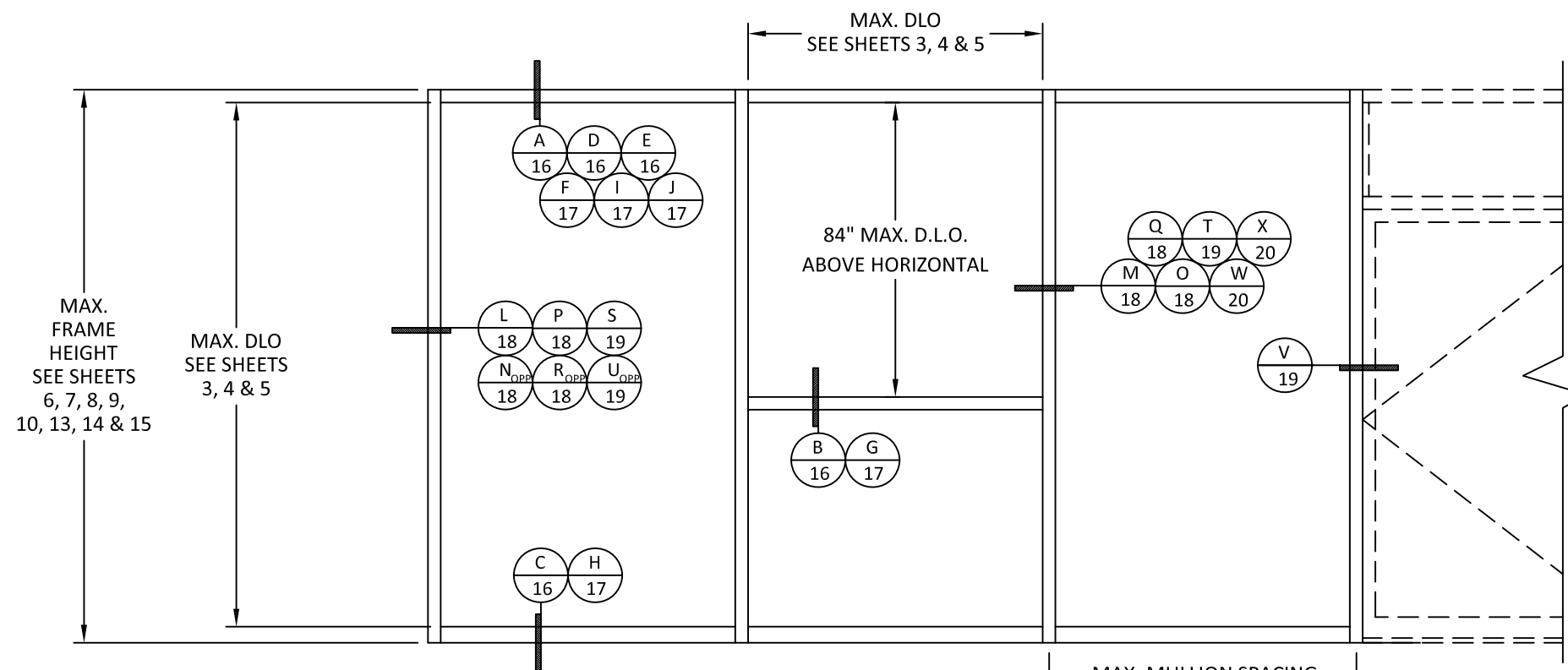

ELEVATION
TYPICAL YHS 50 FI STOREFRONT

SEE SEPARATE DOOR APPROVAL FOR DOOR RATING & DETAILS.
 LOWER DESIGN PRESSURE FROM STOREFRONT OR DOOR APPROVAL WILL APPLY TO ENTIRE SYSTEM.

ANCHOR TYPE	MAX. SPACING	MAX. DP
A OR B	19"	65 PSF
C, E OR D	19"	
A OR B	13.75"	90 PSF
C, E OR D	13.5"	

*NOTE: JAMB ANCHORS ARE ONLY REQUIRED WHEN USING "HEAVY" JAMB CONFIGURATIONS, SEE SHEET 19 FOR HEAVY JAMB DETAILS

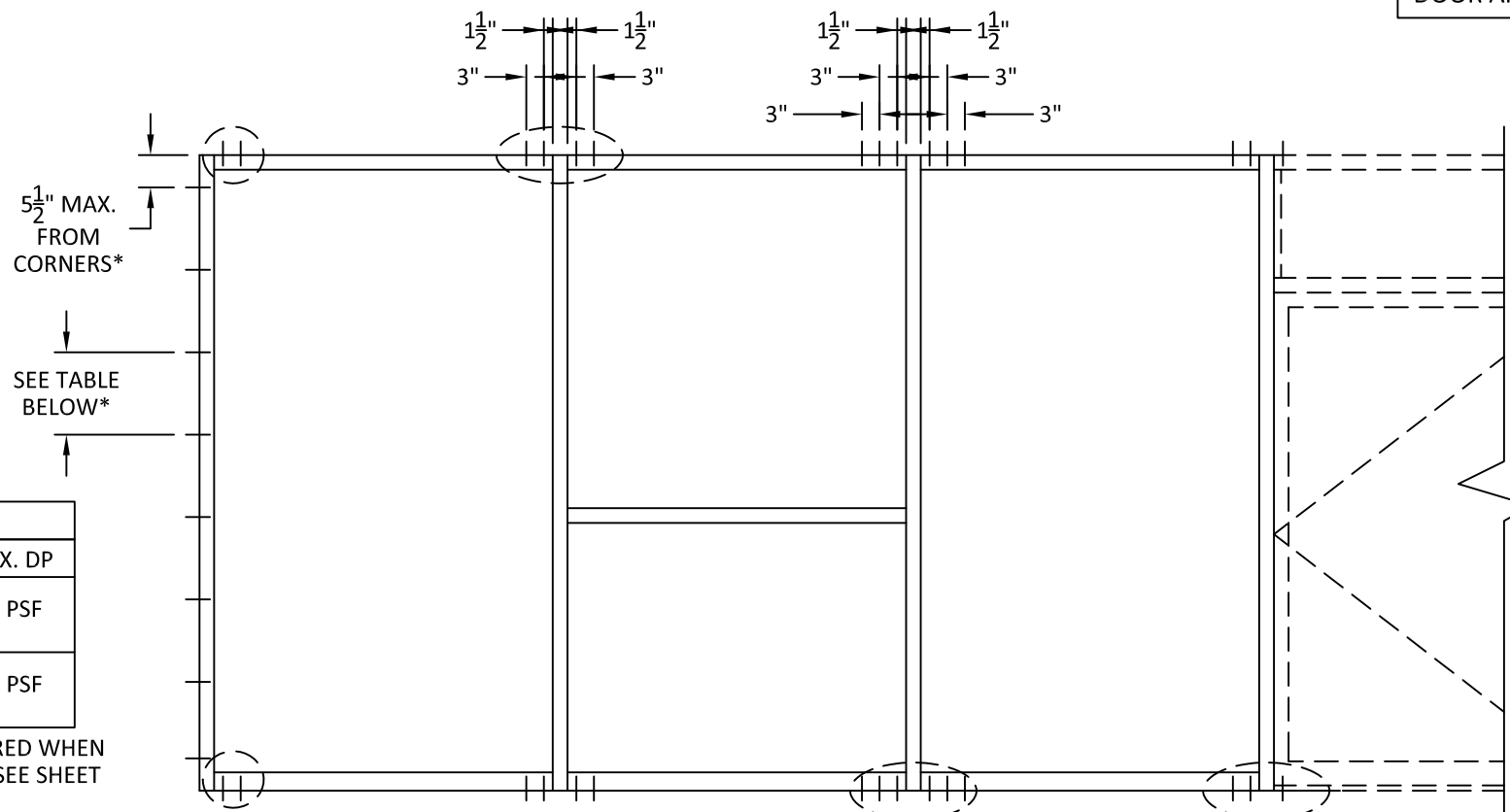

TYPICAL ANCHOR LAYOUT

FOR DOOR ADJACENT MULLION ANCHOR REQUIREMENTS SEE SHEETS 14 & 15

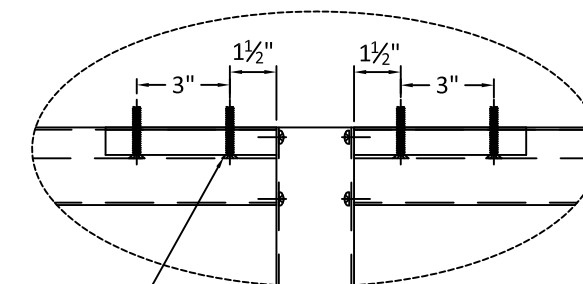

ANCHORS, TYPE A, B, C, D OR E
 SEE SHEETS 11 & 12 FOR QUANTITIES AND SHEET 16 FOR DESCRIPTION

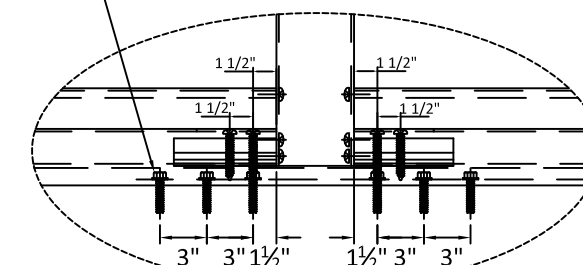

ANCHORS, TYPE A, B, C, D OR E
 SEE SHEETS 12 & 13 FOR QUANTITIES AND SHEET 16 FOR DESCRIPTION

10/27/2021 5:45 PM s:\projects\ykk_ap_america, inc.\tdl-21-0919 - tdl_submittal - revision cwsf 51, cwsf 52, cwsf 53\dwg\ykk283_yhs 50 fi og_wz3.dwg

GLASS TYPES

SMALL MISSILE IMPACT ONLY

GLASS LOAD CAPACITY (PSF)				
NOMINAL DIMS.		GLASS TYPE 'I & J'		GLASS TYPE 'K'
D.L.O. WIDTH	D.L.O. HEIGHT	EXT. (+)	INT. (-)	EXT. (+) INT. (-)
27.5	54.375	70.0	90.0	70.0
33.5		70.0	90.0	70.0
39.5		70.0	90.0	70.0
45.5		70.0	90.0	70.0
51.5		70.0	90.0	70.0
57.5	60.375	70.0	90.0	70.0
63.5		70.0	90.0	70.0
69.5		70.0	90.0	70.0
27.5		70.0	90.0	70.0
33.5		70.0	90.0	70.0
39.5	66.375	70.0	90.0	70.0
45.5		70.0	90.0	70.0
51.5		70.0	90.0	70.0
57.5		70.0	90.0	70.0
63.5		66.7	85.7	66.7
69.5	66.7	85.7	66.7	
27.5	72.375	70.0	90.0	70.0
33.5		70.0	90.0	70.0
39.5		70.0	90.0	70.0
45.5		70.0	90.0	70.0
51.5		70.0	90.0	70.0
57.5	78.375	70.0	90.0	70.0
63.5		70.0	90.0	70.0
69.5		70.0	90.0	70.0
27.5		70.0	90.0	70.0
33.5		70.0	90.0	70.0
39.5	84.375	70.0	90.0	70.0
45.5		70.0	90.0	70.0
51.5		70.0	90.0	70.0
57.5		70.0	90.0	70.0
63.5		63.4	81.5	63.4
69.5	57.9	74.5	57.9	

GLASS LOAD CAPACITY (PSF)				
NOMINAL DIMS.		GLASS TYPE 'I & J'		GLASS TYPE 'K'
D.L.O. WIDTH	D.L.O. HEIGHT	EXT. (+)	INT. (-)	EXT. (+) INT. (-)
27.5	90.375	70.0	90.0	70.0
33.5		70.0	90.0	70.0
39.5		70.0	90.0	70.0
45.5		70.0	90.0	70.0
51.5		70.0	90.0	70.0
57.5	96.375	70.0	90.0	70.0
63.5		63.4	81.5	63.4
69.5		57.9	74.5	47.2
27.5		70.0	90.0	70.0
33.5		70.0	90.0	70.0
39.5	102.375	70.0	90.0	70.0
45.5		70.0	90.0	70.0
51.5		70.0	90.0	70.0
57.5		70.0	90.0	70.0
63.5		63.4	81.5	51.7
69.5	60.5	77.8	49.4	
27.5	108.375	70.0	90.0	70.0
33.5		70.0	90.0	70.0
39.5		70.0	90.0	70.0
45.5		70.0	90.0	70.0
51.5		70.0	90.0	70.0
57.5	114.375	70.0	90.0	57.1
60.5		66.5	85.5	54.3
63.5		63.4	81.5	51.7
69.5		57.9	74.5	57.9
27.5		70.0	90.0	70.0
33.5	120.375	70.0	90.0	70.0
39.5		70.0	90.0	70.0
45.5		70.0	90.0	70.0
51.0		70.0	90.0	57.1
57.5		70.0	90.0	57.1
27.5	126.375	70.0	90.0	70.0
33.5		70.0	90.0	70.0
39.5		70.0	90.0	70.0
45.5		70.0	90.0	70.0
51.5		70.0	90.0	70.0
57.5	132.375	70.0	90.0	70.0
63.5		70.0	90.0	70.0
69.5		70.0	90.0	70.0
27.5		70.0	90.0	70.0
33.5		70.0	90.0	70.0
39.5	138.375	70.0	90.0	70.0
45.5		70.0	90.0	70.0
51.5		70.0	90.0	70.0
57.5		70.0	90.0	70.0
63.5		63.4	81.5	63.4
69.5	57.9	74.5	57.9	

NOTE: GLASS CAPACITIES ON THIS SHEET ARE BASED ON ASTM E1300 (3 SEC. GUSTS) AND CHAPTER 17 OF THE IBC FOR SIZES OTHER THAN TESTED.

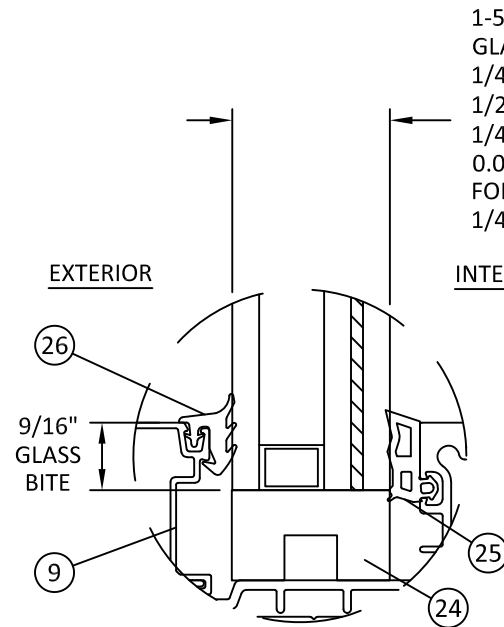

GLAZING DETAIL I
(DRY GLAZED)

1-5/16" O.A. INSULATED LAMINATED GLASS CONSISTING OF:
1/4" TEMPERED GLASS,
1/2" AIR SPACE,
1/4" HEAT STRENGTHENED GLASS,
0.035" SENTRYGLAS BY KURARAY,
FORMERLY KNOWN AS SGP BY DUPONT,
1/4" HEAT STRENGTHENED GLASS

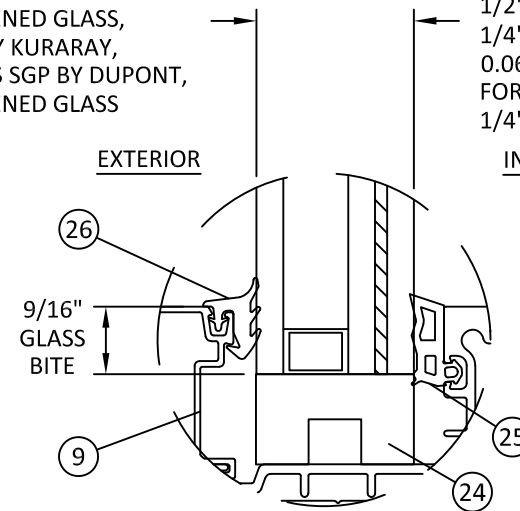

GLAZING DETAIL J
(DRY GLAZED)

1-5/16" O.A. INSULATED LAMINATED GLASS CONSISTING OF:
1/4" TEMPERED GLASS,
1/2" AIR SPACE,
1/4" HEAT STRENGTHENED GLASS,
0.060" TROSIFOL BY KURARAY,
FORMERLY KNOWN AS BUTACITE BY DUPONT,
1/4" HEAT STRENGTHENED GLASS

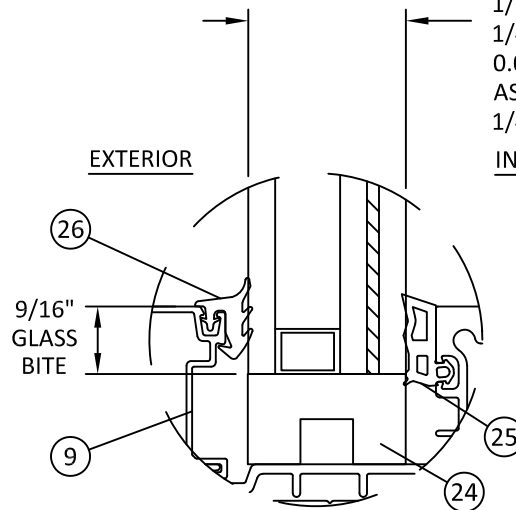

GLAZING DETAIL K
(DRY GLAZED)

1-5/16" O.A. INSULATED LAMINATED GLASS CONSISTING OF:
1/4" TEMPERED GLASS,
1/2" AIR SPACE,
1/4" HEAT STRENGTHENED GLASS,
0.060" EASTMAN (FORMERLY KNOWN AS SOLUTIA) SAFLEX PVB,
1/4" HEAT STRENGTHENED GLASS

ALUMINUM BOX SPACER:
AROUND THE PERIMETER OF THE GLASS.
PRIMARY SEALANT:
POLYISOBUTYLENE (PIB).
SECONDARY SEALANT:
STRUCTURAL SILICONE INTENDED FOR FABRICATION OF INSULATED GLASS UNITS.

DAYLITE OPENING DIMENSIONS:
DAYLITE OPENING WIDTH:
• NOMINAL PANEL WIDTH - 2.500"
DAYLITE OPENING HEIGHT:
• FRAME HEIGHT - 5.625"

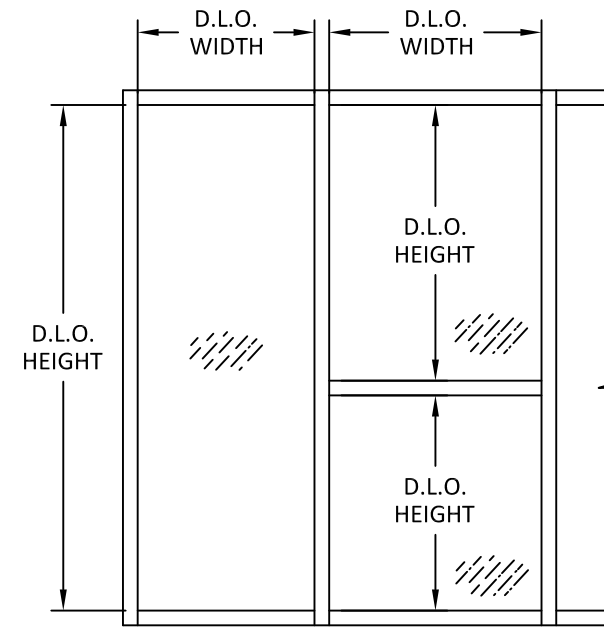

YKK AP AMERICA, INC.
1229 HWY 441 BYPASS
DUBLIN, GEORGIA 31021
PH: (478)277-1955 FAX: (678)838-6001

TITLE: YHS 50 FI ALUMINUM STOREFRONT SYSTEM - OUTSIDE GLAZED (IMPACT)
SMI GLAZING DETAILS

PREPARED BY: BUILDING DROPS, INC.
398 E. DANIA BEACH BLVD., STE. 338
DANIA BEACH, FL 33004
PH: (954)399-8478
FAX: (954)744-4738
WEB: www.buildingdrops.com

REMARKS	BY	DATE

THE INSTALLATION DETAILS DESCRIBED HEREIN ARE GENERIC AND MAY NOT REFLECT ACTUAL CONDITIONS FOR A SPECIFIC SITE. IF SITE CONDITIONS CAUSE INSTALLATION TO DEVIATE FROM THE REQUIREMENTS DETAILED HEREIN, A LICENSED ENGINEER OR ARCHITECT SHALL PREPARE SITE SPECIFIC DOCUMENTS FOR USE WITH THIS DOCUMENT.

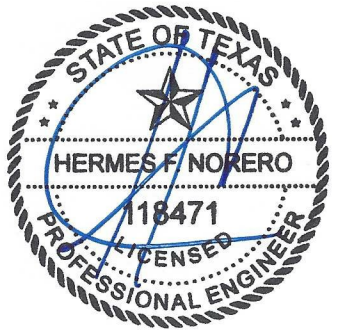

HERMES F. NORERO, P.E.
TEXAS P.E. No. 118471
BUILDING DROPS, INC
398 E. DANIA BEACH BLVD. # 338
DANIA BEACH, FL 33004
TBPE FIRM No. 13734

DATE:	09.20.21	
DWG. BY:	MS	CHK. BY: HFN
SCALE:	NTS	
DWG. #:	YKK283	
SHEET:	3	

GLASS TYPES

LARGE & SMALL MISSILE IMPACT



YKK AP AMERICA, INC.
 1229 HWY 441 BYPASS
 DUBLIN, GEORGIA 31021
 PH: (478)277-1955 FAX: (678)838-6001

TITLE: YHS 50 FI ALUMINUM STOREFRONT SYSTEM - OUTSIDE GLAZED (IMPACT)

LMI GLAZING DETAILS

PREPARED BY: **BUILDING DROPS, INC.**
 398 E. DANIA BEACH BLVD., STE. 338
 DANIA BEACH, FL 33004
 PH: (954)399-8478
 FAX: (954)744-4738
 WEB: www.buildingdrops.com



REMARKS	BY	DATE

THE INSTALLATION DETAILS DESCRIBED HEREIN ARE GENERIC AND MAY NOT REFLECT ACTUAL CONDITIONS FOR A SPECIFIC SITE. IF SITE CONDITIONS CAUSE INSTALLATION TO DEVIATE FROM THE REQUIREMENTS DETAILED HEREIN, A LICENSED ENGINEER OR ARCHITECT SHALL PREPARE SITE SPECIFIC DOCUMENTS FOR USE WITH THIS DOCUMENT.



HERMES F. NORERO, P.E.
 TEXAS P.E. No. 118471
 BUILDING DROPS, INC
 398 E. DANIA BEACH BLVD. # 338
 DANIA BEACH, FL 33004
 TBPE FIRM No. 13734

DATE:	09.20.21	
DWG. BY:	MS	CHK. BY: HFN
SCALE:	NTS	
DWG. #:	YKK283	
SHEET:	4	

GLASS LOAD CAPACITY (PSF)					
NOMINAL DIMS.		GLASS TYPE 'D, E & L'		GLASS TYPE 'F'	
D.L.O. WIDTH 'a'	D.L.O. HEIGHT 'b'	EXT. (+) INT. (-)	EXT. (+) INT. (-)	EXT. (+) INT. (-)	EXT. (+) INT. (-)
27.5	54.375	50.0	70.0	90.0	70.0
33.5		50.0	70.0	90.0	70.0
39.5		50.0	70.0	90.0	70.0
45.5		50.0	70.0	88.5	70.0
51.5		44.2	70.0	78.2	70.0
57.5		41.8	70.0	74.0	70.0
63.5	41.8	70.0	74.0	70.0	
69.5	41.8	70.0	74.0	70.0	
27.5	60.375	50.0	70.0	90.0	70.0
33.5		50.0	70.0	90.0	70.0
39.5		50.0	70.0	90.0	70.0
45.5		50.0	70.0	88.5	70.0
51.5		44.2	70.0	78.2	70.0
57.5		39.6	70.0	70.0	70.0
63.5	37.7	66.7	66.7	66.7	
69.5	37.7	66.7	66.7	66.7	
27.5	66.375	50.0	70.0	90.0	70.0
33.5		50.0	70.0	90.0	70.0
39.5		50.0	70.0	90.0	70.0
45.5		50.0	70.0	88.5	70.0
51.5		44.2	70.0	78.2	70.0
57.5		39.6	70.0	70.0	70.0
63.5	35.8	63.4	63.4	63.4	
69.5	34.3	60.6	60.6	60.6	
27.5	72.375	50.0	70.0	90.0	70.0
33.5		50.0	70.0	90.0	70.0
39.5		50.0	70.0	90.0	70.0
45.5		50.0	70.0	88.5	70.0
51.5		44.2	70.0	78.2	70.0
57.5		39.6	70.0	70.0	70.0
63.5	35.8	63.4	63.4	63.4	
69.5	-	57.9	57.9	57.9	
27.5	78.375	50.0	70.0	90.0	70.0
33.5		50.0	70.0	90.0	70.0
39.5		50.0	70.0	90.0	70.0
45.5		50.0	70.0	88.5	70.0
51.5		44.2	70.0	78.2	70.0
57.5		39.6	70.0	70.0	70.0
63.5	-	63.4	63.4	63.4	
69.5	-	57.9	57.9	57.9	
27.5	84.375	50.0	70.0	90.0	70.0
33.5		50.0	70.0	90.0	70.0
39.5		50.0	70.0	90.0	70.0
45.5		50.0	70.0	87.1	70.0
51.5		44.2	70.0	78.2	70.0
57.5		-	70.0	70.0	70.0
63.5	-	63.4	63.4	63.4	
69.5	-	57.9	57.9	57.9	

GLASS LOAD CAPACITY (PSF)						
NOMINAL DIMS.		GLASS TYPE 'D, E & L'		GLASS TYPE 'F'		
D.L.O. WIDTH 'a'	D.L.O. HEIGHT 'b'	EXT. (+) INT. (-)	EXT. (+) INT. (-)	EXT. (+) INT. (-)	EXT. (+) INT. (-)	
27.5	90.375	50.0	70.0	90.0	70.0	
33.5		50.0	70.0	90.0	70.0	
39.5		50.0	70.0	90.0	70.0	
45.5		50.0	70.0	85.0	70.0	
51.5		44.2	70.0	78.2	70.0	
57.5		-	70.0	70.0	70.0	
63.5	-	63.4	63.4	63.4		
69.5	-	53.8	53.8	-		
27.5	96.375	50.0	70.0	90.0	70.0	
33.5		50.0	70.0	90.0	70.0	
39.5		50.0	70.0	90.0	70.0	
45.5		50.0	70.0	83.3	70.0	
51.5		-	70.0	76.7	70.0	
57.5		-	70.0	70.0	70.0	
63.5	-	58.9	58.9	-		
66.5	-	56.2	56.2	-		
27.5	102.375	50.0	70.0	90.0	70.0	
33.5		50.0	70.0	90.0	70.0	
39.5		50.0	70.0	90.0	70.0	
45.5		50.0	70.0	81.8	70.0	
51.5		-	70.0	75.1	70.0	
57.5		-	70.0	70.0	70.0	
63.5	-	58.9	58.9	-		
27.5	108.375	50.0	70.0	90.0	70.0	
33.5		50.0	70.0	90.0	70.0	
39.5		50.0	70.0	89.6	70.0	
45.5		-	70.0	80.5	70.0	
51.5		-	70.0	73.7	70.0	
57.5		-	65.0	65.0	-	
60.5	-	61.8	61.8	-		
27.5	114.375	50.0	70.0	90.0	70.0	
33.5		50.0	70.0	90.0	70.0	
39.5		50.0	70.0	88.6	70.0	
45.5		-	70.0	79.4	70.0	
51.0		-	65.0	65.0	-	
57.5		-	65.0	65.0	-	
27.5	120.375	50.0	70.0	90.0	70.0	
33.5		50.0	70.0	90.0	70.0	
38.5		50.0	70.0	89.5	70.0	
27.5		50.0	70.0	90.0	70.0	
33.5		50.0	70.0	90.0	70.0	
36.5		50.0	70.0	90.0	70.0	
27.5	126.375	50.0	70.0	90.0	70.0	
33.5		50.0	70.0	90.0	70.0	
34.5		50.0	70.0	90.0	70.0	
33.5		50.0	70.0	90.0	70.0	
34.5		50.0	70.0	90.0	70.0	
27.5		132.375	50.0	70.0	90.0	70.0
33.5	50.0		70.0	90.0	70.0	
34.5	50.0		70.0	90.0	70.0	
27.5	138.375		50.0	70.0	90.0	70.0
33.5			50.0	70.0	90.0	70.0
33.5			50.0	70.0	90.0	70.0

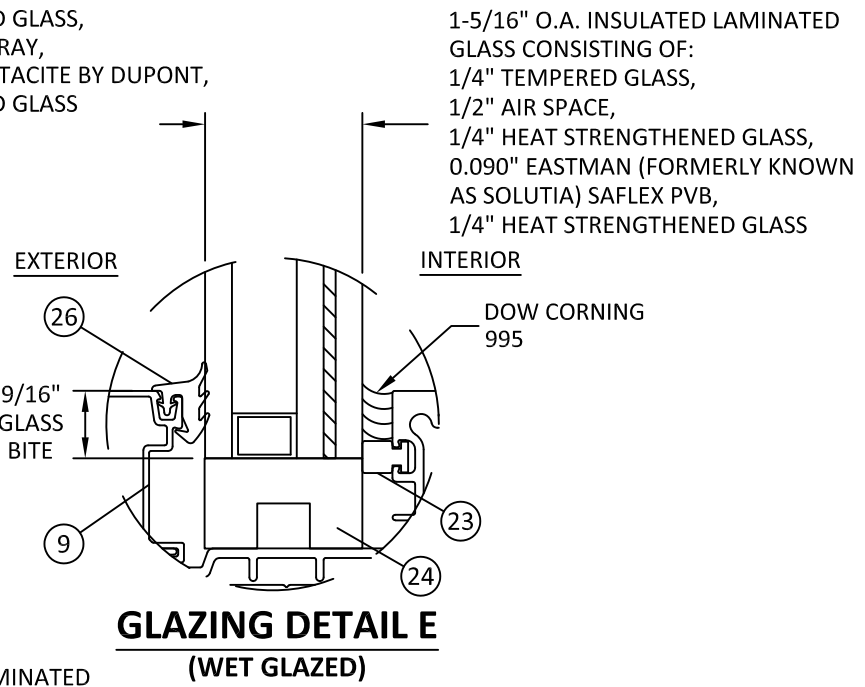
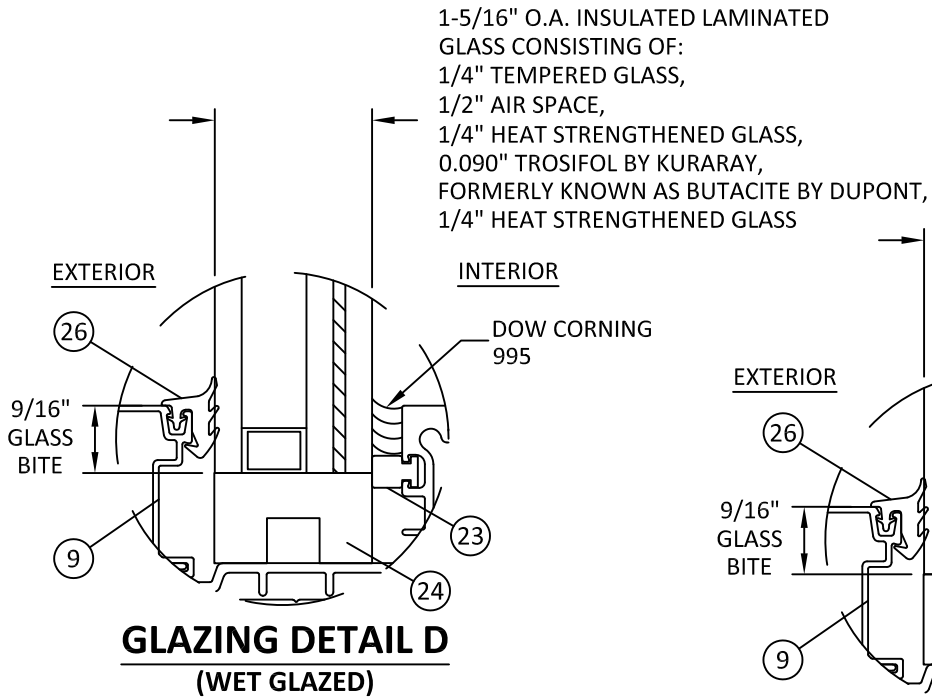

ALUMINUM BOX SPACER:
 AROUND THE PERIMETER OF THE GLASS.
 PRIMARY SEALANT:
 POLYISOBUTYLENE (PIB).
 SECONDARY SEALANT:
 STRUCTURAL SILICONE INTENDED FOR FABRICATION OF INSULATED GLASS UNITS.

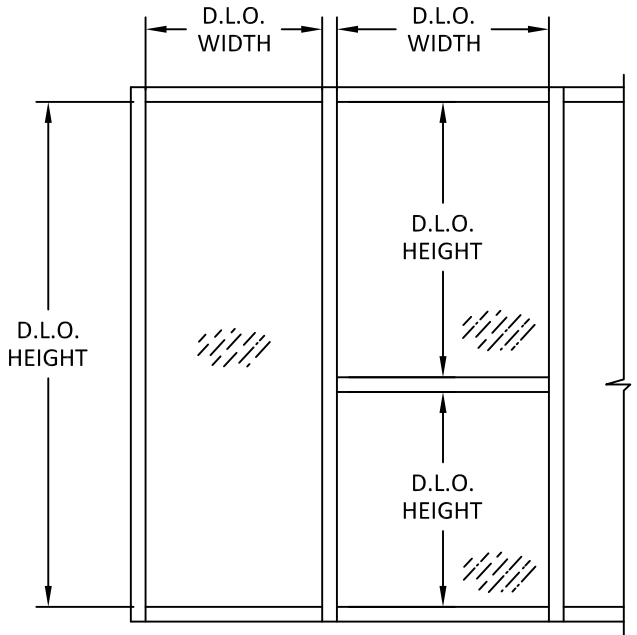
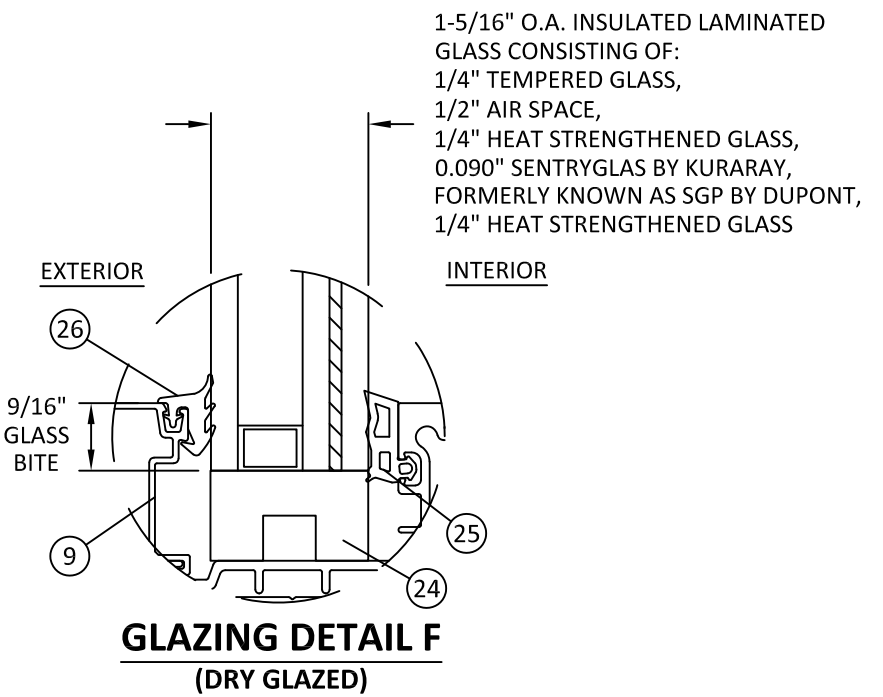

GLAZING DETAILS CONTINUED ON NEXT PAGE

DAYLITE OPENING DIMENSIONS:
 DAYLITE OPENING WIDTH:
 • NOMINAL PANEL WIDTH - 2.500"
 DAYLITE OPENING HEIGHT:
 • FRAME HEIGHT - 5.625"

NOTE:
 GLASS CAPACITIES ON THIS SHEET ARE BASED ON ASTM E1300 (3 SEC. GUSTS) AND CHAPTER 17 OF THE IBC FOR SIZES OTHER THAN TESTED.

GLASS TYPES

LARGE & SMALL MISSILE IMPACT (CONTINUED)

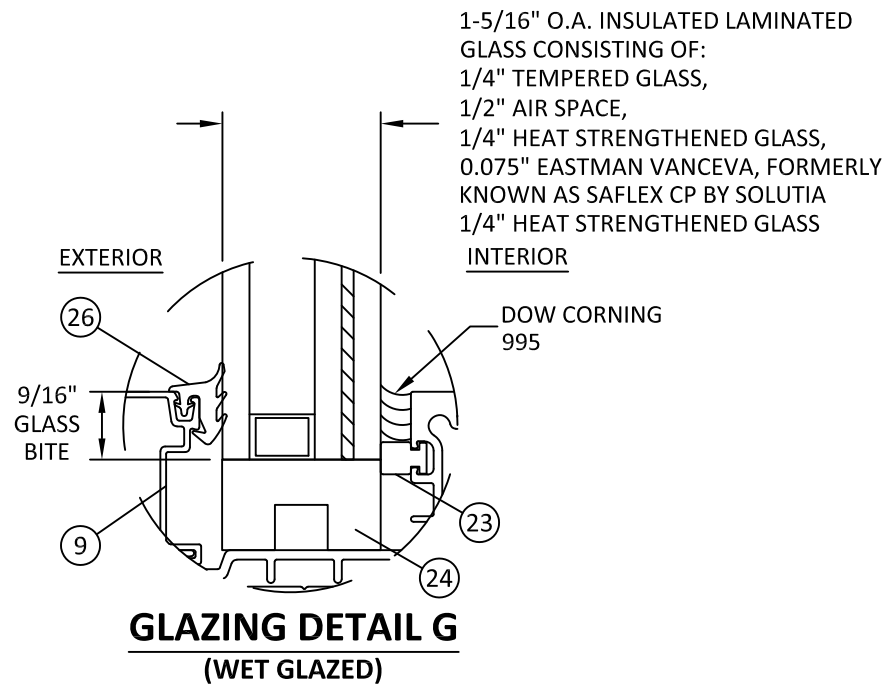

1-5/16" O.A. INSULATED LAMINATED GLASS CONSISTING OF:
 1/4" TEMPERED GLASS,
 1/2" AIR SPACE,
 1/4" HEAT STRENGTHENED GLASS,
 0.075" EASTMAN VANCEVA, FORMERLY KNOWN AS SAFLEX CP BY SOLUTIA
 1/4" HEAT STRENGTHENED GLASS

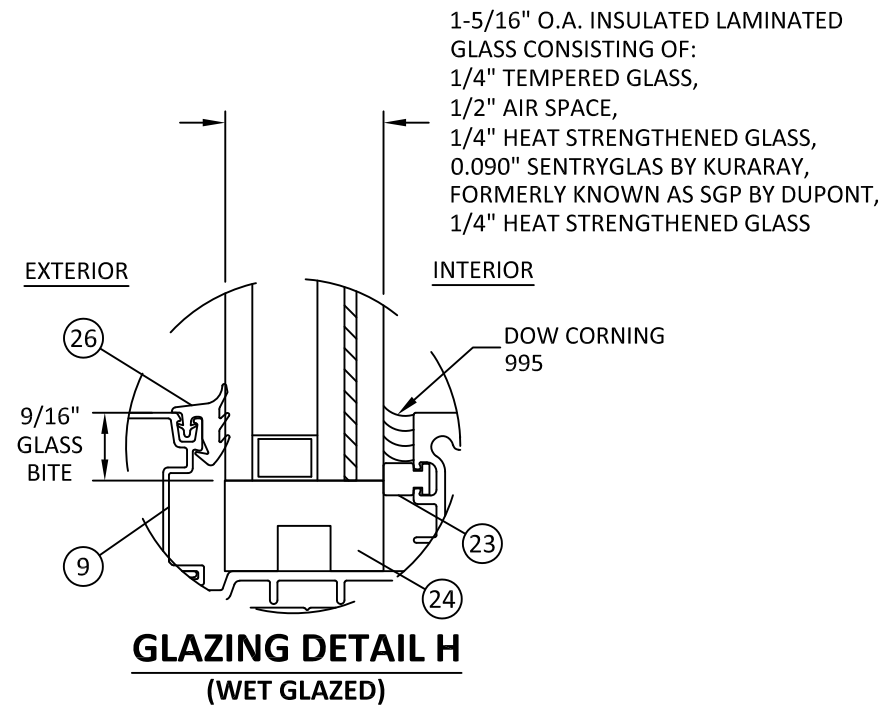

1-5/16" O.A. INSULATED LAMINATED GLASS CONSISTING OF:
 1/4" TEMPERED GLASS,
 1/2" AIR SPACE,
 1/4" HEAT STRENGTHENED GLASS,
 0.090" SENTRYGLAS BY KURARAY, FORMERLY KNOWN AS SGP BY DUPONT,
 1/4" HEAT STRENGTHENED GLASS

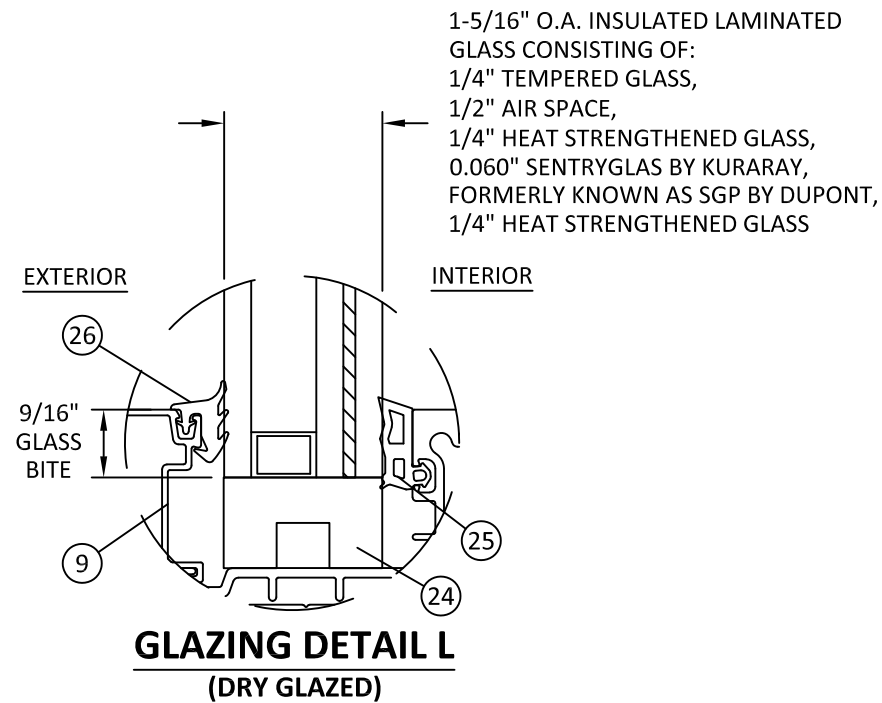

1-5/16" O.A. INSULATED LAMINATED GLASS CONSISTING OF:
 1/4" TEMPERED GLASS,
 1/2" AIR SPACE,
 1/4" HEAT STRENGTHENED GLASS,
 0.060" SENTRYGLAS BY KURARAY, FORMERLY KNOWN AS SGP BY DUPONT,
 1/4" HEAT STRENGTHENED GLASS

ALUMINUM BOX SPACER:
 AROUND THE PERIMETER OF THE GLASS.
PRIMARY SEALANT:
 POLYISOBUTYLENE (PBI).
SECONDARY SEALANT:
 STRUCTURAL SILICONE INTENDED FOR FABRICATION OF INSULATED GLASS UNITS.



YKK AP AMERICA, INC.
 1229 HWY 441 BYPASS
 DUBLIN, GEORGIA 31021
 PH: (478)277-1955 FAX: (678)838-6001

TITLE: YHS 50 FI ALUMINUM STOREFRONT SYSTEM - OUTSIDE GLAZED (IMPACT)
 LMI GLAZING DETAILS

PREPARED BY: BUILDING DROPS, INC.
 398 E. DANIA BEACH BLVD., STE. 338
 DANIA BEACH, FL 33004
 PH: (954)399-8478
 FAX: (954)744-4738
 WEB: www.buildingdrops.com

REMARKS	BY	DATE

THE INSTALLATION DETAILS DESCRIBED HEREIN ARE GENERIC AND MAY NOT REFLECT ACTUAL CONDITIONS FOR A SPECIFIC SITE. IF SITE CONDITIONS CAUSE INSTALLATION TO DEVIATE FROM THE REQUIREMENTS DETAILED HEREIN, A LICENSED ENGINEER OR ARCHITECT SHALL PREPARE SITE SPECIFIC DOCUMENTS FOR USE WITH THIS DOCUMENT.



HERMES F. NORERO, P.E.
 TEXAS P.E. No. 118471
 BUILDING DROPS, INC.
 398 E. DANIA BEACH BLVD. # 338
 DANIA BEACH, FL 33004
 TBPE FIRM No. 13734

DATE: 09.20.21
DWG. BY: MS **CHK. BY:** HFN
SCALE: NTS
DWG. #: YKK283
SHEET:

10/27/2021 5:45 PM
 s:\projects\ykk_ap_america, inc.\tdi-21-0919 - tdi submittal - revision cwsf 51, cwsf 52, cwsf 53\dwgs\ykk283_yhs 50 fi og_wz3.dwg

GLASS TYPES

LARGE MISSILE IMPACT

MISSILE LEVEL E RATED

GLASS LOAD CAPACITY (PSF)				GLASS LOAD CAPACITY (PSF)			
NOMINAL DIMS.		GLASS TYPE 'A'		NOMINAL DIMS.		GLASS TYPE 'A'	
D.L.O. WIDTH 'a'	D.L.O. HEIGHT 'b'	EXT. (+)	INT. (-)	D.L.O. WIDTH 'a'	D.L.O. HEIGHT 'b'	EXT. (+)	INT. (-)
27.5	54.375	70.0	90.0	27.5	90.375	70.0	90.0
33.5		70.0	90.0	33.5		70.0	90.0
39.5		70.0	90.0	39.5		70.0	90.0
45.5		70.0	90.0	45.5		70.0	90.0
51.5		70.0	90.0	51.5		70.0	90.0
57.5		70.0	90.0	57.5		70.0	90.0
63.5		70.0	90.0	63.5		63.4	81.5
69.5	70.0	90.0	69.5	57.9	74.5		
27.5	60.375	70.0	90.0	27.5	96.375	70.0	90.0
33.5		70.0	90.0	33.5		70.0	90.0
39.5		70.0	90.0	39.5		70.0	90.0
45.5		70.0	90.0	45.5		70.0	90.0
51.5		70.0	90.0	51.5		70.0	90.0
57.5		70.0	90.0	57.5		70.0	90.0
63.5		66.7	85.7	63.5		63.4	81.5
69.5	66.7	85.7	66.5	60.5	77.8		
27.5	66.375	70.0	90.0	27.5	102.375	70.0	90.0
33.5		70.0	90.0	33.5		70.0	90.0
39.5		70.0	90.0	39.5		70.0	90.0
45.5		70.0	90.0	45.5		70.0	90.0
51.5		70.0	90.0	51.5		70.0	90.0
57.5		70.0	90.0	57.5		70.0	90.0
63.5		63.4	81.5	63.5		63.4	81.5
69.5	60.6	78.0	27.5	70.0	90.0		
27.5	72.375	70.0	90.0	33.5	108.375	70.0	90.0
33.5		70.0	90.0	39.5		70.0	90.0
39.5		70.0	90.0	45.5		70.0	90.0
45.5		70.0	90.0	51.5		70.0	90.0
51.5		70.0	90.0	57.5		70.0	90.0
57.5		70.0	90.0	60.5		66.5	85.5
63.5		63.4	81.5	27.5		70.0	90.0
69.5	57.9	74.5	33.5	70.0	90.0		
27.5	78.375	70.0	90.0	39.5	114.375	70.0	90.0
33.5		70.0	90.0	45.5		70.0	90.0
39.5		70.0	90.0	51.0		70.0	90.0
45.5		70.0	90.0	57.5		70.0	90.0
51.5		70.0	90.0	27.5		70.0	90.0
57.5		70.0	90.0	33.5		70.0	90.0
63.5		63.4	81.5	38.5		70.0	90.0
69.5	57.9	74.5	27.5	70.0	90.0		
27.5	84.375	70.0	90.0	33.5	120.375	70.0	90.0
33.5		70.0	90.0	36.5		70.0	90.0
39.5		70.0	90.0	27.5		70.0	90.0
45.5		70.0	90.0	33.5		70.0	90.0
51.5		70.0	90.0	34.5		70.0	90.0
57.5		70.0	90.0	27.5		70.0	90.0
63.5		63.4	81.5	33.5		70.0	90.0
69.5	57.9	74.5	33.5	70.0	90.0		

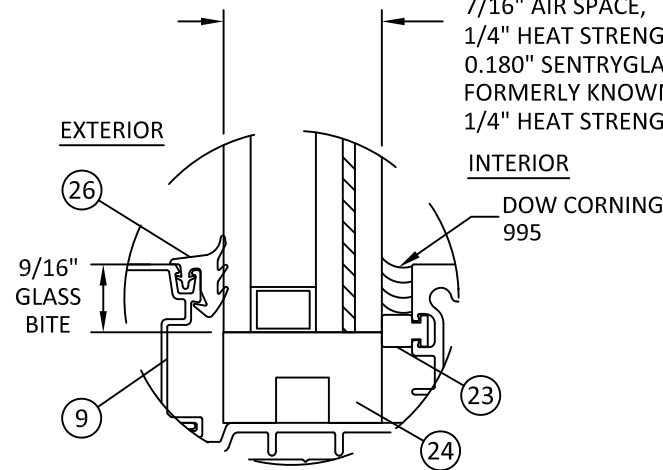

GLAZING DETAIL A
(WET GLAZED)

1-5/16" O.A. INSULATED LAMINATED GLASS CONSISTING OF:
 1/4" TEMPERED GLASS,
 7/16" AIR SPACE,
 1/4" HEAT STRENGTHENED GLASS,
 0.180" SENTRYGLAS BY KURARAY, FORMERLY KNOWN AS SGP BY DUPONT,
 1/4" HEAT STRENGTHENED GLASS

ALUMINUM BOX SPACER:
 AROUND THE PERIMETER OF THE GLASS.
 PRIMARY SEALANT:
 POLYISOBUTYLENE (PIB).
 SECONDARY SEALANT:
 STRUCTURAL SILICONE INTENDED FOR FABRICATION OF INSULATED GLASS UNITS.

- * NOTE:
- GLASS CAPACITIES ON THIS SHEET ARE BASED ON ASTM E1300 (3 SEC. GUSTS) AND CHAPTER 17 OF THE CURRENT IBC FOR SIZES OTHER THAN TESTED.
 - SETTING BLOCK DUROMETER HARDNESS OF 70-90 (SHORE A) AS REFERENCED IN CHAPTER 24.
 - SETTING BLOCKS TO BE LOCATED AT 1/4 SPAN LENGTH FOR GLASS WIDER THAN 36" AS PER CHAPTER 24.
 - D.L.O. MAY NOT EXCEED MAX DIMENSIONS IN GLASS CHARTS FOR GLASS TYPE.

DAYLITE OPENING DIMENSIONS:
 DAYLITE OPENING WIDTH:
 • NOMINAL PANEL WIDTH - 2.500"
 DAYLITE OPENING HEIGHT:
 • FRAME HEIGHT - 5.625"

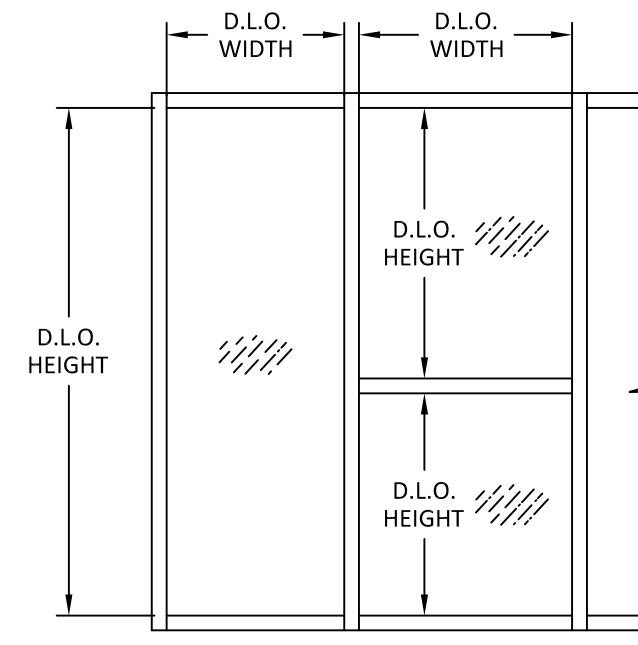

YKK AP AMERICA, INC.
 1229 HWY 441 BYPASS
 DUBLIN, GEORGIA 31021
 PH: (478)277-1955 FAX: (678)838-6001

TITLE: YHS 50 FI ALUMINUM STOREFRONT SYSTEM - OUTSIDE GLAZED (IMPACT)
 GLAZING DETAILS (MISSILE LEVEL E)
 PREPARED BY: BUILDING DROPS, INC.
 398 E. DANIA BEACH BLVD., STE. 338
 DANIA BEACH, FL 33004
 PH: (954)399-8478
 FAX: (954)744-4738
 WEB: www.buildingdrops.com

REMARKS	BY	DATE

THE INSTALLATION DETAILS DESCRIBED HEREIN ARE GENERIC AND MAY NOT REFLECT ACTUAL CONDITIONS FOR A SPECIFIC SITE. IF SITE CONDITIONS CAUSE INSTALLATION TO DEVIATE FROM THE REQUIREMENTS DETAILED HEREIN, A LICENSED ENGINEER OR ARCHITECT SHALL PREPARE SITE SPECIFIC DOCUMENTS FOR USE WITH THIS DOCUMENT.

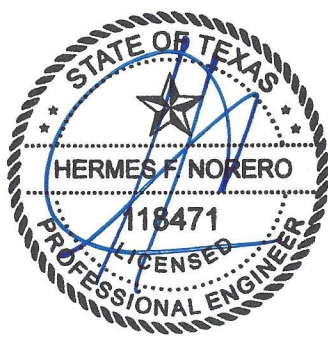

HERMES F. NORERO, P.E.
 TEXAS P.E. No. 118471
 BUILDING DROPS, INC
 398 E. DANIA BEACH BLVD. # 338
 DANIA BEACH, FL 33004
 TBPE FIRM No. 13734

DATE: 09.20.21
 DWG. BY: MS
 CHK. BY: HFN
 SCALE: NTS
 DWG. #: YKK283
 SHEET:

5A

10/27/2021 5:46 PM s:\projects\ykk_ap_america, inc\tel-21-0919 - tel submittal - revision cwsf 51, cwsf 52, cwsf 53\dwg\ykk283_yhs 50 fi og_wz3.dwg

MULLION LOAD TABLES

LIGHT CONFIGURATION



YKK AP AMERICA, INC.
1229 HWY 441 BYPASS
DUBLIN, GEORGIA 31021
PH: (478)277-1955 FAX: (678)838-6001

DESIGN LOAD CAPACITY - PSF			
NOMINAL DIMS.		LIGHT JAMB - J1	LIGHT MULLION - M1
WIDTH (W)	FRAME HEIGHT	EXT. (+) INT. (-)	EXT. (+) INT. (-)
30	72	50.0	50.0
33		50.0	50.0
36		50.0	50.0
39		50.0	50.0
42		50.0	50.0
45		50.0	50.0
48		50.0	50.0
51		50.0	50.0
54		50.0	50.0
57		50.0	50.0
60		50.0	50.0
63		50.0	50.0
66	78	50.0	50.0
69		50.0	50.0
72		50.0	50.0
30		50.0	50.0
33		50.0	50.0
36		50.0	50.0
39		50.0	50.0
42		50.0	50.0
45		50.0	50.0
48		50.0	50.0
51		50.0	50.0
54		50.0	50.0
57	50.0	50.0	
60	50.0	50.0	
63	50.0	50.0	
66	50.0	50.0	
30	84	50.0	50.0
33		50.0	50.0
36		50.0	50.0
39		50.0	50.0
42		50.0	50.0
45		50.0	50.0
48		50.0	50.0
51		50.0	50.0
54		50.0	50.0
57		50.0	50.0
60		50.0	50.0

DESIGN LOAD CAPACITY - PSF				
NOMINAL DIMS.		LIGHT JAMB - J1	LIGHT MULLION - M1	
WIDTH (W)	FRAME HEIGHT	EXT. (+) INT. (-)	EXT. (+) INT. (-)	
30	90	50.0	50.0	
33		50.0	50.0	
36		50.0	50.0	
39		50.0	50.0	
42		50.0	50.0	
45		50.0	50.0	
48		50.0	50.0	
51		50.0	50.0	
54		50.0	48.4	
57		50.0	45.9	
30		96	50.0	50.0
33			50.0	50.0
36	50.0		50.0	
39	50.0		50.0	
42	50.0		50.0	
45	50.0		50.0	
48	50.0		47.9	
51	50.0		45.1	
54	50.0		42.6	
30	102		50.0	50.0
33			50.0	50.0
36			50.0	50.0
39		50.0	50.0	
42		50.0	48.5	
45		50.0	45.2	
48		50.0	42.4	
51		50.0	40.7	
30		108	50.0	50.0
33			50.0	50.0
36			50.0	50.0
39			50.0	46.6
42	50.0		43.2	
45	50.0		40.3	
48	50.0		37.8	



WIDTH (W) = W1 (JAMB)
 WIDTH (W) = $\frac{W2 + W3}{2}$ (MULLION)

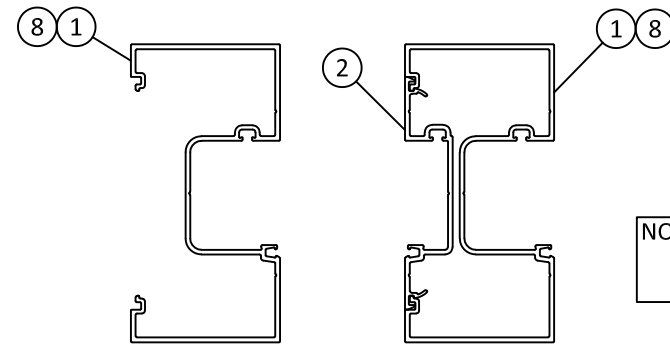

NOTE:
PROFILE #1 SHOWN,
PROFILE #8 SIMILAR.

LIGHT JAMB - J1 LIGHT MULLION - M1

LIGHT CONFIGURATION

TITLE:
YHS 50 FI ALUMINUM STOREFRONT
SYSTEM - OUTSIDE GLAZED
(IMPACT)
LIGHT MULL TABLES

PREPARED BY:
BUILDING DROPS, INC.
398 E. DANIA BEACH BLVD., STE. 338
DANIA BEACH, FL 33004
PH: (954)399-8478
FAX: (954)744-4738
WEB: www.buildingdrops.com

REMARKS	BY	DATE

THE INSTALLATION DETAILS DESCRIBED HEREIN ARE GENERIC AND MAY NOT REFLECT ACTUAL CONDITIONS FOR A SPECIFIC SITE. IF SITE CONDITIONS CAUSE INSTALLATION TO DEVIATE FROM THE REQUIREMENTS DETAILED HEREIN, A LICENSED ENGINEER OR ARCHITECT SHALL PREPARE SITE SPECIFIC DOCUMENTS FOR USE WITH THIS DOCUMENT.

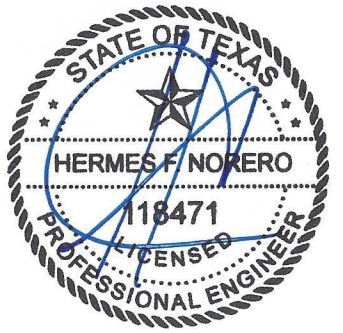

HERMES F. NORERO, P.E.
TEXAS P.E. No. 118471
BUILDING DROPS, INC.
398 E. DANIA BEACH BLVD. # 338
DANIA BEACH, FL 33004
TBPE FIRM No. 13734

DATE:	09.20.21
DWG. BY:	MS
CHK. BY:	HFN
SCALE:	NTS
DWG. #:	YKK283
SHEET:	6

10/27/2021 5:46 PM
s:\projects\ykk_ap_america, inc\tdi-21-0919 - tdi submittal - revision cwsf 51, cwsf 52, cwsf 53\dwg\ykk283_yhs 50 fi og_wz3.dwg

MULLION LOAD TABLES

MEDIUM CONFIGURATION



YKK AP AMERICA, INC.
1229 HWY 441 BYPASS
DUBLIN, GEORGIA 31021
PH: (478)277-1955 FAX: (678)838-6001

DESIGN LOAD CAPACITY - PSF					
NOMINAL DIMS.		MEDIUM JAMB - J2	MEDIUM JAMB - J3	MEDIUM MULLION - M2	MEDIUM MULLION - M3
WIDTH (W)	FRAME HEIGHT	EXT. (+) INT. (-)	EXT. (+) INT. (-)	EXT. (+) INT. (-)	EXT. (+) INT. (-)
30	60	70.0	70.0	70.0	70.0
36		70.0	70.0	70.0	70.0
42		70.0	70.0	70.0	70.0
48		70.0	70.0	70.0	70.0
54		70.0	70.0	70.0	70.0
60		70.0	70.0	70.0	70.0
66		70.0	70.0	70.0	70.0
72		70.0	70.0	70.0	70.0
30	66	70.0	70.0	70.0	70.0
36		70.0	70.0	70.0	70.0
42		70.0	70.0	70.0	70.0
48		70.0	70.0	70.0	70.0
54		70.0	70.0	70.0	70.0
60		70.0	70.0	70.0	70.0
66		70.0	70.0	70.0	70.0
72		70.0	70.0	70.0	70.0
30	72	70.0	70.0	70.0	70.0
36		70.0	70.0	70.0	70.0
42		70.0	70.0	70.0	70.0
48		70.0	70.0	70.0	70.0
54		70.0	70.0	70.0	70.0
60		70.0	70.0	70.0	70.0
66		70.0	70.0	70.0	70.0
72		70.0	70.0	70.0	70.0
30	78	70.0	70.0	70.0	70.0
36		70.0	70.0	70.0	70.0
42		70.0	70.0	70.0	70.0
48		70.0	70.0	70.0	70.0
54		70.0	70.0	70.0	70.0
60		70.0	70.0	70.0	70.0
66		70.0	70.0	70.0	70.0
72		70.0	70.0	70.0	70.0

DESIGN LOAD CAPACITY - PSF						
NOMINAL DIMS.		MEDIUM JAMB - J2	MEDIUM JAMB - J3	MEDIUM MULLION - M2	MEDIUM MULLION - M3	
WIDTH (W)	FRAME HEIGHT	EXT. (+) INT. (-)	EXT. (+) INT. (-)	EXT. (+) INT. (-)	EXT. (+) INT. (-)	
30	84	70.0	70.0	70.0	70.0	
36		70.0	70.0	70.0	70.0	
42		70.0	70.0	70.0	70.0	
48		70.0	70.0	70.0	70.0	
54		70.0	70.0	70.0	70.0	
60		70.0	70.0	70.0	70.0	
66		70.0	70.0	70.0	70.0	
72		70.0	70.0	70.0	70.0	
30	90	70.0	70.0	70.0	70.0	
36		70.0	70.0	70.0	70.0	
42		70.0	70.0	70.0	70.0	
48		70.0	70.0	70.0	70.0	
54		70.0	70.0	70.0	70.0	
60		70.0	70.0	70.0	70.0	
66		70.0	70.0	70.0	70.0	
72		70.0	70.0	70.0	70.0	
30	96	70.0	70.0	70.0	70.0	
36		70.0	70.0	70.0	70.0	
42		70.0	70.0	70.0	70.0	
48		70.0	70.0	70.0	70.0	
54		70.0	70.0	70.0	70.0	
60		70.0	70.0	70.0	70.0	
66		70.0	70.0	70.0	70.0	
72		70.0	70.0	70.0	65.7	
30	102	70.0	70.0	70.0	70.0	
36		70.0	70.0	70.0	70.0	
42		70.0	70.0	70.0	70.0	
48		70.0	70.0	70.0	70.0	
54		70.0	70.0	70.0	70.0	
60		70.0	70.0	70.0	69.3	
66		70.0	69.6	70.0	63.0	
72		70.0	70.0	70.0	70.0	
30	108	70.0	70.0	70.0	70.0	
36		70.0	70.0	70.0	70.0	
42		70.0	70.0	70.0	70.0	
48		70.0	70.0	70.0	70.0	
54		70.0	70.0	70.0	68.2	
60		70.0	67.9	70.0	61.4	
36		108	70.0	70.0	70.0	70.0
42			70.0	70.0	70.0	70.0
48	70.0		70.0	70.0	68.5	
54	70.0		67.2	70.0	60.9	
60	70.0	60.5	70.0	54.8		

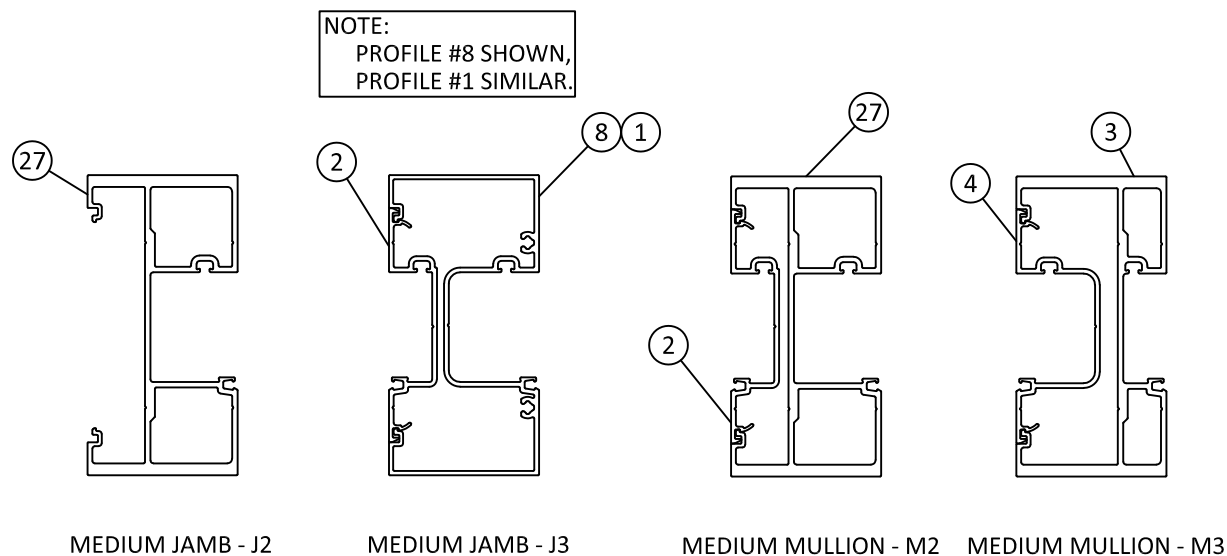

MEDIUM CONFIGURATION

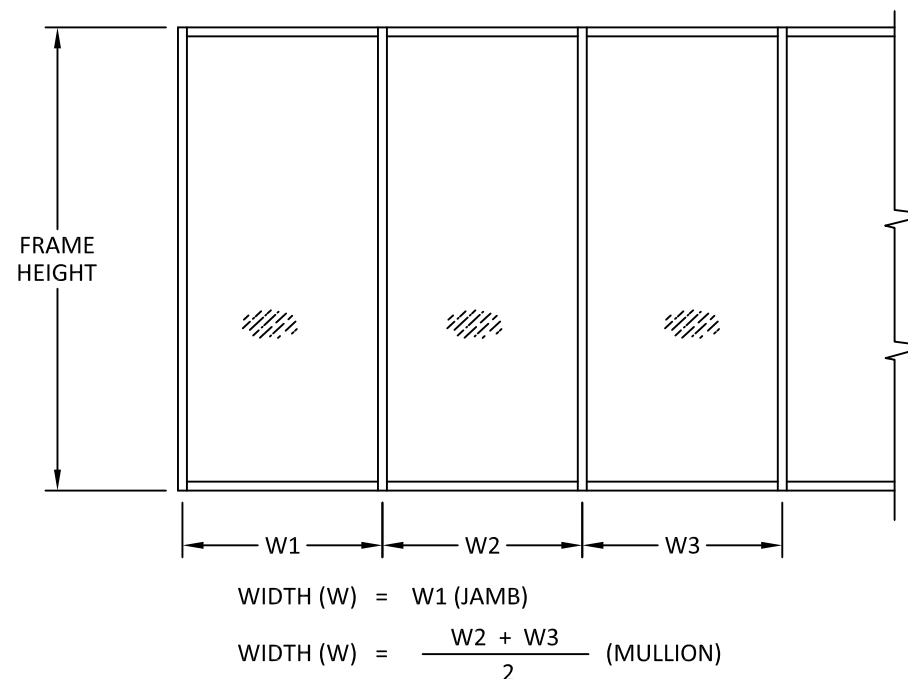

TITLE: YHS 50 FI ALUMINUM STOREFRONT SYSTEM - OUTSIDE GLAZED (IMPACT) MEDIUM MULL TABLES

PREPARED BY: BUILDING DROPS, INC.
398 E. DANIA BEACH BLVD., STE. 338
DANIA BEACH, FL 33004
PH: (954)399-8478
FAX: (954)744-4738
WEB: www.buildingdrops.com

REMARKS	BY	DATE

THE INSTALLATION DETAILS DESCRIBED HEREIN ARE GENERIC AND MAY NOT REFLECT ACTUAL CONDITIONS FOR A SPECIFIC SITE. IF SITE CONDITIONS CAUSE INSTALLATION TO DEVIATE FROM THE REQUIREMENTS DETAILED HEREIN, A LICENSED ENGINEER OR ARCHITECT SHALL PREPARE SITE SPECIFIC DOCUMENTS FOR USE WITH THIS DOCUMENT.

HERMES F. NORERO, P.E.
TEXAS P.E. No. 118471
BUILDING DROPS, INC.
398 E. DANIA BEACH BLVD. # 338
DANIA BEACH, FL 33004
TBPE FIRM No. 13734

DATE: 09.20.21

DWG. BY: MS CHK. BY: HFN

SCALE: NTS

DWG. #: YKK283

SHEET:

10/27/2021 5:46 PM
s:\projects\ykk_ap_america, inc.\tdi-21-0919 - tdi submittal - revision cwsf 51, cwsf 52, cwsf 53\dwg\ykk283_yhs 50 fi og_wz3.dwg

MULLION LOAD TABLES

HEAVY CONFIGURATION

DESIGN LOAD CAPACITY - PSF			
NOMINAL DIMS.		HEAVY MULLION - M4	
WIDTH (W)	FRAME HEIGHT (H)	EXT. (+)	INT. (-)
72	96	70.0	90.0
69	102	70.0	90.0
66	108	70.0	90.0
61	114	70.0	90.0
63	114	70.0	87.5
55	120	70.0	90.0
60	120	70.0	82.9
41	126	70.0	90.0
39	132	70.0	90.0
37	138	70.0	90.0
33	144	70.0	90.0
36	144	67.5	86.8

NOTE: HEAVY CONFIGURATION JAMBS ARE ANCHORED ALONG THEIR LENGTH AND THEREFORE DO NOT LIMIT DESIGN PRESSURE.

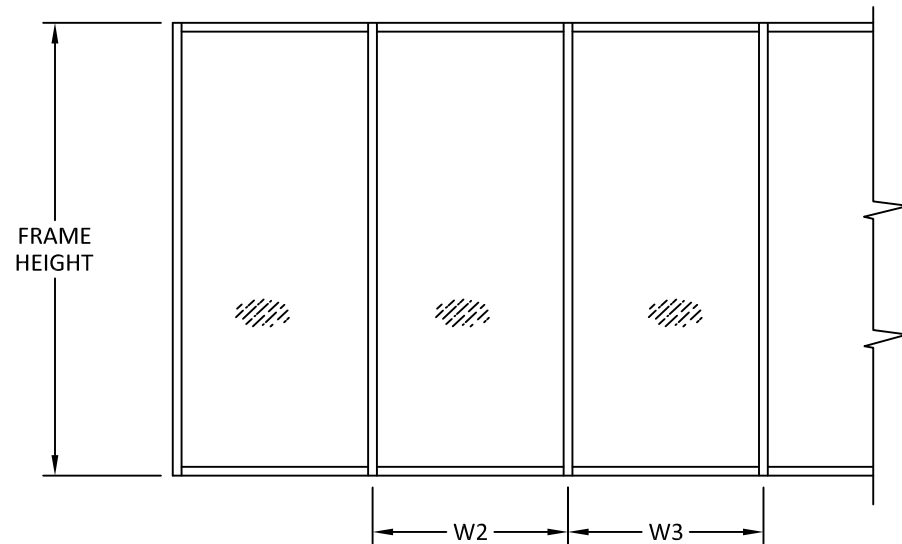

$$\text{WIDTH (W)} = \frac{W2 + W3}{2} \text{ (MULLION)}$$

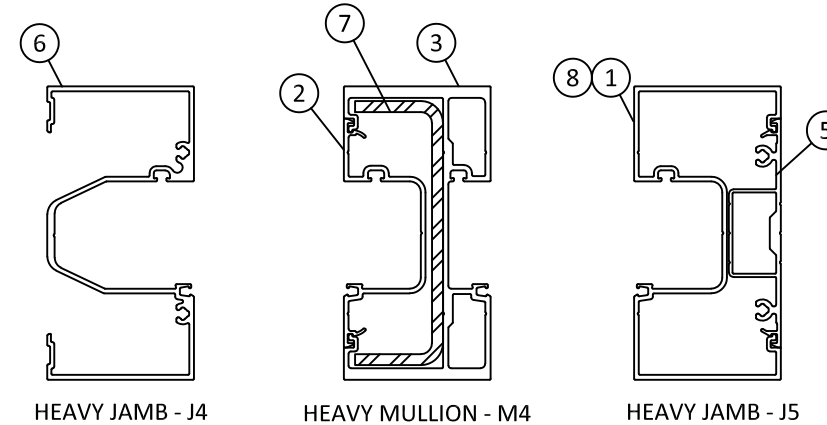

HEAVY CONFIGURATION

NOTE:
PROFILE #1 SHOWN,
PROFILE #8 SIMILAR.



YKK AP AMERICA, INC.
1229 HWY 441 BYPASS
DUBLIN, GEORGIA 31021
PH: (478)277-1955 FAX: (678)838-6001

TITLE:
YHS 50 FI ALUMINUM STOREFRONT
SYSTEM - OUTSIDE GLAZED
(IMPACT)
HEAVY MULL TABLES

PREPARED BY:
BUILDING DROPS, INC.
398 E. DANIA BEACH BLVD., STE. 338
DANIA BEACH, FL 33004
PH: (954)399-8478
FAX: (954)744-4738
WEB: www.buildingdrops.com



REMARKS	BY	DATE

THE INSTALLATION DETAILS DESCRIBED HEREIN ARE GENERIC AND MAY NOT REFLECT ACTUAL CONDITIONS FOR A SPECIFIC SITE. IF SITE CONDITIONS CAUSE INSTALLATION TO DEVIATE FROM THE REQUIREMENTS DETAILED HEREIN, A LICENSED ENGINEER OR ARCHITECT SHALL PREPARE SITE SPECIFIC DOCUMENTS FOR USE WITH THIS DOCUMENT.



HERMES F. NORERO, P.E.
TEXAS P.E. No. 118471
BUILDING DROPS, INC.
398 E. DANIA BEACH BLVD. # 338
DANIA BEACH, FL 33004
TBPE FIRM No. 13734

DATE:	09.20.21	
DWG. BY:	MS	CHK. BY: HFN
SCALE:	NTS	
DWG. #:	YKK283	
SHEET:	8	

MULLION LOAD TABLES

EXPANSION MULLION

DESIGN LOAD CAPACITY - PSF			DESIGN LOAD CAPACITY - PSF			DESIGN LOAD CAPACITY - PSF		
NOMINAL DIMS.		EXPANSION MULLION	NOMINAL DIMS.		EXPANSION MULLION	NOMINAL DIMS.		EXPANSION MULLION
WIDTH (W)	FRAME HEIGHT (H)	EXT. (+) INT. (-)	WIDTH (W)	FRAME HEIGHT (H)	EXT. (+) INT. (-)	WIDTH (W)	FRAME HEIGHT (H)	EXT. (+) INT. (-)
30	72	65.0	30	90	65.0	30	108	65.0
33		65.0	33		65.0	33		65.0
36		65.0	36		65.0	36		65.0
39		65.0	39		65.0	39		65.0
42		65.0	42		65.0	42		65.0
45		65.0	45		65.0	45		65.0
48		65.0	48		65.0	48		65.0
51		65.0	51		65.0	51		65.0
54		65.0	54		65.0	54		65.0
57		65.0	57		65.0	57		65.0
60		65.0	60		65.0	60		65.0
63		65.0	63		65.0	63		65.0
66		65.0	66		65.0	66		63.0
69		65.0	69		65.0	69		65.0
72	65.0	72	65.0	72	65.0			
30	78	65.0	30	96	65.0	30	114	65.0
33		65.0	33		65.0	33		65.0
36		65.0	36		65.0	36		65.0
39		65.0	39		65.0	39		65.0
42		65.0	42		65.0	42		65.0
45		65.0	45		65.0	45		65.0
48		65.0	48		65.0	48		65.0
51		65.0	51		65.0	51		65.0
54		65.0	54		65.0	54		62.2
57		65.0	57		65.0	57		59.2
60		65.0	60		65.0	60		65.0
63		65.0	63		65.0	63		65.0
66		65.0	66		65.0	66		65.0
69		65.0	69		65.0	69		65.0
72	65.0	72	65.0	72	65.0			
30	84	65.0	30	102	65.0	30	120	65.0
33		65.0	33		65.0	33		65.0
36		65.0	36		65.0	36		65.0
39		65.0	39		65.0	39		65.0
42		65.0	42		65.0	42		65.0
45		65.0	45		65.0	45		62.4
48		65.0	48		65.0	48		59.1
51		65.0	51		65.0	51		56.1
54		65.0	54		65.0	54		65.0
57		65.0	57		65.0	57		65.0
60		65.0	60		65.0	60		65.0
63		65.0	63		65.0	63		65.0
66		65.0	66		65.0	66		65.0
69		65.0	69		65.0	69		65.0
72	65.0	72	65.0	72	65.0			
30	84	65.0	30	102	65.0	30	126	65.0
33		65.0	33		65.0	33		65.0
36		65.0	36		65.0	36		65.0
39		65.0	39		65.0	39		65.0
41		65.0	41		65.0	41		65.0
30		65.0	30		65.0	30		65.0
33	65.0	33	65.0	33	65.0			
36	65.0	36	65.0	36	65.0			
39	65.0	39	65.0	39	65.0			
30	84	65.0	30	102	65.0	30	132	65.0
33		65.0	33		65.0	33		65.0
37		65.0	37		65.0	37		65.0

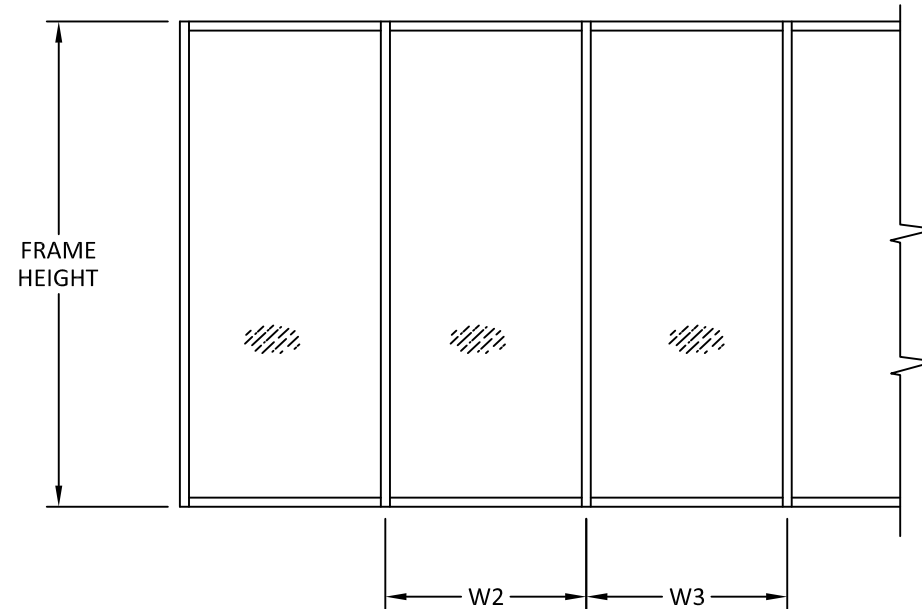

$$\text{WIDTH (W)} = \frac{W2 + W3}{2} \text{ (MULLION)}$$

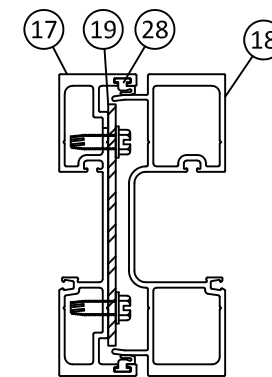

EXPANSION MULLION

NOTE: EXPANSION MULL MAY BE USED WITH ANY MULLION CONFIGURATION SUCH THAT ALLOWABLE SIZES AND PRESSURES ARE NOT EXCEEDED.



YKK AP AMERICA, INC.
 1229 HWY 441 BYPASS
 DUBLIN, GEORGIA 31021
 PH: (478)277-1955 FAX: (678)838-6001

TITLE: YHS 50 FI ALUMINUM STOREFRONT SYSTEM - OUTSIDE GLAZED (IMPACT)
EXPANSION MULL TABLES

PREPARED BY: BUILDING DROPS, INC.
 398 E. DANIA BEACH BLVD., STE. 338
 DANIA BEACH, FL 33004
 PH: (954)399-8478
 FAX: (954)744-4738
 WEB: www.buildingdrops.com

REMARKS	BY	DATE

THE INSTALLATION DETAILS DESCRIBED HEREIN ARE GENERIC AND MAY NOT REFLECT ACTUAL CONDITIONS FOR A SPECIFIC SITE. IF SITE CONDITIONS CAUSE INSTALLATION TO DEVIATE FROM THE REQUIREMENTS DETAILED HEREIN, A LICENSED ENGINEER OR ARCHITECT SHALL PREPARE SITE SPECIFIC DOCUMENTS FOR USE WITH THIS DOCUMENT.

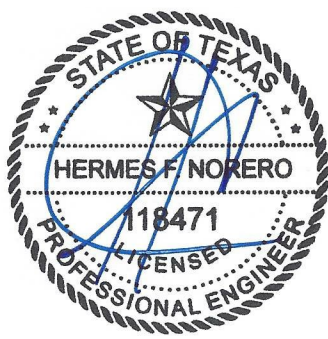

HERMES F. NORERO, P.E.
 TEXAS P.E. No. 118471
 BUILDING DROPS, INC.
 398 E. DANIA BEACH BLVD. # 338
 DANIA BEACH, FL 33004
 TBPE FIRM No. 13734

DATE: 09.20.21	
DWG. BY: MS	CHK. BY: HFN
SCALE: NTS	
DWG. #: YKK283	
SHEET:	

9

10/27/2021 5:46 PM s:\projects\ykk_ap_america, inc.\tdi-21-0919 - tdi submittal - revision cwsf 51, cwsf 52, cwsf 53\dwgs\ykk283_yhs 50 fi og_wz3.dwg

SMI MULLION LOAD TABLES

HEAVY CONFIGURATION FOR USE IN SMALL MISSILE IMPACT APPLICATIONS ONLY

DESIGN LOAD CAPACITY - PSF			
NOMINAL DIMS.		HEAVY MULLION - M4	
WIDTH (W)	FRAME HEIGHT (H)	EXT. (+)	INT. (-)
72	96	70.0	90.0
69	102	70.0	90.0
66	108	70.0	90.0
61	114	70.0	90.0
63	114	70.0	87.5
55	120	70.0	90.0
60	120	70.0	82.9
41	126	70.0	90.0
39	132	70.0	90.0
37	138	70.0	90.0
33	144	70.0	90.0
36	144	67.5	86.8

NOTE: HEAVY CONFIGURATION JAMBS ARE ANCHORED ALONG THEIR LENGTH AND THEREFORE DO NOT LIMIT DESIGN PRESSURE.

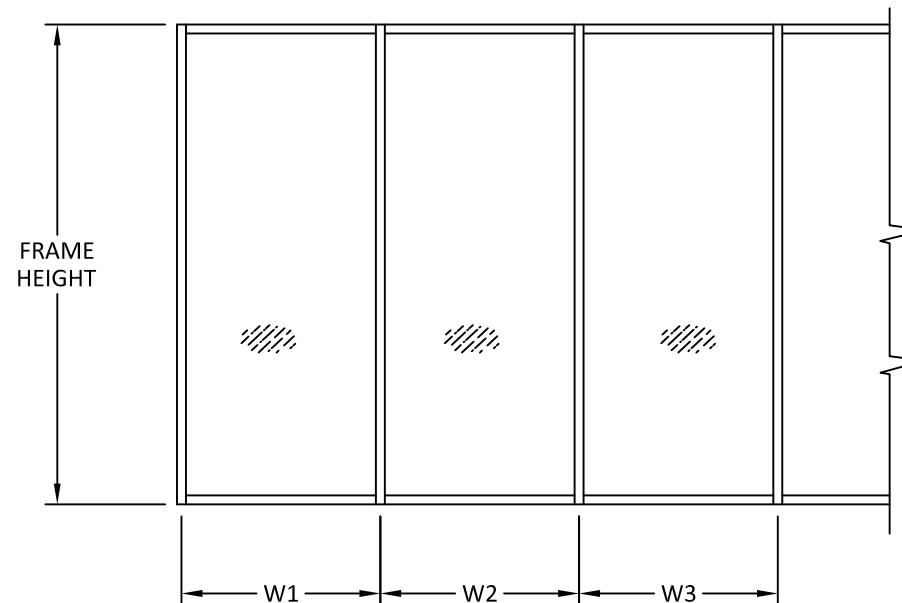

$$\text{WIDTH (W)} = \frac{W2 + W3}{2} \text{ (MULLION)}$$

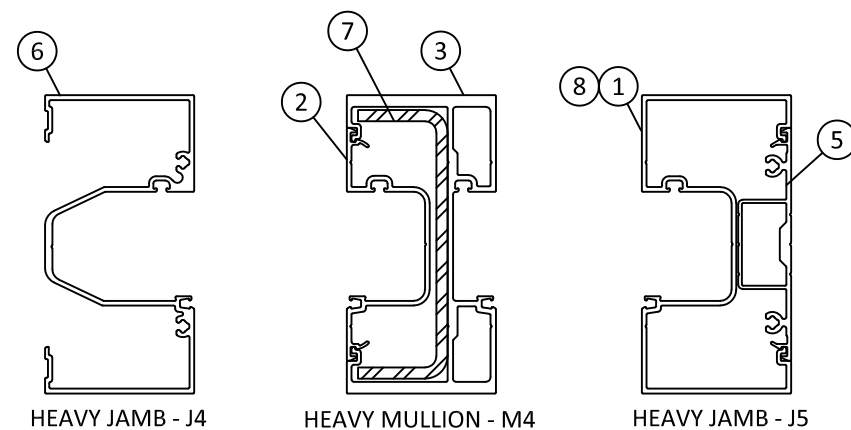

HEAVY JAMB - J4

HEAVY MULLION - M4

HEAVY JAMB - J5

HEAVY CONFIGURATION

NOTE:
PROFILE #1 SHOWN,
PROFILE #8 SIMILAR.

NOTE: ALL PREVIOUSLY DETAILED MULLION CONFIGURATIONS ARE ACCEPTABLE FOR USE IN SMI CONFIGURATIONS IN ADDITION TO THE CONFIGURATION AND RATINGS SHOWN ON THIS PAGE.



YKK AP AMERICA, INC.
1229 HWY 441 BYPASS
DUBLIN, GEORGIA 31021
PH: (478)277-1955 FAX: (678)838-6001

TITLE: YHS 50 FI ALUMINUM STOREFRONT SYSTEM - OUTSIDE GLAZED (IMPACT)
SMI ONLY
HEAVY MULL TABLES

PREPARED BY: **BUILDING DROPS, INC.**
398 E. DANIA BEACH BLVD., STE. 338
DANIA BEACH, FL 33004
PH: (954)399-8478
FAX: (954)744-4738
WEB: www.buildingdrops.com

REMARKS	BY	DATE

THE INSTALLATION DETAILS DESCRIBED HEREIN ARE GENERIC AND MAY NOT REFLECT ACTUAL CONDITIONS FOR A SPECIFIC SITE. IF SITE CONDITIONS CAUSE INSTALLATION TO DEVIATE FROM THE REQUIREMENTS DETAILED HEREIN, A LICENSED ENGINEER OR ARCHITECT SHALL PREPARE SITE SPECIFIC DOCUMENTS FOR USE WITH THIS DOCUMENT.



HERMES F. NORERO, P.E.
TEXAS P.E. No. 118471
BUILDING DROPS, INC.
398 E. DANIA BEACH BLVD. # 338
DANIA BEACH, FL 33004
TBPE FIRM No. 13734

DATE:	09.20.21	
DWG. BY:	MS	CHK. BY: HFN
SCALE:	NTS	
DWG. #:	YKK283	
SHEET:	10	

10/27/2021 5:46 PM s:\projects\ykk_ap_america, inc\tdi-21-0919 - tdi submittal - revision cwsf 51, cwsf 52, cwsf 53\dwg\ykk283_yhs 50 fi og_wz3.dwg

CORNER MULLION LOAD TABLES

DESIGN LOAD CAPACITY - PSF				DESIGN LOAD CAPACITY - PSF				DESIGN LOAD CAPACITY - PSF						
NOMINAL DIMS.		90 DEGREE MULLION	135 DEGREE MULLION	NOMINAL DIMS.		90 DEGREE MULLION	135 DEGREE MULLION	NOMINAL DIMS.		90 DEGREE MULLION	135 DEGREE MULLION			
WIDTH (W)	FRAME HEIGHT	EXT. (+) INT. (-)	EXT. (+) INT. (-)	WIDTH (W)	FRAME HEIGHT	EXT. (+) INT. (-)	EXT. (+) INT. (-)	WIDTH (W)	FRAME HEIGHT	EXT. (+) INT. (-)	EXT. (+) INT. (-)			
30	72	70.0	70.0	30	90	70.0	70.0	30	108	62.1	57.9			
33		70.0	70.0	33		70.0	70.0	33		56.5	52.6			
36		70.0	70.0	36		70.0	69.5	36		51.8	48.3			
39		70.0	70.0	39		68.8	64.1	39		47.8	44.5			
42		70.0	70.0	42		63.9	59.6	42		44.4	41.4			
45		70.0	70.0	45		59.6	55.6	45		41.4	38.6			
48		70.0	70.0	48		55.9	52.1	48		38.8	36.2			
51		70.0	70.0	51		52.6	49.1	51		36.5	34.1			
54		70.0	70.0	54		49.7	46.3	54		34.5	32.2			
57		70.0	68.6	57		47.1	43.9	57		32.7	30.5			
60	78	69.9	65.1	60	96	44.7	41.7	60	114	31.1	29.0			
63		66.6	62.0	63		42.6	39.7	63		29.6	27.6			
66		63.5	59.2	66		40.7	37.9	66		28.2	26.3			
69		60.8	56.7	69		38.9	36.3	69		26.6	24.7			
72		58.2	54.3	72		37.3	34.7	72		25.2	23.5			
30		70.0	70.0	30		70.0	70.0	30		50.3	46.9			
33		70.0	70.0	33		70.0	66.6	33		45.7	42.6			
36		70.0	70.0	36		65.5	61.1	36		41.9	39.1			
39		70.0	70.0	39		60.5	56.4	39		38.7	36.1			
42		70.0	70.0	42		56.2	52.4	42		35.9	33.5			
45	84	70.0	70.0	45	102	52.4	48.9	45	120	32.8	30.6			
48		70.0	69.4	48		49.1	45.8	48		31.0	28.9			
51		70.0	65.3	51		46.3	43.1	51		29.3	27.4			
54		66.2	61.7	54		43.7	40.7	54		27.9	26.0			
57		62.7	58.4	57		41.4	38.6	57		26.6	24.7			
60		59.6	55.5	60		39.3	36.6	60		25.2	23.5			
63		56.7	52.9	63		37.4	34.9	63		23.8	22.1			
66		54.1	50.5	66		35.7	33.3	66		22.5	20.8			
69		51.8	48.3	69		34.2	31.9	69		21.2	19.5			
72		49.6	46.3	72		32.8	30.5	72		20.0	18.3			
30	90	70.0	70.0	30	110	69.6	64.9	30	126	45.6	42.5			
33		70.0	70.0	33		63.3	59.0	33		41.5	38.7			
36		70.0	70.0	36		58.0	54.1	36		38.0	35.5			
39		70.0	70.0	39		53.6	49.9	39		35.1	32.7			
42		70.0	68.4	42		49.7	46.4	42		32.7	30.2			
45		68.5	63.8	45		46.4	43.3	45		30.4	27.9			
48		64.2	59.8	48		43.5	40.6	48		28.2	25.7			
51		60.4	56.3	51		41.0	38.2	51		26.2	23.7			
54		57.1	53.2	54		38.7	36.1	54		24.4	21.9			
57		54.1	50.4	57		36.7	34.2	57		22.8	20.5			
60	96	51.3	47.9	60	118	34.8	32.5	60	132	37.8	35.2			
63		48.9	45.6	63		33.2	30.9	63		36.0	33.6			
66		46.7	43.5	66		31.7	29.5	66		34.4	32.0			
69		44.7	41.6	69		30.3	28.2	69		32.9	30.5			
72		42.8	39.9	72		29.1	27.1	72		31.5	29.1			
30		108	70.0	70.0		30	120	69.6		64.9	30	138	38.1	35.5
33			70.0	70.0		33		63.3		59.0	33		34.6	32.2
36			70.0	70.0		36		58.0		54.1	36		30.9	28.8
39			70.0	70.0		39		53.6		49.9	39		28.2	26.0
42			70.0	68.4		42		49.7		46.4	42		25.7	23.5
45	68.5		63.8	45	46.4	43.3		45	23.4	21.2				
48	64.2		59.8	48	43.5	40.6		48	21.3	19.1				
51	60.4		56.3	51	41.0	38.2		51	19.4	17.2				
54	57.1		53.2	54	38.7	36.1		54	17.7	15.5				
57	54.1		50.4	57	36.7	34.2		57	16.2	14.1				
60	102	51.3	47.9	60	122	34.8	32.5	60	144	34.9	32.6			
63		48.9	45.6	63		33.2	30.9	63		31.8	29.6			
66		46.7	43.5	66		31.7	29.5	66		29.9	27.7			
69		44.7	41.6	69		30.3	28.2	69		28.2	26.0			
72		42.8	39.9	72		29.1	27.1	72		26.7	24.5			

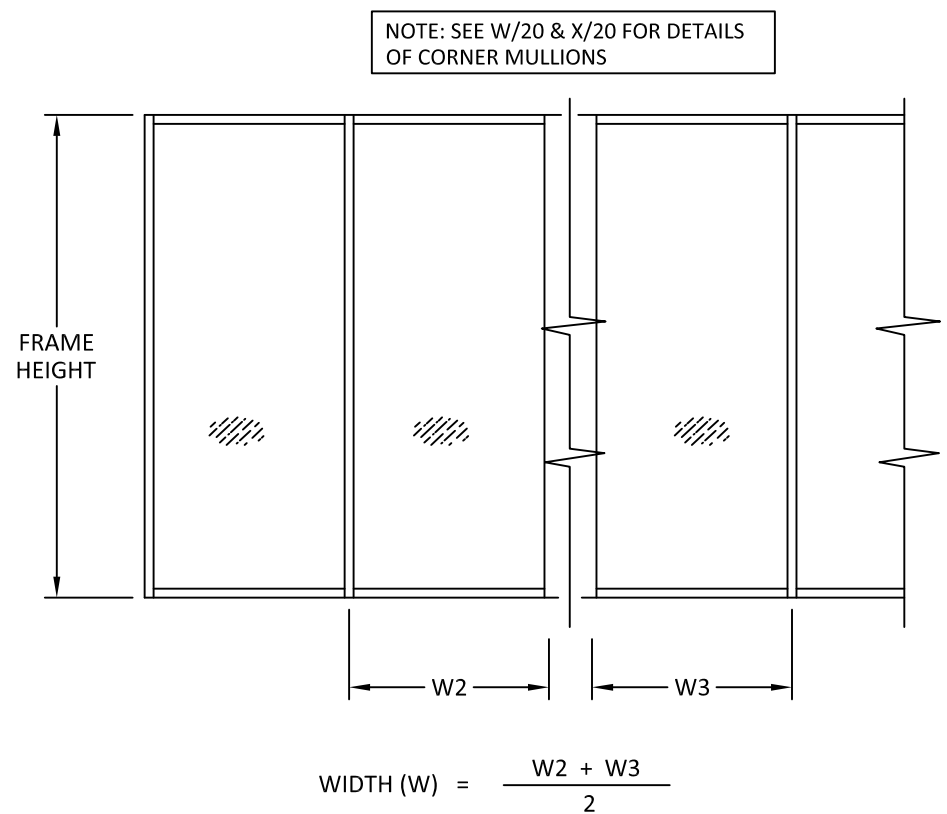

YKK AP Quality inspires™

YKK AP AMERICA, INC.
1229 HWY 441 BYPASS
DUBLIN, GEORGIA 31021
PH: (478)277-1955 FAX: (678)838-6001

TITLE: YHS 50 FI ALUMINUM STOREFRONT SYSTEM - OUTSIDE GLAZED (IMPACT)
CORNER MULL TABLES

PREPARED BY: **BUILDING DROPS, INC.**
398 E. DANIA BEACH BLVD., STE. 338
DANIA BEACH, FL 33004
PH: (954)399-8478
FAX: (954)744-4738
WEB: www.buildingdrops.com

REMARKS	BY	DATE

THE INSTALLATION DETAILS DESCRIBED HEREIN ARE GENERIC AND MAY NOT REFLECT ACTUAL CONDITIONS FOR A SPECIFIC SITE. IF SITE CONDITIONS CAUSE INSTALLATION TO DEVIATE FROM THE REQUIREMENTS DETAILED HEREIN, A LICENSED ENGINEER OR ARCHITECT SHALL PREPARE SITE SPECIFIC DOCUMENTS FOR USE WITH THIS DOCUMENT.

HERMES F. NORERO
118471
LICENSED PROFESSIONAL ENGINEER

HERMES F. NORERO, P.E.
TEXAS P.E. No. 118471
BUILDING DROPS, INC.
398 E. DANIA BEACH BLVD. # 338
DANIA BEACH, FL 33004
TBPE FIRM No. 13734

DATE: **09.20.21**

DWG. BY: **MS** CHK. BY: **HFN**

SCALE: **NTS**

DWG. #: **YKK283**

SHEET: **11**

[PAGE 12 OF 23]

s:\projects\ykk_ap_america, inc.\tdi-21-0919 - tdi submittal - revision cwsf 51, cwsf 52, cwsf 53\dwgs\ykk283_yhs 50 fi og_wz3.dwg 10/27/2021 5:46 PM

ANCHOR TYPE 'A & B' TABLES



YKK AP AMERICA, INC.
 1229 HWY 441 BYPASS
 DUBLIN, GEORGIA 31021
 PH: (478)277-1955 FAX: (678)838-6001

TITLE: YHS 50 FI ALUMINUM STOREFRONT SYSTEM - OUTSIDE GLAZED (IMPACT)
 TYPE A & B ANCHOR TABLES
 PREPARED BY: BUILDING DROPS, INC.
 398 E. DANIA BEACH BLVD., STE. 338
 DANIA BEACH, FL 33004
 PH: (954)399-8478
 FAX: (954)744-4738
 WEB: www.buildingdrops.com

ANCHOR LOAD CAPACITY - PSF EXT. (+) & INT. (-)							
NOMINAL DIMS.		ANCHOR TYPE 'A'			ANCHOR TYPE 'B'		
TRIBUTARY WIDTH 'W' (in.)	FRAME HEIGHT 'H' (in.)	A2	A3	A4	B2	B3	B4
30	72	90.0	90.0	90.0	90.0	90.0	90.0
33		90.0	90.0	90.0	90.0	90.0	90.0
36		90.0	90.0	90.0	90.0	90.0	90.0
39		89.8	90.0	90.0	90.0	90.0	90.0
42		83.3	90.0	90.0	90.0	90.0	90.0
45		77.8	90.0	90.0	90.0	90.0	90.0
48		72.9	90.0	90.0	90.0	90.0	90.0
51		68.6	90.0	90.0	90.0	90.0	90.0
54		64.8	90.0	90.0	90.0	90.0	90.0
57		61.4	90.0	90.0	90.0	90.0	90.0
60		58.3	87.5	90.0	90.0	90.0	90.0
63		55.6	83.3	90.0	89.1	90.0	90.0
66		53.0	79.6	90.0	85.1	90.0	90.0
69		50.7	76.1	90.0	81.4	90.0	90.0
72	48.6	72.9	90.0	78.0	90.0	90.0	
30	78	90.0	90.0	90.0	90.0	90.0	90.0
33		90.0	90.0	90.0	90.0	90.0	90.0
36		89.8	90.0	90.0	90.0	90.0	90.0
39		82.9	90.0	90.0	90.0	90.0	90.0
42		76.9	90.0	90.0	90.0	90.0	90.0
45		71.8	90.0	90.0	90.0	90.0	90.0
48		67.3	90.0	90.0	90.0	90.0	90.0
51		63.4	90.0	90.0	90.0	90.0	90.0
54		59.8	89.8	90.0	90.0	90.0	90.0
57		56.7	85.0	90.0	90.0	90.0	90.0
60		53.9	80.8	90.0	86.4	90.0	90.0
63		51.3	76.9	90.0	82.3	90.0	90.0
66		49.0	73.4	90.0	78.5	90.0	90.0
69		46.8	70.2	90.0	75.1	90.0	90.0
72	44.9	67.3	89.8	72.0	90.0	90.0	
30	84	90.0	90.0	90.0	90.0	90.0	90.0
33		90.0	90.0	90.0	90.0	90.0	90.0
36		83.3	90.0	90.0	90.0	90.0	90.0
39		76.9	90.0	90.0	90.0	90.0	90.0
42		71.4	90.0	90.0	90.0	90.0	90.0
45		66.7	90.0	90.0	90.0	90.0	90.0
48		62.5	90.0	90.0	90.0	90.0	90.0
51		58.8	88.2	90.0	90.0	90.0	90.0
54		55.6	83.3	90.0	89.1	90.0	90.0
57		52.6	79.0	90.0	84.5	90.0	90.0
60		50.0	75.0	90.0	80.2	90.0	90.0
63		47.6	71.4	90.0	76.4	90.0	90.0
66		45.5	68.2	90.0	72.9	90.0	90.0
69		43.5	65.2	87.0	69.8	90.0	90.0
72	41.7	62.5	83.3	66.9	90.0	90.0	

ANCHOR LOAD CAPACITY - PSF EXT. (+) & INT. (-)							
NOMINAL DIMS.		ANCHOR TYPE 'A'			ANCHOR TYPE 'B'		
TRIBUTARY WIDTH 'W' (in.)	FRAME HEIGHT 'H' (in.)	A2	A3	A4	B2	B3	B4
30	90	90.0	90.0	90.0	90.0	90.0	90.0
33		84.9	90.0	90.0	90.0	90.0	90.0
36		77.8	90.0	90.0	90.0	90.0	90.0
39		71.8	90.0	90.0	90.0	90.0	90.0
42		66.7	90.0	90.0	90.0	90.0	90.0
45		62.2	90.0	90.0	90.0	90.0	90.0
48		58.3	87.5	90.0	90.0	90.0	90.0
51		54.9	82.4	90.0	88.1	90.0	90.0
54		51.9	77.8	90.0	83.2	90.0	90.0
57		49.1	73.7	90.0	78.8	90.0	90.0
60		46.7	70.0	90.0	74.9	90.0	90.0
63		44.5	66.7	88.9	71.3	90.0	90.0
66		42.4	63.6	84.9	68.1	90.0	90.0
69		40.6	60.9	81.2	65.1	90.0	90.0
72	38.9	58.3	77.8	62.4	90.0	90.0	
30	96	87.5	90.0	90.0	90.0	90.0	90.0
33		79.6	90.0	90.0	90.0	90.0	90.0
36		72.9	90.0	90.0	90.0	90.0	90.0
39		67.3	90.0	90.0	90.0	90.0	90.0
42		62.5	90.0	90.0	90.0	90.0	90.0
45		58.3	87.5	90.0	90.0	90.0	90.0
48		54.7	82.0	90.0	87.8	90.0	90.0
51		51.5	77.2	90.0	82.6	90.0	90.0
54		48.6	72.9	90.0	78.0	90.0	90.0
57		46.1	69.1	90.0	73.9	90.0	90.0
60		43.8	65.6	87.5	70.2	90.0	90.0
63		41.7	62.5	83.3	66.9	90.0	90.0
66		39.8	59.7	79.6	63.8	90.0	90.0
69		38.0	57.1	76.1	61.0	90.0	90.0
72	36.5	54.7	72.9	58.5	87.8	90.0	
30	102	82.4	90.0	90.0	90.0	90.0	90.0
33		74.9	90.0	90.0	90.0	90.0	90.0
36		68.6	90.0	90.0	90.0	90.0	90.0
39		63.4	90.0	90.0	90.0	90.0	90.0
42		58.8	88.2	90.0	90.0	90.0	90.0
45		54.9	82.4	90.0	88.1	90.0	90.0
48		51.5	77.2	90.0	82.6	90.0	90.0
51		48.5	72.7	90.0	77.7	90.0	90.0
54		45.8	68.6	90.0	73.4	90.0	90.0
57		43.4	65.0	86.7	69.5	90.0	90.0
60		41.2	61.8	82.4	66.1	90.0	90.0
63		39.2	58.8	78.4	62.9	90.0	90.0
66		37.4	56.2	74.9	60.1	90.0	90.0
69		35.8	53.7	71.6	57.5	86.2	90.0

ANCHOR LOAD CAPACITY - PSF EXT. (+) & INT. (-)									
NOMINAL DIMS.		ANCHOR TYPE 'A'			ANCHOR TYPE 'B'				
TRIBUTARY WIDTH 'W' (in.)	FRAME HEIGHT 'H' (in.)	A2	A3	A4	B2	B3	B4		
30	108	77.8	90.0	90.0	90.0	90.0	90.0		
33		70.7	90.0	90.0	90.0	90.0	90.0		
36		64.8	90.0	90.0	90.0	90.0	90.0		
39		59.8	89.8	90.0	90.0	90.0	90.0		
42		55.6	83.3	90.0	89.1	90.0	90.0		
45		51.9	77.8	90.0	83.2	90.0	90.0		
48		48.6	72.9	90.0	78.0	90.0	90.0		
51		45.8	68.6	90.0	73.4	90.0	90.0		
54		43.2	64.8	86.4	69.3	90.0	90.0		
57		40.9	61.4	81.9	65.7	90.0	90.0		
60		38.9	58.3	77.8	62.4	90.0	90.0		
63		37.0	55.6	74.1	59.4	89.1	90.0		
66		35.4	53.0	70.7	56.7	85.1	90.0		
30		114	73.7	90.0	90.0	90.0	90.0	90.0	
33	67.0		90.0	90.0	90.0	90.0	90.0		
36	61.4		90.0	90.0	90.0	90.0	90.0		
39	56.7		85.0	90.0	90.0	90.0	90.0		
42	52.6		79.0	90.0	84.5	90.0	90.0		
45	49.1		73.7	90.0	78.8	90.0	90.0		
48	46.1		69.1	90.0	73.9	90.0	90.0		
51	43.4		65.0	86.7	69.5	90.0	90.0		
54	40.9		61.4	81.9	65.7	90.0	90.0		
57	38.8		58.2	77.6	62.2	90.0	90.0		
60	36.8		55.3	73.7	59.1	88.7	90.0		
63	35.1		52.6	70.2	56.3	84.5	90.0		
30	120		70.0	90.0	90.0	90.0	90.0	90.0	
33			63.6	90.0	90.0	90.0	90.0	90.0	
36		58.3	87.5	90.0	90.0	90.0	90.0		
39		53.9	80.8	90.0	86.4	90.0	90.0		
42		50.0	75.0	90.0	80.2	90.0	90.0		
45		46.7	70.0	90.0	74.9	90.0	90.0		
48		43.8	65.6	87.5	70.2	90.0	90.0		
51		41.2	61.8	82.4	66.1	90.0	90.0		
54		38.9	58.3	77.8	62.4	90.0	90.0		
57		36.8	55.3	73.7	59.1	88.7	90.0		
60		35.0	52.5	70.0	56.2	84.2	90.0		
30		126	66.7	90.0	90.0	90.0	90.0	90.0	
33			60.6	90.0	90.0	90.0	90.0	90.0	
36			55.6	83.3	90.0	89.1	90.0	90.0	
39	51.3		76.9	90.0	82.3	90.0	90.0		
41	48.8		73.2	90.0	78.3	90.0	90.0		
30	132		63.6	90.0	90.0	90.0	90.0	90.0	
33			57.9	86.8	90.0	90.0	90.0	90.0	
36			53.0	79.6	90.0	85.1	90.0	90.0	
39			49.0	73.4	90.0	78.5	90.0	90.0	
30			138	60.9	90.0	90.0	90.0	90.0	90.0
33				55.3	83.0	90.0	88.8	90.0	90.0
36				50.7	76.1	90.0	81.4	90.0	90.0
37				49.4	74.0	90.0	79.2	90.0	90.0
30				144	58.3	87.5	90.0	90.0	90.0
33		53.0			79.6	90.0	85.1	90.0	90.0
36		48.6			72.9	90.0	78.0	90.0	90.0

ANCHORS TYPES: SEE SHEET 16 FOR DESCRIPTION
 A2 = (2) ANCHORS TYPE 'A' AT JAMB OR EACH SIDE OF MULLION
 A3 = (3) ANCHORS TYPE 'A' AT JAMB OR EACH SIDE OF MULLION
 A4 = (4) ANCHORS TYPE 'A' AT JAMB OR EACH SIDE OF MULLION
 B2 = (2) ANCHORS TYPE 'B' AT JAMB OR EACH SIDE OF MULLION
 B3 = (3) ANCHORS TYPE 'B' AT JAMB OR EACH SIDE OF MULLION
 B4 = (4) ANCHORS TYPE 'B' AT JAMB OR EACH SIDE OF MULLION

ALL OTHER ANCHORS TO BE SPACED AS PER ELEVATION

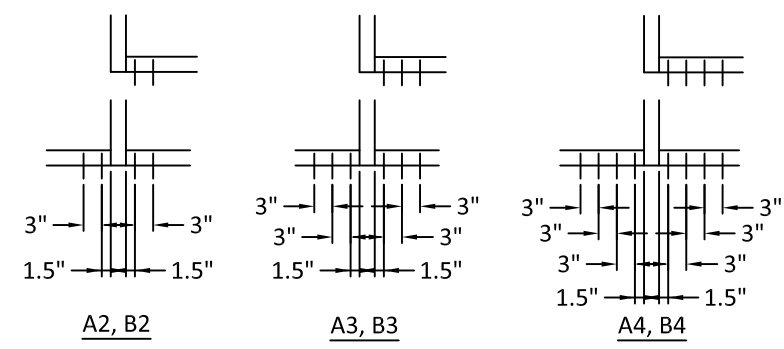

WIDTH (W) = W1 (JAMB)
 WIDTH (W) = $\frac{W2 + W3}{2}$ (MULLION)

REMARKS	BY	DATE

THE INSTALLATION DETAILS DESCRIBED HEREIN ARE GENERIC AND MAY NOT REFLECT ACTUAL CONDITIONS FOR A SPECIFIC SITE. IF SITE CONDITIONS CAUSE INSTALLATION TO DEVIATE FROM THE REQUIREMENTS DETAILED HEREIN, A LICENSED ENGINEER OR ARCHITECT SHALL PREPARE SITE SPECIFIC DOCUMENTS FOR USE WITH THIS DOCUMENT.

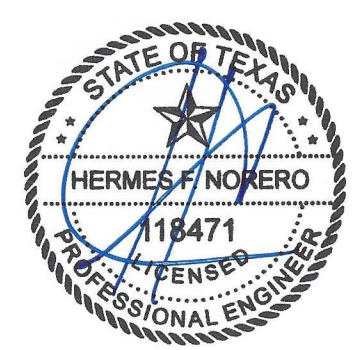

HERMES F. NORERO, P.E.
 TEXAS P.E. No. 118471
 BUILDING DROPS, INC.
 398 E. DANIA BEACH BLVD. # 338
 DANIA BEACH, FL 33004
 TBPE FIRM No. 13734

DATE: 09.20.21	
DWG. BY: MS	CHK. BY: HFN
SCALE: NTS	
DWG. #: YKK283	
SHEET:	

10/27/2021 5:46 PM
 s:\projects\ykk_ap_america, inc\tdi-21-0919 - tdi submittal - revision cwsf 51, cwsf 52, cwsf 53\dwg\ykk283_yhs 50 fi og_wz3.dwg

ANCHOR TYPE 'C, D & E' TABLES

ANCHORS TYPES: SEE SHEET 16 FOR DESCRIPTION

- C2 = (2) ANCHORS TYPE 'C' AT JAMB OR EACH SIDE OF MULLION
- C3 = (3) ANCHORS TYPE 'C' AT JAMB OR EACH SIDE OF MULLION
- C4 = (4) ANCHORS TYPE 'C' AT JAMB OR EACH SIDE OF MULLION
- C5 = (5) ANCHORS TYPE 'C' AT JAMB OR EACH SIDE OF MULLION

- D2 = (2) ANCHORS TYPE 'D' AT JAMB OR EACH SIDE OF MULLION
- D3 = (3) ANCHORS TYPE 'D' AT JAMB OR EACH SIDE OF MULLION
- D4 = (4) ANCHORS TYPE 'D' AT JAMB OR EACH SIDE OF MULLION
- D5 = (5) ANCHORS TYPE 'D' AT JAMB OR EACH SIDE OF MULLION

- E2 = (2) ANCHORS TYPE 'E' AT JAMB OR EACH SIDE OF MULLION
- E3 = (3) ANCHORS TYPE 'E' AT JAMB OR EACH SIDE OF MULLION
- E4 = (4) ANCHORS TYPE 'E' AT JAMB OR EACH SIDE OF MULLION
- E5 = (5) ANCHORS TYPE 'E' AT JAMB OR EACH SIDE OF MULLION

ALL OTHER ANCHORS TO BE SPACED AS PER ELEVATION

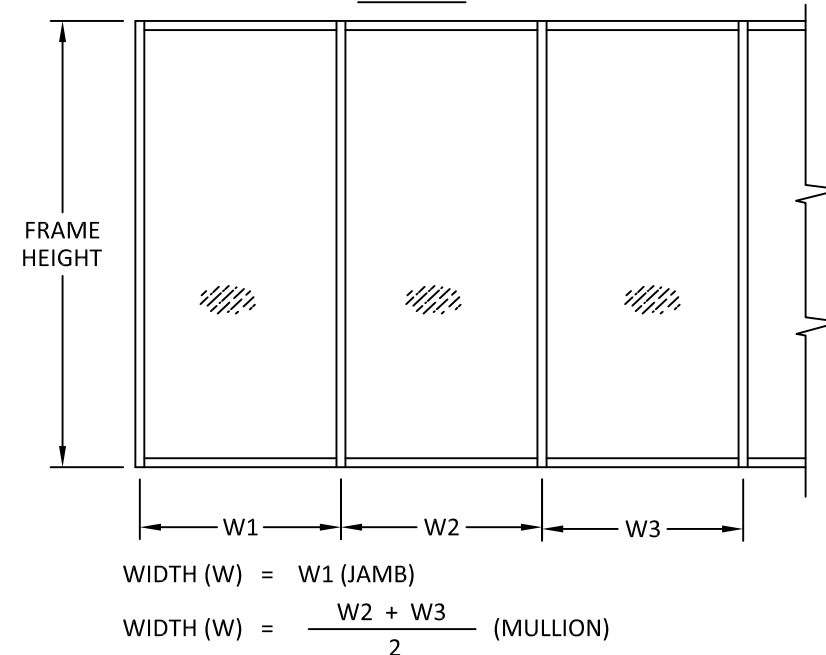
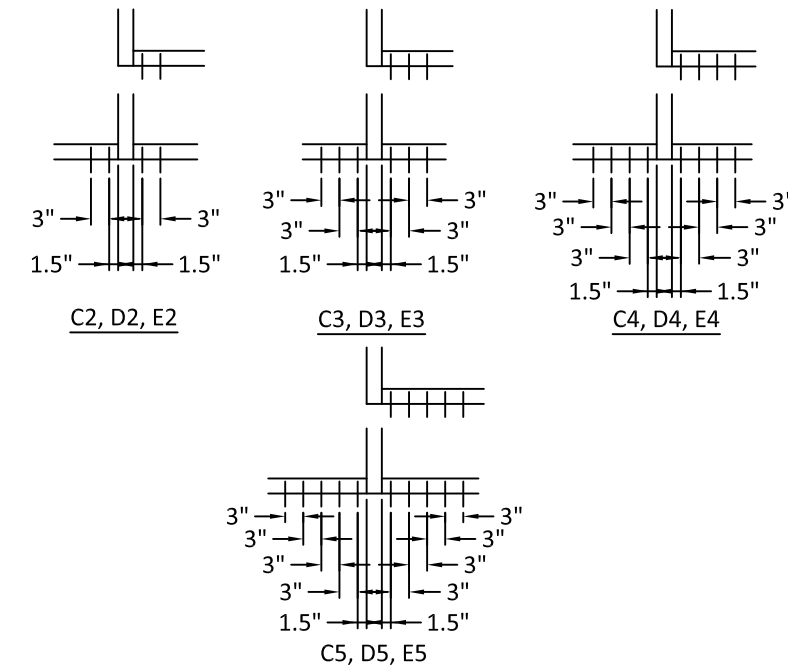

ANCHOR LOAD CAPACITY - PSF									
EXT. (+) & INT. (-)									
NOMINAL DIMS.		ANCHOR TYPE 'C'				ANCHOR TYPE 'D' & 'E'			
TRIBUTAR Y WIDTH 'W' (in.)	FRAME HEIGHT 'H' (in.)	C2	C3	C4	C5	D2/E2	D3/E3	D4/E4	D5/E5
30	72	90.0	90.0	90.0	90.0	90.0	90.0	90.0	90.0
33		90.0	90.0	90.0	90.0	90.0	90.0	90.0	90.0
36		90.0	90.0	90.0	90.0	90.0	90.0	90.0	90.0
39		86.5	90.0	90.0	90.0	90.0	90.0	90.0	90.0
42		80.4	90.0	90.0	90.0	90.0	90.0	90.0	90.0
45		75.0	90.0	90.0	90.0	90.0	90.0	90.0	90.0
48		70.3	90.0	90.0	90.0	90.0	90.0	90.0	90.0
51		66.2	90.0	90.0	90.0	88.1	90.0	90.0	90.0
54		62.5	90.0	90.0	90.0	83.2	90.0	90.0	90.0
57		59.2	88.8	90.0	90.0	78.8	90.0	90.0	90.0
60		56.2	84.4	90.0	90.0	74.9	90.0	90.0	90.0
63		53.6	80.4	90.0	90.0	71.3	90.0	90.0	90.0
66		51.1	76.7	90.0	90.0	68.1	90.0	90.0	90.0
69		48.9	73.4	90.0	90.0	65.1	90.0	90.0	90.0
72	46.9	70.3	90.0	90.0	62.4	90.0	90.0	90.0	
30	78	90.0	90.0	90.0	90.0	90.0	90.0	90.0	90.0
33		90.0	90.0	90.0	90.0	90.0	90.0	90.0	90.0
36		86.5	90.0	90.0	90.0	90.0	90.0	90.0	90.0
39		79.9	90.0	90.0	90.0	90.0	90.0	90.0	90.0
42		74.2	90.0	90.0	90.0	90.0	90.0	90.0	90.0
45		69.2	90.0	90.0	90.0	90.0	90.0	90.0	90.0
48		64.9	90.0	90.0	90.0	86.4	90.0	90.0	90.0
51		61.1	90.0	90.0	90.0	81.3	90.0	90.0	90.0
54		57.7	86.5	90.0	90.0	76.8	90.0	90.0	90.0
57		54.7	82.0	90.0	90.0	72.8	90.0	90.0	90.0
60		51.9	77.9	90.0	90.0	69.1	90.0	90.0	90.0
63		49.4	74.2	90.0	90.0	65.8	90.0	90.0	90.0
66		47.2	70.8	90.0	90.0	62.8	90.0	90.0	90.0
69		45.1	67.7	90.0	90.0	60.1	90.0	90.0	90.0
72	43.3	64.9	86.5	90.0	57.6	86.4	90.0	90.0	
30	84	90.0	90.0	90.0	90.0	90.0	90.0	90.0	90.0
33		87.7	90.0	90.0	90.0	90.0	90.0	90.0	90.0
36		80.4	90.0	90.0	90.0	90.0	90.0	90.0	90.0
39		74.2	90.0	90.0	90.0	90.0	90.0	90.0	90.0
42		68.9	90.0	90.0	90.0	90.0	90.0	90.0	90.0
45		64.3	90.0	90.0	90.0	85.6	90.0	90.0	90.0
48		60.3	90.0	90.0	90.0	80.2	90.0	90.0	90.0
51		56.7	85.1	90.0	90.0	75.5	90.0	90.0	90.0
54		53.6	80.4	90.0	90.0	71.3	90.0	90.0	90.0
57		50.8	76.1	90.0	90.0	67.6	90.0	90.0	90.0
60		48.2	72.3	90.0	90.0	64.2	90.0	90.0	90.0
63		45.9	68.9	90.0	90.0	61.1	90.0	90.0	90.0
66		43.8	65.7	87.7	90.0	58.3	87.5	90.0	90.0
69		41.9	62.9	83.8	90.0	55.8	83.7	90.0	90.0
72	40.2	60.3	80.4	90.0	53.5	80.2	90.0	90.0	

ANCHOR LOAD CAPACITY - PSF									
EXT. (+) & INT. (-)									
NOMINAL DIMS.		ANCHOR TYPE 'C'				ANCHOR TYPE 'D' & 'E'			
TRIBUTAR Y WIDTH 'W' (in.)	FRAME HEIGHT 'H' (in.)	C2	C3	C4	C5	D2/E2	D3/E3	D4/E4	D5/E5
30	90	90.0	90.0	90.0	90.0	90.0	90.0	90.0	90.0
33		81.8	90.0	90.0	90.0	90.0	90.0	90.0	90.0
36		75.0	90.0	90.0	90.0	90.0	90.0	90.0	90.0
39		69.2	90.0	90.0	90.0	90.0	90.0	90.0	90.0
42		64.3	90.0	90.0	90.0	85.6	90.0	90.0	90.0
45		60.0	90.0	90.0	90.0	79.9	90.0	90.0	90.0
48		56.2	84.4	90.0	90.0	74.9	90.0	90.0	90.0
51		52.9	79.4	90.0	90.0	70.5	90.0	90.0	90.0
54		50.0	75.0	90.0	90.0	66.6	90.0	90.0	90.0
57		47.4	71.1	90.0	90.0	63.1	90.0	90.0	90.0
60		45.0	67.5	90.0	90.0	59.9	89.9	90.0	90.0
63		42.9	64.3	85.7	90.0	57.1	85.6	90.0	90.0
66		40.9	61.4	81.8	90.0	54.5	81.7	90.0	90.0
69		39.1	58.7	78.3	90.0	52.1	78.1	90.0	90.0
72	37.5	56.2	75.0	90.0	49.9	74.9	90.0	90.0	
30	96	84.4	90.0	90.0	90.0	90.0	90.0	90.0	90.0
33		76.7	90.0	90.0	90.0	90.0	90.0	90.0	90.0
36		70.3	90.0	90.0	90.0	90.0	90.0	90.0	90.0
39		64.9	90.0	90.0	90.0	86.4	90.0	90.0	90.0
42		60.3	90.0	90.0	90.0	80.2	90.0	90.0	90.0
45		56.2	84.4	90.0	90.0	74.9	90.0	90.0	90.0
48		52.7	79.1	90.0	90.0	70.2	90.0	90.0	90.0
51		49.6	74.4	90.0	90.0	66.1	90.0	90.0	90.0
54		46.9	70.3	90.0	90.0	62.4	90.0	90.0	90.0
57		44.4	66.6	88.8	90.0	59.1	88.7	90.0	90.0
60		42.2	63.3	84.4	90.0	56.2	84.2	90.0	90.0
63		40.2	60.3	80.4	90.0	53.5	80.2	90.0	90.0
66		38.4	57.5	76.7	90.0	51.1	76.6	90.0	90.0
69		36.7	55.0	73.4	90.0	48.8	73.3	90.0	90.0
72	35.2	52.7	70.3	87.9	46.8	70.2	90.0	90.0	
30	102	79.4	90.0	90.0	90.0	90.0	90.0	90.0	90.0
33		72.2	90.0	90.0	90.0	90.0	90.0	90.0	90.0
36		66.2	90.0	90.0	90.0	88.1	90.0	90.0	90.0
39		61.1	90.0	90.0	90.0	81.3	90.0	90.0	90.0
42		56.7	85.1	90.0	90.0	75.5	90.0	90.0	90.0
45		52.9	79.4	90.0	90.0	70.5	90.0	90.0	90.0
48		49.6	74.4	90.0	90.0	66.1	90.0	90.0	90.0
51		46.7	70.1	90.0	90.0	62.2	90.0	90.0	90.0
54		44.1	66.2	88.2	90.0	58.7	88.1	90.0	90.0
57		41.8	62.7	83.6	90.0	55.6	83.5	90.0	90.0
60		39.7	59.6	79.4	90.0	52.9	79.3	90.0	90.0
63		37.8	56.7	75.6	90.0	50.3	75.5	90.0	90.0
66		36.1	54.1	72.2	90.0	48.1	72.1	90.0	90.0
69		34.5	51.8	69.1	86.3	46.0	68.9	90.0	90.0

ANCHOR LOAD CAPACITY - PSF										
EXT. (+) & INT. (-)										
NOMINAL DIMS.		ANCHOR TYPE 'C'				ANCHOR TYPE 'D' & 'E'				
TRIBUTAR Y WIDTH 'W' (in.)	FRAME HEIGHT 'H' (in.)	C2	C3	C4	C5	D2/E2	D3/E3	D4/E4	D5/E5	
30	108	75.0	90.0	90.0	90.0	90.0	90.0	90.0	90.0	
33		68.2	90.0	90.0	90.0	90.0	90.0	90.0	90.0	
36		62.5	90.0	90.0	90.0	83.2	90.0	90.0	90.0	
39		57.7	86.5	90.0	90.0	76.8	90.0	90.0	90.0	
42		53.6	80.4	90.0	90.0	71.3	90.0	90.0	90.0	
45		50.0	75.0	90.0	90.0	66.6	90.0	90.0	90.0	
48		46.9	70.3	90.0	90.0	62.4	90.0	90.0	90.0	
51		44.1	66.2	88.2	90.0	58.7	88.1	90.0	90.0	
54		41.7	62.5	83.3	90.0	55.5	83.2	90.0	90.0	
57		39.5	59.2	78.9	90.0	52.5	78.8	90.0	90.0	
60		37.5	56.2	75.0	90.0	49.9	74.9	90.0	90.0	
63		35.7	53.6	71.4	89.3	47.5	71.3	90.0	90.0	
66		34.1	51.1	68.2	85.2	45.4	68.1	90.0	90.0	
69		32.5	48.9	65.1	82.1	43.3	65.0	90.0	90.0	
30	114	71.1	90.0	90.0	90.0	90.0	90.0	90.0	90.0	
33		64.6	90.0	90.0	90.0	86.0	90.0	90.0	90.0	
36		59.2	88.8	90.0	90.0	78.8	90.0	90.0	90.0	
39		54.7	82.0	90.0	90.0	72.8	90.0	90.0	90.0	
42		50.8	76.1	90.0	90.0	67.6	90.0	90.0	90.0	
45		47.4	71.1	90.0	90.0	63.1	90.0	90.0	90.0	
48		44.4	66.6	88.8	90.0	59.1	88.7	90.0	90.0	
51		41.8	62.7	83.6	90.0	55.6	83.5	90.0	90.0	
54		39.5	59.2	78.9	90.0	52.5	78.8	90.0	90.0	
57		37.4	56.1	74.8	90.0	49.8	74.7	90.0	90.0	
60		35.5	53.3	71.1	88.8	47.3	70.9	90.0	90.0	
63		33.8	50.8	67.7	84.6	45.0	67.6	90.0	90.0	
30		120	67.5	90.0	90.0	90.0	89.9	90.0	90.0	90.0
33			61.4	90.0	90.0	90.0	81.7	90.0	90.0	90.0
36	56.2		84.4	90.0	90.0	74.9	90.0	90.0	90.0	
39	51.9		77.9	90.0	90.0	69.1	90.0	90.0	90.0	
42	48.2		72.3	90.0	90.0	64.2	90.0	90.0	90.0	
45	45.0		67.5	90.0	90.0	59.9	89.9	90.0	90.0	
48	42.2		63.3	84.4	90.0	56.2	84.2	90.0	90.0	
51	39.7		59.6	79.4	90.0	52.9	79.3	90.0	90.0	
54	37.5		56.2	75.0	90.0	49.9	74.9	90.0	90.0	
57	35.5		53.3	71.1	88.8	47.3	70.9	90.0	90.0	
60	33.7		50.6	67.5	84					

TITLE: YHS 50 FI ALUMINUM STOREFRONT SYSTEM - OUTSIDE GLAZED (IMPACT)
 DOOR MULLION TABLE (1)

PREPARED BY: **BUILDING DROPS, INC.**
 398 E. DANIA BEACH BLVD., STE. 338
 DANIA BEACH, FL 33004
 PH: (954)399-8478
 FAX: (954)744-4738
 WEB: www.buildingdrops.com

REMARKS	BY	DATE

THE INSTALLATION DETAILS DESCRIBED HEREIN ARE GENERIC AND MAY NOT REFLECT ACTUAL CONDITIONS FOR A SPECIFIC SITE. IF SITE CONDITIONS CAUSE INSTALLATION TO DEVIATE FROM THE REQUIREMENTS DETAILED HEREIN, A LICENSED ENGINEER OR ARCHITECT SHALL PREPARE SITE SPECIFIC DOCUMENTS FOR USE WITH THIS DOCUMENT.

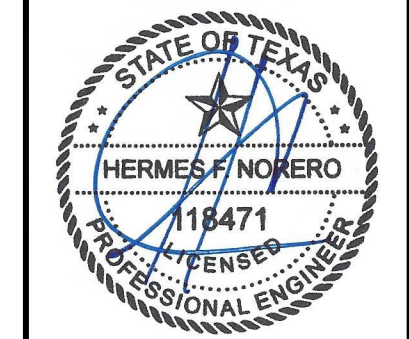

HERMES F. NORERO, P.E.
 TEXAS P.E. No. 118471
 BUILDING DROPS, INC.
 398 E. DANIA BEACH BLVD. # 338
 DANIA BEACH, FL 33004
 TBPE FIRM No. 13734

DATE:	09.20.21	
DWG. BY:	MS	CHK. BY: HFN
SCALE:	NTS	
DWG. #:	YKK283	
SHEET:	14	

DOOR MULLION LOAD & ANCHOR TABLES

DOOR MULLION LOAD CAPACITY					
NOMINAL DIMS.		WITHOUT STEEL REINF.		WITH STEEL REINF.	
WIDTH (W)	FRAME HEIGHT (H)	EXT. (+)	INT. (-)	EXT. (+)	INT. (-)
24	102	70.0	70.0	70.0	90.0
30		70.0	70.0	70.0	90.0
36		70.0	70.0	70.0	90.0
42		70.0	70.0	70.0	90.0
48		70.0	70.0	70.0	90.0
54		70.0	70.0	70.0	90.0
60	70.0	70.0	70.0	70.0	90.0
24	108	70.0	70.0	70.0	90.0
30		70.0	70.0	70.0	90.0
36		70.0	70.0	70.0	90.0
42		70.0	70.0	70.0	90.0
48		70.0	70.0	70.0	90.0
54		70.0	70.0	70.0	90.0
60	70.0	70.0	70.0	70.0	90.0
24	114	70.0	70.0	70.0	90.0
30		70.0	70.0	70.0	90.0
36		70.0	70.0	70.0	90.0
42		70.0	70.0	70.0	90.0
48		70.0	70.0	70.0	90.0
54		70.0	70.0	70.0	90.0
60	70.0	70.0	70.0	70.0	90.0
24	120	70.0	70.0	70.0	90.0
30		70.0	70.0	70.0	90.0
36		70.0	70.0	70.0	90.0
42		70.0	70.0	70.0	90.0
48		70.0	70.0	70.0	90.0
54		69.2	69.2	70.0	90.0
60	62.3	62.3	70.0	90.0	
24	126	70.0	70.0	70.0	90.0
30		70.0	70.0	70.0	90.0
36		70.0	70.0	70.0	90.0
42		70.0	70.0	70.0	90.0
48		67.3	67.3	70.0	90.0
54		59.8	59.8	70.0	90.0
60	57.1	55.0	70.0	90.0	
24	132	70.0	70.0	70.0	90.0
30		70.0	70.0	70.0	90.0
36		70.0	70.0	70.0	90.0
42		66.9	66.9	70.0	90.0
48		58.5	58.5	70.0	90.0
54		57.1	55.0	70.0	90.0
60	52.4	50.4	64.2	82.6	
24	138	70.0	70.0	70.0	90.0
30		70.0	70.0	70.0	90.0
36		68.3	68.3	70.0	90.0
42		58.5	58.5	70.0	90.0
48		57.1	55.0	70.0	90.0
54		50.9	49.1	62.4	80.3
60	45.8	44.1	56.2	72.2	
24	144	70.0	70.0	70.0	90.0
30		70.0	70.0	70.0	90.0
36		60.1	60.1	70.0	90.0
42		57.1	55.0	70.0	90.0
48		50.4	48.6	61.8	79.5
54		44.8	43.2	55.0	70.7
60	40.3	38.9	49.5	63.6	

ANCHOR TYPE	TOTAL NO. OF ANCHORS REQUIRED AT DOOR MULLION HEAD AND SILL BY DESIGN PRESSURE						
	90 PSF	80 PSF	70 PSF	60 PSF	50 PSF	40 PSF	30 PSF
A	13	11	10	9	7	6	5
B	8	7	6	6	5	4	3
C	13	12	10	9	8	6	5
D OR E	10	9	8	7	6	5	4

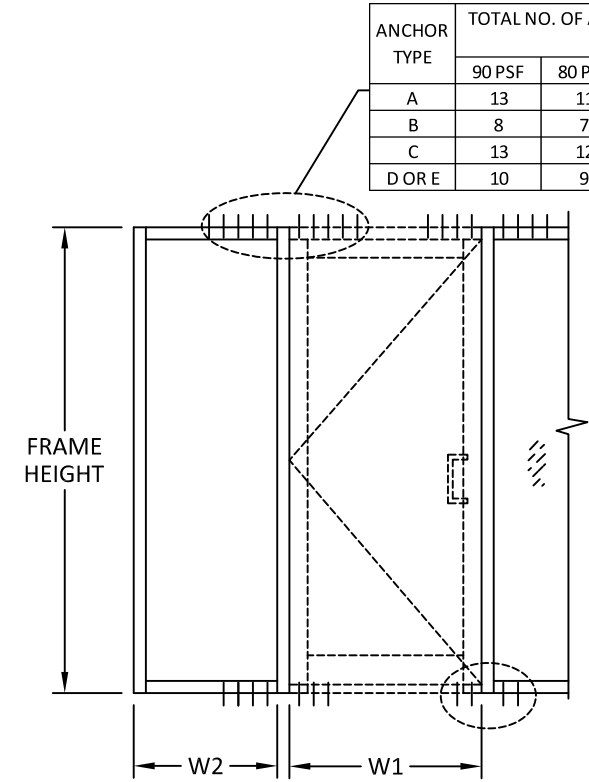

SINGLE DOOR

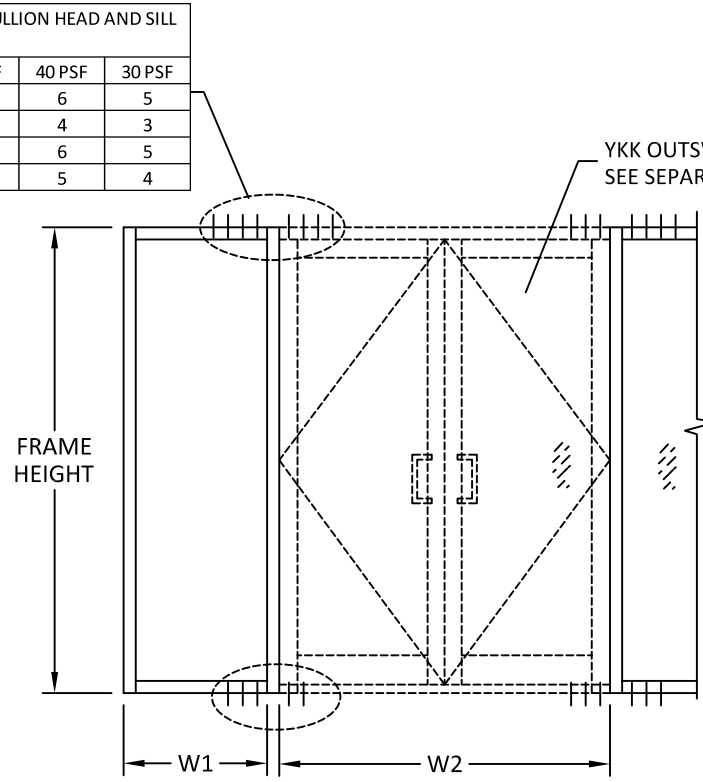

DOUBLE DOOR

ANCHOR TYPE	TOTAL NO. OF ANCHORS REQUIRED AT DOOR MULLION HEAD AND SILL BY DESIGN PRESSURE						
	90 PSF	80 PSF	70 PSF	60 PSF	50 PSF	40 PSF	30 PSF
A	13	11	10	9	7	6	5
B	8	7	6	6	5	4	3
C	13	12	10	9	8	6	5
D OR E	10	9	8	7	6	5	4

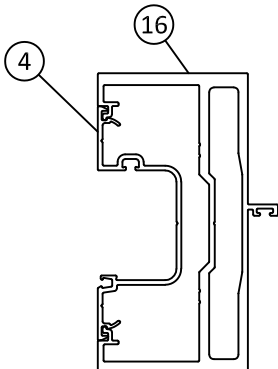

DOOR MULLION WITHOUT STEEL REINFORCEMENT

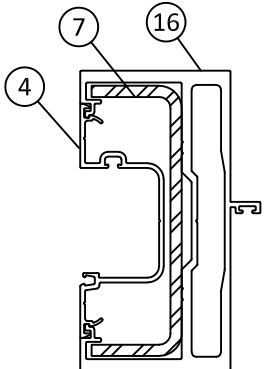

DOOR MULLION WITH STEEL REINFORCEMENT

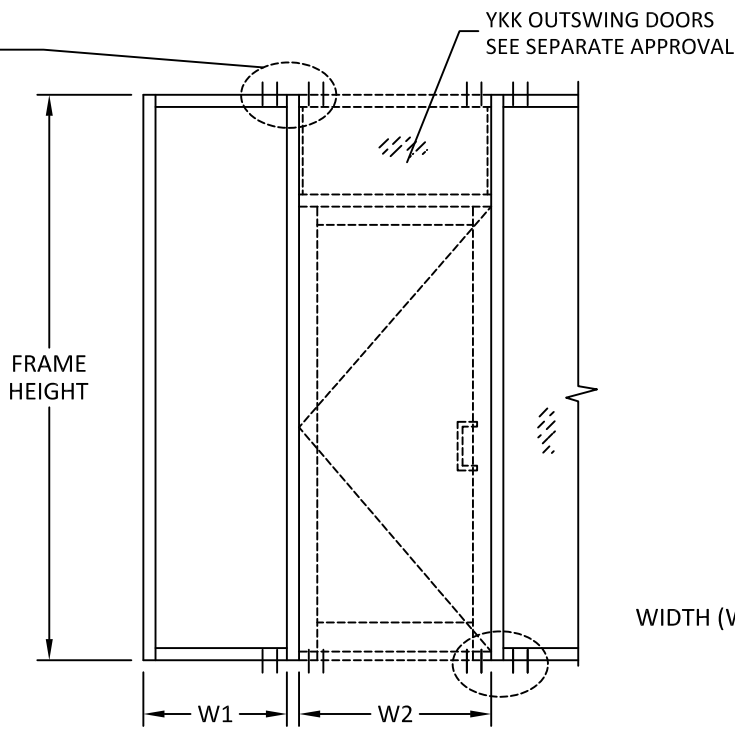

SINGLE DOOR WITH TRANSOM

YKK OUTSWING DOORS
 SEE SEPARATE APPROVAL

YKK OUTSWING DOORS
 SEE SEPARATE APPROVAL

10/27/2021 5:46 PM s:\projects\ykk_apa_america, inc.\tdi-21-0919 - tdi_submittal - revision cwsf 51, cwsf 52, cwsf 53\dwg\ykk283_yhs 50 fi og_w23.dwg

DOOR MULLION LOAD & ANCHOR TABLES



YKK AP AMERICA, INC.
 1229 HWY 441 BYPASS
 DUBLIN, GEORGIA 31021
 PH: (478)277-1955 FAX: (678)838-6001

DOOR MULLION LOAD CAPACITY						
NOMINAL DIMS.			WITHOUT STEEL REINF.		WITH STEEL REINF.	
FRAME HEIGHT (IN.)	DOOR PANEL WIDTH - W1 (IN.)	SIDELITE WIDTH - W2 (IN.)	EXT. (+)	INT. (-)	EXT. (+)	INT. (-)
96	36	30	70.0	70.0	70.0	90.0
		36	70.0	70.0	70.0	90.0
		42	70.0	70.0	70.0	90.0
		48	70.0	70.0	70.0	90.0
	42	30	70.0	70.0	70.0	90.0
		36	70.0	70.0	70.0	90.0
		42	70.0	70.0	70.0	90.0
		48	70.0	70.0	70.0	90.0
	48	30	70.0	70.0	70.0	90.0
		36	70.0	70.0	70.0	90.0
		42	70.0	70.0	70.0	90.0
		48	70.0	70.0	70.0	90.0
102	36	30	70.0	70.0	70.0	90.0
		36	70.0	70.0	70.0	90.0
		42	70.0	70.0	70.0	90.0
		48	70.0	70.0	70.0	90.0
	42	30	70.0	70.0	70.0	90.0
		36	70.0	70.0	70.0	90.0
		42	70.0	70.0	70.0	90.0
		48	70.0	70.0	70.0	90.0
	48	30	70.0	70.0	70.0	90.0
		36	70.0	70.0	70.0	90.0
		42	70.0	70.0	70.0	90.0
		48	70.0	70.0	70.0	90.0
108	36	30	70.0	70.0	70.0	90.0
		36	70.0	70.0	70.0	90.0
		42	70.0	70.0	70.0	90.0
		48	70.0	70.0	70.0	90.0
	42	30	70.0	70.0	70.0	90.0
		36	70.0	70.0	70.0	90.0
		42	70.0	70.0	70.0	90.0
		48	70.0	70.0	70.0	90.0
	48	30	70.0	70.0	70.0	90.0
		36	70.0	70.0	70.0	90.0
		42	70.0	70.0	70.0	90.0
		48	57.1	55.0	70.0	90.0
114	36	30	70.0	70.0	70.0	90.0
		36	70.0	70.0	70.0	90.0
		42	70.0	70.0	70.0	90.0
		48	69.8	69.8	70.0	90.0
	42	30	70.0	70.0	70.0	90.0
		36	69.8	69.8	70.0	90.0
		42	66.6	66.6	70.0	90.0
		48	63.6	63.6	70.0	90.0
	48	30	66.6	66.6	70.0	90.0
		36	63.6	63.6	70.0	90.0
		42	57.1	55.0	70.0	90.0
		48	57.1	55.0	70.0	90.0

DOOR MULLION LOAD CAPACITY						
NOMINAL DIMS.			WITHOUT STEEL REINF.		WITH STEEL REINF.	
FRAME HEIGHT (IN.)	DOOR PANEL WIDTH - W1 (IN.)	SIDELITE WIDTH - W2 (IN.)	EXT. (+)	INT. (-)	EXT. (+)	INT. (-)
120	36	30	69.9	69.9	70.0	90.0
		36	66.2	66.2	70.0	90.0
		42	62.8	62.8	70.0	90.0
		48	59.8	59.8	70.0	90.0
	42	30	62.8	62.8	70.0	90.0
		36	59.8	59.8	70.0	90.0
		42	57.1	57.1	70.0	90.0
		48	57.1	55.0	70.0	90.0
	48	30	57.1	57.1	70.0	90.0
		36	57.1	55.0	70.0	90.0
		42	57.1	55.0	70.0	90.0
		44	57.1	55.0	70.0	90.0
126	36	30	60.4	60.4	70.0	90.0
		36	57.2	57.2	70.0	90.0
		42	57.1	55.0	70.0	90.0
		48	57.1	55.0	70.0	90.0
	42	30	57.1	55.0	70.0	90.0
		36	57.1	55.0	70.0	90.0
		42	55.2	53.1	67.6	86.9
		48	52.7	50.8	64.7	83.1
	48	30	55.2	53.1	67.6	86.9
		36	52.7	50.8	64.7	83.1
		38	52.0	50.1	63.7	81.9
		30	57.1	55.0	70.0	90.0
132	36	36	55.6	53.6	68.2	87.7
		42	52.8	50.9	64.7	83.2
		48	50.3	48.4	61.6	79.2
		30	52.8	50.9	64.7	83.2
	42	36	50.3	48.4	61.6	79.2
		42	48.0	46.2	58.8	75.6
		44	47.3	45.5	57.9	74.5
		30	48.0	46.2	58.8	75.6
	48	32	47.3	45.5	57.9	74.5
		30	51.4	49.5	63.0	81.0
		36	48.7	46.9	59.7	76.7
		42	46.2	44.5	56.7	72.9
138	36	48	44.0	42.4	53.9	69.4
		30	46.2	44.5	56.7	72.9
		36	44.0	42.4	53.9	69.4
		38	43.3	41.7	53.1	68.3
	42	30	43.3	41.7	53.1	68.3
		30	45.2	43.6	55.5	71.3
		36	42.8	41.3	52.5	67.5
		42	40.7	39.2	49.9	64.1
	48	44	40.0	38.5	49.0	63.1
		30	40.7	39.2	49.9	64.1
		32	40.0	38.5	49.0	63.1
		48	20	40.0	38.5	49.0

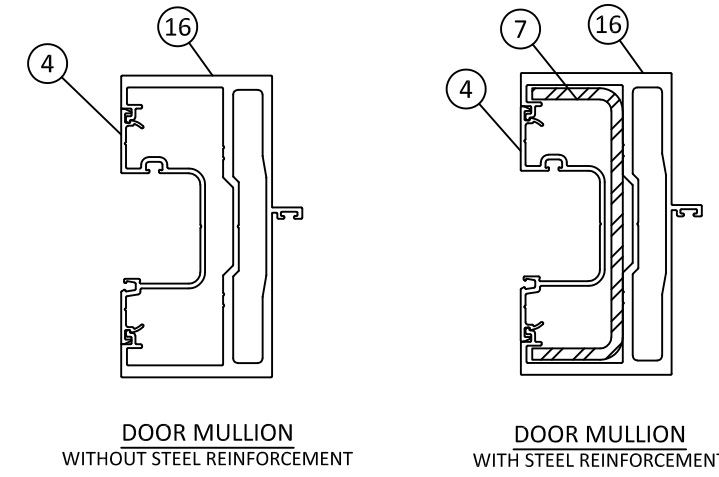

ANCHOR TYPE	TOTAL NO. OF ANCHORS REQUIRED AT DOOR MULLION HEAD AND SILL						
	BY DESIGN PRESSURE						
	90 PSF	80 PSF	70 PSF	60 PSF	50 PSF	40 PSF	30 PSF
A	13	11	10	9	7	6	5
B	8	7	6	6	5	4	3
C	13	12	10	9	8	6	5
D O R E	10	9	8	7	6	5	4

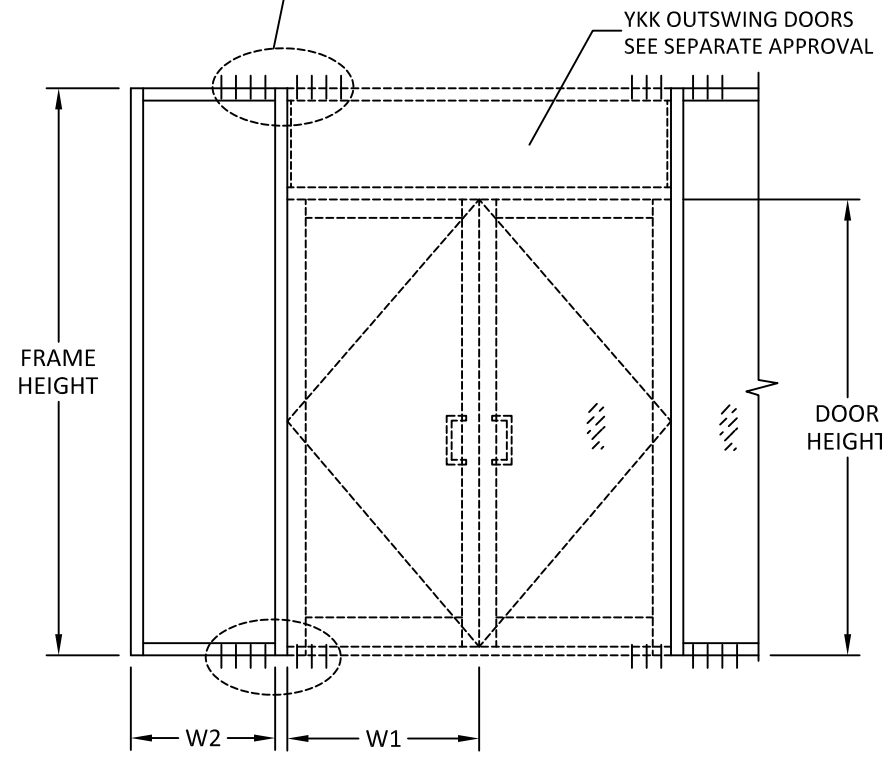

DOUBLE DOOR WITH TRANSOM

TITLE: YHS 50 FI ALUMINUM STOREFRONT SYSTEM - OUTSIDE GLAZED (IMPACT)
DOOR MULLION TABLE (2)

PREPARED BY: BUILDING DROPS, INC.
 398 E. DANIA BEACH BLVD., STE. 338
 DANIA BEACH, FL 33004
 PH: (954)399-8478
 FAX: (954)744-4738
 WEB: www.buildingdrops.com

REMARKS	BY	DATE

THE INSTALLATION DETAILS DESCRIBED HEREIN ARE GENERIC AND MAY NOT REFLECT ACTUAL CONDITIONS FOR A SPECIFIC SITE. IF SITE CONDITIONS CAUSE INSTALLATION TO DEVIATE FROM THE REQUIREMENTS DETAILED HEREIN, A LICENSED ENGINEER OR ARCHITECT SHALL PREPARE SITE SPECIFIC DOCUMENTS FOR USE WITH THIS DOCUMENT.



HERMES F. NORERO, P.E.
 TEXAS P.E. No. 118471
 BUILDING DROPS, INC
 398 E. DANIA BEACH BLVD. # 338
 DANIA BEACH, FL 33004
 TBPE FIRM No. 13734

DATE:	09.20.21	
DWG. BY:	MS	CHK. BY: HFN
SCALE:	NTS	
DWG. #:	YKK283	
SHEET:	15	

10/27/2021 5:47 PM
 s:\projects\ykk_apa_america, inc.\tdi-21-0919 - tdi submittal - revision cwsf 51, cwsf 52, cwsf 53\dwgs\ykk283_yhs 50 fr og_w23.dwg

TITLE: YHS 50 FI ALUMINUM STOREFRONT SYSTEM - OUTSIDE GLAZED (IMPACT)
 VERTICAL SECTIONS & ANCHOR DESCRIPTIONS
 PREPARED BY: **BUILDING DROPS, INC.**
 398 E. DANIA BEACH BLVD., STE. 338
 DANIA BEACH, FL 33004
 PH: (954)399-8478
 FAX: (954)744-4738
 WEB: www.buildingdrops.com

REMARKS	BY	DATE

THE INSTALLATION DETAILS DESCRIBED HEREIN ARE GENERIC AND MAY NOT REFLECT ACTUAL CONDITIONS FOR A SPECIFIC SITE. IF SITE CONDITIONS CAUSE INSTALLATION TO DEVIATE FROM THE REQUIREMENTS DETAILED HEREIN, A LICENSED ENGINEER OR ARCHITECT SHALL PREPARE SITE SPECIFIC DOCUMENTS FOR USE WITH THIS DOCUMENT.

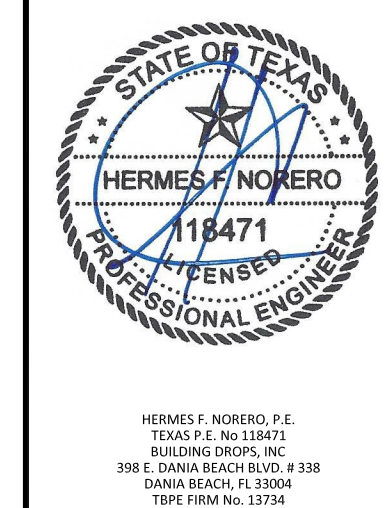

HERMES F. NORERO, P.E.
 TEXAS P.E. No. 118471
 BUILDING DROPS, INC.
 398 E. DANIA BEACH BLVD. # 338
 DANIA BEACH, FL 33004
 TBPE FIRM No. 13734

DATE: **09.20.21**
 DWG. BY: **MS** CHK. BY: **HFN**
 SCALE: **NTS**
 DWG. #: **YKK283**
 SHEET: **16**
 [PAGE 17 OF 23]

s:\projects\ykk_ap_america, inc.\tdi-submittal - revision cwsf 51, cwsf 52, cwsf 53\dwg\ykc283_yhs 50 fi og_wz3.dwg 10/27/2021 5:47 PM

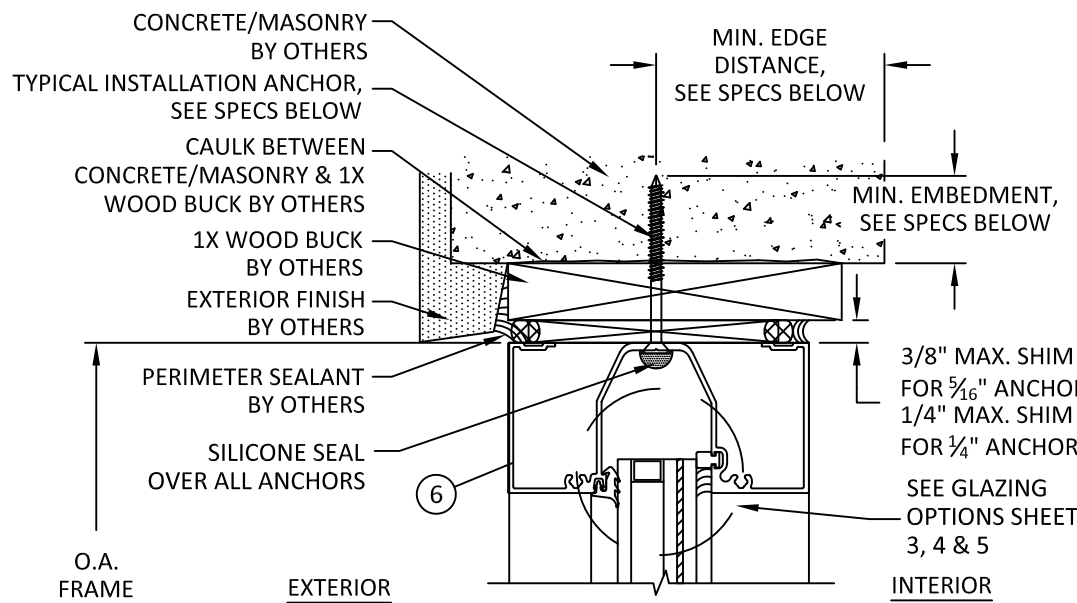

A
16 VERTICAL SECTION
 HEAD - CONCRETE/MASONRY W/ 1X BUCK LIGHT CONFIGURATION

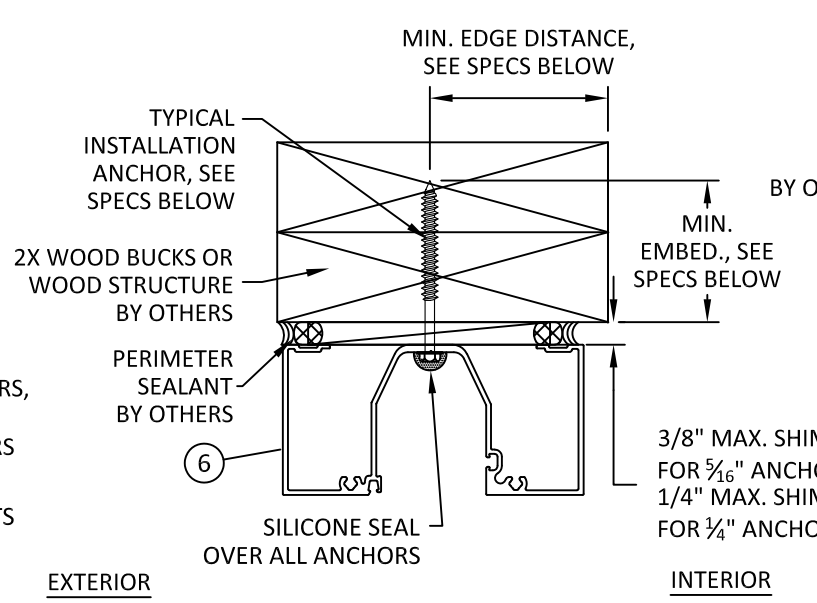

D
16 VERTICAL SECTION
 HEAD - WOOD FRAMING TYPICAL INSTALLATION

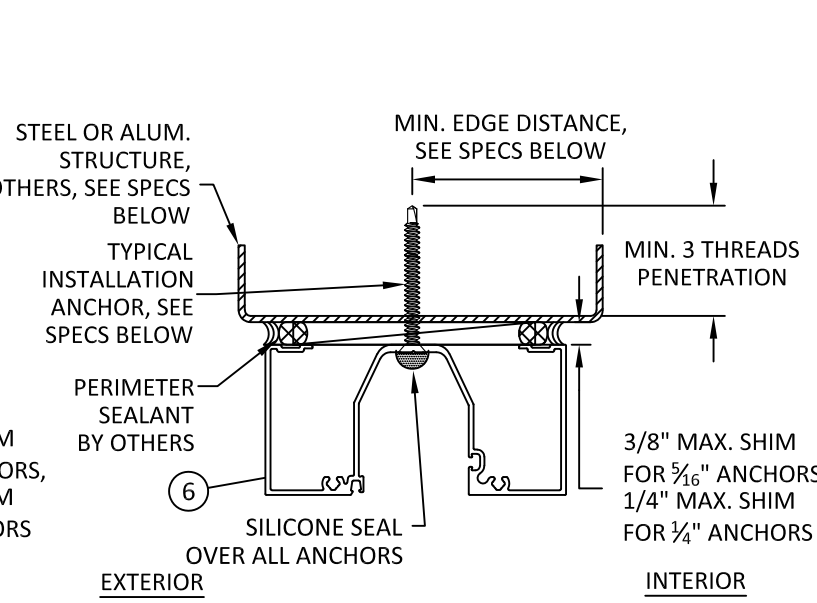

E
16 VERTICAL SECTION
 HEAD - METAL SUBSTRATE TYPICAL INSTALLATION

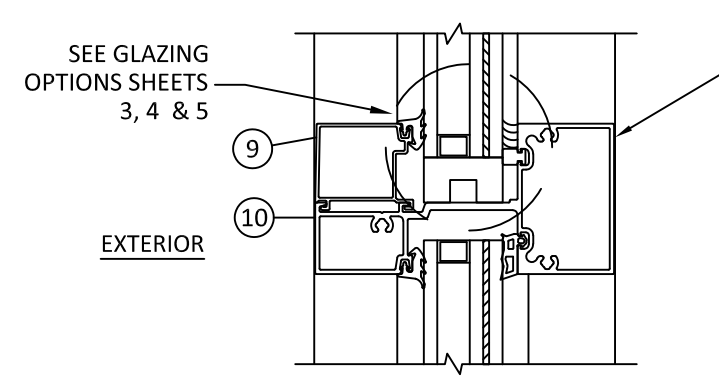

B
16 VERTICAL SECTION
 HORIZONTAL MEMBER

LIMIT DESIGN LOADS FOR HORIZONTAL AS FOLLOWS		
MAX HORIZ. SPAN	MAX GLASS HEIGHT ABOVE HORIZ.	MAX DESIGN LOADS
60"	57'-1/2"	70 PSF
60"	84"	52 PSF
66"	55'-15/16"	44 PSF
66"	84"	32 PSF
72"	55'-15/16"	30 PSF
72"	84"	20 PSF

DESIGN LOADS SHOWN ABOVE ARE BASED ON MAX. GLASS AREA ABOVE HORIZONTAL, FOR SIZES SMALLER THAN SHOWN ABOVE, ALLOWABLE DESIGN LOADS MAY BE CALCULATED SEPARATELY.

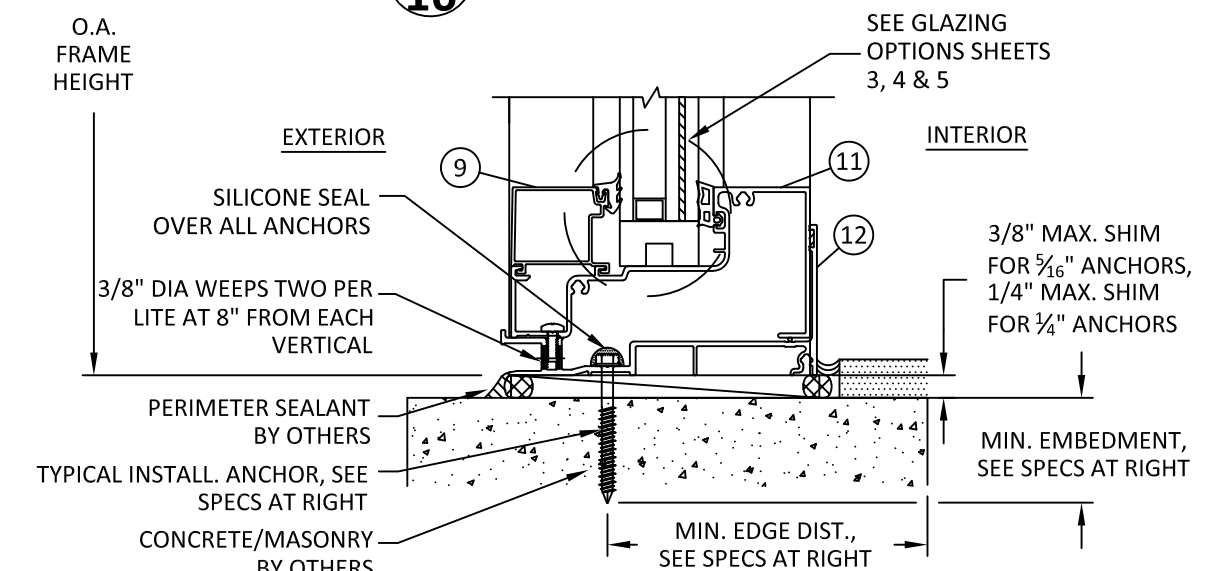

C
16 VERTICAL SECTION
 SILL - DIRECT TO CONCRETE/MASONRY LIGHT CONFIGURATION

YHS 50 FI ANCHOR TYPES					
ANCHOR TYPE	ANCHOR DESCRIPTION	SUBSTRATE REQUIREMENTS	MIN. EMBEDMENT	MIN. EDGE DISTANCE	NOTES
A	5/16" DIA. TAPCON BY ITW (Fu=125 KSI, Fy=100 KSI)	CONCRETE AT HEAD, SILL OR JAMBS F'C = 3000 PSI MIN.	1-3/4"	3"	FOR USE THROUGH OPTIONAL 1X BUCKS, BY OTHERS
	5/16" DIA. ULTRACON BY ELCO (Fu=177 KSI, Fy=155 KSI)	C-90 HOLLOW/FILLED BLOCK AT JAMBS F'M = 2000 PSI MIN.	1"	3"	
	5/16" DIA. ULTRACON BY ELCO (Fu=177 KSI, Fy=155 KSI)	MIN. S.G. = 0.55 WOOD	1-1/2"	1"	--
B	5/16" DIA. SELF-DRILLING SCREWS (GRADE 5)	STEEL: 12 GA. MIN., Fy=36 KSI MIN. ALUM.: 1/8" MIN., 6063-T5 MIN.	THREE THREADS PENETRATION PAST METAL STRUCTURE	3/4"	STEEL IN CONTACT WITH ALUM. TO BE PLATED OR PAINTED
C	1/4" DIA. TAPCON BY ITW (Fu=125 KSI, Fy=100 KSI)	CONCRETE AT HEAD, SILL OR JAMBS F'C = 3000 PSI MIN.	1-3/4"	2-1/2"	FOR USE THROUGH OPTIONAL 1X BUCKS, BY OTHERS
	1/4" DIA. ULTRACON BY ELCO (Fu=177 KSI, Fy=155 KSI)	C-90 HOLLOW/FILLED BLOCK AT JAMBS F'M = 2000 PSI MIN.	1-3/4"	2-1/2"	
	1/4" DIA. ULTRACON BY ELCO (Fu=177 KSI, Fy=155 KSI)	MIN. S.G. = 0.55 WOOD	1-1/2"	1"	--
D	1/4" DIA. SELF-DRILLING SCREWS	STEEL: 12 GA. MIN., Fy=36 KSI MIN. ALUM.: 1/8" MIN., 6063-T5 MIN.	3 THREADS PENETRATION PAST METAL STRUCTURE	3/4"	STEEL IN CONTACT WITH ALUM. TO BE PLATED OR PAINTED
E	1/4" DIA. SELF-DRILLING SCREWS	18 GA. MIN. STEEL STUD, Fy = 33 KSI MIN. WITH WOOD BACKING	1-1/2" IN WOOD	1" IN WOOD	--

TITLE: YHS 50 FI ALUMINUM STOREFRONT SYSTEM - OUTSIDE GLAZED (IMPACT)
 VERTICAL SECTIONS

PREPARED BY: **BUILDING DROPS, INC.**
 398 E. DANIA BEACH BLVD., STE. 338
 DANIA BEACH, FL 33004
 PH: (954)399-8478
 FAX: (954)744-4738
 WEB: www.buildingdrops.com



REMARKS	BY	DATE

THE INSTALLATION DETAILS DESCRIBED HEREIN ARE GENERIC AND MAY NOT REFLECT ACTUAL CONDITIONS FOR A SPECIFIC SITE. IF SITE CONDITIONS CAUSE INSTALLATION TO DEVIATE FROM THE REQUIREMENTS DETAILED HEREIN, A LICENSED ENGINEER OR ARCHITECT SHALL PREPARE SITE SPECIFIC DOCUMENTS FOR USE WITH THIS DOCUMENT.

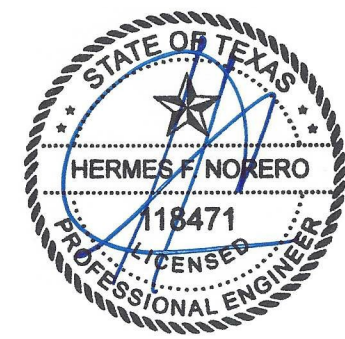

HERMES F. NORERO, P.E.
 TEXAS P.E. No. 118471
 BUILDING DROPS, INC.
 398 E. DANIA BEACH BLVD. # 338
 DANIA BEACH, FL 33004
 TBPE FIRM No. 13734

DATE:	09.20.21	
DWG. BY:	MS	CHK. BY: HFN
SCALE:	NTS	
DWG. #:	YKK283	
SHEET:	17	

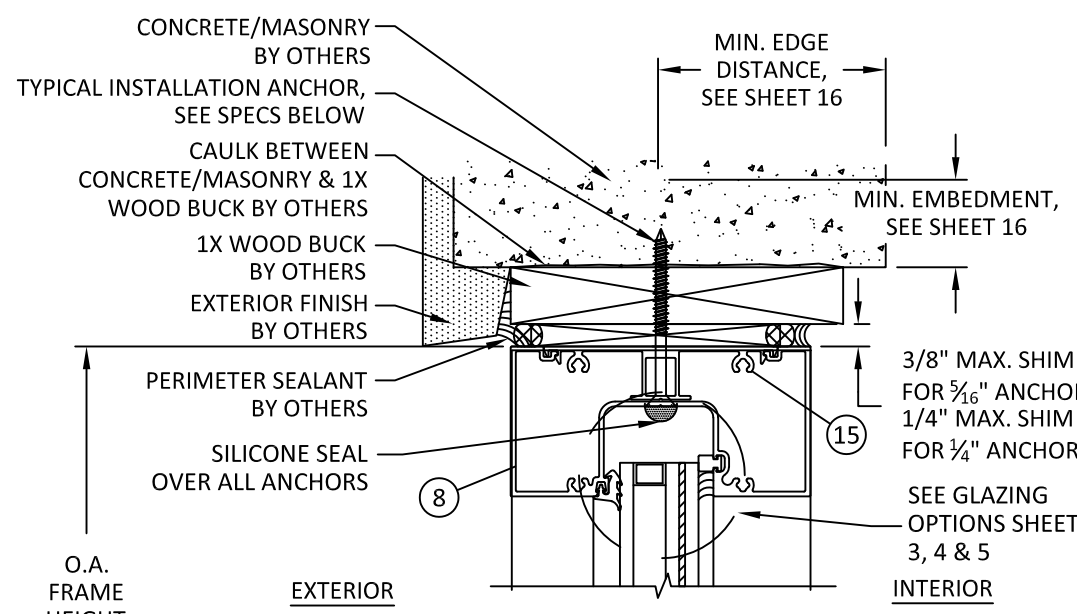

F
17 VERTICAL SECTION
 HEAD - CONCRETE/MASONRY W/ 1X BUCK MEDIUM / HEAVY CONFIGURATION

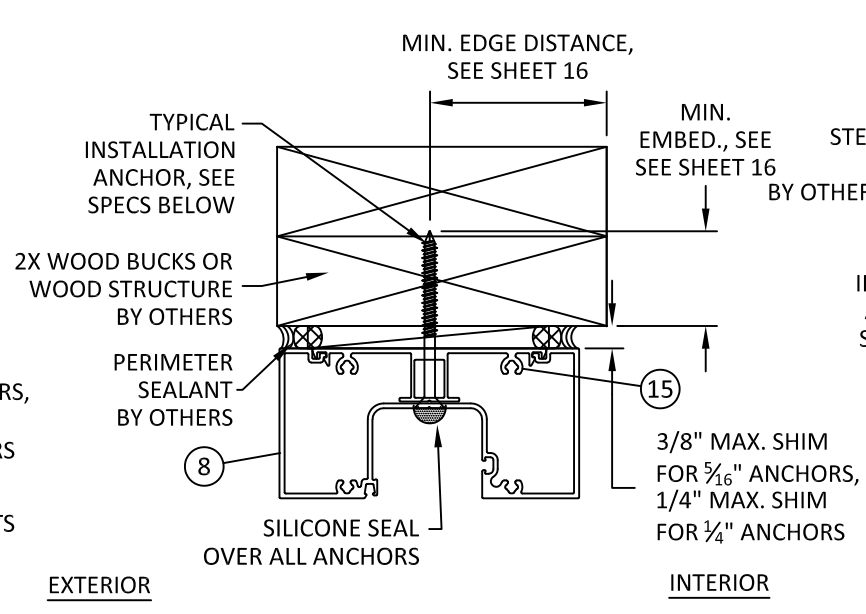

I
17 VERTICAL SECTION
 HEAD - WOOD FRAMING TYPICAL INSTALLATION

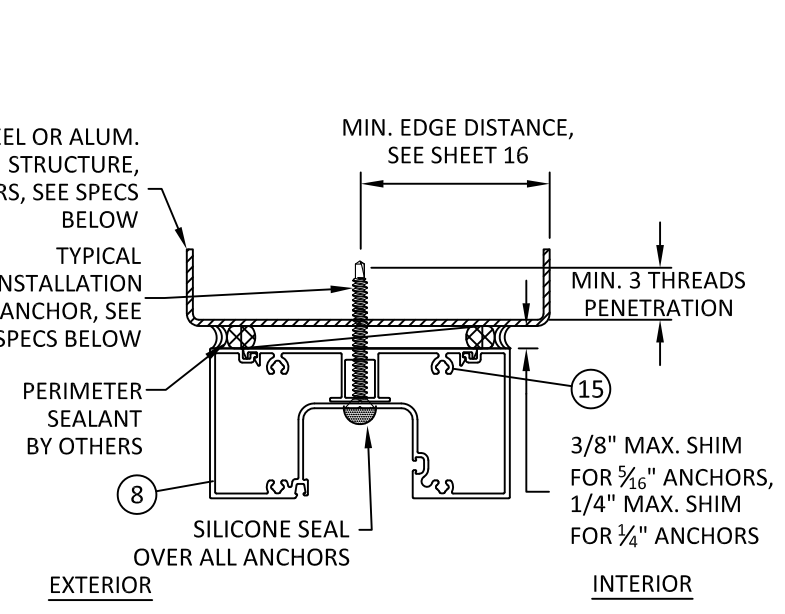

J
17 VERTICAL SECTION
 HEAD - METAL SUBSTRATE TYPICAL INSTALLATION

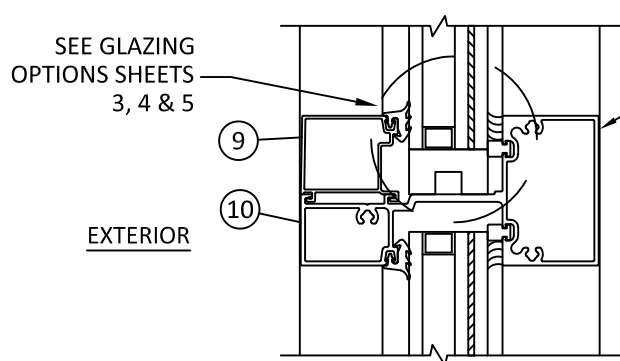

G
17 VERTICAL SECTION
 HORIZONTAL MEMBER

LIMIT DESIGN LOADS FOR HORIZONTAL AS FOLLOWS

MAX HORIZ. SPAN	MAX GLASS HEIGHT ABOVE HORIZ.	MAX DESIGN LOADS
60"	57-1/2"	70 PSF
60"	84"	52 PSF
66"	55-15/16"	44 PSF
66"	84"	32 PSF
72"	55-15/16"	30 PSF
72"	84"	20 PSF

DESIGN LOADS SHOWN ABOVE ARE BASED ON MAX. GLASS AREA ABOVE HORIZONTAL, FOR SIZES SMALLER THAN SHOWN ABOVE, ALLOWABLE DESIGN LOADS MAY BE CALCULATED SEPARATELY.

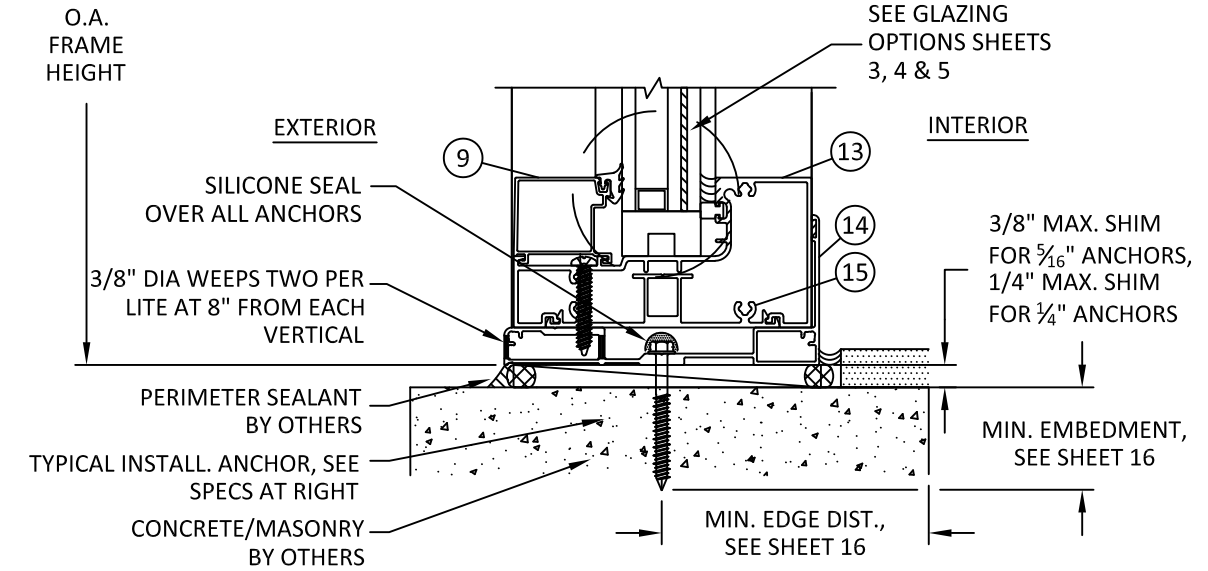

H
17 VERTICAL SECTION
 SILL - DIRECT TO CONCRETE/MASONRY MEDIUM / HEAVY CONFIGURATION

s:\projects\ykk_ap_america, inc.\tdi-21-0919 - tdi submittal - revision cwsf 51, cwsf 52, cwsf 53\dwg\ykk283_yhs 50 fi og_wz3.dwg 10/27/2021 5:47 PM

TITLE: YHS 50 FI ALUMINUM STOREFRONT SYSTEM - OUTSIDE GLAZED (IMPACT)
HORIZONTAL SECTIONS

PREPARED BY: BUILDING DROPS, INC.
 398 E. DANIA BEACH BLVD., STE. 338
 DANIA BEACH, FL 33004
 PH: (954)399-8478
 FAX: (954)744-4738
 WEB: www.buildingdrops.com

REMARKS	BY	DATE

THE INSTALLATION DETAILS DESCRIBED HEREIN ARE GENERIC AND MAY NOT REFLECT ACTUAL CONDITIONS FOR A SPECIFIC SITE. IF SITE CONDITIONS CAUSE INSTALLATION TO DEVIATE FROM THE REQUIREMENTS DETAILED HEREIN, A LICENSED ENGINEER OR ARCHITECT SHALL PREPARE SITE SPECIFIC DOCUMENTS FOR USE WITH THIS DOCUMENT.

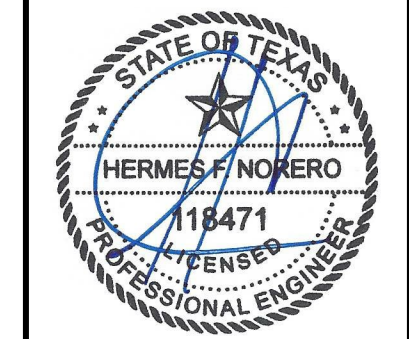

HERMES F. NORERO, P.E.
 TEXAS P.E. No. 118471
 BUILDING DROPS, INC
 398 E. DANIA BEACH BLVD. # 338
 DANIA BEACH, FL 33004
 TBPE FIRM No. 13734

DATE:	09.20.21
DWG. BY:	MS
CHK. BY:	HFN
SCALE:	NTS
DWG. #:	YKK283
SHEET:	18

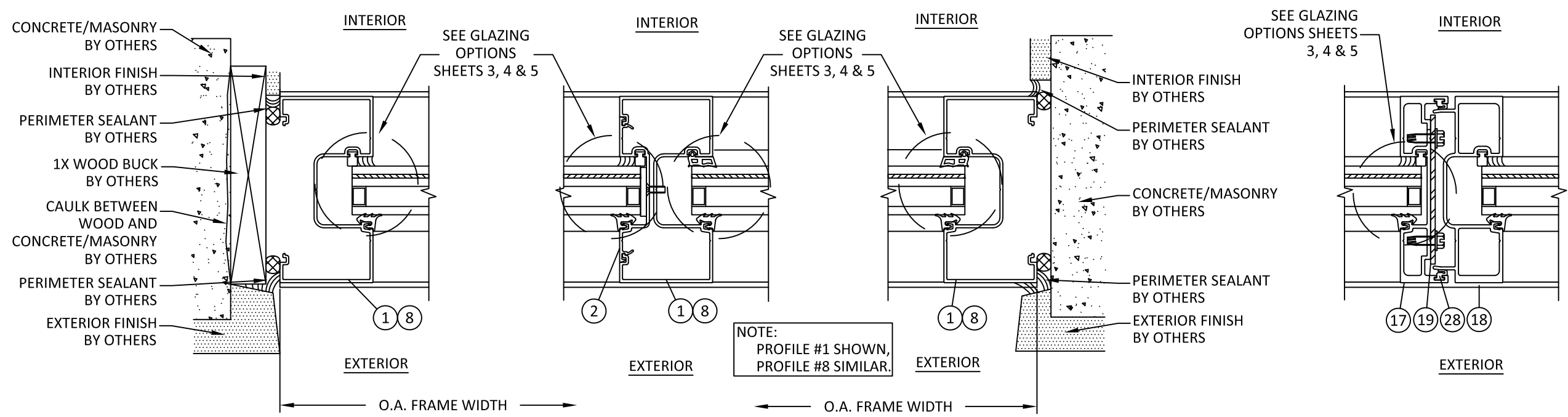

L 18 HORIZONTAL SECTION JAMB - CONCRETE/MASONRY W/ 1X BUCK LIGHT CONFIGURATION
M 18 HORIZONTAL SECTION VERTICAL MULLION LIGHT CONFIGURATION
N 18 HORIZONTAL SECTION JAMB - DIRECT TO CONCRETE/MASONRY LIGHT CONFIGURATION
O 18 HORIZONTAL SECTION VERTICAL EXPANSION MULLION LIGHT CONFIGURATION

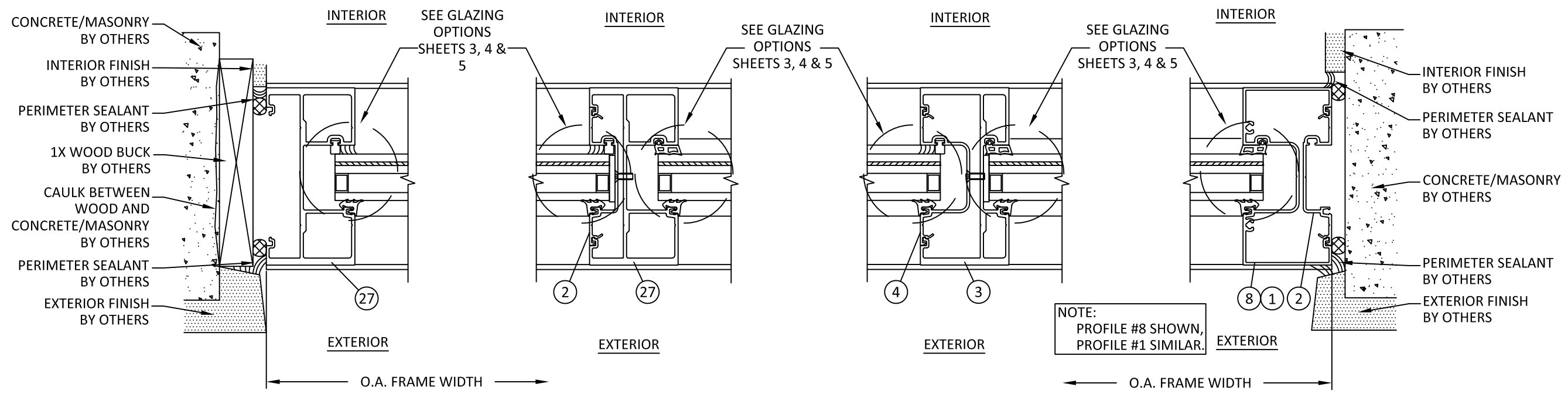

P 18 HORIZONTAL SECTION JAMB - CONCRETE/MASONRY W/ 1X BUCK MEDIUM CONFIGURATION
Q 18 HORIZONTAL SECTION VERTICAL MULLION MEDIUM CONFIGURATION
Q1 18 HORIZONTAL SECTION VERTICAL MULLION MEDIUM CONFIGURATION
R 18 HORIZONTAL SECTION JAMB - DIRECT TO CONCRETE/MASONRY MEDIUM CONFIGURATION

10/27/2021 5:47 PM
 s:\projects\ykk_ap_america, inc.\tbl-21-0919 - tbl-submittal - revision cwsf 51, cwsf 52, cwsf 53\dwg\ykk283_yhs 50 fi og_wz3.dwg

TITLE: YHS 50 FI ALUMINUM STOREFRONT SYSTEM - OUTSIDE GLAZED (IMPACT)
 HORIZONTAL SECTIONS

PREPARED BY: **BUILDING DROPS, INC.**
 398 E. DANIA BEACH BLVD., STE. 338
 DANIA BEACH, FL 33004
 PH: (954)399-8478
 FAX: (954)744-4738
 WEB: www.buildingdrops.com

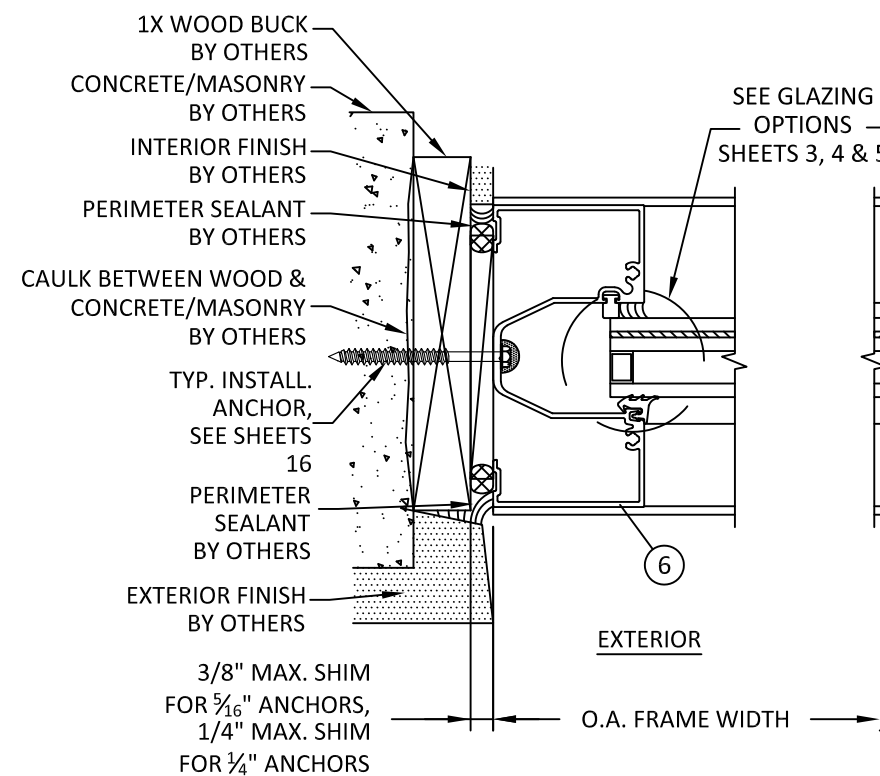

S **HORIZONTAL SECTION**
19 JAMB - CONCRETE/MASONRY W/ 1X BUCK HEAVY CONFIGURATION

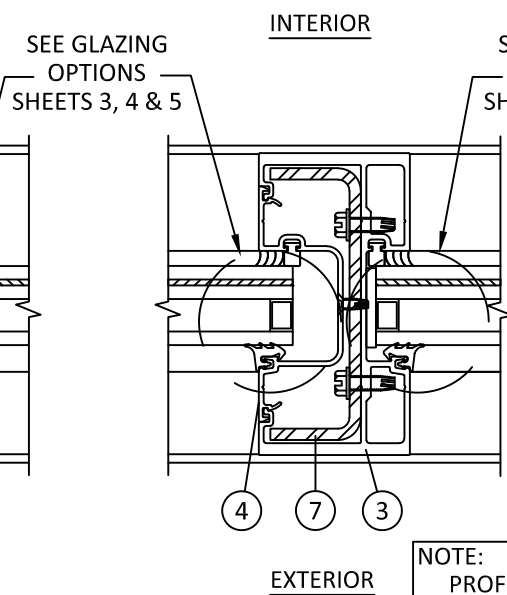

T **HORIZONTAL SECTION**
19 VERTICAL MULLION HEAVY CONFIGURATION

NOTE: PROFILE #1 SHOWN, PROFILE #8 SIMILAR.

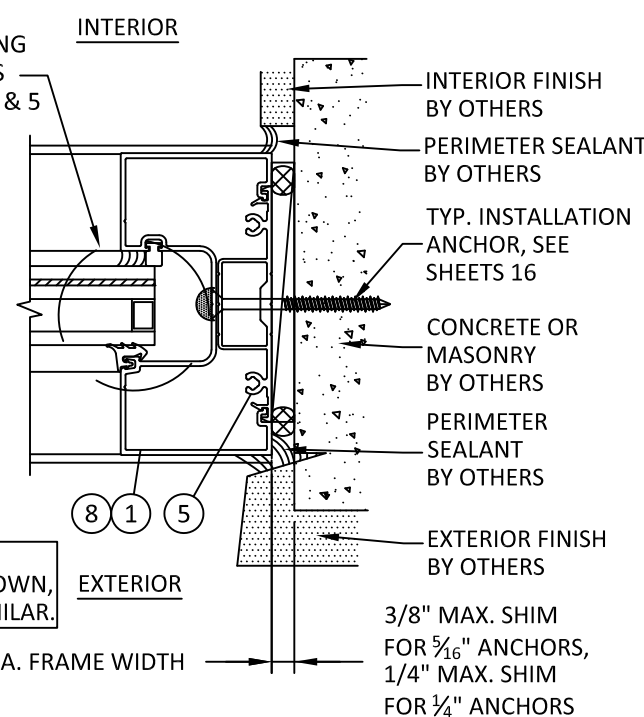

U **HORIZONTAL SECTION**
19 JAMB - DIRECT TO CONCRETE/MASONRY HEAVY CONFIGURATION

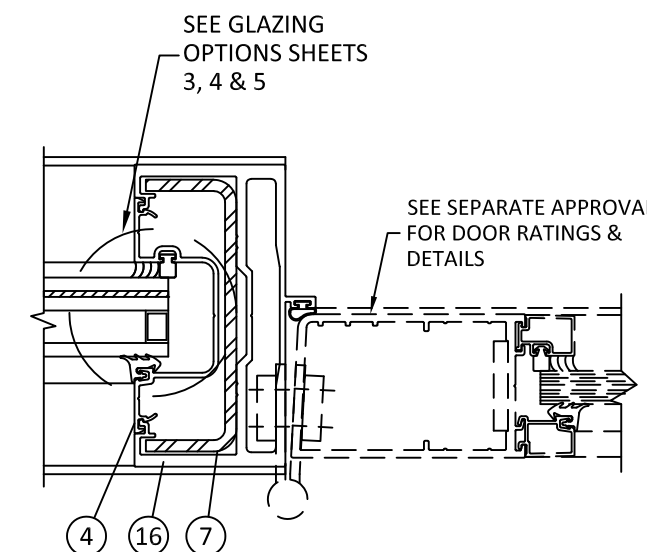

V **HORIZONTAL SECTION**
19 DOOR JAMB MULLION

THE INSTALLATION DETAILS DESCRIBED HEREIN ARE GENERIC AND MAY NOT REFLECT ACTUAL CONDITIONS FOR A SPECIFIC SITE. IF SITE CONDITIONS CAUSE INSTALLATION TO DEVIATE FROM THE REQUIREMENTS DETAILED HEREIN, A LICENSED ENGINEER OR ARCHITECT SHALL PREPARE SITE SPECIFIC DOCUMENTS FOR USE WITH THIS DOCUMENT.



HERMES F. NORERO, P.E.
 TEXAS P.E. No. 118471
 BUILDING DROPS, INC.
 398 E. DANIA BEACH BLVD. # 338
 DANIA BEACH, FL 33004
 TBPE FIRM No. 13734

DATE: 09.20.21	
DWG. BY: MS	CHK. BY: HFN
SCALE: NTS	
DWG. #: YKK283	
SHEET: 19	
[PAGE 20 OF 23]	

10/27/2021 5:47 PM s:\projects\ykk_ap_america, inc.\tdi-21-0919 - tdi submittal - revision cwsf 51, cwsf 52, cwsf 53\dwg\ykk283_yhs 50 fi og_wz3.dwg



YKK AP AMERICA, INC.
 1229 HWY 441 BYPASS
 DUBLIN, GEORGIA 31021
 PH: (478)277-1955 FAX: (678)838-6001

TITLE:
 YHS 50 FI ALUMINUM STOREFRONT
 SYSTEM - OUTSIDE GLAZED
 (IMPACT)
 HORIZONTAL SECTIONS

PREPARED BY:

BUILDING DROPS, INC.
 398 E. DANIA BEACH BLVD., STE. 338
 DANIA BEACH, FL 33004
 PH: (954)399-8478
 FAX: (954)744-4738
 WEB: www.buildingdrops.com

REMARKS	BY	DATE

THE INSTALLATION DETAILS DESCRIBED HEREIN ARE GENERIC AND MAY NOT REFLECT ACTUAL CONDITIONS FOR A SPECIFIC SITE. IF SITE CONDITIONS CAUSE INSTALLATION TO DEVIATE FROM THE REQUIREMENTS DETAILED HEREIN, A LICENSED ENGINEER OR ARCHITECT SHALL PREPARE SITE SPECIFIC DOCUMENTS FOR USE WITH THIS DOCUMENT.

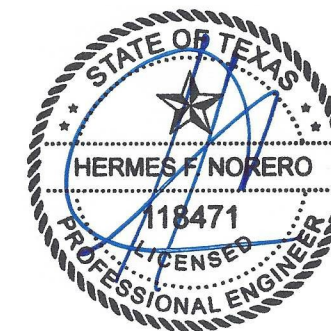

HERMES F. NORERO, P.E.
 TEXAS P.E. No. 118471
 BUILDING DROPS, INC.
 398 E. DANIA BEACH BLVD. # 338
 DANIA BEACH, FL 33004
 TBPE FIRM No. 13734

DATE:	09.20.21	
DWG. BY:	MS	CHK. BY: HFN
SCALE:	NTS	
DWG. #:	YKK283	
SHEET:	20	

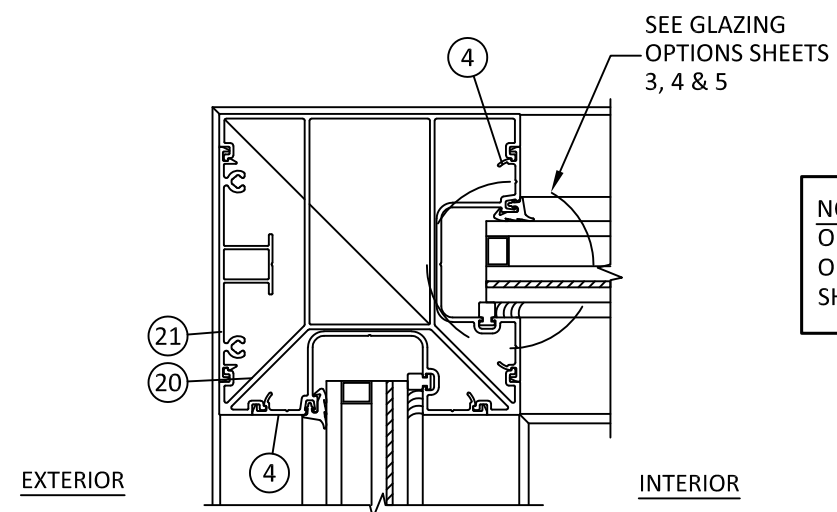

W
20 **HORIZONTAL SECTION**
 90 DEGREE CORNER MULLION

NOTE: CORNER MULLIONS MAY BE ORIENTED TO EXTERIOR (AS SHOWN ON 90° DETAIL) OR TO INTERIOR (AS SHOWN ON 135° DETAIL).

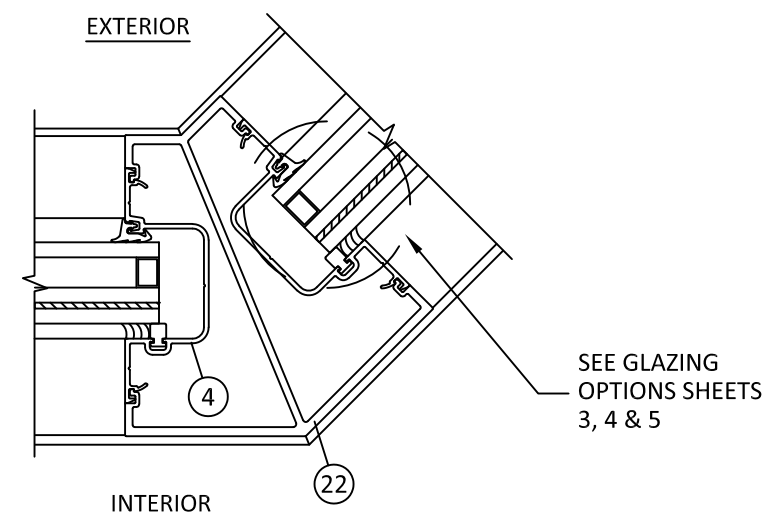

X
20 **HORIZONTAL SECTION**
 135 DEGREE CORNER MULLION

s:\projects\ykk_ap_america, inc.\tdi-21-0919 - tdi submittal - revision cwsf 51, cwsf 52, cwsf 53\dwgs\ykk283_yhs 50 fi og_wz3.dwg 10/27/2021 5:47 PM

10/27/2021 5:47 PM

ITEM	PART NO.	DESCRIPTION	MATERIAL
1	E9-0663	JAMB / VERTICAL	6063-T5
2	E9-0655	SHALLOW POCKET FILLER	6063-T5
3	E9-0665	HEAVY DUTY VERTICAL	6063-T5
4	E9-0656	DEEP POCKET FILLER	6063-T5
5	E1-1068	FLAT FILLER AT PERIMETER ANCHOR	6063-T5
6	E9-0662	HEAD / JAMB	6063-T5
7	E1-1062	STEEL CHANNEL (1-1/2" X 4-1/2" X 3/16")	A36 STEEL
8	E9-0651	HEAD / JAMB / VERTICAL	6063-T6
9	E9-0658	GLASS STOP	6063-T5
10	E9-0653	HORIZONTAL	6063-T5
11	E9-0664	SILL (UP TO ±50 PSF)	6063-T5
12	E9-0625	SILL FLASHING (UP TO ±50 PSF)	6063-T5
13	E9-0652	SILL (UP TO +70/-90 PSF)	6063-T5
14	E9-0619	SILL FLASHING (UP TO +70/-90 PSF)	6063-T5
15	E1-1073	ANCHOR FILLER	6063-T5
16	E9-0504	DOOR JAMB O/P	6063-T6
17	E9-0688	EXPANSION MULLION (FEMALE)	6063-T6
18	E9-0689	EXPANSION MULLION (MALE)	6063-T6
19	E1-0165	STEEL REINFORCEMENT BAR (4" X 1/8")	STEEL
20	E9-0659	90° CORNER MULLION	6063-T5
21	E9-0657	CORNER MULLION FILLER	6063-T5
22	E9-0660	135° CORNER MULLION	6063-T5
23	E2-0084	INTERIOR SILICONE SPACER	SILICONE
24	E2-0095	SETTING BLOCK	EPDM (85±5)
25	E2-0088	INTERIOR GLAZING GASKET	EPDM
26	E2-0083	EXTERIOR GLAZING GASKET	EPDM
27	E9-0654	HEAVY DUTY MULLION	6063-T6
28	K2-2441	WEATHERING GASKET	EPDM

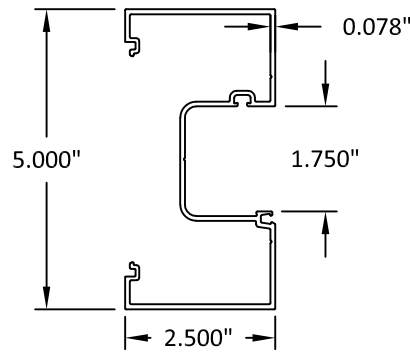

1 JAMB/VERTICAL

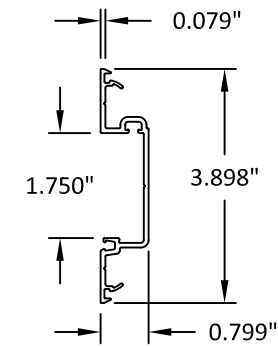

2 SHALLOW POCKET FILLER

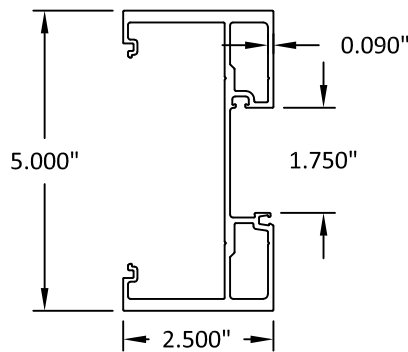

3 HEAVY DUTY VERTICAL

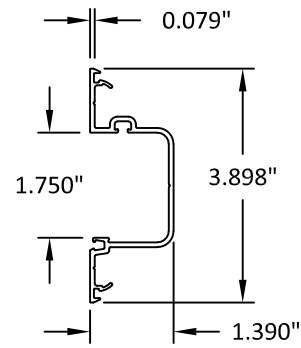

4 DEEP POCKET FILLER

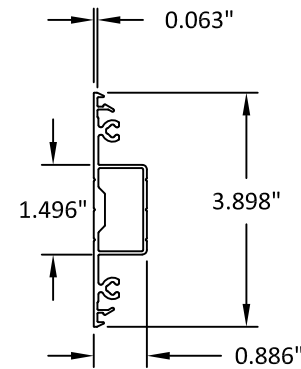

5 FLAT FILLER AT PERIMETER ANCHOR

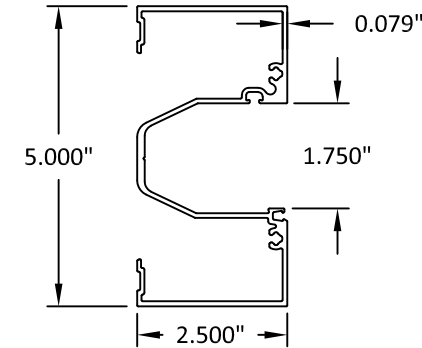

6 HEAD/JAMB

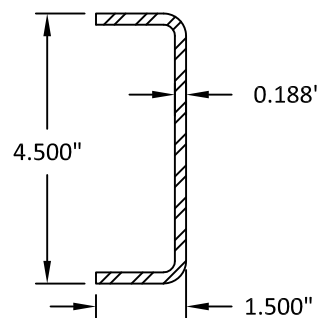

7 STEEL CHANNEL (1-1/2" X 4-1/2" X 3/16")

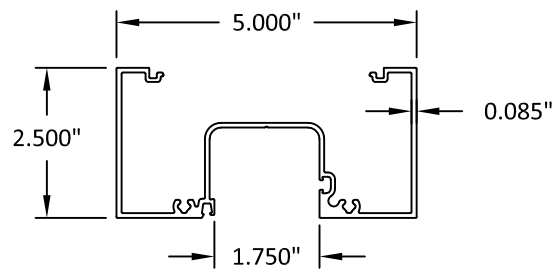

8 HEAD/JAMB/VERTICAL

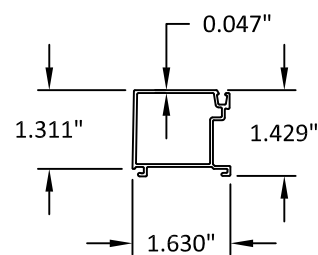

9 GLASS STOP

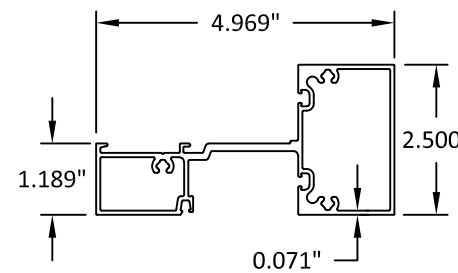

10 HORIZONTAL



YKK AP AMERICA, INC.
 1229 HWY 441 BYPASS
 DUBLIN, GEORGIA 31021
 PH: (478)277-1955 FAX: (678)838-6001

TITLE: YHS 50 FI ALUMINUM STOREFRONT SYSTEM - OUTSIDE GLAZED (IMPACT)
 COMPONENTS & BILL OF MATERIALS

PREPARED BY: **BUILDING DROPS, INC.**
 398 E. DANIA BEACH BLVD., STE. 338
 DANIA BEACH, FL 33004
 PH: (954)399-8478
 FAX: (954)744-4738
 WEB: www.buildingdrops.com



REMARKS	BY	DATE

THE INSTALLATION DETAILS DESCRIBED HEREIN ARE GENERIC AND MAY NOT REFLECT ACTUAL CONDITIONS FOR A SPECIFIC SITE. IF SITE CONDITIONS CAUSE INSTALLATION TO DEVIATE FROM THE REQUIREMENTS DETAILED HEREIN, A LICENSED ENGINEER OR ARCHITECT SHALL PREPARE SITE SPECIFIC DOCUMENTS FOR USE WITH THIS DOCUMENT.

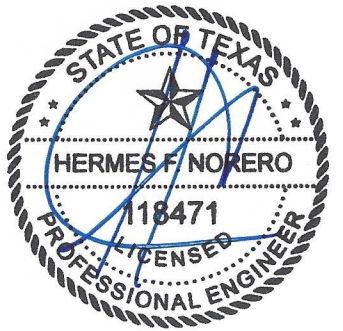

HERMES F. NORERO, P.E.
 TEXAS P.E. No. 118471
 BUILDING DROPS, INC
 398 E. DANIA BEACH BLVD. # 338
 DANIA BEACH, FL 33004
 TBPE FIRM No. 13734

DATE:	09.20.21	
DWG. BY:	MS	CHK. BY: HFN
SCALE:	NTS	
DWG. #:	YKK283	
SHEET:	21	

s:\projects\ykk_ap_america, inc.\tdi-21-0919 - tdi submittal - revision cwsf 51, cwsf 52, cwsf 53\dwg\ykk283_yhs 50 fi og_wz3.dwg

TITLE: YHS 50 FI ALUMINUM STOREFRONT SYSTEM - OUTSIDE GLAZED (IMPACT)
 COMPONENTS

PREPARED BY: **BUILDING DROPS, INC.**
 398 E. DANIA BEACH BLVD., STE. 338
 DANIA BEACH, FL 33004
 PH: (954)399-8478
 FAX: (954)744-4738
 WEB: www.buildingdrops.com



REMARKS	BY	DATE

THE INSTALLATION DETAILS DESCRIBED HEREIN ARE GENERIC AND MAY NOT REFLECT ACTUAL CONDITIONS FOR A SPECIFIC SITE. IF SITE CONDITIONS CAUSE INSTALLATION TO DEVIATE FROM THE REQUIREMENTS DETAILED HEREIN, A LICENSED ENGINEER OR ARCHITECT SHALL PREPARE SITE SPECIFIC DOCUMENTS FOR USE WITH THIS DOCUMENT.

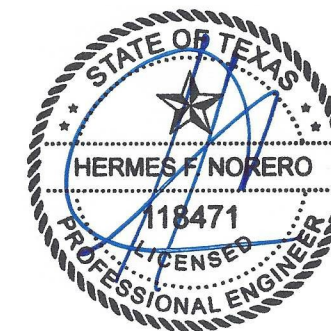

HERMES F. NORERO, P.E.
 TEXAS P.E. No 118471
 BUILDING DROPS, INC
 398 E. DANIA BEACH BLVD. # 338
 DANIA BEACH, FL 33004
 TBPE FIRM No. 13734

DATE: **09.20.21**

DWG. BY: **MS**

CHK. BY: **HFN**

SCALE: **NTS**

DWG. #: **YKK283**

SHEET:

22

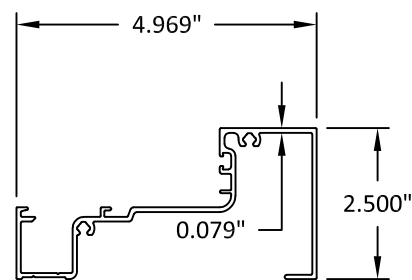

11 SILL (UP TO ± 50 PSF)

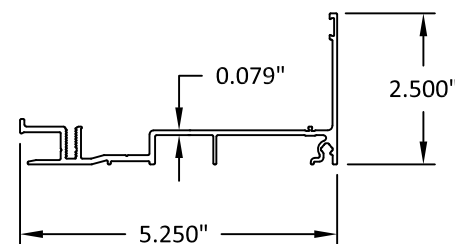

12 SILL FLASHING (UP TO ± 50 PSF)

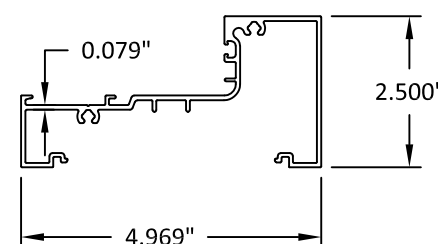

13 SILL (UP TO +70/-90 PSF)

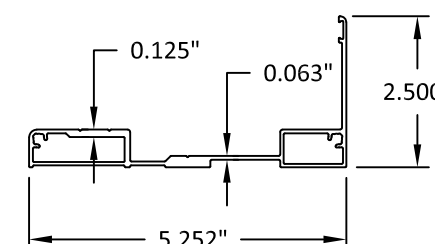

14 SILL FLASHING (UP TO +70/-90 PSF)

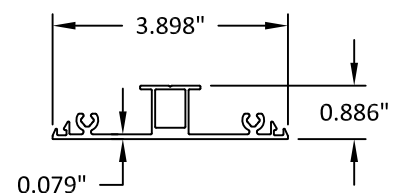

15 ANCHOR FILLER

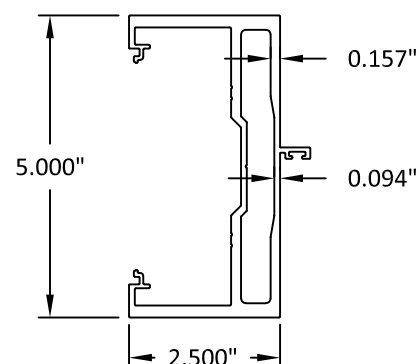

16 DOOR JAMB O/P

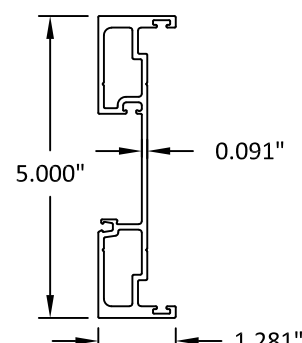

17 EXPANSION MULLION (FEMALE)

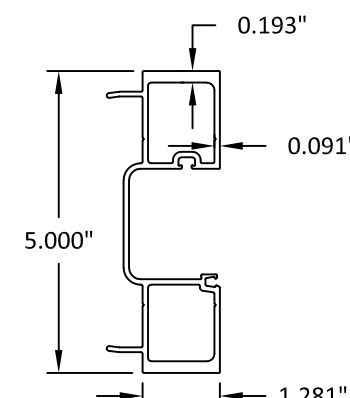

18 EXPANSION MULLION (MALE)

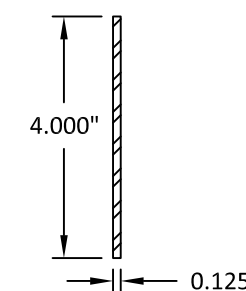

19 STEEL REINFORCEMENT BAR

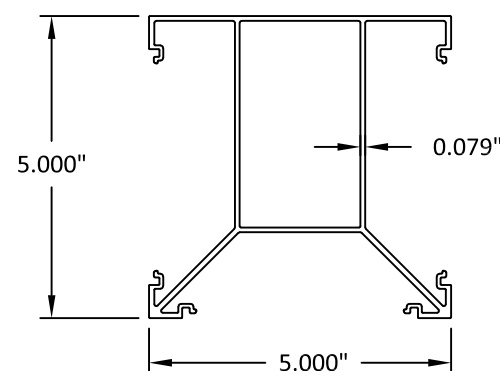

20 90 DEGREE CORNER MULLION

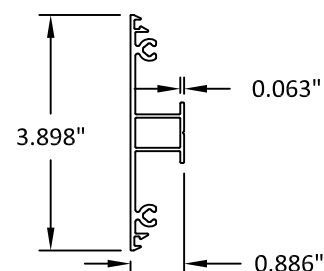

21 90 DEGREE CORNER MULLION FILLER

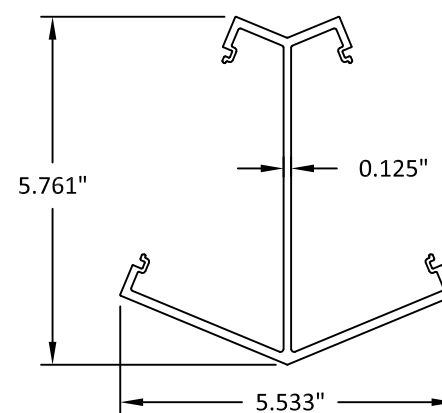

22 135 DEGREE CORNER MULLION

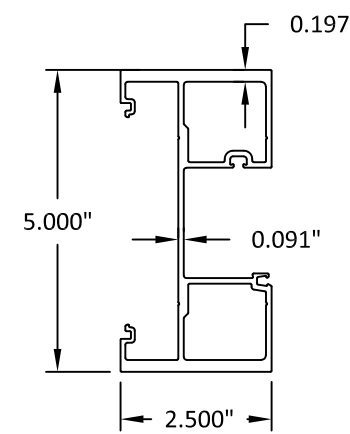

27 HEAVY DUTY MULLION