

EYEWALL ARMOR FABRIC SHUTTER

FOR USE WITHIN TEXAS INLAND ZONE I/II & SEAWARD ZONES

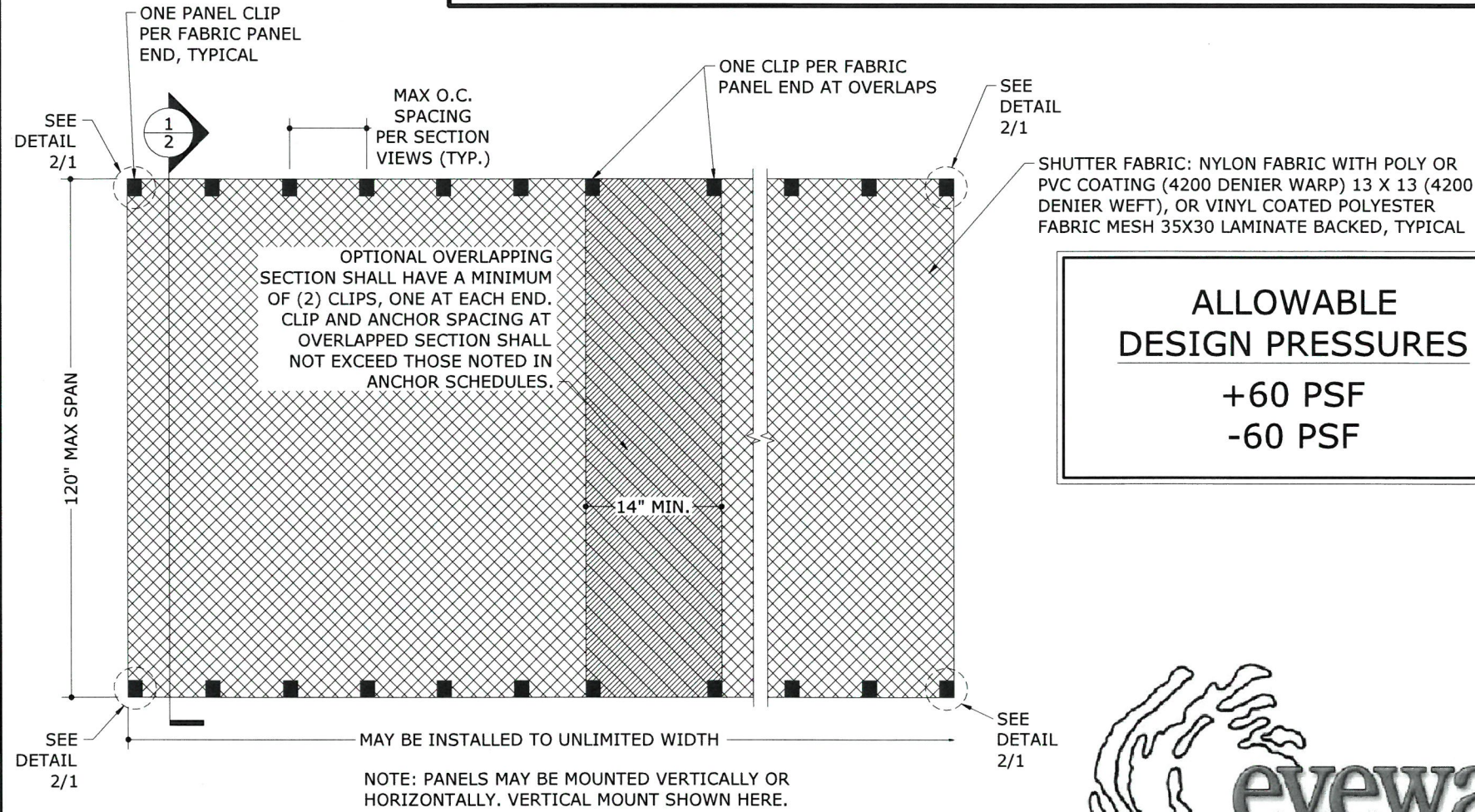

1 TYPICAL PANEL INSTALLATION
1 N.T.S. EXTERIOR ELEV

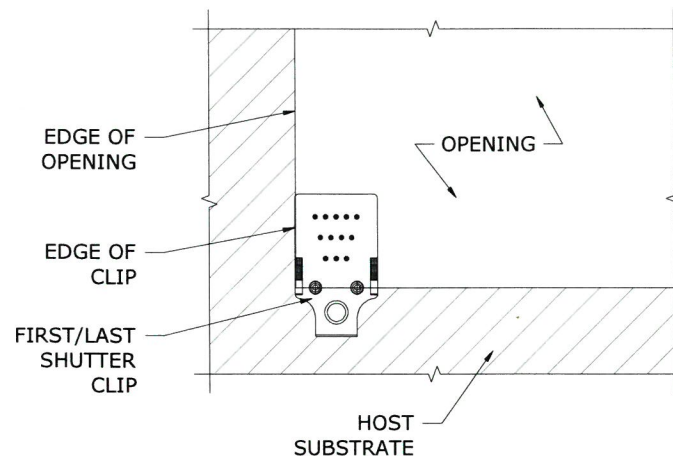

2 TYPICAL PANEL INSTALLATION
1 N.T.S. SECTION VIEW

ALLOWABLE DESIGN PRESSURES
+60 PSF
-60 PSF



GENERAL NOTES

1. THE SYSTEM DESCRIBED HEREIN HAS BEEN DESIGNED AND TESTED IN ACCORDANCE WITH THE 2006 INTERNATIONAL BUILDING & RESIDENTIAL CODE (IRC), FOR USE WITHIN TEXAS INLAND ZONE II, INLAND ZONE 1 AND SEAWARD ZONES. THIS SYSTEM HAS BEEN TESTED IN ACCORDANCE WITH ASTM E330, E1996 AND E1886 TESTING STANDARDS PER TEST REPORT C9417.01-450-44, E1014.01-450-44 AND H3373-450-18 BY ARCHITECTURAL TESTING, INC.
2. NO 33-1/3% INCREASE IN ALLOWABLE STRESS HAS BEEN USED IN THE DESIGN OF THIS SYSTEM. WIND LOAD DURATION FACTOR Cd=1.6 HAS BEEN USED FOR WOOD ANCHOR DESIGN.
3. THE ARCHITECT/ENGINEER OF RECORD FOR THE PROJECT SUPERSTRUCTURE WITH WHICH THIS DESIGN IS USED SHALL BE RESPONSIBLE FOR THE INTEGRITY OF ALL SUPPORTING SURFACES TO THIS DESIGN WHICH SHALL BE COORDINATED BY THE PERMITTING CONTRACTOR.
4. POSITIVE AND NEGATIVE DESIGN PRESSURES CALCULATED FOR USE WITH THIS SYSTEM SHALL BE DETERMINED PER SEPARATE ENGINEERING IN ACCORDANCE WITH THE GOVERNING CODE. PRESSURE REQUIREMENTS SHALL BE LESS THAN OR EQUAL TO THE POSITIVE OR NEGATIVE DESIGN PRESSURE CAPACITY VALUES LISTED HEREIN FOR ANY ASSEMBLY AS SHOWN.
5. FOR INSTALLATIONS OUTSIDE THE HVHZ, THIS SYSTEM HAS BEEN DESIGNED WITH NO SEPARATION FROM GLAZING REQUIRED FOR ALL WIND ZONES, IN ACCORDANCE WITH ASTM E1996-09. IT IS ACCEPTABLE BY CODE UNLESS OPTIONAL CRITERIA IS INDEPENDENTLY ADOPTED BY THE AUTHORITY HAVING JURISDICTION.
6. DESIGN PRESSURES NOTED HEREIN ARE BASED ON MAXIMUM TESTED PRESSURES DIVIDED BY A 1.5 SAFETY FACTOR.
7. THE SYSTEM DETAILED HEREIN IS GENERIC AND DOES NOT PROVIDE INFORMATION FOR A SPECIFIC SITE. FOR SITE CONDITIONS DIFFERENT FROM THE CONDITIONS DETAILED HEREIN, A LICENSED ENGINEER OR REGISTERED ARCHITECT SHALL PREPARE SITE SPECIFIC DOCUMENTS FOR USE IN CONJUNCTION WITH THIS DOCUMENT.
8. PERMIT HOLDER SHALL VERIFY THE ADEQUACY OF THE EXISTING STRUCTURE TO WITHSTAND SUPERIMPOSED LOADS. WOOD BUCKS (BY OTHERS) SHALL BE ANCHORED PROPERLY TO TRANSFER LOADS TO THE EXISTING STRUCTURE.
9. THIS SYSTEM IS INTENDED FOR USE ONLY DURING WIND STORM EVENTS. WHEN NOT IN USE, PRODUCT SHALL BE PROPERLY STORED AWAY FROM PROLONGED EXPOSURE TO DIRECT SUNLIGHT OR OTHER WEATHERING CONDITIONS.
10. MAXIMUM PANEL SPAN: 10'-0"
11. MAXIMUM ALLOWABLE DESIGN PRESSURE: ±60 PSF
12. PANEL OPENINGS SHALL BE PERMANENTLY LABELED WITH A MINIMUM OF ONE LABEL PER PANEL OPENING CONTAINING THE FOLLOWING MINIMUM INFORMATION:
TOWN & COUNTRY INDUSTRIES
FORT LAUDERDALE, FL
MISSILE LEVEL D - ASTM E1886, E1996 & E330
TDI SHU#
13. HURRICANE FABRIC PANELS MAY BE MOUNTED VERTICALLY OR HORIZONTALLY AS APPLICABLE.
14. EXCEPT AS EXPRESSLY PROVIDED HEREIN, NO ADDITIONAL CERTIFICATIONS OR AFFIRMATIONS ARE INTENDED.



EX EXPRESS ENGINEERING
CORPORATE OFFICE:
160 SW 12th AVE, SUITE 106
DEERFIELD BEACH, FL 33442
P: (954) 354-0660 F: (954) 354-0443
E: HELLO@ENGINEERINGEXPRESS.COM
ENGINEERINGEXPRESS.COM
CERT OF AUTH #F-11383

Town & Country INDUSTRIES
Wholesale Aluminum and Building Products
A Division of ABC Supply Co., Inc.
400 WEST MCNAB ROAD
FT. LAUDERDALE, FL 33309

REMARKS	DRWN	CHKD	DATE
INIT ISSUE	KL	FLB	04/25/14
REVISE ANCHOR TABLES	CSL	TSB	12/30/14
REV 2014 FBC	ZAR	CSL	02/16/15
Rev - NEW FABRIC	RWN	FLB	08/03/17
REV (TDI)	RWN	FLB	4/10/18

THIS DOCUMENT IS THE PROPERTY OF FRANK L. BENNARDO, P.E. AND SHALL NOT BE REPRODUCED, COPIED, OR TRANSMITTED IN ANY FORM OR BY ANY MEANS, WITHOUT THE WRITTEN PERMISSION OF FRANK L. BENNARDO, P.E. ANY ALTERATIONS, ADDITIONS, HIGHLIGHTS, OR OTHER MARKINGS TO THIS DOCUMENT ARE NOT PERMITTED AND INVALIDATE OUR CERTIFICATION.

COPYRIGHT FRANK L. BENNARDO P.E.

14-1634

SCALE: -
PAGE DESCRIPTION: -

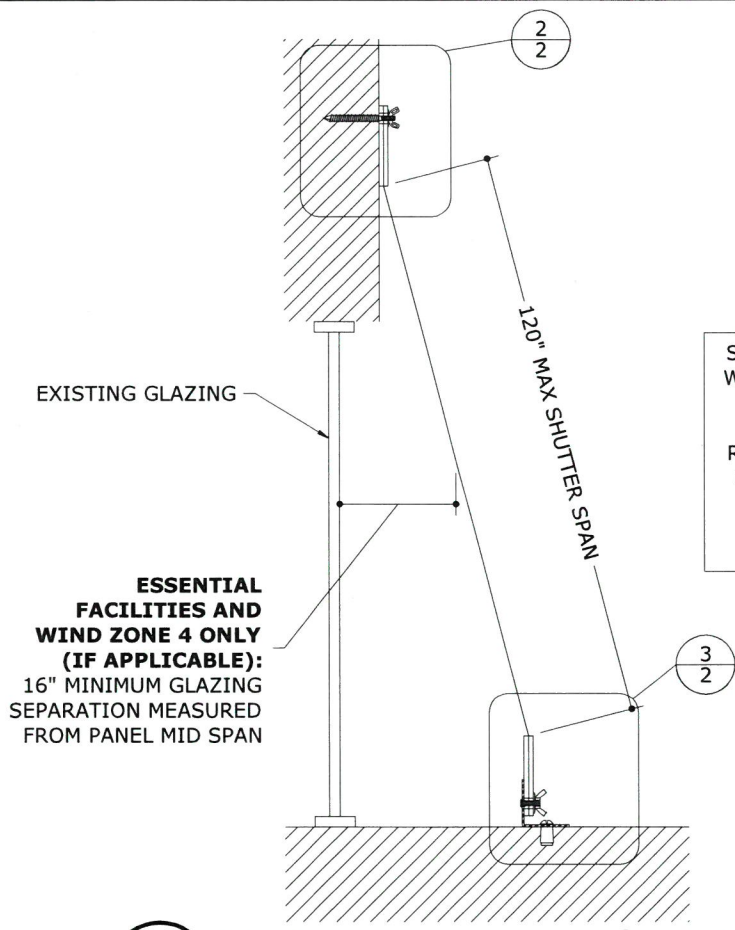

1a TYPICAL SHUTTER (SLANTED)
2 N.T.S. VERT SECTION

CONNECTION C1
ANCHORS SPACED PER ANCHOR SCHEDULE

SHUTTER MAY BE INSTALLED WITH OR WITHOUT SLANT AS LONG AS THE MINIMUM SEPARATION FROM GLASS REQUIREMENT IS MET WHEN MEASURED FROM SHUTTER PANEL MID SPAN WHEN REQUIRED FOR HVHZ OR ESSENTIAL FACILITIES

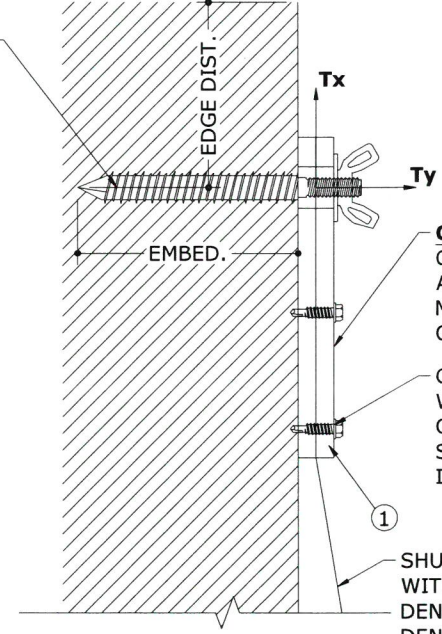

2 TYPICAL WALL MOUNT
2 N.T.S. VERT SECTION

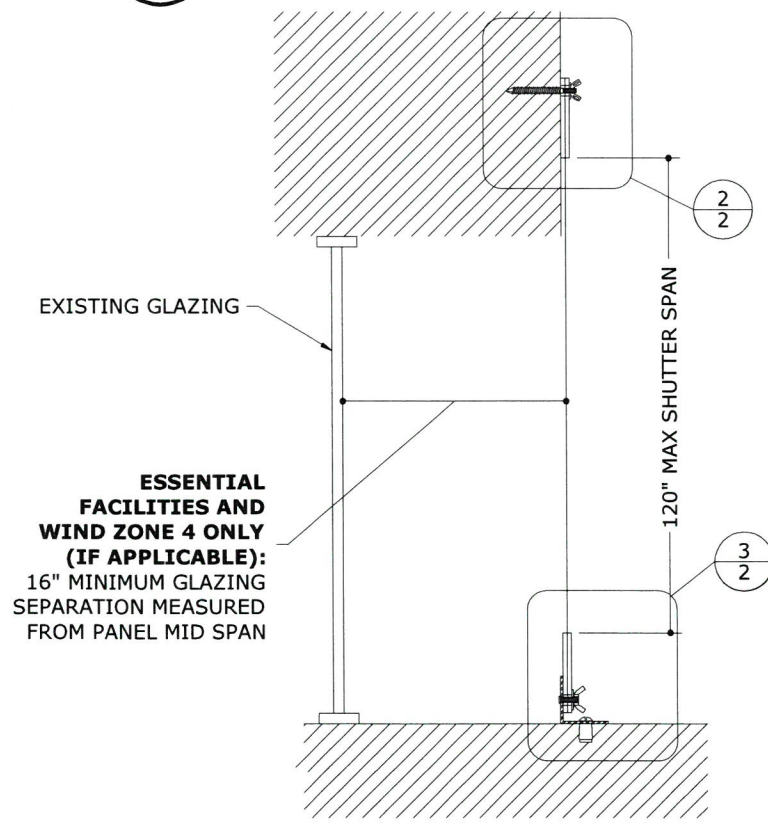

1b TYPICAL SHUTTER (VERTICAL)
2 N.T.S. VERT SECTION

CONNECTION C1
ANCHORS SPACED PER ANCHOR SCHEDULE

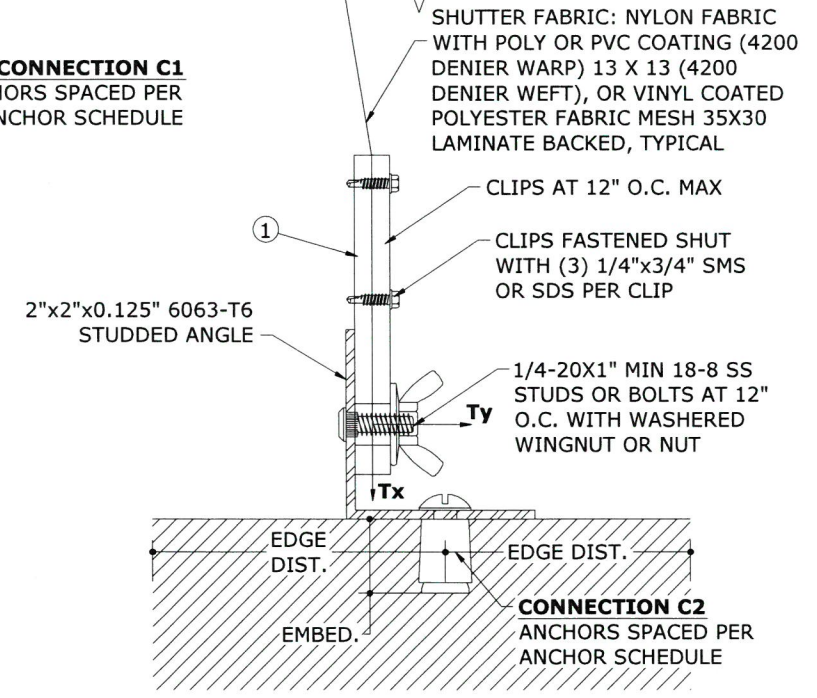

3 TYPICAL TRAP MOUNT
2 N.T.S. VERT SECTION

LOAD ON EXISTING STRUCTURE FROM SCREEN SYSTEM
Tx = PARALLEL LOADS (PLF)

SPAN	DESIGN PRESSURE				
	60 PSF	53 PSF	45 PSF	38 PSF	33 PSF
3'-6"	164.5	151.5	135.8	121.3	110.4
4'-6"	194.5	179.1	160.6	143.5	130.6
5'-7"	257.8	237.3	212.8	190.1	173.0
6'-6"	328.8	302.7	271.4	242.5	220.7
8'-6"	474.4	436.8	391.6	349.9	318.5
10'-0"	580.5	534.4	479.2	428.1	389.7

LOAD ON EXISTING STRUCTURE FROM SCREEN SYSTEM
Ty = PERPENDICULAR LOADS (PLF)

SPAN	DESIGN PRESSURE				
	60 PSF	53 PSF	45 PSF	38 PSF	33 PSF
3'-6"	105.0	92.8	78.8	66.5	57.8
4'-6"	135.0	119.3	101.3	85.5	74.3
5'-7"	167.5	148.0	125.6	106.1	92.1
6'-6"	195.0	172.3	146.3	123.5	107.3
8'-6"	255.0	225.3	191.3	161.5	140.3
10'-0"	300.0	265.0	225.0	190.0	165.0

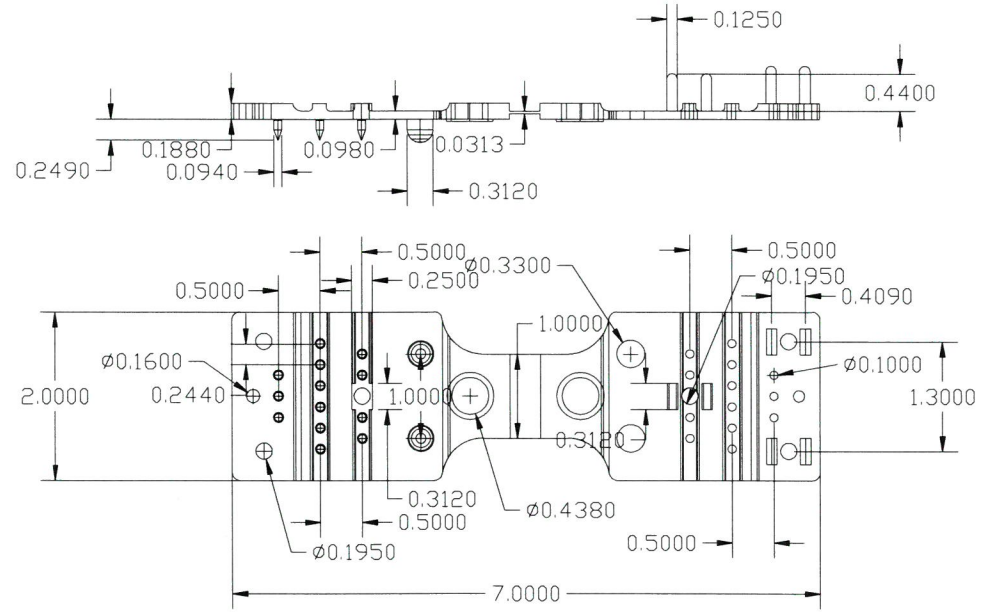

1 SHUTTER CLIP
N.T.S. MATERIAL: NYLON 6

FRANK L. BENNARDO, P.E.
PE96064

STATE OF FLORIDA
04/11/2018

FRANK L. BENNARDO
9661
PROFESSIONAL ENGINEER
EX-EXPRESS

CORPORATE OFFICE:
160 SW 12th AVE, SUITE 303
DEERFIELD BEACH, FL 33441
P: (954) 354-0660 F: (954) 354-0643
E: HELLO@ENGINEERINGEXPRESS.COM
ENGINEERINGEXPRESS.COM
CERT OF AUTH #F-11383

Town & Country
INDUSTRIES
Wholesale Aluminum and Building Products
A Division of ABC Supply Co., Inc.

400 WEST MCNAB ROAD
FT. LAUDERDALE, FL 33309

REMARKS	DRWN	CHKD	DATE
INIT ISSUE	KL	FLB	04/25/14
REVISE ANCHOR TABLES	CSL	TSB	12/30/14
REV 2014 FBC	ZAR	CSL	02/16/15
Rev- NEW FABRIC	RWN	FLB	08/03/17
REV (TDI)	RWN	FLB	4/10/18

THIS DOCUMENT IS THE PROPERTY OF FRANK L. BENNARDO, P.E. AND SHALL NOT BE REPRODUCED, COPIED, OR TRANSMITTED IN ANY FORM OR BY ANY MEANS, ELECTRONIC OR MECHANICAL, INCLUDING PHOTOCOPYING, RECORDING, OR BY ANY INFORMATION STORAGE AND RETRIEVAL SYSTEM. ANY ALTERATIONS, ADJUSTMENTS, OR OTHER MARKINGS TO THIS DOCUMENT ARE NOT PERMITTED AND INVALIDATE OUR CERTIFICATION.

COPYRIGHT FRANK L. BENNARDO P.E.

14-1634

SCALE: -

PAGE DESCRIPTION: -

ANCHOR NOTES:

- SEE SECTION VIEWS FOR ANCHOR LOCATIONS AND/OR SPACING.
- ANCHORS SHALL BE INSTALLED IN ACCORDANCE WITH MANUFACTURERS' RECOMMENDATIONS.
- UNLESS OTHERWISE NOTED HEREIN, WHERE ANCHORS FASTEN TO NARROW FACE OF STUD FRAMING, ANCHOR SHALL BE LOCATED IN CENTER OF NOMINAL 2x (MIN) WOOD STUD (i.e. 3/4" EDGE DISTANCE IS ACCEPTABLE FOR ANCHORS TO WOOD FRAMING, PER APPLICABLE ANCHOR SCHEDULE).
- MINIMUM EMBEDMENT SHALL BE AS NOTED IN ANCHOR SCHEDULE. MINIMUM EMBEDMENT AND EDGE DISTANCE EXCLUDES STUCCO, FOAM, BRICK, AND OTHER WALL FINISHES.
- ANCHOR SCHEDULE APPLIES TO ALL PRODUCTS CERTIFIED HEREIN, BUT ONLY PROVIDES MAXIMUM ALLOWABLE ANCHOR SPACING. MAXIMUM ALLOWABLE SPANS AND PRESSURES INDICATED IN SPAN SCHEDULE SHALL APPLY.
- WHERE EXISTING STRUCTURE IS WOOD FRAMING, EXISTING CONDITIONS MAY VARY. FIELD VERIFY THAT FASTENERS ARE INTO ADEQUATE WOOD FRAMING MEMBERS, NOT INTO PLYWOOD.
- MACHINE SCREWS SHALL HAVE MINIMUM OF 1/2" ENGAGEMENT OF THREADS IN BASE ANCHOR AND MAY HAVE EITHER A PAN HEAD, TRUSS HEAD, OR WAFER HEAD ("SIDEWALK BOLT") U.N.O.
-  DESIGNATES ANCHOR CONDITIONS WHICH ARE NOT ACCEPTABLE FOR USE.

ANCHOR SCHEDULES:

HOST STRUCT.	ANCHOR TYPE	LOAD (psf)	2.5" MIN EDGE DISTANCE												
			Spans Up To 3'-6"		Spans Up To 4'-6"		Spans Up To 5'-7"		Spans Up To 6'-6"		Spans Up To 8'-6"		Spans Up To 10'-0"		
			CONN TYPE C1	CONN TYPE C2	CONN TYPE C1	CONN TYPE C2	CONN TYPE C1	CONN TYPE C2	CONN TYPE C1	CONN TYPE C2	CONN TYPE C1	CONN TYPE C2	CONN TYPE C1	CONN TYPE C2	
CONCRETE	5/16" ITW TAPCON XL, 2-1/4" EMBED (2899 PSI CONC)	33	12.0"	12.0"	12.0"	12.0"	12.0"	12.0"	12.0"	12.0"	12.0"	12.0"	12.0"	11.0"	
		38	12.0"	12.0"	12.0"	12.0"	12.0"	12.0"	12.0"	12.0"	12.0"	12.0"	11.9"	12.0"	9.9"
		45	12.0"	12.0"	12.0"	12.0"	12.0"	12.0"	12.0"	12.0"	12.0"	12.0"	10.5"	12.0"	8.7"
		53	12.0"	12.0"	12.0"	12.0"	12.0"	12.0"	12.0"	12.0"	12.0"	12.0"	9.3"	12.0"	7.7"
		60	12.0"	12.0"	12.0"	12.0"	12.0"	12.0"	12.0"	12.0"	12.0"	11.8"	12.0"	12.0"	7.0"
	1/4" ELCO PANELMATE, MALE OR FEMALE, 1-3/4" EMBED (3323 PSI CONC)	33	12.0"	12.0"	12.0"	12.0"	12.0"	12.0"	12.0"	12.0"	12.0"	9.0"	11.4"	7.4"	
		38	12.0"	12.0"	12.0"	12.0"	12.0"	12.0"	12.0"	11.3"	12.0"	8.1"	10.3"	6.7"	
		45	12.0"	12.0"	12.0"	12.0"	12.0"	12.0"	12.0"	9.9"	11.1"	7.1"	9.1"	5.9"	
		53	12.0"	12.0"	12.0"	12.0"	12.0"	10.7"	12.0"	8.7"	9.9"	6.2"	8.1"	5.2"	
		60	12.0"	12.0"	12.0"	12.0"	12.0"	9.7"	12.0"	7.9"	9.0"	5.7"	7.4"	4.7"	
	1/4" ITW TAPCON SG, 1-3/4" EMBED (3295 PSI CONC)	33	12.0"	12.0"	12.0"	12.0"	12.0"	12.0"	12.0"	12.0"	12.0"	12.0"	12.0"	9.9"	
		38	12.0"	12.0"	12.0"	12.0"	12.0"	12.0"	12.0"	12.0"	12.0"	10.8"	12.0"	8.9"	
		45	12.0"	12.0"	12.0"	12.0"	12.0"	12.0"	12.0"	12.0"	12.0"	9.5"	12.0"	7.8"	
		53	12.0"	12.0"	12.0"	12.0"	12.0"	12.0"	12.0"	11.7"	12.0"	8.4"	12.0"	6.9"	
		60	12.0"	12.0"	12.0"	12.0"	12.0"	12.0"	12.0"	10.6"	12.0"	7.6"	11.6"	6.3"	
	1/4" ITW SAMMYS SSC, 2-1/4" EMBED (3295 PSI CONC)	33	12.0"	12.0"	12.0"	12.0"	12.0"	12.0"	12.0"	12.0"	12.0"	12.0"	12.0"	10.4"	
		38	12.0"	12.0"	12.0"	12.0"	12.0"	12.0"	12.0"	12.0"	12.0"	11.2"	12.0"	9.3"	
		45	12.0"	12.0"	12.0"	12.0"	12.0"	12.0"	12.0"	12.0"	12.0"	9.9"	11.1"	8.2"	
		53	12.0"	12.0"	12.0"	12.0"	12.0"	12.0"	12.0"	12.0"	12.0"	8.7"	9.9"	7.2"	
		60	12.0"	12.0"	12.0"	12.0"	12.0"	12.0"	12.0"	10.9"	11.0"	7.9"	9.1"	6.5"	
	1/4" ALL POINTS SOLID-SET, 7/8" EMBED (3000 PSI CONC)	33	12.0"	12.0"	12.0"	12.0"	12.0"	12.0"	12.0"	11.6"	12.0"	8.3"	12.0"	6.8"	
		38	12.0"	12.0"	12.0"	12.0"	12.0"	12.0"	12.0"	10.4"	12.0"	7.4"	12.0"	6.1"	
		45	12.0"	12.0"	12.0"	12.0"	12.0"	11.4"	12.0"	9.2"	12.0"	6.5"	10.7"	5.4"	
		53	12.0"	12.0"	12.0"	12.0"	12.0"	10.0"	12.0"	8.1"	11.4"	5.8"	9.4"	4.8"	
		60	12.0"	12.0"	12.0"	11.7"	12.0"	9.1"	12.0"	7.3"	10.4"	5.2"	8.6"	4.3"	
	1/4" ALL POINTS SOLID-SET, 7/8" EMBED (3000 PSI CONC)	2" MIN EDGE DISTANCE													
		33	12.0"	12.0"	12.0"	12.0"	12.0"	12.0"	12.0"	10.2"	12.0"	7.3"	11.6"	6.0"	
		38	12.0"	12.0"	12.0"	12.0"	12.0"	11.4"	12.0"	9.2"	12.0"	6.5"	10.5"	5.4"	
45		12.0"	12.0"	12.0"	12.0"	12.0"	10.0"	12.0"	8.1"	11.2"	5.7"	9.2"	4.7"		
53		12.0"	12.0"	12.0"	11.4"	12.0"	8.8"	12.0"	7.1"	9.9"	5.1"	8.2"	4.2"		
60	12.0"	12.0"	12.0"	10.3"	12.0"	8.0"	12.0"	6.5"	9.0"	4.6"	7.5"	3.8"			
1/4" ELCO PANELMATE INSERT, 1-5/8" EMBED (2700 PSI CONC)	4" MIN EDGE DISTANCE														
	33	12.0"	12.0"	12.0"	12.0"	12.0"	12.0"	12.0"	12.0"	12.0"	9.7"	12.0"	8.0"		
	38	12.0"	12.0"	12.0"	12.0"	12.0"	12.0"	12.0"	12.0"	12.0"	8.7"	11.3"	7.2"		
	45	12.0"	12.0"	12.0"	12.0"	12.0"	12.0"	12.0"	10.7"	12.0"	7.7"	10.0"	6.3"		
	53	12.0"	12.0"	12.0"	12.0"	12.0"	11.6"	12.0"	9.4"	10.8"	6.7"	8.9"	5.6"		
60	12.0"	12.0"	12.0"	12.0"	12.0"	10.5"	12.0"	8.5"	9.9"	6.1"	8.2"	5.1"			

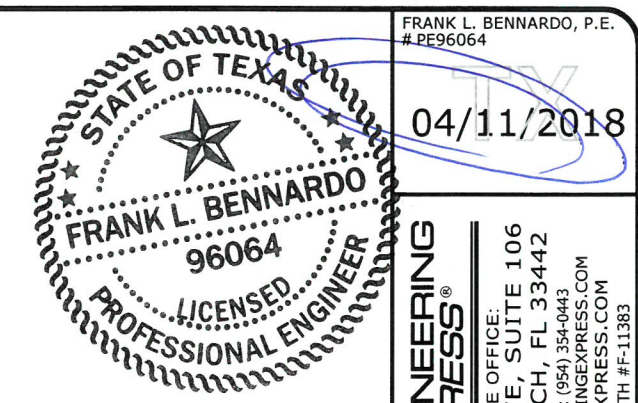

ENGINEERING EXPRESS
 CORPORATE OFFICE:
 160 SW 12th AVE, SUITE 106
 DEERFIELD BEACH, FL 33442
 P: (954) 354-0660 F: (954) 354-0443
 E: HELLO@ENGINEERINGEXPRESS.COM
 ENGINEERINGEXPRESS.COM
 CERT OF AUTH #F-11383

Town & Country INDUSTRIES
 Wholesale Aluminum and Building Products
 A Division of ABC Supply Co., Inc.
 400 WEST MCNAB ROAD
 FT. LAUDERDALE, FL 33309

REMARKS	DRWN	CHKD	DATE
INIT ISSUE	KL	FLB	04/25/14
REVISE ANCHOR TABLES	CSL	TSB	12/30/14
REV 2014 FBC	ZAR	CSL	02/16/15
REV- NEW FABRIC	RWN	FLB	08/03/17
REV (TDI)	RWN	FLB	4/10/18

THIS DOCUMENT IS THE PROPERTY OF FRANK L. BENNARDO, P.E. AND SHALL NOT BE REPRODUCED OR TRANSMITTED IN ANY FORM OR BY ANY MEANS, ELECTRONIC OR MECHANICAL, INCLUDING PHOTOCOPYING, RECORDING, OR BY ANY INFORMATION STORAGE AND RETRIEVAL SYSTEM. ANY UNAUTHORIZED ALTERATIONS, ADDITIONS, DELETIONS, OR OTHER MARKINGS TO THIS DOCUMENT ARE NOT PERMITTED AND INVALIDATE OUR CERTIFICATION.

COPYRIGHT FRANK L. BENNARDO P.E.

14-1634

SCALE: -

PAGE DESCRIPTION: -

ANCHOR SCHEDULES (CONT.):

HOST STRUCT.	ANCHOR TYPE	LOAD (psf)	2.5" MIN EDGE DISTANCE											
			Spans Up To 3'-6"		Spans Up To 4'-6"		Spans Up To 5'-7"		Spans Up To 6'-6"		Spans Up To 8'-6"		Spans Up To 10'-0"	
			CONN TYPE C1	CONN TYPE C2	CONN TYPE C1	CONN TYPE C2	CONN TYPE C1	CONN TYPE C2	CONN TYPE C1	CONN TYPE C2	CONN TYPE C1	CONN TYPE C2	CONN TYPE C1	CONN TYPE C2
GROUT-FILLED BLOCK	5/16" ELCO ULTRACON, 2-1/4" EMBED	33	12.0"	12.0"	12.0"	11.4"	12.0"	8.7"	12.0"	7.0"	11.6"		9.6"	
		38	12.0"	12.0"	12.0"	10.2"	12.0"	7.9"	12.0"	6.3"	10.4"		8.6"	
		45	12.0"	10.9"	12.0"	9.0"	12.0"	6.9"	12.0"	5.6"	9.1"		7.6"	
		53	12.0"	9.6"	12.0"	7.9"	12.0"	6.1"	11.2"		8.0"		6.7"	
		60	12.0"	8.7"	12.0"	7.2"	12.0"	5.5"	10.2"		7.3"		6.1"	
	1/4" ELCO ULTRACON, 2-1/4" EMBED	33	12.0"	12.0"	12.0"	12.0"	12.0"	11.4"	12.0"	9.3"	8.8"	6.6"	7.3"	5.5"
		38	12.0"	12.0"	12.0"	12.0"	12.0"	10.2"	11.4"	8.3"	8.0"	5.9"	6.6"	4.9"
		45	12.0"	12.0"	12.0"	11.5"	12.0"	8.9"	10.1"	7.2"	7.1"	5.2"	5.8"	
		53	12.0"	12.0"	12.0"	10.1"	11.3"	7.8"	9.0"	6.4"	6.3"	4.6"	5.2"	
		60	12.0"	11.2"	12.0"	9.1"	10.4"	7.1"	8.2"	5.8"	5.8"		4.8"	
	1/4" ITW TAPCON SG, 1-3/4" EMBED	33	12.0"	12.0"	12.0"	12.0"	12.0"	12.0"	12.0"	12.0"	12.0"	12.0"	12.0"	9.9"
		38	12.0"	12.0"	12.0"	12.0"	12.0"	12.0"	12.0"	12.0"	12.0"	10.8"	10.9"	8.9"
		45	12.0"	12.0"	12.0"	12.0"	12.0"	12.0"	12.0"	12.0"	11.9"	9.4"	9.7"	7.8"
		53	12.0"	12.0"	12.0"	12.0"	12.0"	12.0"	12.0"	11.5"	10.6"	8.3"	8.7"	6.9"
		60	12.0"	12.0"	12.0"	12.0"	12.0"	12.0"	12.0"	10.4"	9.7"	7.5"	8.0"	6.2"
	1/4" ITW SAMMYS SSC, 2-1/2" EMBED	33	12.0"	12.0"	12.0"	12.0"	12.0"	12.0"	12.0"	12.0"	9.6"	9.9"	7.9"	8.2"
		38	12.0"	12.0"	12.0"	12.0"	12.0"	12.0"	12.0"	12.0"	8.7"	8.8"	7.2"	7.3"
		45	12.0"	12.0"	12.0"	12.0"	12.0"	12.0"	11.1"	10.6"	7.8"	7.7"	6.4"	6.4"
		53	12.0"	12.0"	12.0"	12.0"	12.0"	11.3"	10.0"	9.3"	6.9"	6.7"	5.7"	5.6"
		60	12.0"	12.0"	12.0"	12.0"	11.6"	10.2"	9.1"	8.4"	6.4"	6.1"	5.2"	5.1"
1/4" ELCO PANELMATE INSERT, 1-1/2" EMBED	3.5" MIN EDGE DISTANCE													
	33	12.0"	12.0"	12.0"	12.0"	12.0"	10.1"	12.0"	8.1"	12.0"	5.7"	11.2"	4.7"	
	38	12.0"	12.0"	12.0"	11.7"	12.0"	9.0"	12.0"	7.3"	12.0"	5.2"	10.1"	4.3"	
	45	12.0"	12.0"	12.0"	10.3"	12.0"	7.9"	12.0"	6.4"	10.7"	4.6"	8.8"		
	53	12.0"	11.0"	12.0"	9.1"	12.0"	7.0"	12.0"	5.6"	9.4"	4.0"	7.8"		
60	12.0"	10.0"	12.0"	8.2"	12.0"	6.4"	11.9"	5.1"	8.5"		7.1"			

ANCHOR NOTES: SEE SHEET 3 FOR ANCHOR NOTES.

HOST STRUCT.	ANCHOR TYPE	LOAD (psf)	2.5" MIN EDGE DISTANCE											
			Spans Up To 3'-6"		Spans Up To 4'-6"		Spans Up To 5'-7"		Spans Up To 6'-6"		Spans Up To 8'-6"		Spans Up To 10'-0"	
			CONN TYPE C1	CONN TYPE C2	CONN TYPE C1	CONN TYPE C2	CONN TYPE C1	CONN TYPE C2	CONN TYPE C1	CONN TYPE C2	CONN TYPE C1	CONN TYPE C2	CONN TYPE C1	CONN TYPE C2
HOLLOW BLOCK	1/4" ELCO PANELMATE, MALE OR FEMALE, 1-1/4" EMBED	33	12.0"	10.1"	12.0"	8.3"	11.8"	6.4"	9.4"	5.2"	6.7"	3.7"	5.5"	3.0"
		38	12.0"	9.1"	12.0"	7.5"	10.6"	5.7"	8.5"	4.6"	6.0"	3.3"	4.9"	
		45	12.0"	7.9"	12.0"	6.5"	9.3"	5.0"	7.5"	4.1"	5.3"		4.4"	
		53	12.0"	7.0"	12.0"	5.7"	8.3"	4.4"	6.6"	3.6"	4.7"		3.9"	
		60	11.8"	6.3"	9.7"	5.2"	7.5"	4.0"	6.0"	3.3"	4.3"		3.5"	
	1/4" ITW TAPCON SG, 1-1/4" EMBED	33	12.0"	12.0"	12.0"	12.0"	12.0"	10.6"	11.1"	8.6"	7.8"	6.2"	6.4"	5.1"
		38	12.0"	12.0"	12.0"	12.0"	12.0"	9.5"	10.0"	7.7"	7.0"	5.5"	5.8"	4.6"
		45	12.0"	12.0"	12.0"	10.7"	11.2"	8.3"	8.9"	6.8"	6.2"	4.9"	5.1"	4.0"
		53	12.0"	11.5"	12.0"	9.4"	10.0"	7.3"	7.9"	5.9"	5.6"	4.3"	4.6"	3.5"
		60	12.0"	10.4"	12.0"	8.4"	9.1"	6.6"	7.3"	5.4"	5.1"	3.9"	4.2"	3.2"
	1/4" ITW SAMMYS SSC, 1-1/4" EMBED	33	12.0"	12.0"	12.0"	10.9"	12.0"	8.4"	12.0"	6.8"	9.2"	4.8"	7.6"	4.0"
		38	12.0"	11.9"	12.0"	9.8"	12.0"	7.6"	11.7"	6.1"	8.3"	4.3"	6.8"	3.6"
		45	12.0"	10.5"	12.0"	8.6"	12.0"	6.6"	10.3"	5.4"	7.3"	3.8"	6.0"	3.2"
		53	12.0"	9.2"	12.0"	7.6"	11.3"	5.8"	9.1"	4.7"	6.5"	3.4"	5.3"	
		60	12.0"	8.4"	12.0"	6.9"	10.3"	5.3"	8.3"	4.3"	5.9"	3.1"	4.9"	
	1/4" ALL POINTS SOLID-SET, 7/8" EMBED (3000 PSI CONC)	33	12.0"	12.0"	12.0"	10.5"	12.0"	8.1"	9.9"	6.6"	6.9"	4.7"	5.7"	3.9"
		38	12.0"	11.5"	12.0"	9.4"	11.2"	7.3"	8.9"	5.9"	6.3"	4.2"	5.2"	3.5"
		45	12.0"	10.1"	12.0"	8.2"	9.9"	6.4"	7.9"	5.2"	5.6"	3.7"	4.6"	3.1"
		53	12.0"	8.8"	11.5"	7.2"	8.8"	5.6"	7.0"	4.5"	5.0"	3.3"	4.1"	
		60	12.0"	8.0"	10.5"	6.5"	8.1"	5.1"	6.4"	4.1"	4.5"		3.7"	
1/4" ELCO PANELMATE INSERT, 1-1/4" EMBED	3.5" MIN EDGE DISTANCE													
	33	12.0"	12.0"	12.0"	12.0"	12.0"	9.7"	12.0"	7.8"	12.0"	5.6"	11.1"	4.6"	
	38	12.0"	12.0"	12.0"	11.4"	12.0"	8.7"	12.0"	7.0"	12.0"	5.0"	10.0"	4.1"	
	45	12.0"	12.0"	12.0"	10.0"	12.0"	7.7"	12.0"	6.2"	10.6"	4.4"	8.7"		
	53	12.0"	10.7"	12.0"	8.8"	12.0"	6.8"	12.0"	5.5"	9.3"		7.7"		
60	12.0"	9.7"	12.0"	8.0"	12.0"	6.2"	11.7"	5.0"	8.4"		7.0"			
5/16" ITW TAPCON XL, 1-3/4" EMBED	4" MIN EDGE DISTANCE													
	33	12.0"	10.1"	12.0"	8.4"	12.0"	6.4"	12.0"	5.2"	11.6"		9.6"		
	38	12.0"	9.1"	12.0"	7.5"	12.0"	5.8"	12.0"	4.6"	10.3"		8.6"		
	45	12.0"	8.0"	12.0"	6.6"	12.0"	5.1"	12.0"	4.1"	8.9"		7.4"		
	53	12.0"	7.1"	12.0"	5.8"	12.0"	4.5"	10.6"		7.8"		6.5"		
60	12.0"	6.4"	12.0"	5.3"	11.5"	4.1"	9.5"		7.0"		5.8"			

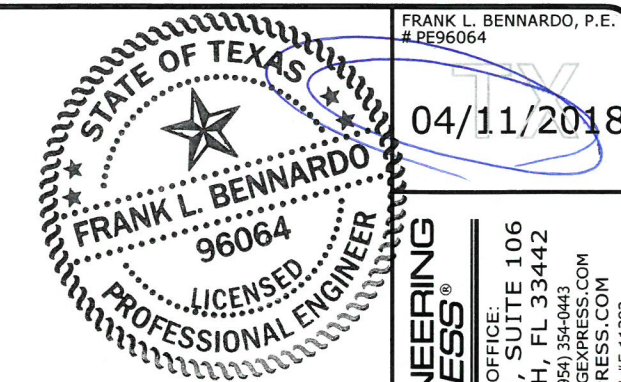

ENGINEERING EXPRESS
 CORPORATE OFFICE:
 160 SW 12th AVE, SUITE 106
 DEERFIELD BEACH, FL 33442
 P: (954) 354-0660 F: (954) 354-0443
 E: HELLO@ENGINEERINGEXPRESS.COM
 CERT OF AUTH #F-11383

Town & Country INDUSTRIES
 Wholesale Aluminum and Building Products
 A Division of ABC Supply Co., Inc.
 400 WEST MCNAB ROAD
 FT. LAUDERDALE, FL 33309

REMARKS	DRWN	CHKD	DATE
INIT ISSUE	KL	FLB	04/25/14
REVISE ANCHOR TABLES	CSL	TSB	12/30/14
REV 2014 FBC	ZAR	CSL	02/16/15
REV - NEW FABRIC	RWN	FLB	08/03/17
REV (TDI)	RWN	FLB	4/10/18

THIS DOCUMENT IS THE PROPERTY OF FRANK L. BENNARDO, P.E. AND SHALL NOT BE REPRODUCED OR TRANSMITTED IN ANY FORM OR BY ANY MEANS, ELECTRONIC OR MECHANICAL, INCLUDING PHOTOCOPYING, RECORDING, OR BY ANY INFORMATION STORAGE AND RETRIEVAL SYSTEM. ANY UNAUTHORIZED REPRODUCTION OR TRANSMISSION OF THIS DOCUMENT IS STRICTLY PROHIBITED AND WILL BE PROSECUTED TO THE FULL EXTENT OF THE LAW.

COPYRIGHT FRANK L. BENNARDO P.E.

14-1634
 SCALE: -
 PAGE DESCRIPTION:
 4

ANCHOR SCHEDULES (CONT.):

HOST STRUCT.	ANCHOR TYPE	LOAD (psf)	3/4" MIN EDGE DISTANCE												
			Spans Up To 3'-6"		Spans Up To 4'-6"		Spans Up To 5'-7"		Spans Up To 6'-6"		Spans Up To 8'-6"		Spans Up To 10'-0"		
			CONN TYPE		CONN TYPE		CONN TYPE		CONN TYPE		CONN TYPE		CONN TYPE		
			C1	C2	C1	C2	C1	C2	C1	C2	C1	C2	C1	C2	
WOOD (G=0.42)	1/4" HANGAR BOLT, 2" EMBED	33	12.0"	12.0"	12.0"	12.0"	9.5"	11.7"	7.4"	9.7"	5.2"	7.1"	4.2"	5.9"	
		38	12.0"	12.0"	11.4"	12.0"	8.6"	10.3"	6.8"	8.6"	4.7"	6.3"	3.8"	5.2"	
		45	12.0"	12.0"	10.1"	11.3"	7.7"	8.9"	6.0"	7.4"	4.2"	5.4"	3.4"	4.5"	
		53	10.7"	12.0"	9.1"	9.8"	6.9"	7.7"	5.4"	6.4"	3.8"	4.7"	3.1"	3.9"	
		60	9.9"	11.0"	8.3"	8.8"	6.3"	6.9"	5.0"	5.8"	3.4"	4.2"	2.8"	3.5"	
	1/4" ELCO PANELMATE, MALE OR FEMALE, 1-7/8" EMBED	33	12.0"	12.0"	11.8"	12.0"	8.9"	11.0"	7.0"	9.1"	4.9"	6.7"	4.0"	5.6"	
		38	12.0"	12.0"	10.7"	12.0"	8.1"	9.7"	6.4"	8.1"	4.4"	5.9"	3.6"	4.9"	
		45	11.3"	12.0"	9.6"	10.7"	7.2"	8.4"	5.7"	7.0"	4.0"	5.1"	3.2"	4.3"	
		53	10.2"	11.5"	8.6"	9.2"	6.5"	7.3"	5.1"	6.0"	3.5"	4.4"	2.9"	3.7"	
		60	9.3"	10.3"	7.9"	8.2"	5.9"	6.5"	4.7"	5.4"	3.3"	4.0"	2.7"	3.3"	
	1/4" ITW SAMMY SSC OR TAPCON SG, 1-3/4" EMBED	33	12.0"	12.0"	11.7"	11.2"	8.9"	8.7"	7.0"	7.1"	4.9"	5.2"	4.0"	4.3"	
		38	12.0"	12.0"	10.6"	10.0"	8.0"	7.8"	6.3"	6.4"	4.4"	4.6"	3.6"	3.8"	
		45	11.2"	10.7"	9.4"	8.6"	7.2"	6.7"	5.6"	5.5"	3.9"	4.0"	3.2"	3.3"	
		53	10.0"	9.3"	8.4"	7.5"	6.4"	5.9"	5.0"	4.8"	3.5"	3.5"	2.9"	2.9"	
		60	9.2"	8.4"	7.7"	6.8"	5.9"	5.3"	4.6"	4.4"	3.2"	3.2"	2.6"	2.6"	
	1" MIN EDGE DISTANCE														
	5/16" HANGAR BOLT, 2" EMBED	33	12.0"	12.0"	12.0"	12.0"	12.0"	12.0"	9.9"	12.0"	6.8"	10.9"	5.6"	9.1"	
		38	12.0"	12.0"	12.0"	12.0"	11.4"	12.0"	9.0"	12.0"	6.2"	9.6"	5.1"	8.0"	
		45	12.0"	12.0"	12.0"	12.0"	10.2"	12.0"	8.0"	11.1"	5.5"	8.3"	4.5"	6.9"	
		53	12.0"	12.0"	12.0"	12.0"	9.1"	11.5"	7.2"	9.6"	5.0"	7.1"	4.1"	6.0"	
60		12.0"	12.0"	11.1"	12.0"	8.4"	10.2"	6.6"	8.6"	4.6"	6.4"	3.7"	5.4"		

ANCHOR NOTES: SEE SHEET 3 FOR ANCHOR NOTES.

HOST STRUCT.	ANCHOR TYPE	LOAD (psf)	1.5" MIN EDGE DISTANCE											
			Spans Up To 3'-6"		Spans Up To 4'-6"		Spans Up To 5'-7"		Spans Up To 6'-6"		Spans Up To 8'-6"		Spans Up To 10'-0"	
			CONN TYPE		CONN TYPE		CONN TYPE		CONN TYPE		CONN TYPE		CONN TYPE	
			C1	C2	C1	C2	C1	C2	C1	C2	C1	C2	C1	C2
WOOD (G=0.42)	1/4" HANGAR BOLT, 2" THREAD PENETRATION	33	12.0"	12.0"	12.0"	12.0"	12.0"	12.0"	9.8"	10.8"	6.8"	7.9"	5.6"	6.5"
		38	12.0"	12.0"	12.0"	12.0"	11.3"	11.7"	8.9"	9.6"	6.2"	7.0"	5.1"	5.8"
		45	12.0"	12.0"	12.0"	12.0"	10.1"	10.2"	7.9"	8.4"	5.5"	6.1"	4.5"	5.1"
		53	12.0"	12.0"	11.9"	11.3"	9.0"	8.8"	7.1"	7.3"	4.9"	5.3"	4.0"	4.4"
		60	12.0"	12.0"	10.9"	10.1"	8.3"	7.9"	6.5"	6.6"	4.5"	4.8"	3.7"	4.0"
	1/4" ELCO PANELMATE, MALE OR FEMALE, 1-7/8" THREAD PENETRATION	33	12.0"	12.0"	12.0"	12.0"	10.5"	11.9"	8.3"	9.8"	5.8"	7.1"	4.7"	5.9"
		38	12.0"	12.0"	12.0"	12.0"	9.6"	10.5"	7.5"	8.7"	5.2"	6.3"	4.3"	5.3"
		45	12.0"	12.0"	11.3"	11.6"	8.5"	9.1"	6.7"	7.5"	4.7"	5.5"	3.8"	4.6"
		53	12.0"	12.0"	10.1"	10.1"	7.6"	7.9"	6.0"	6.5"	4.2"	4.8"	3.4"	4.0"
		60	11.0"	11.2"	9.2"	9.0"	7.0"	7.1"	5.5"	5.9"	3.8"	4.3"	3.1"	3.6"
	1/4" ITW SAMMY SSC OR TAPCON SG, 1-3/4" THREAD PENETRATION	33	12.0"	12.0"	12.0"	12.0"	11.5"	9.4"	9.1"	7.7"	6.4"	5.5"	5.2"	4.6"
		38	12.0"	12.0"	12.0"	10.8"	10.5"	8.4"	8.3"	6.9"	5.8"	4.9"	4.7"	4.1"
		45	12.0"	11.6"	12.0"	9.4"	9.3"	7.3"	7.4"	6.0"	5.1"	4.3"	4.2"	3.6"
		53	12.0"	10.1"	10.9"	8.3"	8.3"	6.4"	6.6"	5.2"	4.6"	3.8"	3.8"	3.1"
		60	11.9"	9.2"	9.9"	7.4"	7.6"	5.8"	6.0"	4.7"	4.2"	3.4"	3.5"	2.8"
	5/16" HANGAR BOLT, 3" THREAD PENETRATION	33	12.0"	12.0"	12.0"	12.0"	12.0"	12.0"	12.0"	12.0"	8.5"	12.0"	7.0"	10.1"
		38	12.0"	12.0"	12.0"	12.0"	12.0"	12.0"	11.1"	12.0"	7.7"	10.8"	6.3"	9.0"
		45	12.0"	12.0"	12.0"	12.0"	12.0"	12.0"	9.9"	12.0"	6.9"	9.3"	5.7"	7.8"
		53	12.0"	12.0"	12.0"	12.0"	11.3"	12.0"	8.9"	10.9"	6.2"	8.1"	5.1"	6.8"
		60	12.0"	12.0"	12.0"	12.0"	10.4"	11.7"	8.2"	9.8"	5.7"	7.2"	4.7"	6.1"

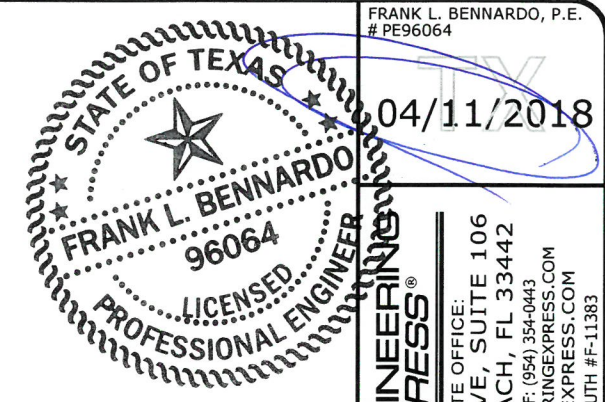

ENGINEERING EXPRESS
 CORPORATE OFFICE:
 160 SW 12th AVE, SUITE 106
 DEERFIELD BEACH, FL 33442
 P: (954) 354-0660 F: (954) 354-0443
 E: HELLO@ENGINEERINGEXPRESS.COM
 ENGINEERINGEXPRESS.COM
 CERT OF AUTH #F-11383

Town & Country INDUSTRIES
 Wholesale Aluminum and Building Products
 A Division of ABC Supply Co., Inc.
 400 WEST MCNAB ROAD
 FT. LAUDERDALE, FL 33309

REMARKS	DRWN	CHKD	DATE
INIT ISSUE	KL	FLB	04/25/14
REVISE ANCHOR TABLES	CSL	TSB	12/30/14
REV 2014 FBC	ZAR	CSL	02/16/15
Rev - NEW FABRIC	RWN	FLB	06/03/17
REV (TDJ)	RWN	FLB	4/10/18

THIS DOCUMENT IS THE PROPERTY OF FRANK L. BENNARDO, P.E. AND SHALL NOT BE REPRODUCED, COPIED, OR TRANSMITTED IN ANY FORM OR BY ANY MEANS, WITHOUT THE WRITTEN PERMISSION OF FRANK L. BENNARDO, P.E. ALTERATIONS, ADDITIONS, HIGHLIGHTS, OR OTHER MARKINGS TO THIS DOCUMENT ARE NOT PERMITTED AND INVALIDATE OUR CERTIFICATION.

COPYRIGHT FRANK L. BENNARDO P.E.

14-1634
 SCALE: -
 PAGE DESCRIPTION:
 5