

**GENERAL NOTES:**

1. THE BRICKHOUSE BI FOLD LOW PROFILE COLONIAL SHUTTER WAS TESTED IN ACCORDANCE WITH ASTM E 1886-13, E 1996-14 AND E 330-14 STANDARDS.
2. THE BRICKHOUSE BI FOLD LOW PROFILE COLONIAL SHUTTER MEETS THE 2018 INTERNATIONAL BUILDING CODE AND 2018 INTERNATIONAL RESIDENTIAL CODE.
3. MAXIMUM OVERALL DIMENSIONS: 81' WIDE X 99 1/2' HIGH
4. THE MAXIMUM DESIGN PRESSURE RATING = +/- 600 PSF.
5. THE SHUTTER ASSEMBLY QUALITIES FOR LARGE MISSILE IMPACT LEVEL D AND SMALL MISSILE IMPACT PER ASTM E 1996-14.
6. ALL ALUMINUM EXTRUSIONS SHALL BE ALUMINUM ASSOCIATION 6063-T5 OR 6063-T6 ALLOY AND TEMPER. THE THICKNESS OF THE EXTRUSIONS SHALL BE AS NOTED ON THE DRAWINGS WITH STANDARD TOLERANCES IN ACCORDANCE WITH THE 'ALUMINUM DESIGN MANUAL 2015'.
7. ALL FASTENERS SHALL BE CORROSION RESISTANT AS SPECIFIED IN THE INTERNATIONAL RESIDENTIAL CODE (IRC) AND THE INTERNATIONAL BUILDING CODE (IBC).
8. ANCHORS TO WALL SHALL BE AS FOLLOWS:  
 - TO EXISTING WOOD FRAMING, SOUTHERN YELLOW PINE NO. 2, G=0.55  
 \*(2) 1/2"x4" TIMBERLOK HEAVY DUTY WOOD SCREWS MANUFACTURED BY FASTENMASTER  
 \*MINIMUM 2" THREADED PENETRATION INTO WOOD  
 \*IN CASE THE WALL HAS SIDING PANELS ON THE EXTERIOR, THE ANCHOR MUST BE LONG ENOUGH TO REACH THE MAIN BUILDING WOOD STRUCTURE.  
 \*ANCHORS SHALL BE INSTALLED PER MANUFACTURER'S RECOMMENDATIONS AND SPECIFICATIONS.
9. IT SHALL BE THE RESPONSIBILITY OF THE CONTRACTOR TO VERIFY THE SOUNDNESS OF THE STRUCTURE WHERE THE SHUTTER IS TO BE ATTACHED TO INSURE PROPER ANCHORAGE. THIS SHUTTER SHALL ONLY BE ATTACHED TO WOOD FRAMING BUILDINGS.
10. EACH SHUTTER SHALL HAVE A LEGIBLE AND READILY VISIBLE MARKING INSTRUCTING THE BUILDING OWNER OR TENANT TO SECURE THE SHUTTER WITH STORM BARS AND COMPONENTS DURING PERIODS OF HURRICANE WARNINGS.
11. THE BUILDING OWNER OR TENANT IS RESPONSIBLE FOR SECURING THE SHUTTER WITH STORM BARS AND COMPONENTS DURING PERIODS OF HURRICANE WARNINGS.

12. THE INSTALLATION CONTRACTOR IS TO SEAL/CAULK AROUND ALL SHUTTER COMPONENTS IN CONTINUOUS CONTACT WITH BUILDING EXTERIOR TO PREVENT WIND/RAIN INTRUSION.
13. THE SHUTTER SHALL COMPLY WITH ALL SPECIFICATIONS INDICATED IN THIS DRAWING AND ANY BUILDING AND ZONING REGULATIONS PROVIDED BY THE JURISDICTION WHERE PERMIT IS APPLIED.
14. THIS PRODUCT EVALUATION DOCUMENT WILL BE CONSIDERED INVALID IF ALTERED BY ANY MEANS.
15. SHUTTER MUST HAVE A MINIMUM SEPERATION FROM GLASS OF 3'.



FORCE ENGINEERING AND TESTING  
 STATE OF TEXAS  
 REGISTRATION NO. F-21280

PROJECT	BRICKHOUSE BI FOLD LOW PROFILE COLONIAL SHUTTER
DATE	
BY	
DATE	
NO. OF SETS	1 OF 4



Eastern Metal Supply, Inc.  
 9400 Telge Road  
 Houston, TX 77095  
 800-996-6061

DATE ORDER	12-22-20
CHECKED BY	BU
DATE REVISION	10-16-22
APPROVED BY	BU
NO. OF SHEETS	
SHEET NO.	

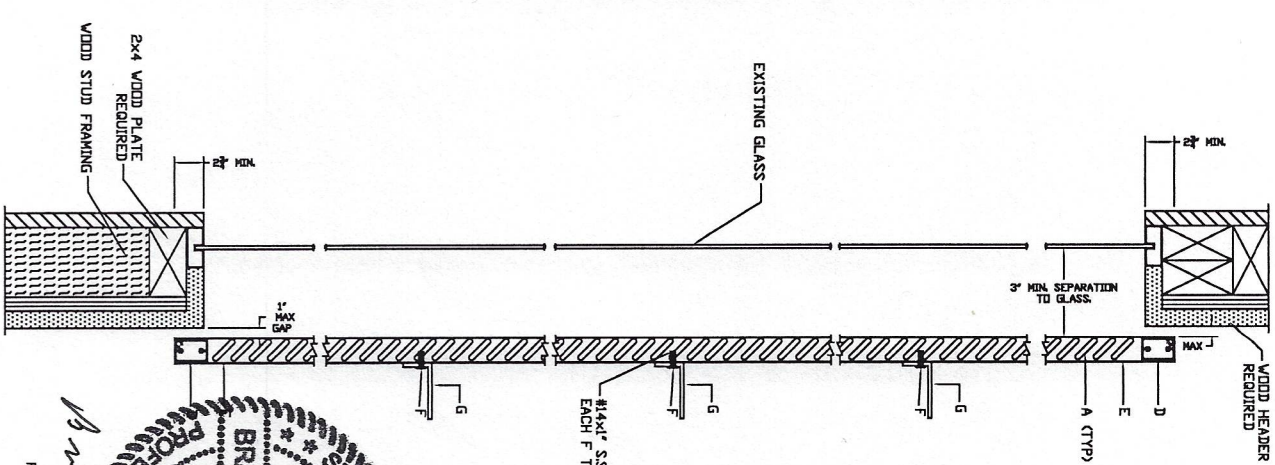
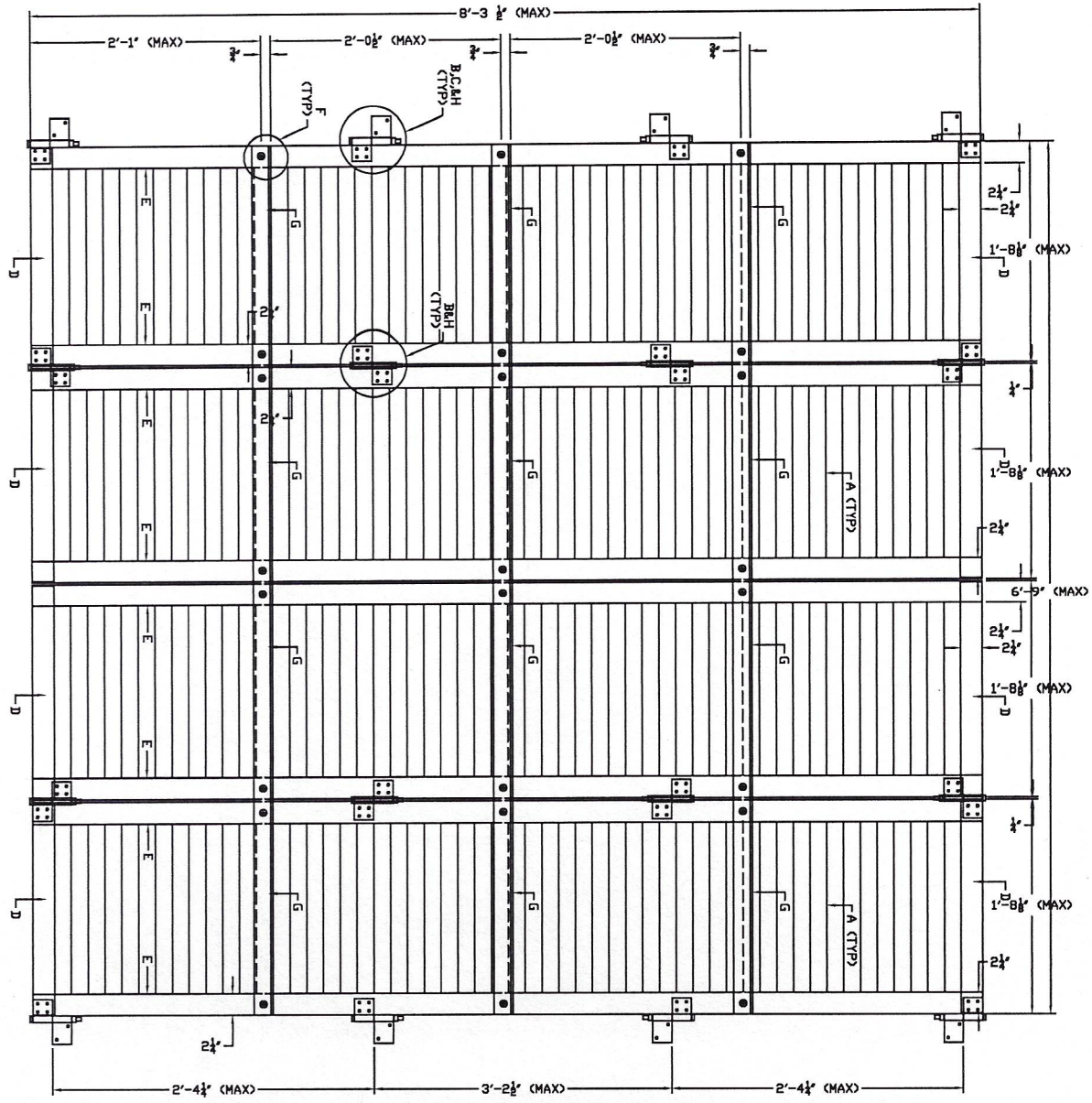

FORCE ENGINEERING AND TESTING  
 STATE OF TEXAS  
 REGISTRATION NO. F-21280  
 10/18/22



**Eastern Metal Supply, Inc.**  
 9400 Telge Road  
 Houston, TX 77095  
 800-996-6061

DESIGNED BY	BJ	DATE DESIGNED	12-22-20
CHECKED BY	BJ	DATE CHECKED	10-18-22
APPROVED BY	BJ		
SCALE	AS SHOWN		

PROJECT	BRICKHOUSE 31 FOLD LOW PROFILE COLONIAL SHUTTER
DATE	10/18/22
NO.	2 OF 4

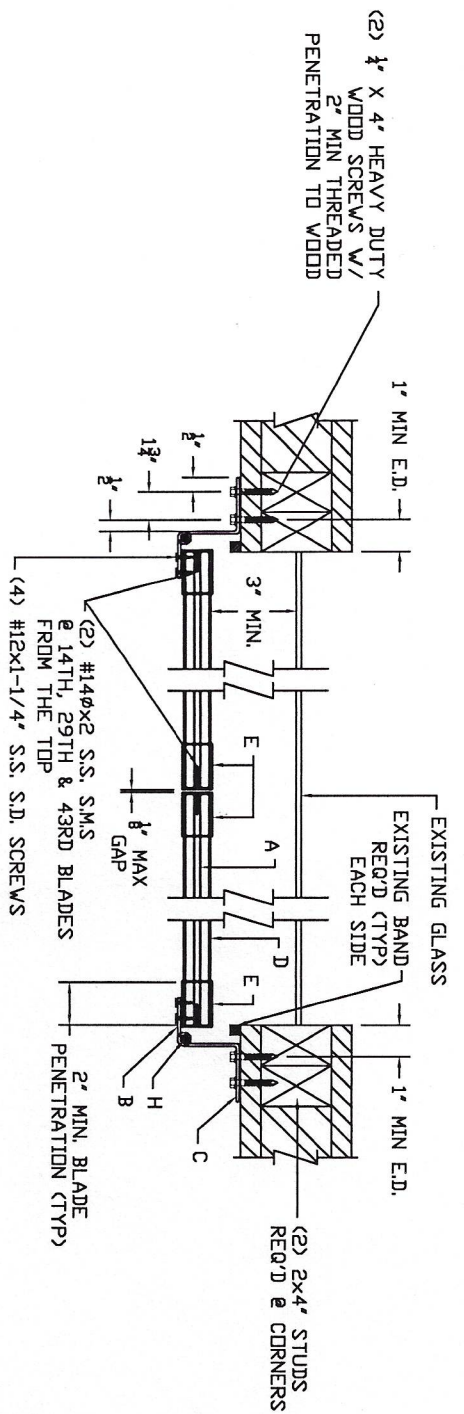

HURRICANE POSITION

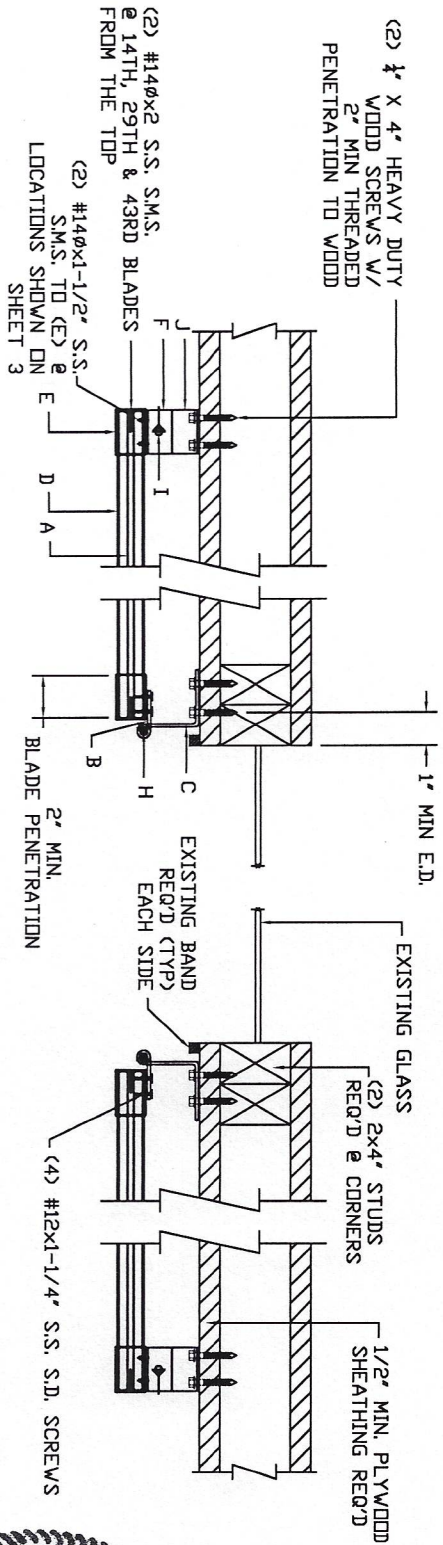

NON-HURRICANE POSITION

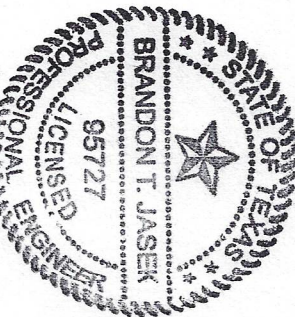

BRANDON T. JASEK  
 10/17/2011  
 FORCE ENGINEERING AND TESTING  
 STATE OF TEXAS  
 REGISTRATION NO. F-21280

PROJECT:	BRICKHOUSE BI FOLD LOW PROFILE COLONIAL SHUTTER	DATE CHECKED:	12-22-20
DATE DESIGNED:		DATE REVISION:	10-18-22
DRAWN BY:	BJ	APPROVED BY:	BJ
CHECKED BY:	BJ	SCALE:	
DATE:		WARS:	



Eastern Metal Supply, Inc.  
 9400 Telge Road  
 Houston, TX 77095  
 800-996-6061

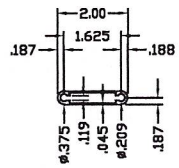

(A) LOUVER BLADE  
6063-T6 ALUM. ALLOY

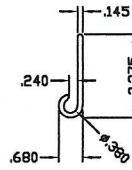

(B) FLAT HINGE, 2" LONG  
6063-T5 ALUM. ALLOY

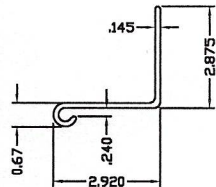

(C) DOUBLE HINGE, 2" LONG  
6063-T5 ALUM. ALLOY

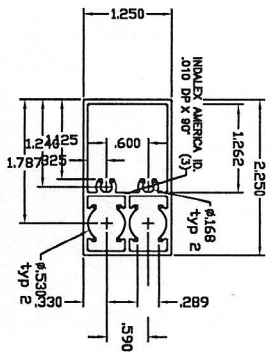

(D) TOP & BOTTOM RAIL  
6063-T6 ALUM. ALLOY

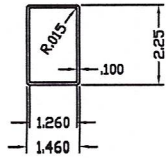

(E) JAMB  
6063-T6 ALUM. ALLOY

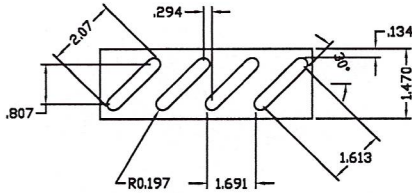

(G) STORM BAR  
6063-T5 ALUM. ALLOY

# SHUTTER COMPONENTS



(F) 1/4-20x1" SS SIDEWALK BOLT  
1/4-20x3/4" ALUM. RIVET NUT

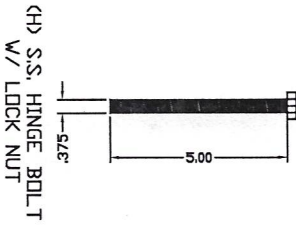
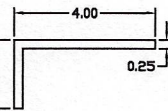

(H) S.S. HINGE BOLT  
W/ LOCK NUT

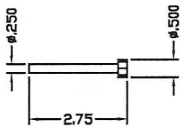

(I) S.S. H.V. SAFETY PEN  
W/ 2 S.S. WIRE SNAP

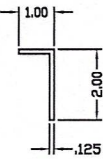

(J) NON-HURRICANE BRACKET ANGLE  
6063-T6 ALUM. ALLOY



10/18/2012  
BRANDON T. JASEK  
95727  
PROFESSIONAL ENGINEER  
STATE OF TEXAS  
FORCE ENGINEERING AND TESTING  
STATE OF TEXAS  
REGISTRATION NO. F-21280

PROJECT:	BRICKHOUSE BI FOLD LOW PROFILE COLONIAL SHUTTER
DATE:	
BY:	
TX:	
NO. OF SETS:	4 OF 4



Eastern Metal Supply, Inc.  
9400 Telge Road  
Houston, TX 77095  
800-996-6061

DESIGN BY:	BJ	DATE DRAWN:	12-22-20
CHECKED BY:	BJ	DATE REVISION:	10-10-22
APPROVED BY:	BJ		
SCALE:	AS SHOWN		
WARES:			