

YKK AP AMERICA, INC.

YHS 50 TU ALUMINUM STOREFRONT SYSTEM - OUTSIDE GLAZED (IMPACT)

INSTALLATION NOTES:

- SEE SHEET 10 FOR ANCHOR TYPE REQUIREMENTS, MINIMUM EMBEDMENTS, AND MINIMUM EDGE DISTANCES. ALL ANCHOR REQUIREMENTS MUST BE ADHERED TO. ANY DEVIATIONS FROM ANCHOR REQUIREMENTS REQUIRES SEPARATE EVALUATION AND APPROVAL.
- ONE (1) INSTALLATION ANCHOR IS REQUIRED AT EACH ANCHOR LOCATION SHOWN.
- THE NUMBER OF INSTALLATION ANCHORS DEPICTED IS THE MINIMUM NUMBER OF ANCHORS TO BE USED FOR PRODUCT INSTALLATION.
- INSTALL INDIVIDUAL INSTALLATION ANCHORS WITHIN A TOLERANCE OF ±1/2 INCH OF THE DEPICTED LOCATION IN THE ANCHOR LAYOUT DETAIL (I.E., WITHOUT CONSIDERATION OF TOLERANCES). TOLERANCES ARE NOT CUMULATIVE FROM ONE INSTALLATION ANCHOR TO THE NEXT.
- SHIM AS REQUIRED AT EACH INSTALLATION ANCHOR WITH LOAD BEARING SHIM(S). MAXIMUM ALLOWABLE SHIM STACK TO BE 3/8 INCH. SHIM WHERE SPACE OF 1/16 INCH OR GREATER OCCURS. SHIM(S) SHALL BE CONSTRUCTED OF HIGH DENSITY PLASTIC OR BETTER.
- MINIMUM EMBEDMENT AND EDGE DISTANCE EXCLUDE WALL FINISHES, INCLUDING BUT NOT LIMITED TO STUCCO, FOAM, BRICK VENEER, AND SIDING.
- INSTALLATION ANCHORS AND ASSOCIATED HARDWARE MUST BE MADE OF CORROSION RESISTANT MATERIAL OR HAVE A CORROSION RESISTANT COATING.
- FOR HOLLOW BLOCK AND GROUT FILLED BLOCK, DO NOT INSTALL INSTALLATION ANCHORS INTO MORTAR JOINTS. EDGE DISTANCE IS MEASURED FROM FREE EDGE OF BLOCK OR EDGE OF MORTAR JOINT INTO FACE SHELL OF BLOCK.
- INSTALLATION ANCHORS SHALL BE INSTALLED IN ACCORDANCE WITH ANCHOR MANUFACTURER'S INSTALLATION INSTRUCTIONS, AND ANCHORS SHALL NOT BE USED IN SUBSTRATES WITH STRENGTHS LESS THAN THE MINIMUM STRENGTH SPECIFIED BY THE ANCHOR MANUFACTURER.
- INSTALLATION ANCHOR CAPACITIES FOR PRODUCTS HEREIN ARE BASED ON SUBSTRATE MATERIALS WITH THE FOLLOWING PROPERTIES:
 - WOOD - MINIMUM SPECIFIC GRAVITY OF 0.42.
 - CONCRETE - MINIMUM COMPRESSIVE STRENGTH OF 3000 PSI.
 - MASONRY - CMU UNIT STRENGTH CONFORMS TO ASTM C-90, WITH MIN. COMPRESSIVE STRENGTH OF 2000 PSI AND GROUT CONFORMS TO ASTM C 476, MIN. GROUT COMPRESSIVE STRENGTH OF 2000 PSI.
 - STEEL - MINIMUM YIELD STRENGTH OF 36 KSI. MINIMUM 12 GA. WALL THICKNESS.
 - STEEL - MINIMUM YIELD STRENGTH OF 36 KSI. MINIMUM 18 GA. WALL THICKNESS WITH 2X WOOD BACKING.
 - ALUMINUM - MINIMUM 1/8 INCH THICK 6063-T5 ALUMINUM.

GENERAL NOTES:

- THE PRODUCT SHOWN HEREIN IS DESIGNED AND MANUFACTURED TO COMPLY WITH 2018 INTERNATIONAL BUILDING CODE (IBC) AND 2018 INTERNATIONAL RESIDENTIAL CODE (IRC), AND HAS BEEN EVALUATED ACCORDING TO THE FOLLOWING:
 - ASTM E283-04(12)
 - ASTM E330-14
 - ASTM E331-00(09)
 - ASTM E1886-13a
 - ASTM E1996-14a
 - TAS 201-94
 - TAS 202-94
 - TAS 203-94
- ADEQUACY OF THE EXISTING STRUCTURAL CONCRETE/MASONRY, 2X FRAMING AND METAL STUD FRAMING AS A MAIN WIND FORCE RESISTING SYSTEM CAPABLE OF WITHSTANDING AND TRANSFERRING APPLIED PRODUCT LOADS TO THE FOUNDATION IS THE RESPONSIBILITY OF THE ENGINEER OR ARCHITECT OF RECORD FOR THE PROJECT OF INSTALLATION.
- 1X AND 2X BUCKS (WHEN USED) SHALL BE DESIGNED AND ANCHORED TO PROPERLY TRANSFER ALL LOADS TO THE STRUCTURE. BUCK DESIGN AND INSTALLATION IS THE RESPONSIBILITY OF THE ENGINEER OR ARCHITECT OF RECORD FOR THE PROJECT OF INSTALLATION.
- THE INSTALLATION DETAILS DESCRIBED HEREIN ARE GENERIC AND MAY NOT REFLECT ACTUAL CONDITIONS FOR A SPECIFIC SITE. IF SITE CONDITIONS CAUSE INSTALLATION TO DEVIATE FROM THE REQUIREMENTS DETAILED HEREIN, A LICENSED ENGINEER OR ARCHITECT SHALL PREPARE SITE SPECIFIC DOCUMENTS FOR USE WITH THIS DOCUMENT.
- APPROVED IMPACT PROTECTIVE SYSTEM **IS NOT REQUIRED** ON THIS PRODUCT IN AREAS REQUIRING IMPACT RESISTANCE IN WIND ZONE 3 OR LESS. SEE SHEETS 3 & 4 FOR LMI AND SMI GLASS TYPES.
- STOREFRONT FRAME MATERIAL: ALUMINUM 6063-T5
- ALL STRUCTURAL MATERIALS & DISSIMILAR METALS SHALL BE PROTECTED, TREATED, PAINTED, COATED, AND/OR ISOLATED AS REQUIRED IN THE APPLICABLE SECTIONS OF THE 2018 INTERNATIONAL BUILDING CODE AND REFERENCED DESIGN SPECIFICATIONS.
- GLASS MEETS THE REQUIREMENTS OF ASTM E1300 GLASS CHARTS. SEE SHEETS 3 & 4 FOR GLAZING DETAILS.

TABLE OF CONTENTS	
SHEET	SHEET DESCRIPTION
1	INSTALLATION & GENERAL NOTES
2	ELEVATION & ANCHOR LAYOUT
3	DRY GLAZING DETAILS
4	WET GLAZING DETAILS
5	MULLION TABLES
6	TYPE A & B ANCHOR TABLES
7	TYPE C, D & E ANCHOR TABLES
8	DOOR MULLION TABLE (1)
9	DOOR MULLION TABLE (2)
10	VERTICAL SECTIONS & ANCHOR DESCRIPTIONS
11	HORIZONTAL SECTIONS
12	COMPONENTS & BILL OF MATERIALS

INSTRUCTIONS FOR USE:

- DETERMINE DESIGN WIND LOAD REQUIREMENTS BASED ON WIND VELOCITY, BLDG, HEIGHT, WIND ZONE USING APPLICABLE ASCE 7 STANDARD.
- SEE CHARTS ON SHEETS 3 & 4 FOR DESIGN LOAD CAPACITY OF DESIRED GLASS SIZE.
- CHECK MULLION CAPACITY FOR A GIVEN SPACING AND HEIGHT USING CHARTS ON SHEET 5 FOR STORE FRONT MULLION AND SHEETS 8 & 9 FOR DOOR MULLION, THE CAPACITY SHOULD EXCEED THE DESIGN LOAD.
- USING CHART ON SHEET 6 & 7 SELECT ANCHOR OPTION WITH DESIGN RATING MORE THAN DESIGN LOAD SPECIFIED IN STEP 1 ABOVE.
- THE LOWEST VALUE RESULTING FROM STEP 2, 3 AND 4 SHALL APPLY TO ENTIRE SYSTEM.



YKK AP AMERICA, INC.
1229 HWY 441 BYPASS
DUBLIN, GEORGIA 31021
PH: (478)277-1955 FAX: (678)838-6001

TITLE:
YHS 50 TU ALUMINUM STOREFRONT
SYSTEM - OUTSIDE GLAZED
(IMPACT)

INSTALLATION & GENERAL NOTES

PREPARED BY:
BUILDING DROPS, INC.
398 E. DANIA BEACH BLVD., STE. 338
DANIA BEACH, FL 33004
PH: (954)399-8478
FAX: (954)744-4738
WEB: www.buildingdrops.com



REMARKS	BY	DATE

THE INSTALLATION DETAILS DESCRIBED HEREIN ARE GENERIC AND MAY NOT REFLECT ACTUAL CONDITIONS FOR A SPECIFIC SITE. IF SITE CONDITIONS CAUSE INSTALLATION TO DEVIATE FROM THE REQUIREMENTS DETAILED HEREIN, A LICENSED ENGINEER OR ARCHITECT SHALL PREPARE SITE SPECIFIC DOCUMENTS FOR USE WITH THIS DOCUMENT.

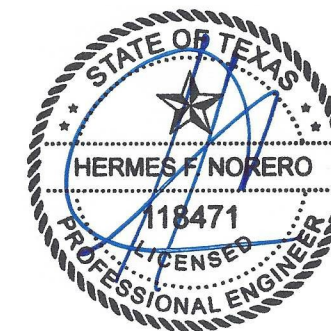

HERMES F. NORERO, P.E.
TEXAS P.E. No 118471
BUILDING DROPS, INC
398 E. DANIA BEACH BLVD. # 338
DANIA BEACH, FL 33004
TBPE FIRM No. 13734

DATE: 09.20.21

DWG. BY: MS

CHK. BY: HFN

SCALE: NTS

DWG. #: YKK281

SHEET:

1

OF 12

TITLE: YHS 50 TU ALUMINUM STOREFRONT SYSTEM - OUTSIDE GLAZED (IMPACT)

ELEVATION & ANCHOR LAYOUT

PREPARED BY: **BUILDING DROPS, INC.**
 398 E. DANIA BEACH BLVD., STE. 338
 DANIA BEACH, FL 33004
 PH: (954)399-8478
 FAX: (954)744-4738
 WEB: www.buildingdrops.com



REMARKS	BY	DATE

THE INSTALLATION DETAILS DESCRIBED HEREIN ARE GENERIC AND MAY NOT REFLECT ACTUAL CONDITIONS FOR A SPECIFIC SITE. IF SITE CONDITIONS CAUSE INSTALLATION TO DEVIATE FROM THE REQUIREMENTS DETAILED HEREIN, A LICENSED ENGINEER OR ARCHITECT SHALL PREPARE SITE SPECIFIC DOCUMENTS FOR USE WITH THIS DOCUMENT.

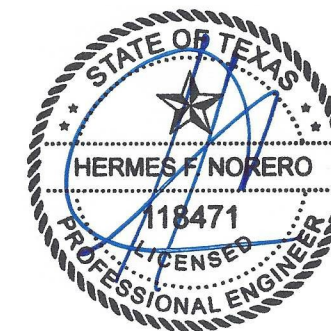

HERMES F. NORERO, P.E.
 TEXAS P.E. No. 118471
 BUILDING DROPS, INC.
 398 E. DANIA BEACH BLVD. # 338
 DANIA BEACH, FL 33004
 TBPE FIRM No. 13734

DATE: **09.20.21**

DWG. BY: **MS**

CHK. BY: **HFN**

SCALE: **NTS**

DWG. #: **YKK281**

SHEET: **2**

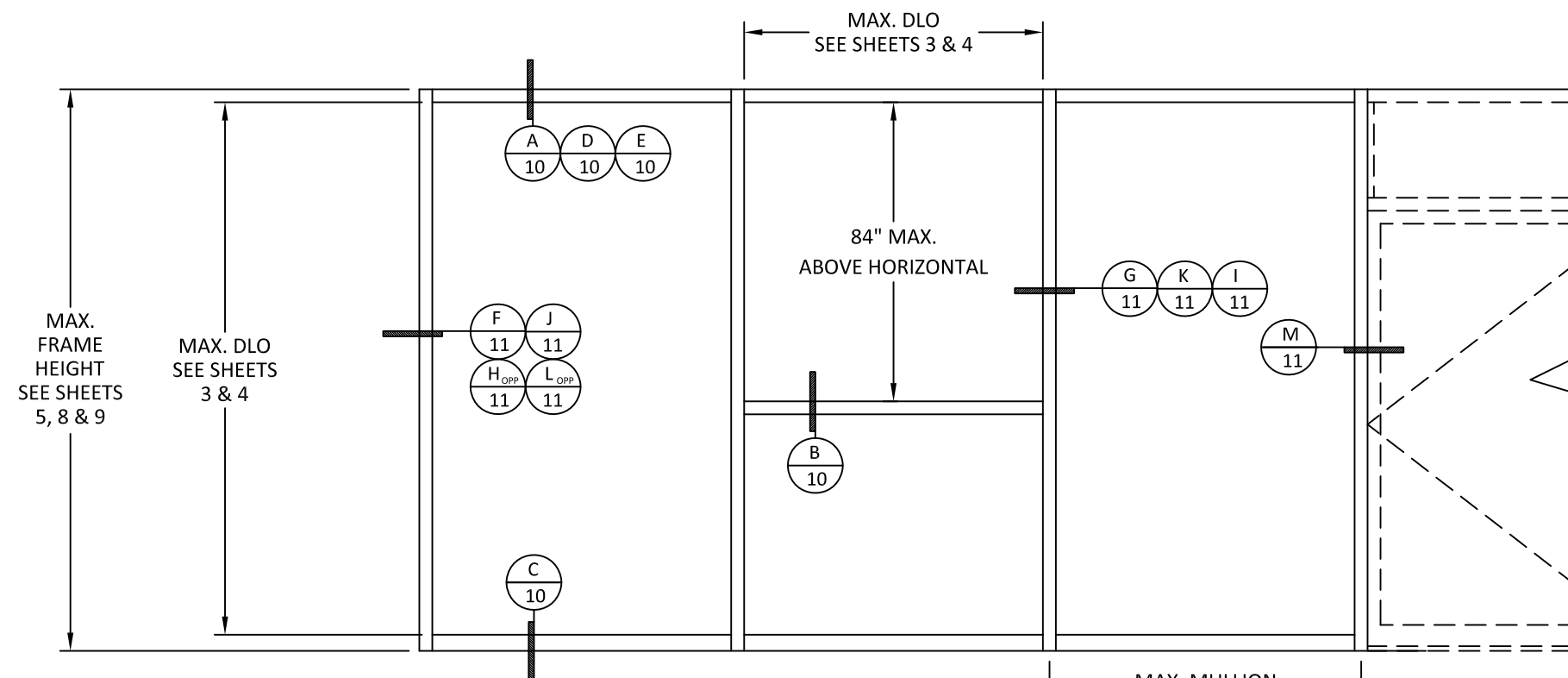

ELEVATION
TYPICAL YHS 50 TU STOREFRONT

MAX. MULLION SPACING
 SEE SHEET 5

SEE SEPARATE DOOR APPROVAL FOR DOOR RATING & DETAILS.
 LOWER DESIGN PRESSURE FROM STOREFRONT OR DOOR APPROVAL WILL APPLY TO ENTIRE SYSTEM.

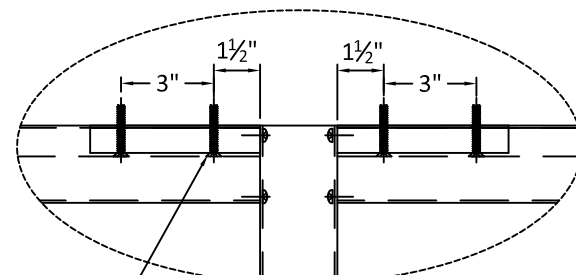

ANCHORS, TYPE A, B, C, D OR E
 SEE SHEETS 6 & 7 FOR QUANTITIES AND SHEET 10 FOR DESCRIPTION

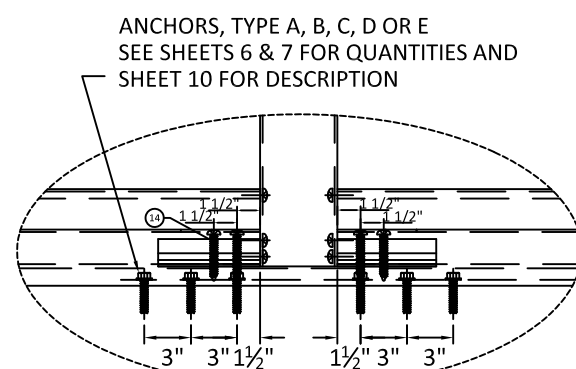

ANCHORS, TYPE A, B, C, D OR E
 SEE SHEETS 6 & 7 FOR QUANTITIES AND SHEET 10 FOR DESCRIPTION

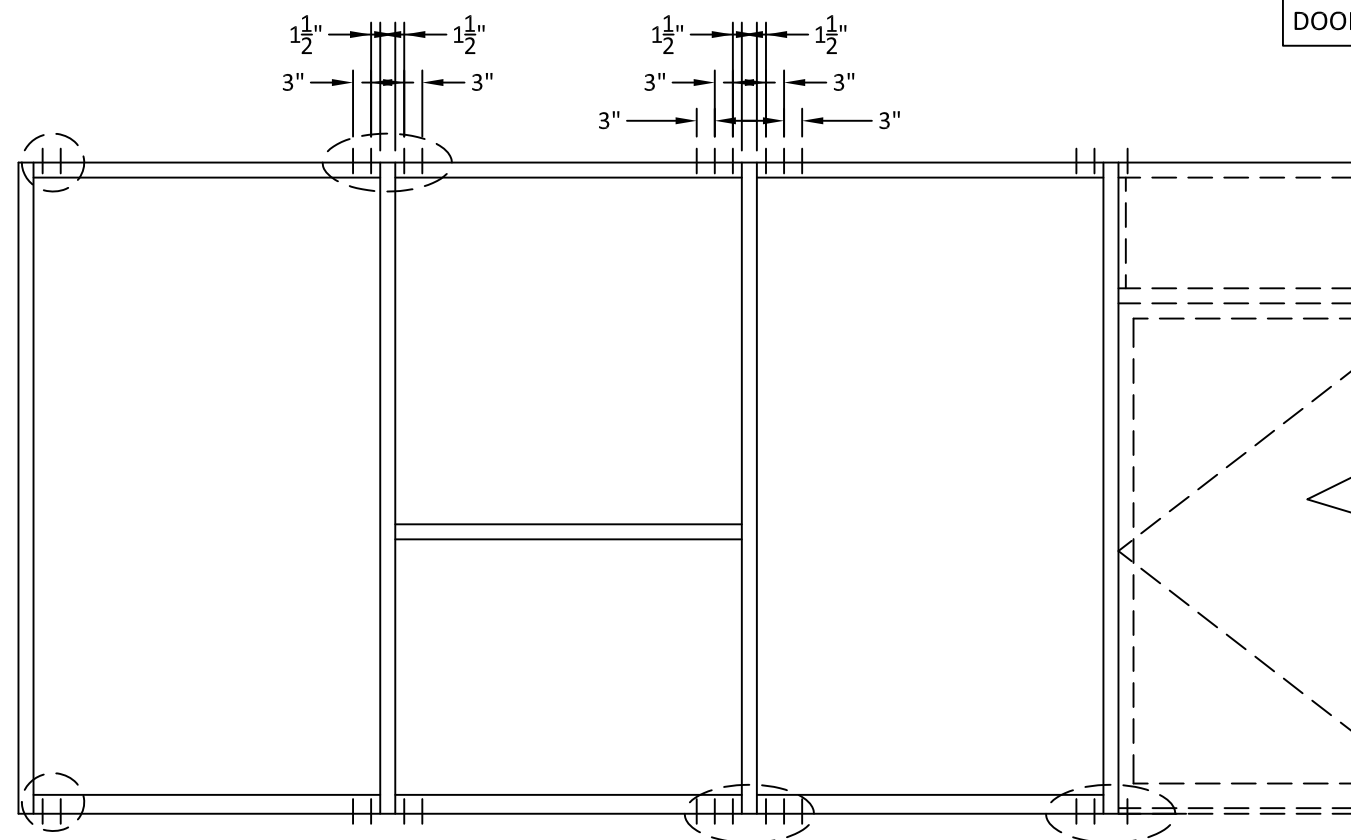

TYPICAL ANCHOR LAYOUT

FOR DOOR ADJACENT MULLION ANCHOR REQUIREMENTS SEE SHEETS 8 & 9

10/27/2021 4:27 PM
 s:\projects\ykk_ap_america, inc.\tdi-21-0919 - tdi submittal - revision cwsf 51, cwsf 52, cwsf 53\dwgs\ykk281_yhs 50 tu og_wr3.dwg

TITLE: YHS 50 TU ALUMINUM STOREFRONT SYSTEM - OUTSIDE GLAZED (IMPACT)

DRY GLAZING DETAILS

PREPARED BY: **BUILDING DROPS, INC.**
 398 E. DANIA BEACH BLVD., STE. 338
 DANIA BEACH, FL 33004
 PH: (954)399-8478
 FAX: (954)744-4738
 WEB: www.buildingdrops.com

REMARKS	BY	DATE

THE INSTALLATION DETAILS DESCRIBED HEREIN ARE GENERIC AND MAY NOT REFLECT ACTUAL CONDITIONS FOR A SPECIFIC SITE. IF SITE CONDITIONS CAUSE INSTALLATION TO DEVIATE FROM THE REQUIREMENTS DETAILED HEREIN, A LICENSED ENGINEER OR ARCHITECT SHALL PREPARE SITE SPECIFIC DOCUMENTS FOR USE WITH THIS DOCUMENT.

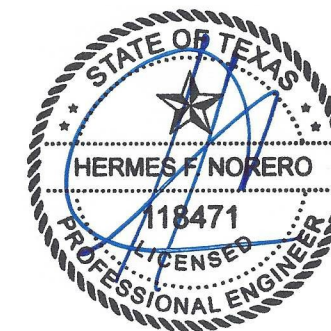

HERMES F. NORERO, P.E.
 TEXAS P.E. No. 118471
 BUILDING DROPS, INC
 398 E. DANIA BEACH BLVD. # 338
 DANIA BEACH, FL 33004
 TBPE FIRM No. 13734

DATE:	09.20.21	
DWG. BY:	MS	CHK. BY: HFN
SCALE:	NTS	
DWG. #:	YKK281	
SHEET:		

DRY GLAZED GLASS TYPES LARGE & SMALL MISSILE IMPACT

GLASS LOAD CAPACITY (PSF)			
NOMINAL DIMS.		GLASS TYPE 'A, B, C, & D'	GLASS TYPE 'H'
D.L.O. WIDTH 'a' (in.)	D.L.O. HEIGHT 'b' (in.)	EXT. (+) INT. (-)	EXT. (+) INT. (-)
27.5	54.375	70.0	50.0
33.5		70.0	50.0
39.5		70.0	50.0
45.5		70.0	50.0
51.5		70.0	50.0
57.5		70.0	50.0
63.5		70.0	50.0
69.5	60.375	70.0	50.0
27.5		70.0	50.0
33.5		70.0	50.0
39.5		70.0	50.0
45.5		70.0	50.0
51.5		70.0	50.0
57.5		70.0	50.0
63.5	70.0	50.0	
69.5	70.0	50.0	
27.5	66.375	70.0	50.0
33.5		70.0	50.0
39.5		70.0	50.0
45.5		70.0	50.0
51.5		70.0	50.0
57.5		70.0	50.0
63.5		66.7	47.6
69.5	66.7	47.6	
27.5	72.375	70.0	50.0
33.5		70.0	50.0
39.5		70.0	50.0
45.5		70.0	50.0
51.5		70.0	50.0
57.5		70.0	50.0
63.5		63.4	45.3
69.5	57.9	41.4	
27.5	78.375	70.0	50.0
33.5		70.0	50.0
39.5		70.0	50.0
45.5		70.0	50.0
51.5		70.0	50.0
57.5		70.0	50.0
63.5		63.4	45.3
69.5	57.9	41.4	
27.5	84.375	70.0	50.0
33.5		70.0	50.0
39.5		70.0	50.0
45.5		70.0	50.0
51.5		70.0	50.0
57.5		70.0	50.0
63.5		63.4	45.3
69.5	57.9	41.4	

NOTE:
SEE DIAGRAM ON SHEET 4 FOR ILLUSTRATION OF D.L.O. DIMENSIONS

NOTE:
GLASS CAPACITIES ON THIS SHEET ARE BASED ON ASTM E1300 (3 SEC. GUSTS) AND CHAPTER 17 OF THE IBC FOR SIZES OTHER THAN TESTED.

GLASS LOAD CAPACITY (PSF)			
NOMINAL DIMS.		GLASS TYPE 'A, B, C, & D'	GLASS TYPE 'H'
D.L.O. WIDTH 'a' (in.)	D.L.O. HEIGHT 'b' (in.)	EXT. (+) INT. (-)	EXT. (+) INT. (-)
27.5	90.375	70.0	50.0
33.5		70.0	50.0
39.5		70.0	50.0
45.5		70.0	50.0
51.5		70.0	50.0
57.5		70.0	50.0
63.5		63.4	45.3
27.5	96.375	70.0	50.0
33.5		70.0	50.0
39.5		70.0	50.0
45.5		70.0	50.0
51.5		70.0	50.0
57.5		70.0	50.0
63.5		70.0	50.0
27.5	102.375	70.0	50.0
33.5		70.0	50.0
39.5		70.0	50.0
45.5		70.0	50.0
51.5		70.0	50.0
57.5		70.0	50.0
63.5		70.0	50.0
27.5	108.375	70.0	50.0
33.5		70.0	50.0
39.5		70.0	50.0
45.5		70.0	50.0
51.5		70.0	50.0
57.5		70.0	50.0
63.5		70.0	50.0
27.5	114.375	70.0	50.0
33.5		70.0	50.0
39.5		70.0	50.0
45.5		70.0	50.0
51.5		70.0	50.0
57.5		70.0	50.0
63.5		70.0	50.0
69.5	70.0	50.0	
27.5	120.375	70.0	50.0
33.5		70.0	50.0
39.5		70.0	50.0
45.5		70.0	50.0
51.5		70.0	50.0
57.5		70.0	50.0
63.5		70.0	50.0
69.5	70.0	50.0	

1-5/16" O.A. LAMINATED INSULATED GLASS CONSISTING OF:
 1/4" HEAT STRENGTHENED OR TEMPERED GLASS,
 1/2" AIR SPACE,
 1/4" HEAT STRENGTHENED GLASS,
 0.090" SENTRYGLAS BY KURARAY,
 FORMERLY KNOWN AS SGP BY DUPONT,
 1/4" HEAT STRENGTHENED GLASS

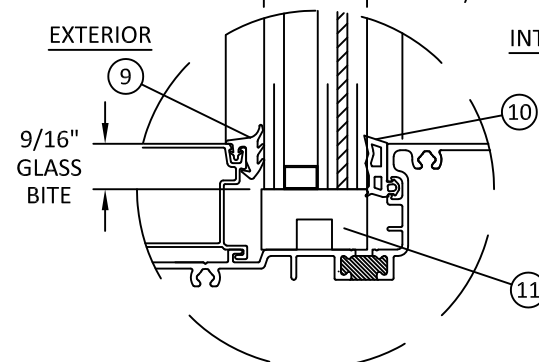

GLAZING DETAIL A
(DRY GLAZED)

ALUMINUM BOX SPACER:
 AROUND THE PERIMETER OF THE GLASS.
 PRIMARY SEALANT:
 POLYISOBUTYLENE (PIB).
 SECONDARY SEALANT:
 STRUCTURAL SILICONE INTENDED FOR FABRICATION OF INSULATED GLASS UNITS.

1-5/16" O.A. LAMINATED INSULATED GLASS CONSISTING OF:
 1/4" TEMPERED GLASS,
 1/2" AIR SPACE,
 1/4" HEAT STRENGTHENED GLASS,
 0.060" SENTRYGLAS BY KURARAY,
 FORMERLY KNOWN AS SGP BY DUPONT,
 1/4" HEAT STRENGTHENED GLASS

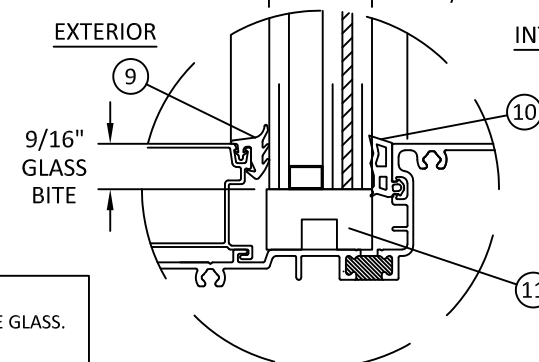

GLAZING DETAIL H
(DRY GLAZED)

DRY GLAZED GLASS TYPES SMALL MISSILE IMPACT ONLY

1-5/16" O.A. LAMINATED INSULATED GLASS CONSISTING OF:
 1/4" TEMPERED GLASS,
 1/2" AIR SPACE,
 1/4" HEAT STRENGTHENED GLASS,
 0.060" EASTMAN CHEM. CO. (FORMERLY KNOWN AS SOLUTIA) SAFLEX PVB,
 1/4" HEAT STRENGTHENED GLASS

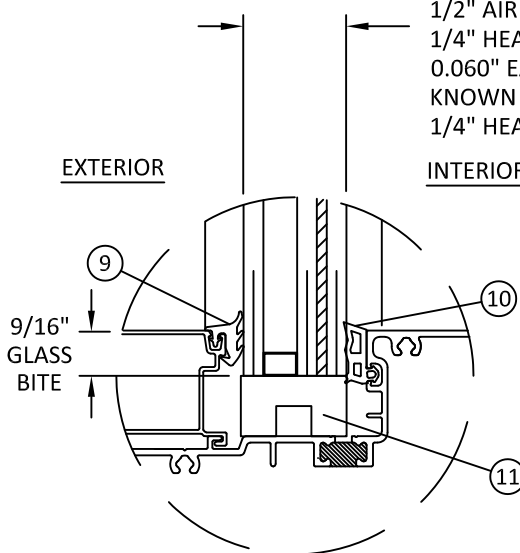

GLAZING DETAIL B
(DRY GLAZED)

1-5/16" O.A. LAMINATED INSULATED GLASS CONSISTING OF:
 1/4" TEMPERED GLASS,
 1/2" AIR SPACE,
 1/4" HEAT STRENGTHENED GLASS,
 0.060" TROSFOL BY KURARAY,
 FORMERLY KNOWN AS BUTACITE BY DUPONT,
 1/4" HEAT STRENGTHENED GLASS

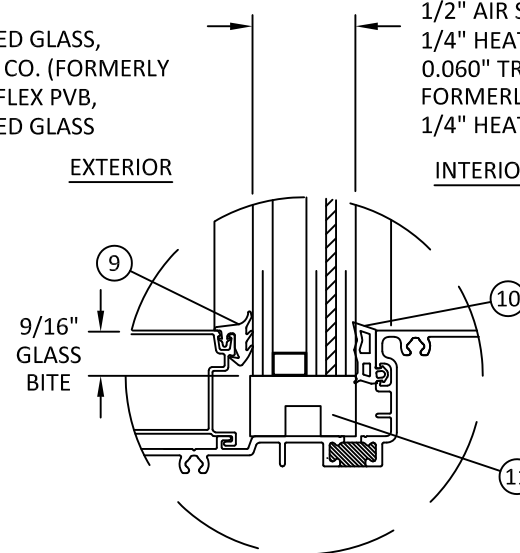

GLAZING DETAIL C
(DRY GLAZED)

1-5/16" O.A. LAMINATED INSULATED GLASS CONSISTING OF:
 1/4" TEMPERED GLASS,
 1/2" AIR SPACE,
 1/4" HEAT STRENGTHENED GLASS,
 0.035" SENTRYGLAS BY KURARAY,
 FORMERLY KNOWN AS SGP BY DUPONT,
 1/4" HEAT STRENGTHENED GLASS

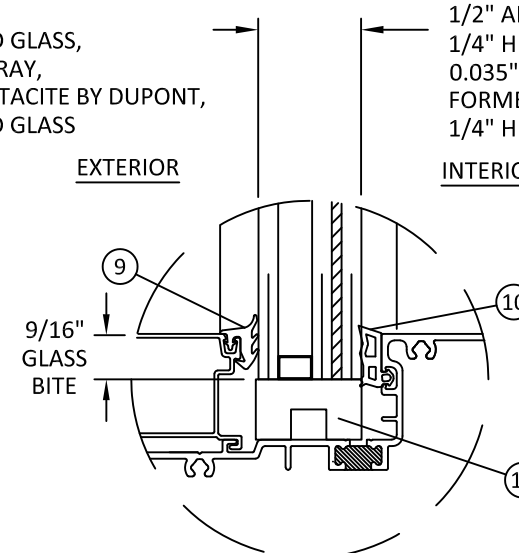

GLAZING DETAIL D
(DRY GLAZED)

WET GLAZED GLASS TYPES

LARGE & SMALL MISSILE IMPACT

GLASS LOAD CAPACITY (PSF)			
NOMINAL DIMS.		GLASS TYPE 'E'	GLASS TYPE 'F & G'
D.L.O. WIDTH 'a' (in.)	D.L.O. HEIGHT 'b' (in.)	EXT. (+) INT. (-)	EXT. (+) INT. (-)
27.5	54.375	70.0	50.0
33.5		70.0	50.0
39.5		70.0	50.0
45.5		70.0	50.0
51.5		70.0	44.2
57.5		70.0	41.8
63.5	60.375	70.0	41.8
69.5		70.0	41.8
27.5		70.0	50.0
33.5		70.0	50.0
39.5		70.0	50.0
45.5		70.0	50.0
51.5	66.375	70.0	50.0
57.5		70.0	44.2
63.5		70.0	39.6
69.5		70.0	37.7
27.5		70.0	50.0
33.5		70.0	50.0
39.5	72.375	70.0	50.0
45.5		70.0	50.0
51.5		70.0	44.2
57.5		70.0	39.6
63.5		63.4	35.8
69.5		57.9	-
27.5	78.375	70.0	50.0
33.5		70.0	50.0
39.5		70.0	50.0
45.5		70.0	50.0
51.5		70.0	44.2
57.5		70.0	39.6
63.5	84.375	63.4	-
69.5		57.9	-
27.5		70.0	50.0
33.5		70.0	50.0
39.5		70.0	50.0
45.5		70.0	50.0
51.5	90.375	70.0	50.0
57.5		70.0	44.2
63.5		63.4	-
69.5		57.9	-
27.5		70.0	50.0
33.5		70.0	50.0
39.5	96.375	70.0	50.0
45.5		70.0	50.0
51.5		70.0	-
57.5		70.0	-
63.5		63.4	-
69.5		57.9	-
27.5	102.375	70.0	50.0
33.5		70.0	50.0
39.5		70.0	50.0
45.5		70.0	-
51.5		70.0	-
57.5		70.0	-
63.5	108.375	70.0	50.0
69.5		66.7	37.7
27.5		70.0	50.0
33.5		70.0	50.0
39.5		70.0	50.0
45.5		70.0	-
51.5	114.375	70.0	50.0
57.5		70.0	-
63.5		63.4	-
69.5		57.9	-
27.5		70.0	50.0
33.5		70.0	50.0
39.5	120.375	70.0	50.0
45.5		70.0	-
51.5		70.0	-
57.5		70.0	-
63.5		63.4	-
69.5		57.9	-

GLASS LOAD CAPACITY (PSF)			
NOMINAL DIMS.		GLASS TYPE 'E'	GLASS TYPE 'F & G'
D.L.O. WIDTH 'a' (in.)	D.L.O. HEIGHT 'b' (in.)	EXT. (+) INT. (-)	EXT. (+) INT. (-)
27.5	90.375	70.0	50.0
33.5		70.0	50.0
39.5		70.0	50.0
45.5		70.0	50.0
51.5		70.0	44.2
57.5		70.0	-
63.5	96.375	63.4	-
69.5		57.9	-
27.5		70.0	50.0
33.5		70.0	50.0
39.5		70.0	50.0
45.5		70.0	50.0
51.5	102.375	70.0	-
57.5		70.0	-
63.5		63.4	-
69.5		57.9	-
27.5		70.0	50.0
33.5		70.0	50.0
39.5	108.375	70.0	50.0
45.5		70.0	-
51.5		70.0	-
57.5		70.0	-
63.5		63.4	-
69.5		57.9	-
27.5	114.375	70.0	50.0
33.5		70.0	50.0
39.5		70.0	50.0
45.5		70.0	-
51.5		70.0	-
57.5		70.0	-
63.5	120.375	63.4	-
69.5		57.9	-
27.5		70.0	50.0
33.5		70.0	50.0
39.5		70.0	50.0
45.5		70.0	-
51.5	126.375	70.0	50.0
57.5		70.0	-
63.5		63.4	-
69.5		57.9	-
27.5		70.0	50.0
33.5		70.0	50.0
39.5	132.375	70.0	50.0
45.5		70.0	-
51.5		70.0	-
57.5		70.0	-
63.5		63.4	-
69.5		57.9	-

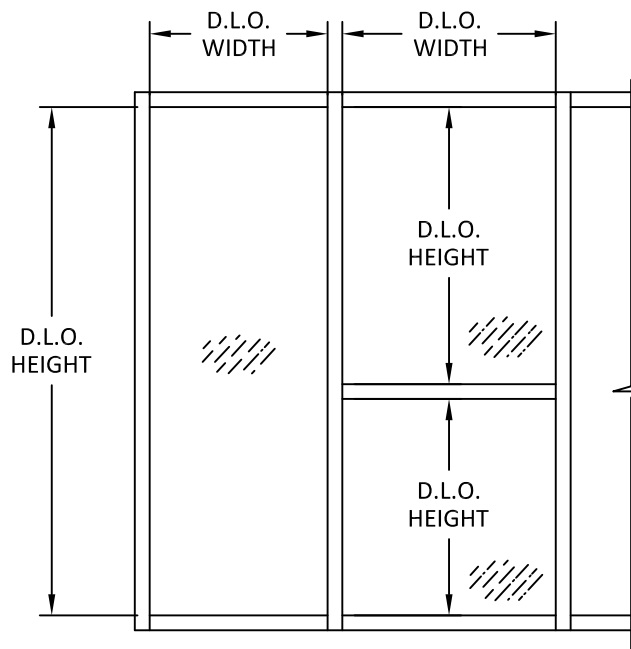

ALUMINUM BOX SPACER:
AROUND THE PERIMETER OF THE GLASS.
PRIMARY SEALANT:
POLYISOBUTYLENE (PIB).
SECONDARY SEALANT:
STRUCTURAL SILICONE INTENDED FOR FABRICATION OF INSULATED GLASS UNITS.

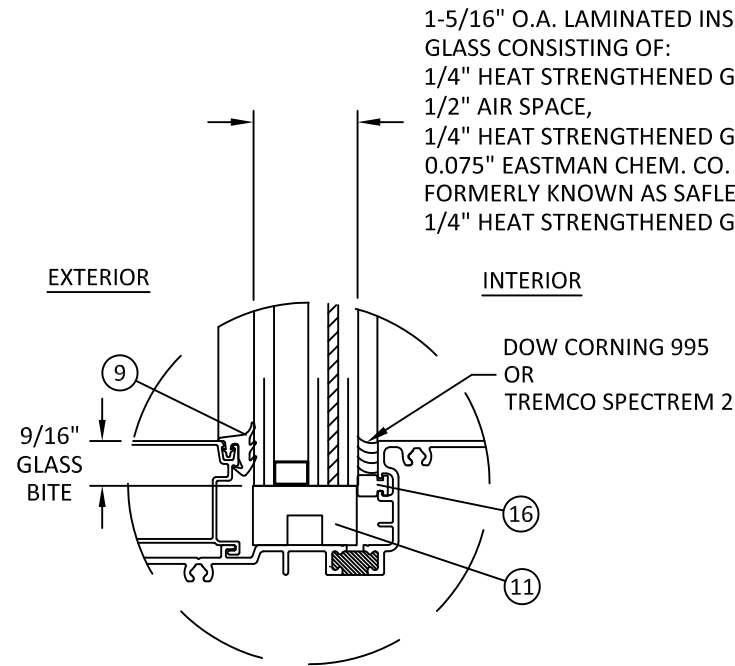

GLAZING DETAIL E (WET GLAZED)

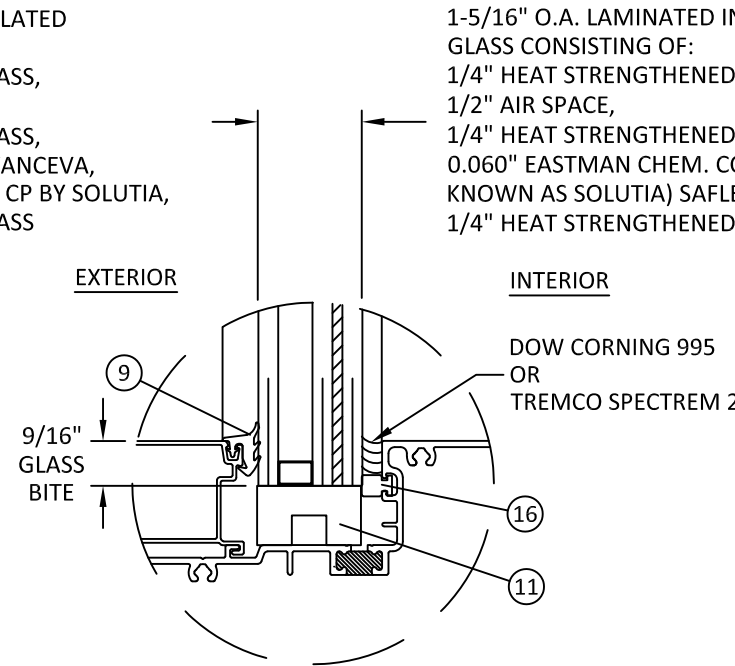

GLAZING DETAIL F (WET GLAZED)

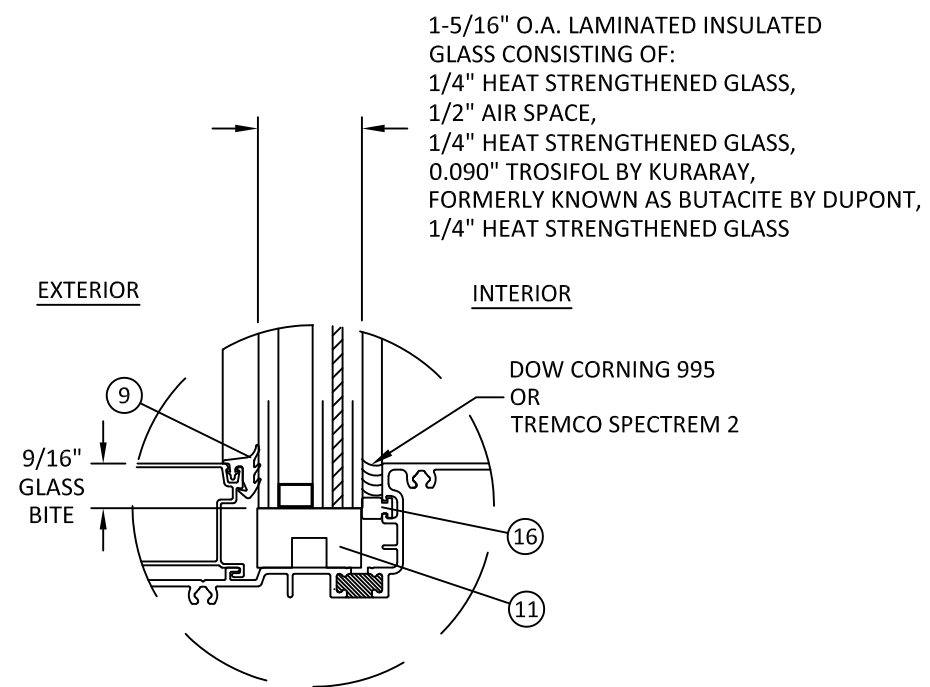

GLAZING DETAIL G (WET GLAZED)



YKK AP AMERICA, INC.
1229 HWY 441 BYPASS
DUBLIN, GEORGIA 31021
PH: (478)277-1955 FAX: (678)838-6001

TITLE: YHS 50 TU ALUMINUM STOREFRONT SYSTEM - OUTSIDE GLAZED (IMPACT) WET GLAZING DETAILS

PREPARED BY: **BUILDING DROPS, INC.**
398 E. DANIA BEACH BLVD., STE. 338
DANIA BEACH, FL 33004
PH: (954)399-8478
FAX: (954)744-4738
WEB: www.buildingdrops.com

REMARKS	BY	DATE

THE INSTALLATION DETAILS DESCRIBED HEREIN ARE GENERIC AND MAY NOT REFLECT ACTUAL CONDITIONS FOR A SPECIFIC SITE. IF SITE CONDITIONS CAUSE INSTALLATION TO DEVIATE FROM THE REQUIREMENTS DETAILED HEREIN, A LICENSED ENGINEER OR ARCHITECT SHALL PREPARE SITE SPECIFIC DOCUMENTS FOR USE WITH THIS DOCUMENT.

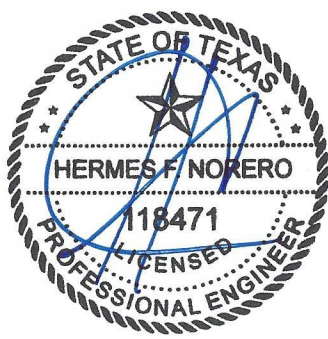

HERMES F. NORERO, P.E.
TEXAS P.E. No. 118471
BUILDING DROPS, INC
398 E. DANIA BEACH BLVD. # 338
DANIA BEACH, FL 33004
TBPE FIRM No. 13734

DATE:	09.20.21	
DWG. BY:	MS	CHK. BY: HFN
SCALE:	NTS	
DWG. #:	YKK281	
SHEET:	4	

MULLION LOAD TABLES

JAMB/MULLION LOAD CAPACITY - PSF WITH OR WITHOUT INTERMEDIATE HORIZONTALS				
NOMINAL DIMS.		STANDARD CONFIG.	HEAVY CONFIG.	EXP. MULLION
WIDTH (W)	FRAME HEIGHT	EXT. (+) INT. (-)	EXT. (+) INT. (-)	EXT. (+) INT. (-)
30	60	70.0	70.0	70.0
36		70.0	70.0	70.0
42		70.0	70.0	70.0
48		70.0	70.0	70.0
54		70.0	70.0	70.0
60		70.0	70.0	70.0
66		70.0	70.0	70.0
72		70.0	70.0	70.0
30	66	70.0	70.0	70.0
36		70.0	70.0	70.0
42		70.0	70.0	70.0
48		70.0	70.0	70.0
54		70.0	70.0	70.0
60		70.0	70.0	70.0
66		70.0	70.0	70.0
72		50.0	70.0	70.0
30	72	70.0	70.0	70.0
36		70.0	70.0	70.0
42		70.0	70.0	70.0
48		70.0	70.0	70.0
54		70.0	70.0	70.0
60		70.0	70.0	70.0
66		50.0	70.0	70.0
72		50.0	70.0	70.0
30	78	70.0	70.0	70.0
36		70.0	70.0	70.0
42		70.0	70.0	70.0
48		70.0	70.0	70.0
54		70.0	70.0	70.0
60		50.0	70.0	70.0
66		50.0	70.0	70.0
72		--	70.0	70.0
30	84	70.0	70.0	70.0
36		70.0	70.0	70.0
42		70.0	70.0	70.0
48		70.0	70.0	70.0
54		70.0	70.0	70.0
60		50.0	70.0	70.0
66		--	70.0	70.0
72		--	70.0	--
30	90	70.0	70.0	70.0
36		70.0	70.0	70.0
42		70.0	70.0	70.0
48		70.0	70.0	70.0
54		50.0	70.0	70.0
60		--	70.0	70.0
66		--	70.0	--
72		--	70.0	--

JAMB/MULLION LOAD CAPACITY - PSF WITH OR WITHOUT INTERMEDIATE HORIZONTALS				
NOMINAL DIMS.		STANDARD CONFIG.	HEAVY CONFIG.	EXP. MULLION
WIDTH (W)	FRAME HEIGHT	EXT. (+) INT. (-)	EXT. (+) INT. (-)	EXT. (+) INT. (-)
30	96	70.0	70.0	70.0
36		70.0	70.0	70.0
42		70.0	70.0	70.0
48		70.0	70.0	70.0
54		50.0	70.0	70.0
60		--	70.0	70.0
66		--	70.0	--
72		--	70.0	70.0
30	102	70.0	70.0	70.0
36		70.0	70.0	70.0
42		66.7	70.0	70.0
48		50.0	70.0	70.0
54		--	70.0	70.0
60		--	70.0	--
66		70.0	70.0	70.0
72		65.6	70.0	70.0
30	108	56.2	70.0	70.0
36		50.0	70.0	70.0
42		--	70.0	70.0
48		--	70.0	--
54		66.9	70.0	70.0
60		55.7	70.0	70.0
66		48.6	70.0	70.0
72		--	70.0	67.0
30	114	--	66.1	--
36		57.3	70.0	70.0
42		48.6	70.0	70.0
48		41.7	70.0	65.6
54		--	63.8	57.4
60		--	56.7	--
66		--	--	--
72		--	--	--

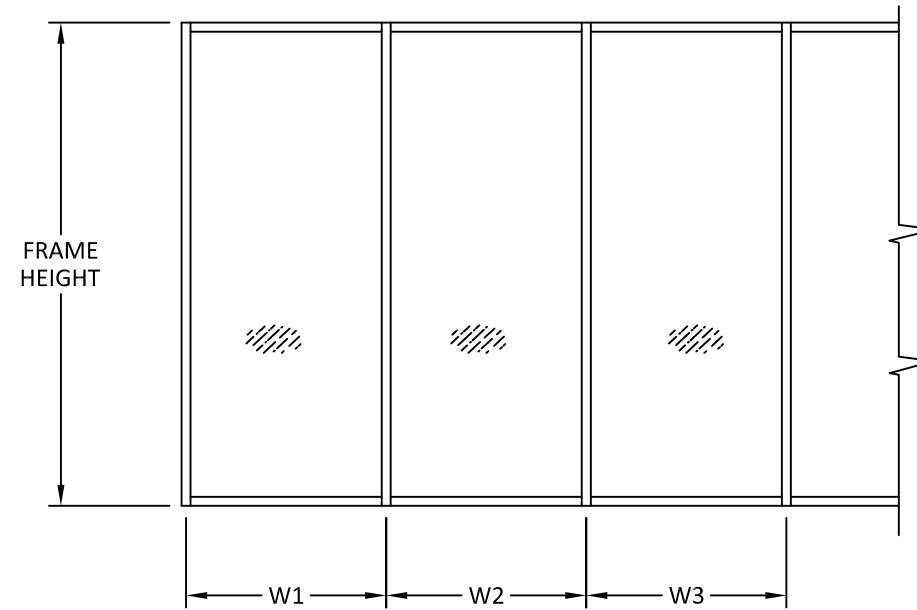

WIDTH (W) = W1 (JAMB)

WIDTH (W) = $\frac{W2 + W3}{2}$ (MULLION)

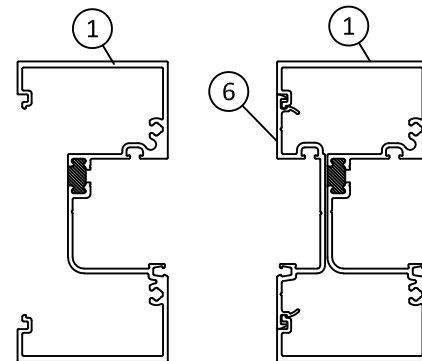

JAMB MULLION

STD. CONFIGURATION

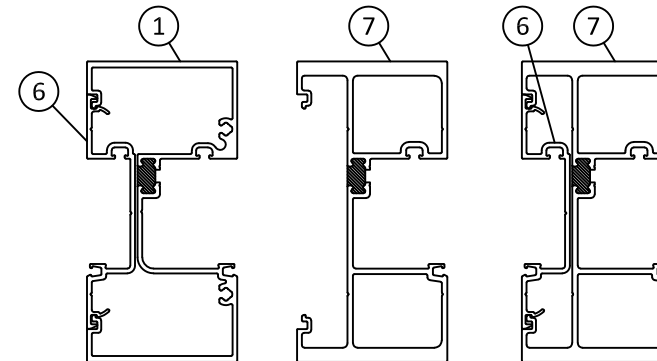

JAMB JAMB MULLION

HEAVY CONFIGURATION

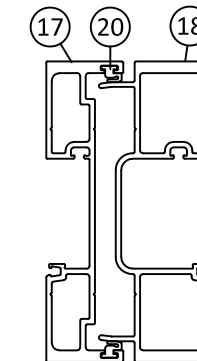

EXPANSION MULLION



YKK AP AMERICA, INC.
1229 HWY 441 BYPASS
DUBLIN, GEORGIA 31021
PH: (478)277-1955 FAX: (678)838-6001

TITLE: YHS 50 TU ALUMINUM STOREFRONT SYSTEM - OUTSIDE GLAZED (IMPACT)

MULLION TABLES
PREPARED BY: BUILDING DROPS, INC.
398 E. DANIA BEACH BLVD., STE. 338
DANIA BEACH, FL 33004
PH: (954)399-8478
FAX: (954)744-4738
WEB: www.buildingdrops.com

REMARKS	BY	DATE

THE INSTALLATION DETAILS DESCRIBED HEREIN ARE GENERIC AND MAY NOT REFLECT ACTUAL CONDITIONS FOR A SPECIFIC SITE. IF SITE CONDITIONS CAUSE INSTALLATION TO DEVIATE FROM THE REQUIREMENTS DETAILED HEREIN, A LICENSED ENGINEER OR ARCHITECT SHALL PREPARE SITE SPECIFIC DOCUMENTS FOR USE WITH THIS DOCUMENT.

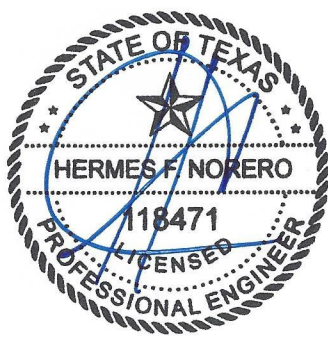

HERMES F. NORERO, P.E.
TEXAS P.E. No. 118471
BUILDING DROPS, INC.
398 E. DANIA BEACH BLVD. # 338
DANIA BEACH, FL 33004
TBPE FIRM No. 13734

DATE:	09.20.21
DWG. BY:	MS
CHK. BY:	HFN
SCALE:	NTS
DWG. #:	YKK281
SHEET:	5

ANCHOR TYPE 'A & B' TABLES



YKK AP AMERICA, INC.
1229 HWY 441 BYPASS
DUBLIN, GEORGIA 31021
PH: (478)277-1955 FAX: (678)838-6001

ANCHORS TYPES: SEE SHEET 10 FOR DESCRIPTION

A2 = (2) ANCHORS TYPE 'A' AT JAMB OR EACH SIDE OF MULLION
A3 = (3) ANCHORS TYPE 'A' AT JAMB OR EACH SIDE OF MULLION

B2 = (2) ANCHORS TYPE 'B' AT JAMB OR EACH SIDE OF MULLION
B3 = (3) ANCHORS TYPE 'B' AT JAMB OR EACH SIDE OF MULLION

ALL OTHER ANCHORS TO BE SPACED AS PER ELEVATION

ANCHOR LOAD CAPACITY - PSF EXT. (+) & INT (-)					
NOMINAL DIMS.		ANCHOR TYPE		ANCHOR TYPE	
TRIBUTARY WIDTH 'W' (in.)	FRAME HEIGHT 'H' (in.)	A2	A3	B2	B3
30	60	70.0	70.0	70.0	70.0
36		70.0	70.0	70.0	70.0
42		70.0	70.0	70.0	70.0
48		70.0	70.0	70.0	70.0
54		70.0	70.0	70.0	70.0
60		70.0	70.0	70.0	70.0
66		63.6	70.0	70.0	70.0
72		58.3	70.0	70.0	70.0
30	66	70.0	70.0	70.0	70.0
36		70.0	70.0	70.0	70.0
42		70.0	70.0	70.0	70.0
48		70.0	70.0	70.0	70.0
54		70.0	70.0	70.0	70.0
60		63.6	70.0	70.0	70.0
66		57.9	70.0	70.0	70.0
72		53.0	70.0	70.0	70.0
30	72	70.0	70.0	70.0	70.0
36		70.0	70.0	70.0	70.0
42		70.0	70.0	70.0	70.0
48		70.0	70.0	70.0	70.0
54		64.8	70.0	70.0	70.0
60		58.3	70.0	70.0	70.0
66		53.0	70.0	70.0	70.0
72		48.6	70.0	70.0	70.0
30	78	70.0	70.0	70.0	70.0
36		70.0	70.0	70.0	70.0
42		70.0	70.0	70.0	70.0
48		67.3	70.0	70.0	70.0
54		59.8	70.0	70.0	70.0
60		53.9	70.0	70.0	70.0
66		49.0	70.0	70.0	70.0
72		44.9	67.3	70.0	70.0

ANCHOR LOAD CAPACITY - PSF EXT. (+) & INT (-)					
NOMINAL DIMS.		ANCHOR TYPE		ANCHOR TYPE	
TRIBUTARY WIDTH 'W' (in.)	FRAME HEIGHT 'H' (in.)	A2	A3	B2	B3
30	84	70.0	70.0	70.0	70.0
36		70.0	70.0	70.0	70.0
42		70.0	70.0	70.0	70.0
48		62.5	70.0	70.0	70.0
54		55.6	70.0	70.0	70.0
60		50.0	70.0	70.0	70.0
66		45.5	68.2	70.0	70.0
72		41.7	62.5	66.9	70.0
30	90	70.0	70.0	70.0	70.0
36		70.0	70.0	70.0	70.0
42		66.7	70.0	70.0	70.0
48		58.3	70.0	70.0	70.0
54		51.9	70.0	70.0	70.0
60		46.7	70.0	70.0	70.0
66		42.4	63.6	68.1	70.0
72		38.9	58.3	62.4	70.0
30	96	70.0	70.0	70.0	70.0
36		70.0	70.0	70.0	70.0
42		62.5	70.0	70.0	70.0
48		54.7	70.0	70.0	70.0
54		48.6	70.0	70.0	70.0
60		43.8	65.6	70.0	70.0
66		39.8	59.7	63.8	70.0
72		30	70.0	70.0	70.0
30	102	68.6	70.0	70.0	70.0
36		58.8	70.0	70.0	70.0
42		51.5	70.0	70.0	70.0
48		45.8	68.6	70.0	70.0
54		41.2	61.8	66.1	70.0
60		41.2	61.8	66.1	70.0

ANCHOR LOAD CAPACITY - PSF EXT. (+) & INT (-)						
NOMINAL DIMS.		ANCHOR TYPE		ANCHOR TYPE		
TRIBUTARY WIDTH 'W' (in.)	FRAME HEIGHT 'H' (in.)	A2	A3	B2	B3	
30	108	70.0	70.0	70.0	70.0	
36		64.8	70.0	70.0	70.0	
42		55.6	70.0	70.0	70.0	
48		48.6	70.0	70.0	70.0	
54		43.2	64.8	69.3	70.0	
60		38.9	58.3	62.4	70.0	
30		114	70.0	70.0	70.0	70.0
36			61.4	70.0	70.0	70.0
42	52.6		70.0	70.0	70.0	
48	46.1		69.1	70.0	70.0	
54	40.9		61.4	65.7	70.0	
30	120		70.0	70.0	70.0	70.0
36			58.3	70.0	70.0	70.0
42			50.0	70.0	70.0	70.0
48		43.8	65.6	70.0	70.0	
54		38.9	58.3	62.4	70.0	

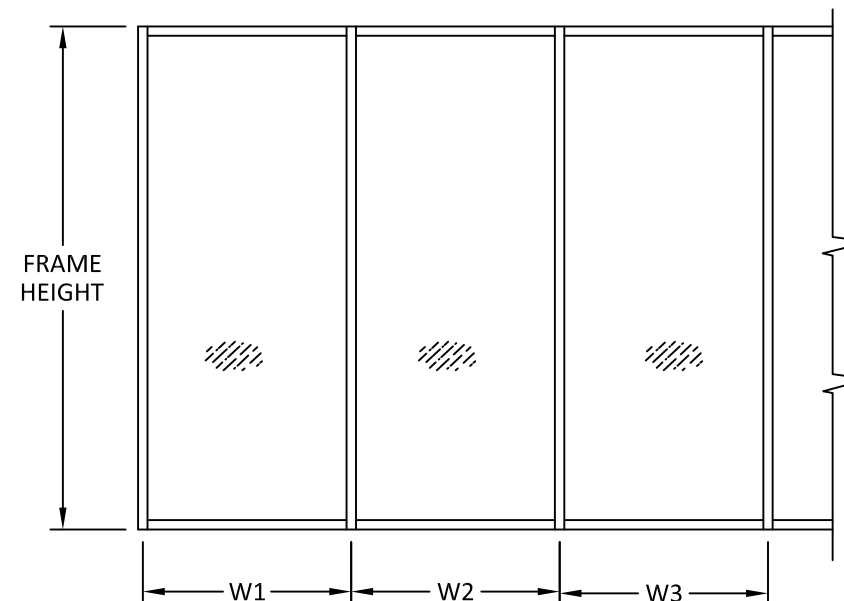
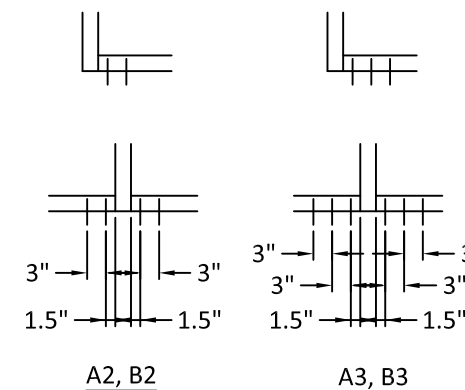

WIDTH (W) = W1 (JAMB)

WIDTH (W) = $\frac{W2 + W3}{2}$ (MULLION)

TITLE: YHS 50 TU ALUMINUM STOREFRONT SYSTEM - OUTSIDE GLAZED (IMPACT)
TYPE A & B ANCHOR TABLES
PREPARED BY: BUILDING DROPS, INC.
398 E. DANIA BEACH BLVD., STE. 338
DANIA BEACH, FL 33004
PH: (954)399-8478
FAX: (954)744-4738
WEB: www.buildingdrops.com

REMARKS	BY	DATE

THE INSTALLATION DETAILS DESCRIBED HEREIN ARE GENERIC AND MAY NOT REFLECT ACTUAL CONDITIONS FOR A SPECIFIC SITE. IF SITE CONDITIONS CAUSE INSTALLATION TO DEVIATE FROM THE REQUIREMENTS DETAILED HEREIN, A LICENSED ENGINEER OR ARCHITECT SHALL PREPARE SITE SPECIFIC DOCUMENTS FOR USE WITH THIS DOCUMENT.

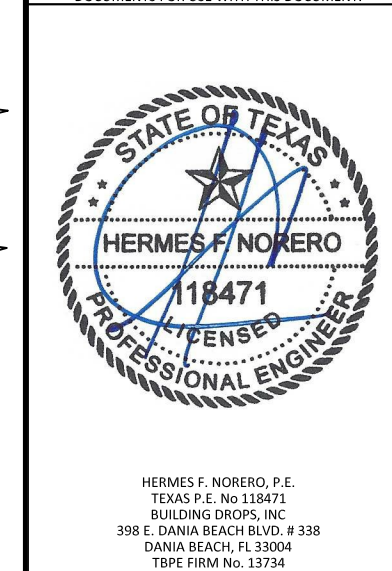

HERMES F. NORERO, P.E.
TEXAS P.E. No 118471
BUILDING DROPS, INC
398 E. DANIA BEACH BLVD. # 338
DANIA BEACH, FL 33004
TBPE FIRM No. 13734

DATE: 09.20.21
DWG. BY: MS
CHK. BY: HFN
SCALE: NTS
DWG. #: YKK281
SHEET: 6 OF 12

10/27/2021 4:27 PM
s:\projects\ykk_ap_america, inc.\tdi-21-0919 - tdi submittal - revision cwsf 51, cwsf 52, cwsf 53\dwg\ykk281_yhs 50 tu eg wr3.dwg

ANCHOR TYPE 'C, D & E' TABLES

ANCHOR LOAD CAPACITY - PSF EXT. (+) & INT (-)					
NOMINAL DIMS.		ANCHOR TYPE 'C'		ANCHOR TYPE 'D' & 'E'	
TRIBUTARY WIDTH 'W' (in.)	FRAME HEIGHT 'H' (in.)	C2	C3	D2/E2	D3/E3
30	60	70.0	70.0	70.0	70.0
36		70.0	70.0	70.0	70.0
42		70.0	70.0	70.0	70.0
48		70.0	70.0	70.0	70.0
54		70.0	70.0	70.0	70.0
60		67.5	70.0	70.0	70.0
66		61.4	70.0	70.0	70.0
72		56.2	70.0	70.0	70.0
30	66	70.0	70.0	70.0	70.0
36		70.0	70.0	70.0	70.0
42		70.0	70.0	70.0	70.0
48		70.0	70.0	70.0	70.0
54		68.2	70.0	70.0	70.0
60		61.4	70.0	70.0	70.0
66		55.8	70.0	70.0	70.0
72		51.1	70.0	68.1	70.0
30	72	70.0	70.0	70.0	70.0
36		70.0	70.0	70.0	70.0
42		70.0	70.0	70.0	70.0
48		70.0	70.0	70.0	70.0
54		62.5	70.0	70.0	70.0
60		56.2	70.0	70.0	70.0
66		51.1	70.0	68.1	70.0
72		46.9	70.0	62.4	70.0
30	78	70.0	70.0	70.0	70.0
36		70.0	70.0	70.0	70.0
42		70.0	70.0	70.0	70.0
48		64.9	70.0	70.0	70.0
54		57.7	70.0	70.0	70.0
60		51.9	70.0	69.1	70.0
66		47.2	70.0	62.8	70.0
72		43.3	64.9	57.6	70.0
30	84	70.0	70.0	70.0	70.0
36		70.0	70.0	70.0	70.0
42		68.9	70.0	70.0	70.0
48		60.3	70.0	70.0	70.0
54		53.6	70.0	70.0	70.0
60		48.2	70.0	64.2	70.0
66		43.8	65.7	58.3	70.0
72		40.2	60.3	53.5	70.0

ANCHOR LOAD CAPACITY - PSF EXT. (+) & INT (-)						
NOMINAL DIMS.		ANCHOR TYPE 'C'		ANCHOR TYPE 'D' & 'E'		
TRIBUTARY WIDTH 'W' (in.)	FRAME HEIGHT 'H' (in.)	C2	C3	D2/E2	D3/E3	
30	90	70.0	70.0	70.0	70.0	
36		70.0	70.0	70.0	70.0	
42		64.3	70.0	70.0	70.0	
48		56.2	70.0	70.0	70.0	
54		50.0	70.0	66.6	70.0	
60		45.0	67.5	59.9	70.0	
66		40.9	61.4	54.5	70.0	
72		37.5	56.2	49.9	70.0	
30	96	70.0	70.0	70.0	70.0	
36		70.0	70.0	70.0	70.0	
42		60.3	70.0	70.0	70.0	
48		52.7	70.0	70.0	70.0	
54		46.9	70.0	62.4	70.0	
60		42.2	63.3	56.2	70.0	
66		38.4	57.5	51.1	70.0	
72		30	70.0	70.0	70.0	70.0
36	102	66.2	70.0	70.0	70.0	
42		56.7	70.0	70.0	70.0	
48		49.6	70.0	66.1	70.0	
54		44.1	66.2	58.7	70.0	
60		39.7	59.6	52.9	70.0	
30		108	70.0	70.0	70.0	70.0
36			62.5	70.0	70.0	70.0
42			53.6	70.0	70.0	70.0
48	46.9		70.0	62.4	70.0	
54	41.7		62.5	55.5	70.0	
60	37.5		56.2	49.9	70.0	
30	114		70.0	70.0	70.0	70.0
36			59.2	70.0	70.0	70.0
42		50.8	70.0	67.6	70.0	
48		44.4	66.6	59.1	70.0	
54		39.5	59.2	52.5	70.0	
30		120	67.5	70.0	70.0	70.0
36			56.2	70.0	70.0	70.0
42			48.2	70.0	64.2	70.0
48	42.2		63.3	56.2	70.0	
54	37.5		56.2	49.9	70.0	

ANCHORS TYPES: SEE SHEET 10 FOR DESCRIPTION

- C2 = (2) ANCHORS TYPE 'C' AT JAMB OR EACH SIDE OF MULLION
- C3 = (3) ANCHORS TYPE 'C' AT JAMB OR EACH SIDE OF MULLION
- D2 = (2) ANCHORS TYPE 'D' AT JAMB OR EACH SIDE OF MULLION
- D3 = (3) ANCHORS TYPE 'D' AT JAMB OR EACH SIDE OF MULLION
- E2 = (2) ANCHORS TYPE 'E' AT JAMB OR EACH SIDE OF MULLION
- E3 = (3) ANCHORS TYPE 'E' AT JAMB OR EACH SIDE OF MULLION

ALL OTHER ANCHORS TO BE SPACED AS PER ELEVATION

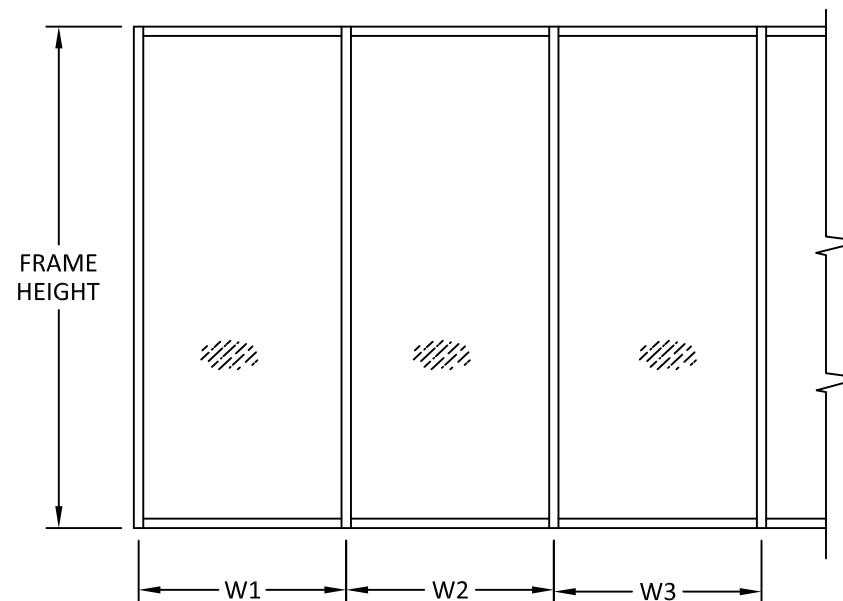
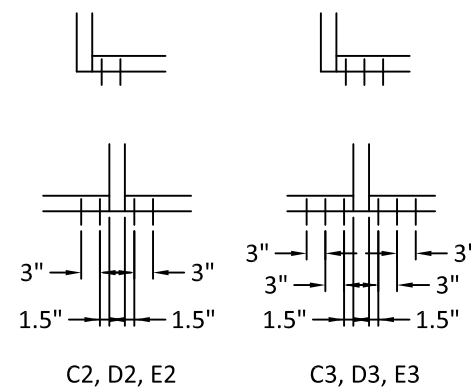

WIDTH (W) = W1 (JAMB)

$$\text{WIDTH (W)} = \frac{W2 + W3}{2} \text{ (MULLION)}$$



YKK AP AMERICA, INC.
1229 HWY 441 BYPASS
DUBLIN, GEORGIA 31021
PH: (478)277-1955 FAX: (678)838-6001

TITLE: YHS 50 TU ALUMINUM STOREFRONT SYSTEM - OUTSIDE GLAZED (IMPACT)

TYPE C, D & E ANCHOR TABLES

PREPARED BY: BUILDING DROPS, INC.
398 E. DANIA BEACH BLVD., STE. 338
DANIA BEACH, FL 33004
PH: (954)399-8478
FAX: (954)744-4738
WEB: www.buildingdrops.com



REMARKS	BY	DATE

THE INSTALLATION DETAILS DESCRIBED HEREIN ARE GENERIC AND MAY NOT REFLECT ACTUAL CONDITIONS FOR A SPECIFIC SITE. IF SITE CONDITIONS CAUSE INSTALLATION TO DEVIATE FROM THE REQUIREMENTS DETAILED HEREIN, A LICENSED ENGINEER OR ARCHITECT SHALL PREPARE SITE SPECIFIC DOCUMENTS FOR USE WITH THIS DOCUMENT.

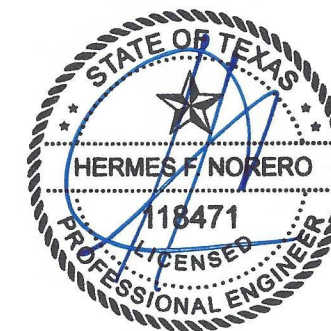

HERMES F. NORERO, P.E.
TEXAS P.E. No. 118471
BUILDING DROPS, INC.
398 E. DANIA BEACH BLVD. # 338
DANIA BEACH, FL 33004
TBPE FIRM No. 13734

DATE: 09.20.21

DWG. BY: MS

CHK. BY: HFN

SCALE: NTS

DWG. #: YKK281

SHEET:

7

DOOR MULLION LOAD & ANCHOR TABLES



YKK AP AMERICA, INC.
 1229 HWY 441 BYPASS
 DUBLIN, GEORGIA 31021
 PH: (478)277-1955 FAX: (678)838-6001

DOOR MULLION LOAD CAPACITY					
NOMINAL DIMS.		WITHOUT STEEL REINF.		WITH STEEL REINF.	
WIDTH (W)	FRAME HEIGHT (H)	EXT. (+)	INT. (-)	EXT. (+)	INT. (-)
24	102	70.0	70.0	70.0	90.0
30		70.0	70.0	70.0	90.0
36		70.0	70.0	70.0	90.0
42		70.0	70.0	70.0	90.0
48		70.0	70.0	70.0	90.0
54		70.0	70.0	70.0	90.0
60	108	70.0	70.0	70.0	90.0
24		70.0	70.0	70.0	90.0
30		70.0	70.0	70.0	90.0
36		70.0	70.0	70.0	90.0
42		70.0	70.0	70.0	90.0
48		70.0	70.0	70.0	90.0
54	114	70.0	70.0	70.0	90.0
60		70.0	70.0	70.0	90.0
24		70.0	70.0	70.0	90.0
30		70.0	70.0	70.0	90.0
36		70.0	70.0	70.0	90.0
42		70.0	70.0	70.0	90.0
48	120	70.0	70.0	70.0	90.0
54		70.0	70.0	70.0	90.0
60		70.0	70.0	70.0	90.0
24		70.0	70.0	70.0	90.0
30		70.0	70.0	70.0	90.0
36		70.0	70.0	70.0	90.0
42	120	70.0	70.0	70.0	90.0
48		70.0	70.0	70.0	90.0
54		69.2	69.2	70.0	90.0
60		62.3	62.3	70.0	90.0

ANCHOR TYPES	TOTAL NO. OF ANCHORS AT DOOR MULLION HEAD AND SILL
A	10
B	6
C	10
D OR E	8

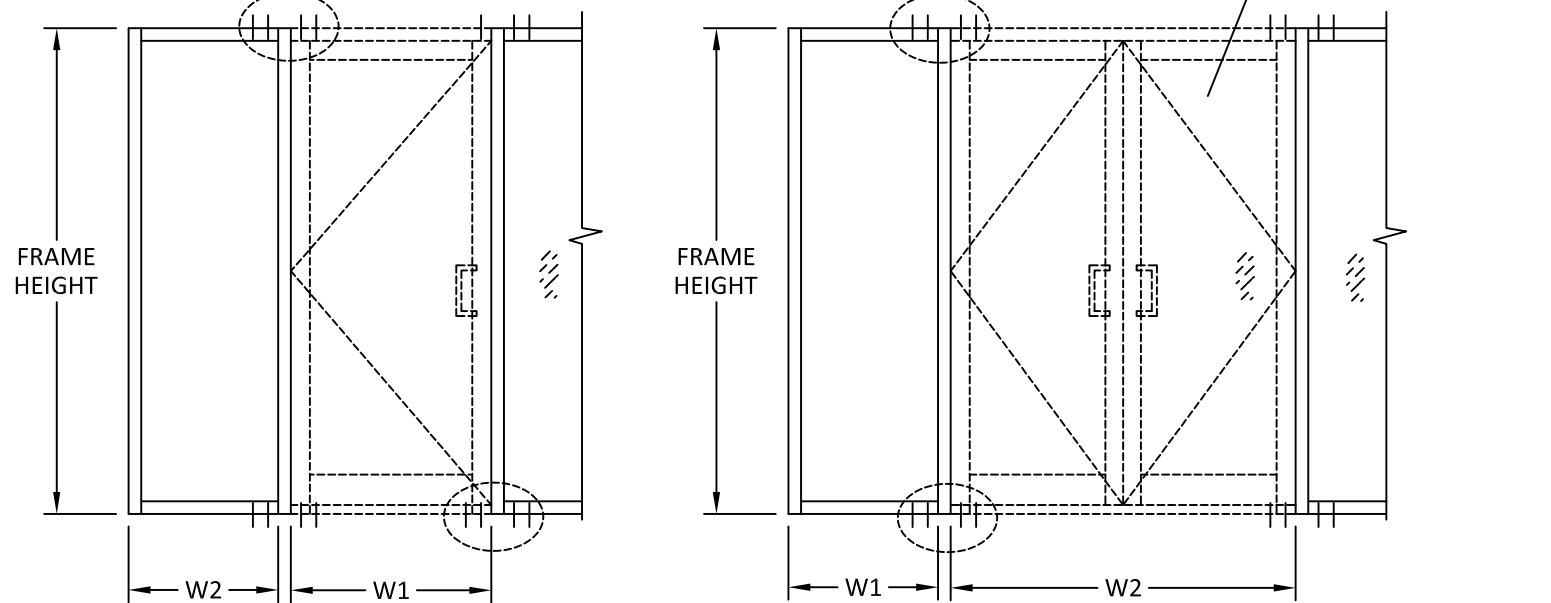

$$\text{WIDTH (W)} = \frac{W1 + W2}{2}$$

SINGLE DOOR

$$\text{WIDTH (W)} = \frac{W1}{2} + \frac{W2}{4}$$

DOUBLE DOOR

ANCHOR TYPES	TOTAL NO. OF ANCHORS AT DOOR MULLION HEAD AND SILL
A	10
B	6
C	10
D OR E	8

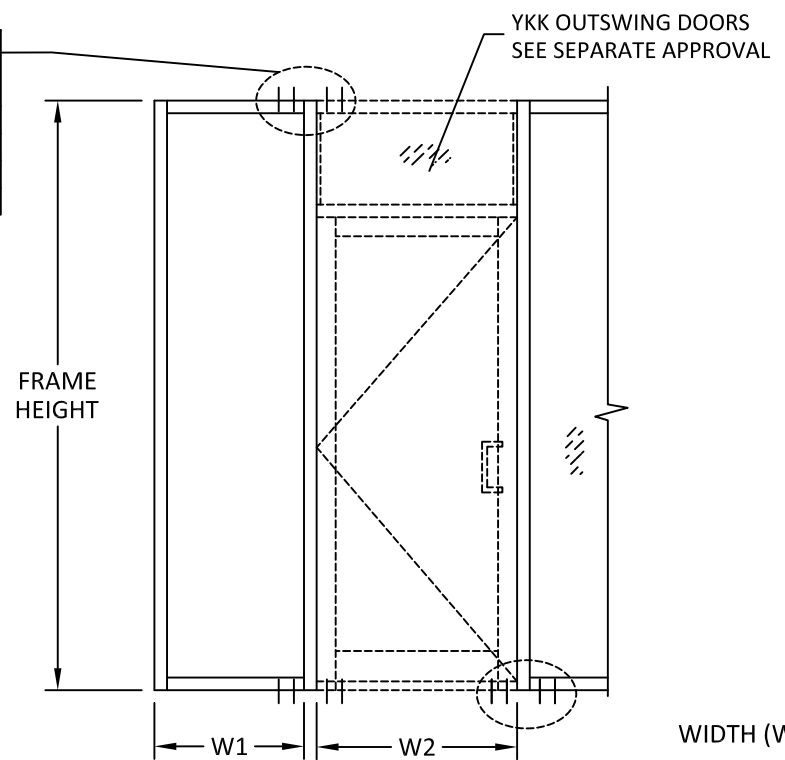

$$\text{WIDTH (W)} = \frac{W1 + W2}{2}$$

SINGLE DOOR WITH TRANSOM

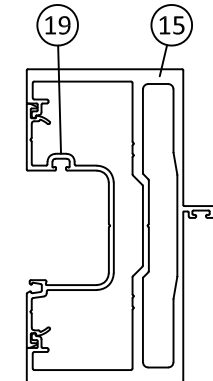

DOOR MULLION WITHOUT STEEL REINFORCEMENT

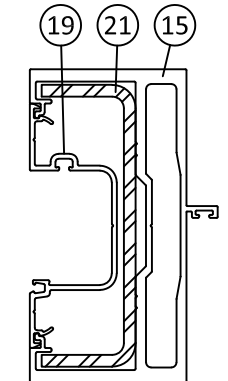

DOOR MULLION WITH STEEL REINFORCEMENT

TITLE: YHS 50 TU ALUMINUM STOREFRONT SYSTEM - OUTSIDE GLAZED (IMPACT)
 DOOR MULLION TABLE (1)

PREPARED BY: **BUILDING DROPS, INC.**
 398 E. DANIA BEACH BLVD., STE. 338
 DANIA BEACH, FL 33004
 PH: (954)399-8478
 FAX: (954)744-4738
 WEB: www.buildingdrops.com

REMARKS	BY	DATE

THE INSTALLATION DETAILS DESCRIBED HEREIN ARE GENERIC AND MAY NOT REFLECT ACTUAL CONDITIONS FOR A SPECIFIC SITE. IF SITE CONDITIONS CAUSE INSTALLATION TO DEVIATE FROM THE REQUIREMENTS DETAILED HEREIN, A LICENSED ENGINEER OR ARCHITECT SHALL PREPARE SITE SPECIFIC DOCUMENTS FOR USE WITH THIS DOCUMENT.



HERMES F. NORERO, P.E.
 TEXAS P.E. No 118471
 BUILDING DROPS, INC
 398 E. DANIA BEACH BLVD. # 338
 DANIA BEACH, FL 33004
 TBPE FIRM No. 13734

DATE:	09.20.21	
DWG. BY:	MS	CHK. BY: HFN
SCALE:	NTS	
DWG. #:	YKK281	
SHEET:	8	

s:\projects\ykk_ap_america, inc\tdi-21-0919 - tdi submittal - revision cwsf 51, cwsf 52, cwsf 53\dwgs\ykk281_yhs 50 tu og_wr3.dwg 10/27/2021 4:27 PM

DOOR MULLION LOAD & ANCHOR TABLES



YKK AP AMERICA, INC.
 1229 HWY 441 BYPASS
 DUBLIN, GEORGIA 31021
 PH: (478)277-1955 FAX: (678)838-6001

DOOR MULLION LOAD CAPACITY						
NOMINAL DIMS.			WITHOUT STEEL REINF.		WITH STEEL REINF.	
FRAME HEIGHT (IN.)	DOOR PANEL WIDTH - W1 (IN.)	SIDELITE WIDTH - W2 (IN.)	EXT. (+)	INT. (-)	EXT. (+)	INT. (-)
96	36	30	70.0	70.0	70.0	90.0
		36	70.0	70.0	70.0	90.0
		42	70.0	70.0	70.0	90.0
		48	70.0	70.0	70.0	90.0
	42	30	70.0	70.0	70.0	90.0
		36	70.0	70.0	70.0	90.0
		42	70.0	70.0	70.0	90.0
		48	70.0	70.0	70.0	90.0
	48	30	70.0	70.0	70.0	90.0
		36	70.0	70.0	70.0	90.0
		42	70.0	70.0	70.0	90.0
		48	70.0	70.0	70.0	90.0
102	36	30	70.0	70.0	70.0	90.0
		36	70.0	70.0	70.0	90.0
		42	70.0	70.0	70.0	90.0
		48	70.0	70.0	70.0	90.0
	42	30	70.0	70.0	70.0	90.0
		36	70.0	70.0	70.0	90.0
		42	70.0	70.0	70.0	90.0
		48	70.0	70.0	70.0	90.0
	48	30	70.0	70.0	70.0	90.0
		36	70.0	70.0	70.0	90.0
		42	70.0	70.0	70.0	90.0
		48	70.0	70.0	70.0	90.0
108	36	30	70.0	70.0	70.0	90.0
		36	70.0	70.0	70.0	90.0
		42	70.0	70.0	70.0	90.0
		48	70.0	70.0	70.0	90.0
	42	30	70.0	70.0	70.0	90.0
		36	70.0	70.0	70.0	90.0
		42	70.0	70.0	70.0	90.0
		48	70.0	70.0	70.0	90.0
	48	30	70.0	70.0	70.0	90.0
		36	70.0	70.0	70.0	90.0
		42	70.0	70.0	70.0	90.0
		48	57.1	55.0	70.0	90.0

DOOR MULLION LOAD CAPACITY						
NOMINAL DIMS.			WITHOUT STEEL REINF.		WITH STEEL REINF.	
FRAME HEIGHT (IN.)	DOOR PANEL WIDTH - W1 (IN.)	SIDELITE WIDTH - W2 (IN.)	EXT. (+)	INT. (-)	EXT. (+)	INT. (-)
114	36	30	70.0	70.0	70.0	90.0
		36	70.0	70.0	70.0	90.0
		42	70.0	70.0	70.0	90.0
		48	69.8	69.8	70.0	90.0
	42	30	70.0	70.0	70.0	90.0
		36	69.8	69.8	70.0	90.0
		42	66.6	66.6	70.0	90.0
		48	63.6	63.6	70.0	90.0
	48	30	66.6	66.6	70.0	90.0
		36	63.6	63.6	70.0	90.0
		42	57.1	55.0	70.0	90.0
		48	57.1	55.0	70.0	90.0
120	36	30	69.9	69.9	70.0	90.0
		36	66.2	66.2	70.0	90.0
		42	62.8	62.8	70.0	90.0
		48	59.8	59.8	70.0	90.0
	42	30	62.8	62.8	70.0	90.0
		36	59.8	59.8	70.0	90.0
		42	57.1	57.1	70.0	90.0
		48	57.1	55.0	70.0	90.0
	48	30	57.1	57.1	70.0	90.0
		36	57.1	55.0	70.0	90.0
		42	57.1	55.0	70.0	90.0
		44	57.1	55.0	70.0	90.0

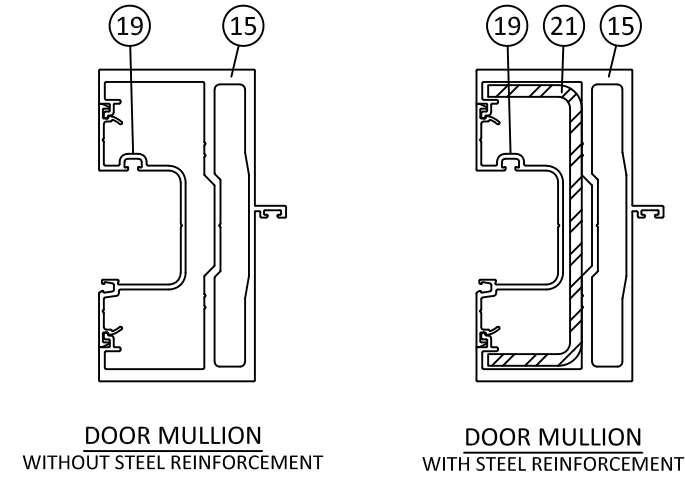

ANCHOR TYPES	TOTAL NO. OF ANCHORS AT DOOR MULLION HEAD AND SILL
A	10
B	6
C	10
D OR E	8

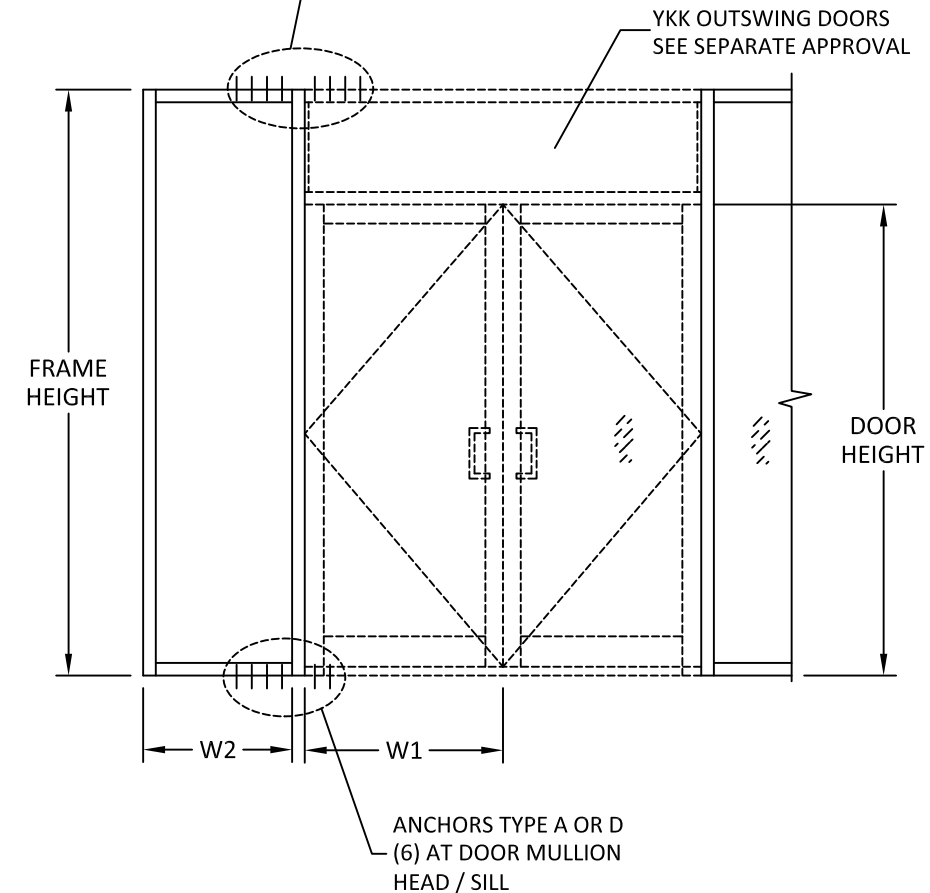

DOUBLE DOOR WITH TRANSOM

TITLE: YHS 50 TU ALUMINUM STOREFRONT SYSTEM - OUTSIDE GLAZED (IMPACT)
 DOOR MULLION TABLE (2)

PREPARED BY: **B.D. BUILDING DROPS**
 BUILDING DROPS, INC.
 398 E. DANIA BEACH BLVD., STE. 338
 DANIA BEACH, FL 33004
 PH: (954)399-8478
 FAX: (954)744-4738
 WEB: www.buildingdrops.com

REMARKS	BY	DATE

THE INSTALLATION DETAILS DESCRIBED HEREIN ARE GENERIC AND MAY NOT REFLECT ACTUAL CONDITIONS FOR A SPECIFIC SITE. IF SITE CONDITIONS CAUSE INSTALLATION TO DEVIATE FROM THE REQUIREMENTS DETAILED HEREIN, A LICENSED ENGINEER OR ARCHITECT SHALL PREPARE SITE SPECIFIC DOCUMENTS FOR USE WITH THIS DOCUMENT.



HERMES F. NORERO, P.E.
 TEXAS P.E. No. 118471
 BUILDING DROPS, INC
 398 E. DANIA BEACH BLVD. # 338
 DANIA BEACH, FL 33004
 TBPE FIRM No. 13734

DATE:	09.20.21
DWG. BY:	MS
CHK. BY:	HFN
SCALE:	NTS
DWG. #:	YKK281
SHEET:	9

TITLE: YHS 50 TU ALUMINUM STOREFRONT SYSTEM - OUTSIDE GLAZED (IMPACT)

VERTICAL SECTIONS & ANCHOR DESCRIPTIONS

PREPARED BY: **BUILDING DROPS, INC.**
398 E. DANIA BEACH BLVD., STE. 338
DANIA BEACH, FL 33004
PH: (954)399-8478
FAX: (954)744-4738
WEB: www.buildingdrops.com



REMARKS	BY	DATE

THE INSTALLATION DETAILS DESCRIBED HEREIN ARE GENERIC AND MAY NOT REFLECT ACTUAL CONDITIONS FOR A SPECIFIC SITE. IF SITE CONDITIONS CAUSE INSTALLATION TO DEVIATE FROM THE REQUIREMENTS DETAILED HEREIN, A LICENSED ENGINEER OR ARCHITECT SHALL PREPARE SITE SPECIFIC DOCUMENTS FOR USE WITH THIS DOCUMENT.

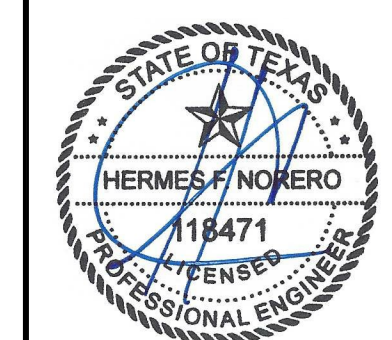

HERMES F. NORERO, P.E.
TEXAS P.E. No. 118471
BUILDING DROPS, INC.
398 E. DANIA BEACH BLVD. # 338
DANIA BEACH, FL 33004
TBPE FIRM No. 13734

DATE:	09.20.21
DWG. BY:	MS
CHK. BY:	HFN
SCALE:	NTS
DWG. #:	YKK281
SHEET:	10

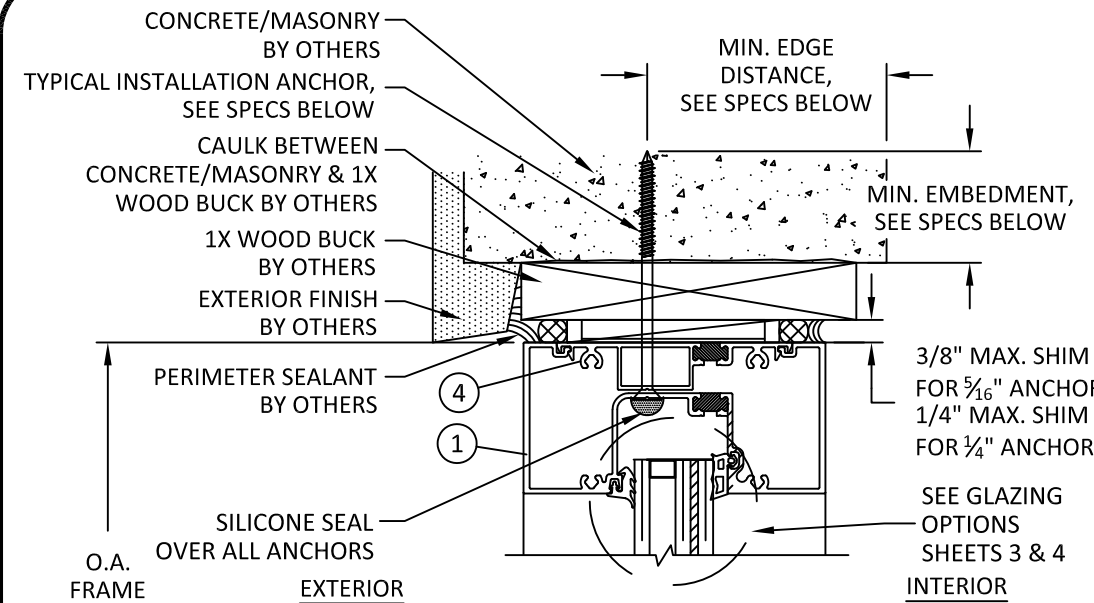

A 10 VERTICAL SECTION
HEAD - CONCRETE/MASONRY W/ 1X BUCK

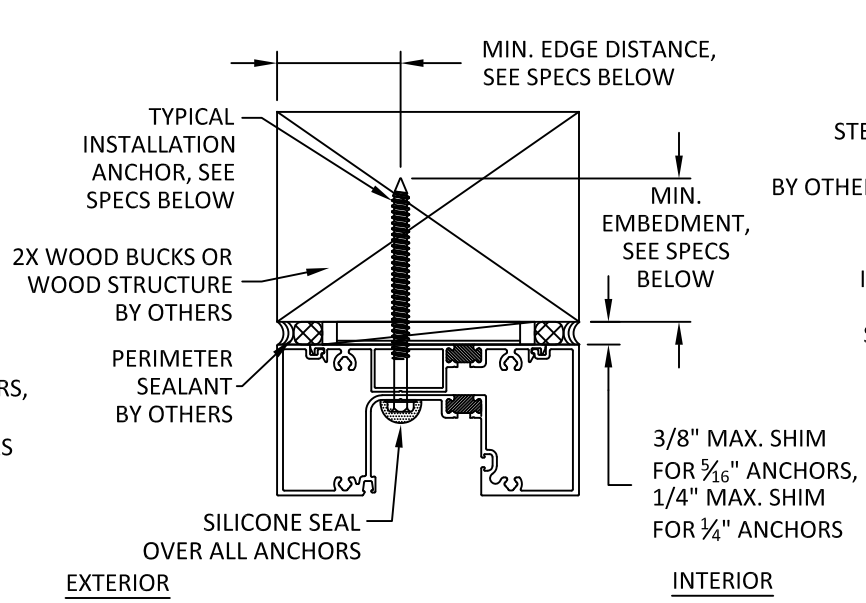

D 10 VERTICAL SECTION
HEAD - WOOD FRAMING
TYPICAL INSTALLATION

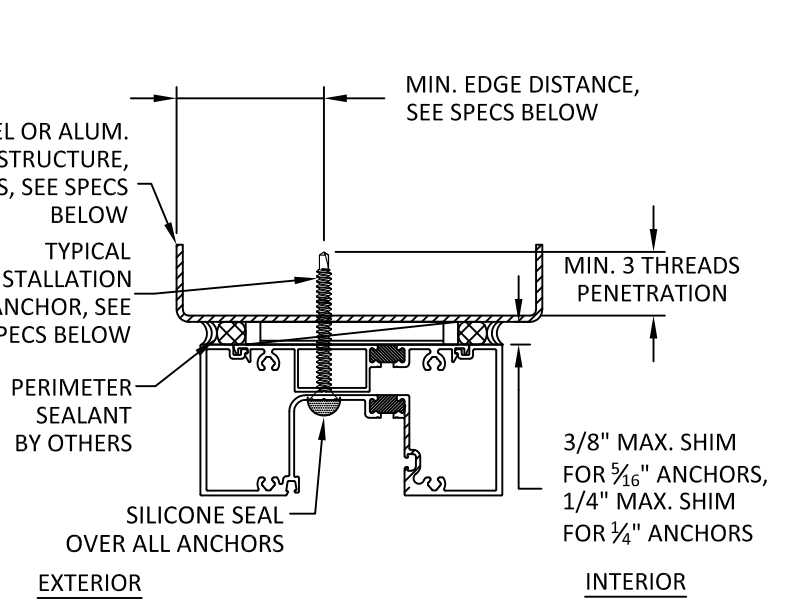

E 10 VERTICAL SECTION
HEAD - METAL SUBSTRATE
TYPICAL INSTALLATION

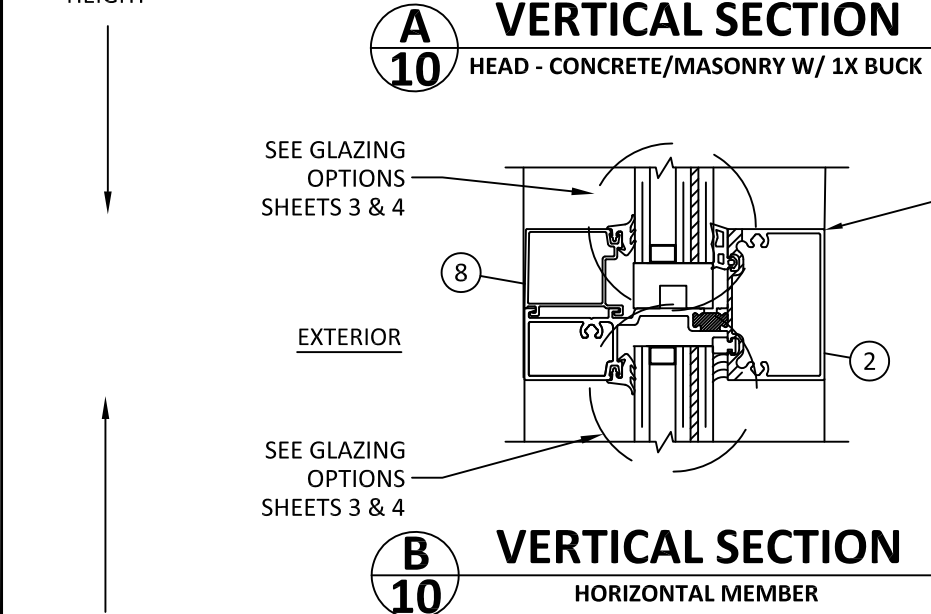

B 10 VERTICAL SECTION
HORIZONTAL MEMBER

LIMIT DESIGN LOADS FOR HORIZONTAL AS FOLLOWS		
MAX HORIZ. SPAN	MAX GLASS HEIGHT ABOVE HORIZ.	MAX DESIGN LOADS
60"	54"	70 PSF
60"	84"	54 PSF
66"	54"	48 PSF
66"	84"	34 PSF
72"	54"	33 PSF
72"	84"	20 PSF

DESIGN LOADS SHOWN ABOVE ARE BASED ON MAX. GLASS AREA ABOVE HORIZONTAL FOR SMALLER GLASS ABOVE HORIZONTAL DESIGN LOADS TO BE CALCULATED SEPARATELY.

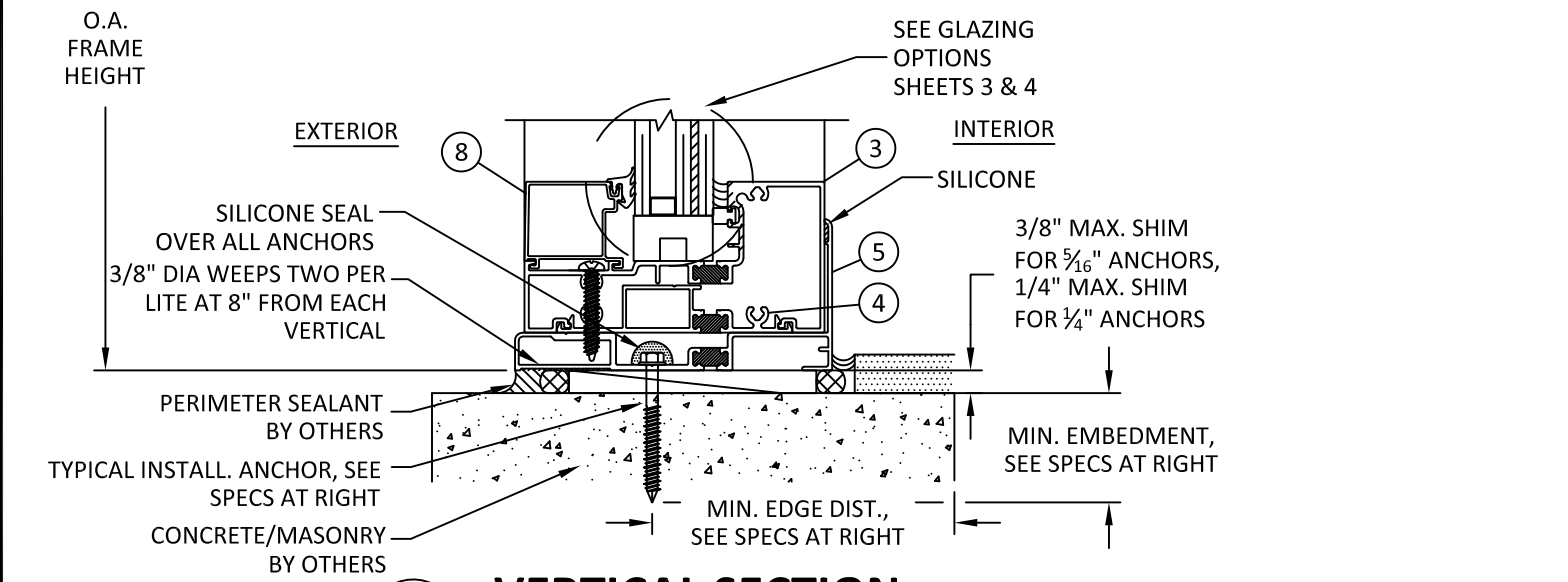

C 10 VERTICAL SECTION
SILL - DIRECT TO CONCRETE/MASONRY

YHS 50 TU ANCHOR TYPES					
ANCHOR TYPE	ANCHOR DESCRIPTION	SUBSTRATE REQUIREMENTS	MIN. EMBEDMENT	MIN. EDGE DISTANCE	NOTES
A	5/16" DIA. TAPCON BY ITW (Fu=125 KSI, Fy=100 KSI)	CONCRETE AT HEAD, SILL OR JAMBS F'C = 3000 PSI MIN.	1-3/4"	3"	FOR USE THROUGH OPTIONAL 1X BUCKS, BY OTHERS
	5/16" DIA. ULTRACON BY ELCO (Fu=177 KSI, Fy=155 KSI)	C-90 HOLLOW/FILLED BLOCK AT JAMBS F'M = 2000 PSI MIN.	1"	3"	
	5/16" DIA. ULTRACON BY ELCO (Fu=177 KSI, Fy=155 KSI)	MIN. S.G. = 0.42 WOOD	1-1/2"	1"	--
B	5/16" DIA. SELF-DRILLING SCREWS (GRADE 5)	STEEL: 12 GA. MIN., Fy=36 KSI MIN. ALUM.: 1/8" MIN., 6063-T5 MIN.	THREE THREADS PENETRATION PAST METAL STRUCTURE	3/4"	STEEL IN CONTACT WITH ALUM. TO BE PLATED OR PAINTED
C	1/4" DIA. TAPCON BY ITW (Fu=125 KSI, Fy=100 KSI)	CONCRETE AT HEAD, SILL OR JAMBS F'C = 3000 PSI MIN.	1-3/4"	2-1/2"	FOR USE THROUGH OPTIONAL 1X BUCKS, BY OTHERS
	1/4" DIA. ULTRACON BY ELCO (Fu=177 KSI, Fy=155 KSI)	C-90 HOLLOW/FILLED BLOCK AT JAMBS F'M = 2000 PSI MIN.	1-3/4"	2-1/2"	
	1/4" DIA. ULTRACON BY ELCO (Fu=177 KSI, Fy=155 KSI)	MIN. S.G. = 0.42 WOOD	1-1/2"	1"	--
D	1/4" DIA. SELF-DRILLING SCREWS	STEEL: 12 GA. MIN., Fy=36 KSI MIN. ALUM.: 1/8" MIN., 6063-T5 MIN.	3 THREADS PENETRATION PAST METAL STRUCTURE	3/4"	STEEL IN CONTACT WITH ALUM. TO BE PLATED OR PAINTED
E	1/4" DIA. SELF-DRILLING SCREWS	18 GA. MIN. STEEL STUD, Fy = 33 KSI MIN. WITH WOOD BACKING	1-1/2" IN WOOD	1" IN WOOD	--

s:\projects\ykk_ap_america, inc.\tdi-21-0919 - tdi submittal - revision cwsf 51, cwsf 52, cwsf 53\dwg\ykk281_yhs 50 tu og_wr3.dwg 10/27/2021 4:27 PM

TITLE: YHS 50 TU ALUMINUM STOREFRONT SYSTEM - OUTSIDE GLAZED (IMPACT)
 HORIZONTAL SECTIONS
 PREPARED BY: **B.D. BUILDING DROPS**
 BUILDING DROPS, INC.
 398 E. DANIA BEACH BLVD., STE. 338
 DANIA BEACH, FL 33004
 PH: (954)399-8478
 FAX: (954)744-4738
 WEB: www.buildingdrops.com

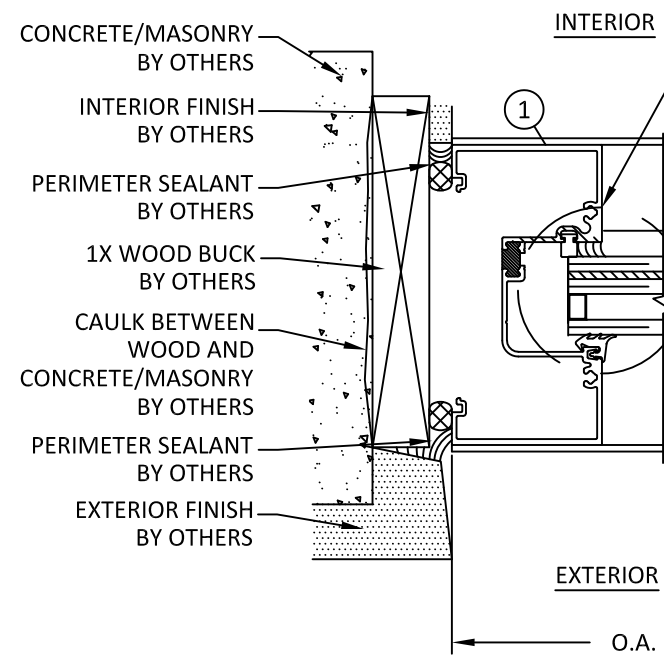

F **HORIZONTAL SECTION 11**
JAMB - CONCRETE/MASONRY W/ 1X BUCK STANDARD CONFIGURATION

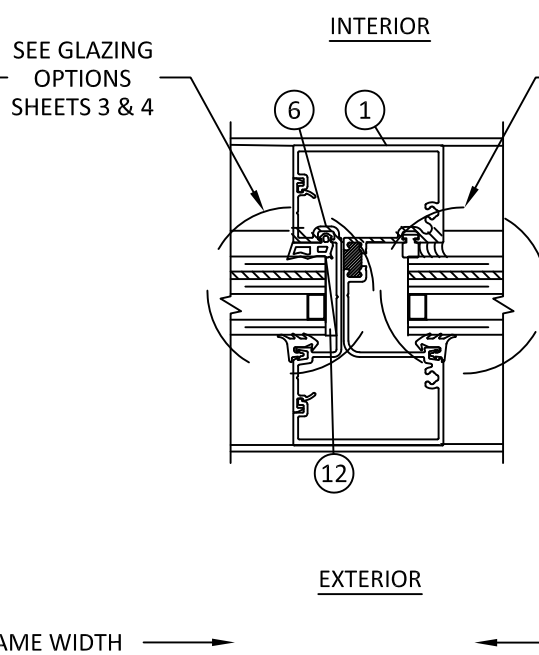

G **HORIZONTAL SECTION 11**
VERTICAL MULLION STANDARD CONFIGURATION

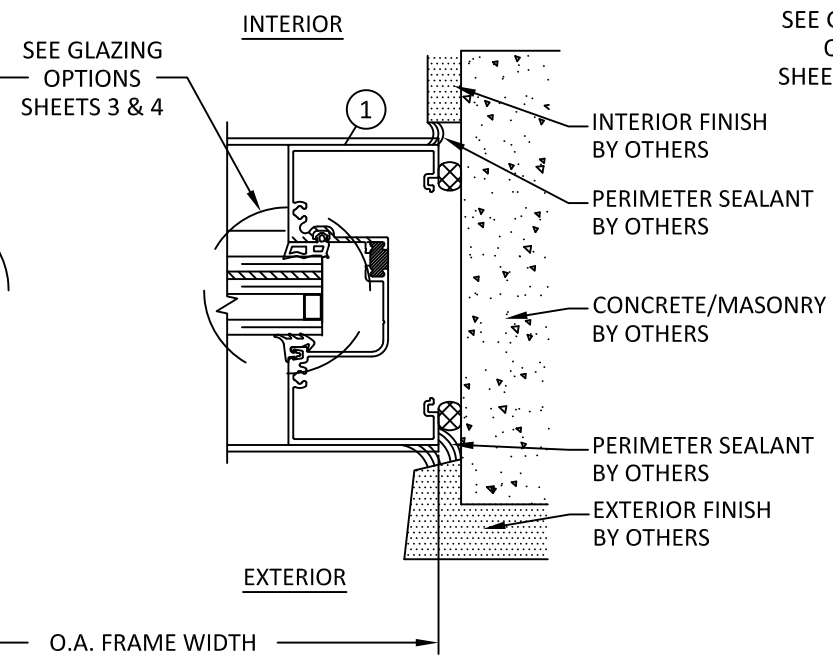

H **HORIZONTAL SECTION 11**
JAMB - DIRECT TO CONCRETE/MASONRY STANDARD CONFIGURATION

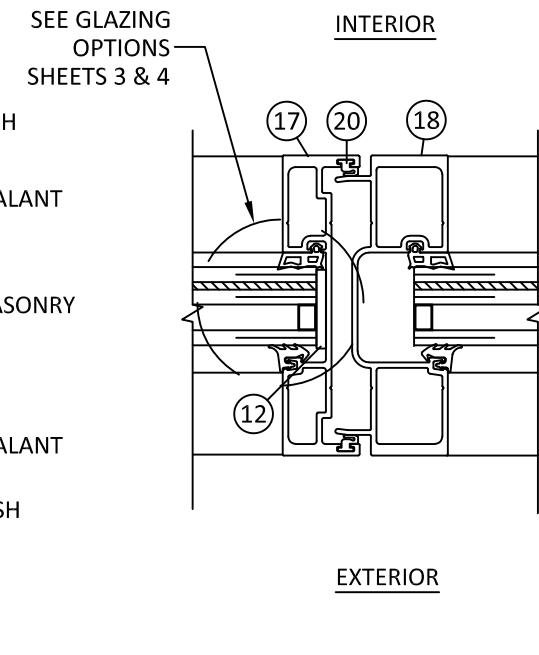

I **HORIZONTAL SECTION 11**
VERTICAL EXPANSION MULLION

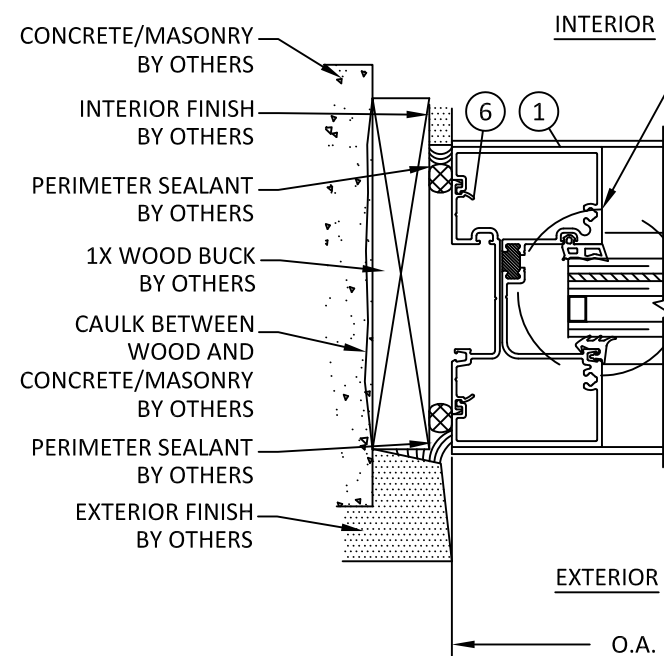

J **HORIZONTAL SECTION 11**
JAMB - CONCRETE/MASONRY W/ 1X BUCK HEAVY CONFIGURATION

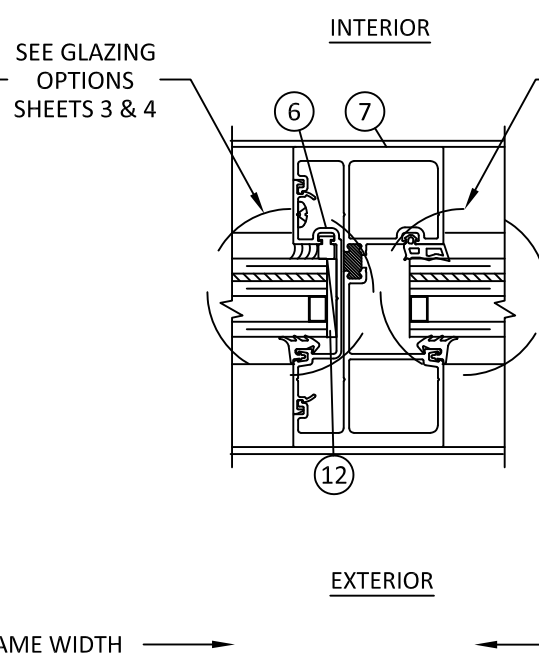

K **HORIZONTAL SECTION 11**
VERTICAL MULLION HEAVY CONFIGURATION

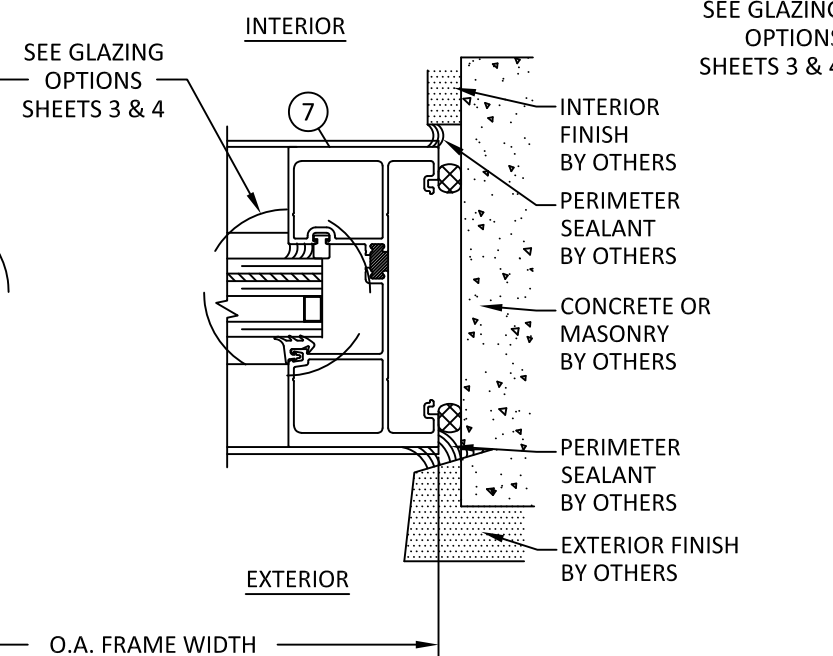

L **HORIZONTAL SECTION 11**
JAMB - DIRECT TO CONCRETE/MASONRY HEAVY CONFIGURATION

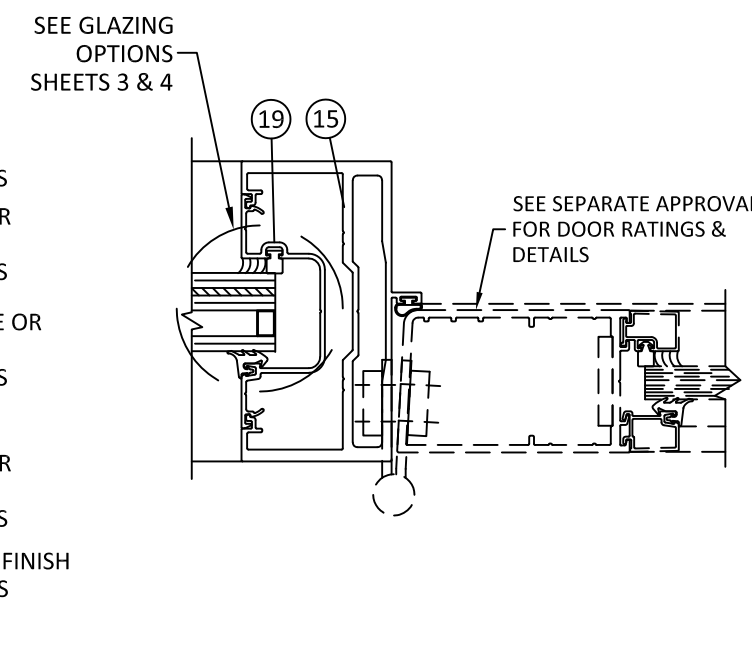

M **HORIZONTAL SECTION 11**
DOOR JAMB MULLION

REMARKS	BY	DATE

THE INSTALLATION DETAILS DESCRIBED HEREIN ARE GENERIC AND MAY NOT REFLECT ACTUAL CONDITIONS FOR A SPECIFIC SITE. IF SITE CONDITIONS CAUSE INSTALLATION TO DEVIATE FROM THE REQUIREMENTS DETAILED HEREIN, A LICENSED ENGINEER OR ARCHITECT SHALL PREPARE SITE SPECIFIC DOCUMENTS FOR USE WITH THIS DOCUMENT.



HERMES F. NORERO, P.E.
 TEXAS P.E. No. 118471
 BUILDING DROPS, INC.
 398 E. DANIA BEACH BLVD. # 338
 DANIA BEACH, FL 33004
 TBPE FIRM No. 13734

DATE:	09.20.21	
DWG. BY:	MS	CHK. BY: HFN
SCALE:	NTS	
DWG. #:	YKK281	
SHEET:	11	

10/27/2021 4:27 PM s:\projects\ykk_ap_america, inc.\tbl-21-0919 - tbl-submittal - revision cwsf 51, cwsf 52, cwsf 53\dwg\ykk281_yhs 50 tu og_wr3.dwg

10/27/2021 4:28 PM

ITEM	PART NO.	DESCRIPTION	MATERIAL
1	BE9-0681	HEAD / JAMB / VERTICAL	6063-T5
2	BE9-0683	HORIZONTAL	6063-T5
3	BE9-0682	SILL	6063-T5
4	E1-1060	ANCHOR FILLER	6063-T5
5	BE9-0687	SILL FLASHING	6063-T5
6	BE9-0655	SHALLOW POCKET FILLER	6063-T5
7	BE9-0684	HEAVY DUTY VERTICAL	6063-T5
8	E9-0658	GLASS STOP	6063-T5
9	E2-0083	EXTERIOR GLAZING GASKET	EPDM
10	E2-0088	INTERIOR GLAZING GASKET	EPDM
11	E2-0095	SETTING BLOCK	EPDM (85±5)
12	E2-0096	SIDE BLOCK	EPDM
13	PC-1220	#12 x 1-1/4" PHSMS Type AB	ZINC PLATED STEEL
14	PC-1424	#14 x 1-1/2" PHSMS Type AB	ZINC PLATED STEEL
15	E9-0504	DOOR JAMB O/P	6063-T6
16	E2-0084	INTERIOR SILICONE SPACER	SILICONE
17	BE9-0688	EXPANSION MULLION (FEMALE)	6063-T6
18	BE9-0689	EXPANSION MULLION (MALE)	6063-T6
19	E9-0656	DEEP POCKET FILLER	6063-T5
20	K2-2441	WEATHERING GASKET	EPDM
21	E1-1062	STEEL CHANNEL (1-1/2" X 4-1/2" X 3/16")	A36 STEEL

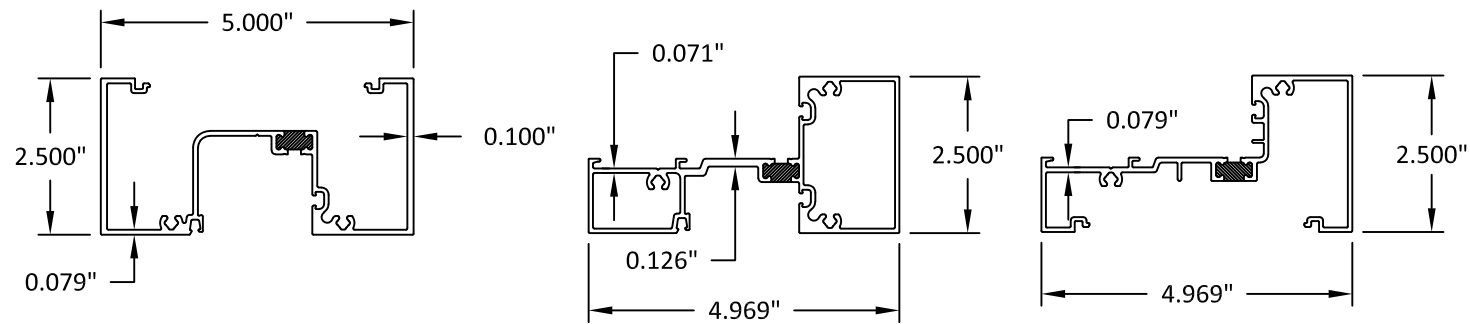

1 HEAD/JAMB/VERTICAL 2 HORIZONTAL 3 SILL

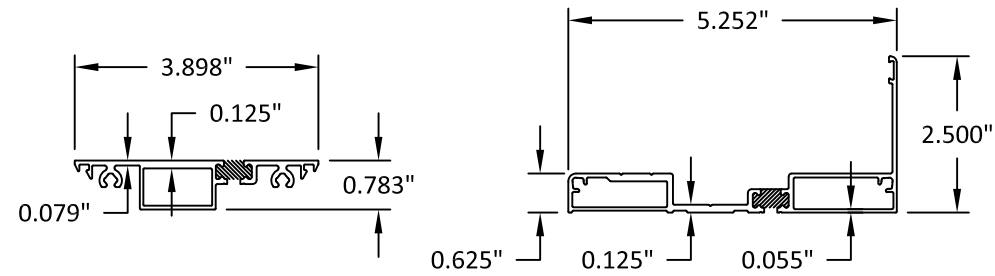

4 ANCHOR FILLER 5 SILL FLASHING

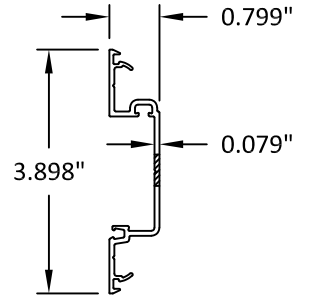

6 SHALLOW POCKET FILLER

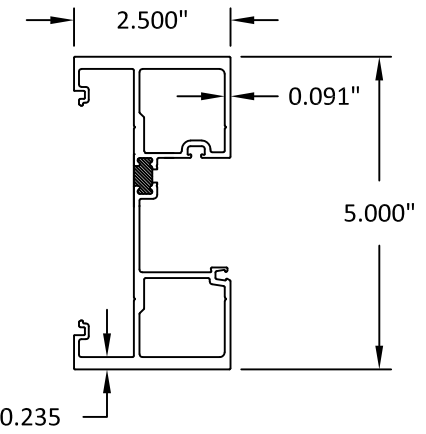

7 HEAVY DUTY VERTICAL

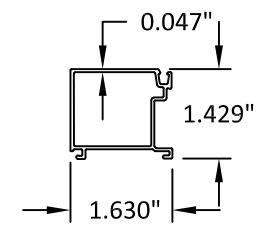

8 GLAZING STOP

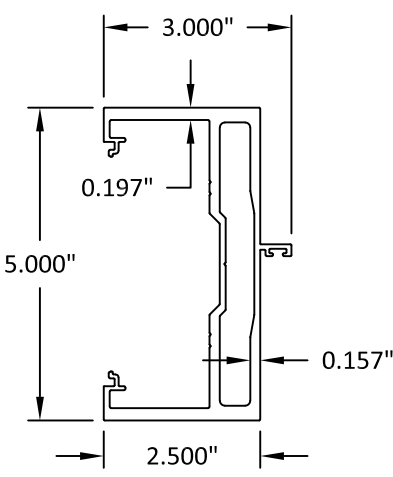

15 DOOR MULLION O/P

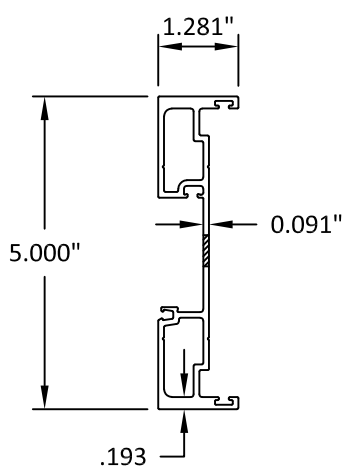

17 EXPANSION MULLION (FEMALE)

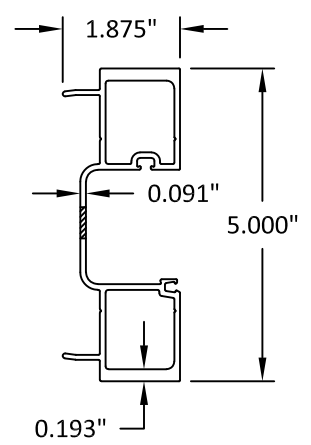

18 EXPANSION MULLION (MALE)

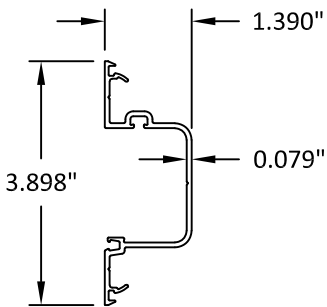

19 DEEP POCKET FILLER

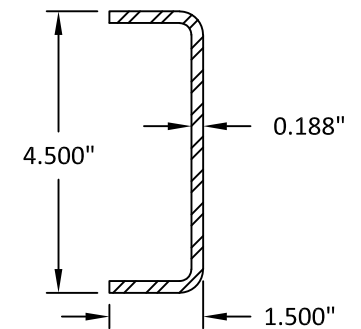

21 DOOR MULLION REINFORCEMENT



YKK AP AMERICA, INC.
 1229 HWY 441 BYPASS
 DUBLIN, GEORGIA 31021
 PH: (478)277-1955 FAX: (678)838-6001

TITLE: YHS 50 TU ALUMINUM STOREFRONT SYSTEM - OUTSIDE GLAZED (IMPACT)
 COMPONENTS & BILL OF MATERIALS
 PREPARED BY: **BUILDING DROPS, INC.**
 398 E. DANIA BEACH BLVD., STE. 338
 DANIA BEACH, FL 33004
 PH: (954)399-8478
 FAX: (954)744-4738
 WEB: www.buildingdrops.com

REMARKS	BY	DATE

THE INSTALLATION DETAILS DESCRIBED HEREIN ARE GENERIC AND MAY NOT REFLECT ACTUAL CONDITIONS FOR A SPECIFIC SITE. IF SITE CONDITIONS CAUSE INSTALLATION TO DEVIATE FROM THE REQUIREMENTS DETAILED HEREIN, A LICENSED ENGINEER OR ARCHITECT SHALL PREPARE SITE SPECIFIC DOCUMENTS FOR USE WITH THIS DOCUMENT.



HERMES F. NORERO, P.E.
 TEXAS P.E. No. 118471
 BUILDING DROPS, INC
 398 E. DANIA BEACH BLVD. # 338
 DANIA BEACH, FL 33004
 TBPE FIRM No. 13734

DATE:	09.20.21
DWG. BY:	MS
CHK. BY:	HFN
SCALE:	NTS
DWG. #:	YKK281
SHEET:	12

s:\projects\ykk_ap_america, inc\tdr-21-0919 - tdr submittal - revision cwsf 51, cwsf 52, cwsf 53\dwgs\ykk281_yhs 50 tu og_wr3.dwg