

MODEL	FASTENER G		FASTENER H		FASTENER J		FASTENER K	
	QTY.	DESCRIPTION	QTY.	DESCRIPTION	QTY.	DESCRIPTION	QTY.	DESCRIPTION
USGF-140/HP USGF-160/HP/XP	16 EA.	TCS 1/4-20 X 3/4 DACROMET COATED	4	RIVET, 1/4 X 5/8 SEMI TUBULAR 5052 ALUM.	4	SCREW, 1/4-20 X 5/8 18-8/SS	4	PAL NUT, 1/4-20 SPRING STEEL
USGF-180/HP USGF-200/HP	24 EA.		6					

DESIGN LIMITS USGF-140/HP AND USGF-160/HP/XP	
Max: Design Load:	±130 psf (6.2 Kpa)
Max: Overall Enclosure Dia.	28.95 in. (735 mm)
Max: Overall Unit Height W/CURB	53.00 in. (1130 mm)
Max: Overall Unit Height W/O CURB	29.00 in. (737 mm)
Max: CURB CAP SQ. DIM.:	26.00 in. (660 mm)
Max: ROOF CURB SQ. DIM.:	24.75 in. (629 mm)
Max: ROOF CURB HEIGHT:	24.00 in. (610 mm)
QUALIFIED SUBSTRATES	3000 psi Concrete, 1/8" Steel

DESIGN LIMITS USGF-180/HP AND USGF-200/HP	
Max: Design Load:	±130 psf (6.2 Kpa)
Max: Overall Enclosure Dia.	35.45 in. (900 mm)
Max: Overall Unit Height W/CURB	56.85 in. (951 mm)
Max: Overall Unit Height W/O CURB	32.85 in. (834 mm)
Max: CURB CAP SQ. DIM.:	30.00 in. (762 mm)
Max: ROOF CURB SQ. DIM.:	28.75 in. (730 mm)
Max: ROOF CURB HEIGHT:	24.00 in. (610 mm)
QUALIFIED SUBSTRATES	3000 psi Concrete, 1/8" Steel

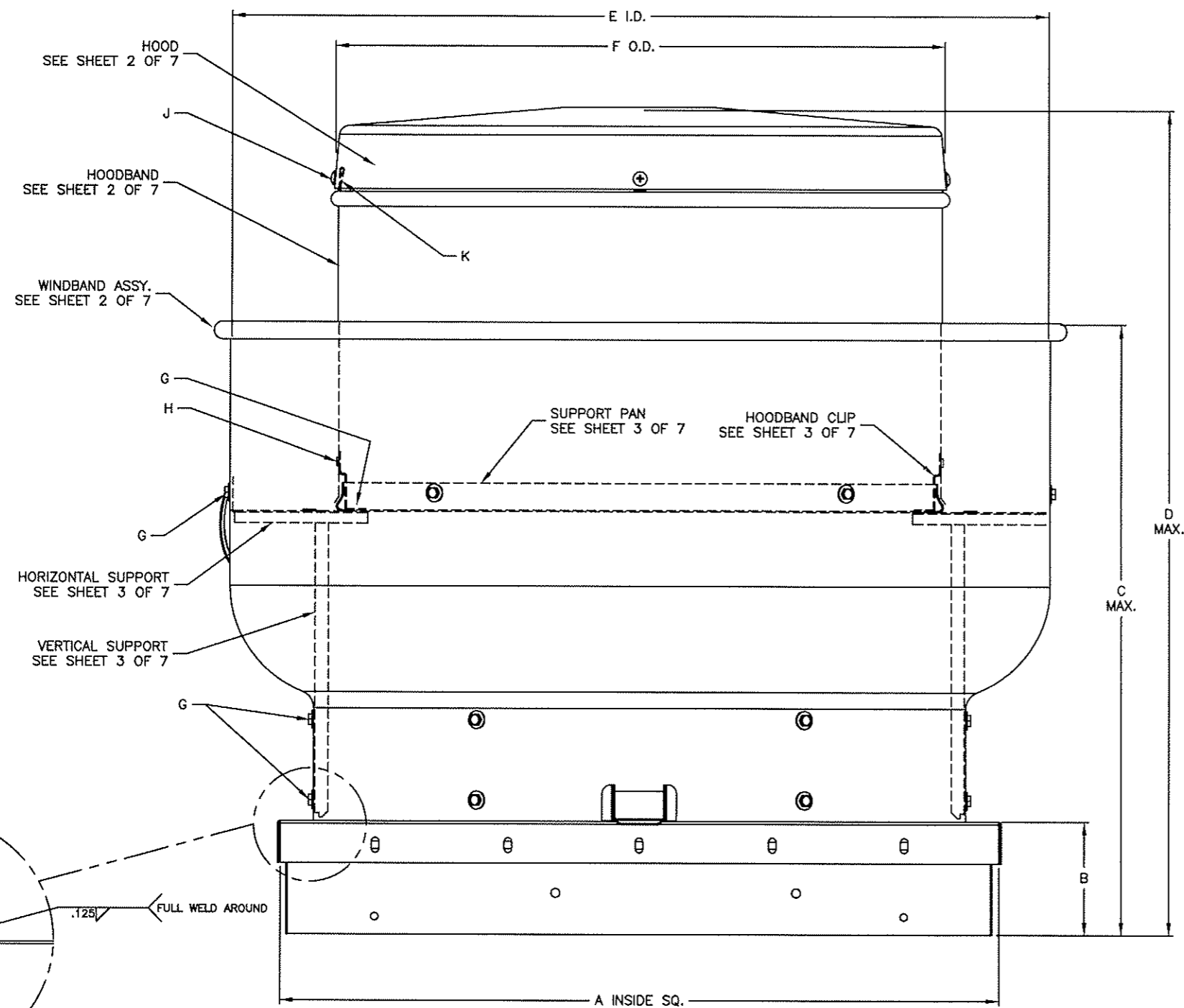

ALL DIMENSIONS ARE IN INCHES

MODEL	A	B	C	D	E	F	WEIGHT LBS.
USGF-140/HP	26.00	3.75	23.35	33.75	27.70	21.00	84
USGF-160/HP/XP	26.00	1.75	20.35	32.20	27.70	21.00	87
USGF-180/HP	30.00	1.75	22.72	33.75	34.20	25.20	126
USGF-200/HP	30.00	1.75	22.72	33.75	34.20	25.20	142

NOTES:

1. ROOF STRUCTURE MUST BE DESIGNED TO WITHSTAND THE WEIGHT AND LOADING TRANSMITTED BY ROOF TOP FANS. FASTENERS SHALL BE AS SPECIFIED AND INSTALLED AS DETAILED.
2. DESIGN TESTING AND INSTALLATION CONFORMS TO AISC MANUAL OF STEEL CONSTRUCTION AND ALUMINUM DESIGN MANUAL.
3. FAN CURBS MUST BE ANCHORED TO ROOF FRAMING MEMBERS AND NOT TO THE ROOFING SYSTEM.
4. DESIGN, TESTING, AND INSTALLATION CONFORMS TO THE TEXAS REVISIONS TO THE 2006 INTERNATIONAL BUILDING CODE AND THE TEXAS REVISIONS TO THE 2006 INTERNATIONAL RESIDENTIAL CODE
5. THIS APPROVAL IS FOR THE STRUCTURAL PERFORMANCE AND IMPACT RESISTANCE ONLY. INTERIOR MECHANISM AND/OR ELECTRICAL CIRCUITRY ARE OUTSIDE THE SCOPE OF THIS APPROVAL.

RICE
ENGINEERING

105 School Creek Trail
Luxemburg, WI 54217
Phone: 920.845.1042
Fax: 920.845.1048
www.rice-inc.com

Texas Firm No: F-2183
L. David Rice
Registration No: 81248

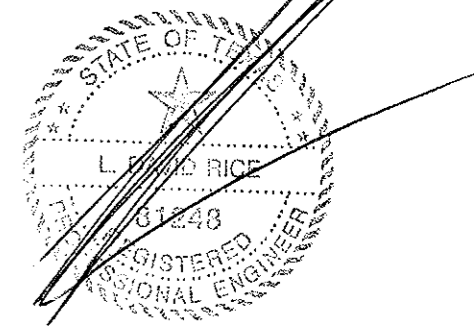

AUG 15 2012

	DATE: 03/30/2012 DRAWN BY: PEEIFFER CHECKED BY: PEEIFFER PROJECT: USGF-140 THRU 200 SHEET 1 OF 5	USGF-140/HP USGF-160/HP/XP USGF-180/HP USGF-200/HP
	1/3	HSS5001

WINDBAND TO CURB CAP CONNECTION
TYP. ALL MODELS

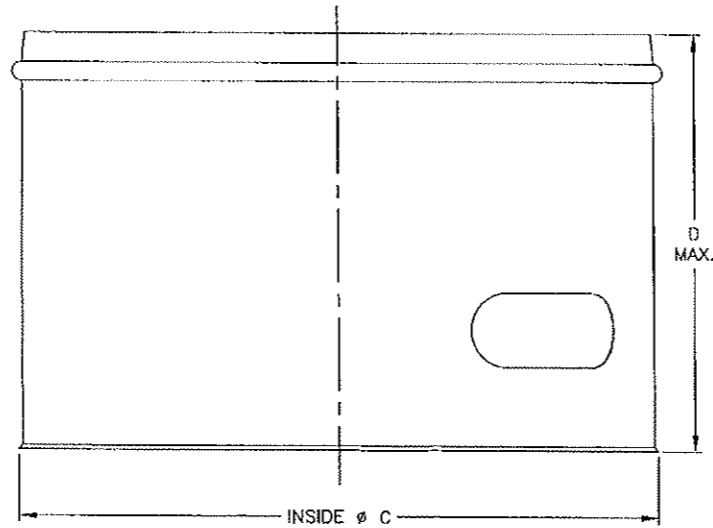
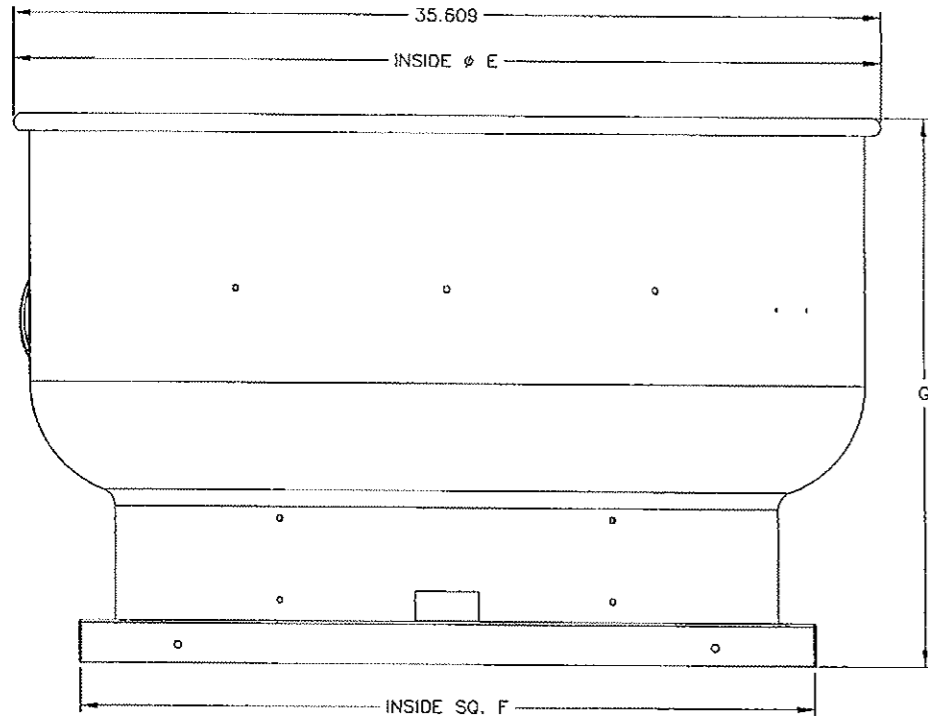
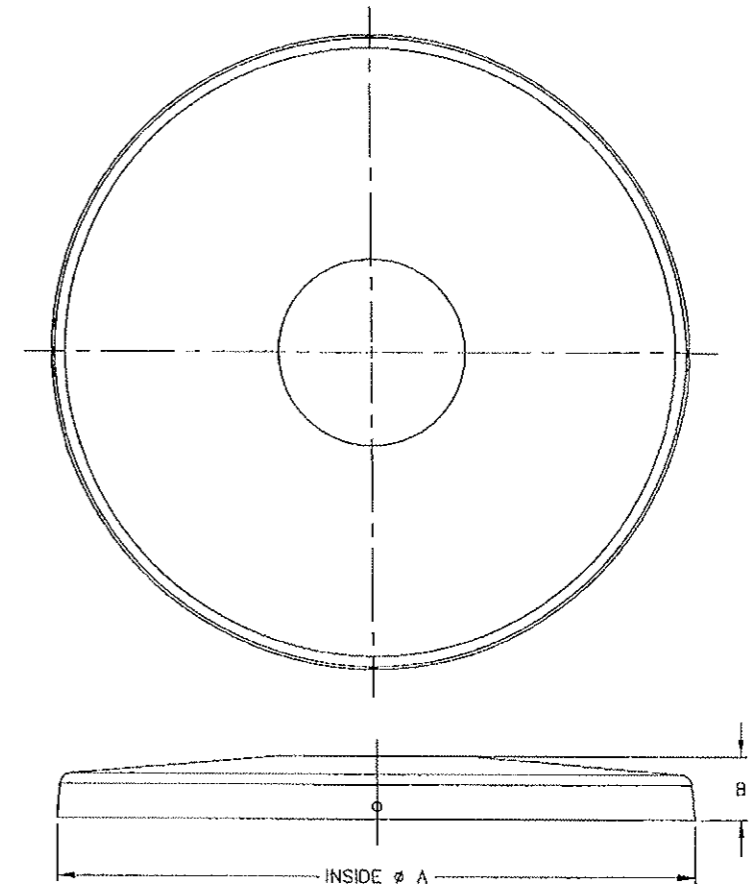
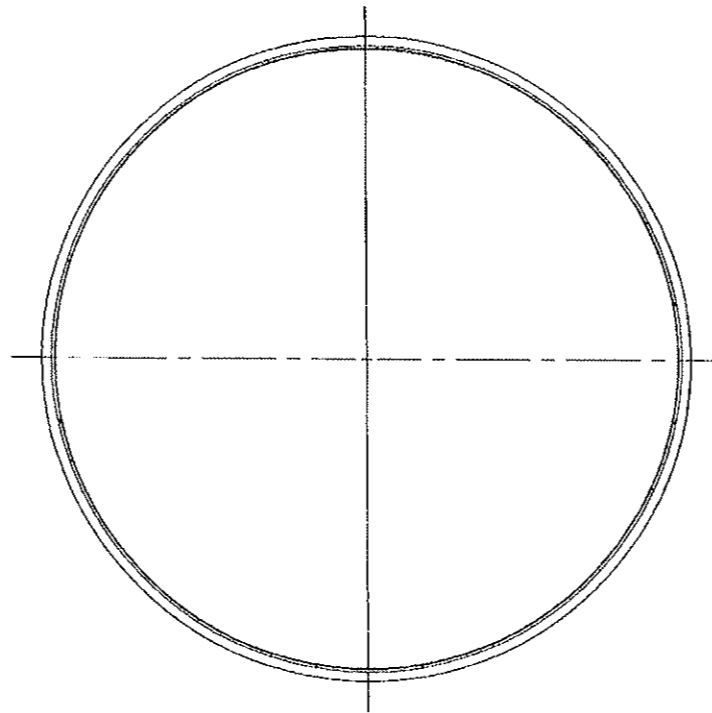
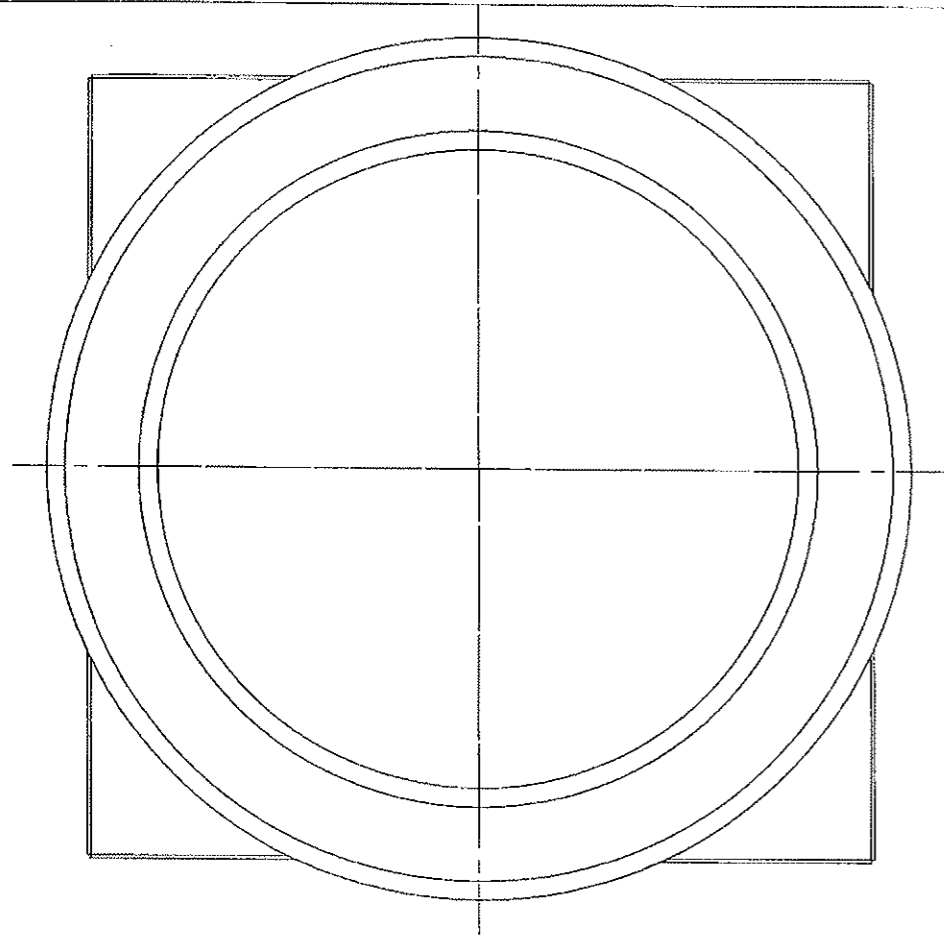

HOUSING ASSY.
1 REQ'D. PER UNIT

HOODBAND
1 REQ'D. PER UNIT

HOOD
1 REQ'D. PER UNIT

MODEL	E	F	G	MATERIAL
USGF-140/HP-160/HP/XP	27.70	26.00	20.35	16GA. CRDS
USGF-180/HP-200/HP	34.20	30.00	22.75	16GA. CRDS

MODEL	C	D	MATERIAL
USGF-140/HP-160/HP/XP	20.94	17.00	16GA. CRCS
USGF-180/HP-200/HP	25.00	19.00	16GA. CRCS

MODEL	A	B	MATERIAL
USGF-140/HP-160/HP/XP	21.24	2.13	16GA. CRDS
USGF-180/HP-200/HP	25.20	3.00	16GA. CRDS

RICE
ENGINEERING

105 School Creek Trail
Luxemburg, WI 54217
Phone: 920.845.1042
Fax: 920.845.1048
www.rice-inc.com

Texas Firm No: F-2183
L. David Rice
Registration No: 81248



JUN 14 2012

ALL DIMENSIONS ARE IN INCHES

	DATE: 05/30/2012 TIME: 11:44 AM USER: PFEFFER
	SCALE: 1/4" = 1" SHEET: 2 OF 5 HSS5002

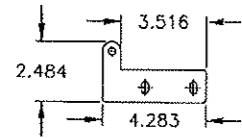

HINGE BRACKET

MODEL	QTY.	MATERIAL
USGF-140/HP-160/HP/XP	4	.190 1100-H14 ALUMINUM
USGF-180/HP-200/HP	4	.190 1100-H14 ALUMINUM

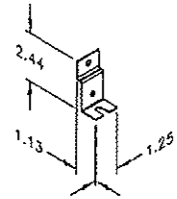

HOODBAND CLIPS

MODEL	QTY.	MATERIAL
USGF-140/HP-160/HP/XP	4	16 GA. GALV G90
USGF-180/HP-200/HP	6	16 GA. GALV G90

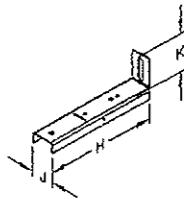

HORIZONTAL SUPPORT

MODEL	H	J	K	QTY.	MATERIAL
USGF-140/HP-160/HP/XP	4.68	1.03	2.00	4	16 GA. GALV. G90
USGF-180/HP-200/HP	5.72	1.03	2.00	6	16 GA. GALV. G90

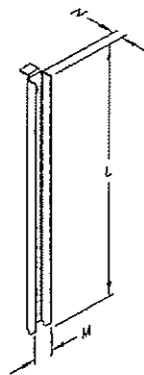

VERTICAL SUPPORT

MODEL	L	M	N	QTY.	MATERIAL
USGF-140/HP-160/HP/XP	10.88	0.885	0.595	4	16 GA. GALV. G90
USGF-180/HP-200/HP	12.78	0.885	0.595	6	16 GA. GALV. G90

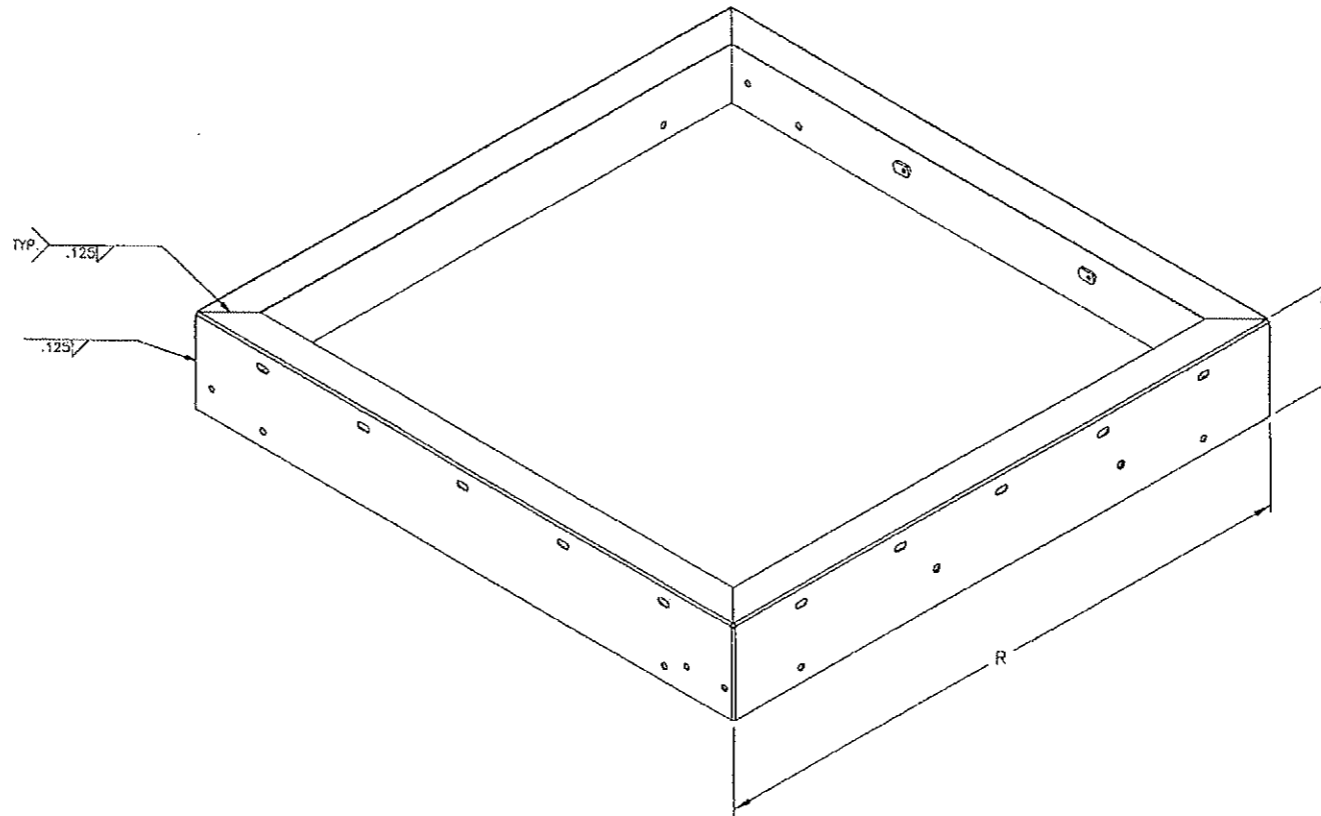

HINGE FRAME ASSEMBLY
1 REQ'D. PER UNIT

MODEL	R	T	MATERIAL
USGF-140-160/HP	25.50	4.58	16 GA. GALV G90
USGF-180/HP-200	29.50	4.58	16 GA. CALV G90

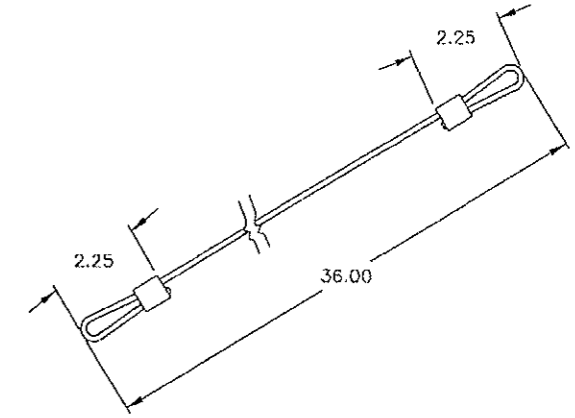

CABLE ASSEMBLY

MODEL	QTY.	MATERIAL
USGF-140/HP-160/HP/XP	2	1/8" GALVANIZED CABLE
USGF-180/HP-200/HP	2	1/8" GALVANIZED CABLE

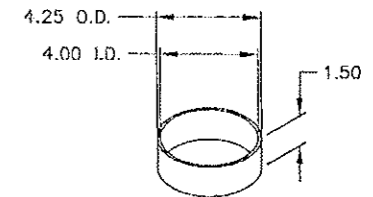

CLEANOUT TUBE

MODEL	QTY.	MATERIAL
USGF-140/HP-160/HP/XP	1	12 GA. CRS
USGF-180/HP-200/HP	1	12 GA. CRS

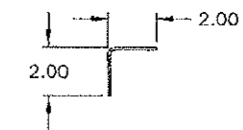

CURB SUPPORT ANGLE

MODEL	QTY.	LENGTH	MATERIAL
USGF-140/HP-160/HP/XP	4	22.61	12 GA. CRS
USGF-180/HP-200/HP	4	26.61	12 GA. CRS

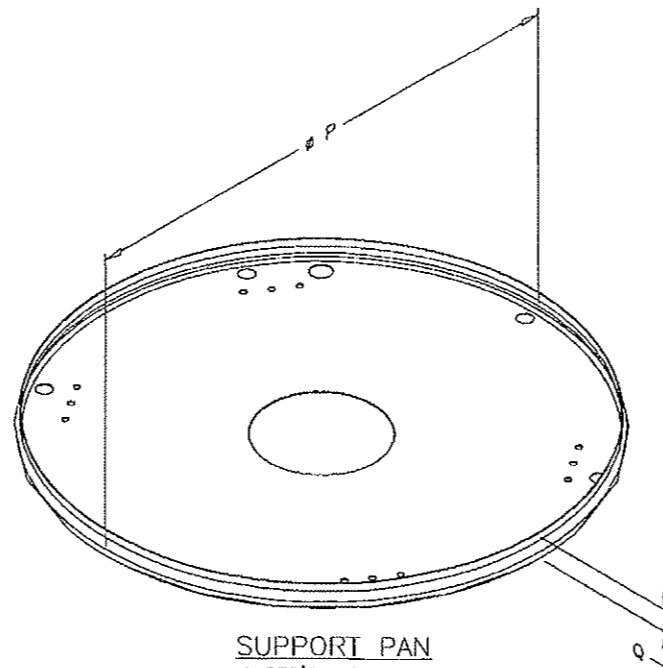

SUPPORT PAN
1 REQ'D. PER UNIT

MODEL	P	Q	MATERIAL
USGF-140-160/HP	20.90	1.50	20 GA. GALV G90
USGF-180/HP-200	25.20	1.20	20 GA. GALV G90

RICE
ENGINEERING

105 School Creek Trail
Luxemburg, WI 54217
Phone: 920.845.1042
Fax: 920.845.1048
www.rice-inc.com

Texas Firm No: F-2183
L. David Rice
Registration No: 81248

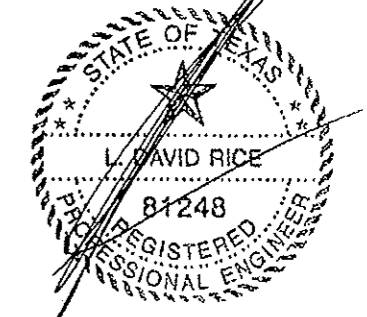

JUN 14 2012

ALL DIMENSIONS ARE IN INCHES

	DATE: 03/30/2012 TIME: 11:45 AM USER: PFEIFFER
	TITLE: USGF 140 THRU 200 SHEET 3 OF 5
SCALE: 1/4" = 1"	PROJECT: HSS5003

HINGE FRAME AND CLEAN OUT ASSEMBLY DETAIL

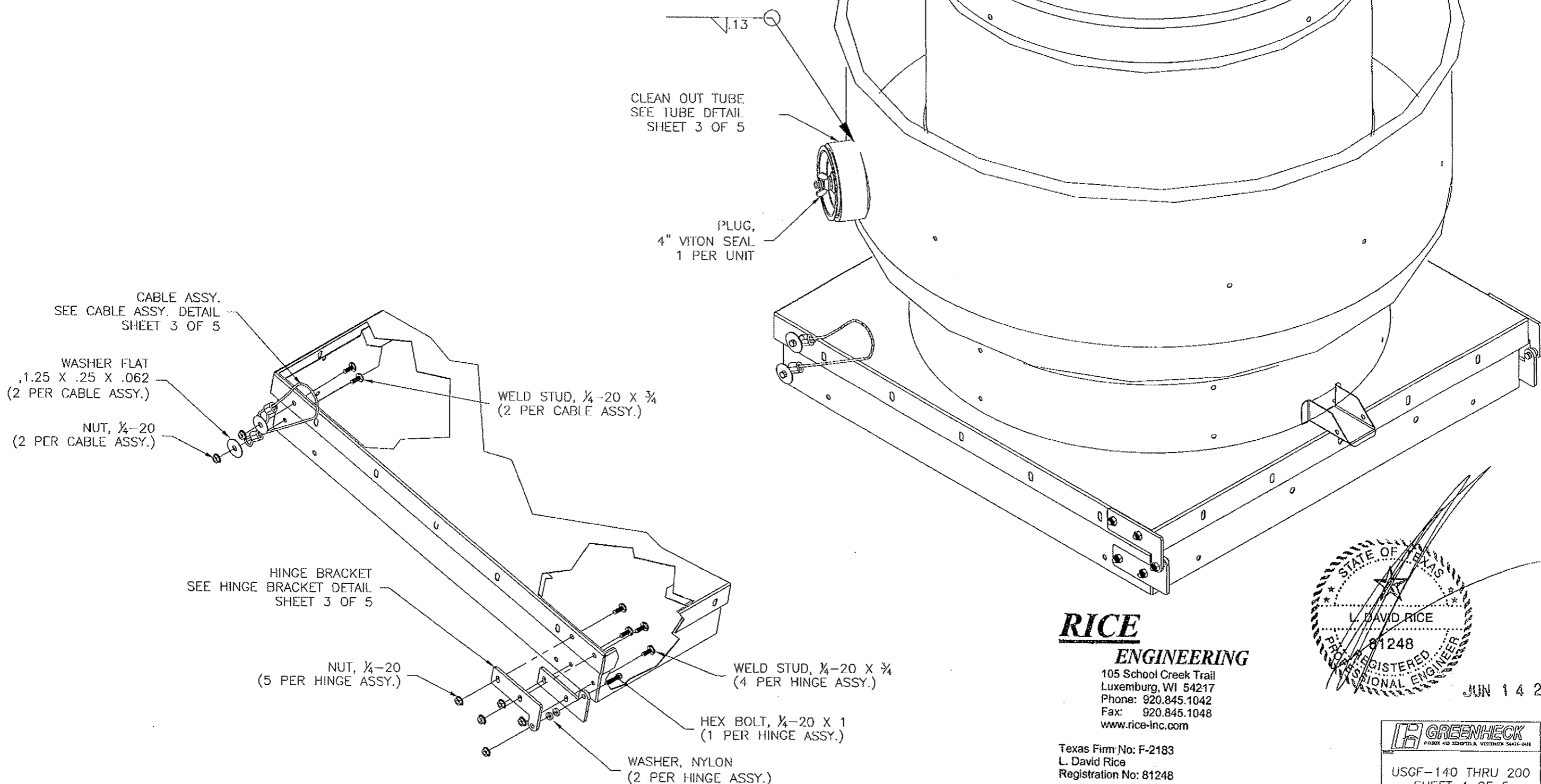

CLEAN OUT TUBE
SEE TUBE DETAIL
SHEET 3 OF 5

PLUG,
4" VITON SEAL
1 PER UNIT

CABLE ASSY.
SEE CABLE ASSY. DETAIL
SHEET 3 OF 5

WASHER FLAT
.125 X .25 X .062
(2 PER CABLE ASSY.)

NUT, 1/4-20
(2 PER CABLE ASSY.)

WELD STUD, 1/4-20 X 3/4
(2 PER CABLE ASSY.)

HINGE BRACKET
SEE HINGE BRACKET DETAIL
SHEET 3 OF 5

NUT, 1/4-20
(5 PER HINGE ASSY.)

WELD STUD, 1/4-20 X 3/4
(4 PER HINGE ASSY.)

HEX BOLT, 1/4-20 X 1
(1 PER HINGE ASSY.)

WASHER, NYLON
(2 PER HINGE ASSY.)

RICE
ENGINEERING

105 School Creek Trail
Luxemburg, WI 54217
Phone: 920.845.1042
Fax: 920.845.1048
www.rice-inc.com

Texas Firm No: F-2183
L. David Rice
Registration No: 81248



JUN 14 2012

	DATE: 03/30/2012 FILE: 1/4.5 SHEET: 4 OF 5	DRAWN BY: [blank] CHECKED BY: [blank] DESIGNED BY: [blank]
	USGF-140 THRU 200 SHEET 4 OF 5	HSS5004

FAN TO CURB MOUNTING

UNIT SIZE	FASTENERS PER SIDE
USGF-140/HP-160/HP/XP	5
USGF-180/HP-200/HP	5

FASTENERS ON EACH SIDE OF THE FAN ARE TO BE INSTALLED WITH ONE FASTENER 4 INCHES FROM EACH EDGE AND ONE FASTENER CENTERED. THE FASTENERS ARE TO BE EQUALLY SPACED. 5/16 INCH SELF-DRILLING SCREWS.

CURB TO DECK MOUNTING

UNIT SIZE	CONCRETE ANCHORING NO. OF FASTENERS PER SIDE	STEEL DECK ANCHORING NO. OF FASTENERS PER SIDE
USGF-140/HP-160/HP/XP	5	5
USGF-180/HP-200/HP	7	7

FASTENERS NEED TO BE LOCATED ON 2 OPPOSITE ENDS OF FAN CURB.

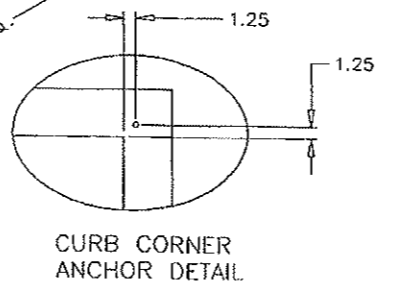
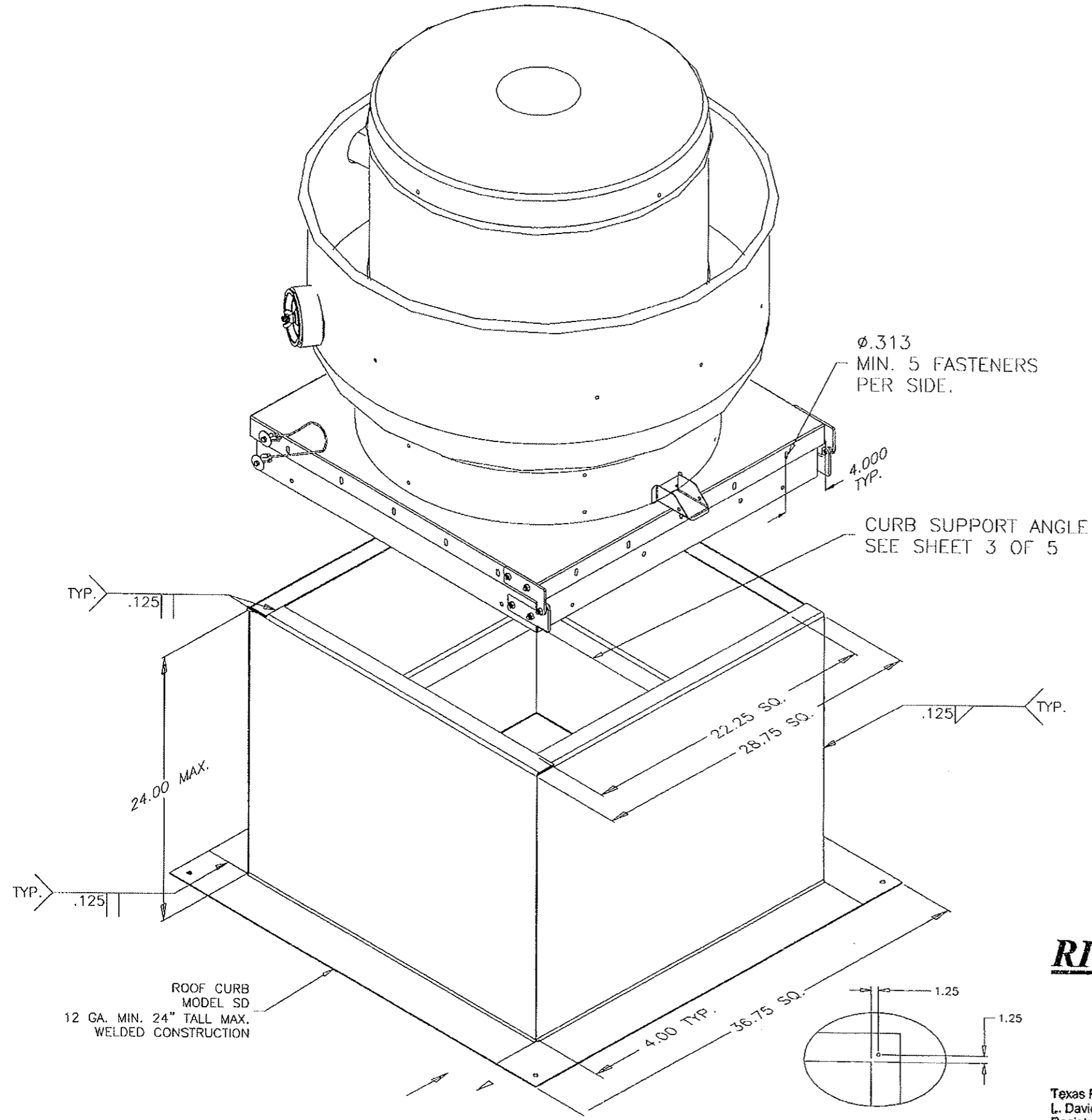
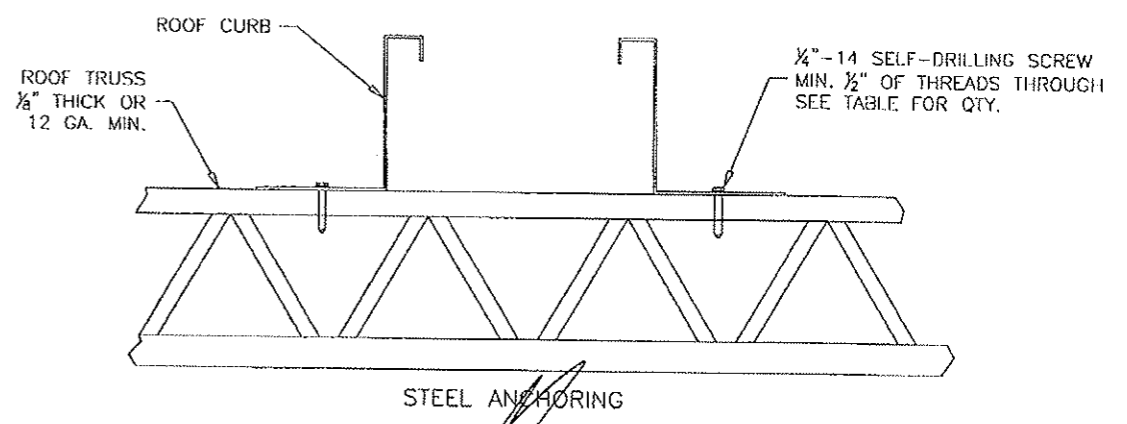
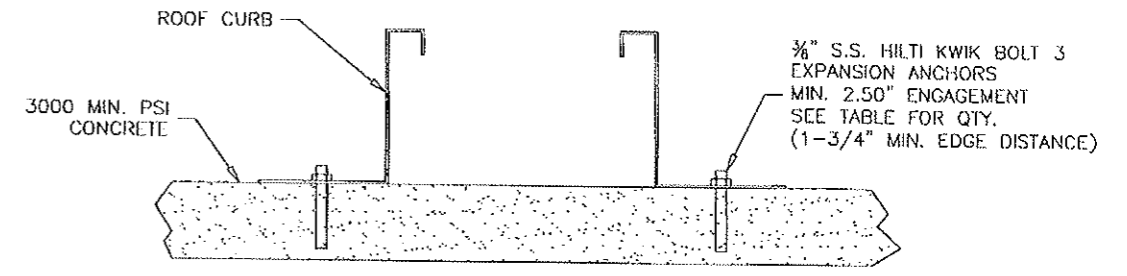

ROOF CURB
MODEL SD
12 GA. MIN. 24" TALL MAX.
WELDED CONSTRUCTION

RICE
ENGINEERING
105 School Creek Trail
Luxemburg, WI 54217
Phone: 920.845.1042
Fax: 920.845.1048
www.rice-inc.com

Texas Firm No: F-2183
L. David Rice
Registration No: 81248

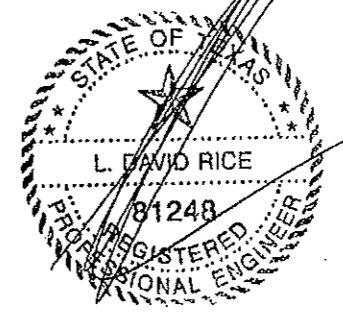

JUN 14 2012
JUN 14 2012

GREENHECK P.O. BOX 418, SCHNITZER, WASHINGTON 98290-0418	DATE: 03/30/2012	BY: PEEFFER
	SCALE: 1/32	PROJECT: HSS505
TITLE: USGF-140 THRU 200 SHEET 5 OF 5		DATE: JUN 14 2012