



6605 Flotilla Street
City of Commerce
CA 90040

DKS SERIES 1800 STEEL COMMERCIAL DOOR OUTSWING "IMPACT"

EVALUATED FOR USE IN THE STATE OF TEXAS

The Cal-Royal Door described herein complies with the 2006 International Residential Code (IRC), Sections R301 and the 2006 International Building Code (IBC), Sections 1405.12, 1609 & 1714.5 (including Texas revisions) subject to the following conditions:

1. Anchors shall be as listed and spaced as shown in the details. Anchor embedment to base material shall be beyond wall dressing or stucco.
2. This system has been tested and evaluated as a large missile impact protective system for installation in the Seaward, Inland I and Inland II areas. This product meets missile level "D" and includes Wind Zone 4 as defined in ASTM E1996.
3. Allowable design pressure requirements must be equal to or less than the design pressure rating shown in the design pressure chart, sheet 1 of this drawing.
4. Conditions not covered by this drawing are subject to further engineering analysis.

TABLE OF CONTENTS	
SHEET#	DESCRIPTION
1	Typical elevation, design pressures & general notes
2	Door panel details
3	Horizontal and vertical cross sections
4	Frame anchoring
5	Frame anchoring
6	Components
7	Bill of materials and components

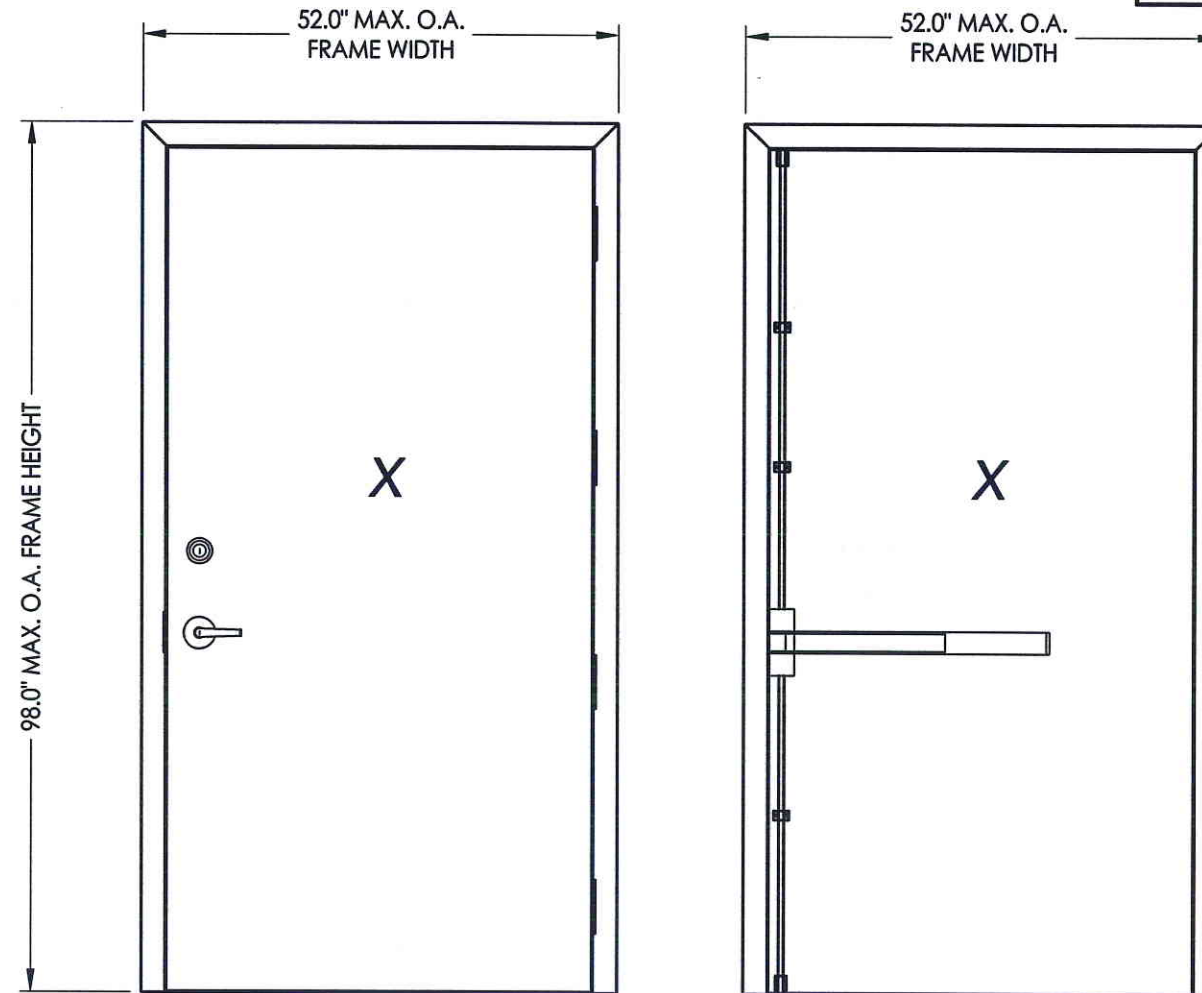

161 Latch & Deadbolt
"Pioneer SL/CSL Series" Latch
"T300 Series" Deadbolt

Panic Bar Exit Device
w/ Vertical Rods
"7700-V Series"

OVERALL FRAME DIMENSION	LOCK TYPE	DESIGN PRESSURE (PSF) OUTSWING	
		POSITIVE	NEGATIVE
52.0" x 98.0"	161 LATCH & DEADBOLT "PIONEER SL/CSL & T300 Series"	+80.0	-80.0
40.0" x 98.0"	PANIC BAR EXIT DEVICE w/ VERTICAL RODS "7700-V Series"	+70.0	-70.0
52.0" x 98.0"	PANIC BAR EXIT DEVICE w/ VERTICAL RODS "7700-V Series"	+50.0	-50.0

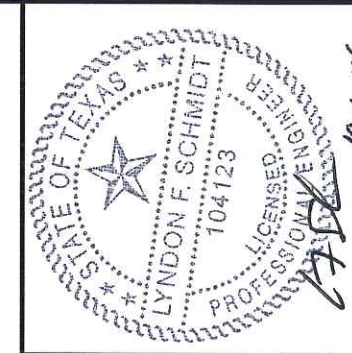

Documents Prepared By: Lyndon F. Schmidt, P.E.
TEXAS P.E. #104123

RW BUILDING CONSULTANTS, INC.
P.O. Box 230 Varico FL 33595
Phone No.: 813.659.9197

TEXAS BOARD OF PROFESSIONAL ENGINEERS
CERTIFICATE OF REGISTRATION # F-11852

PRODUCT: CAL-ROYAL
STEEL COMMERCIAL DOOR
PART OR ASSEMBLY:
TYPICAL ELEVATION, DESIGN
PRESSURES & GENERAL NOTES

NO.	DATE	BY	REVISIONS

DATE: 10/1/14
SCALE: N.T.S.
DWG. BY: JK
CHK. BY: LFS
DRAWING NO.:
TX-4483

SHEET 1 OF 7

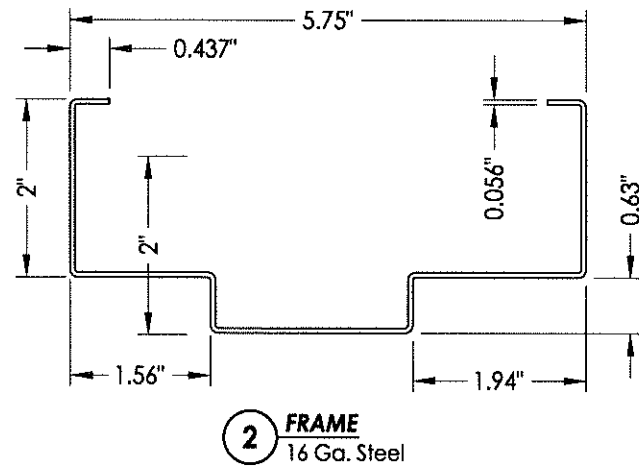

2 FRAME
16 Ga. Steel

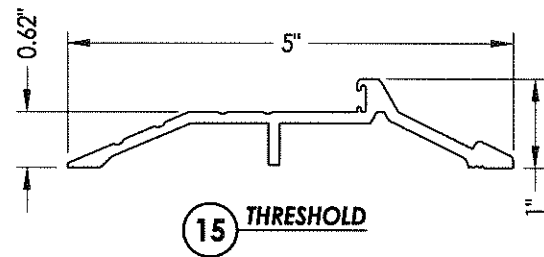

15 THRESHOLD

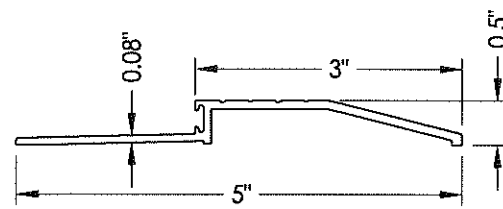

18 THRESHOLD

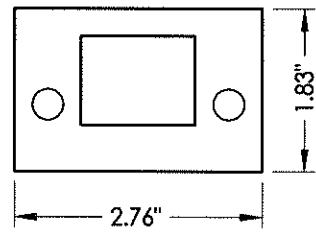

91 VERTICAL ROD LATCH STRIKE PLATE
@ Sill

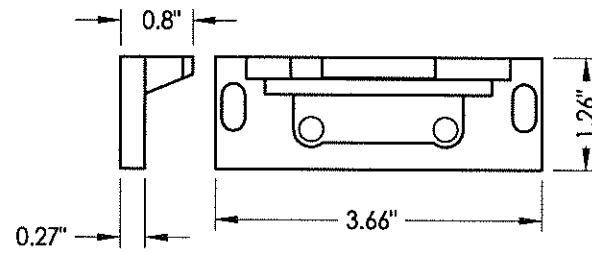

90 VERTICAL ROD LATCH STRIKE PLATE
@ Head

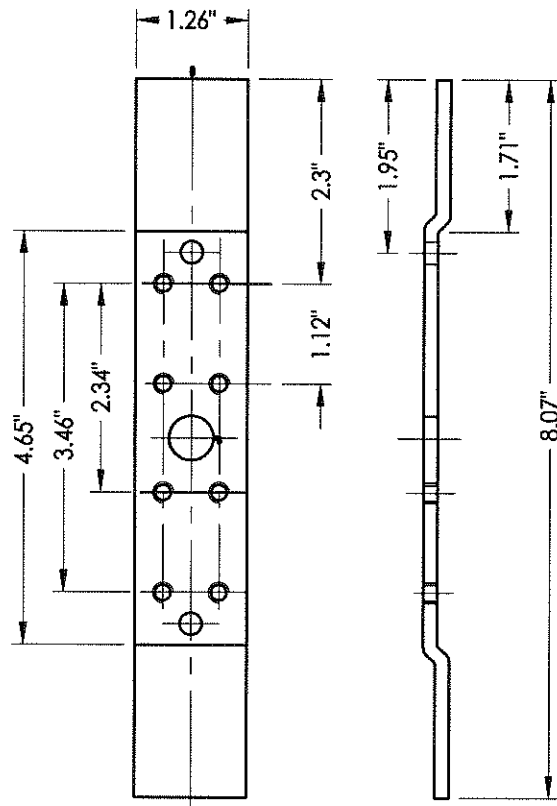

11 FRAME HINGE REINFORCEMENT
8 Ga. Steel

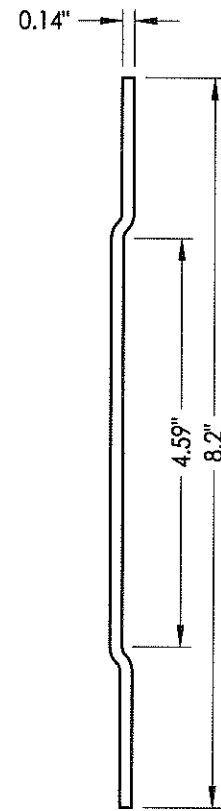

7 DOOR HINGE REINFORCEMENT
8 Ga. Steel

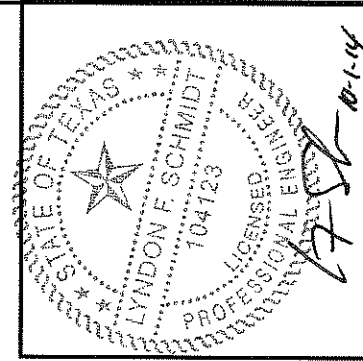
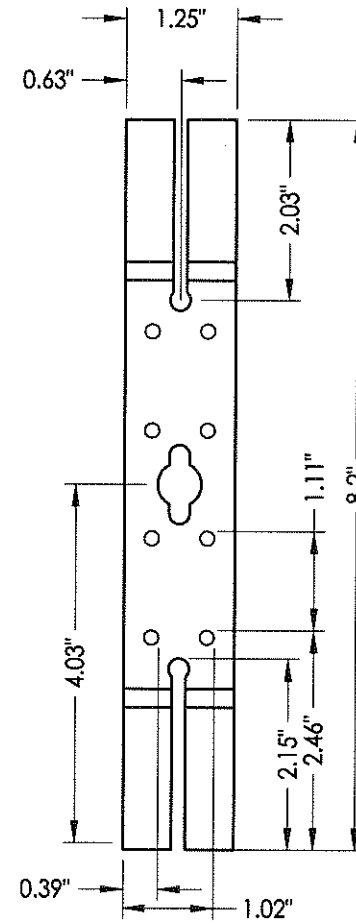

Documents Prepared By: Lyndon F. Schmidt, P.E.
TEXAS P.E. #104123

RW BUILDING CONSULTANTS, INC.
P.O. Box 230 Vairco FL 33595
Phone No.: 813.659.9197

TEXAS BOARD OF PROFESSIONAL ENGINEERS
CERTIFICATE OF REGISTRATION # F-11852

PRODUCT: CAL-ROYAL
STEEL COMMERCIAL DOOR

PART OR ASSEMBLY:
BILL OF MATERIALS AND
COMPONENTS

NO.	DATE	BY	REVISIONS

DATE: 10/1/14
SCALE: N.T.S.
DWG. BY: JK
CHK. BY: LFS
DRAWING NO.: TX-4483
SHEET 6 OF 7

\\2012ess\RWBC\Clients\Cal-Royal NEW\Texas Dept of Ins\TDI - 472 Renewal\Drawings\Current\TEXAS 2014.dwg, 1-7

BILL OF MATERIALS		
ITEM #	DESCRIPTION	MATERIAL
E	MASONRY - 3,000 PSI MIN. CONCRETE CONFORMING TO ACI 301 OR HOLLOW BLOCK CONFORMING TO ASTM C90	CONCRETE
F	1/4" X 2-1/4" ITW PFH CONCRETE SCREW	STEEL
G	3/8" X 2" PFH ITW DYNABOLT SLEEVE ANCHOR	STEEL
H	3/8" X 2" PFH TAPPER CONCRETE SCREW BY POWERS FASTENERS	STEEL
P	#12 X 2-1/2" PFH WOOD SCREW	STEEL
Q	WOOD STRAP ANCHOR	STEEL
1	DOOR PANEL	STEEL
2	HOLLOW FRAME 2"	STEEL
3	BOTTOM CHANNEL	STEEL
4	FLUSH TOP CHANNEL	STEEL
5	LOCK BOX REINFORCEMENT	STEEL
5A	LOCK BOX REINFORCEMENT	STEEL
6	DOOR CLOSER REINFORCEMENT (11 GA.)	STEEL
7	DOOR HINGE REINFORCEMENT	STEEL
8	WEATHERSTRIP - COMPRESSION BULB 1/4" X 1/2" (PEMCO S88)	NEOPRENE
9	4-1/2" X 4-1/2" X 0.125" TEMPLATE HINGE	STEEL
10	#12-24 X 1/2" PFH MACHINE SCREW	STEEL
11	FRAME HINGE REINFORCEMENT	STEEL
12	#12-24 X 1" COMBINATION MACHINE / WOOD SCREW	STEEL
13	DEAD BOLT STRIKE	STEEL
14	ANSI LATCH STRIKE	STEEL
15	THRESHOLD (PEMCO #181_T)	ALUM
16	WEATHERSTRIP (THERMOSEAL™)	NEOPRENE
17	UNIVERSAL WALL ANCHOR REINFORCEMENT	STEEL
18	THRESHOLD (PEMCO 2001P)	ALUM
19	TUBE ANCHOR REINFORCEMENT	STEEL
20	CAL-ROYAL PIONEER SL/CSL SERIES GRADE 2 CYLINDRICAL LOCK	-
21	CAL-ROYAL T300 MAX. SECURITY HEAVY-DUTY DEAD BOLT GRADE 2 LOCK	-
22	#8-24 X 3/4" COMB. MACHINE / WOOD SCREW	STEEL
23	CAL-ROYAL 7700-V SERIES VERTICAL ROD EXIT DEVICE	-
90	VERTICAL ROD LATCH STRIKE PLATE @ HEAD	STEEL
91	VERTICAL ROD LATCH STRIKE PLATE @ SILL	STEEL

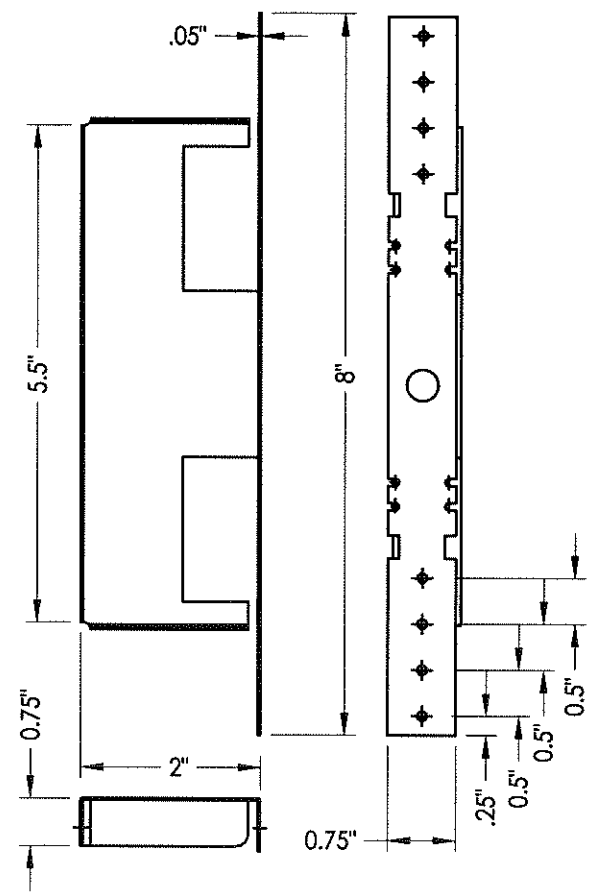

Q WOOD STRAP ANCHOR

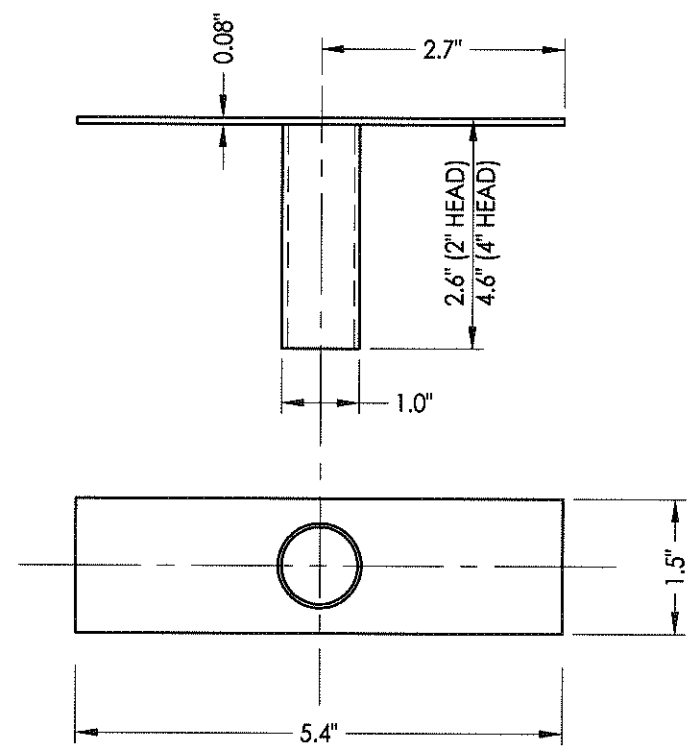

19 TUBE ANCHOR

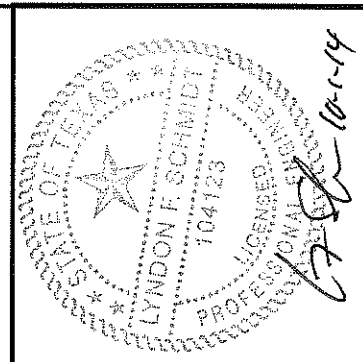

Documents Prepared By: Lyndon F. Schmidt, P.E.
TEXAS P.E. #104123

RW BUILDING CONSULTANTS, INC.
P.O. Box 230 Valrico FL 33595
Phone No.: 813.659.9197

TEXAS BOARD OF PROFESSIONAL ENGINEERS
CERTIFICATE OF REGISTRATION # F-11852

PRODUCT: CAL-ROYAL
STEEL COMMERCIAL DOOR

PART OR ASSEMBLY: BILL OF MATERIALS AND COMPONENTS

NO.	DATE	BY	REVISIONS

DATE: 10/1/14
SCALE: N.T.S.
DWG. BY: JK
CHK. BY: LFS
DRAWING NO.: TX-4483
SHEET 7 OF 7